

07210/DOW
BuyLine 2930

BLUEPRINTS* Services

Specially Designed
Commercial/
Roofing Insulation
Products and
Systems

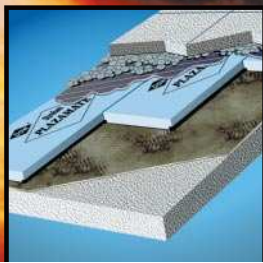
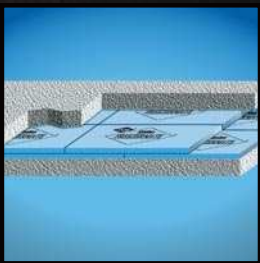
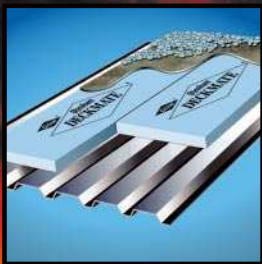
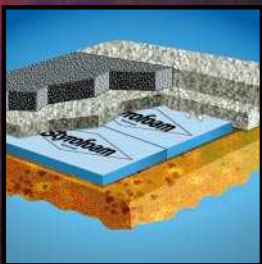
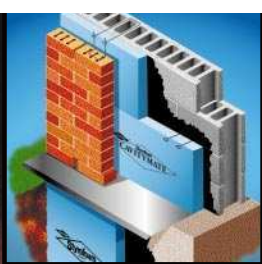

*Trademark of The Dow Chemical Company

STYROFOAM Brand Insulation - The Right Insulation For Every Application.

Throughout these pages, you'll discover a complete range of STYROFOAM® brand insulation products and systems for many commercial, roofing, geotechnical and low temperature projects you may be involved in. Use this brochure to identify the STYROFOAM product best suited to your application. Then call the appropriate toll-free number for product availability or technical literature.

PROVEN PERFORMANCE

Since its introduction in 1948, STYROFOAM brand insulation, the Blue* extruded polystyrene foam, has been a proven performer in millions of installations worldwide. The reason: its unique, tight closed cell structure leaves no voids between the cells. The result: high compressive strength and unequalled resistance to water penetration.

But don't take our word for it. Lab and field test studies clearly document the performance of

STYROFOAM brand products. These test results (graphically represented on this page) make it clear that STYROFOAM brand insulation consistently out-performs competitive insulating materials in the lab and in the real world. And that's why we can offer a 15-year limited thermal performance warranty, the most comprehensive thermal warranty in the industry. Contact your Dow representative for more details.

Water Submersion Lab Test

Indicates how much water an insulation product absorbs when subjected to moisture in a liquid form. (Test Method ASTM D 2842). Test was conducted by Dow Technical Service & Development Group.

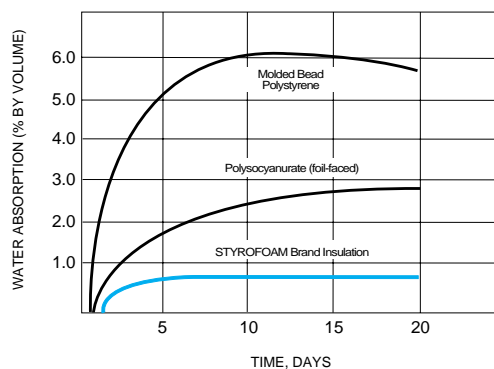

R-value Retention Lab Test

Indicates the retained thermal resistance of insulation products when subjected to moisture in a liquid form for over 200 hours. (Test Method ASTM C518,C177). Test was conducted by Ortech International.

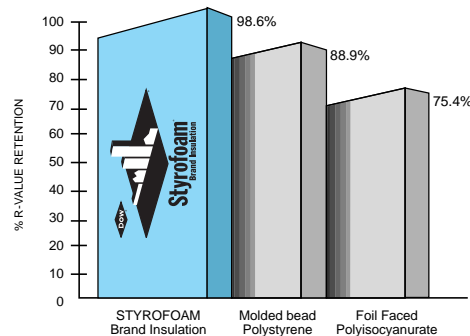

R-value Retention and Water Absorbption Lab Test

Indicates retained thermal resistance and water absorption of insulation products subjected to vapor drive for 300 days. Test was conducted by the U.S. Army Corps of Engineers' Cold Regions Research and Engineering Laboratory (CRREL).

% Retained R-Value
 % Water Absorption by Volume

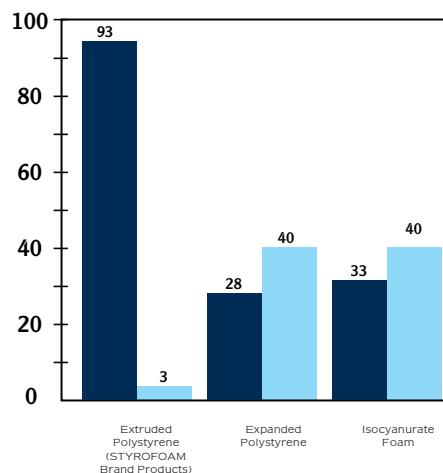

Water Absorbption in Freeze-Thaw Cycling

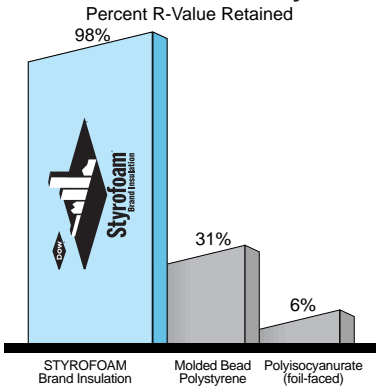
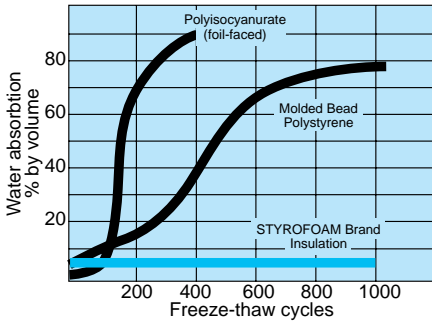

Freeze-thaw cycle lab test indicates how much water an insulation product absorbs when subjected to many hundreds of freeze/thaw cycles, where 414 cycles is roughly equivalent to a 10-year exposure period. (Test method ASTM C 666 procedure B)

R-value retention in Freeze-thaw cycling test indicates the retained thermal resistance of the insulation products after 414 freeze/thaw cycles. (Test method ASTM C 666 procedure B)

ENVIRONMENTAL ACTIVITIES



Dow has taken a leadership role in defining and implementing solutions to environmental concerns.

have ozone depletion potentials over 90 percent less than standard CFC blowing agents.

By July 1990, Dow had completely phased out CFCs in STYROFOAM brand products at all nine of its North American plants. Six European plants and all plants in Japan and Brazil have also been converted. The world's largest manufacturer of extruded polystyrene foam and the largest U.S. supplier, Dow was the first to begin conversion, shortly after the correlation between CFCs and ozone depletion was made.

STYROFOAM brand products can be re-used, even after decades in place. In commercial buildings, low temperature facilities and marine docks. STYROFOAM brand products, particularly roof insulation - have been salvaged and re-used while other building components are discarded. Product re-use is the ultimate way to save money, conserve energy and minimize contributions to the waste stream.

This quick response was made possible by extensive research which yielded CFC substitutes.

The reason for the established insulating performance is that the structure and composition of STYROFOAM brand insulation provide the properties that curb thermal drift - the continuous loss of R-value in most other rigid foam insulating products.

STYROFOAM brand products, in North America are manufactured with HCFC blowing agents which

LIMITED THERMAL WARRANTIES

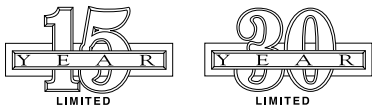

The R-value of STYROFOAM brand insulation products is 5.0 per inch @ 75° mean temperature and many products are backed by a 15 year Limited Thermal Warranty.

The R-value of STYROFOAM CAVITYMATE* Ultra brand insulation products is 5.6 per inch @ 75° mean temperature and is backed by a 30 year Limited Thermal Warranty.

DOW HELPS

In selecting STYROFOAM brand insulation, you're not only getting superior products, you're tapping into Dow's vast resources. For example, a simple phone call can put you in touch with a highly skilled insulation professional who can provide you with technical assistance along the way, from the blue-prints stage right through to completion.

For product availability or the name of your local sales representative, call 1-800-232-2436.

For additional information, technical data sheets, case studies, or literature on any of the insulation products and systems listed in this brochure, call 1-800-441-4369.

Above Grade Wall Insulation and Systems

CAVITY WALL APPLICATIONS

Products: STYROFOAM CAVITYMATE, CAVITYMATE Plus and CAVITYMATE* Ultra brand insulation.

Application: Installed directly between the wall ties on 16" centers. Designed to save the contractor time and money, the 16" width eliminates the need to cut or snap the insulation to the correct dimension to fit into the cavity wall.

Note: STYROFOAM brand Score Board insulation may also be used in this application.

Features and Benefits:

Proven Moisture Resistance - long lasting thermal performance.

Specially designed 16" width - fits directly between wall ties without cutting or snapping - quick installation, tight joints, quality job.

Lightweight - easy to work with and easy to handle on scaffolding.

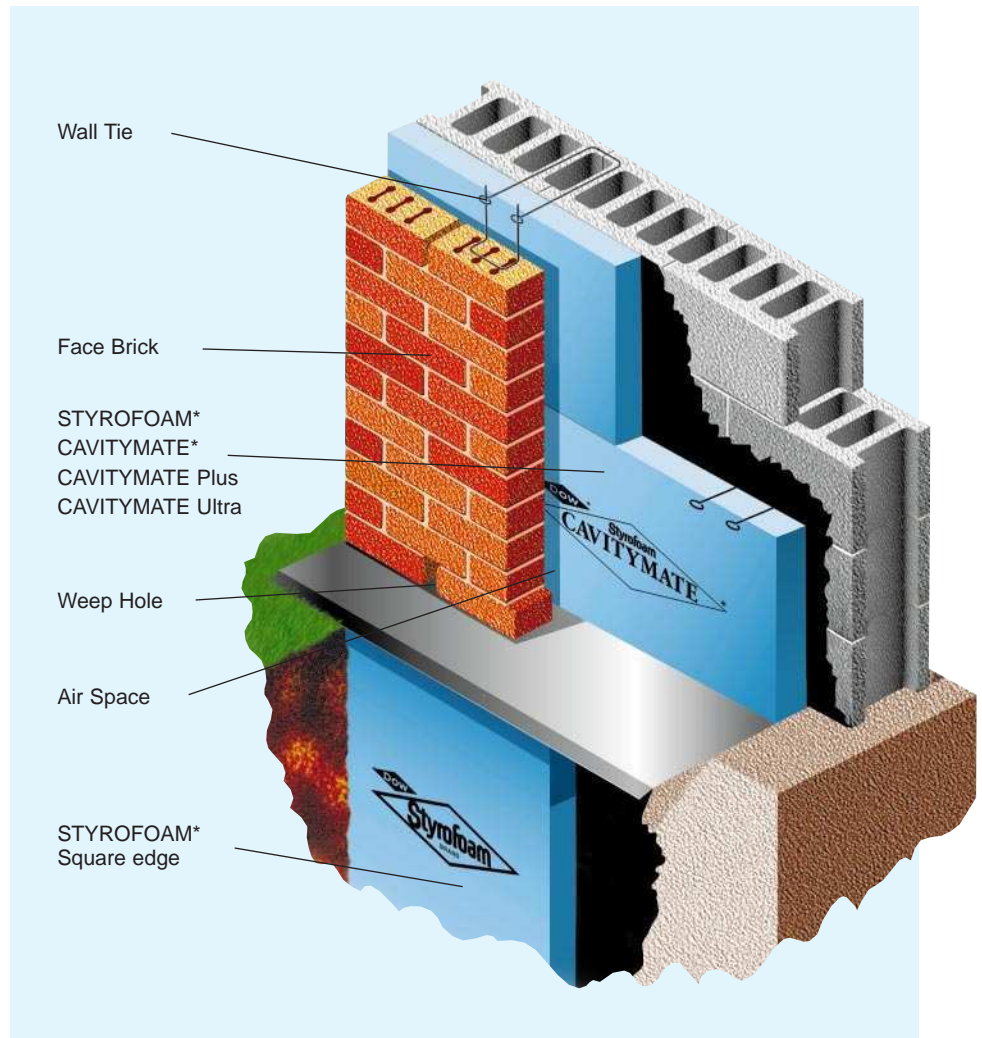

THE CAVITYMATE LINE-UP

The Dow Chemical Company offers an insulation for every cavity wall application need through its new line of STYROFOAM CAVITYMATE brand insulation products. Architects, specifiers and contractors can now choose from three CAVITYMATE brand products to fulfill a variety of thermal protection requirements.

	GOOD	BETTER	BEST
Width	16"	16"	16"
R-Value (per inch)	R=5.0	R=5.0	R=5.6
ASTM-C578	Type X	Type IV	Type IV
Thickness	1", 1.5", 2"	1.0, 1.5", 2"	1 5/8", 2" †
Compressive Strength	15	25	25
Warranty		15-Year Warranty	30-Year Warranty

† Nominal thickness

FOUNDATION WALL AND DRAINAGE APPLICATIONS

Products: STYROFOAM brand Square Edge and Score Board insulation.

Application: Installed against the exterior foundation wall.

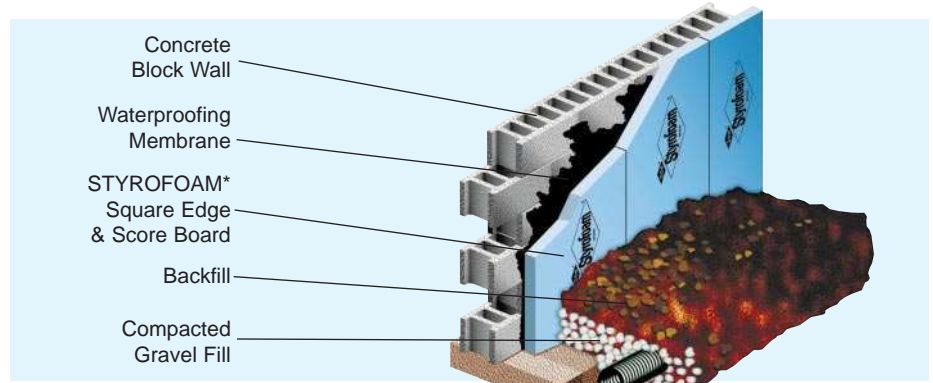

Features and Benefits:

Proven moisture resistance - long lasting thermal performance.

High compressive strength - rigid, durable and resistant to crushing by back fill.

Lightweight and easy to cut - easy to work with on the jobsite.

Product: STYROFOAM PERIMATE® brand insulating drainage panels.

Application: STYROFOAM PERIMATE panels have grooved drain channels on one face. PERIMATE is installed on the exterior of foundation walls with the drainage grooves facing the soil and connected to a foundation tile and gravel drainage system. In a single application step, the panels provide protection for the waterproofing, thermal insulation and drainage of the subsurface soil moisture.

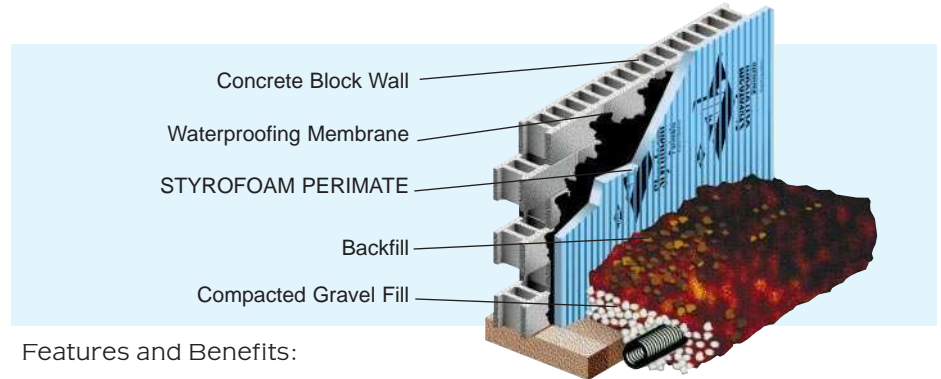

Features and Benefits:

Moisture resistance, high compressive strength and protection for waterproofing - long term insulating value in wet or high compressive conditions.

Channels direct water away from walls into the drainage system - water drains, R-Value remains, keeping below - grade interior spaces dry and energy efficient.

Simple, fast, conventional and economical installation - protection, thermal insulation and drainage all in one.

Product: Dow Protection Board II.

Application: Recommended for perimeter concrete and masonry walls where waterproofing protection is the primary requirement. It is installed against the exterior foundation wall.

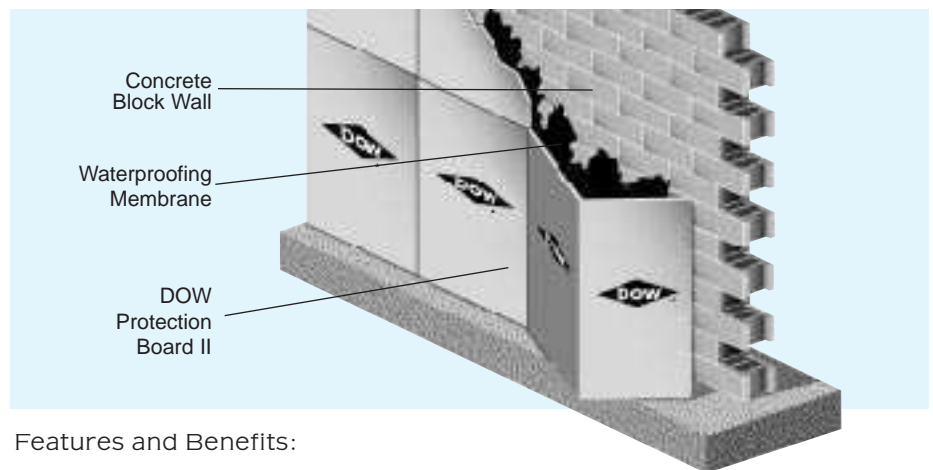

Features and Benefits:

Dow Protection Board II is tough and resistant - helps protect the waterproofing membrane from damage during backfill.

Proven moisture resistance - long term R-value retention.

Supplied in standard bundles, fan-folded on 2 foot centers - easy to install and work with on the jobsite.

PRECAST WALL APPLICATIONS

THERMOMASS Composite Technologies Building System®

Product: STYROFOAM Brand Square Edge Wide Insulation.

Application: Concrete is poured on both sides of the foam and is held together structurally with connectors. Composite non-conducting connectors are inserted in factory-drilled holes in specially fabricated foam. Sandwich panels can be tilt wall, precast, prestressed or poured-in-place wall construction.

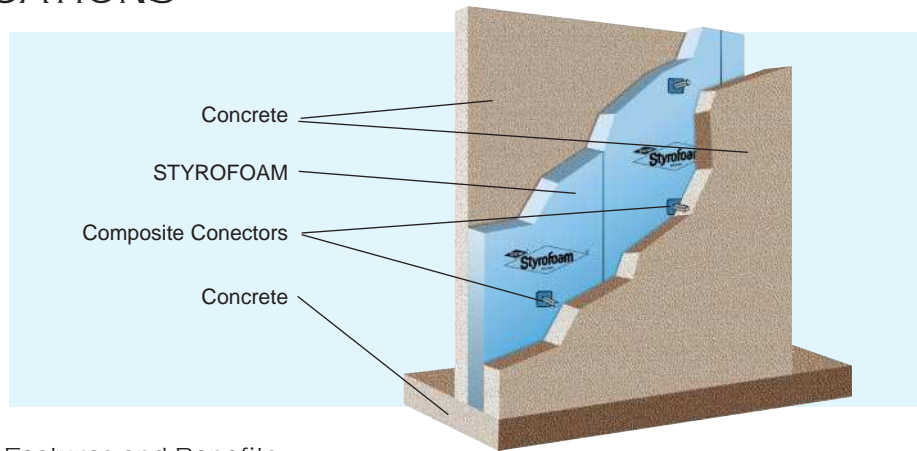

Features and Benefits:

Proven moisture resistance - long lasting thermal performance. The strength of concrete, the long term R-value of STYROFOAM brand insulation - walls are durable, strong and energy efficient.

Sandwich Panel

Product: STYROFOAM Brand Square Edge Insulation.

Application: Concrete is poured on both sides of the foam and is held together structurally with connectors. Steel connectors are typically pushed through the foam. Sandwich panels can be tilt wall, precast, prestressed or poured-in-place wall construction.

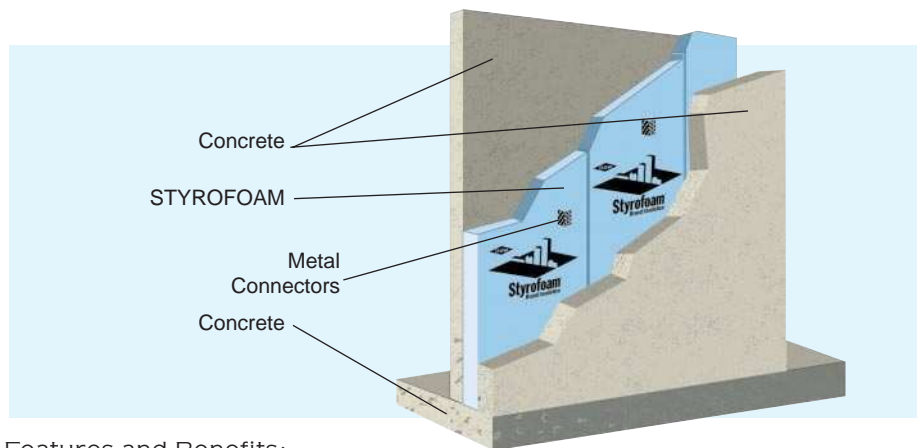

Features and Benefits:

Proven moisture resistance - long lasting thermal performance. The strength of concrete, the long term R-value of STYROFOAM brand insulation - walls are durable, strong and energy efficient.

INTERIOR WALL INSULATION

Product: STYROFOAM Z-MATE* brand insulation.

Application: Pre-cut to 23 7/8-inch x 96-inch boards, STYROFOAM Z-MATE brand insulation can be installed between Z-furring channels placed on 24-inch centers without cutting or trimming, saving time and money.

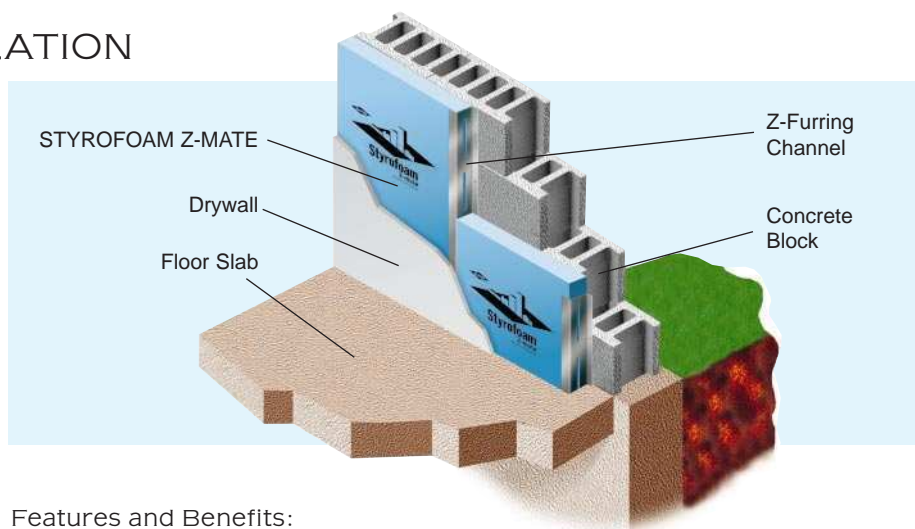

Features and Benefits:

Specially designed 23 7/8-inch x 96-inch boards - fits directly between Z-furring channels without cutting or trimming and delivers consistent 2 ft. centers once installed. Lightweight - easy to work with and install on the job site. Proven moisture resistance - long lasting thermal performance.

CONVENTIONAL ROOFING INSULATION APPLICATIONS

LOOSE LAID BALLASTED SYSTEM

Products: STYROFOAM DECKMATE* and DECKMATE Plus brand insulation.

Application: STYROFOAM DECKMATE and DECKMATE Plus brand insulation are installed directly on the structural deck, including metal decking, eliminating the need for a labor intensive thermal barrier. This is followed by a sheet membrane and ballast.

DECKMATE and DECKMATE Plus brand insulation continue to provide lasting performance even when the membrane fails to do so. When the membrane reaches the end of its useful life and must be replaced, the DECKMATE and DECKMATE Plus can be reused. Reusing DECKMATE and DECKMATE Plus saves building owners the cost of new insulation, as well as labor and disposal costs. DECKMATE and DECKMATE Plus brand insulation may be the only insulation the roof will ever need, making it an exceptional investment.

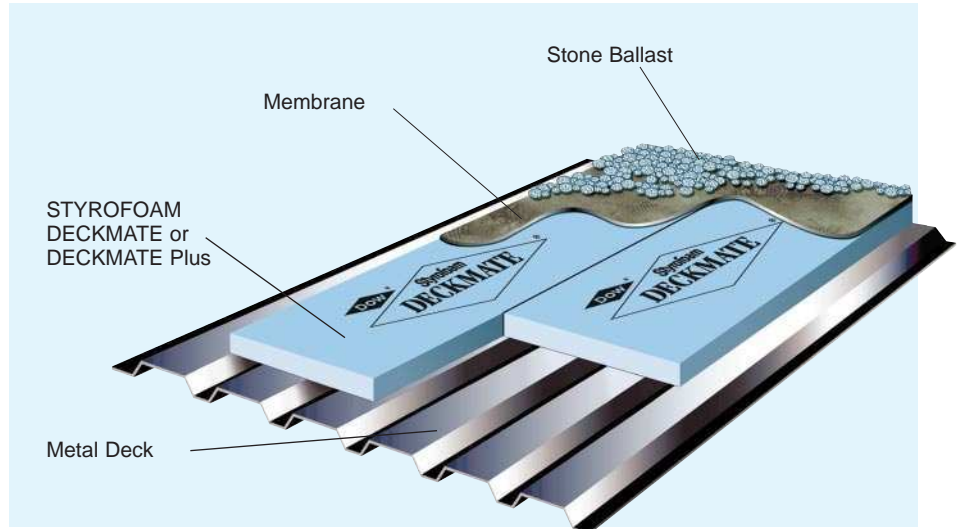

Features and Benefits:

- High moisture resistance - long term R-value retention.
- High compressive strength - excellent durability and resistance to damage. Withstands foot traffic and gravel buggies without crushing.
- Can be reused - excellent economic value and return on investment.
- Excellent handling characteristics - easy to cut and install or store.
- Fifteen year limited thermal warranty - provides peace of mind and assurance of product performance.

STYROFOAM brand Insulation may be installed directly on metal deck according to Underwriters Laboratory Construction 260 and 440. Consult Dow for installation recommendations in your locale.

TAPERED INSULATION SYSTEM

Products: Tapered STYROFOAM DECKMATE and DECKMATE Plus brand insulation.

Application: STYROFOAM DECKMATE and DECKMATE Plus brand tapered panels are installed on flat roof decks. The tapered insulation system is designed to provide positive slope to facilitate roof drainage. This is followed by a membrane and ballast or other securement system. Mechanically fastened dark-colored and adhered membranes require a coverboard.

STYROFOAM DECKMATE Plus brand tapered insulation is an ideal choice for both new and retrofit construction, providing a cost-effective method to roof systems requiring a positive slope. A STYROFOAM DECKMATE Plus brand tapered insulation system maybe the only insulation a roof will ever need, making it an exceptional investment.

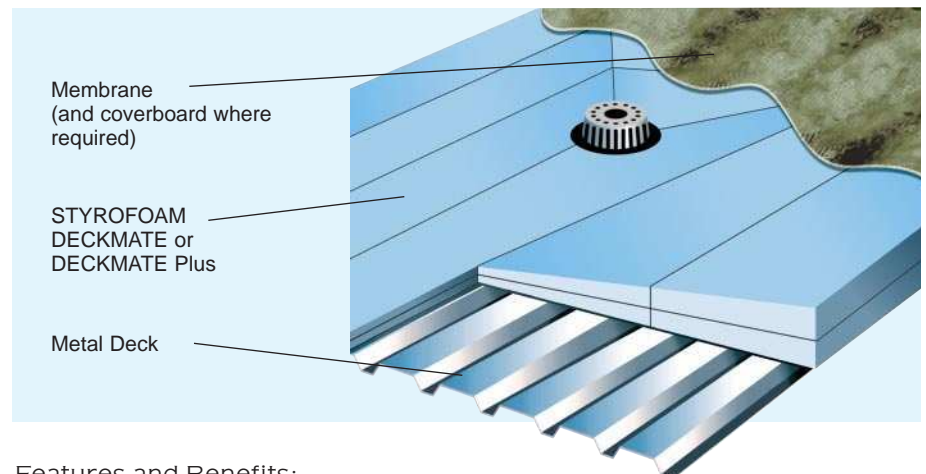

Features and Benefits:

- Precision tapered panels - facilitates water drainage.
- Approved fabricators - provides take-offs. Experienced custom fabricators provide exceptional job service while assuring optimum drainage.
- Durable extruded polystyrene - allows for thinner cut cross-sections, reducing waste
- High compressive strength - exceptionally durable and resistant to damage, withstands foot traffic, excellent substrate for membranes.
- Fifteen year limited thermal warranty - provides peace of mind and assurance of performance.

MECHANICALLY FASTENED AND FULLY ADHERED SYSTEMS

Products: Flat or Tapered STYROFOAM DECKMATE and DECKMATE Plus brand insulation.

Application: Flat or Tapered STYROFOAM DECKMATE and DECKMATE Plus brand insulation is installed directly on the structural deck, including steel decking, eliminating the need for an extra labor intensive thermal barrier. This is followed by the application of a mechanically fastened sheet membrane, or a coverboard and fully adhered sheet or bituminous membrane.

DECKMATE and DECKMATE Plus provide lasting performance and continue to perform even when the membrane fails to do so. When the membrane reaches the end of its useful life and must be replaced, DECKMATE and DECKMATE Plus can be reused, saving the building owner the cost of new insulation as well as labor and disposal costs. DECKMATE and DECKMATE Plus may be the only insulation the roof will ever need, making it an exceptional investment.

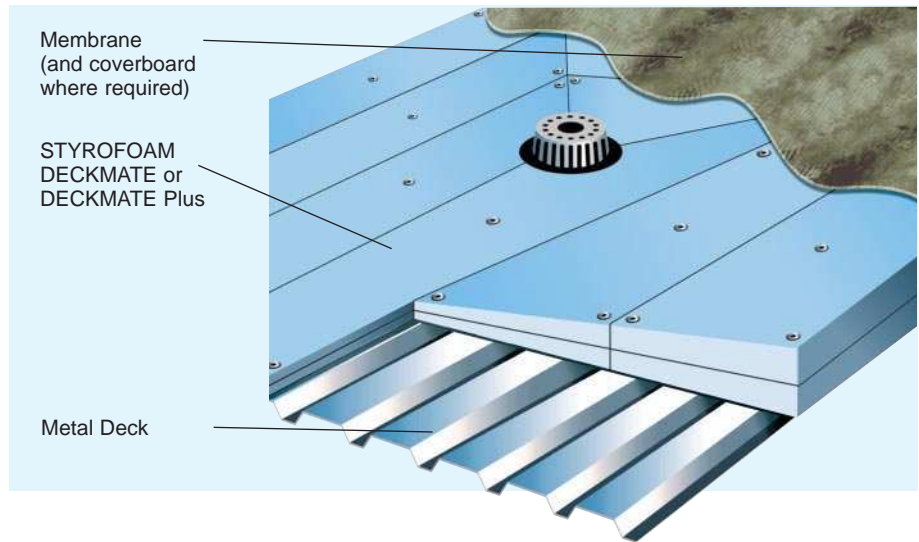

Features and Benefits:

- High moisture resistance - maintains R-value, long term. Easy to store.
- High compressive strength - exceptionally durable and resistant to damage, withstands foot traffic, excellent substrate for membranes.
- Insulation is re-usable in most circumstances - excellent economic value and return on investment.
- Excellent handling characteristics - easy to cut and install.
- Fifteen year limited thermal warranty - provides peace of mind and assurance of performance.

STYROFOAM brand insulation may be installed directly on metal deck according to Underwriters Laboratory Construction 260 and 440. Consult Dow for installation recommendations in your locale.

ROOFING RECOVERY APPLICATION

Product: STYROFOAM RECOVERMATE* brand insulation.

Application: STYROFOAM RECOVERMATE brand insulation is placed over the entire surface of the old roof, where it functions as a separator layer between the old roof and a new, single ply roofing system.

RECOVERMATE is installed over the existing membrane and followed by a ballasted or mechanically attached sheet membrane. Plasticized membranes require a separation sheet between the RECOVERMATE and the membrane. Unlike conventional recovery materials, RECOVERMATE retains its compressive strength even when wet. RECOVERMATE is unique in that it is the only extruded polystyrene product that can withstand temperatures to 200°F while maintaining acceptable dimensional stability.

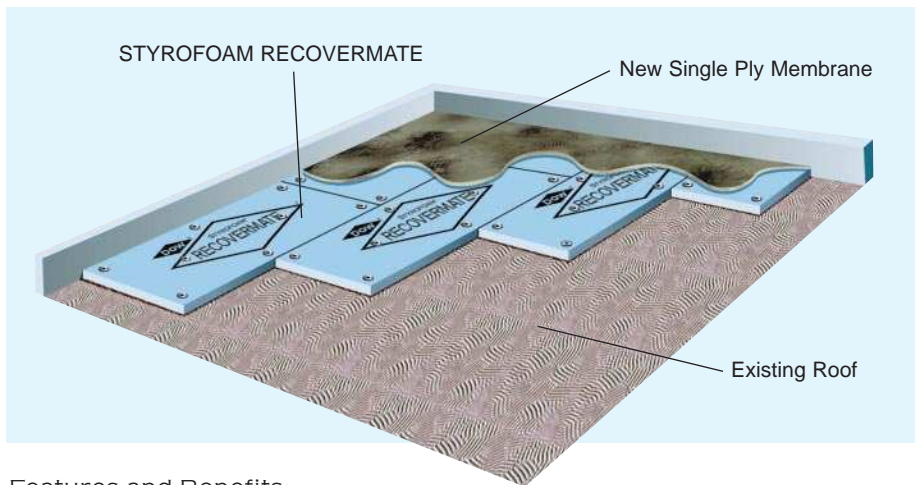

Features and Benefits:

- Moisture resistant - unlike conventional recovery products, will maintain its integrity for the lifetime of the roofing system.
- High compressive strength - able to withstand the weight of ballast and pedestrian traffic.
- Superior compressive retention - reduces the potential for membrane problems at fastener locations.
- Excellent dimensional stability - a unique product that withstands the high temperatures which can occur directly below dark colored sheet membranes.
- Excellent handling characteristics - lightweight, easy to cut, handle, store and install on the job site.

*Trademark of The Dow Chemical Company

ROOFING APPLICATIONS

Products: STYROFOAM ROOFMATE* and Ribbed ROOFMATE brand insulations.

Application: STYROFOAM ROOFMATE brand insulation with fabric and ballast or ribbed ROOFMATE with paver ballast is installed above the waterproofing membrane, eliminating most causes of premature roof failure.

MEMBRANE TEMPERATURES

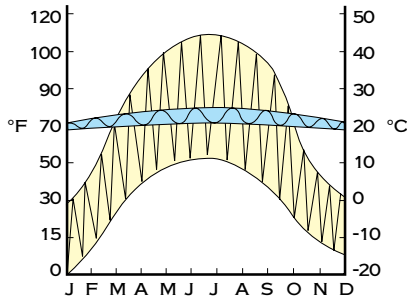

Membrane Temperature Field Test

Membrane Protection (PMR vs. Conventional). Field studies have shown that a constant temperature can extend the life of the membrane. Compare a PMR roof (blue line), where the temperature of the membrane remains constant, with that of a conventional roof (yellow line), where the temperature of the membrane fluctuates widely.

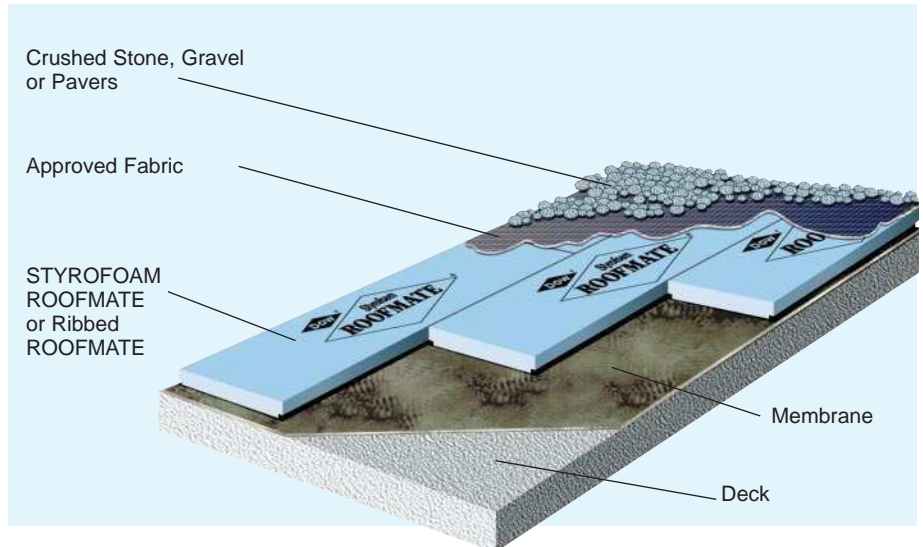

Features and Benefits:

Insulation is placed above the membrane - maintains the membrane at constant temperature, minimizing harmful effects of freeze/thaw cycling; protects against weathering and physical abuse during and after construction.

Closed cell structure - excellent moisture resistance and long term R-value.

Allows year round construction in any weather - roof is waterproofed first and insulated later.

High compressive strength - suitable for use under roof terraces, promenades and similar applications.

Over 20 years proven performance - thermal and water tightness warranties available from Dow or membrane manufactureres.

Insulation is still re-usable in most circumstances when the membrane needs to be replaced or for planned vertical expansion.

PLAZA DECK OR EXTENDED USE ROOF APPLICATIONS

Product: STYROFOAM PLAZAMATE* brand insulation.

Application: STYROFOAM brand insulation is installed directly on top of the waterproofing membrane. A levelling and drainage layer consisting of fabric with gravel or pedestals is installed above the insulation. Pavers, poured concrete or other exterior topping is then applied. Use when pedestrian or vehicular traffic is anticipated.

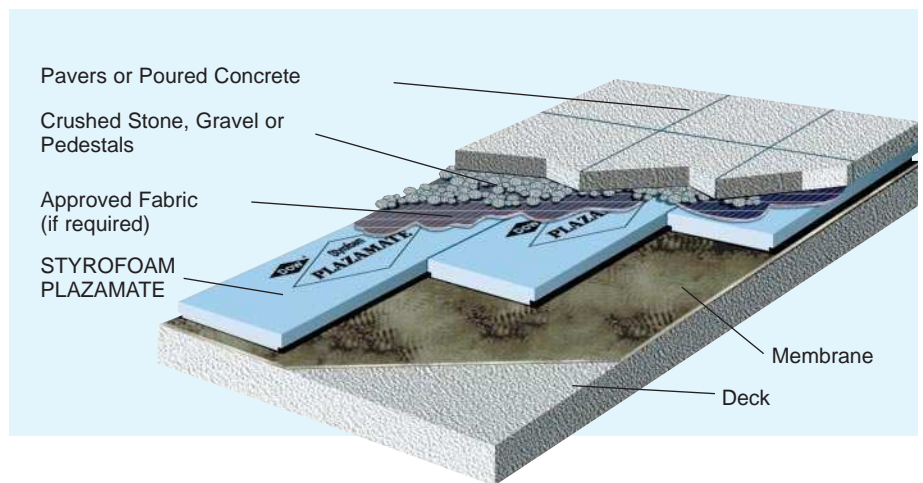

Features and Benefits:

Layered system of plaza deck construction - reduces installation, material and repair expenditures.

High moisture resistance - long term R-value.

High compressive strength - assures integrity of membrane and extended life of deck.

The system - protects membrane from abuse and damage.

Low Temperature and Geotechnical Insulation

LOW TEMPERATURE FLOOR APPLICATION

Product: STYROFOAM FREEZERMATE* brand insulation.

Application: Almost all large refrigerated warehouses, food processing plants, and freezer storage facilities use extruded polystyrene insulation under the floor. This is a demanding application where excellent moisture resistance, freeze-thaw stability, compressive strength, foundation modulus, and creep properties are required. STYROFOAM FREEZERMATE Brand insulation offers protection for concrete-wearing slabs from frost heave and fork lift truck damage, while keeping cooling costs down.

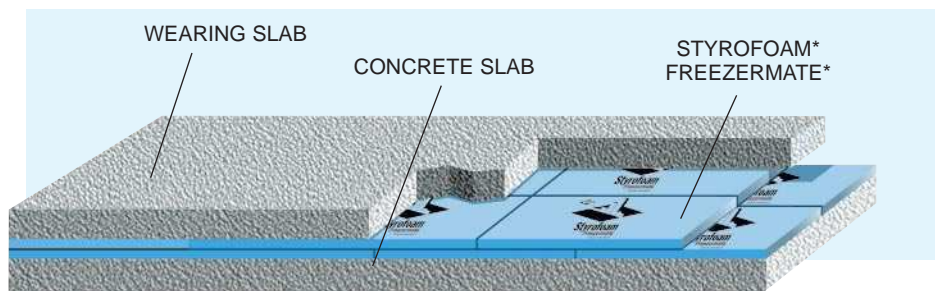

Features and Benefits:

Provides an enhanced compressive resistance of 30 pounds per square inch - suitable for most flooring applications where static and dynamic loadings are encountered.

Closed cell structure - resists the most severe forms of moisture penetration found in low temperature freezer and cooler construction.

High resistance to liquid water penetration and water vapor permeance - long term R-value retention.

LOW TEMPERATURE ROOFING INSULATION APPLICATION

Products: STYROFOAM DECKMATE and DECKMATE Plus brand insulation.

Application: STYROFOAM DECKMATE and DECKMATE Plus brand insulation are installed directly on the structural deck, including metal decking, eliminating the need for a labor intensive thermal barrier. This is followed by a sheet membrane and ballast. DECKMATE and DECKMATE Plus brand insulation continue to provide lasting performance even when the membrane fails to do so. Reusing DECKMATE and DECKMATE Plus saves building owners the cost of new insulation, as well as labor and disposal costs. DECKMATE and DECKMATE Plus brand insulation may be the only insulation the roof will ever need.

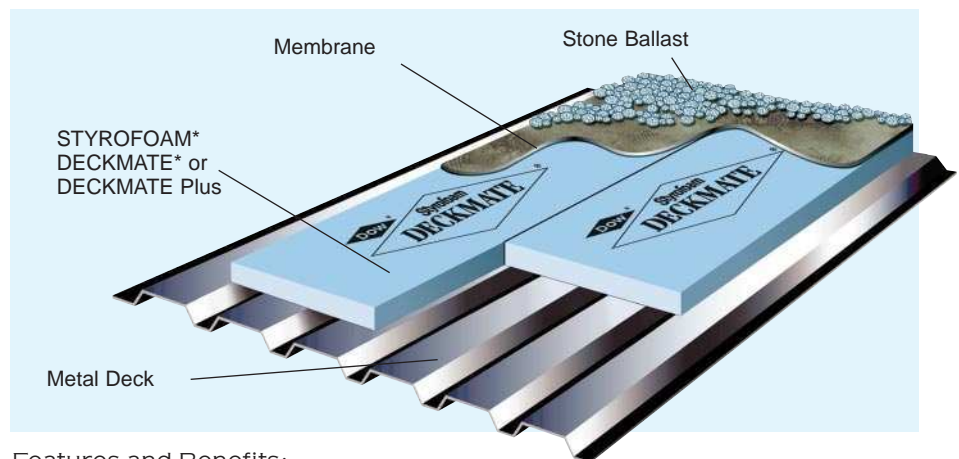

Features and Benefits:

High moisture resistance - long term R-value retention.

High compressive strength - excellent durability and resistance to damage. Withstands foot traffic and gravel buggies without crushing.

Can be reused - excellent economic value and return on investment.

Excellent handling characteristics - easy to cut and install or store.

Fifteen year limited thermal warranty - provides peace of mind and assurance of product performance.

GEOTECHNICAL APPLICATIONS

Products: STYROFOAM brand High Load 40, STYROFOAM brand High Load 60, and STYROFOAM brand High Load 100 insulations.

Application: The many applications of STYROFOAM brand High Load insulation include highways, airport runways, taxiways and aprons, railroads, culverts, retaining walls, building slabs, storage tank slabs, transmission line tower foundations, septic tanks, swimming pools, cooling tower basins and concrete spill containment structures.

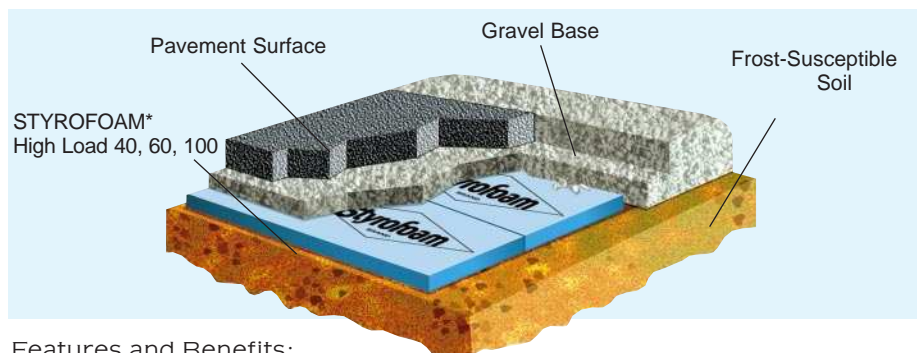

Features and Benefits:

Closed cell structure - one of the highest R-values when compared to other load bearing insulations.

Very low water absorption - virtually unaffected by moisture and freeze-thaw cycles, retaining its R-value over the long term.

High compressive strength - good durability, load bearing capability and resistance to damage.

Specifically developed for in-ground applications - will not crumble, waterlog, mold or decay.

PROPERTY (Units)	Thermal Resistance ^{1,2} Aged R-Value per Inch @ 75°F Mean Temp	Compressive Strength (lb/in ² /min. ³)	Flexural Strength (lb/in ² /min.)	Water Absorption (% by volume) Max.	Water Vapor Permeance (perm)	Dimensional Stability (% linear change) Max.	Coefficient of Linear Thermal Expansion (x10 ⁻⁶ in/in °F)	Complies with ASTM C 578, Type ⁶	Maximum Use Temperature (°F)	Flame Spread ⁸	Smoke Development	Width (in.)	Length (in.)	Thickness (in.)
ASTM METHOD	C518	D1621	C203	C272	E96	D2126				E84	E84			
CAVITYMATE	5.0	15	40	0.1	1.1	2.0	3.5	X	165	5	165	16	96	1, 1 1/2, 2
CAVITYMATE Plus	5.0	25	50	0.1	1.1	2.0	3.5	IV	165	5	165	16	96	1 1/2, 2
CAVITYMATE Ultra	5.6	25	50	0.1	1.1	2.0	3.5	IV	165	10	160	16	96	1 3/4, 2
DECKMATE	5.0	18	40	0.1	<1.0	2.0	3.5	X	165	5	165	24 48	96	2, 3 1, 1 1/2, 2, 2 1/2, 3
DECKMATE Plus	5.0	25	50	0.1	<1.0	2.0	3.5	IV	165	5	165	24 48	96	2, 3 1, 1 1/2, 2
FREEZERMATE	5.0	30	50	0.1	0.8	2.0	3.5	IV	165	5	165	24 48	96	2, 3 3
PERIMATE	7.0 ⁸	30	50	1.0	1.1	2.0	3.5	IV	165	5	165	24	96	1 1/2, 3 1/2, 4
PLAZAMATE	5.0	60	75	0.1	0.8	2.0	3.5	VII	165	5	165	24	96	1 1/2, 2, 3
RECOVERMATE	2.2 ¹¹	18	-	-	-	<0.5	3.5	-	200	5	165	48	96	1/2,
ROOFMATE	5.0	40	60	0.1	<1.0	2.0	3.5	VI	165	5	160	24	96	1, 1 1/2, 2, 2 1/2, 3, 3 1/2, 4
Ribbed ROOFMATE	5.0 ¹²	600 ¹³	-	0.1	0.8	2.0	3.5	VI	165	5	165	24	96	2
Z-MATE	5.0	15	40	0.1	1.1	2.0	3.5	X	165	5	165	23 1/2	96	1 1/2, 2
Dow Protection Board II	1.0 ⁷	10	-	0.1	0.8 ⁷	-	-	-	165	10	200	48	600	3/16
GRAYBOARD ⁹ Score Board	5.0	15	40	0.2	1.1	2.0	3.5	X	165	5	165	48	96	1, 1 1/2, 2
GRAYBOARD Square Edge	5.0	15	40	0.2	1.1	2.0	3.5	X	165	5	165	24	96	1, 1 1/2, 2
High Load 40	5.0	40	60	0.1	<1.0	2.0	3.5	VI	165	5	165	24 48	96	2, 3 2
High Load 60	5.0	60	75	0.1	0.8	2.0	3.5	VII	165	5	165	24	96	1, 2, 3
High Load 100	5.0	100	100	0.1	0.8	2.0	3.5	V	165	5	165	24	96	2
Panel Core	5.0	25	50	1.9 ¹⁰	1.0	2.0	3.5	IV	165	5	165	24.1 48.1	96	1 1/2, 3 1/2, 4 3/4, 1, 1 1/2, 2, 3
Score Board ⁹	5.0	25	50	0.1	1.1	2.0	3.5	IV	165	5	165	48	96	3/4, 1, 1 1/2, 2, 2 1/2, 3
Square Edge ⁹	5.0	25	50	0.1	1.1	2.0	3.5	IV	165	5	165	24 48	96	3/4, 1, 1 1/2, 2, 2 1/2, 3, 4 3/4, 1, 1 1/2, 2, 2 1/2, 3
Tongue & Groove	5.0	25	50	0.1	1.1	2.0	3.5	IV	165	5	165	24 48	96	3/4, 1, 1 1/2, 2 3/4, 1, 1 1/2, 2

- NOTES:**
1. Values are consistent with the criteria of ASTM C 578 and the requirements of the FTC R-value rule (16 CFR Part 460). The higher the R-value, the greater the insulating power. Ask your seller for the fact sheet on R-value. A fifteen year limited thermal warranty is available.
 2. R means resistance to heat flow. R-values are expressed in °F·ft²·h/BTU.
 3. Vertical compressive strength is measured at 10% deformation (5% for STYROFOAM PLAZAMATE and for STYROFOAM brand High Load 40, 60 and 100 products) or at yield, whichever occurs first. Since STYROFOAM brand insulations are visco-elastic materials, adequate design safety factors should be

4. used to prevent long term creep. for static loads, 3-1 is suggested. For dynamic loads, 5-1 is suggested.
4. Water vapor permeance varies with product type and thickness. Values are based on the desiccant method and they apply to insulation 1 inch in thickness. Thicker products have lower permeance.
5. Former Federal Specification HH-I-524C was cancelled in 1985 and replaced by ASTM Specification C 578.
6. This numerical flame spread rating is not intended to reflect hazards presented by this or any other material under actual fire conditions.
7. For 1/4" thickness.
8. For 1.5" thickness.

9. If using these products for z-furring applications, please contact your local Dow Sales Representative for exact Product sizes.
 10. Water absorption per ASTM D2842
 11. For 1/2" thickness
 12. R value is 10.0 for nominal 2" thickness and 15.0 for nominal 3" thickness
 13. Recommended load (psf) including 5:1 design factor
- Not all products are available in all parts of the country. Other product sizes are available on a made-to-order basis. Please contact your Dow sales representative with questions.

Dow has manufactured STYROFOAM* brand insulation for use in construction and specialty applications for nearly 50 years. Its dense closed-cell structure gives STYROFOAM superior moisture resistance, long-term thermal performance and compressive strength. STYROFOAM brand insulation is CFC-free and reusable.

Notice: STYROFOAM* brand insulation is combustible and should be protected from flame and other high heat sources. It should be installed with code-acceptable thermal barriers or used in approved alternative constructions. For more information, contact Dow (1-800-441-4DOW).

Notice: No freedom from any patent owned by Seller or others is to be inferred. Because use conditions and applicable laws may differ from one location to another and may change with time, Customer is responsible for determining whether products and the information in this document are appropriate for Customer's use and for ensuring that Customer's workplace and disposal practices are in compliance with applicable laws and other governmental enactments. Seller assumes no obligation or liability for the information in this document. NO WARRANTIES ARE GIVEN; ALL IMPLIED WARRANTIES OF MERCHANTABILITY OR FITNESS FOR A PARTICULAR PURPOSE ARE EXPRESSLY EXCLUDED.

For more information on STYROFOAM brand insulation, contact your local Dow representative or The Dow Chemical Company, Customer Information Group, P.O. Box 1206, Midland, MI 48674, or call 1-800-441-4369. Visit Dow on the World Wide Web at <http://www.dow.com>.



For Technical Information
1-800-441-4DOW (4369)

The Dow Chemical Company
Construction Materials Group
200 Larkin Center
Midland, Michigan
48674

Visit us at our website:
www.dow.com

For Sales Information
1-800-232-2436

