

RIGID FOAM INSULATION Concrete Sandwich Panel Applications

Concrete is a strong and highly durable material and a good choice in both commercial and multistory residential applications. However, concrete panel walls (precast, tilt-up or poured in place) can absorb moisture from rain and vapor drive. Condensation buildup can reduce the effectiveness of the insulation and may cause other problems, including mold and mildew.

In concrete sandwich wall construction, STYROFOAM™ Square Edge extruded polystyrene and ISOCAST™ R polyisocyanurate insulations combine superior insulating capabilities and dew point control with the additional strength of concrete. The closed-cell, rigid plastic foam insulations manufactured exclusively by The Dow Chemical Company provide dependable and predictable performance, even in severe moisture environments. Both are well-suited for use in concrete walls.

Concrete Wall Assemblies

To form concrete walls, concrete is poured on both sides of the foam and the finished panel is held together structurally with connectors.

Concrete panels provide thermal mass, which can store considerable amounts of thermal energy. Rigid foam insulation isolates the thermal mass provided by the concrete panels, minimizing building interior temperature fluctuations under outside temperature swings.

Concrete sandwich panel wall with STYROFOAM™ Square Edge or ISOCAST™ R insulation

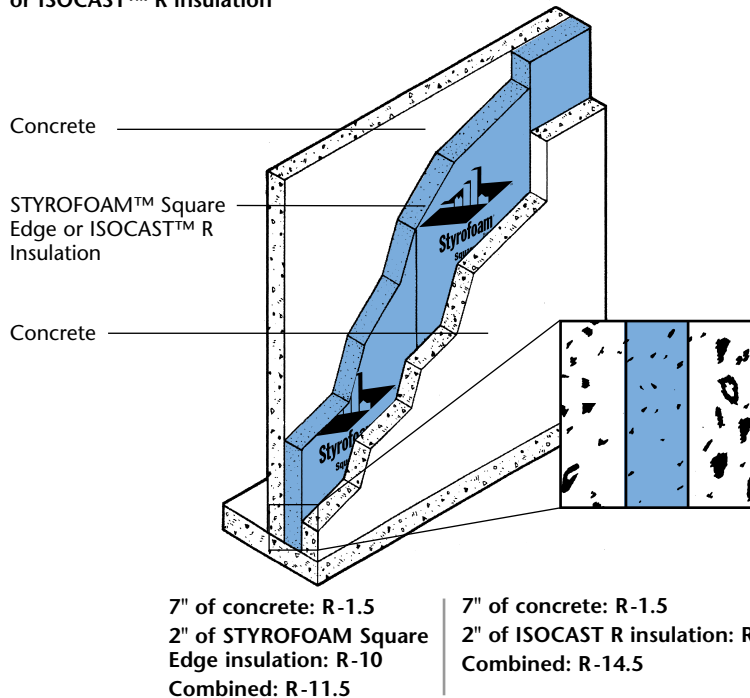

Figure 1

This reduces energy consumption in hot and cold climates. For example, a 7" thick slab of concrete has the same R-value* as a pane of glass (R-1.5). A 2" thick layer of STYROFOAM™ Square Edge insulation, R-10, increases the total thermal value of the concrete sandwich panel to R-11.5, almost eight times the value without it. A 2" thick layer of ISOCAST™ R polyisocyanurate insulation, R-13.0, increases the total thermal value of the concrete sandwich panel to R-14.5, 10 times the value without it. (See Figure 1.)

Buildings that incorporate concrete sandwich panels made with STYROFOAM Square Edge or ISOCAST R insulation

will perform more efficiently over time because of the insulations' superior long-term thermal performance and unparalleled moisture control qualities.

Why Rigid Foam Insulation From Dow?

Concrete wall manufacturers recognize the need for high-performance insulation in this application.

STYROFOAM™ Square Edge insulation is an ASTM C578 Type IV extruded polystyrene insulation with smooth, high-density skins that make it virtually moisture resistant.

roofs

walls

slabs

foundations

It has no facings that are susceptible to corrosion or delamination. Plus, STYROFOAM™ Square Edge insulation offers superior economical long-term thermal performance under the harsh conditions of freeze-thaw cycling, a common phenomenon exhibited in concrete panels in cold climates.

ISOCAST™ R insulation is an ASTM C1289 Type I polyisocyanurate insulation with a triplex aluminum/poly facer on

both sides that makes it virtually moisture resistant. It has no exposed metallic facings that are susceptible to corrosion or chemical reaction with the concrete, as the aluminum facer is completely covered by a polymer layer. Plus, ISOCAST R insulation offers superior economical thermal performance under the harsh vapor drive conditions often exhibited in concrete panels in cold climates.

Boards of both STYROFOAM Square Edge and ISOCAST R insulation are lightweight and easy to handle, cut and install.

Refer to Tables 1 and 2 for physical properties of STYROFOAM Square Edge and ISOCAST R insulations.

TABLE 1

Physical Properties of STYROFOAM™ Square Edge Extruded Polystyrene Insulation	
Property and Test Method	Value
Thermal Resistance, ASTM C518 ⁽¹⁾ , C177, Aged R-value per inch, ft ² •h•°F/Btu	
@ 75°F mean temp.	5.0
@ 40°F mean temp.	5.4
@ 25°F mean temp.	5.6
Compressive Strength ⁽²⁾ , ASTM D1621, psi, min.	25
Flexural Strength, ASTM C203, psi, min.	50
Water Absorption, ASTM C272, % by volume, max.	0.1
Water Vapor Permeance ⁽³⁾ , ASTM E96, perm., max.	1.1
Coefficient of Linear Thermal Expansion, ASTM D696, in/in•°F	3.5 x 10 ⁻⁵
Maximum Use Temperature, °F	165

- (1) Values are consistent with the criteria of ASTM C578 and the requirements of the FTC R-value rule (16 CFR Part 460).
- (2) Vertical compressive strength is measured at 10 percent deformation or at yield, whichever occurs first. Since STYROFOAM™ extruded polystyrene insulations are visco-elastic materials, adequate design safety factors should be used to prevent long-term creep and fatigue deformation.
- (3) Based on 1" thickness.

TABLE 2

Physical Properties of ISOCAST™ R Polyisocyanurate Insulation	
Property and Test Method	Value
Thermal Resistance, ASTM C518 ⁽¹⁾ , C177, Aged R-value per inch, ft ² •h•°F/Btu	
@ 75°F mean temp.	6.5
Compressive Strength ⁽²⁾ , ASTM D1621, psi, min.	25
Water Absorption, ASTM C209, % by volume, max.	0.05
Flexural Strength, ASTM C203, psi, min.	40
Water Vapor Permeance ⁽³⁾ , ASTM E96, perm., max.	<0.03
Dimensional Stability, 158°F, 97% RH, percent linear change, length, max.	1.0
Maximum Use Temperature, °F	190

- (1) In accordance with ASTM C518.
- (2) Vertical compressive strength is measured at 10 percent deformation or at yield, whichever occurs first.

IN THE U.S.:

- For Technical Information: **1-866-583-BLUE (2583)**
- For Sales Information: **1-800-232-2436**

THE DOW CHEMICAL COMPANY

• Building Solutions • 200 Larkin • Midland, MI 48674 • www.dowstyrofoam.com/architect

NOTICE: No freedom from any patent owned by Dow or others is to be inferred. Because use conditions and applicable laws may differ from one location to another and may change with time, Customer is responsible for determining whether products and the information in this document are appropriate for Customer's use and for ensuring that Customer's workplace and disposal practices are in compliance with applicable laws and other government enactments. Dow assumes no obligation or liability for the information in this document. NO WARRANTIES ARE GIVEN; ALL IMPLIED WARRANTIES OF MERCHANTABILITY OR FITNESS FOR A PARTICULAR PURPOSE ARE EXPRESSLY EXCLUDED.

COMBUSTIBLE: Protect from high heat sources. Local building codes may require a protective or thermal barrier. For more information, consult MSDS, call Dow at 1-866-583-BLUE (2583) or contact your local building inspector. In an emergency, call 1-989-636-4400.

Building and/or construction practices unrelated to building materials could greatly affect moisture and the potential for mold formation. No material supplier including Dow can give assurance that mold will not develop in any specific system.

a proud partner of

