

# PERLOK® 90 PARAPET WALL COPING



Standard Perlok® 90 utilizes a new metal chair which functions as both a gutter chair with its raised ribs and as an internal splice plate in the same color and finish as the coping cap.

Internal metal chair drainage system eliminates caulked joints.

True welded radius, matching corners, end caps, and other accessories, are factory fabricated.

Standard Perlok 90 with a 20- gauge galvanized steel cleat is Approved for up to an FM 1-90 Wind Storm Rating and has a 20-Year, 90 mph Warranty

Tested, certified, and approved to withstand the peeling effects of strong winds

Pre-punched holes and supplied fasteners for proper attachment and fast installation.

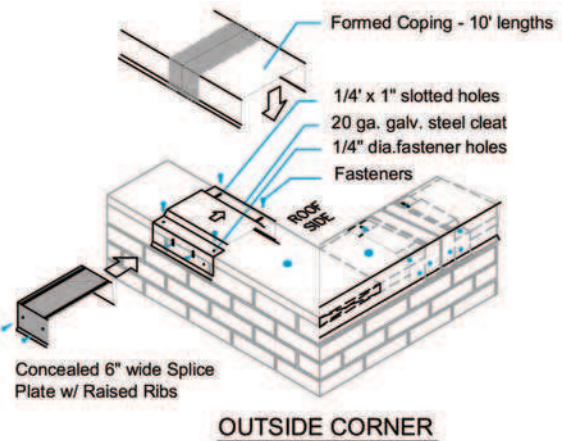
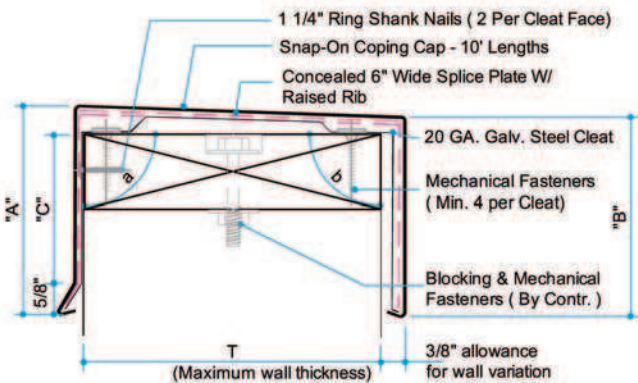

Standard Sizes	Material	Gauge	Finishes
Wall Sizes - 6" - 17"	Aluminum	Standard is .050" & .063"	Mill Finish
Standard Leg Size - 4" Minimum Leg Size - 2.125" Maximum Leg Size - 12"	Galvanized Steel	Standard is 24 Gauge	Manufacturer's Standard Kynar 500® Colors
Nominal Miter Leg Lengths 6" - 17" Wall - 24" Nominal 17" - 32" Wall - Wall Width + 6"	Copper & Stainless Steel By Request	Other Metal Thicknesses By Request	Custom or Exotic Kynar 500® Post-Finished Colors  Clear Anodize Bronze Anodize



PERFORMANCE Roof Systems, Inc.  
4800 Blue Parkway  
Kansas City, MO 64130  
Phone - 800.727.9872 - Fax 816.924.1542  
E-mail : info@derbigum.com - WWW.DERBIGUM.COM

## Perlok® 90 Coping

### SPECIFICATIONS *(short form)*

The coping cap shall be the Perlok® 90 coping system as provided by the Performance Roof Systems. The coping cap shall be formed as indicated with allowance for expansion and contraction. The standard support cleat shall be a 20 Ga. galvanized steel perforated cleat with pre-slotted fastener holes. A 6" wide concealed joint cover with raised ribs on the top surface to channel water shall be installed at coping joints. Installation shall conform to Manufacturer's written instructions.

### DESCRIPTION

#### *Application:*

The product is a metal coping with hold down cleats and metal drain chairs for capping most any parapet. Standard coping is formed from .063" (1.60 mm) or .050" (1.25 mm) aluminum; 24 Ga. Galv. Steel with Kynar 500® coating; custom metal by request. Standard length is 10' with standard corners having 24" nominal length. Cleats are 20 ga. galvanized steel. Chairs are metal in the same color and finish as the coping cap. Standard widths in 1" (25mm) increments for walls between 6" (152mm) and 32" (812mm) in width. See chart. Face and back leg are 4" (102mm) nominal length with tested approvals up to 6" (152mm). Custom sizes by request. Your Performance Roof Systems Representative will be happy to discuss your special design requirements.

### INSTALLATION PROCEDURES

**NOTE:** *This is a general outline only.*

*Please refer to our full installation guide for additional specific detail.*

#### **Preparation:**

The substrate should be flat and level from front to back. Shim areas not level.

#### **Procedure:**

The first cleat/chair set should be installed with the center line at nominal (see chart on front page) 24" (300mm) from the outside wall of an outside corner, 24" (300mm) from the inside wall of an inside corner and 24" (300mm) from the end of a wall. Install cleats/chairs sets at all corners and ends first, then work along the wall to the center locating sets every five feet on

center. Most walls are not equally divided by five feet. Therefore, at the middle of a run, adjust the location to fit a short coping length. This procedure will provide a symmetrical appearance of the installed coping. Install metal gutter chair/concealed joint covers at joint locations. Hook coping face leg over the cleat face (front) leg and swing over the top. Snap the roof side (back) leg by pressing firmly down on the back edge directly over the cleat chair sets. Allow 1/8" (3mm) gap, 1/4" (6mm) in colder weather, at each joint.

### FINISHES

- Natural mill aluminum
- Pre-coat Kynar 500® — from the manufacturer's standard color chart
- Post-coat Kynar 500® — industry standard two coat colors
- Non-standard Kynar 500® — colors requiring multiple coatings or protective clear coats
- Anodized aluminum – clear, bronze and black

### GUARANTEE

#### **A. Manufacturer's Standard**

**Warranty:** Materials shall be free of defects in material and workmanship for five years after shipment. If, after inspection, the manufacturer agrees that the materials supplied by them are defective, the manufacturer shall at their option repair or replace them.

**B. Special Performance/20-Year Warranty:** Manufacturer shall guarantee that a standard size roof edge system, when installed per manufacturer's instructions, will not blow off, leak, or cause membrane failure, even in wind conditions up to 90 mph, or the manufacturer shall at their option repair or replace their materials.

**C. Decorative Finish Warranty** (*consult manufacturer*).

### QUALITY ASSURANCE

Perlok® 90 coping is listed in the current Factory Mutual Research Corporation Approval Guide approved for Windstorm ratings up to FM 1-90 depending upon wall width, cleat spacing, cleat gauge and

gauge of cap. Consult FMRC Approval Guide or Performance Roof Systems for other conditions. High performance coping system shall be certified by the coping manufacturer to meet ANSI/SPRI ES-1 Test Method RE-3 for coping. The Perlok® 90 coping system has been tested simultaneously on the horizontal and vertical surfaces and has exceeded design wind pressure as calculated in accordance with the current edition of ANSI/SPRI ES-1 "Wind Design Standard for Edge Systems used with Low Slope Roofing Systems".

### TECHNICAL SERVICES

Engineering and shop drawings are available from the factory. Product samples, detail sheets, color chips and color charts are ready for your submittal package. For personal assistance with questions or submittals, contact your local representative or call Performance Roof Systems.

## Performance Roof Systems

4800 Blue Parkway, Kansas City, MO 64130 • Phone (800) 727-9872 • Fax (816) 924-1542 • [www.derbigum.com](http://www.derbigum.com)

# PERLOK® 90 FASCIA



*Free floating fascia system does not stress roofing.*

*Locks roofing securely; no leaks or maintenance.*

*Factory Mutual FM I-225 wind rating.*

*Tested, Certified, & Guaranteed for wind speeds up to 90 mph for 20-Year s.*

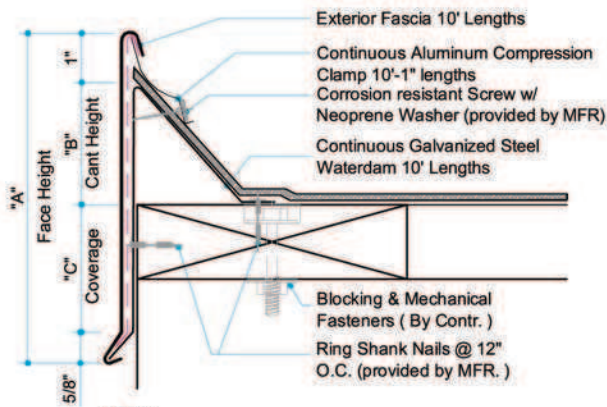

- Notes:
1. Extruded Fascia is available in a slightly different profile.
  2. Coordinate installation with Membrane manufacturer.

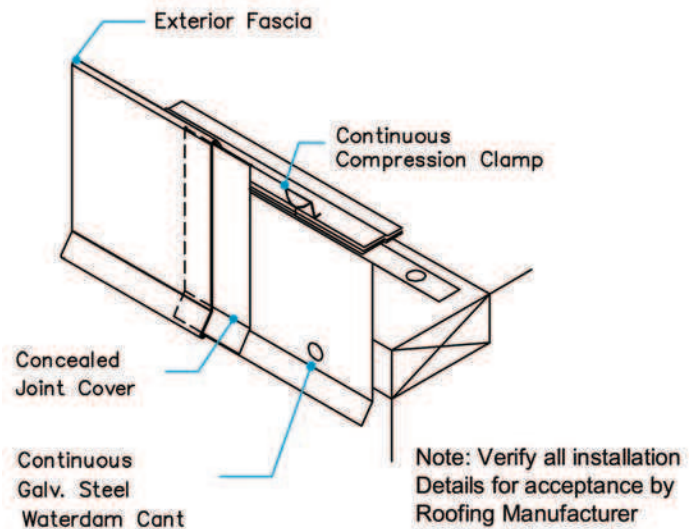

FASCIA MODEL	FACE HEIGHT (INCES)	MINIMUM FASCIA GAUGE	COVERAGE (INCHES)	WATER DAM GAUGE B&S
F-625	6.25"	.050"	2-3/16"	24
F-775	7.75"	.050"	3-13/16"	22
F-925	9.25"	.050"	5-1/16"	20
F-1075	10.75"	.050"	6-9/16"	20
EXTRUDED ALUMINUM FASCIA MODELS				
FX-625	6.25"	.080"	2-13/16"	22
FX-800	8.0"	.090"	3-7/8"	22
FX-1000	10.0"	.125"	5-7/8"	20



PERFORMANCE Roof Systems, Inc.  
 4800 Blue Parkway  
 Kansas City, MO 64130  
 Phone - 800.727.9872 - Fax 816.924.1542  
 E-mail : info@derbigum.com - WWW.DERBIGUM.COM

## PERLOK® 90 GRAVELSTOP SYSTEM

### SPECIFICATIONS *(short form)*

The gravel stop for Modified Bitumen roofing material shall be Perlok® 90 as provided by the Performance Roof Systems. The fascia shall be extruded aluminum or formed metal fascia with continuous galvanized steel water dam, aluminum compression clamp complete with stainless steel fasteners and conical neoprene washers. Fascia and water dam will be in 10' lengths.

### DESCRIPTION

Perlok® 90 is a three-part assembly designed for modified bitumen roofs. The system consists of a continuous galvanized steel water dam, exterior fascia and continuous compression clamp with fasteners. Standard Perlok® is formed from .063" (1.60 mm) or .050" (1.25 mm) aluminum and 24 ga. Kynar 500® coated galvanized steel. Extruded aluminum fascia is available in some standard sizes and in thicknesses that vary with size. *(See size chart.)*

### INSTALLATION PROCEDURES

**Note:** *This is a general outline only. Please refer to our full installation guide for additional specific detail.*

#### Preparation:

The roof edge must be level and wood nailers must be straight. Place corner supports at all corner locations and nail flange to deck. Locate and install leveling clips so they are at all corner locations and nail flange to deck. Locate and install leveling clips so they are at the end of each water dam section. Align angle clip with face flush to the roof edge face. Set water dam over corner support and leveling angle clip and secure. Using a minimum 1½" galvanized roofing nail, attach the water dam to the nailer at 12" on center on the roof side and 12" on center on the face side. At the joints, lap the water dam ½". Do not fasten through the lap. Mop the plies

up and over the water dam, allowing the plies to overhang top of water dam by about 2". Trim overhanging plies flush with the face of the water dam. Engage lower drip edge of the exterior fascia over the drip edge of the water dam and bring up flush with face of cant. Install concealed splice plates at joints between fascia sections and leave 1/8" gap (1/4" in cold weather) for expansion. Place compression clamp into the return edge of fascia and lap ½" at ends. Pull fascia up tight on the water dam and push compression clamp fully up into top of fascia. Install the supplied corrosion resistant screws with conical neoprene washers using the pre-punched holes in the compression clamp as a guide. Coordinate with membrane manufacturer before starting installation.

### FINISHES

- Natural mill aluminum
- Pre-coat Kynar 500® — from the manufacturer's standard color chart
- Post-coat Kynar 500® — industry standard two coat colors
- Non-standard Kynar 500® — colors requiring multiple coatings or protective clear coats
- Anodized aluminum – clear, bronze and black

### GUARANTEE

A. Manufacturer's Standard Warranty: Warranted materials shall be free of defects in material and workmanship for five years after shipment. If, after inspection, the manufacturer agrees that materials are defective, the manufacturer shall at their option repair or replace them. For decorative finish warranty, consult manufacturer.

B. Special 20-Year Warranty: Manufacturer shall guarantee that a standard size roof edge system,

when installed per manufacturer's instructions, will not blow off, leak, or cause membrane failure, even in wind conditions up to 90 mph, or the manufacturer shall replace or repair its materials.

### D. Decorative Finish Warranty *(consult manufacturer).*

### QUALITY ASSURANCE

The fascia product shall be listed in the current Factory Mutual Research Corporation Approval Guide approved for FM 1-225. SPRI Test Method RE-2 Pull-Off test for fascia. Fascia shall be certified to design pressures as indicated in current edition of Wind Resistance Standard for Edge Systems Used with Low Slope Roofing Systems.

### TECHNICAL SERVICES

Engineering and shop drawings are available from the factory. Product samples, detail sheets, color chips and color charts are ready for your submittal package. For personal assistance with questions or submittals, contact your local representative or call Performance Roof Systems.

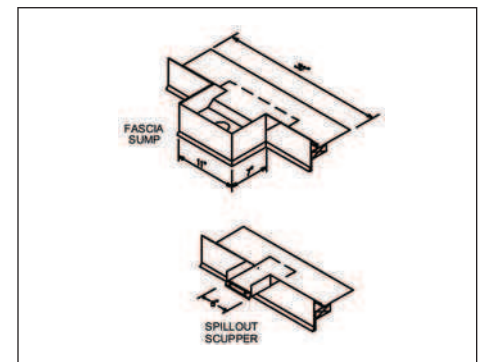

## Performance Roof Systems

4800 Blue Parkway, Kansas City, MO 64130 • Phone (800) 727-9872 • Fax (816) 924-1542 • www.derbigum.com