



Special Application Curbs

Technical Product Information

Burglar Bar Style

P.O. NUMBER _____

CUSTOMER _____

PROJECT _____

LOCATION _____

ARCHITECT _____

STANDARD CONSTRUCTION

- 18 GAUGE GALVANIZED STEEL
- 1-1/2", 3LB. DENSITY FIBERGLASS INSULATION
- WOOD NAILER
 - "A" STYLE FLUSH
 - "B" STYLE _____ OVERHANG
- UNITIZED CONSTRUCTION
- RAISED BUILT-IN CANT WITH MITERED CORNERS
- CONTINUOUS WELDED CORNER SEAMS
- AVAILABLE WITH ANY RPS CURB STYLE

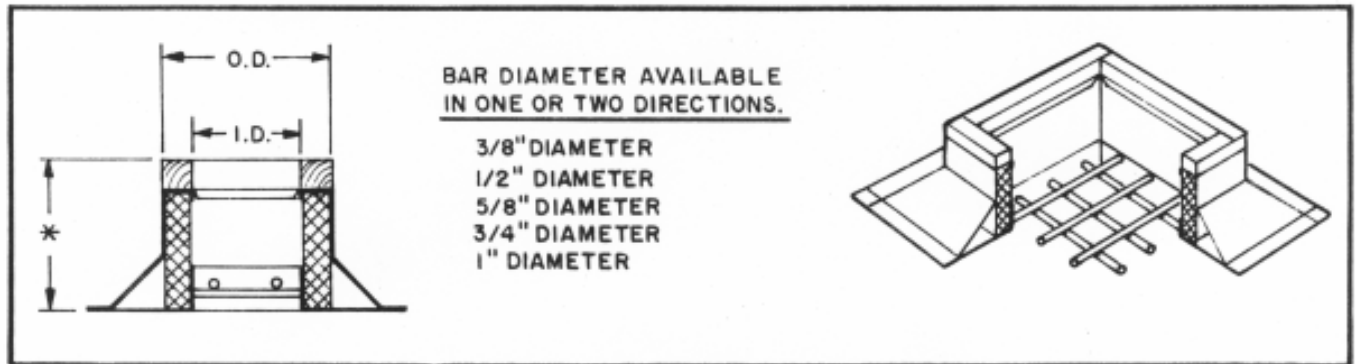

ALSO AVAILABLE
RC- 2B, 3B, 4B,
5A&B, 6A&B,
7, 8, and 9

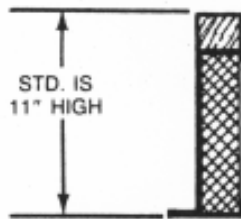

RCB-2A STYLE

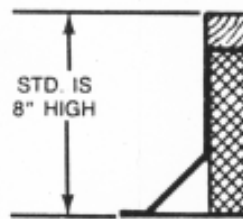

RCB-3A STYLE

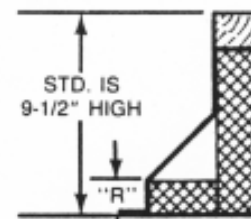

RCB-4A STYLE

PROJECT REQUIREMENTS

QTY.	STYLE	ACTUAL DIMENSIONS		* OVERALL HEIGHT	"B" STYLE NAILER OVERHANG	"R" DIM.	BAR DIAM.	BAR DIRECTION		TAG
		O.D.	I.D.					ONE WAY O.C.	BOTH WAY O.C.	