

CertainTeed

# Sustainable Products and Systems

A Reference for Building Responsibly.

Life Cycle Thinking

Building Science

Resource Efficiency

Beauty and Performance

Vol. 7

**CertainTeed**  
SAINT-GOBAIN



## Building responsibly. We all have a part.

Buildings and all that go into them—from the raw materials, to the design of the structure, to the life cycle of every component—have an enormous impact on the well-being of people and the environment.

As the manufacturer of a complete portfolio of building materials, we share a responsibility to help you make a sustainable difference in as many ways as possible. The following is your guide to CertainTeed systems and products that deliver the beauty, comfort, performance and sustainable advantages you're looking for.



## pgs 6-19

### SYSTEMS

- LEED for New Construction
- LEED for Schools
- LEED for Healthcare
- LEED for Homes Advanced Design
- LEED for Homes Standard Design
- NAHB Advanced Design
- NAHB Standard Design

## pgs 20-25

### INTERIOR PRODUCTS

- Ceilings
- Gypsum
- Insulation

## pgs 26-35

### EXTERIOR PRODUCTS

- Fence, Railing and Decking
- Fiber Cement Siding, Soffit and Trim
- Foundations
- Polymer Shakes and Shingles, Vinyl Siding and Trim
- Roofing

## pgs 36-47

### GLOSSARY OF TERMS

CertainTeed and our parent company, Saint-Gobain, commit to continually improve the sustainability of our products. A sustainable product can incorporate many different attributes, including: recycled content, bio-based materials, organic plants, rapidly renewable materials, sustainably harvested wood, regional or local materials, little or no Volatile Organic Compound (VOC) emissions and energy efficiency. As part of CertainTeed's pledge to product stewardship our sustainable product development program is evidence of our continual commitment to sustainability.

Sustainable Product Development (SPD) starts at the research and development phase of a product. Sustainable attributes of a product are considered throughout the entire design process and life cycle of a new product. The sustainability of the product's supply chain is evaluated, raw materials are sourced from recycled or renewable materials and closed loop design is considered. For some products, a life cycle assessment (LCA) is performed to fully understand and minimize the impacts of the product. During the SPD process, energy, water, waste and transportation are evaluated to reduce any potential impacts during production and manufacturing. The feasibility of a take-back, or recycling program for a product's end-of-life is also examined. All of these steps are integrated into CertainTeed's sustainable product development process, making CertainTeed the preferred choice for innovative and sustainable building products.



Following a two-year run as an ENERGY STAR® Partner of the Year, CertainTeed, through its parent company Saint-Gobain, received the 2011 ENERGY STAR Sustained Excellence Award, the highest level of recognition from the U.S. Environmental Protection Agency. The Sustained Excellence Award recognizes consistent efforts to use energy efficiently in facility operations and to integrate superior energy management into overall organizational strategy. CertainTeed is the first and only fiber glass insulation manufacturer whose contributions have been recognized through the program.



The National Association of Home Builders (NAHB) collaborated with the International Code Council (ICC) to develop an ANSI standard for green building practices. This standard, known as the National Green Building Standard (NGBS), provides a system for certifying homes as green buildings, awarding points to homes based on the design and material choices made in constructing the home. The NAHB credits listed in this brochure are based on the final version of the standard, approved by ANSI in early 2008. CertainTeed offers many products that will achieve points toward NAHB's NGBS certification. In addition, many of these products have received the NAHB Research Center Green Approved third-party endorsement, evidence that they meet specific green criteria that facilitate achievement of NGBS credits. Through the program, guaranteed points are awarded based on a variety of factors that contribute to the sustainability of a product, including recycled content, ISO 14001 environmental management system certification and the use of durable, termite-resistant materials. More products from CertainTeed have received the Green Approved certification from the NAHB than from any other manufacturer.



The LEED® rating system was developed by the U.S. Green Building Council to provide a national benchmark for the design, construction and operation of high-performance sustainable buildings. In order for a building to become LEED certified, it must meet certain prerequisites and achieve specified performance levels to qualify for rating system points. CertainTeed is a member of the U.S. Green Building Council and supports the LEED program.



The Canada Green Building Council (CaGBC) was established in December 2002 to promote and accelerate the design and construction of high-performance buildings. In addition to promoting green building principles and benefits, the Council holds the license for LEED in Canada. CertainTeed has been a proud corporate member since 2007.

This brochure details CertainTeed products that can help achieve LEED credits under LEED for Homes (LEED-H); LEED for Canada: Homes; LEED for New Construction (LEED-NC); LEED for Canada: New Construction; LEED for Core & Shell (LEED-CS); LEED for Commercial Interiors (LEED-CI); LEED for Schools (LEED-SCH); and LEED for Retail.



### YouthBuild® Project Philadelphia, PA

The YouthBuild Project is part of a three-year, national partnership between Saint-Gobain, CertainTeed and YouthBuild USA. The partnership gives support to the organization's "Green Initiative," which provides YouthBuild students with the opportunity to build sustainable, energy-efficient and healthy homes in their neighborhoods, gain green-collar job skills, industry-recognized credentials, and develop environmentally focused leadership skills. The project will be seeking LEED certification from the U.S. Green Building Council, and will consist of the renovation of 4620 Greene Street, a dilapidated building vacant for nearly 20 years. The project is being undertaken in collaboration with YouthBuild Philadelphia Charter School, Philadelphia Neighborhood Housing Services, Saint-Gobain and CertainTeed.



### Saint-Gobain R&D Center Northboro, MA LEED® Gold

The largest facility in Saint-Gobain's network of research centers throughout the world, the 60,000-square-foot state-of-the-art building specializes in the groundbreaking research of high-performance materials, such as plastics, ceramics and abrasives, as well as renewable energy and technologies to promote energy efficiency in buildings. Saint-Gobain and CertainTeed utilized 13 key sustainable products from both companies to achieve certification for the facility's recent expansion, including Flintlastic® FR Cap with CoolStar™ roofing; CertaPro™ AcoustaTherm insulation and Commercial Insulation Board; GlasRoc® sheathing and shaftliner; ProRoc® gypsum board; ceiling panels and metal grid ceiling suspension systems; and Restoration Millwork® trimboard.



### Whistler Vision Net Zero House Whistler, British Columbia LEED® Platinum

The first of its kind in British Columbia, the Whistler Vision Net Zero House is taking the lead in renewable energy, consuming less energy than it is able to produce. The 2,200-square-foot home features not a variety of CertainTeeds WeatherBoards™ fiber cement siding profiles, and the company's ProRoc M2Tech® gypsum board and setting compound, ProRoc Type C fire-rated gypsum board and ProRoc joint tape and compound. These products helped contribute to the home's LEED Platinum certification.

# Green Building Products

## At-A-Glance

	Percent Recycled Content	Does Not Emit Harmful Chemicals	Third-party Certifications	Manufacturing Plant ISO 14001 Certified (+) or has an Environmental Management System (♻️)	Contributes to Energy Efficiency <sup>2</sup> (♻️) or is ENERGY STAR Certified (C) or an ENERGY STAR Partner (P)	Reduces Carbon Footprint <sup>3</sup>	Green Approved Products for NAHB National Green Building Standard Credits	Contributes to Achieving LEED®-H, LEED® for Canada: Homes Credits	Contributes to Achieving LEED®-NC, -CS, Schools, Retail, or LEED for Canada: NC Credits	Contributes to Achieving LEED®-CI Credits	Contributes to Achieving LEED® for Healthcare Credits
Form-A-Drain®	92%	♻️		♻️		♻️	♻️	♻️	♻️		♻️
ThermaEZE™		♻️			P	♻️		♻️	♻️		♻️
Platon®	92%	♻️		♻️			♻️	♻️	♻️		♻️
T-ROC™		♻️			♻️	♻️		♻️	♻️		♻️
WeatherBoards™ Fiber Cement Siding, Soffit and Trim	38%	♻️	GreenCircle™ <sup>5</sup>	♻️			♻️	♻️	♻️		♻️
Cedar Impressions® Polymer Shakes and Shingles, CedarBoards™ Insulated Siding, Vinyl Siding and Trim	53% <sup>5</sup>	♻️	GreenCircle™ <sup>4,5</sup>	+	♻️ <sup>5</sup>	♻️ <sup>5</sup>	♻️	♻️ <sup>5</sup>	♻️		♻️
Restoration Millwork®		♻️					♻️	♻️	♻️		♻️
Insulation—Batts and Blowing Wool	22-74%	♻️	GreenCircle™ <sup>5</sup> GREENGUARD	+	P	♻️	♻️	♻️	♻️	♻️	♻️
CertaSpray™ Spray Foam Insulation		♻️			♻️	♻️		♻️	♻️	♻️	♻️
Insulation—HVAC	22-74%	♻️	GreenCircle™ <sup>5</sup> GREENGUARD	+	P	♻️	♻️	♻️	♻️	♻️	♻️
Gypsum—ProRoc®, GlasRoc® and ProRoc® M2Tech®	5-99% <sup>1</sup>	♻️	GREENGUARD, EcoLogo™ <sup>7</sup> UL Environment	+			♻️	♻️ <sup>1</sup>	♻️	♻️	♻️
Roofing—Residential	1-89%	♻️			♻️	♻️	♻️	♻️	♻️	♻️	♻️
Roofing—Low Slope	1-28%	♻️			C	♻️	♻️	♻️	♻️	♻️	♻️
Ceilings	7-75%	♻️	GreenCircle™ <sup>5</sup> , FSC <sup>6</sup>		♻️	♻️		♻️	♻️	♻️	♻️
Fence	10-20%	♻️	GreenCircle™ <sup>5</sup>	♻️					♻️		♻️
Decking	5-74%	♻️		♻️			♻️		♻️		♻️
Panorama® Railing	90%	♻️	GreenCircle™ <sup>5</sup>	♻️			♻️	♻️	♻️		♻️

1 Depends on plant: Products made at Toronto, ON; Moundsville, WV; and Carrollton, KY, plants contain enough recycled content to qualify as EPP for LEED-H.

2 Contributes to Energy Efficiency – This product reduces the energy consumption of the building in which it is installed by reducing the energy needed to light, heat, and/or cool the building.

3 Reduces Carbon Footprint – This product reduces the carbon emissions related to the building in which it is installed either because less fossil fuel was used in its production or installation than comparable materials, or because the product reduces the energy used in the operation of the building (i.e., heating, cooling, lighting, etc.).

4 CedarBoards™ D6 only.

5 GreenCircle™ certification provides third party verification and assurance to builders, regulators and consumers that products labeled with the GreenCircle mark have undergone a rigorous audit process that verifies compliance with the environmental and sustainability claims of the manufacturers.

6 Forest Stewardship Council (FSC) – Decoustics Quadrillo®, Solo™ and Solo M™ ceiling panels only.

7 Toronto, ON; and Vancouver, BC plants.

# LEED for New Construction (NC) and LEED for Canada: NC

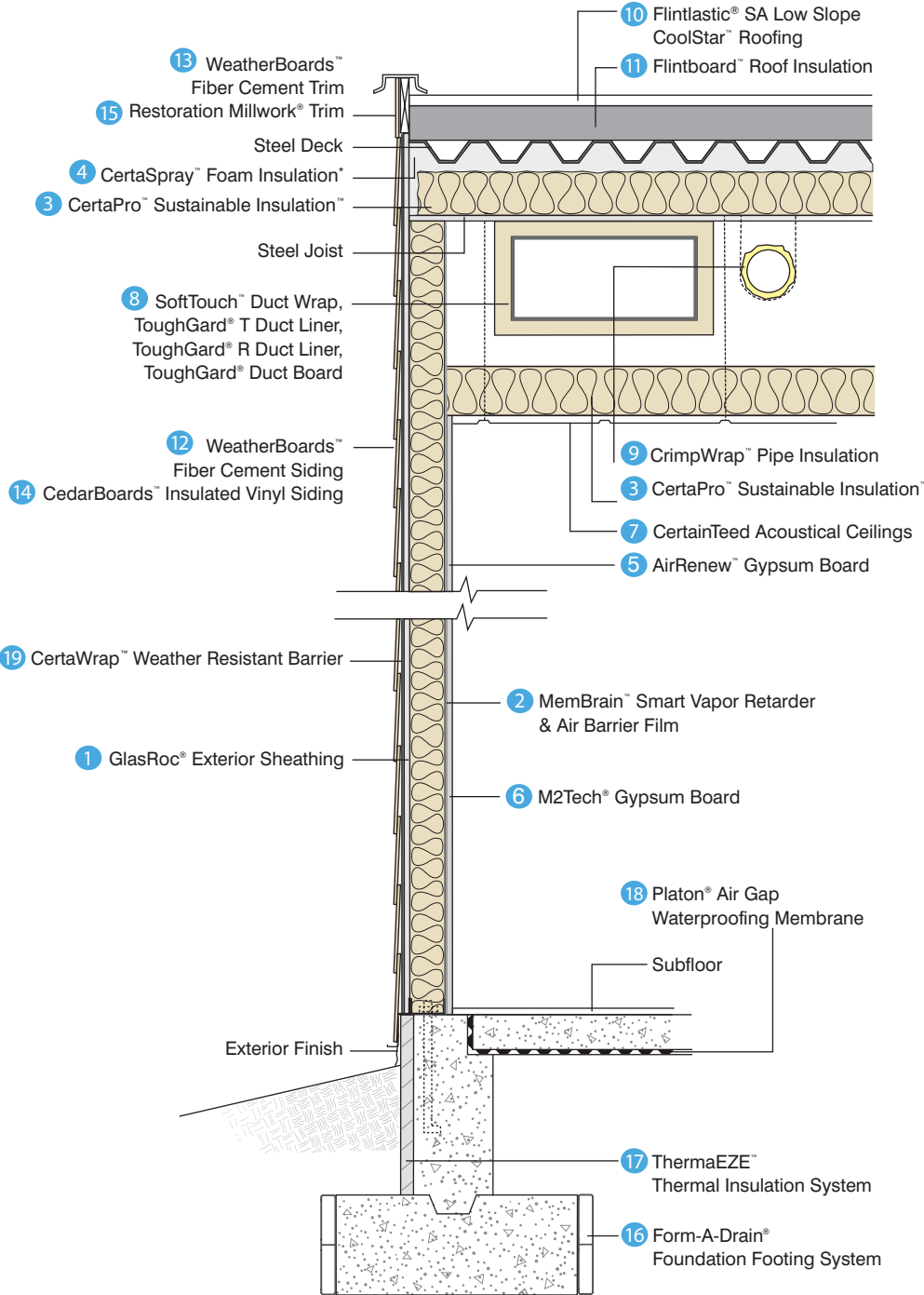

\*Apply thermal or ignition barrier. Check local code.

# CertainTeed Product Contributions to LEED for NC and LEED for Canada: NC Credits

LEED 2009

PRODUCT	CREDITS	POINTS
1. GlasRoc® Exterior Sheathing	MR 5. Regional Materials	1-2
2. MemBrain™ Smart Vapor Retarder & Air Barrier Film	EA Prerequisite 2. Minimum Energy Performance EA 1. Optimize Energy Performance	Required 1-19
3. CertaPro™ Sustainable Insulation™	MR 4. Recycled Content ( <i>excludes CertaSpray</i> )	1-2
4. CertaSpray™ Foam Insulation	MR 5. Regional Materials IEQ 7.1. Thermal Comfort	1-2 1
5. AirRenew™ Gypsum Board	MR 4. Recycled Content MR 5. Regional Materials	1-2 1-2
6. M2Tech® Gypsum Board	MR 2. Construction Waste Management MR 4. Recycled Content MR 5. Regional Materials	1-2 1-2 1-2
7. CertainTeed Acoustical Ceilings	EA 1. Optimize Energy Performance MR 2. Construction Waste Management MR 4. Recycled Content MR 6. Rapidly Renewable Materials IEQ 8.1. Daylight and Views—Daylight	1-19 1-2 1-2 1 1
8. SoftTouch™ Duct Wrap, ToughGard® T Duct Liner, ToughGard® R Duct Liner, ToughGard® Duct Board	EA Prerequisite 2. Minimum Energy Performance EA 1. Optimize Energy Performance MR 4. Recycled Content MR 5. Regional Materials IEQ 7.1. Thermal Comfort	Required 1-19 1-2 1-2 1
9. CrimpWrap™ Pipe Insulation	EA Prerequisite 2. Minimum Energy Performance EA 1. Optimize Energy Performance IEQ 7.1 Thermal Comfort	Required 1-19 1
10. Flintlastic® SA Low Slope CoolStar™ Roofing	SS 7.2 Heat Island Effect—Roof EA Prerequisite 2. Minimum Energy Performance EA 1. Optimize Energy Performance MR 2. Construction Waste Management MR 5. Regional Materials IEQ 7.1. Thermal Comfort	1 Required 1-19 1-2 1-2 1

PRODUCT	CREDITS	POINTS
11. FlintBoard™ Roof Insulation	EA Prerequisite 2. Minimum Energy Performance EA 1. Optimize Energy Performance MR 4. Recycled Content MR 5. Regional Materials IEQ 7.1. Thermal Comfort	Required 1-19 1-2 1-2 1
12. WeatherBoards™ Fiber Cement Siding	MR 4. Recycled Content MR 5. Regional Materials	1-2 1-2
13. WeatherBoards™ Fiber Cement Trim and Soffit	MR 4. Recycled Content MR 5. Regional Materials	1-2 1-2
14. CedarBoards™ Insulated Vinyl Siding	EA Prerequisite 2. Minimum Energy Performance EA 1. Optimize Energy Performance MR 4. Recycled Content	Required 1-19 1-2
15. Restoration Millwork® Trim	MR 5. Regional Materials	1-2
16. Form-A-Drain® Foundation Footing System	MR 4. Recycled Content	1-2
17. ThermaEZE™ Thermal Insulation System	EA Prerequisite 2. Minimum Energy Performance EA 1. Optimize Energy Performance IEQ 7.1. Thermal Comfort	Required 1-19 1
18. Platon® Air Gap Waterproofing Membrane	MR 4. Recycled Content	1-2
19. CertaWrap™ Weather Resistant Barrier	EA Prerequisite 2. Minimum Energy Performance EA 1. Optimize Energy Performance	Required 1-19

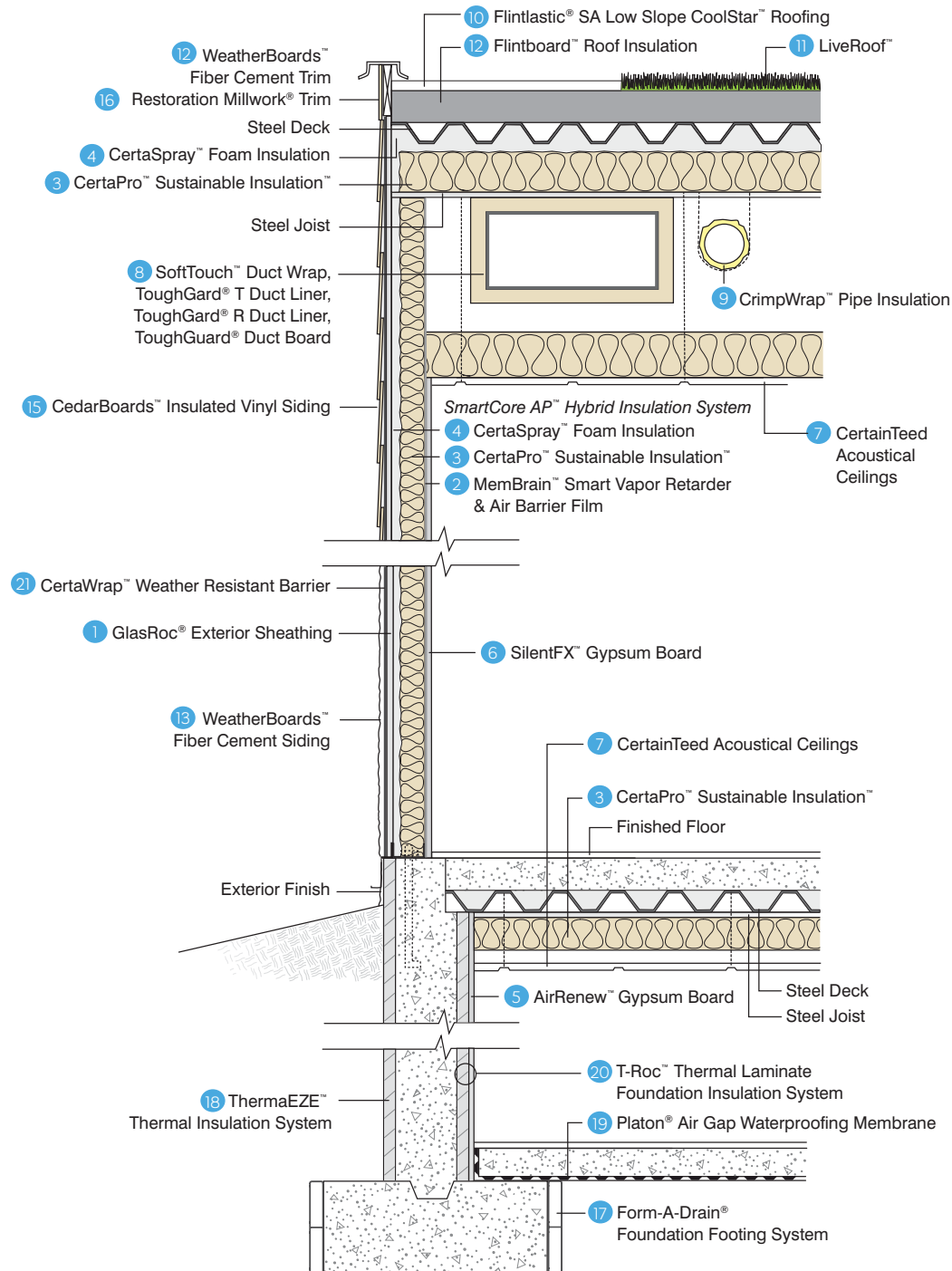

Check out  
[certainteed.com](https://certainteed.com)

for an in-depth look at Certainteed and Saint-Gobain products that support evidence-based design principles in educational facilities.

\*Apply thermal or ignition barrier. Check local code.



# CertainTeed Product Contributions to LEED-SCH Credits

LEED 2009

PRODUCT	CREDITS	POINTS
1. GlasRoc® Exterior Sheathing	MR 5. Regional Materials	1-2
<i>SmartCore AP™ Hybrid Insulation System</i>		
2. MemBrain™ Smart Vapor Retarder & Air Barrier Film	EA Prerequisite 2. Minimum Energy Performance EA 1. Optimize Energy Performance	Required 1-19
3. CertaPro™ Sustainable Insulation™	MR 4. Recycled Content ( <i>excludes CertaSpray</i> )	1-2
4. CertaSpray™ Foam Insulation	MR 5. Regional Materials IEQ Prerequisite 3. Minimum Acoustical Performance IEQ 7.1. Thermal Comfort IEQ 9. Enhanced Acoustical Performance	1-2 Required 1 1
5. AirRenew™ Gypsum Board	MR 4. Recycled Content MR 5. Regional Materials	1-2 1-2
6. SilentFX™ Gypsum Board	MR 4. Recycled Content MR 5. Regional Materials IEQ Prerequisite 3. Minimum Acoustical Performance IEQ 9. Enhanced Acoustical Performance	1-2 1-2 Required 1
7. CertainTeed Acoustical Ceilings	EA 1. Optimize Energy Performance MR 2. Construction Waste Management MR 4. Recycled Content MR 5. Regional Materials MR 6. Rapidly Renewable Materials IEQ Prerequisite 3. Minimum Acoustical Performance IEQ 4.6. Low-Emitting Materials—Daylight IEQ 8.1. Daylight and Views—Daylight IEQ 9. Enhanced Acoustical Performance	1-19 1-2 1-2 1-2 1 Required 1 1 1
8. SoftTouch™ Duct Wrap, ToughGard® T Duct Liner, ToughGard® R Duct Liner, ToughGard® Duct Board	EA Prerequisite 2. Minimum Energy Performance EA 1. Optimize Energy Performance MR 4. Recycled Content MR 5. Regional Materials IEQ Prerequisite 3. Minimum Acoustical Performance IEQ 7.1. Thermal Comfort IEQ 9. Enhanced Acoustical Performance	Required 1-19 1-2 1-2 Required 1 1
9. CrimpWrap™ Pipe Insulation	EA Prerequisite 2. Minimum Energy Performance EA 1. Optimize Energy Performance IEQ 7.1. Thermal Comfort	Required 1-19 1

PRODUCT	CREDITS	POINTS
10. Flintlastic® SA Low Slope CoolStar™ Roofing	SS 7.2. Heat Island Effect—Roof EA Prerequisite 2. Minimum Energy Performance EA 1. Optimize Energy Performance MR 2. Construction Waste Management MR 5. Regional Materials IEQ 7.1. Thermal Comfort	1 Required 1-19 1-2 1-2 1
11. LiveRoof®	SS 5.1. Site Development—Protect or Restore Habitat SS 5.2. Site Development—Maximize Open Space SS 6.1. Stormwater Design—Quantity Control SS 6.1. Stormwater Design—Quality Control SS 7.2. Heat Island Effect—Roof	1 1 1 1 1
12. FlintBoard™ Roof Insulation	EA Prerequisite 2. Minimum Energy Performance EA 1. Optimize Energy Performance MR 4. Recycled Content MR 5. Regional Materials IEQ 7.1. Thermal Comfort	Required 1-19 1-2 1-2 1
13. WeatherBoards™ Fiber Cement Siding	MR 4. Recycled Content	1-2
14. WeatherBoards™ Fiber Cement Trim and Soffit	MR 5. Regional Materials	1-2
15. CedarBoards™ Insulated Vinyl Siding	EA Prerequisite 2. Minimum Energy Performance EA 1. Optimize Energy Performance MR 4. Recycled Content	Required 1-19 1-2
16. Restoration Millwork® Trim	MR 5. Regional Materials	1-2
17. Form-A-Drain® Foundation Footing System	MR 4. Recycled Content	1-2
18. ThermaEZE™ Thermal Insulation System	EA Prerequisite 2. Minimum Energy Performance EA 1. Optimize Energy Performance IEQ 7.1. Thermal Comfort	Required 1-19 1
19. Platon® Air Gap Waterproofing Membrane	MR 4. Recycled Content	1-2
20. T-ROC® Thermal Laminate Foundation Insulation System	EA Prerequisite 2. Minimum Energy Performance EA 1. Optimize Energy Performance IEQ 7.1. Thermal Comfort	Required 1-19 1
21. CertaWrap™ Weather Resistant Barrier	EA Prerequisite 2. Minimum Energy Performance EA 1. Optimize Energy Performance	Required 1-19

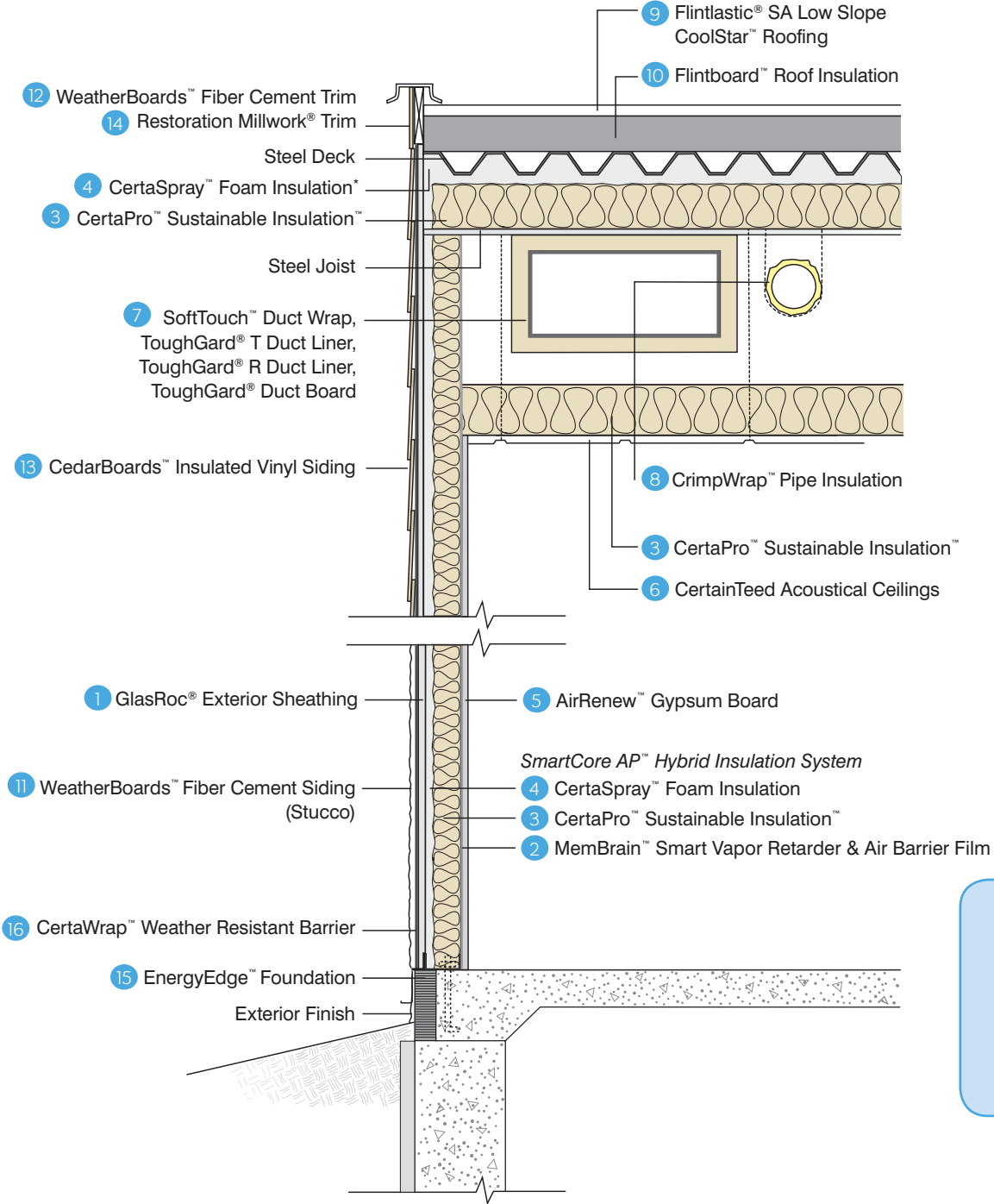

Check out [certainteedsolutions.com](http://certainteedsolutions.com) for an in-depth look at CertainTeed and Saint-Gobain products that support evidence-based design principles in healthcare facilities.

\*Apply thermal or ignition barrier. Check local code.

# CertainTeed Product Contributions to LEED-HC Credits

Healthcare Supplement, 2009

PRODUCT	CREDITS	POINTS
1. GlasRoc® Exterior Sheathing	MR 3. Sustainably Sourced Materials and Products	1-4
<i>SmartCore AP™ Hybrid Insulation System</i>		
2. MemBrain™ Smart Vapor Retarder & Air Barrier Film	EA Prerequisite 2. Minimum Energy Performance EA 1. Optimize Energy Performance	Required 1-24
3. CertaPro™ Sustainable Insulation™	MR 3. Sustainably Sourced Materials and Products	1-4
4. CertaSpray™ Foam Insulation	IEQ 2. Acoustic Environment	1-2
	IEQ 4. Low Emitting Materials	1-4
	IEQ 7. Thermal Comfort	1
5. AirRenew™ Gypsum Board	MR 3. Sustainably Sourced Materials and Products	1-4
	IEQ 4. Low-Emitting Materials	1-4
6. CertainTeed Acoustical Ceilings	EA Prerequisite 2. Minimum Energy Performance	Required
	EA 1. Optimize Energy Performance	1-24
	MR 2. Construction Waste Management	1-2
	MR 3. Sustainably Sourced Materials and Products	1-2
	IEQ 2. Acoustic Environment	1-2
7. SoftTouch™ Duct Wrap, ToughGard® T Duct Liner, ToughGard® R Duct Liner, ToughGard® Duct Board	IEQ 4. Low-Emitting Materials	1-4
	IEQ 8.1. Daylight and Views—Daylight	2
	EA Prerequisite 2. Minimum Energy Performance	Required
	EA 1. Optimize Energy Performance	1-24
	MR 3. Sustainably Sourced Materials and Products	1-4
8. CrimpWrap™ Pipe Insulation	IEQ 2. Acoustic Environment	1-2
	IEQ 4. Low Emitting Materials	1-4
	IEQ 7.1. Thermal Comfort	1
	EA Prerequisite 2. Minimum Energy Performance	Required
EA 1. Optimize Energy Performance	1-24	
	IEQ 7. Thermal Comfort	1

PRODUCT	CREDITS	POINTS
9. Flintlastic® SA Low Slope CoolStar™ Roofing	SS 7.2. Heat Island Effect—Roof	1
	EA Prerequisite 2. Minimum Energy Performance	Required
	EA 1. Optimize Energy Performance	1-24
	MR 2. Construction Waste Management	1-2
	MR 3. Sustainably Sourced Materials and Products	1-4
IEQ 7. Thermal Comfort	1	
10. FlintBoard™ Roof Insulation	EA Prerequisite 2. Minimum Energy Performance	Required
	EA 1. Optimize Energy Performance	1-24
	IEQ 7. Thermal Comfort	1
11. WeatherBoards™ Fiber Cement Siding	MR 3. Sustainably Sourced Materials and Products	1-4
12. WeatherBoards™ Fiber Cement Trim and Soffit		
13. CedarBoards™ Insulated Vinyl Siding	EA Prerequisite 2. Minimum Energy Performance	Required
	EA 1. Optimize Energy Performance	1-24
	MR 3. Sustainably Sourced Materials and Products	1-4
14. Restoration Millwork® Trim	MR 3. Sustainably Sourced Materials and Products	1-4
15. EnergyEdge™ Foundation	EA Prerequisite 2. Minimum Energy Performance	Required
	EA 1. Optimize Energy Performance	1-24
	MR 5. Regional Materials	1-2
	IEQ 7. Thermal Comfort	1
16. CertaWrap™ Weather Resistant Barrier	EA Prerequisite 2. Minimum Energy Performance	Required
	EA 1. Optimize Energy Performance	1-19

# LEED for Homes (H) and LEED for Homes: Canada Advanced Design

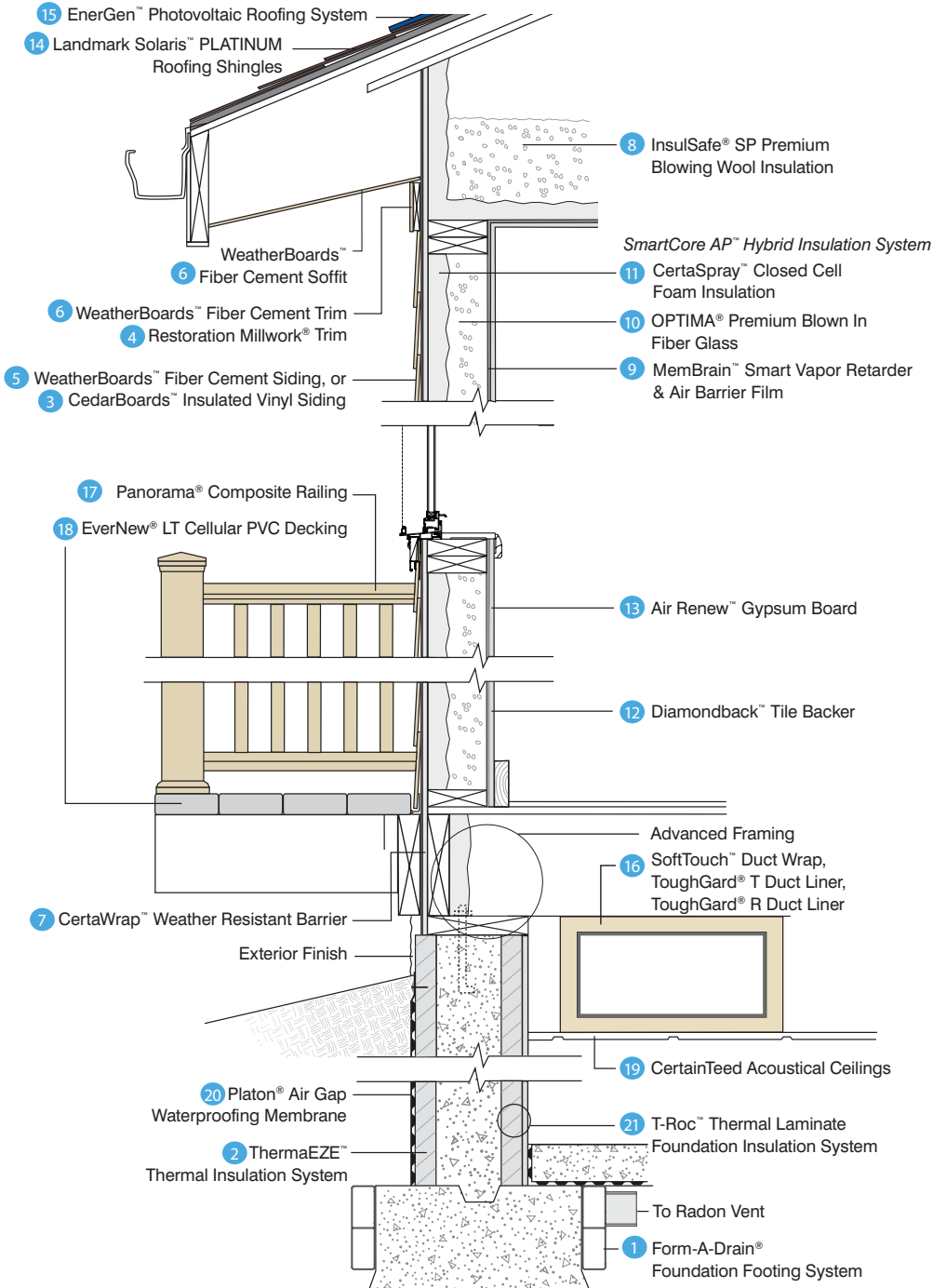

# CertainTeed Product Contributions to LEED-H and LEED-H: Canada Advanced Design Credits

LEED-H, 2009

PRODUCT	CREDITS	POINTS
1. Form-A-Drain® Foundation Footing System	ID 2. Durability Management Process IEQ 9. Radon Protection	3 1
2. ThermaEZE™ Thermal Insulation System	EA 1. Optimize Energy Performance EA 2. Insulation	1–34 2
3. CedarBoards™ Insulated Vinyl Siding	EA 1. Optimize Energy Performance MR 2.2. Environmentally Preferable Products— Materials	1–34 0.5
4. Restoration Millwork® Trim	MR 2.2. Environmentally Preferable Products—Local	0.5
5. WeatherBoards™ Fiber Cement Siding	MR 2.2. Environmentally Preferable Products— Materials	0.5
6. WeatherBoards™ Fiber Cement Trim and Soffit	MR 2.2. Environmentally Preferable Products—Local	0.5
7. CertaWrap™ Weather Resistant Barrier	ID 2. Durability Management Process	3
8. InsulSafe® SP Premium Blowing Wool Insulation	ID 2. Durability Management Process EA 1. Optimize Energy Performance	3 1–34
<i>SmartCore AP™ Hybrid Insulation System</i>	EA 2. Insulation MR 2.2. Environmentally Preferable Products— Materials	2 0.5
9. MemBrain™ Smart Vapor Retarder & Air Barrier Film	MR 2.2. Environmentally Preferable Products—Local	0.5
10. OPTIMA® Premium Blown In Fiber Glass	MR 2.2. Environmentally Preferable Products— Emissions Specifications	0.5
11. CertaSpray™ Closed Cell Foam Insulation		
12. Diamondback™ Tile Backer	MR 2.2. Environmentally Preferable Products— Materials MR 2.2. Environmentally Preferable Products—Local	0.5 0.5

PRODUCT	CREDITS	POINTS
13. AirRenew™ Gypsum Board	MR 2.2. Environmentally Preferable Products— Emissions Specifications MR 2.2. Environmentally Preferable Products— Materials	0.5 0.5
14. Landmark Solaris™ PLATINUM Roofing Shingles	EA 1. Optimize Energy Performance MR 2.2. Environmentally Preferable Products— Local MR 3.2. Construction Waste Reduction	1–34 0.5 3
15. EnerGen™ Photovoltaic Roofing System	EA 10. Renewable Energy	1–10
16. SoftTouch™ Duct Wrap, ToughGard® T Duct Liner, ToughGard® R Duct Liner	EA 5. Heating and Cooling Distribution System MR 2.2. Environmentally Preferable Products— Emissions Specifications MR 2.2. Environmentally Preferable Products— Materials	2–3 0.5 0.5
17. Panorama® Composite Railing	MR 2.2. Environmentally Preferable Products— Materials	0.5
18. EverNew® LT Cellular PVC Decking	MR 2.2. Environmentally Preferable Products— Materials	0.5
19. CertainTeed Acoustical Ceilings	MR 2.2. Environmentally Preferable Products— Materials MR 2.2. Environmentally Preferable Products— Local MR 3. Construction Waste Management	0.5 0.5 0.5–3
20. Platon® Air Gap Waterproofing Membrane	ID 2. Durability Management Process	3
21. T-ROC® Thermal Laminate Foundation Insulation System	EA 1. Optimize Energy Performance EA 2. Insulation	1–34 2

# LEED for Homes (H) and LEED for Homes: Canada Standard Design

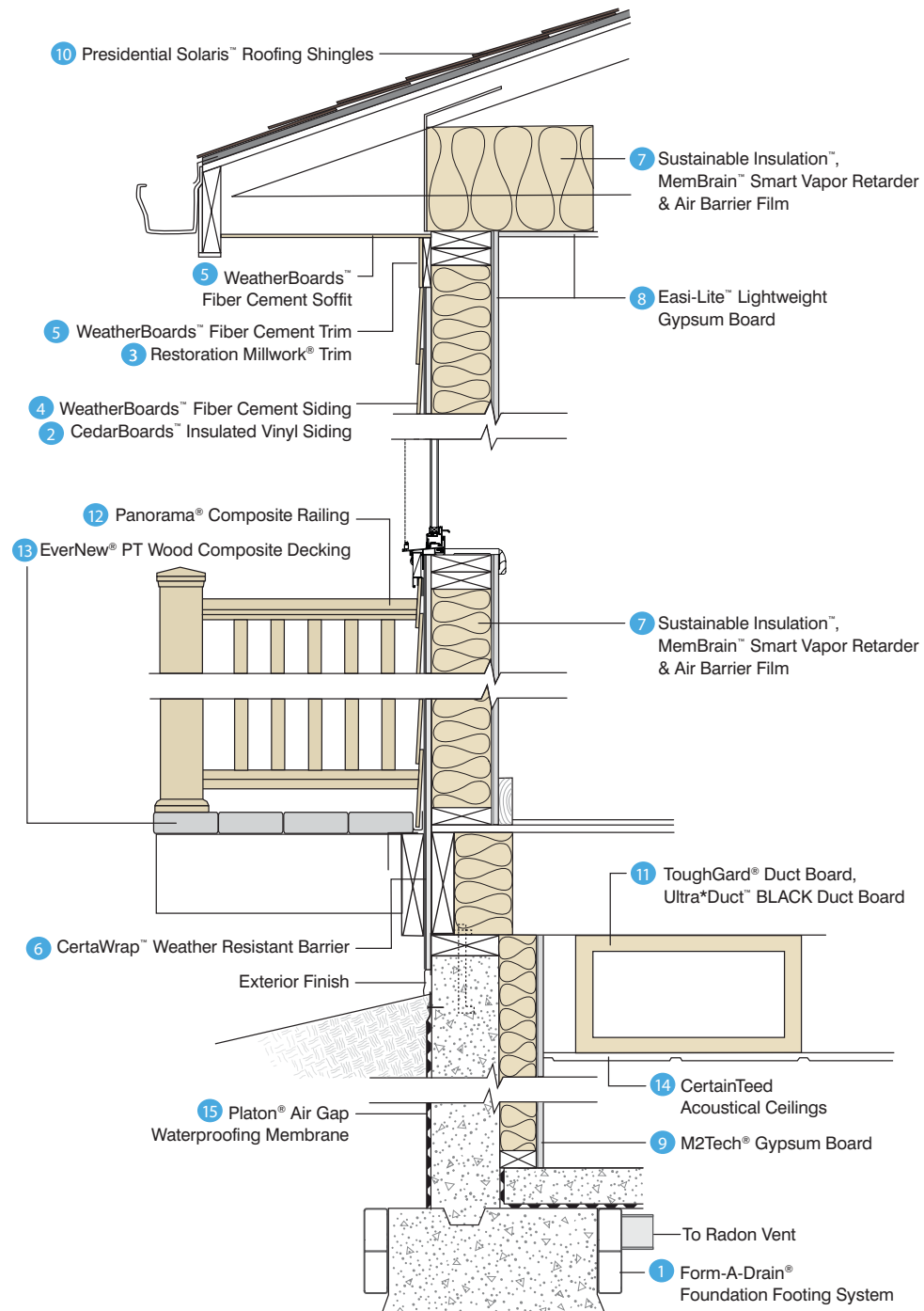

# CertainTeed Product Contributions to LEED-H and LEED-H: Canada Standard Design Credits

LEED-H, 2009

PRODUCT	CREDITS	POINTS
1. Form-A-Drain® Foundation Footing System	ID 2. Durability Management Process	3
	IEQ 9. Radon Protection	1
2. CedarBoards™ Insulated Vinyl Siding	EA 1. Optimize Energy Performance	1–34
	MR 2.2. Environmentally Preferable Products—Materials	0.5
3. Restoration Millwork® Trim	MR 2.2. Environmentally Preferable Products—Local	0.5
4. WeatherBoards™ Fiber Cement Siding	MR 2.2. Environmentally Preferable Products—Materials	0.5
5. WeatherBoards™ Fiber Cement Trim and Soffit	MR 2.2. Environmentally Preferable Products—Local	0.5
6. CertaWrap™ Weather Resistant Barrier	ID 2. Durability Management Process	3
7. Sustainable Insulation™, MemBrain™ Smart Vapor Retarder & Air Barrier Film	ID 2. Durability Management Process	3
	EA 1. Optimize Energy Performance	1–34
	EA 2. Insulation	2
	MR 2.2. Environmentally Preferable Products—Materials	0.5
	MR 2.2. Environmentally Preferable Products—Local	0.5
8. Easi-Lite™ Lightweight Gypsum Board	MR 2.2. Environmentally Preferable Products—Materials	0.5
	MR 2.2. Environmentally Preferable Products—Local	0.5
	MR 3. Construction Waste Management	0.5–3
9. M2Tech® Gypsum Board	MR 2.2. Environmentally Preferable Products—Materials	0.5
	MR 2.2. Environmentally Preferable Products—Local	0.5
	MR 3. Construction Waste Management	0.5–3

PRODUCT	CREDITS	POINTS
10. Presidential Solaris™ Roofing Shingles	EA 1. Optimize Energy Performance	1–34
	MR 2.2. Environmentally Preferable Products—Local	0.5
	MR 3.2. Construction Waste Reduction	3
11. ToughGard® T Duct Liner, Ultra*Duct™ BLACK Duct Board†	EA 5. Heating and Cooling Distribution System	2–3
	MR 2.2. Environmentally Preferable Products—Emissions Specifications	0.5
	MR 2.2. Environmentally Preferable Products—Materials	0.5
12. Panorama® Composite Railing	MR 2.2. Environmentally Preferable Products—Materials	0.5
13. EverNew® PT Wood Composite Decking	MR 2.2. Environmentally Preferable Products—Materials	0.5
14. CertainTeed Acoustical Ceilings	MR 2.2. Environmentally Preferable Products—Materials	0.5
	MR 2.2. Environmentally Preferable Products—Local	0.5
	MR 3. Construction Waste Management	0.5–3
15. Platon® Air Gap Waterproofing Membrane	ID 2. Durability Management Process	3

† Does not achieve MR 2.2. Emissions Specifications

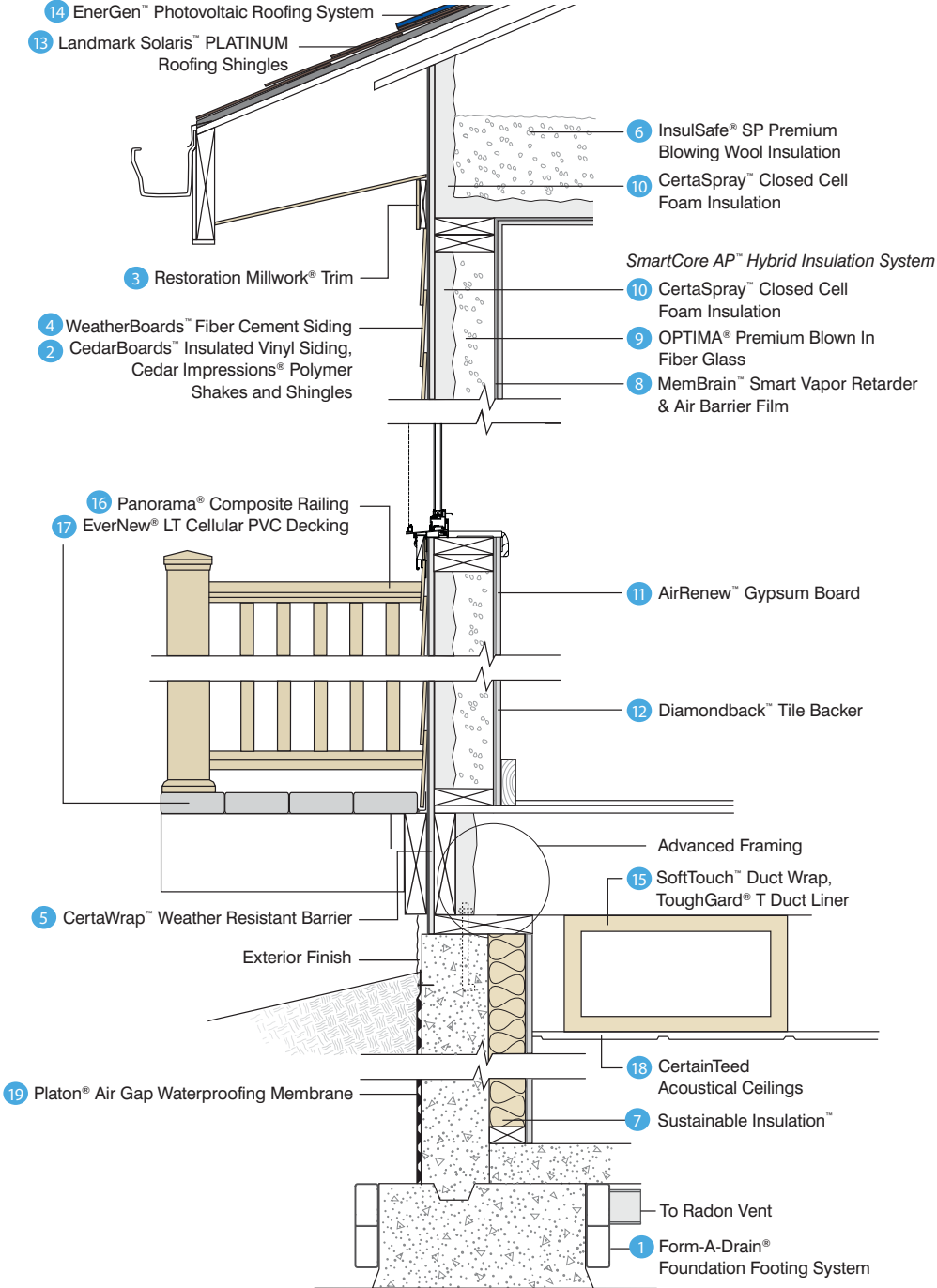



# CertainTeed Product Contributions To NAHB Advanced Design Credits

National Green Building Standard, 2008



Note: Green text indicates product has been Green Approved by the NAHB Research Center to automatically earn points for this particular credit. See individual product pages for certification numbers.

PRODUCT	CREDITS	POINTS	
1. Form-A-Drain® Foundation Footing System	602.3	Foundation Drainage	4
	604.1	Recycled Content	3
	608.1	Indigenous Materials	2
	902.3	Radon Control	10–15
2. CedarBoards™ Insulated Vinyl Siding, Cedar Impressions® Polymer Shakes and Shingles	601.7	Site-Applied Finishing Materials	2–5
	602.8	Termite-Resistant Materials	2–6
	604.1	Recycled Content ( <i>CedarBoards D6 only</i> )	2–4
	605.3	Recycled Construction Materials	3
3. Restoration Millwork® Trim	608.1	Indigenous Materials	2
	609.1	Life Cycle Analysis ( <i>CedarBoards and Cedar Impressions only</i> )	3
	610.1	Manufacturer's Environmental Management System Concepts ( <i>CedarBoards and Cedar Impressions only</i> )	1–10
	702.2	Energy Cost Performance Levels ( <i>CedarBoards only</i> )	30–120
	703.1	Building Envelope ( <i>CedarBoards only</i> )	10–36
4. WeatherBoards™ Fiber Cement Siding	601.7	Site-Applied Finishing Materials ( <i>ColorMax™ Finishing System only</i> )	2–5
	602.8	Termite-Resistant Materials	2–6
	604.1	Recycled Content	2–4
	608.1	Indigenous Materials	2
	609.1	Life Cycle Analysis	3
	610.1	Manufacturer's Environmental Management System Concepts	1–10
5. CertaWrap™ Weather Resistant Barrier	602.7	Termite Barrier	4
	602.11	Foundation Waterproofing	4
6. InsulSafe® SP Premium Blowing Wool Insulation	604.1	Recycled Content	1–2
	604.1	Recycled Content	2–4
7. Sustainable Insulation™ <i>SmartCore AP™ Hybrid Insulation System</i>	608.1	Indigenous Materials	2
	609.1	Life Cycle Analysis	3
	610.1	Manufacturer's Environmental Management System Concepts ( <i>Blown In Insulation only</i> )	1–10
8. MemBrain™ Smart Vapor Retarder & Air Barrier Film	702.2	Energy Cost Performance Levels	30–120
9. OPTIMA® Premium Blown In Fiber Glass	703.1	Building Envelope	10–36
	703.2.1	Insulation and Air Sealing ( <i>CertaSpray only</i> )	3–15
10. CertaSpray™ Closed Cell Foam Insulation	704.6.2.1	Building Envelope Leakage Rate ( <i>CertaSpray only</i> )	3–15
	901.11	Insulation	4
	901.3(1)(B)	Continuous Air Barrier	2

PRODUCT	CREDITS	POINTS	
11. AirRenew™ Gypsum Board	604.1	Recycled Content	2–6
12. Diamondback™ Tile Backer	608.1	Indigenous Materials	2
	610.1	Manufacturer's Environmental Management System Concepts	1–10
	901.7	Pollutant Source Control—Wall Coverings	4
	602.13	Roof Surfaces	3
13. Landmark Solaris™ PLATINUM Roofing Shingles	608.1	Indigenous Materials	2
	702.2	Energy Cost Performance Levels	30–120
	703.1	Building Envelope	10–36
	704.3.3.1	Additional Renewable Energy Options	1 per 100 watts
14. EnerGen™ Photovoltaic Roofing System	604.1	Recycled Content	1
	608.1	Indigenous Materials	2
	610.1	Manufacturer's Environmental Management System Concepts	1–10
	702.2	Energy Cost Performance Levels	30–120
	703.5.4.1	Water Heating Design, Equipment and Installation	1
	901.11	Insulation	4
15. SoftTouch™ Duct Wrap, ToughGard® T Duct Liner	903.5.2	Plumbing	2
	903.6	Duct Insulation	2
	601.7	Site-Applied Finishing Materials ( <i>Green Approved for Panorama only</i> )	2–5
16. Panorama® Composite Railing	602.8	Termite-Resistant Materials ( <i>Green Approved for Panorama only</i> )	2–6
	604.1	Recycled Content ( <i>Green Approved for Panorama only</i> )	1–3
17. EverNew® LT Cellular PVC Decking	606.3	Manufacturing Energy	2
	608.1	Indigenous Materials	2
	601.7	Site-Applied Finishing Materials	2–5
	604.1	Recycled Content	1–3
18. CertainTeed Acoustical Ceilings	605.3	Recycled Construction Materials	3
	608.1	Indigenous Materials	2
	602.7	Termite Barrier	4
	602.11	Foundation Waterproofing	4
19. Platon® Air Gap Waterproofing Membrane	604.1	Recycled Content	3
	608.1	Indigenous Materials	2
	903.3.1	Crawlspace	6

# NAHB Standard Design

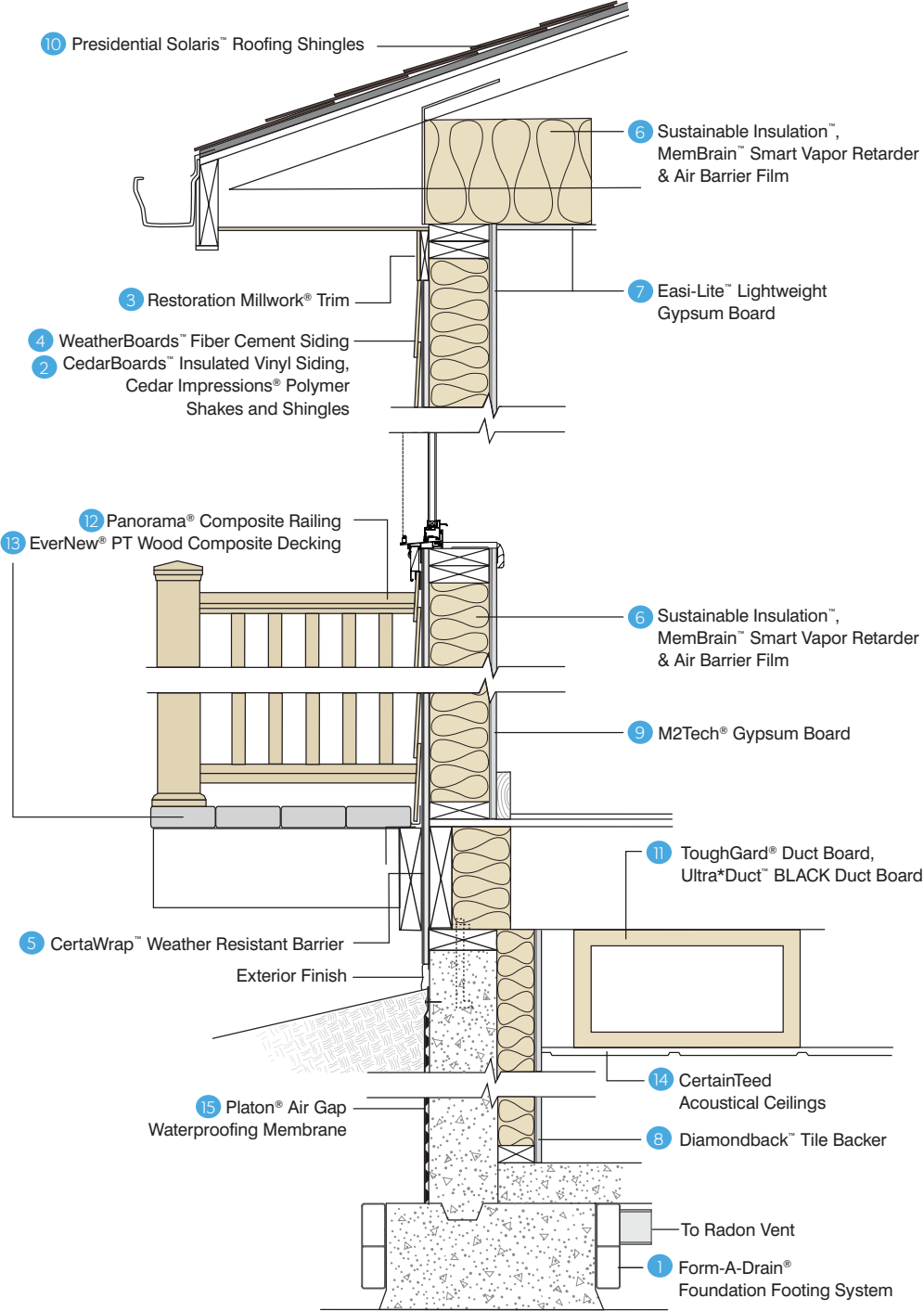

# CertainTeed Product Contributions To NAHB Standard Design Credits

National Green Building Standard, 2008



Note: Green text indicates product has been Green Approved by the NAHB Research Center to automatically earn points for this particular credit. See individual product pages for certification numbers.

PRODUCT	CREDITS	POINTS
1. Form-A-Drain® Foundation Footing System	602.3 Foundation Drainage	4
	604.1 Recycled Content	3
	608.1 Indigenous Materials	2
	902.3 Radon Control	10–15
2. CedarBoards™ Insulated Vinyl Siding, Cedar Impressions® Polymer Shakes and Shingles	601.7 Site-Applied Finishing Materials	2–5
	602.8 Termite-Resistant Materials	2–6
	604.1 Recycled Content ( <i>CedarBoards D6 only</i> )	2–4
	605.3 Recycled Construction Materials	3
3. Restoration Millwork® Trim	608.1 Indigenous Materials	2
	609.1 Life Cycle Analysis ( <i>CedarBoards and Cedar Impressions only</i> )	3
	610.1 Manufacturer's Environmental Management System Concepts ( <i>CedarBoards and Cedar Impressions only</i> )	1–10
	702.2 Energy Cost Performance Levels ( <i>CedarBoards only</i> )	30–120
	703.1 Building Envelope ( <i>CedarBoards only</i> )	10–36
4. WeatherBoards™ Fiber Cement Siding	601.7 Site-Applied Finishing Materials ( <i>ColorMax™ Finishing System only</i> )	2–5
	602.8 Termite-Resistant Materials	2–6
	604.1 Recycled Content	2–4
	608.1 Indigenous Materials	2
	609.1 Life Cycle Analysis	3
	610.1 Manufacturer's Environmental Management System Concepts	1–10
5. CertaWrap™ Weather Resistant Barrier	602.7 Termite Barrier	4
	602.11 Foundation Waterproofing	4
6. Sustainable Insulation™, MemBrain™ Smart Vapor Retarder & Air Barrier Film	604.1 Recycled Content	1–2
	608.1 Indigenous Materials	2
	609.1 Life Cycle Analysis	3
	610.1 Manufacturer's Environmental Management System Concepts	1–10
	702.2 Energy Cost Performance Levels	30–120
	703.1 Building Envelope	10–36
	703.2.1 Insulation and Air Sealing	3–15
901.11 Insulation	4	

PRODUCT	CREDITS	POINTS
7. Easi-Lite™ Lightweight Gypsum Board	604.1 Recycled Content	2–6
	608.1 Indigenous Materials	2
8. Diamondback™ Tile Backer	610.1 Manufacturer's Environmental Management System Concepts	1–10
	901.7 Pollutant Source Control—Wall Coverings	4
10. Presidential Solaris™ Roofing Shingles	602.13 Roof Surfaces	3
	608.1 Indigenous Materials	2
	702.2 Energy Cost Performance Levels	30–120
	703.1 Building Envelope	10–36
11. ToughGuard® T Duct Liner, Ultra*Duct™ BLACK Duct Board	604.1 Recycled Content	1–2
	608.1 Indigenous Materials	2
	610.1 Manufacturer's Environmental Management System Concepts ( <i>Green Approved for ToughGuard T only</i> )	1–10
	702.2 Energy Cost Performance Levels	30–120
	703.5.4.1 Water Heating Design, Equipment and Installation	1
	901.11 Insulation	4
12. Panorama® Composite Railing	903.5.2 Plumbing	2
	903.6 Duct Insulation	2
13. EverNew® PT Wood Composite Decking	601.7 Site-Applied Finishing Materials ( <i>Green Approved for Panorama only</i> )	2–5
	602.8 Termite-Resistant Materials ( <i>Green Approved for Panorama only</i> )	2–6
14. CertainTeed Acoustical Ceilings	604.1 Recycled Content ( <i>Green Approved for Panorama only</i> )	1–3
	606.3 Manufacturing Energy	2
	608.1 Indigenous Materials	2
	601.7 Site-Applied Finishing Materials	2–5
15. Platon® Air Gap Waterproofing Membrane	604.1 Recycled Content	1–3
	605.3 Recycled Construction Materials	3
	608.1 Indigenous Materials	2
	602.7 Termite Barrier	4
	602.11 Foundation Waterproofing	4
15. Platon® Air Gap Waterproofing Membrane	604.1 Recycled Content	3
	608.1 Indigenous Materials	2
	903.3.1 Crawlspace	6

# Understanding the role of CertainTeed Ceilings in meeting Green Building Standards

Interior Products

CertainTeed Ceilings is a leader in promoting sustainable design. We offer a recycling program for the return and recycling of old ceiling panels into new ones. In lieu of sending the panels to landfills, participants qualify for valuable points under the LEED rating systems for Construction Waste Management.

Our L'Anse, Michigan plant uses 100% renewable electricity from a nearby biomass-fueled power plant for all operations. Waste heat from the biomass plant is utilized in the manufacturing process, which reduces natural gas usage by 25%. In addition, water and manufacturing waste from the L'Anse facility are used to grow crops on nearby land, creating an almost zero waste facility.

CertainTeed Ceilings has published four Environmental Product Declarations (EPD) for their mineral fiber ceiling panels. These are the only EPDs published within this product category.



## Green Facts

- > CertainTeed ceilings offer outstanding acoustical performance, which can satisfy the acoustic prerequisite in LEED for Schools projects.
- > Our Ecophon® line of products—with 70% post-consumer recycled content—offers the highest post-consumer recycled content of any ceiling tile in North America.
- > Most CertainTeed ceiling products meet the California Department of Health Services Standard Practice for Testing of Volatile Organic Emissions from Various Sources.
- > CertainTeed mineral fiber ceiling panels incorporate steel mill slag waste as well as post-consumer waste such as newspaper.
- > More than 90% of manufacturing waste is recycled into ceiling products.
- > Most CertainTeed ceiling products have high light reflecting surfaces that can extend daylighting farther into a space. This can allow for lower light fixture density, resulting in reductions in energy consumption and greenhouse gas production.
- > Decoustics Quadrillo®, Solo™ and Solo M™ ceiling panels have been certified by the Forest Stewardship Council, which helps projects earn points towards LEED and NAHB certification.

CertainTeed Ecophon® Focus™ Dg ceiling panels feature 70% post-consumer recycled content.

# CertainTeed Ceilings Product Contributions

Visit [www.certainteed.com/ecodocs](http://www.certainteed.com/ecodocs) for more details about which products qualify for these credits and full credit descriptions.



NAHB		POSSIBLE POINTS
CREDITS	DESCRIPTION	
<i>(NAHB: National Green Building Standard, 2008)</i>		
<b>Resource Efficiency</b>		
601.7	Site-Applied Finishing Materials	2-5
604.1	Recycled Content	1-3
605.3	Recycled Construction Materials	3
606.3	Manufacturing Energy	6
608.1	Indigenous Materials	2

LEED-H		POSSIBLE POINTS
CREDITS	DESCRIPTION	
<i>(LEED-H and LEED for Canada: Homes: LEED-H, 2009)</i>		
<b>Materials &amp; Resources</b>		
MR 2.2	Environmentally Preferable Products—Materials	0.5
MR 2.2	Environmentally Preferable Products—Local	0.5
MR 3	Waste Management	0.5-3

LEED-NC, LEED-CS, LEED FOR SCHOOLS, LEED FOR HEALTHCARE AND LEED FOR RETAIL						
<i>(LEED for NC, CS, Schools, LEED for Canada: NC: LEED 2009. LEED for Healthcare: Healthcare Supplement. LEED for Retail: Retail Supplement 2009.)</i>						
CREDITS	DESCRIPTION	POSSIBLE POINTS				
		NC	CS	Schools	Health-care	Retail
<b>Energy &amp; Atmosphere</b>						
EA	Minimum Energy Performance	Req	Req	Req	Req	Req
EA 1	Optimize Energy Performance	1-19	3-21	1-19	1-24	1-19
<b>Materials &amp; Resources</b>						
MR 2	Construction Waste Management	1-2	1-2	1-2	1-2	1-2
MR 3	Sustainably Sourced Materials and Products	NA	NA	NA	1-4	NA
MR 4	Recycled Content	1-2	1-2	1-2	NA	1-2
MR 5	Regional Materials	1-2	1-2	1-2	NA	1-2
MR 6	Rapidly Renewable Materials	1	NA	1	NA	1
<b>Indoor Environmental Quality</b>						
IEQ 2	Acoustic Environment	NA	NA	NA	1-2	NA
IEQ Prereq. 3	Minimum Acoustical Performance	NA	NA	Req	NA	NA
IEQ 4	Low-Emitting Materials	NA	NA	NA	1-4	1-5
IEQ 4.6	Low-Emitting Materials—Ceiling and Wall Systems	NA	NA	1	NA	NA
IEQ 8.1	Daylight and Views—Daylight	1	1	1-3	2	1
IEQ 9	Enhanced Acoustical Performance	NA	NA	1	NA	NA

LEED-CI		POSSIBLE POINTS
CREDITS	DESCRIPTION	
<i>(LEED CI: LEED 2009)</i>		
<b>Energy &amp; Atmosphere</b>		
EA 1.1	Optimize Energy Performance—Lighting Power	1-5
<b>Materials &amp; Resources</b>		
MR 2	Construction Waste Management	1-2
MR 4	Recycled Content	1-2
MR 5	Regional Materials	1-2
MR 6	Rapidly Renewable Materials	1
<b>Indoor Environmental Quality</b>		
IEQ 8.1	Daylight and Views—Daylight	1-2

As part of our commitment to product stewardship, CertainTeed conducted life cycle assessments on our mineral fiber ceiling panels. This data is published in four Environmental Product Declarations (EPD) to provide transparent information about the life cycle impacts of our mineral fiber ceiling panels. CertainTeed Ceilings is the first manufacturer to publish an EPD in our product category, offering an unprecedented level of transparency with regards to our ongoing sustainability efforts.

These EPDs can help contribute in achieving points in LEED Pilot Credit 43: Certified Products. For more information about these EPDs please visit our website at [www.certainteed.com/CeilingsEPD](http://www.certainteed.com/CeilingsEPD).

CertainTeed Ceilings Plant Locations:  Ellenton, FL • L'Anse, MI • Plymouth, WI  Toronto, ON

# Understanding the role of CertainTeed Gypsum in meeting Green Building Standards

Interior Products

CertainTeed Gypsum is committed to preservation of natural resources, recycling, waste management and reclamation in its operations. As part of Saint-Gobain, the world's largest gypsum board manufacturer, CertainTeed Gypsum is a leader in the effort to provide building materials that promote sustainable design.

CertainTeed offers gypsum products that can contribute to the built environment's indoor environmental quality, acoustics management, fire resistance and materials recycled content. Our gypsum board, paperless glass mat board, finishing compound and joint tape manufacturing locations can provide regional materials coverage throughout North America.

Gypsum board product innovation is also carried out with a focus on sustainability. Research and development emphasize minimizing environmental impacts to the greatest extent possible.



## Green Facts

- > Sustainable gypsum solutions from CertainTeed include paperless exterior sheathing, area separation firewall and shaft wall, abuse- and impact-resistant board, moisture- and mold-resistant board for walls and ceilings, glass mat tile backer, corner reinforcements and finishing products to help maintain healthy indoor environments.
- > Innovative AirRenew Indoor Air Quality gypsum board is the first of its kind to clean the air. AirRenew helps improve IAQ by actively capturing VOCs, such as formaldehyde, from the indoor environment and safely converting them into inert compounds. AirRenew can be installed, finished, renovated and recycled like standard gypsum board.
- > AirRenew, SilentFX, Diamondback and M2Tech board and finishing products and systems have achieved the best scores possible for mold resistance per ASTM standards. The family includes GREENGUARD Children & Schools<sup>SM</sup> Certified, GREENGUARD Indoor Air Quality Certified, UL Environment ECV validated and NAHB Green Approved products.
- > CertainTeed is committed to resource conservation:
  - Energy, water and waste reduction programs at all plants across U.S. and Canada.
  - 100% recycled face and back paper on gypsum board.
  - Total recycled content is 99% for CertainTeed Gypsum wallboard products using synthetic gypsum.

M2Tech gypsum board has achieved GREENGUARD<sup>®</sup> Children & Schools<sup>SM</sup> certification.

# CertainTeed Gypsum Product Contributions

Visit [www.certainteed.com/ecodocs](http://www.certainteed.com/ecodocs) for more details about which products qualify for these credits and full credit descriptions.



### NAHB

(NAHB: National Green Building Standard, 2008)

CREDITS	DESCRIPTION	POSSIBLE POINTS
<b>Resource Efficiency</b>		
604.1	Recycled Content	2-6
608.1	Indigenous Materials	2
609.1	Life Cycle Analysis	3
610.1	Manufacturer's Environmental Management System Concepts	1-10

Note: Green text indicates qualifying CertainTeed products that have been Green Approved by the NAHB Research Center to automatically earn points for this particular credit. M2Tech gypsum board and ProRoc finishing products: 00047

### LEED-NC, LEED-CS, LEED FOR SCHOOLS, LEED FOR HEALTHCARE AND LEED FOR RETAIL

(LEED for NC, CS, Schools, LEED for Canada: NC: LEED 2009. LEED for Healthcare: Healthcare Supplement. LEED for Retail: Retail Supplement 2009.)

CREDITS	DESCRIPTION	POSSIBLE POINTS				
		NC	CS	Schools	Health-care	Retail
<b>Materials &amp; Resources</b>						
MR 2	Construction Waste Management	1-2	1-2	1-2	1-2	1-2
MR 3	Sustainably Sourced Materials and Products	NA	NA	NA	1-4	NA
MR 4	Recycled Content	1-2	1-2	1-2	NA	1-2
MR 5	Regional Materials	1-2	1-2	1-2	NA	1-2
<b>Indoor Environmental Quality</b>						
IEQ Prereq. 3	Minimum Acoustical Performance	NA	NA	Req	NA	NA
IEQ 2	Acoustic Environment	NA	NA	NA	1-2	NA
IEQ 4	Low-Emitting Materials	NA	NA	NA	1-4	1-5
IEQ 4.6	Low-Emitting Materials—Ceiling and Wall Systems	NA	NA	1	NA	NA
IEQ 9	Enhanced Acoustical Performance	NA	NA	1	NA	NA
IEQ 10	Mold Prevention	NA	NA	1	NA	NA

### LEED-CI

(LEED CI: LEED 2009)

CREDITS	DESCRIPTION	POSSIBLE POINTS
<b>Materials &amp; Resources</b>		
MR 2	Construction Waste Management	1-2
MR 4	Recycled Content	1-2
MR 5	Regional Materials	1-2

### LEED-H

(LEED-H and LEED for Canada: Homes: LEED-H, 2009)

CREDITS	DESCRIPTION	POSSIBLE POINTS
<b>Materials &amp; Resources</b>		
MR 2.2	Environmentally Preferable Products—Materials	0.5
MR 2.2	Environmentally Preferable Products—Local	0.5

CertainTeed Gypsum Plant Locations: Carrollton, KY • Cody, WY • Fort Dodge, IA • Junction City, KS • Kent, WA • Las Vegas, NV • Moundsville, WV • Napa, CA • Nashville, AR • Seattle, WA

Calgary, AB • McAdam, NB • Montreal, QC • Oakville, ON • Toronto, ON • Vancouver, BC • Winnipeg, MB

## Understanding the role of CertainTeed Insulation in meeting Green Building Standards

Interior Products

CertainTeed insulation products by their very nature improve building energy efficiency and reduce energy consumption for the life of the structure, conserving nonrenewable energy sources, decreasing dependence on foreign oil and lowering greenhouse gas emissions. Sand—an inert, abundant and naturally renewable resource—is the primary raw material used to make fiber glass. In addition, our fiber glass products average 30-40% in the US and 60-70% in Canada for recycled glass content (pre- and post-consumer).

All CertainTeed fiber glass building insulation is GREENGUARD® Children & Schools<sup>SM</sup> Certified, ensuring very low or no emissions of volatile organic compounds (VOCs), including formaldehyde.



### Green Facts

> CertainTeed is proud to introduce Sustainable Insulation, an environmentally responsible fiber glass building insulation that uses recycled and renewable content and a plant-based binder with no added formaldehyde, acrylics, dyes or unnecessary fire retardant chemicals.

**sustainable**  **insulation.**

> A typical pound of fiber glass insulation saves 12 times as much energy in its first year in place as the energy used to produce it.

> CertainTeed fiber glass insulation continues to save energy for the life of the building, with no sealing, no maintenance and no additional expense required.

> CertainTeed CertaSpray spray polyurethane foam insulation also provides an effective air seal, which helps to reduce energy loss and can improve indoor air quality performance.

> All insulation products improve acoustical performance and environmental comfort of buildings.

> CertainTeed's patented innovation MemBrain™, the smart vapor retarder and air barrier film, helps keep moisture out of wall cavities, reducing the risk of damaging mold growth and helping to maintain better indoor air quality.

> ToughGard R and ToughGard T duct liner can minimize background HVAC system noise, helping to contribute to acoustical performance credits.

> CertainTeed Insulation is an ENERGY STAR Insulation Manufacturing Partner.



# CertainTeed Insulation Product Contributions

Visit [www.certainteed.com/ecodocs](http://www.certainteed.com/ecodocs) for more details about which products qualify for these credits and full credit descriptions.



## NAHB

(NAHB: National Green Building Standard, 2008)

CREDITS	DESCRIPTION	POSSIBLE POINTS
<b>Resource Efficiency</b>		
604.1	Recycled Content	1-2
608.1	Indigenous Materials	2
609.1	Life Cycle Analysis	3
610.1	Manufacturer's Environmental Management System Concepts	1-10
<b>Energy Efficiency</b>		
702.2	Energy Cost Performance Levels	30-120
703.1	Building Envelope	10-36
703.2.1	Insulation and Air Sealing	3-15
703.5.4.1	Water Heating Design, Equipment and Installation	1
<b>Indoor Environmental Quality</b>		
901.11	Insulation/Duct	5
903.5.2	Plumbing	2
903.6	Duct Insulation	2

Note: Green text indicates qualifying CertainTeed products that have been Green Approved by the NAHB Research Center to automatically earn points for this particular credit.  
 Premium blowing wool insulation: 00048  
 SoftTouch duct wrap insulation: 00049  
 Sustainable Insulation batt and roll insulation: 00187  
 Fiber glass batt and roll insulation: 00188  
 CertaSpray open and closed cell spray foam insulation

## LEED-H

(LEED-H and LEED for Canada: Homes: LEED-H, 2009)

CREDITS	DESCRIPTION	POSSIBLE POINTS
<b>Innovation &amp; Design</b>		
ID 2	Durability Management Process	3
<b>Energy &amp; Atmosphere</b>		
EA 1	Optimize Energy Performance	1-34
EA 2	Insulation	2
EA 5	Heating and Cooling Distribution System	2-3
<b>Materials &amp; Resources</b>		
MR 2.2	Environmentally Preferable Products—Materials	0.5
MR 2.2	Environmentally Preferable Products—Local	0.5
MR 2.2	Environmentally Preferable Products—Emission Specifications	0.5

## LEED-CI

(LEED CI: LEED 2009)

CREDITS	DESCRIPTION	POSSIBLE POINTS
<b>Energy &amp; Atmosphere</b>		
EA Prereq. 2	Minimum Energy Performance	Req
EA 1.3	Optimize Energy Performance—HVAC	5-10
<b>Materials &amp; Resources</b>		
MR 4	Recycled Content	1-2
MR 5	Regional Materials	1-2
<b>Indoor Environmental Quality</b>		
IEQ 7.1	Thermal Comfort	1

## LEED-NC, LEED-CS, LEED FOR SCHOOLS, LEED FOR HEALTHCARE AND LEED FOR RETAIL

(LEED for NC, CS, Schools, LEED for Canada: NC: LEED 2009. LEED for Healthcare: Healthcare Supplement. LEED for Retail: Retail Supplement 2009.)

CREDITS	DESCRIPTION	POSSIBLE POINTS				
		NC	CS	Schools	Health-care	Retail
<b>Energy &amp; Atmosphere</b>						
EA Prereq. 2	Minimum Energy Performance	Req	Req	Req	Req	Req
EA 1	Optimize Energy Performance	1-19	3-21	1-19	1-24	1-19
<b>Materials &amp; Resources</b>						
MR 3	Sustainably Sourced Materials and Products	NA	NA	NA	1-4	NA
MR 4	Recycled Content	1-2	1-2	1-2	NA	1-2
MR 5	Regional Materials	1-2	1-2	1-2	NA	1-2
<b>Indoor Environmental Quality</b>						
IEQ Prereq. 3	Minimum Acoustical Performance	NA	NA	1	NA	NA
IEQ 2	Acoustic Environment	NA	NA	NA	1-2	NA
IEQ 4	Low-Emitting Materials	NA	NA	NA	1-4	1-5
IEQ 4.6	Low-Emitting Materials—Ceiling and Wall Systems	NA	NA	1	NA	NA
IEQ 7	Thermal Comfort	NA	NA	NA	1	NA
IEQ 7.1	Thermal Comfort	1	1	1	NA	1
IEQ 9	Enhanced Acoustical Performance	NA	NA	1	NA	NA

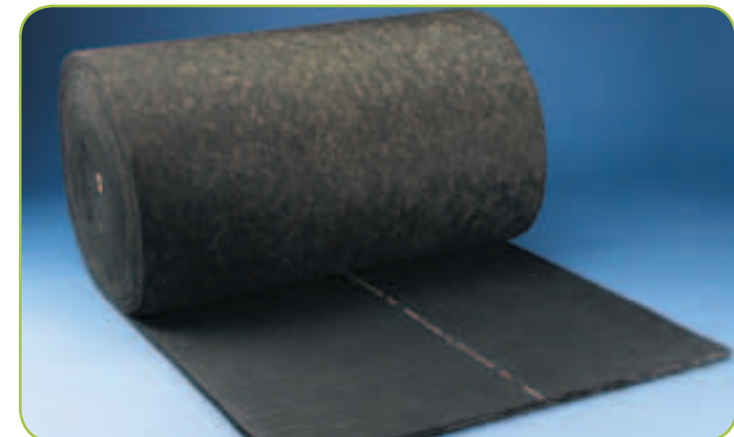

CertainTeed Insulation Plant Locations: Athens, GA • Chowchilla, CA • Kansas City, KS • Sherman, TX

Ottawa, ON • Redcliff, AB

# Understanding the role of CertainTeed Fence, Railing and Decking in meeting Green Building Standards

Exterior Products

CertainTeed supports sustainable building and manufacturing practices. CertainTeed offers a comprehensive line of environmentally friendly fence, railing and decking products. CertainTeed fence does not require chemical treatment or painting. Our fence, railing and decking products are termite resistant and feature a long life span and low maintenance, which helps to conserve natural resources.

Beautiful, durable, and virtually maintenance-free, CertainTeed fence, railing and decking systems and accessories come in a wide array of colors, textures and sizes, making it easy to create a look that complements your personality and lifestyle while conserving natural resources.



## Green Facts

- > Our fence, railing and deck manufacturing facility in Buffalo, New York is built on a brownfield site and uses 100% hydropower.
- > The Buffalo plant uses a closed loop water system that saves more than 372,000,000 gallons of water per year. Water used in the manufacturing process is self-contained and re-used; it is not released into the environment.
- > CertainTeed has a strong recycling program that includes cardboard, paper, oil, metals (i.e., steel and aluminum), plastics and wood.
- > Our Panorama® composite railing is made of 90% recycled material and is an NAHB Research Center Green Approved product.
- > CertainTeed's vinyl fence, railing and deck products feature a minimum 30-year product life and low maintenance.
- > CertainTeed's composite products feature a minimum 25-year product life and low maintenance.
- > None of our fence, railing and deck products require chemical treatment or painting.
- > All CertainTeed fence, railing and deck products are non-porous, and will not develop mold or rot.
- > EverNew® PT deck contains 74% recycled content. EverNew® LT Cellular PVC Decking contains 27% recycled content.

Panorama composite railing with square balusters in white and EverNew PT composite decking in IPE Tropics.

# CertainTeed Fence, Railing and Decking Product Contributions

Visit [www.buildingresponsibly.com](http://www.buildingresponsibly.com) for more details about which products qualify for these credits and full credit descriptions.



**NAHB**  
(NAHB: National Green Building Standard, 2008)

CREDITS	DESCRIPTION	POSSIBLE POINTS
<b>Resource Efficiency</b>		
601.7	Site-Applied Finishing Materials	2–5
602.8	Termite-Resistant Materials <i>(Green Approved for railing and decking only)</i>	2–5
604.1	Recycled Content	1–3
606.3	Manufacturing Energy	2
608.1	Indigenous Materials	2

**NAHB RESEARCH CENTER GREEN APPROVED**

Note: Green text indicates qualifying CertainTeed products that have been Green Approved by the NAHB Research Center to automatically earn points for this particular credit. CertainTeed vinyl railing and deck and Panorama composite railing: 00069

**LEED-H**  
(LEED-H and LEED for Canada: Homes: LEED-H, 2009)

CREDITS	DESCRIPTION	POSSIBLE POINTS
<b>Materials &amp; Resources</b>		
MR 2.2	Environmentally Preferable Products—Materials	0.5

**LEED-NC, LEED-CS, LEED FOR SCHOOLS, LEED FOR HEALTHCARE AND LEED FOR RETAIL**  
(LEED for NC, CS, Schools, LEED for Canada: NC: LEED 2009. LEED for Healthcare: Healthcare Supplement. LEED for Retail: Retail Supplement 2009.)

CREDITS	DESCRIPTION	POSSIBLE POINTS				
		NC	CS	Schools	Health-care	Retail
<b>Materials &amp; Resources</b>						
MR 3	Sustainably Sourced Materials and Products	NA	NA	NA	1–4	NA
MR 4	Recycled Content	1–2	1–2	1–2	NA	1–2

Exterior Products

CertainTeed Fence, Railing and Decking Plant Locations:  Buffalo, NY

# Understanding the role of CertainTeed Fiber Cement Siding, Soffit and Trim in meeting Green Building Standards

CertainTeed WeatherBoards™ fiber cement siding and trim products are durable, low maintenance and environmentally sustainable. After several years of research and development, CertainTeed introduced the first proprietary formula that now contains 38% pre-consumer recycled material.

The innovative use of recycled content in our formulation not only improves the strength and durability of our products, but also makes them more flexible and easy to install. At the same time, the product has retained its superior paint adherence properties.

CertainTeed offers WeatherBoards™ prefinished with ColorMax® solid colors for the look of painted wood, or ColorMax® stains for the look of natural wood.



## Green Facts

- > WeatherBoards™ contains 38% recycled content.
- > Boards made with recycled content are lighter than previous formulations, which translates into less energy used to package and transport.
- > Our proprietary fiber cement formulation includes recycled content, which optimizes efficiency and sustainability of the product while decreasing the carbon footprint.
- > CertainTeed is committed to resource conservation:
  - Our manufacturing facilities recycle the water used in our plants, saving billions of gallons each year.
  - CertainTeed is dedicated to sustainable wood fiber solutions. Wherever possible, we work with the global marketplace to source and secure pulp from sustainably managed forests.
  - To incorporate recycled content into its WeatherBoards™ formula, CertainTeed uses pre-consumer by-product from electric generation at coal-fired facilities, diverting it from landfills.
- > This formulation has ICC Building Code approval (reference report #ESR-1668).
- > CertainTeed siding has conducted an industry first life cycle analysis of all its siding products. This LCA was submitted to and approved by the National Institute of Standards and Technologies (NIST) for use with its Building for Environmental and Economical Sustainability (BEES) in its product selection program. This audit and evaluation provides complete transparency to our customers.

WeatherBoards Random Square Staggered Edge in ColorMax® Nantucket Gray.

# CertainTeed Fiber Cement Siding, Soffit and Trim Product Contributions

Visit [www.buildingresponsibly.com](http://www.buildingresponsibly.com) for more details about which products qualify for these credits and full credit descriptions.



## NAHB

(NAHB: National Green Building Standard, 2008)

CREDITS	DESCRIPTION	POSSIBLE POINTS
<b>Resource Efficiency</b>		
601.7	Site-Applied Finishing Materials <i>(ColorMax only)</i>	2-5
602.8	Termite-Resistant Materials	2-6
604.1	Recycled Content	2-4
608.1	Indigenous Materials	2
609.1	Life Cycle Analysis	3
610.1	Manufacturer's Environmental Management System Concepts	1-10



Note: Green text indicates qualifying CertainTeed products that have been Green Approved by the NAHB Research Center to automatically earn points for this particular credit. WeatherBoards siding, soffit and trim: 00060 WeatherBoards siding, soffit and trim with ColorMax Finishing System or Premium stains: 00061

## LEED-H

(LEED-H and LEED for Canada: Homes: LEED-H, 2009)

CREDITS	DESCRIPTION	POSSIBLE POINTS
<b>Materials &amp; Resources</b>		
MR 2.2	Environmentally Preferable Products—Materials	0.5
MR 2.2	Environmentally Preferable Products—Local	0.5

## LEED-NC, LEED-CS, LEED FOR SCHOOLS, LEED FOR HEALTHCARE AND LEED FOR RETAIL

(LEED for NC, CS, Schools, LEED for Canada: NC: LEED 2009. LEED for Healthcare: Healthcare Supplement. LEED for Retail: Retail Supplement 2009.)

CREDITS	DESCRIPTION	POSSIBLE POINTS				
		NC	CS	Schools	Health-care	Retail
<b>Materials &amp; Resources</b>						
MR 3	Sustainably Sourced Materials and Products	NA	NA	NA	1-4	NA
MR 4	Recycled Content	1-2	1-2	1-2	NA	1-2
MR 5	Regional Materials	1-2	1-2	1-2	NA	1-2

CertainTeed is committed to product stewardship. As a part of our sustainable product development program we have conducted life cycle assessments (LCAs) of fiber cement siding products in order to provide transparency to our customers and better understand and improve our products' performance. The LCAs were submitted to BEES for third party verification and use in BEES online. Products that have a published LCA can help contribute to earning points with the NAHB National Green Building Standard and the new LEED Pilot Credit 43: Certified Products. For more information about the LCAs visit [www.certainteed.com/LCA](http://www.certainteed.com/LCA).

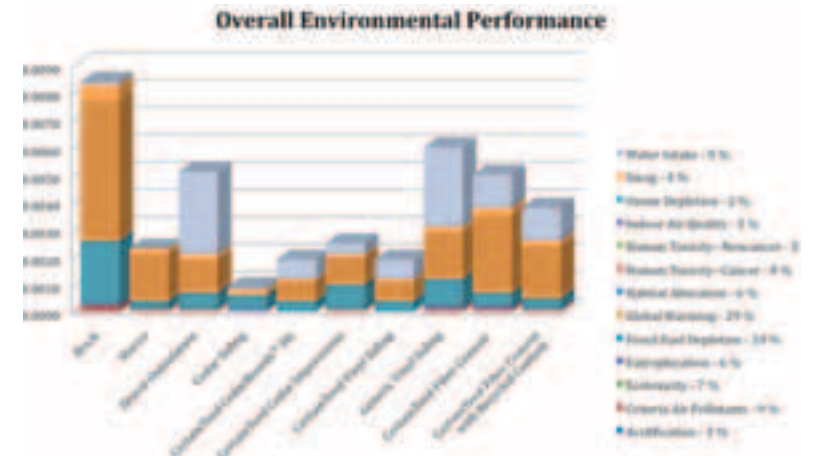

CertainTeed Fiber Cement Siding Plant Locations: North Wilkesboro, NC • Terre Haute, IN • White City, OR

# Understanding the role of CertainTeed Foundations in meeting Green Building Standards

Providing superior drainage and protection against basement water infiltration, Form-A-Drain lineals are manufactured from 100% pre- and post-consumer recycled PVC. This commitment to the use of recycled material diverts significant quantities of PVC from landfills and reduces CO<sub>2</sub> emissions that would occur if made from virgin PVC. Form-A-Drain also contributes to the home's overall indoor air quality by facilitating the dissipation of harmful radon gas. CertainTeed offers Platon®, a high-density polyethylene membrane containing up to 92% post-consumer content and providing superior moisture protection for foundation walls, floors and sub-slabs. Our ThermaEZE and T-ROC products improve overall energy efficiency of poured concrete foundation walls, while EnergyEdge serves as a form and thermal barrier for slab on grade construction.

When used in combination, CertainTeed's foundation products create a highly efficient insulation and waterproofing system providing energy efficiency, durability and moisture protection.

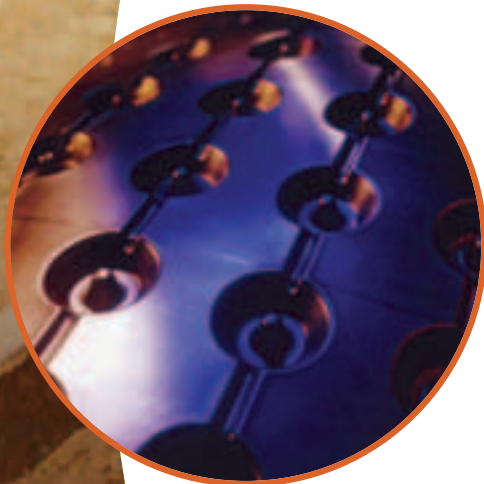

Platon, a high-density polyethylene membrane that controls both interior and exterior moisture.

## Green Facts

- > CertainTeed is committed to resource conservation. Our manufacturing facility in McPherson, Kansas has a comprehensive recycling program with a goal of zero waste disposed to landfills, and uses a closed loop process to recycle cooling water in the manufacturing process.
- > Indoor environmental quality is enhanced by Form-A-Drain and Platon since these products provide drainage and moisture control in the basement. Form-A-Drain and Platon are both NAHB Research Center Green Approved products for the National Green Building Standard.
- > EnergyEdge, ThermaEZE and T-ROC concrete foundation insulation contributes to improved overall energy efficiency. ThermaEZE is an ENERGY STAR-rated insulation product.
- > Platon is manufactured with up to 92% recycled high-density polyethylene (HDPE) from milk and other beverage containers.
- > Form-A-Drain lineals are manufactured from 100% pre- and post-consumer PVC. The overall pre- and post-consumer recycled content of Form-A-Drain system components is 92%.
- > CertainTeed diverts millions of pounds/year of PVC from landfills by recycling this material into our product formulation for Form-A-Drain.
- > In addition to landfill waste reduction, the use of recycled PVC in our product reduces the release of CO<sub>2</sub> from the extraction and processing of raw materials that are used to create virgin PVC.

# CertainTeed Foundations Product Contributions

Visit [www.buildingresponsibly.com](http://www.buildingresponsibly.com) for more details about which products qualify for these credits and full credit descriptions.

## NAHB

(NAHB: National Green Building Standard, 2008)

CREDITS	DESCRIPTION	POSSIBLE POINTS
<b>Resource Efficiency</b>		
602.11	Foundation Waterproofing <i>(PLATON only)</i>	4
602.3	Foundation Drainage <i>(FORM-A-DRAIN only)</i>	4
602.7	Termite Barrier <i>(PLATON only)</i>	4
604.1	Recycled Content <i>(FORM-A-DRAIN and PLATON only. Green Approved for FORM-A-DRAIN only.)</i>	3
608.1	Indigenous Materials	2
602.8	Termite-Resistant Materials <i>(EnergyEdge, ThermaEZE and T-ROC only)</i>	2-6
<b>Energy Efficiency</b> <i>(EnergyEdge, ThermaEZE and T-ROC only)</i>		
702.2	Energy Cost Performance Levels	30-120
703.1	Building Envelope	10-36
703.2.1	Insulation and Air Sealing	3-15
<b>Indoor Environmental Quality</b>		
902.3	Radon Control <i>(FORM-A-DRAIN only)</i>	10-15
903.3.1	Crawlspaces <i>(PLATON only)</i>	6



Note: Green text indicates qualifying CertainTeed products that have been Green Approved by the NAHB Research Center to automatically earn points for this particular credit.  
FORM-A-DRAIN foundation footing system: 00070  
PLATON: 00093

## LEED-H

(LEED-H and LEED for Canada: Homes: LEED-H, 2009)

CREDITS	DESCRIPTION	POSSIBLE POINTS
<b>Innovation &amp; Design</b> <i>(FORM-A-DRAIN and PLATON only)</i>		
ID 2	Durability Management Process	3
<b>Energy &amp; Atmosphere</b> <i>(EnergyEdge, ThermaEZE and T-ROC only)</i>		
EA 1	Optimize Energy Performance	1-34
EA 2	Insulation	2
<b>Materials &amp; Resources</b> <i>(EnergyEdge, FORM-A-DRAIN and PLATON only)</i>		
MR 2.2	Environmentally Preferable Products—Materials	0.5
MR 2.2	Environmentally Preferable Products—Local	0.5
<b>Indoor Environmental Quality</b> <i>(FORM-A-DRAIN only)</i>		
IEQ 9	Radon Control	1

## LEED-NC, LEED-CS, LEED FOR SCHOOLS, LEED FOR HEALTHCARE AND LEED FOR RETAIL

(LEED for NC, CS, Schools, LEED for Canada: NC: LEED 2009. LEED for Healthcare: Healthcare Supplement. LEED for Retail: Retail Supplement 2009.)

CREDITS	DESCRIPTION	POSSIBLE POINTS				
		NC	CS	Schools	Health-care	Retail
<b>Energy &amp; Atmosphere</b> <i>(EnergyEdge, ThermaEZE and T-ROC only)</i>						
EA Prereq. 2	Minimum Energy Performance	Req	Req	Req	Req	Req
EA 1	Optimize Energy Performance	1-19	3-21	1-19	1-24	1-19
<b>Materials &amp; Resources</b>						
MR3	Sustainably Sourced Products and Materials <i>(FORM-A-DRAIN and PLATON only)</i>	NA	NA	NA	1-4	NA
MR 4	Recycled Content <i>(FORM-A-DRAIN and PLATON only)</i>	1-2	1-2	1-2	NA	NA
MR 5	Regional Materials <i>(EnergyEdge only)</i>	1-2	1-2	1-2	NA	1-2
<b>Indoor Environmental Quality</b> <i>(EnergyEdge, ThermaEZE and T-ROC only)</i>						
IEQ 7	Thermal Comfort	NA	1	NA	1	NA
IEQ 7.1	Thermal Comfort	1	NA	1	NA	1

CertainTeed Foundations Plant Location:  McPherson, KS

## Understanding the role of CertainTeed Polymer Shakes and Shingles, Vinyl Siding and Trim in meeting Green Building Standards



Cedar Impressions® Polymer Shake and Shingles, CedarBoards™ insulated siding, vinyl siding and Restoration Millwork® are low maintenance exterior cladding and trim materials. They require no painting or caulking and only occasional washing with soap and water, thus contributing to the sustainability of any project.

CedarBoards™ D6 contains 60% (53% entire assembly) post-consumer and pre-consumer recycled content, thus contributing to credits within USGBC's LEED-H standard and NAHB's National Green Building Standard. Using Cedar Impressions® Polymer Shake and Shingles, CedarBoards™ insulated siding, vinyl siding and Restoration Millwork® offers opportunities for building professionals to increase their projects' sustainability while maximizing possible LEED and NAHB certification points.



CertainTeed vinyl siding is a closed loop product, reusing old vinyl siding to make new vinyl siding in its take-back program.

### Green Facts

- > CertainTeed has developed a corporate sustainability strategy for reducing energy use, water use and waste, and has conducted Life Cycle Assessments (LCA's) of the siding products in order to provide transparency to its customers and better understand and improve its products' performance. The LCA was submitted to BEES for third party verification and use on BEES Online. The full LCA can be found on CertainTeed's website under siding.
- > Products such as CertainTeed's CedarBoards™ insulated siding and Triple 3-1/3 soffit can help increase a project's energy efficiency.
- > Almost 100% of raw material inputs are used in the manufacturing process of Cedar Impressions® Polymer Shake and Shingles, CedarBoards™ insulated siding, vinyl siding and Restoration Millwork® product lines, practically eliminating landfill waste from manufacturing these products.
- > CedarBoards™ D6 contains 60% (53% entire assembly) pre- and post-consumer recycled material, and is an NAHB Research Center Green Approved Product.
- > CertainTeed's vinyl and polymer manufacturing facilities have been certified by ISO 14001 to meet their stringent environmental management guidelines
- > Installation of Cedar Impressions® Polymer Shake and Shingles, CedarBoards™ insulated siding, vinyl siding and Restoration Millwork® eliminates the need for paint and caulk, decreasing maintenance and the projects' environmental and economic impact.



# CertainTeed Polymer Shakes and Shingles, Vinyl Siding and Trim Product Contributions

Visit [www.buildingresponsibly.com](http://www.buildingresponsibly.com) for more details about which products qualify for these credits and full credit descriptions.



**NAHB**  
(NAHB: National Green Building Standard, 2008)

CREDITS	DESCRIPTION	POSSIBLE POINTS
<b>Resource Efficiency</b>		
601.7	Site-Applied Finishing Materials	2-5
602.8	Termite-Resistant Materials	2-6
604.1	Recycled Content ( <i>CedarBoards only</i> )	2-4
605.3	Recycled Construction Materials	3
608.1	Indigenous Materials	2
609.1	Life Cycle Analysis	3
610.1	Manufacturer's Environmental Management System Concepts	1-10
<b>Energy Efficiency</b>		
702.2	Energy Cost Performance Levels ( <i>CedarBoards only</i> )	30-120
703.1	Building Envelope ( <i>CedarBoards only</i> )	10-36

**NAHB RESEARCH CENTER GREEN APPROVED**

Note: Green text indicates qualifying CertainTeed products that have been Green Approved by the NAHB Research Center to automatically earn points for this particular credit.  
 CedarBoards insulated siding: 00050  
 Cedar Impressions: 00051  
 Restoration Millwork: 00052  
 CertainTeed and Vytec vinyl siding and soffit: 00059

**LEED-H**  
(LEED-H and LEED for Canada: Homes: LEED-H, 2009)

CREDITS	DESCRIPTION	POSSIBLE POINTS
<b>Energy &amp; Atmosphere</b>		
EA 1	Optimize Energy Performance ( <i>CedarBoards D6 only</i> )	1-34
<b>Materials &amp; Resources</b>		
MR 2.2	Environmentally Preferable Products—Materials ( <i>CedarBoards D6 only</i> )	0.5
MR 2.2	Environmentally Preferable Products—Local ( <i>Restoration Millwork only</i> )	0.5

**LEED-NC, LEED-CS, LEED FOR SCHOOLS, LEED FOR HEALTHCARE AND LEED FOR RETAIL**  
(LEED for NC, CS, Schools, LEED for Canada: NC: LEED 2009. LEED for Healthcare: Healthcare Supplement. LEED for Retail: Retail Supplement 2009.)

CREDITS	DESCRIPTION	POSSIBLE POINTS				
		NC	CS	Schools	Health-care	Retail
<b>Energy &amp; Atmosphere</b>						
EA	Minimum Energy Performance ( <i>CedarBoards only</i> )	Req	Req	Req	Req	Req
EA 1	Optimize Energy Performance ( <i>CedarBoards only</i> )	1-19	3-21	1-19	1-24	1-19
<b>Materials &amp; Resources</b>						
MR 2	Construction Waste Management ( <i>vinyl siding only</i> )	1-2	1-2	1-2	1-2	1-2
MR 3	Sustainably Sourced Materials and Products	NA	NA	NA	1-4	NA
MR 4	Recycled Content ( <i>CedarBoards D6 only</i> )	1-2	1-2	1-2	NA	1-2
MR 5	Regional Materials ( <i>Restoration Millwork only</i> )	1-2	1-2	1-2	NA	1-2
<b>Indoor Environmental Quality</b>						
IEQ 7	Thermal Comfort ( <i>CedarBoards D6 only</i> )	NA	1	NA	1	NA
IEQ 7.1	Thermal Comfort ( <i>CedarBoards D6 only</i> )	1	NA	1	NA	1

CertainTeed is committed to product stewardship. As a part of our sustainable product development program we have conducted life cycle assessments (LCAs) of fiber cement siding products in order to provide transparency to our customers and better understand and improve our products' performance. The LCAs were submitted to BEES for third party verification and use in BEES online. Products that have a published LCA can help contribute to earning points with the NAHB National Green Building Standard and the new LEED Pilot Credit 43: Certified Products. For more information about the LCAs visit [www.certainteed.com/LCA](http://www.certainteed.com/LCA).

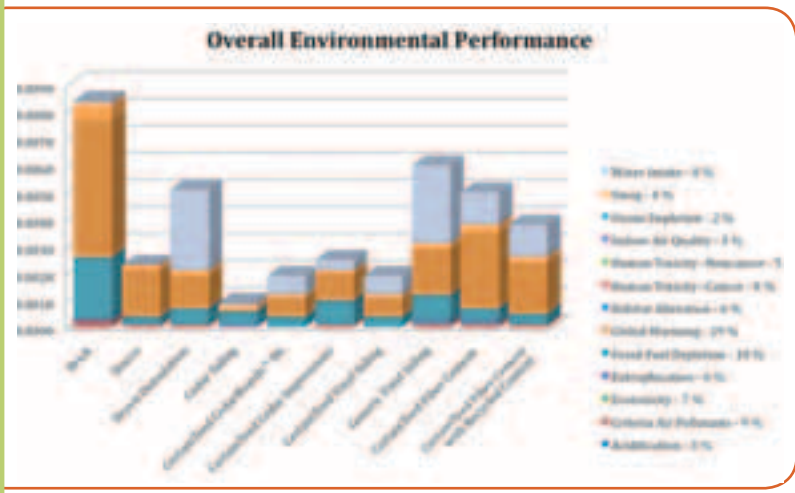

CertainTeed Polymer Shakes and Shingles, Vinyl Siding and Trim Plant Locations: Hagerstown, MD • Jackson, MI • McPherson, KS • Social Circle, GA

Exterior Products

# Understanding the role of CertainTeed Roofing in meeting Green Building Standards

CertainTeed Roofing demonstrates leadership in environmental stewardship by recycling the vast majority of internal waste created during manufacturing and also by developing new products and systems specifically designed to improve energy efficiency and reduce the environmental footprint of homes and buildings.



In 2010, CertainTeed introduced the Roofing Responsibly™ program to encourage homeowners and contractors to recycle old roof systems at the end of their useful life. We have developed a portfolio of unique, patented products and systems to meet market demand for more environmentally sensitive

and energy efficient products. Our Solaris shingle series and CoolStar commercial products feature solar reflective surfaces designed to reduce energy consumption and CO<sub>2</sub> emissions. CertainTeed has also launched a new photovoltaic roofing system and is developing a portfolio of products to address the needs of that important, growing market.



EnerGen, a photovoltaic roofing system, is structurally integrated for a sleek and seamless look.

## Green Facts

- > CertainTeed is committed to resource conservation. Our roofing manufacturing facilities recycle close to 90% of production waste into asphalt materials used for road construction. We also integrate recycled content into packaging materials like corrugated rolls and kraft paper.
- > CertainTeed diverts over 250,000 tons/year of slag, stone granules, corrugated mixed paper and sludge from landfills by recycling this material into our products.
- > In addition to reducing landfill waste, the use of recycled materials in our products reduces the release of CO<sub>2</sub> that would result from the extraction and processing of virgin raw materials.
- > CertainTeed also produces low and steep slope roofing products that help reduce energy costs and overall CO<sub>2</sub> emissions. Our ENERGY STAR-rated Solaris shingle series achieves up to 40% solar reflectance, while CoolStar and selected white Flintlastic cap products are energy efficient, ENERGY STAR-rated low slope roof solutions help lower cooling costs by reflecting the sun's rays away from the roof to reduce rooftop and attic temperatures.
- > CertainTeed Roofing launched the EnerGen photovoltaic roof system in 2010 and is developing additional PV systems to meet the growing need for responsibly designed energy generating roof systems.
- > CertainTeed is expanding its Roofing Responsibly program, which encourages homeowners and roofing contractors to have their torn-off roof systems recycled into road paving materials. For more information, visit [www.certainteed.com/roofingresponsibly](http://www.certainteed.com/roofingresponsibly).

# CertainTeed Roofing Product Contributions

Visit [www.certainteed.com/certaspec](http://www.certainteed.com/certaspec) for more details about which products qualify for these credits and full credit descriptions.

## NAHB

(NAHB: National Green Building Standard, 2008)

CREDITS	DESCRIPTION	POSSIBLE POINTS
---------	-------------	-----------------

### Lot Design, Preparation, and Development

503.4	Storm Water Management	3
-------	------------------------	---

### Resource Efficiency

602.13	Roof Surfaces	3
604.1	Recycled Content	2-4
608.1	Indigenous Materials	2

### Energy Efficiency

702.2	Energy Cost Performance Levels	30-120
703.1	Building Envelope	10-36



Note: Green text indicates qualifying CertainTeed products that have been Green Approved by the NAHB Research Center to automatically earn points for this particular credit. Landmark Solaris Gold and Platinum, Presidential Solaris, Landmark [Silver Birch shingles], all CoolStar products: 00058

## LEED-H

(LEED-H and LEED for Canada: Homes: LEED-H, 2009)

CREDITS	DESCRIPTION	POSSIBLE POINTS
---------	-------------	-----------------

### Energy & Atmosphere

EA 1	Optimize Energy Performance	1-34
------	-----------------------------	------

### Materials & Resources

MR 2.2	Environmentally Preferable Products—Local	0.5
MR 2.2	Environmentally Preferable Products—Materials	0.5
MR 3	Waste Management	0.5-3

### Sustainable Sites

SS 4.3	Management of Runoff from Roof	1
--------	--------------------------------	---

## LEED-NC, LEED-CS, LEED FOR SCHOOLS, LEED FOR HEALTHCARE AND LEED FOR RETAIL

(LEED for NC, CS, Schools, LEED for Canada: NC: LEED 2009. LEED for Healthcare: Healthcare Supplement. LEED for Retail: Retail Supplement 2009.)

CREDITS	DESCRIPTION	POSSIBLE POINTS				
		NC	CS	Schools	Health-care	Retail

### Sustainable Sites

SS 5.1	Site Development—Protect or Restore Habitat	1	1	1	1	1
SS 5.2	Site Development—Maximize Open Space	1	1	1	1	1
SS 6.1	Stormwater Design—Quantity Control	1	1	1	1	1
SS 6.2	Stormwater Design—Quality Control	1	1	1	1	1
SS 7.2	Heat Island Effect—Roof	1	1	1	1	1

### Water Efficiency

WE 1	Water Efficient Landscaping	2-4	2-4	2-4	NA	2-4
------	-----------------------------	-----	-----	-----	----	-----

### Energy & Atmosphere

EA Prereq. 2	Minimum Energy Performance	Req	Req	Req	Req	Req
EA 1	Optimize Energy Performance	1-19	3-21	1-19	1-24	1-19
EA 2	Onsite Renewable Energy	1-7	4	1-7	1-8	1-7

### Materials & Resources

MR 2	Construction Waste Management	1-2	1-2	1-2	NA	1-2
MR 3	Sustainably Sourced Materials and Products	NA	NA	NA	1-4	NA
MR 4	Recycled Content	1-2	1-2	1-2	NA	1-2
MR 5	Regional Materials	1-2	1-2	1-2	NA	1-2

### Indoor Environmental Quality

IEQ 7	Thermal Comfort	NA	1	NA	1	NA
IEQ 7.1	Thermal Comfort	1	NA	1	NA	1

## LEED-CI

(LEED CI: LEED 2009)

CREDITS	DESCRIPTION	POSSIBLE POINTS
---------	-------------	-----------------

### Sustainable Sites

SS1 Opt 2	Heat Island Effect—Roof	1
-----------	-------------------------	---

CertainTeed Roofing Plant Locations:



Avery, OH • Ennis, TX • Fremont, CA • Gads Hill, MO • Glenwood, AR • Little Rock, AR • Norwood, MA • Oxford, NC • Peachtree City, GA  
Portland, OR • Shakopee, MN • Shreveport, LA • Wilmington, CA

This glossary includes credit numbers, descriptions, explanations of the descriptions and CertainTeed products that qualify for the credits under the NAHB and LEED rating systems. This is not a comprehensive list of all credits available under these systems, only those that apply to CertainTeed products. This brochure does not cover the new Regional Priority Credits (RPCs) available in LEED Version 3 New Construction, Core & Shell, Schools and Commercial Interiors categories.

## LEED-NC/LEED for Canada: NC, LEED-CS, LEED-SCH and LEED for Retail Credit Descriptions

LEED 2009

CREDIT	CREDIT DESCRIPTION	PRODUCTS INCLUDED*
<b>Sustainable Sites</b>		
SS 5.1 Site Development—Protect or Restore Habitat	Previously developed areas or graded sites: Restore or protect a minimum of 50% of the site or 20% of the total site area with native or adapted vegetation, which may include vegetated roof surfaces.	LiveRoof
SS 5.2 Site Development—Maximize Open Space	Provide vegetated open space, which vegetated roofs can contribute to credit compliance.	LiveRoof
SS 6.1 Stormwater Design—Quantity Control	Implement a stormwater management plan that results in a 25% decrease in the volume of stormwater runoff.	LiveRoof
SS 6.2 Stormwater Design—Quality Control	Implement a stormwater management plan that reduces impervious cover, promotes infiltration and captures and treats the stormwater runoff from 90% of the average annual rainfall using acceptable best management practices.	LiveRoof
SS 7.2 Heat Island Effect—Roof	Use roofing materials on at least 75% of the roof area that have a Solar Reflectance Index (SRI) of at least 78 for a roof with a slope less than or equal to 2:12 (low-sloped) or an SRI of 29 for a roof with a slope greater than 2:12 (steep-sloped).	Low Slope CoolStar Roofing Surface, Landmark Solaris
<b>Water Efficiency</b>		
WE 1 Water Efficient Landscaping	Reduce potable water consumption for irrigation by 50%. Reductions must be attributed to any combination of plant species, irrigation efficiency, use of captured rainwater and use of recycled wastewater. Buildings without vegetation on the grounds may earn points by reducing potable water use for a vegetated roof.	LiveRoof

\*Visit [www.certainteed.com](http://www.certainteed.com) for more details about the products listed here.

# LEED-NC/LEED for Canada: NC, LEED-CS, LEED-SCH and LEED for Retail Credit Descriptions

LEED 2009

CREDIT	CREDIT DESCRIPTION	PRODUCTS INCLUDED*
<b>Energy &amp; Atmosphere</b>		
EA Prerequisite 2 Minimum Energy Performance	Establish a minimum level of building energy performance to exceed ASHRAE/IESNA Standard 90.1-2007 by 10% for new construction or 5% for major renovations to existing buildings.	DryRight Insulation with MemBrain, CertaPro Insulation, CertaSpray Foam Insulation, CertainTeed Sustainable Insulation: Batt and Roll Insulation, OPTIMA Blown In Insulation, InsulSafe SP Blown In Insulation, CertainTeed Mechanical Insulation, SoftTouch Duct Wrap, ToughGard T Duct Liner, ToughGard R Duct Liner, CrimpWrap Pipe Insulation, Low Slope CoolStar Roofing Surface, FlintBoard Insulation, CedarBoards Insulated Vinyl Siding, ThermaEZE Thermal Insulation System, T-ROC, EnergyEdge
EA 1 Optimize Energy Performance	Achieve increasing levels of building energy performance above required minimum performance standards.	CertainTeed Acoustical Ceilings, DryRight Insulation with MemBrain, CertaPro Insulation, CertaSpray Foam Insulation, CertainTeed Sustainable Insulation: Batt and Roll Insulation, OPTIMA Blown In Insulation, InsulSafe SP Blown In Insulation, CertainTeed Mechanical Insulation, SoftTouch Duct Wrap, ToughGard T Duct Liner, ToughGard R Duct Liner, CrimpWrap Pipe Insulation, Low Slope CoolStar Roofing Surface, FlintBoard Insulation, CedarBoards Insulated Vinyl Siding, ThermaEZE Thermal Insulation System, T-ROC, EnergyEdge
EA 2 On-Site Renewable Energy	Encourage and recognize increasing levels of on-site renewable energy self-supply to reduce environmental and economic impacts associated with fossil fuel energy use.	EnerGen Photovoltaic Roofing System
<b>Materials &amp; Resources</b>		
MR 2 Construction Waste Management	Recycle and/or salvage at least 50% or 75% of nonhazardous construction and demolition debris.	M2Tech Gypsum Board for Walls and Ceilings, CertainTeed Acoustical Ceilings, Asphalt Roofing Shingles, CertainTeed Vinyl Siding
MR 4 Recycled Content	Use materials with recycled content such that the sum of post-consumer recycled content plus one-half of the pre-consumer content constitutes at least 10% or 20% (based on cost) of the total value of the materials in the project.	DryRight Insulation with MemBrain, CertaPro Insulation, M2Tech Gypsum Board for Walls and Ceilings, AirRenew Gypsum Board, SilentFX Gypsum Board, Easi-Lite Gypsum Board, CertainTeed Acoustical Ceilings, Diamondback Tile Backer, SoftTouch Duct Wrap, ToughGard T Duct Liner, ToughGard R Duct Liner, CrimpWrap Pipe Insulation, FlintBoard Insulation, WeatherBoards Fiber Cement Siding, Soffit and Trim, CedarBoards Insulated Vinyl Siding, Form-A-Drain Foundation Footing System, Platon Air Gap Waterproofing Membrane, Panorama Composite Railing, EverNew LT Cellular PVC Decking
MR 5 Regional Materials	Use building materials or products that have been extracted, harvested or recovered, as well as manufactured, within 500 miles of the project site for a minimum of 10% or 20% (based on cost) or the total materials value.	GlasRoc Gypsum Products, DryRight Insulation with MemBrain, CertaPro Insulation, CertaSpray Foam Insulation, M2Tech Gypsum Board for Walls and Ceilings, CertainTeed Acoustical Ceilings, SoftTouch Duct Wrap, ToughGard T Duct Liner, ToughGard R Duct Liner, CrimpWrap Pipe Insulation, Low Slope CoolStar Roofing Surface, FlintBoard Insulation, WeatherBoards Fiber Cement Siding, Soffit and Trim, Restoration Millwork Trim, EnergyEdge
MR 6 Rapidly Renewable Materials	Use rapidly renewable building materials and products for 2.5% of the total value of all building materials and products used in the project (based on cost).	CertainTeed Acoustical Ceilings

\*Visit [www.certainteed.com](http://www.certainteed.com) for more details about the products listed here.

# LEED-NC/LEED for Canada: NC, LEED-CS, LEED-SCH and LEED for Retail Credit Descriptions

LEED 2009

CREDIT	CREDIT DESCRIPTION	PRODUCTS INCLUDED*
<b>Indoor Environmental Quality</b>		
IEQ Prerequisite 3 (LEED for Schools only) Minimum Acoustical Performance	Design classrooms and other core learning spaces to include sufficient sound-absorptive finishes for compliance with reverberation time requirements as specified in ANSI Standard S12.60-2002 and confirm that 100% of ceiling area (excluding lay-in lights, diffusers, grills) in all classrooms and core learning spaces < 20,000 cubic feet are finished with a material that has a Noise Reduction Coefficient (NRC) of 0.70 or higher. The calculation can also be of equivalent performance via a combination of ceiling and wall panels.	CertainTeed Acoustical Ceilings, SilentFX Noise-Reducing Gypsum Board, CertaPro Insulation, CertaSpray Foam Insulation, MemBrain Smart Retarder & Air Barrier Film, CertainTeed Mechanical Insulation Products
IEQ 4.6 (LEED for Schools only) Low-Emitting Materials—Ceiling and Wall Systems	Acoustical ceiling systems installed in the building interior must meet the testing and product requirements of the California Dept. of Health Services “Standard Practice for the Testing of Volatile Organic Emissions from Various Sources Using Small-scale Environmental Chambers” (incl. 2004 Addenda).	CertainTeed Acoustical Ceilings, M2Tech Gypsum Board for Walls and Ceilings, AirRenew Gypsum Board, Diamondback Tile Backer, Easi-Lite Lightweight Gypsum Board, Silent FX Noise-Reducing Gypsum Board
IEQ 7 (LEED-CS only) Thermal Comfort	Design HVAC system and building envelope to comply with the requirements of ASHRAE Standard 55-2004, “Thermal Environmental Conditions for Human Occupancy.”	DryRight Insulation with MemBrain, CertaPro Insulation, CertaSpray Foam Insulation, CertainTeed Sustainable Insulation: Batt and Roll Insulation, OPTIMA Blown In Insulation, CertainTeed Mechanical Insulation, SoftTouch Duct Wrap, ToughGard T Duct Liner, ToughGard R Duct Liner, Low Slope CoolStar Roofing Surface, FlintBoard Insulation, ThermaEZE Thermal Insulation System, T-ROC, EnergyEdge
IEQ 7.1 (LEED-NC, LEED for Schools and Retail only) Thermal Comfort	Design HVAC system and building envelope to comply with the requirements of ASHRAE Standard 55-2004, “Thermal Environmental Conditions for Human Occupancy.”	DryRight Insulation with MemBrain, CertaPro Insulation, CertaSpray Foam Insulation, CertainTeed Sustainable Insulation: Batt and Roll Insulation, OPTIMA Blown In Insulation, InsulSafe SP Blown In Insulation, CertainTeed Mechanical Insulation, SoftTouch Duct Wrap, ToughGard T Duct Liner, ToughGard R Duct Liner, Low Slope CoolStar Roofing Surface, FlintBoard Insulation, ThermaEZE Thermal Insulation System, T-ROC, EnergyEdge
IEQ 8.1 Daylight and Views—Daylight	Achieve daylighting in 75% of regularly occupied spaces, or, for schools, achieve daylighting in 75% or 90% of classroom spaces.	CertainTeed Acoustical Ceilings
IEQ 9 (LEED for Schools only) Enhanced Acoustical Performance	Design the classroom and core learning spaces to meet the Sound Transmission Class (STC) requirements of ANSI Standard S12.60-2002, “Acoustical Performance Criteria, Design Requirements and Guidelines for Schools.”	CertainTeed Acoustical Ceilings, SilentFX Noise-Reducing Gypsum Board, CertaPro Insulation, CertaSpray Foam Insulation, MemBrain Smart Retarder & Air Barrier Film, CertainTeed Mechanical Insulation products
IEQ 10 (LEED for Schools only) Mold Prevention	To reduce the potential presence of mold in schools through preventive design and construction measures. Provide HVAC systems designed to limit space relative humidity to 60% and implement an ongoing IAQ management program for the building. Material choices can play a significant role in mold prevention. Both the interior and exterior of the school will benefit from careful consideration of the building’s location and use, since some materials are more resistant to moisture buildup than others.	GlasRoc Gypsum Products

\*Visit [www.certainteed.com](http://www.certainteed.com) for more details about the products listed here.

# LEED-HC Credit Descriptions

Healthcare Supplement, 2009

CREDIT	CREDIT DESCRIPTION	PRODUCTS INCLUDED*
<b>Sustainable Sites</b>		
SS 5.1 Site Development—Protect or Restore Habitat	To conserve existing natural areas and restore damaged areas to provide habitat and promote biodiversity.	LiveRoof
SS 5.2 Site Development—Maximize Open Space	To promote biodiversity by providing a high ratio of open space to development footprint.	LiveRoof
SS 6.1 Stormwater Design—Quantity Control	To limit disruption of natural hydrology by reducing impervious cover, increasing on-site infiltration, reducing or eliminating pollution from stormwater runoff and eliminating contaminants.	LiveRoof
SS 6.2 Stormwater Design—Quality Control	To limit disruption and pollution of natural water flows by managing storm water runoff.	LiveRoof
SS 7.2 Heat Island Effect—Roof	To reduce heat islands to minimize impacts on microclimates and human/wildlife habitats.	Low Slope CoolStar Roofing Surface, Landmark Solaris, LiveRoof
<b>Energy &amp; Atmosphere</b>		
EA Prerequisite 2 Minimum Energy Performance	To establish the minimum level of energy efficiency for the proposal building and systems to reduce environmental and economic impacts associated with excessive energy use.	Low Slope CoolStar Roofing Surface, Landmark Solaris, CertainTeed Acoustical Ceiling Panels, Fiberglass Batt and Roll, Sustainable Insulation, OPTIMA Blown In Insulation, InsulSafe SP Blown In Insulation, CertainTeed Mechanical Insulation, DryRight Insulation with Membrain, CertaSpray Foam Insulation, High Temperature Blanket, ThermaEZE, T-ROC, EnergyEdge, CedarBoards Insulated Vinyl Siding, FlintBoard Insulation

\*Visit [www.certainteed.com](http://www.certainteed.com) for more details about the products listed here.

# LEED-HC Credit Descriptions

Healthcare Supplement, 2009

CREDIT	CREDIT DESCRIPTION	PRODUCTS INCLUDED*
<b>Energy &amp; Atmosphere</b>		
EA 1 Optimize Energy Performance	To achieve increasing levels of energy performance beyond the prerequisite standard to reduce environmental and economic impacts associated with excessive energy use.	Low Slope CoolStar Roofing Surface, Landmark Solaris, CertainTeed Acoustical Ceiling Panels, Fiberglass Batt and Roll, Sustainable Insulation, OPTIMA Blown In Insulation, InsulSafe SP Blown In Insulation, CertainTeed Mechanical Insulation, DryRight Insulation with Membrain, CertaSpray Foam Insulation, High Temperature Blanket, ThermaEZE, T-ROC, EnergyEdge, CedarBoards Insulated Vinyl Siding, FlintBoard Insulation
EA 2 On-Site Renewable Energy	To establish the minimum level of energy efficiency for the proposed building and systems to reduce environmental and economic impacts associated with excessive energy use.	EnerGen Photovoltaic Roofing System
<b>Materials &amp; Resources</b>		
MR 2 Construction Waste Management	To divert construction and demolition debris from disposal in landfills and incineration facilities. Redirect recyclable recovered resources back to the manufacturing process and reusable materials to appropriate sites.	ProRoc and ProRoc M2Tech Gypsum Board for Walls and Ceilings, Vinyl Siding, CertainTeed Asphalt Roofing Shingles
MR 3 Sustainably Sourced Materials and Products	To reduce the environmental burdens of materials and products acquired to construct building and to upgrade building services.	CertainTeed Acoustical Ceiling Panels, ProRoc and ProRoc M2Tech Gypsum Board for Walls and Ceilings, GlassRoc Gypsum Products, AirRenew, SilentFX, Diamondback, Fiberglass Batt and Roll Insulation, Sustainable Insulation, OPTIMA Blown In Insulation, InsulSafe SP Blown In Insulation, CertainTeed Mechanical Insulation, DryRight Insulation with Membrain, CertaSpray Foam Insulation, High Temperature Blanket, ThermaEZE, T-ROC, EnergyEdge, CedarBoards Insulated Vinyl Siding, WeatherBoards Fibercement Siding, Soffit and Trim, Form-a-Drain, Platon, Restorations Millwork, Vinyl Siding, Low Slope CoolStar Roofing Surface, FlintBoard Insulation.
<b>Indoor Environmental Quality</b>		
IEQ 2 Acoustic Environment	To provide building occupants with an indoor hearing environment free of intrusive or disruptive levels of sound.	SilentFX Gypsum Board, CertainTeed Acoustical Ceilings, CertaPro Insulation, CertaSpray Foam Insulation, MemBrain Smart Retarder & Air Barrier Film, CertainTeed Mechanical Insulation Products
IEQ 4 Low Emitting Materials	To reduce the quantity of indoor air contaminants that are odorous, irritating and/or harmful to the comfort and well-being of installers and occupants.	CertainTeed Acoustical Ceiling Panels, AirRenew, ProRoc and ProRoc M2Tech Gypsum Board for Wall and Ceilings, Diamondback, Easi-Lite LightWeight Gypsum Board, SilentFX, Fiberglass Batt and Roll Insulation, Sustainable Insulation, Metal Building Insulation 202-96, Canadian Metal Building Insulation, Commercial Blanket Insulation, CertainTeed Basement Wall Insulation, Fiberglass Insulation White PSK Faced Roll, ToughGuard Duct Board, SoftTouch Duct Wrap, ToughGuard R Duct Liner, TougGuard Rigid Liner Board, True Comfort Insulation.

\*Visit [www.certainteed.com](http://www.certainteed.com) for more details about the products listed here.



## LEED-HC Credit Descriptions

Healthcare Supplement, 2009

CREDIT	CREDIT DESCRIPTION	PRODUCTS INCLUDED*
Indoor Environmental Quality		
IEQ Credit 7: Thermal Comfort	To provide a comfortable thermal environment that supports and promotes occupant productivity and well-being and provide for the assessment of building occupant's thermal comfort over time.	Low Slope CoolStar Roofing Surface, Landmark Solaris, Fiberglass Batt and Roll, Sustainable Insulation, OPTIMA Blown In Insulation, InsulSafe SP Blown In Insulation, CertainTeed Mechanical Insulation, DryRight Insulation with MemBrain, CertaSpray Foam Insulation, High Temperature Blanket, ThermaEZE, T-ROC, EnergyEdge, CedarBoards Insulated Vinyl Siding, FlintBoard Insulation
IEQ Credit 8.1: Daylight and Views-Daylight	To provide building occupants with a connection between indoor spaces and the outdoors through the introduction of daylight and views into the regularly occupied areas of the building.	CertainTeed Acoustical Ceilings

## LEED-CI Credit Descriptions

LEED 2009

CREDIT	CREDIT DESCRIPTION	PRODUCTS INCLUDED*
Sustainable Sites		
SS 1, Option 2, Path 5 Heat Island Effect—Roof	Use roofing materials on at least 75% of the roof area that have a Solar Reflectance Index (SRI) of at least 78 for a roof with a slope less than or equal to 2:12 (low-sloped) or an SRI of 29 for a roof with a slope greater than 2:12 (steep-sloped).	Low Slope CoolStar Roofing Surface, Landmark Solaris
Energy & Atmosphere		
EA Prerequisite 2 Minimum Energy Performance	Establish minimum level of building energy efficiency per ASHRAE/IESNA Standard 90.1-2007.	DryRight Insulation with MemBrain, CertaPro Insulation, CertaSpray Foam Insulation, CertainTeed Sustainable Insulation: Batt and Roll Insulation, OPTIMA Blown In Insulation, InsulSafe SP Blown In Insulation, CertainTeed Mechanical Insulation, SoftTouch Duct Wrap, ToughGard T Duct Liner, ToughGard R Duct Liner, CrimpWrap Pipe Insulation, FlintBoard Insulation System
EA 1.1 Optimize Energy Performance—Lighting Power	Reduced connected lighting power density below that allowed by ANSI/ASHRAE/IESNA Standard 90.1-2007.	CertainTeed Acoustical Ceilings
EA 1.3 Optimize Energy Performance—HVAC	Achieve increasing levels of energy conservation above required minimum performance standards.	CertainTeed Sustainable Insulation: Batt and Roll Insulation, OPTIMA Blown In Insulation, InsulSafe SP Blown In Insulation, CertainTeed Mechanical Insulation, DryRight Insulation with MemBrain, CertaPro Insulation, CertaSpray Foam Insulation, SoftTouch Duct Wrap, ToughGard T Duct Liner, ToughGard R Duct Liner, CrimpWrap Pipe Insulation, FlintBoard Insulation Systems

\*Visit [www.certainteed.com](http://www.certainteed.com) for more details about the products listed here.

# LEED-CI Credit Descriptions

LEED 2009

CREDIT	CREDIT DESCRIPTION	PRODUCTS INCLUDED*
<b>Materials &amp; Resources</b>		
MR 2 Construction Waste Management	Recycle and/or salvage at least 50% or 75% of nonhazardous construction and demolition debris.	M2Tech Gypsum Board for Walls and Ceilings, CertainTeed Acoustical Ceilings
MR 4 Recycled Content	Use materials with recycled content such that the sum of post-consumer recycled content plus one-half of the pre-consumer content constitutes at least 10% or 20% (based on cost) of the total value of the materials in the project.	DryRight Insulation with MemBrain, CertaPro Insulation, CertaSpray Foam Insulation, M2Tech Gypsum Board for Walls and Ceilings, CertainTeed Acoustical Ceilings, SoftTouch Duct Wrap, ToughGard T Duct Liner, ToughGard R Duct Liner, CrimpWrap Pipe Insulation, Diamondback Tile Backer
MR 5 Regional Materials	Use a minimum of 20% materials and products manufactured regionally within a radius of 500 miles. Or, in addition to purchasing 20% of materials and products manufactured regionally, purchase 10% of materials and products extracted, harvested, or recovered as well as manufactured within 500 miles of the project site based on the combined value of all construction and Division 12 materials and products.	DryRight Insulation with MemBrain, CertaPro Insulation, CertaSpray Foam Insulation, M2Tech Gypsum Board for Walls and Ceilings, CertainTeed Acoustical Ceilings, SoftTouch Duct Wrap, ToughGard T Duct Liner, ToughGard R Duct Liner, CrimpWrap Pipe Insulation, GlasRoc Gypsum Products
MR 6 Rapidly Renewable Materials	Use rapidly renewable construction and Division 12 materials and products for 5% of the total value of all building materials and products used in the project (based on cost).	CertainTeed Acoustical Ceilings
<b>Indoor Environmental Quality</b>		
IEQ 7.1 Thermal Comfort	Design HVAC system and building envelope to comply with the requirements of ASHRAE Standard 55-2004, "Thermal Environmental Conditions for Human Occupancy."	CertainTeed Sustainable Insulation: Batt and Roll Insulation, OPTIMA Blown In Insulation, InsulSafe SP Blown In Insulation, CertainTeed Mechanical Insulation, DryRight Insulation with MemBrain, CertaPro Insulation, CertaSpray Foam Insulation, SoftTouch Duct Wrap, ToughGard T Duct Liner, ToughGard R Duct Liner, FlintBoard Insulation Systems
IEQ 8.1 Daylight and Views—Daylight	Achieve daylighting in 75% or 90% of regularly occupied spaces.	CertainTeed Acoustical Ceilings

\*Visit [www.certainteed.com](http://www.certainteed.com) for more details about the products listed here.

# LEED-H and LEED-H: Canada Credit Descriptions

LEED-H, 2009

CREDIT	CREDIT DESCRIPTION	PRODUCTS INCLUDED*
<b>Innovation &amp; Design</b>		
ID 2 Durability Management Process	Promote durability and high performance of the building enclosure and its components and systems through appropriate design, material selection, and construction practices.	Form-A-Drain Foundation Footing System, OPTIMA Loose Fill Fiber Glass Insulation, MemBrain Smart Vapor Retarder, InsulSafe SP Premium Blowing Wool Insulation, Platon Air Gap Waterproofing Membrane, R-13, R-19 and R-38 DryRight with MemBrain or R-38 Faced Fiber Glass Batt—Walls and Rim Joist
<b>Sustainable Sites</b>		
SS 4.3 Management of Runoff from Roof	Install a vegetated roof to cover 50% to 100% of roof area to control runoff.	LiveRoof
<b>Energy &amp; Atmosphere</b>		
EA 1 Optimize Energy Performance	Meet or exceed the performance requirements of an ENERGY STAR home.	CertainTeed Sustainable Insulation: Batt and Roll Insulation, CertainTeed Mechanical Insulation, CedarBoards Insulated Vinyl Siding, OPTIMA Loose Fill Fiber Glass Insulation, MemBrain Smart Vapor Retarder, InsulSafe SP Premium Blowing Wool Insulation, R-13, R-19 and R-38 DryRight with MemBrain or R-38 Faced Fiber Glass Batt—Walls and Rim Joist, FlintBoard Insulation Systems, ThermaEZE Thermal Insulation System, T-ROC Thermal Laminate Foundation Insulation System, EnergyEdge
EA 2 Insulation	Install above code insulation that exceeds the 2004 International Energy Conservation Code (IECC) requirements by at least 5% and meets at least Grade 1 specifications (per National Home Energy Rating Standards).	CertainTeed Sustainable Insulation: Batt and Roll Insulation, OPTIMA Loose Fill Fiber Glass Insulation, MemBrain Smart Vapor Retarder, InsulSafe SP Premium Blowing Wool Insulation, R-13, R-19 and R-38 DryRight with MemBrain or R-38 Faced Fiber Glass Batt—Walls and Rim Joist, ThermaEZE Thermal Insulation System, EnergyEdge, T-ROC Thermal Laminate Foundation Insulation System
EA 5 Heating and Cooling Distribution System	Minimize energy consumption due to thermal bridges and/or leaks in the heating and cooling distribution system.	ToughGard Duct Board, Ultra*Duct BLACK Duct Board, SoftTouch Duct Wrap, ToughGard T Duct Liner, ToughGard R Duct Liner

\*Visit [www.certainteed.com](http://www.certainteed.com) for more details about the products listed here.

# LEED-H and LEED-H: Canada Credit Descriptions

LEED-H, 2009

CREDIT	CREDIT DESCRIPTION	PRODUCTS INCLUDED*
<b>Materials &amp; Resources</b>		
MR 2.2 Environmentally Preferable Products— Materials	Use products that meet the criteria for environmentally preferable products.	CertainTeed Roofing Products, OPTIMA Loose Fill Fiber Glass Insulation, MemBrain Smart Vapor Retarder, InsulSafe SP Premium Blowing Wool Insulation, M2Tech Gypsum Board, AirRenew Gypsum Board, Diamondback Tile Backer, Panorama Composite Railing, EverNew LT Cellular PVC Decking, CertainTeed Acoustical Ceilings, R-13, R-19 and R-38 DryRight with MemBrain or R-38 Faced Fiber Glass Batt—Walls and Rim Joist, Vinyl Siding and Soffit, CedarBoards Insulated Vinyl Siding, Restoration Millwork Trim, WeatherBoards Fiber Cement Siding, Soffit and Trim, CertainTeed Mechanical Insulation products
MR 2.2 Environmentally Preferable Products— Local	Use products that are extracted, processed and manufactured within 500 miles of home.	WeatherBoards Fiber Cement Siding, Soffit and Trim, Vinyl Siding and Soffit, Restoration Millwork Trim, CedarBoards D6, DiamondBack Tilebacker Gypsum Board, Easi-Lite Lightweight Gypsum Board, OPTIMA Loose Fill Fiber Glass Insulation, MemBrain Smart Vapor Retarder, InsulSafe SP Premium Blowing Wool Insulation, M2Tech Gypsum Board, GlasRoc Gypsum Products, CertainTeed Roofing Shingles, CertainTeed Acoustical Ceilings, R-13, R-19 and R-38 DryRight with MemBrain or R-38 Faced Fiber Glass Batt—Walls and Rim Joist
MR 2.2 Environmentally Preferable Products— Emission Specifications	Use products that comply with the emission criteria for environmentally preferable products, State of California, DHS, "Standard Practice for Testing of VOCs from Various Sources Using Small-scale Chambers."	AirRenew Gypsum Board, OPTIMA Loose Fill Fiber Glass Insulation, MemBrain Smart Vapor Retarder, InsulSafe SP Premium Blowing Wool Insulation, R-13, R-19 and R-38 DryRight with MemBrain or R-38 Faced Fiber Glass Batt—Walls and Rim Joist, CertainTeed Mechanical Insulation Products
MR 3 Construction Waste Management	Reduce or divert waste generated from construction activities from landfills and incinerators to a level below the industry norm.	CertainTeed Acoustical Ceilings, Vinyl Siding, Roofing Shingles
<b>Indoor Environmental Quality</b>		
IEQ 9 Radon Protection	Design and build home with radon resistant construction techniques.	Form-A-Drain Foundation Footing System

\*Visit [www.certainteed.com](http://www.certainteed.com) for more details about the products listed here.

# NAHB Credit Descriptions

NAHB National Green Building Standard, 2008

CREDIT	CREDIT DESCRIPTION	PRODUCTS INCLUDED*
<b>Lot Design, Preparation, and Development</b>		
503.4 Storm Water Management	Storm water may be managed by having a roof that is a minimum of 75% vegetated (green roof).	LiveRoof
<b>Resource Efficiency</b>		
601.7 Site-Applied Finishing Materials	Building materials or assemblies are utilized that do not require additional site-applied material for finishing.	WeatherBoards Fiber Cement Siding (ColorMax Finishing Systems only), CedarBoards Insulated Vinyl Siding, Vinyl Siding and Soffit, Restoration Millwork Trim, Cedar Impressions Polymer Shakes and Shingles, Panorama Composite Railing, EverNew LT Cellular PVC Decking, CertainTeed Acoustical Ceilings
602.3 Foundation Drainage	Interior and exterior foundation perimeter drains are installed and drain pipe is sloped to discharge to daylight, drywell or sump pit.	Form-A-Drain Foundation Footing System
602.7 Termite Barrier	Continuous physical foundation termite barrier used with or without low toxicity treatment is installed in geographical areas that have subterranean termite infestation potential.	Platon Air Gap Waterproofing Membrane
602.8 Termite-Resistant Materials	Use termite resistant construction materials appropriate for the level of termite infestation probability as defined by the NAHB National Green Building Standard.	ThermaEZE Thermal Insulation System, T-ROC Thermal Laminate Foundation Insulation System, WeatherBoards Fiber Cement Siding, Soffit and Trim primed or prefinished, CedarBoards Insulated Vinyl Siding, Vinyl Siding and Soffit, Restoration Millwork Trim, Cedar Impressions Polymer Shakes and Shingles, Panorama Composite Railing, EverNew LT Cellular PVC Decking, EnergyEdge
602.11 Foundation Waterproofing	Enhanced foundation waterproofing is installed.	Platon Air Gap Waterproofing Membrane
602.13 Roof Surfaces	A minimum of 90% of roof surfaces are constructed of products that are (1) in accordance with the ENERGY STAR or Cool Roof Rating Council certification or equivalent, or (2) a green roof system.	CertainTeed Roofing Shingles
604.1 Recycled Content	Use recycled-content building materials for two minor and/or two major components of the building with a recycled content of 25% or greater.	Form-A-Drain Foundation Footing System, Platon Air Gap Waterproofing Membrane, WeatherBoards Siding, Soffit and Trim primed or prefinished, CedarBoards Insulated Vinyl Siding, Vinyl Siding and Soffit, Restoration Millwork Trim, Fiber Glass Batt and Roll Insulation, Sustainable Insulation, R-13, R-19 and R-38 DryRight with MemBrain or R-38 Faced Fiber Glass Batt—Walls and Rim Joist, OPTIMA Loose Fill Fiber Glass Insulation, MemBrain Smart Vapor Retarder, InsulSafe SP Premium Blowing Wool Insulation, Metal Building Insulation 202-96, Canadian Metal Building Insulation, Commercial Blanket Insulation, SoftTouch Duct Wrap, ToughGard R Duct Liner, ToughGard T Duct Liner, AcoustaBlanket Black, Universal Blanket, Commercial Board (FSK, ASJ, WMP Faced, Unfaced), OEM Acoustical Board, High Temperature Blanket, CrimpWrap Pipe Insulation, M2Tech Gypsum Board for Walls and Ceilings, Panorama Composite Railing, EverNew LT Cellular PVC Decking, CertainTeed Acoustical Ceilings

\*Visit [www.certainteed.com](http://www.certainteed.com) for more details about the products listed here.

# NAHB Credit Descriptions

NAHB National Green Building Standard, 2008

CREDIT	CREDIT DESCRIPTION	PRODUCTS INCLUDED*
<b>Resource Efficiency</b>		
605.3 Recycled Construction Materials	Construction materials such as wood, cardboard, metals, drywall, plastic, etc., are recycled offsite.	CedarBoards Insulated Vinyl Siding, Vinyl Siding and Soffit, Restoration Millwork Trim, CertainTeed Acoustical Ceilings, M2Tech Gypsum Board for Walls and Ceilings
606.3 Manufacturing Energy	Materials used for major components of the building that are manufactured using a minimum of 33% of the primary manufacturing process energy derived from renewable sources, combustible waste sources or renewable energy credits (RECs).	Panorama Composite Railing, CertainTeed Mineral Fiber Ceiling Panels
608.1 Indigenous Materials	Use indigenous materials for major elements of the building.	Form-A-Drain Foundation Footing System, Platon Air Gap Waterproofing Membrane, ThermaEZE Thermal Insulation System, T-ROC Thermal Laminate Foundation Insulation System, WeatherBoards Fiber Cement Siding, Soffit and Trim primed or prefinished, CedarBoards Insulated Vinyl Siding, Vinyl Siding and Soffit, Restoration Millwork Trim, Cedar Impressions Polymer Shakes and Shingles, R-13, R-19 and R-38 DryRight with MemBrain or R-38 Faced Fiber Glass Batt—Walls and Rim Joist, OPTIMA Loose Fill Fiber Glass Insulation, MemBrain Smart Vapor Retarder, InsulSafe SP Premium Blowing Wool Insulation, SoftTouch Duct Wrap, ToughGard T Duct Liner, CrimpWrap Pipe Insulation, CertaSpray Foam Insulation, CertainTeed Roofing Shingles, M2Tech Gypsum Board for Walls and Ceilings, Panorama Composite Railing, EverNew LT Cellular PVC Decking, CertainTeed Acoustical Ceilings, GlasRoc Gypsum Products
609.1 Life Cycle Analysis	A more environmentally preferable product or assembly is selected for an application based on the use of a Life Cycle Assessment (LCA) tool compliant with ISO14044 or other recognized standards that compare the environmental impact of building materials, assemblies, or the whole building.	WeatherBoards Fiber Cement Siding, Soffit and Trim primed or prefinished, CedarBoards Insulated Vinyl Siding, Vinyl Siding and Soffit, Cedar Impressions Polymer Shakes and Shingles, Restoration Millwork Trim, R-13, R-19 and R-38 DryRight with MemBrain or R-38 Faced Fiber Glass Batt—Walls and Rim Joist, OPTIMA Loose Fill Fiber Glass Insulation, MemBrain Smart Vapor Retarder, InsulSafe SP Premium Blowing Wool Insulation
610.1 Manufacturer's Environmental Management System Concepts	Product manufacturer's operation and business practices include environmental management system concepts, and the product facility is ISO 14001 certified or equivalent. The aggregate value of the building products from ISO 14001 certified or equivalent production facilities is 1% or more of the total estimated building materials cost.	CedarBoards Insulated Vinyl Siding, Vinyl Siding and Soffit, Restoration Millwork Trim, Cedar Impressions Polymer Shakes and Shingles, Fiber Glass Batt and Roll Insulation, Sustainable Insulation, R-13, R-19 and R-38 DryRight with MemBrain or R-38 Faced Fiber Glass Batt—Walls and Rim Joist, OPTIMA Loose Fill Fiber Glass Insulation, MemBrain Smart Vapor Retarder, InsulSafe SP Premium Blowing Wool Insulation, Metal Building Insulation 202-96, Canadian Metal Building Insulation, Commercial Blanket Insulation, SoftTouch Duct Wrap, ToughGard R Duct Liner, ToughGard T Duct Liner, AcoustaBlanket Black, Universal Blanket, Commercial Board (FSK, ASJ, WMP Faced, Unfaced), OEM Acoustical Board, High Temperature Blanket, CrimpWrap Pipe Insulation, M2Tech Gypsum Board for Walls and Ceilings
<b>Energy Efficiency</b>		
702.2 Energy Cost Performance Levels	Energy efficiency features are implemented to achieve energy cost performance that exceeds ICC IECC by 15-60%.	ThermaEZE Thermal Insulation System, T-ROC Thermal Laminate Foundation Insulation System, R-13, R-19 and R-38 DryRight with MemBrain or R-38 Faced Fiber Glass Batt—Walls and Rim Joist, OPTIMA Loose Fill Fiber Glass Insulation, MemBrain Smart Vapor Retarder, InsulSafe SP Premium Blowing Wool Insulation, SoftTouch Duct Wrap, ToughGard T Duct Liner, CrimpWrap Pipe Insulation, CertaSpray Foam Insulation, EnergyEdge

\*Visit [www.certainteed.com](http://www.certainteed.com) for more details about the products listed here.

# NAHB Credit Descriptions

NAHB National Green Building Standard, 2008

CREDIT	CREDIT DESCRIPTION	PRODUCTS INCLUDED*
<b>Energy Efficiency</b>		
703.1 Building Envelope	Total building thermal envelope UA improved by 10-20% over that required by IECC. Insulation must receive a Grade 1 rating or insulation is graded by a third party to achieve Grade 1 or 2.	ThermaEZE Thermal Insulation System, T-ROC Thermal Laminate Foundation Insulation System, R-13, R-19 and R-38 DryRight with MemBrain or R-38 Faced Fiber Glass Batt—Walls and Rim Joist, OPTIMA Loose Fill Fiber Glass Insulation, MemBrain Smart Vapor Retarder, InsulSafe SP Premium Blowing Wool Insulation, CertaSpray Foam Insulation, EnergyEdge
703.2.1 Insulation and Air Sealing	Insulation and air sealing is installed in accordance with all NAHB National Green Building Standard requirements.	R-13, R-19 and R-38 DryRight with MemBrain or R-38 Faced Fiber Glass Batt—Walls and Rim Joist, OPTIMA Loose Fill Fiber Glass Insulation, MemBrain Smart Vapor Retarder, InsulSafe SP Premium Blowing Wool Insulation, CertaSpray Foam Insulation, ThermaEZE Thermal Insulation System, T-ROC Thermal Laminate Foundation Insulation System
703.5.4.1 Water Heating Design, Equipment and Installation	Hot water lines are insulated to a minimum of R-4.	SoftTouch Duct Wrap, ToughGard T Duct Liner, CrimpWrap Pipe Insulation
704.6.2.1 Building Envelope Leakage Rate	Building envelope leakage rate demonstrated by blower door test	CertaSpray Open and Closed Cell Spray Foam Insulation
<b>Indoor Environmental Quality</b>		
901.3(1)(B) Continuous Air Barrier	A continuous air barrier is provided between the walls and ceilings separating the garage and living space	CertaSpray Open and Closed Cell Spray Foam Insulation
901.11 Insulation	Formaldehyde emissions of wall, ceiling, floor, and duct insulation materials are in accordance with CDPH 01350, as certified by a third party program, such as GREENGUARD Environmental Institute's Children & Schools Certification Program or the Scientific Certification System's Indoor Advantage Gold Program.	Fiber Glass Batt and Roll Insulation, Sustainable Insulation, R-13, R-19 and R-38 DryRight with MemBrain or R-38 Faced Fiber Glass Batt—Walls and Rim Joist, OPTIMA Loose Fill Fiber Glass Insulation, MemBrain Smart Vapor Retarder, InsulSafe SP Premium Blowing Wool Insulation, CertainTeed Mechanical Insulation
902.3 Radon Control	Radon control measures are in accordance with ICC IRC for each radon zone.	Form-A-Drain Foundation Footing System
903.3.1 Crawlspace	Use a crawlspace vapor retarder for the floors and walls.	Platon Air Gap Waterproofing Membrane
903.5.2 Plumbing	Cold water pipes in unconditioned spaces are insulated to a minimum of R-4 with pipe insulation or other covering that adequately prevents condensation.	SoftTouch Duct Wrap, ToughGard T Duct Liner, CrimpWrap Pipe Insulation
903.6 Duct Insulation	All HVAC ducts, plenums, and trunks in unconditioned attics, basements, and crawlspaces are insulated to a minimum of (1)R-6 or (2) R-8. Outdoor air supplies to ventilation systems are insulated to a minimum of (1) R-6 or (2) R-8.	SoftTouch Duct Wrap, ToughGard T Duct Liner, CrimpWrap Pipe Insulation

\*Visit [www.certainteed.com](http://www.certainteed.com) for more details about the products listed here.

*CertainTeed respects the environment through the responsible development of sustainable building products and systems.*

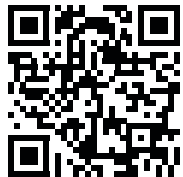

Scan the code with your smart phone to view the most up to date green information from CertainTeed. Don't have a QR Reader? Download ours for free at [certainteed.com/qr](http://certainteed.com/qr)

**ASK ABOUT ALL OF OUR OTHER CERTAINTEED® PRODUCTS AND SYSTEMS:**

ROOFING • SIDING • TRIM • DECKING • RAILING • FENCE • FOUNDATIONS  
GYPSUM • CEILINGS • INSULATION • PIPE

[www.certainteed.com](http://www.certainteed.com)    <http://blog.certainteed.com>

CertainTeed Corporation  
P.O. Box 860  
Valley Forge, PA 19482

Professional: 800-233-8990  
Consumer: 800-782-8777

© 10/11 CertainTeed Corporation  
Code No. 90-10-005

