

Garage Door Foam Panel Guide

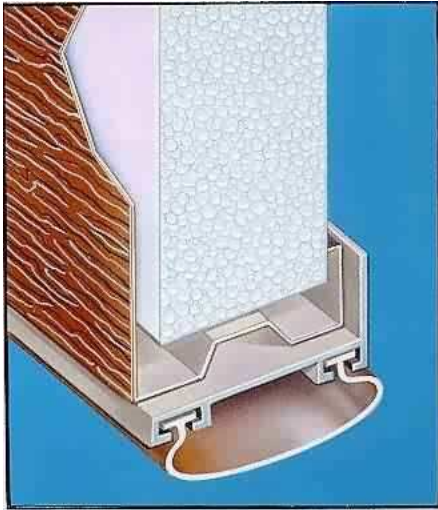

DiversiFoam Products is an industry leader with over 34 years experience producing expanded polystyrene (EPS) foam. We have a strong commitment to engineering excellence, outstanding quality and dependable customer service.

Utilizing state of the art manufacturing equipment and total quality management techniques, *DiversiFoam Products* has established itself as the reliable source for quality foam panels. Custom molded, laminated, multi-ribbed, burn routed or plain unfaced polystyrene are all manufactured to the most demanding customer specifications.

RayLite brand EPS insulation offers the highest "R" value per dollar on the market today. RayLite is a strong, lightweight, moisture resistant, CFC free closed cell foamed plastic. Molded in densities ranging from 1-2 pound per cubic foot (PCF), RayLite combines strength and insulating properties to meet specific customer applications and requirements.

Applications

Laminating

DiversiFoam Products currently laminates white high impact styrene sheeting with a haircell texture or a matte finish to expanded polystyrene panels.

The laminated panels may also be kerfed to facilitate easier installation.

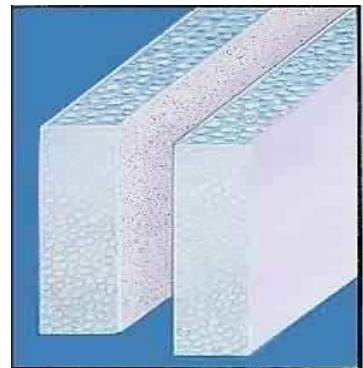

Multi Rib

Multi rib panels are a routed panel designed to fit your ribbed door pans. Routing out the panel enables a thicker insulation to be inserted into the door pan which gives a higher "R" value. Multi ribbed panels may also be laminated with white high impact styrene sheeting with a haircell texture or a matte finish

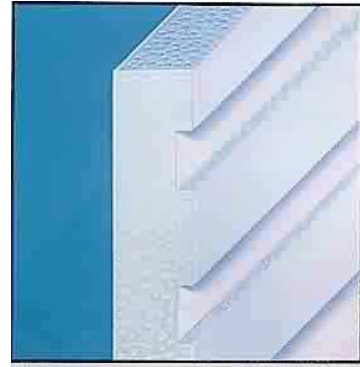

Burn Route/ Custom Molded

Burn Routed Panels

The burn route panels are a low cost foam insert that may be manufactured to specific requirements to ensure a proper fit into the raised panel door pan. The panels can be manufactured up to 18' in length and can be made in a 1.0 PCF to 2.0 PCF density expanded polystyrene.

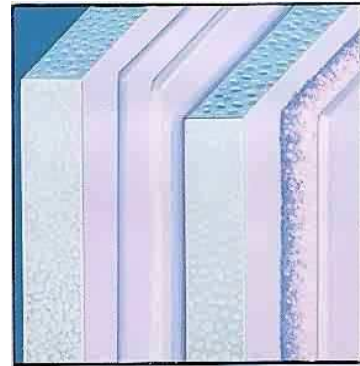

Molded Panels

Individually molded expanded polystyrene panels are the ultimate in strong, lightweight door inserts. Close dimensional tolerances on these high quality inserts can be consistently maintained to fit the exact configuration of your door pan. Structural strengths required for the foam inserts can range from 1.1 PCF to 3.0 PCF.

Corporate Headquarters
Minneapolis/St. Paul
9091 County Road 50
Rockford, MN 55373
Phone: (763) 477-5854
Fax: (763) 477-5863



Regional Office
Chicago/Milwaukee/St.
Louis
1101 Lori Lane
Mendota, IL 61342
Phone: (815) 539-3221
Fax: (815) 539-3433

E-Mail info@diversifoam.com