



Dow Building Solutions

THERMAX™ INSULATION Standing Seam Metal Roofs

The versatility, long-term durability and low maintenance of standing seam metal roofs have made them a highly popular choice in many new, retrofit and reroof applications.

Dow offers five THERMAX™ polyisocyanurate insulation products* that are ideally suited for use in standing seam metal roof applications:

- THERMAX™ Metal Building Board
- THERMAX™ Sheathing
- THERMAX™ Heavy Duty
- THERMAX™ Light Duty
- THERMAX™ White Finish

Insulating with THERMAX™ products from Dow boosts the energy performance of a metal roof, further increasing its cost effectiveness. Additional advantages of THERMAX products include:

- Outstanding thermal performance (R-6.5 at 1") – one of the highest R-values available
- Durability – robust facers enhance durability, moisture resistance and dimensional stability
- Code compliance – meets most building code requirements for foamed plastic insulation
- Exceptional fire performance – can be installed exposed to the interior without a thermal barrier
- Board lengths up to 30'
- Shiplap edges available for products thicker than 1.5"
- Ease of installation

Metal building designers and building owners will also appreciate significant savings in material and labor costs when specifying THERMAX insulation in a standing seam metal roof. The exceptional thermal performance and Class 1 rating of THERMAX products allow the use of lighter gauge decking (26 gauge instead of the typical 22 gauge), resulting in significant cost savings. Open frame designs, where the insulation boards may be left exposed, allow further design flexibility, and enhance interior aesthetics. The bright white surface of the acrylic facers (with a light reflectance of 65 percent) also contributes to reduced light energy costs.

Standard Ridge Lock Seam Roof Panels

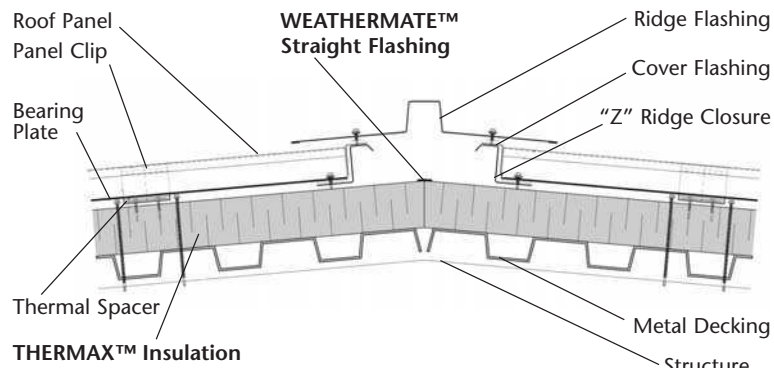

Simple Eave on Lock Seam Roof Panels or Wall Panels

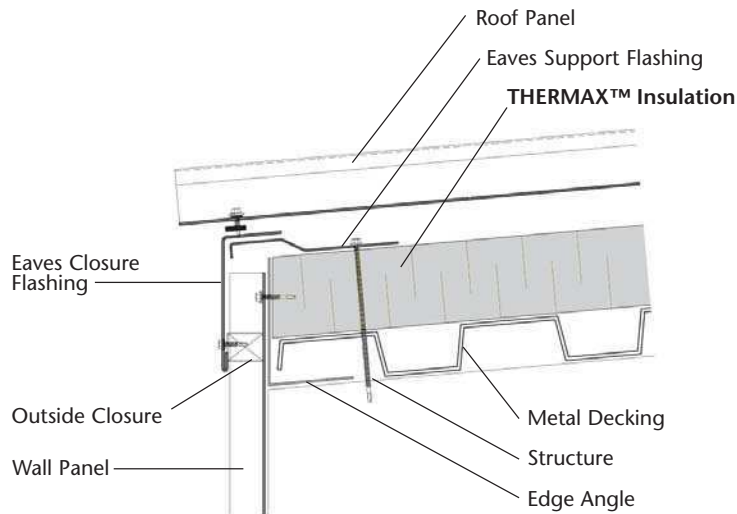

Note: These illustrations are of typical details only. Responsibility for actual design remains that of the designer.

For greater resistance to water intrusion, apply WEATHERMATE™ Straight Flashing at seams between insulation boards.

Available in 4" and 6" widths, WEATHERMATE™ Straight Flashing combines a high-density polyethylene film facer with a butyl rubber adhesive for a strong mechanical and chemical bond to insulation and other building materials.

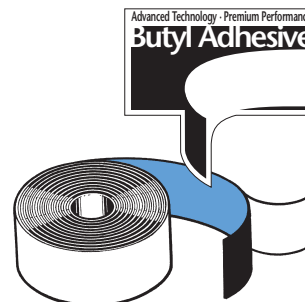

roofs

roofs

walls

slabs

foundations

Underwriters Laboratories, Inc. (UL) Approval

THERMAX™ products comply with UL Class 90 wind uplift when properly installed in an approved system. See UL Roofing Materials and Systems Directory. THERMAX products are classified by UL per ANSI/UL 1256 for “Roof Deck Constructions” (TGKX). They are tested according to UL 723 (ASTM E84) based on the Steiner Tunnel test.

Table 1 lists UL-approved SSMR assemblies incorporating THERMAX insulation.

TABLE 1

UL-Approved SSMR/THERMAX™ Assemblies		
UL Assembly	UL Assembly	UL Assembly
TGKX 26	TGKX 127	TGKX 198
TGKX 112	TGKX 130	TGKX 199
TGKX 113	TGKX 139	TGKX 227
TGKX 113A	TGKX 165	TGKX 245
TGKX 115	TGKX 178	TGKX 246
TGKX 119	TGKX 185	TGKX 354B
TGKX 126	TGKX 185A	

Note: Always check with the UL Roofing Materials and Systems Directory for the specific details of the assembly.

Factory Mutual

THERMAX™ products, in thicknesses of 4-1/4" and less, have been approved by Factory Mutual Research Corporation Standard 4880 for use as Class 1 Wall and

Ceiling panels (30' height maximum) when installed as described in the current edition of the FMRC Approval Guide.

Table 2 lists FM-approved SSMR assemblies that specify THERMAX insulation.

TABLE 2

FM-Approved SSMR/THERMAX™ Assemblies					
FM Assembly	FM Assembly	FM Assembly	FM Assembly	FM Assembly	FM Assembly
147-0-0	995-0-0	18732-0-0	29903-0-0	51532-0-0	62645-0-0
149-0-0	1134-0-0	18738-0-0	29908-0-0	51628-0-0	62646-0-0
150-0-0	1141-0-0	18739-0-0	32907-0-0	51777-0-0	62647-0-0
151-0-0	13714-0-0	18740-0-0	32916-0-0	51780-0-0	62648-0-0
152-0-0	16863-0-0	18741-0-0	32927-0-0	51785-0-0	62649-0-0
153-0-0	18447-0-0	18743-0-0	36485-0-0	51786-0-0	62650-0-0
154-0-0	18474-0-0	18744-0-0	36488-0-0	51791-0-0	62651-0-0
156-0-0	18633-0-0	18745-0-0	36489-0-0	51792-0-0	62652-0-0
157-0-0	18634-0-0	18748-0-0	36625-0-0	51794-0-0	62653-0-0
204-0-0	18635-0-0	18749-0-0	36632-0-0	51795-0-0	76679-0-0
210-0-0	18638-0-0	18751-0-0	36667-0-0	51796-0-0	137311-0-0
649-0-0	18640-0-0	18752-0-0	36759-0-0	51797-0-0	137313-0-0
650-0-0	18641-0-0	18754-0-0	36763-0-0	51800-0-0	137316-0-0
652-0-0	18642-0-0	18755-0-0	36780-0-0	51802-0-0	154922-0-0
653-0-0	18643-0-0	18812-0-0	36787-0-0	51803-0-0	156286-0-0
654-0-0	18644-0-0	18813-0-0	36790-0-0	56995-0-0	
655-0-0	18646-0-0	18814-0-0	36795-0-0	57002-0-0	
656-0-0	18647-0-0	18815-0-0	36822-0-0	57103-0-0	
657-0-0	18654-0-0	18816-0-0	36827-0-0	57107-0-0	
658-0-0	18656-0-0	18817-0-0	37064-0-0	57117-0-0	
659-0-0	18661-0-0	18818-0-0	48021-0-0	57122-0-0	
660-0-0	18663-0-0	18819-0-0	48037-0-0	57128-0-0	
661-0-0	18664-0-0	18820-0-0	48051-0-0	57163-0-0	
662-0-0	18665-0-0	18824-0-0	48348-0-0	57174-0-0	
663-0-0	18666-0-0	18825-0-0	51042-0-0	57178-0-0	
664-0-0	18667-0-0	18827-0-0	51065-0-0	57182-0-0	
697-0-0	18682-0-0	18828-0-0	51450-0-0	57184-0-0	
698-0-0	18726-0-0	18829-0-0	51460-0-0		
699-0-0	18728-0-0	20862-0-0	51481-0-0		
700-0-0	18729-0-0	29819-0-0	51488-0-0		
701-0-0	18730-0-0	29821-0-0			
702-0-0	18731-0-0	29826-0-0			

Note: Always check with the FMRC Approval Guide for specific details of the assembly. For the most up-to-date information about FM-approved roofing products and assemblies, visit www.roofnav.com

IN THE U.S.:

- For Technical Information: **1-866-583-BLUE (2583)**
- For Sales Information: **1-800-232-2436**

THE DOW CHEMICAL COMPANY

• Dow Building Solutions • 200 Larkin • Midland, MI 48674 • www.dowstyrofoam.com/architect • www.thermaxbydow.com

NOTICE: No freedom from any patent owned by Dow or others is to be inferred. Because use conditions and applicable laws may differ from one location to another and may change with time, Customer is responsible for determining whether products and the information in this document are appropriate for Customer's use and for ensuring that Customer's workplace and disposal practices are in compliance with applicable laws and other government enactments. Dow assumes no obligation or liability for the information in this document. NO WARRANTIES ARE GIVEN; ALL IMPLIED WARRANTIES OF MERCHANTABILITY OR FITNESS FOR A PARTICULAR PURPOSE ARE EXPRESSLY EXCLUDED.

THERMAX products should be used only in strict accordance with product application instructions. THERMAX products, when used in a building containing combustible materials, may contribute to the spread of fire. For more information, consult MSDS and/or call Dow at 1-866-583-BLUE (2583). In an emergency, call 1-989-636-4400.

WARNING: THERMAX insulation does not constitute a working walkable surface or qualify as a fall protection product.

Building and/or construction practices unrelated to building materials could greatly affect moisture and the potential for mold formation. No material supplier including Dow can give assurance that mold will not develop in any specific system.

