

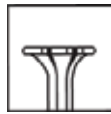

Light Gauge Metal (20-25)

Product #212A

Bugle Head Streaker USA



Bugle



Streaker



#2 Phillips

Self tapping fasteners for attaching gypsum board to 20 – 25 gauge steel in walls and ceilings.

Finish - Black/Gray Phosphate

Applications

- 1/2" and 5/8" single-layer gypsum board to steel studs and track
- 1/2" and multiple-layer gypsum board to steel studs and track
- Steel or wood cabinets through single-layer gypsum board to steel studs, 20 – 25 gauge
- OSB or plywood to 20 – 25 steel

Specifications

- Gauge – #6 to #10
- Length – 1" to 6"
- Head Type – Bugle
- Recess Type – #2 Phillips
- Thread Type – Double Lead
- Finish – Gray Phosphate
- GRABBER screws are manufactured in a ISO 9002 and ISO 14001 certified and approved factory, and are approved by ICBO ES ER #5280.

Product Features

- A fine-thread screw for general interior applications
- Ideal for use with 20 and 25 gauge steel
- 12 – 15 threads per inch
- Super sharp, 23° STREAKER Point, designed to penetrate steel quickly and easily
- #2 Phillips recess drive
- The Bugle head is designed to seat fast and easily into soft wood or drywall, creating a flush surface finish.

Installation Guidelines

- Use a standard screwgun with a depth-sensitive nose piece. Suggested screwgun specifications for optimal performance – 4 amps minimum and RPM range of 0 – 4000.
- The bugle head is fully seated when the head is flush with the work surface.
- Overdriving may result in failure of the STREAKER or stripout of the work surface.
- The STREAKER must penetrate beyond the metal a minimum of three thread pitches.

Light Gauge Metal (20-25)

Product #212A Bugle Head Streaker USA

Product Sizes and Ordering Information

Catalog No.	Gauge/Length	Length Metric	Quantity per Carton	Weight Per Carton
168A	#6x1"	25 mm	10 M	30.00(lbs)
168HLA	#6x1"	25 mm	10 M	30.00(lbs)
368A	#6x1-1/4"	32 mm	10 M	30.00(lbs)
368HLA	#6x1-1/4"	32 mm	8 M	30.00(lbs)
268A	#6x1-1/8"	28 mm	10 M	35.00(lbs)
468A	#6x1-5/8"	41 mm	5 M	24.00(lbs)
468HLA	#6x1-5/8"	41 mm	5 M	24.00(lbs)
768A7	#7x2"	51 mm	3.5 M	28.00(lbs)
968A8	#8x2-1/2"	63 mm	2.5 M	21.00(lbs)
1168A	#8x3"	76 mm	2 M	21.00(lbs)

Pull-out and Shear Test Data**

Screw Gauge	Metal Gauge	Tension (lbs.)	Shear (lbs.)
#6	20	237	557
	25	139	278
#7	20	222	817
	25	100	245
#8	20	342	785
	25	145	325

**GRABBER fasteners are not categorized as structural bolts. The figures listed above are ultimate average values achieved under independent laboratory conditions, and apply to GRABBER Line fasteners only. An appropriate safety factor must be determined by a qualified professional for design purposes.

Standard Corrosion Test Results

Finish	Test	Standard/Protocol	Results
Black/Gray Phosphate	Salt Spray Results	ASTM B117	24 hours, no red rust

Product Dimensions (millimeters)

Gauge	B Head Dia	Recess Depth	W Gauging Width	d Shank Dia	d1 Minor Dia	d2 Major Dia	TPI
#6	8.00	0.50	#2	2.68	2.27	3.45	15
	8.50	0.80		2.72	2.42	3.58	
#7	8.00	0.50	#2	2.93	2.40	3.75	15
	8.50	0.80		2.97	2.55	3.90	
#8	8.00	0.50	#2	3.18	2.80	4.08	15
	8.50	0.80		3.22	3.00	4.20	
#10	8.50	0.50	#2	3.78	3.20	4.75	12
	8.90	0.80		3.82	3.40	4.95	

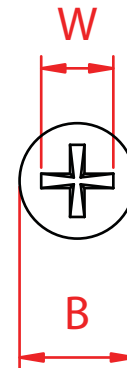
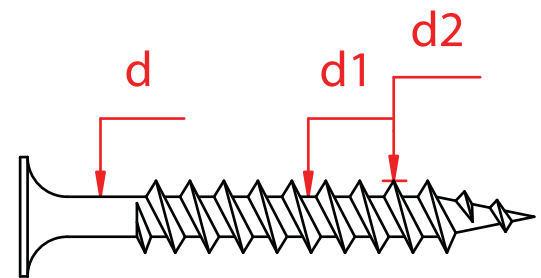

All GRABBER® screw products are manufactured in facilities that are ISO 9002 and ISO 1401 certified and approved. The fasteners comply with SAE J78 and ASTM C1002 or C954, as referenced in ICBO report ER-5280, and are approved for use by the Uniform Building Code. ©2008 John Wagner Associates, Inc. GRABBER®, STREAKER®, DRIVALL®, LOX®, GRABBERGARD® and SCAVENGER® are registered names or trademarks by John Wagner Associates, Inc.,

Distributed by:



205 Mason Circle
Concord, CA 94520
1.800.477.TURN