



The National Roofing Contractors Association (NRCA) is providing construction details as examples of quality installations for the specific roof or waterproofing material or system within BuildSite's Product Category listing in which you are searching.

The roof system construction details are from The NRCA Roofing Manual series, which was launched in 2007. The volumes in the series are *The NRCA Roofing Manual: Membrane Roof Systems—2007*, *The NRCA Roofing Manual: Metal Panel and SPF Roof Systems—2008*, *The NRCA Roofing Manual: Steep-slope Roof Systems—2009* and *The NRCA Roofing Manual: Sheet Metal Flashing, Moisture Control and Reroofing—2010*.

The waterproofing details are from *The NRCA Waterproofing Manual, 2005 Edition*. In publishing The NRCA Roofing Manual series, NRCA made the decision to no longer include the waterproofing section that was previously included in *The NRCA Roofing and Waterproofing Manual, Fifth Edition* (2001). Instead, the waterproofing section was updated and issued as a separate publication.

Additional information about roofing and waterproofing can be found on NRCA's Web site, [www.nrca.net](http://www.nrca.net), or by calling NRCA at (847) 299-9070.

National Roofing Contractors Association  
10255 W. Higgins Road, Suite 600  
Rosemont, IL 60018  
(847) 299-9070  
Fax: (847) 299-1183  
[www.nrca.net](http://www.nrca.net)  
[www.professionalroofing.net](http://www.professionalroofing.net)

#### NRCA Construction Details—EPDM Roof Systems

|         |   |
|---------|---|
| EPDM-1  | Base Flashing At Parapet Wall With Metal Cap (Coping)               |
| EPDM-3  | Embedded Edge Metal Flashing (Gravel Stop)                          |
| EPDM-4  | Base Flashing With Surface-mounted Counterflashing At Concrete Wall |
| EPDM-19 | Plumbing Vent (Premanufactured Boot)                                |
| EPDM-22 | Roof Drain  |

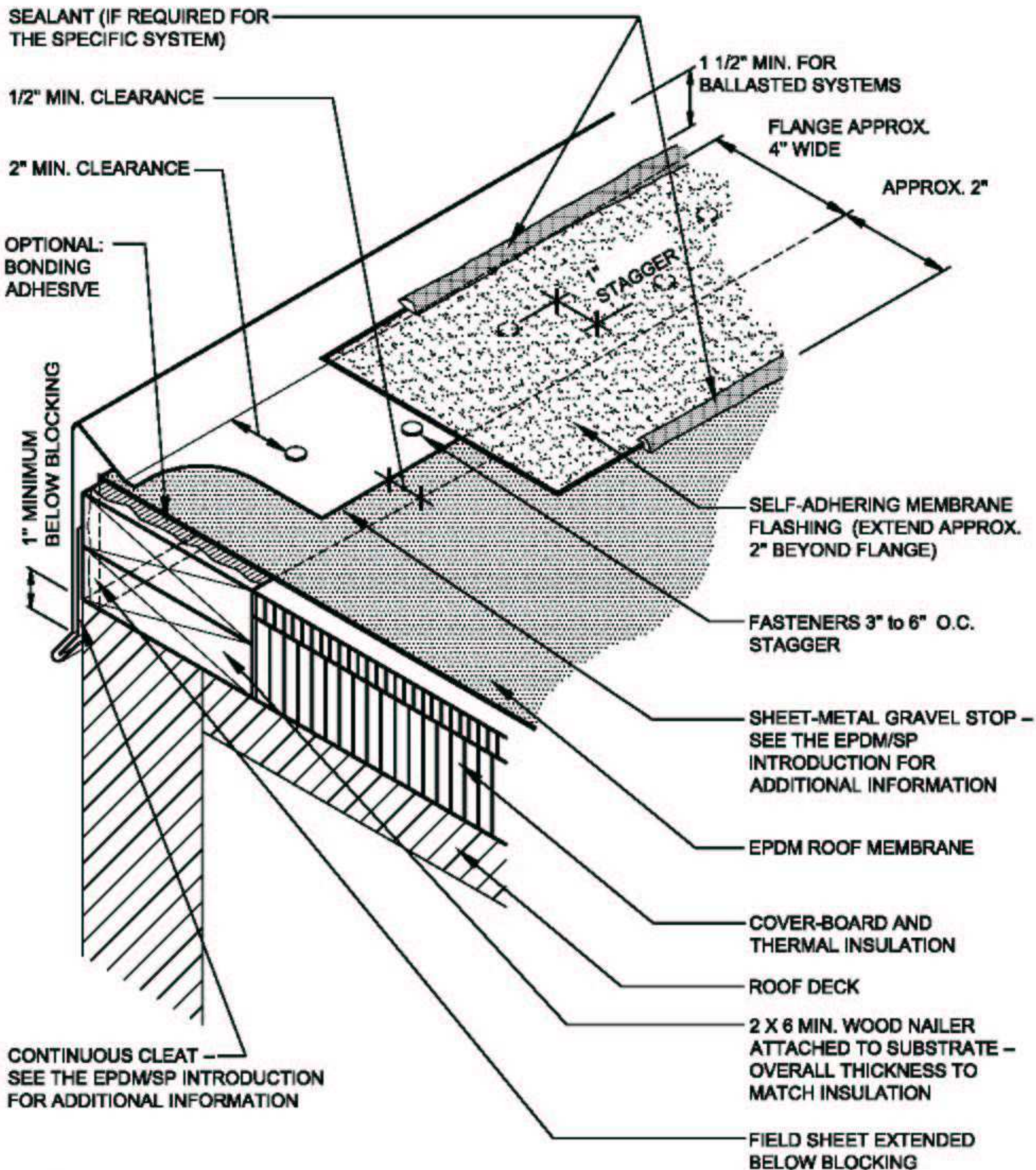

**NOTES:**

1. THIS DETAIL SHOULD BE USED ONLY WHERE THE DECK IS SUPPORTED BY THE OUTSIDE WALL.
2. REFER TO THE ARCHITECTURAL SHEET METAL SECTION OF THE NRCA ROOFING AND WATERPROOFING MANUAL FOR JOINERY AND SECUREMENT OPTIONS FOR SHEET METAL.
3. REFER TO THE EPDM/SP INTRODUCTION FOR ADDITIONAL INFORMATION.



**EMBEDDED EDGE METAL FLASHING  
(GRAVEL STOP)**

2007

NOT DRAWN TO SCALE

EPDM-3