



The National Roofing Contractors Association (NRCA) is providing construction details as examples of quality installations for the specific roof or waterproofing material or system within BuildSite's Product Category listing in which you are searching.

The roof system construction details are from The NRCA Roofing Manual series, which was launched in 2007. The volumes in the series are *The NRCA Roofing Manual: Membrane Roof Systems—2007*, *The NRCA Roofing Manual: Metal Panel and SPF Roof Systems—2008*, *The NRCA Roofing Manual: Steep-slope Roof Systems—2009* and *The NRCA Roofing Manual: Sheet Metal Flashing, Moisture Control and Reroofing—2010*.

The waterproofing details are from *The NRCA Waterproofing Manual, 2005 Edition*. In publishing The NRCA Roofing Manual series, NRCA made the decision to no longer include the waterproofing section that was previously included in *The NRCA Roofing and Waterproofing Manual, Fifth Edition* (2001). Instead, the waterproofing section was updated and issued as a separate publication.

Additional information about roofing and waterproofing can be found on NRCA's Web site, [www.nrca.net](http://www.nrca.net), or by calling NRCA at (847) 299-9070.

National Roofing Contractors Association  
10255 W. Higgins Road, Suite 600  
Rosemont, IL 60018  
(847) 299-9070  
Fax: (847) 299-1183  
[www.nrca.net](http://www.nrca.net)  
[www.professionalroofing.net](http://www.professionalroofing.net)

#### NRCA Construction Details—Built-up Roof Systems

BUR-1	Mop- or Cold-applied Base Flashing At Parapet Wall With Metal Cap (Coping)
BUR-3	Flashing At Embedded Edge Metal (Gravel Stop)
BUR-4	Base Flashing With Surface-mounted Counterflashing At Concrete Wall
BUR-19	Plumbing Vent
BUR-22	Roof Drain

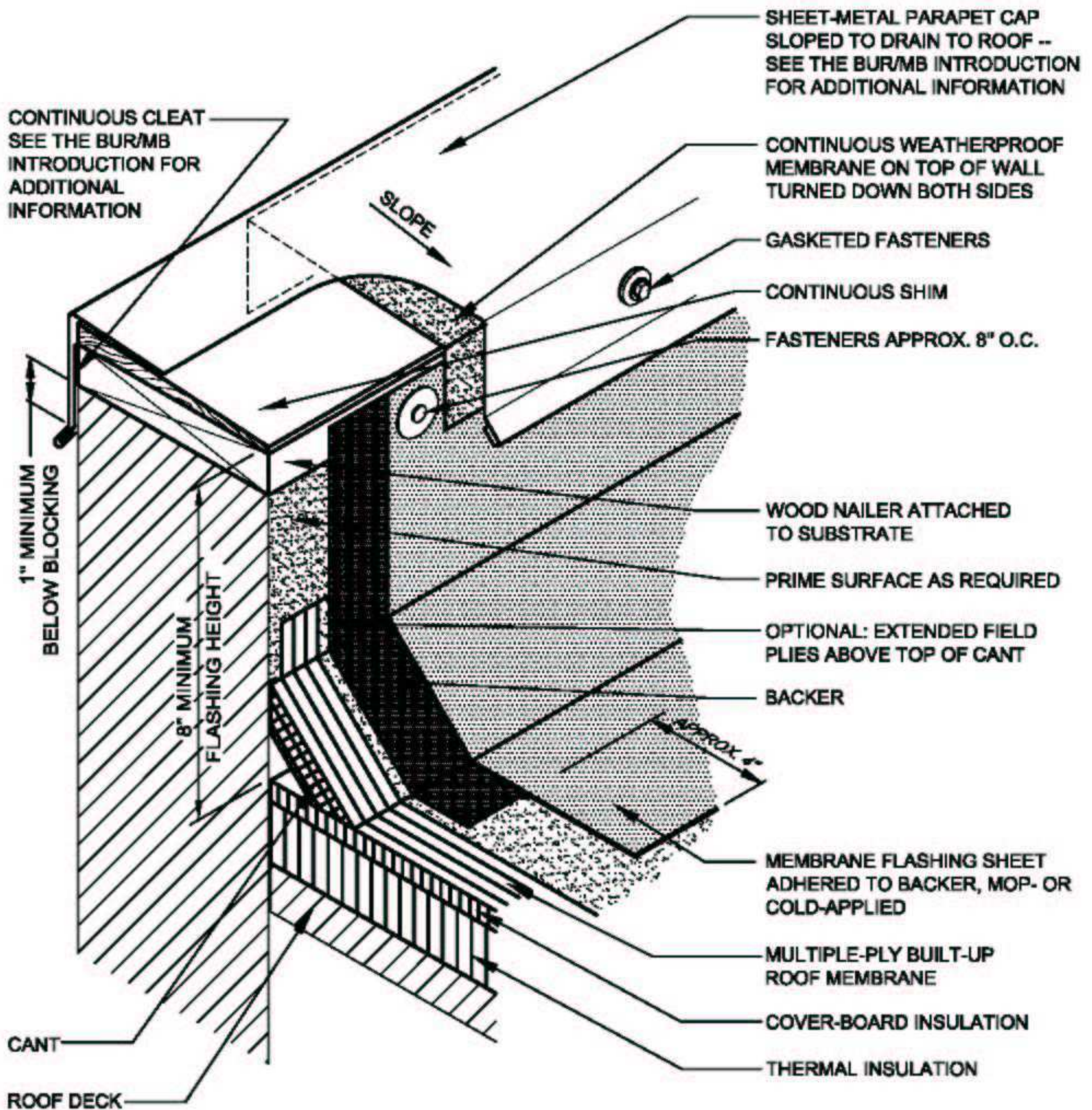

**NOTES:**

1. THIS DETAIL SHOULD BE USED ONLY WHEN THE ROOF DECK IS SUPPORTED BY THE WALL. DETAIL BUR-6 SHOULD BE USED FOR NONWALL-SUPPORTED DECK.
2. IN LIEU OF EXTENDED BASE FLASHING, INSTALL CONTINUOUS SHEET MEMBRANE LINER.
3. REFER TO THE ARCHITECTURAL SHEET METAL SECTION OF THE NRCA ROOFING AND WATERPROOFING MANUAL FOR JOINERY AND SECUREMENT OPTIONS FOR SHEET METAL.
4. REFER TO THE BUR/MB INTRODUCTION FOR ADDITIONAL INFORMATION.



**NATIONAL  
ROOFING  
CONTRACTORS  
ASSOCIATION**

**MOP- OR COLD-APPLIED BASE FLASHING AT  
PARAPET WALL WITH METAL CAP (COPING)**

2007

NOT DRAWN TO SCALE

**BUR-1**