



The National Roofing Contractors Association (NRCA) is providing construction details as examples of quality installations for the specific roof or waterproofing material or system within BuildSite's Product Category listing in which you are searching.

The roof system construction details are from The NRCA Roofing Manual series, which was launched in 2007. The volumes in the series are *The NRCA Roofing Manual: Membrane Roof Systems—2007*, *The NRCA Roofing Manual: Metal Panel and SPF Roof Systems—2008*, *The NRCA Roofing Manual: Steep-slope Roof Systems—2009* and *The NRCA Roofing Manual: Sheet Metal Flashing, Moisture Control and Reroofing—2010*.

The waterproofing details are from *The NRCA Waterproofing Manual, 2005 Edition*. In publishing The NRCA Roofing Manual series, NRCA made the decision to no longer include the waterproofing section that was previously included in *The NRCA Roofing and Waterproofing Manual, Fifth Edition* (2001). Instead, the waterproofing section was updated and issued as a separate publication.

Additional information about roofing and waterproofing can be found on NRCA's Web site, [www.nrca.net](http://www.nrca.net), or by calling NRCA at (847) 299-9070.

National Roofing Contractors Association  
10255 W. Higgins Road, Suite 600  
Rosemont, IL 60018  
(847) 299-9070  
Fax: (847) 299-1183  
[www.nrca.net](http://www.nrca.net)  
[www.professionalroofing.net](http://www.professionalroofing.net)

#### NRCA Construction Details—Single-ply Roof Systems

SP-1	Base Flashing At Parapet Wall With Metal Cap (Coping)
SP-3	Embedded Edge Metal Flashing (Gravel Stop)
SP-4	Base Flashing With Surface-mounted Counterflashing At Concrete Wall
SP-19	Plumbing Vent (Premanufactured Boot)
SP-22	Roof Drain



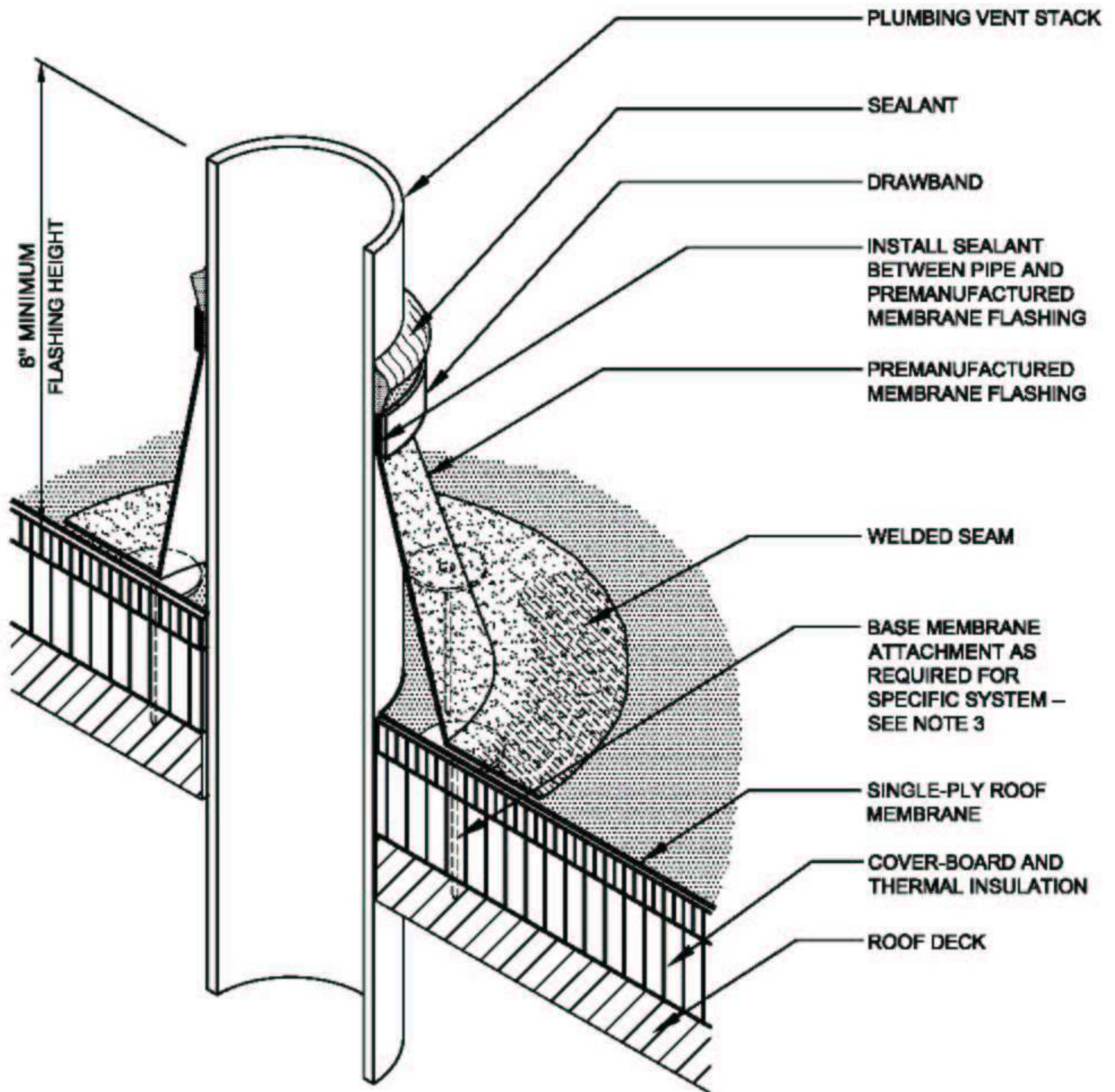

**NOTES:**

1. VENT STACKS AND OTHER PIPES SHOULD HAVE A MINIMUM OF 12 INCHES OF CLEARANCE ON ALL SIDES FROM WALLS, CURBS AND OTHER PROJECTIONS TO FACILITATE PROPER FLASHING. SEE THE INTRODUCTION TO THE CONSTRUCTION DETAILS FOR ADDITIONAL INFORMATION.
2. NRCA RECOMMENDS FLASHINGS BE 8 INCHES HIGH; HOWEVER, NRCA IS AWARE THAT PREMANUFACTURED BOOT FLASHINGS GENERALLY WILL NOT MEET THE HEIGHT REQUIREMENT.
3. REFER TO MANUFACTURERS' SPECIFICATIONS FOR SPECIFIC REQUIREMENTS FOR BASE MEMBRANE ATTACHMENT AND PLACEMENT. MECHANICALLY ATTACHED SYSTEMS AND PIPES LARGER THAN 18 INCHES GENERALLY REQUIRE BASE MEMBRANE ATTACHMENT.
4. REFER TO THE EPDM/SP INTRODUCTION FOR ADDITIONAL INFORMATION.



**PLUMBING VENT  
(PREMANUFACTURED BOOT)**

2007

NOT DRAWN TO SCALE

**SP-19**