

# PCZ/EPCZ

## Post Caps

PCZ/EPCZ post caps are designed with their post and beam flanges in-line so that one PCZ/EPCZ model can accommodate several post sizes. The PCZ/EPCZ now uses easier-to-install 10d common nails. An alternate choice of fasteners is Strong-Drive® #9 x 1½" SD Connector screws. ZMAX® finish is standard to meet exposure conditions in many environments. See additional corrosion information at [strongtie.com/info](http://strongtie.com/info).

**Material:** 16 gauge

**Finish:** ZMAX coating

**Installation:**

- Use all specified fasteners; see General Notes
- Do not install bolts into pilot holes

**Options:**

- For end conditions, specify EPCZ post caps
- For heavy-duty applications, see CCQ and CC Series
- For retrofit applications, see AC and LCE Series

**Codes:** See p. 14 for Code Reference Key Chart

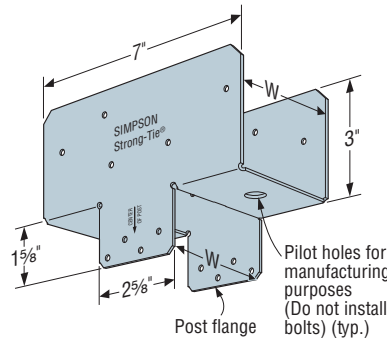

PCZ

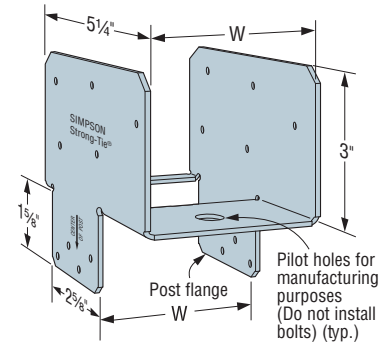

EPCZ

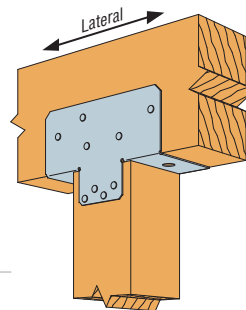

Typical PCZ Post Cap Installation

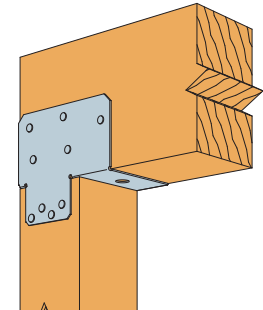

Typical EPCZ End Post Cap Installation

These products are available with additional corrosion protection. For more information, see p. 18.

These products are approved for installation with the Strong-Drive® SD Connector screw. See pp. 39–40 for more information.

Model No.7	W (in.)	Fasteners <sup>5,6</sup>		Post Size	Allowable Loads (DF/SP)				Code Ref.
		Beam	Post		PCZ		EPCZ		
					Uplift (160)	Lateral (160)	Uplift (160)	Lateral (160)	
PC4Z	3¾	(10) 10d	(8) 10d	(2) 2x4 <sup>4</sup>	1,480	1,120	1,130	895	I12, L4, FL
				4x4	1,480	1,260	1,130	1,075	
				4x6	1,480	1,260	1,130	1,230	
				4x8	1,480	1,380	1,130	1,230	
PC6Z	5½	(10) 10d	(8) 10d	4x6	1,480	1,260	1,435	1,075	
				6x6	1,480	1,295	1,435	1,230	
				6x8	1,480	1,380	1,435	1,230	
PC8Z	7½	(10) 10d	(8) 10d	4x8	1,480	1,260	1,435	1,075	
				6x8	1,480	1,295	1,435	1,230	
				8x8	1,480	1,380	1,435	1,230	

1. Allowable loads have increased for wind or earthquake with no further increase allowed; reduce where other loads govern.
2. Uplift loads do not apply to spliced conditions. Spliced conditions must be detailed by the Designer to transfer tension loads between spliced members by means other than the post cap.
3. Structural composite lumber columns have sides that show either the wide face or the edges of the lumber strands/veneers. Values in the tables reflect installation into the wide face and do not allow for installation into the narrow face.
4. Post and beam may consist of multiple members provided they are connected independently of the post cap fasteners.
5. 10d x 2½" (0.148" dia. x 2½" long) nails may be used with no load reduction for uplift and 0.85 of the table loads for lateral.
6. Strong-Drive® SD9 x 1½" Connector screws may be substituted for table fasteners with no load reduction.
7. Models available for rough size lumber, specify RZ suffix. Ex. PC4RZ.
8. **Nails:** 10d = 0.148" dia. x 3" long. See pp. 26–27 for other nail sizes and information.  
**Screws:** SD9112 = 0.131" dia. x 1½" long.

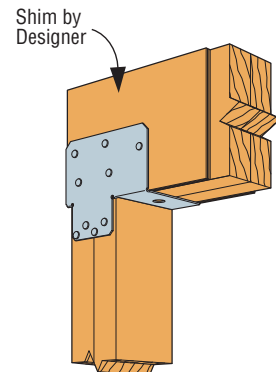

EPCZ Post Cap Installed on Double 2x Members

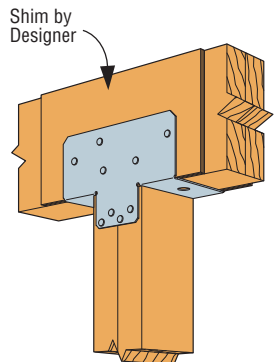

PCZ Post Cap Installed on Double 2x Members