

LMRH-101

Digital Lighting Management

Digital IR Handheld Remote

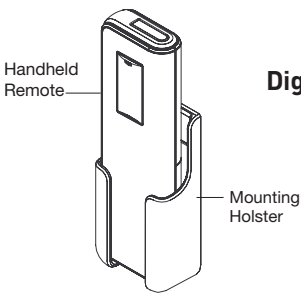

SPECIFICATIONS

Power Supply. 3 AAA batteries, 1.5V alkaline or NiMH rechargeable
Environment:

- Operating Temperature 32° to 95°F (0° to 35°C)
- Storage Temperature 23 to 176°F (-5° to 80°C)
- Relative Humidity 5 to 95% (non condensing)

Other:

- RoHS compliant, 5-year warranty
- FCC part 15

This device complies with Part 15 of the FCC Rules. Operation is subject to the following two conditions: (1) this device may not cause harmful interference, and (2) this device must accept any interference received, including interference that may cause undesired operation.

UNIT DESCRIPTION

The WattStopper LMRH-101 Digital IR Handheld Remote uses an infrared (IR) transmitter to send commands to a Digital Lighting Management (DLM) network. It allows the user to turn lights ON/OFF and dim without going to a wall box device.

The LMRH-101 operates on three AAA batteries. It communicates wirelessly with other DLM devices by sending an IR signal to a DLM IR enabled device within its range and line of sight.

Battery Installation

The battery compartment holds three standard 1.5V AAA Alkaline batteries (supplied). Rechargeable NiMH batteries can be used. Do not mix battery types. Do not mix old batteries with new batteries.

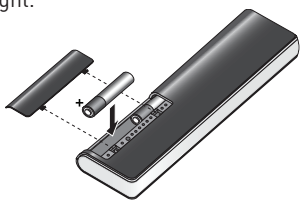

OPERATION

The LMRH-101 uses IR technology to wirelessly send control signals to the DLM system. Point the handheld remote at any IR enabled DLM device within its range and press a button to send signals to the DLM network. To identify an IR enabled device, look for a dark translucent lens on the face of the device.

Transmitting range

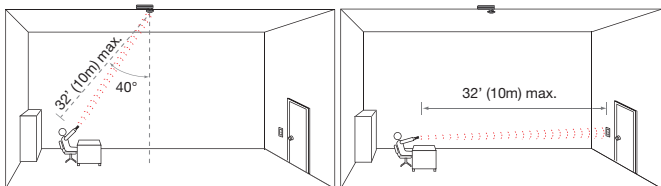

Default Functionality: Plug n' Go™ (PnG)

As shipped from the factory, the rocker paddle controls all loads on the DLM local network. To change the loads that are controlled by the LMRH-101 see UNIT ADJUSTMENT.

Button Functions

Press the top of the rocker paddle to turn load(s) ON. The blue LED on the paddle also turns ON. Switched loads turn ON. Dimmable loads turn ON to the last light level set before they turned OFF. Press the bottom of the rocker paddle to turn load(s) OFF.

- Single tap: Bound loads turn ON to last light level
- Press and hold: Raise light level
- Single tap: Bound loads OFF
- Press and hold: Lower light level

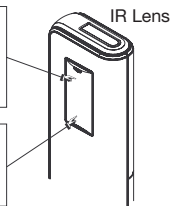

Dimmable loads ramp down or up in response to pressing and holding the top or bottom of the paddle. ON/OFF loads turn OFF when the ramp level dims below 50% and turn ON when the ramp level rises above 50%.

Battery Life

To conserve battery life, the LMRH-101 shuts down 5 seconds after the last key press unless the LMRH-101 and the DLM local network is in configuration mode (Push n' Learn, PnL).

UNIT ADJUSTMENT

A “configuration” button allows access to the WattStopper Push n’ Learn™ technology to change the operation of the LMRH-101.

Step 1: Enter Push n’ Learn (PnL)

- Locate the configuration button inside the LMRH-101 battery compartment.
- Point the LMRH-101 at a DLM IR device.
- Press and hold the configuration button until the red LED in the battery compartment begins blinking (approximately 3 seconds), then release the button. Make sure the LMRH-101’s red LED continues to blink, then observe the following:
 - The Red LEDs on all other DLM devices on the network start blinking rapidly (2x/second). The LEDs continue to blink until you exit PnL.
 - All loads on the DLM local network turn OFF immediately after entering PnL. After 1 second, load 1 turns ON.

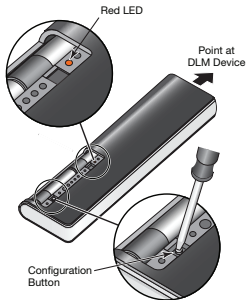

Step 2: Load Selection

A quick press on the LMRH-101’s configuration button turns OFF load 1 then turns on the next load in sequence. Keep pressing the configuration button to step through all the loads connected to the DLM local network. When a load turns ON the blue LED is lit brightly on all switch buttons and sensors bound to the load.

- To bind the load to the LMRH-101: While the load is ON press the paddle making sure that the blue LED turns ON brightly.
- To unbind a load: While the load is ON and the blue LED is brightly lit, press the paddle. The LED goes dim to indicate the paddle on the handheld remote no longer controls this load.
- A quick press on the configuration button turns ON the next load.
- Repeat until the paddle is bound to all the loads you want it to control.

Note: more than one load can be assigned to the paddle and a load can be assigned to multiple devices in the DLM network.

Step 3: Exit Push n’ Learn (PnL)

- Point the LMRH-101 at a DLM IR device.
- Press and hold the LMRH-101 configuration button until the red LED in the battery compartment stops blinking (approximately 3 seconds), then release the button.

RESET PROCESS

Load binding reset - To clear the unit so that it is not bound to any load:

1. Do not point the LMRH-101 toward any DLM IR enabled device.
2. Press and hold the configuration button in the battery compartment until the red LED goes solid ON (approximately 10 seconds).

Device reset - To get the unit back to its default Plug n' Go state (bind to all loads):

1. Do not point the LMRH-101 toward any DLM IR enabled device.
2. Press and hold the configuration button in the battery compartment for 20 seconds.

System Reset - This reset returns ALL DLM devices to their factory default PnG settings. All system settings will be reset; all customized binding relationships will be lost. All PnG functionality will be restored. To return all devices on the DLM local network to PnG using the LMRH-101:

1. Point the LMRH-101 at an IR enabled DLM local network device.
2. Press and hold the configuration button in the battery compartment until the red LED starts blinking to put the DLM local network into PnL (see Step 1 in UNIT ADJUSTMENT for details). Release the button.
3. Press and hold the configuration button again for approximately 20 seconds, until the red LED on the DLM devices resume blinking rapidly (approximately 2x/second).

TROUBLESHOOTING

LED on the remote doesn't light	Press the button. If the LED doesn't light: <ul style="list-style-type: none">• Check to see if the LED is actually lit, but very dim. This is normal. Press the top of the button to fully turn ON the LED.• Check batteries. Replace if needed.• Remove the batteries for 5 minutes. After 5 minutes, reinstall the batteries and try again.
--	--

A Group brand

WattStopper[®]

2800 De La Cruz Boulevard, Santa Clara, CA 95050
Technical Support: 800.879.8585 • www.wattstopper.com
12512r2 7/2010

Please
Recycle

