

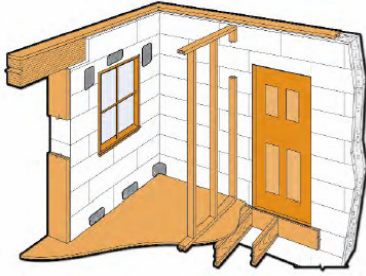

GRAPPLER™

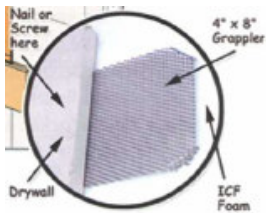

Where to place the Grappler



Where and When to install



Magnified View



Comes in buckets of 50
Or boxes of 90

Quick and easy to install, the 4"x 8" mesh Grappler is pushed onto the foam wall before the drywall is installed. When it is between the drywall and the foam, it becomes a locking washer with 175 pounds per



screw of holding power. The holding power of the Grappler exceeds that of many common drywall anchors.

The Grappler is less labor intensive and more finished than other methods. With the Grappler, no pre-drilling is necessary. Most screws or finishing nails pilot a hole into the open weave mesh and lock into place, securing fixtures such as thermostats, smoke detectors and towel bars. And, if a mistake is made, the screws can be easily backed out with no major holes to repair.

Product Applications:

- *Decorative Wall Hangings
- *Bathroom Accessories
- *Smoke Detectors
- *Bulletin Boards
- *Picture Frames
- *Curtain Rods
- *Doorbells
- *Brackets

Product Features:

- * Installed in seconds
- * No pre-drilling necessary
- * Replaces plastic plugs and toggles
- * Easily located behind drywall with common stud finder
- * Screws can be backed out without major holes to repair in the drywall



1055 Leiscz's Bridge Road • Leesport, PA 19533
610-926-6815 • 1-800-872-5625 • Fax: 1-800-854-6614
www.wind-lock.com