

PowerDrain - S200K 4-Bolt Ductile Iron Grate

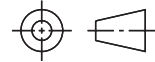

S200K 4-Bolt Ductile Iron Grate
part no. 99591



Top

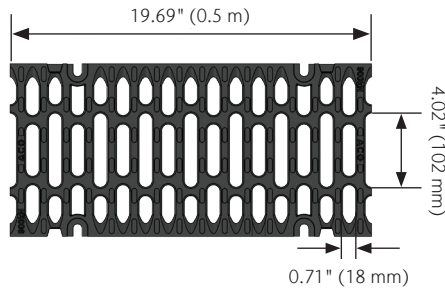

Side



Front

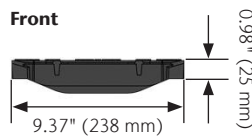

'4-Bolt' Locking Mechanism

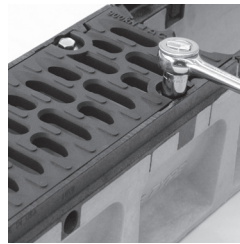

ACO offers a 4-bolt locking solution for applications requiring more security. The four threaded stainless steel inserts in the PowerDrain channel body allow a 4-bolt grate to be bolted into the channel for ultimate stiffness and security. Tamper resistant bolts can also be used.

Product Features

- Certified to EN 1433 Load Class F - 202,328 lbs - 3,481 psi
- Uses '4-Bolt' locking system
- Suitable for channels: S200K, H200SK-13, HD200 Access, HD200 Outlet
- Manufactured from ductile iron to ASTM A536 - Grade 80-55-06
- Recesses for anti-shunt lugs

Parts

Parts	Part No.	Length in (mm)	Width in (mm)	Weight lbs
S200K '4-Bolt' Ductile Iron Grate	99591	19.69 (500)	9.37 (238)	26.5

Specifications

General

The surface drainage system shall be ACO PowerDrain or SlabDrain, complete with ACO 4 Bolt iron grate with '4-bolt' locking as manufactured by ACO, Inc. or similar approved.

Materials

The covers shall be manufactured from ductile iron and have minimum properties as follows:

- Independently certified to meet Load Class F to EN 1433 - 202,328 lbs - 3,481 psi.
- Ductile iron to ASTM A536 - Grade 80-55-06.
- Intake area of 459.98 cm² per ½ meter of grate.

The overall width of 9.37" (238 mm) and overall length of 19.69" (500 mm). Slots measure at a maximum of 0.791" (18.03 mm).

Grates

Grate is ductile iron. Ductile iron ASTM A536 - Grade 80-55-06. After removal of the grates there shall be uninterrupted access to the trench to aid maintenance. Grates can be used for PowerDrain or SlabDrain.

Bolts

m10-1.5 x 30 Hex Flange Bolts 18-8 Stainless Steel to be manufactured in the USA. Pull-Out test results available upon request.

Installation

The trench drain system and grates shall be installed in accordance with the manufacturer's installation instructions and recommendations.



Bicycle Safe



200,000 lbs limit



EN 1433 Load Class F
202,328 lbs - 3,481 psi

ACO, Inc.

West Sales Office
825 W. Beechcraft Street
Casa Grande, AZ 85122
Tel: (520) 421-9988
Toll-Free: (888) 490-9552
Fax: (520) 421-9899

Northeast Sales Office
9470 Pinecone Drive
Mentor, OH 44060
Tel: (440) 639-7230
Toll-Free: (800) 543-4764
Fax: (440) 639-7235

Southeast Sales Office
4211 Pleasant Road
Fort Mill, SC 29708
Toll-Free: (800) 543-4764
Fax: (803) 802-1063

info@acousa.com
www.acousa.com

© June 2021 ACO, Inc.

All reasonable care has been taken in compiling the information in this document. All recommendations and suggestions on the use of ACO products are made without guarantee since the conditions of use are beyond the control of the company. It is the customer's responsibility to ensure that each product is fit for its intended purpose and that the actual conditions of use are suitable. ACO, Inc. reserves the right to change products and specifications without notice.

ACO. creating
the future of drainage

