

Roof Access Hatches, Smoke Vents *and Accessories*



Ladder Access
Ship Stair
Service Stair
Equipment Hatch
Security Hatch
Electric Actuation Roof Hatch
Poly-Dome Hatch
UL Smoke Vent
Smoke Vent Double Hatch
Safety Rails
Ladders

RHG GALVANIZED LADDER ACCESS ROOF HATCH

Application

Acudor Ladder Access Roof Hatches are designed to provide convenient, economical access to the roof of a building

Features RHG

- Weather tight construction
- Convenient one-hand operation
- 12" high insulated curb
- Supports 40lbs./sq. ft. live load
- G90 Galv. Steel
- Stainless Steel Hardware

Optional Features RHG

- Stainless Steel cover, curb
- Polycarbonate domes for daylighting
- Louvered Curbs
- Curb Mounted Units
- Curb pitch corrected for sloped roof
- Higher curb heights for "green roof" applications

RHG Specifications:

Cover: Double-skin construction ("in box type design") with 1" Polyiso (R-6) insulation and a continuous EPDM foam weather/draft seal gasket that is attached to the inside of cover to provide a flush, tight fit. Designed to support a live load of 40lbs./sq. ft., the cover is 14 gauge galvanized steel with a 22 gauge galvanized steel inside liner.

Curb: 14 gauge galvanized steel with 1" thick Polyiso (R-6) insulation with Fiberglass liner at curb exterior. Curb is 12" high, with 3.375" wide bottom flange and pre-drilled mounting holes.

Hinge: Heavy duty galvanized steel pintle hinges with 3/8" SS pin

Opening: Gas spring operators allow cover to open and close with ease. Stainless Steel inside pull handle allows for easy control when closing cover.

Door Latch: Self latching, zinc plated outside T handle with stainless steel inside lock and lever assembly. Heavy duty detention lock with paracentric key. Unit also has inside and outside padlock provisions.

Finish: Material is prepared with an iron phosphate wash, followed by a rust inhibiting primer, and then a baked on polyester enamel paint.



RHG STANDARD SIZES (other sizes available)

Model	Curb ID W&L inches (mm)	Weight per Hatch lbs. (kg.)
G3232	24 x 24 (610 x 610)	125 (56.8)
G3238	24 x 30 (610 x 762)	130 (58.9)
G3244	24 X 36 (610 X 914)	135 (61.4)
G3838	30 x 30 (762 x 762)	140 (63.5)
G3844	30 x 36 (762 x 914)	155 (70.5)
G4444	36 x 36 (914 x 914)	170 (77.3)

For detailed specifications see submittal sheet

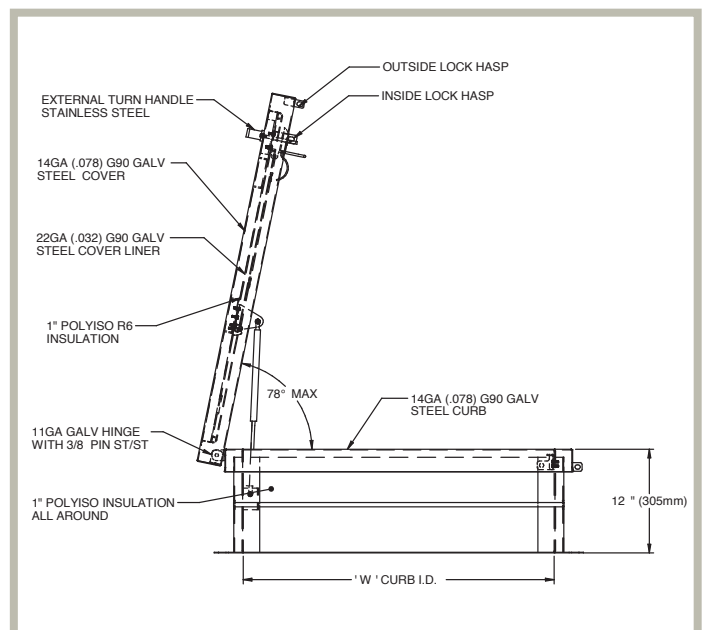



RHA ALUMINUM LADDER ACCESS ROOF HATCH

Application

Acudor Ladder Access Roof Hatches are designed to provide convenient, economical access to the roof of a building

Features RHA

- Weather tight construction
- Convenient one-hand operation
- 12" high insulated curb
- Supports 40lbs./sq. ft. live load
- Stainless Steel Hardware

Optional Features RHA

- Painted and Anodized finishes
- Polycarbonate domes for daylighting
- Louvered Curbs
- Curb Mounted Units
- Curb pitch corrected for sloped roof
- Higher curb heights for "green roof" applications

RHA Specifications:

Cover: Double-skin construction ("in box type design") with 1" Polyiso (R-6) insulation and a continuous EPDM foam weather/draft seal gasket that is attached to the inside of cover to provide a flush, tight fit. Designed to support a live load of 40lbs./sq. ft., the cover is 11 gauge aluminum with a 20 gauge aluminum inside liner.

Curb: 11 gauge aluminum with 1" thick Polyiso (R-6) insulation at curb exterior. Curb is 12" high, with 3.375" wide bottom flange and pre-drilled mounting holes.

Hinge: Heavy duty Aluminum pintle hinges with 3/8" SS pin

Opening: Gas spring operators allow cover to open and close with ease. Stainless Steel Inside pull handle allows for easy control when closing cover.

Door Latch: Self latching, Stainless steel outside T handle with stainless steel inside lock and lever assembly. Unit also has inside and outside padlock provisions.

Finish: Mill finish.



RHA STANDARD SIZES (other sizes available)

Model	Curb ID W&L	Weight per Hatch
	inches (mm)	lbs. (kg.)
A3232	24 x 24 (610 x 610)	60 (27.3)
A3238	24 x 30 (610 x 762)	65 (29.4)
A3244	24 X 36 (610 X 914)	70 (31.8)
A3838	30 x 30 (762 x 762)	75 (34.0)
A3844	30 x 36 (762 x 914)	85 (38.6)
A4444	36 x 36 (914 x 914)	95 (43.2)

For detailed specifications see submittal sheet

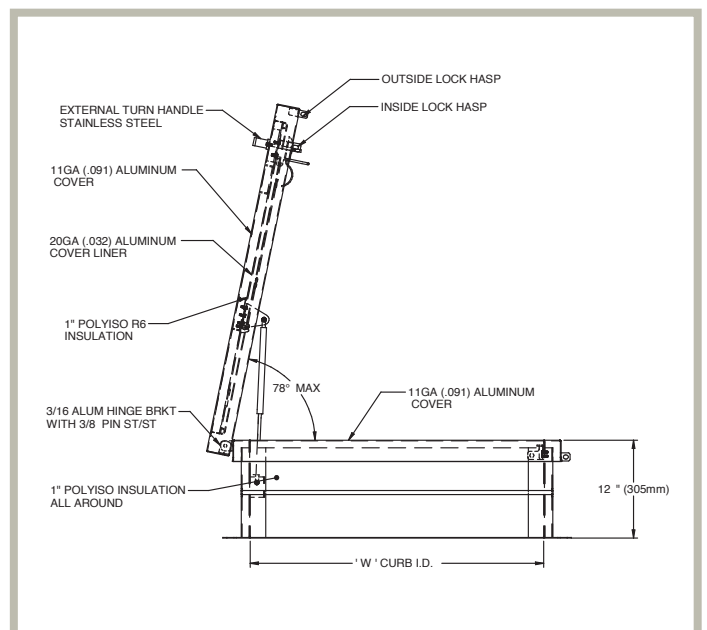

RHG GALVANIZED SHIP STAIR ACCESS ROOF HATCH

Application

Acudor Ship Stair Roof Hatches are designed to provide convenient, economical access to the roof of a building for maintenance.

Features RHG

- Weather tight construction
- Convenient one-hand operation
- 12" high insulated curb
- Supports 40lbs./sq. ft. live load
- G90 Galv. Steel
- Stainless Steel Hardware

Optional Features RHG

- Stainless Steel cover, curb
- Polycarbonate domes for daylighting
- Louvered Curbs
- Curb Mounted Units
- Curb pitch corrected for sloped roof
- Higher curb heights for "green roof" applications

RHG Specifications:

Cover: Double-skin construction ("in box type design") with 1" Polyiso (R-6) insulation and a continuous EPDM foam weather/draft seal gasket that is attached to the inside of cover to provide a flush, tight fit. Designed to support a live load of 40lbs./sq. ft., the cover is 14 gauge galvanized steel with a 22 gauge galvanized steel inside liner.

Curb: 14 gauge galvanized steel with 1" thick Polyiso (R-6) insulation with Fiberglass liner at curb exterior. Curb is 12" high, with 3.375" wide bottom flange and pre-drilled mounting holes.

Hinge: Heavy duty galvanized steel pintle hinges with 3/8" SS pin

Opening: Gas spring operators allow cover to open and close with ease. Stainless Steel inside pull handle allows for easy control when closing cover.

Door Latch: Self latching, zinc plated outside T handle with stainless steel inside lock and lever assembly. Heavy duty detention lock with paracentric key. Unit also has inside and outside padlock provisions.

Finish: Material is prepared with an iron phosphate wash, followed by a rust inhibiting primer, and then a baked on polyester enamel paint.



RHG STANDARD SIZES (other sizes available)

Model	Curb ID W&L	Weight per Hatch
	inches (mm)	lbs. (kg.)
G3862	30 x 54 (762 x 1372)	225 (102.3)

For detailed specifications see submittal sheet

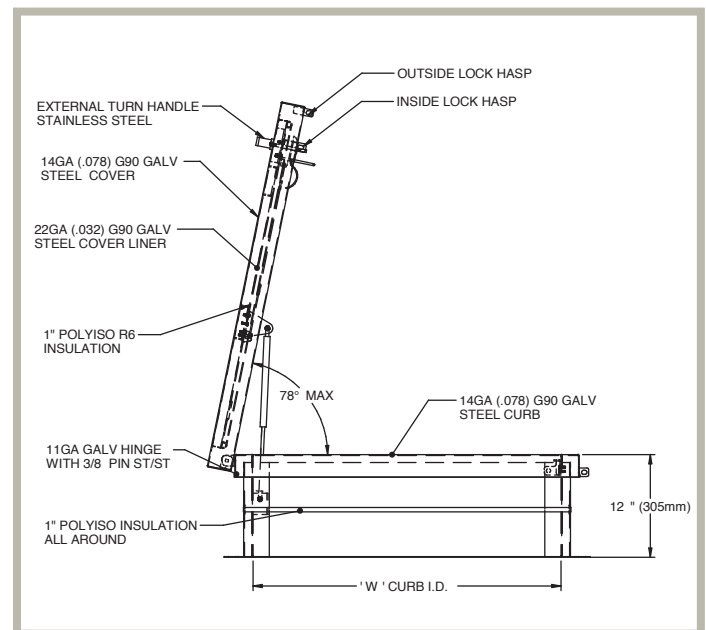

RHA ALUMINUM SHIP STAIR ACCESS ROOF HATCH

Application

Acudor Ship Stair Roof Hatches are designed to provide convenient, economical access to the roof of a building for maintenance.

Features RHA

- Weather tight construction
- Convenient one-hand operation
- 12" high insulated curb
- Supports 40lbs./sq. ft. live load
- Stainless Steel Hardware

Optional Features RHA

- Painted and Anodized finishes
- Curb Mounted Units
- Louvered Curbs
- Polycarbonate domes for daylighting
- Curb pitch corrected for sloped roof
- Higher curb heights for "green roof" applications

RHA Specifications:

Cover: Double-skin construction ("in box type design") with 1" Polyiso (R-6) insulation and a continuous EPDM foam weather/draft seal gasket that is attached to the inside of cover to provide a flush, tight fit. Designed to support a live load of 40lbs./sq. ft., the cover is 10 gauge aluminum with a 20 gauge aluminum inside liner.

Curb: 10 gauge aluminum with 1" thick Polyiso (R-6) insulation at curb exterior. Curb is 12" high, with 3.375" wide bottom flange and pre-drilled mounting holes.

Hinge: Heavy duty Aluminum pintle hinges with 3/8" SS pin

Opening: Gas spring operators allow cover to open and close with ease. Stainless Steel Inside pull handle allows for easy control when closing cover.

Door Latch: Self latching, Stainless steel outside T handle with stainless steel inside lock and lever assembly. Unit also has inside and outside padlock provisions.

Finish: Mill finish.



RHA STANDARD SIZES (other sizes available)

Model	Curb ID W&L inches (mm)	Weight per Hatch lbs. (kg.)
A3862	30 x 54 (762 x 1372)	135 (61.4)

For detailed specifications see submittal sheet

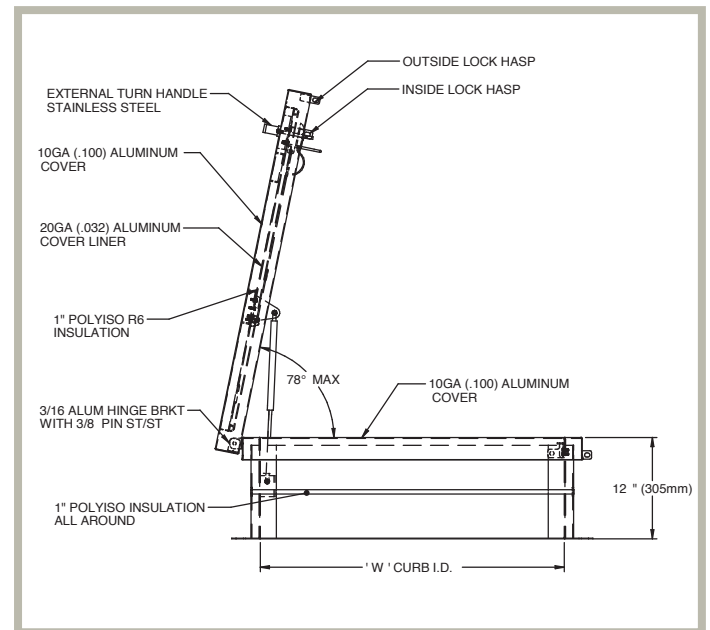

RHG GALVANIZED SERVICE STAIR ACCESS ROOF HATCH

Application

Acudor Service Stair Roof Hatches are designed to provide convenient, economical access to the roof of a building from a full size staircase to perform maintenance.

Features RHG

- Weather tight construction
- Convenient one-hand operation
- 12" high insulated curb
- Supports 40lbs./sq. ft. live load
- G90 Galv. Steel
- Stainless Steel Hardware

Optional Features RHG

- Stainless Steel cover, curb
- Louvered Curbs
- Curb Mounted Units
- Polycarbonate domes for daylighting
- Curb pitch corrected for sloped roof
- Higher curb heights for "green roof" applications

RHG Specifications:

Cover: Double-skin construction ("in box type design") with 1" Polyiso (R-6) insulation and a continuous EPDM foam weather/draft seal gasket that is attached to the inside of cover to provide a flush, tight fit. Designed to support a live load of 40lbs./sq. ft., the cover is 14 gauge galvanized steel with a 20 gauge aluminum inside liner.

Curb: 14 gauge galvanized steel with 1" thick Polyiso (R-6) insulation with Fiberglass liner at curb exterior. Curb is 12" high, with 3.375" wide bottom flange and pre-drilled mounting holes.

Hinge: Heavy duty galvanized steel pintle hinges with 3/8" SS pin

Opening: Gas spring operators allow cover to open and close with ease.

Stainless Steel inside pull handle allows for easy control when closing cover.

Door Latch: Self latching, Stainless Steel outside T handle with inside lock and lever assembly. Unit also has inside and outside padlock provisions.

Finish: Material is prepared with an iron phosphate wash, followed by a rust inhibiting primer, and then a baked on polyester enamel grey paint.

RHG STANDARD SIZES (other sizes available)

Model	Curb ID W&L inches (mm)	Weight per Hatch lbs. (kg.)
G38104	30 x 96 (762 x 2438)	335 (152.3)

For detailed specifications see submittal sheet

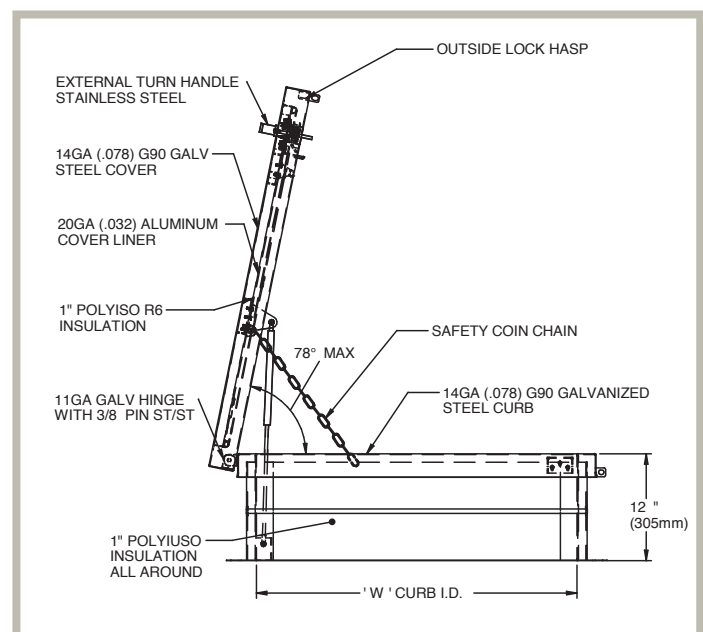
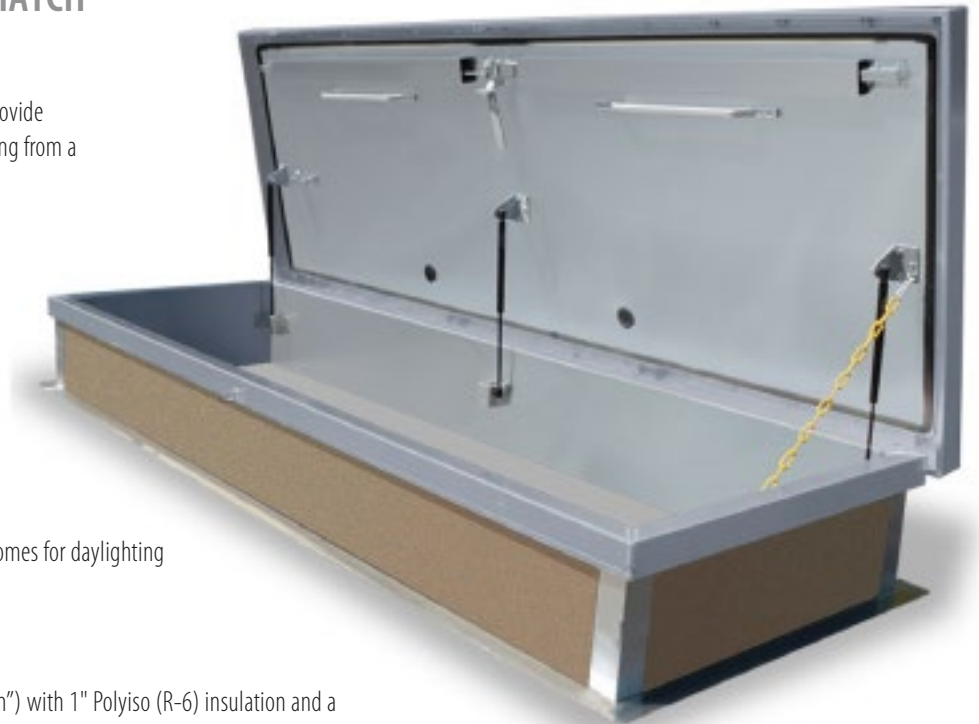

RHA ALUMINUM SERVICE STAIR ACCESS ROOF HATCH

Application

Acudor Service Stair Roof Hatches are designed to provide convenient, economical access to the roof of a building from a full size staircase to perform maintenance.

Features RHA

- Weather tight construction
- Convenient one-hand operation
- 12" high insulated curb
- Supports 40lbs./sq. ft. live load
- Stainless Steel Hardware

Optional Features RHA

- Painted and Anodized finishes
- Louvered Curbs
- Curb Mounted Units
- Polycarbonate domes for daylighting
- Curb pitch corrected for sloped roof
- Higher curb heights for "green roof" applications

RHA Specifications:

Cover: Double-skin construction ("in box type design") with 1" Polyiso (R-6) insulation and a continuous EPDM foam weather/draft seal gasket that is attached to the inside of cover to provide a flush, tight fit. Designed to support a live load of 40lbs./sq. ft., the cover is 1/8" aluminum with a 20 gauge aluminum inside liner.

Curb: 1/8" thick aluminum with 1" thick Polyiso (R-6) insulation at curb exterior. Curb is 12" high, with 3.375" wide bottom flange and pre-drilled mounting holes.

Hinge: Heavy duty Aluminum pintle hinges with 3/8" SS pin

Opening: Gas spring operators allow cover to open and close with ease.
Stainless Steel inside pull handle allows for easy control when closing cover.

Door Latch: Self latching, Stainless Steel outside T handle with inside lock and lever assembly. Unit also has inside and outside padlock provisions.

Finish: Mill finish

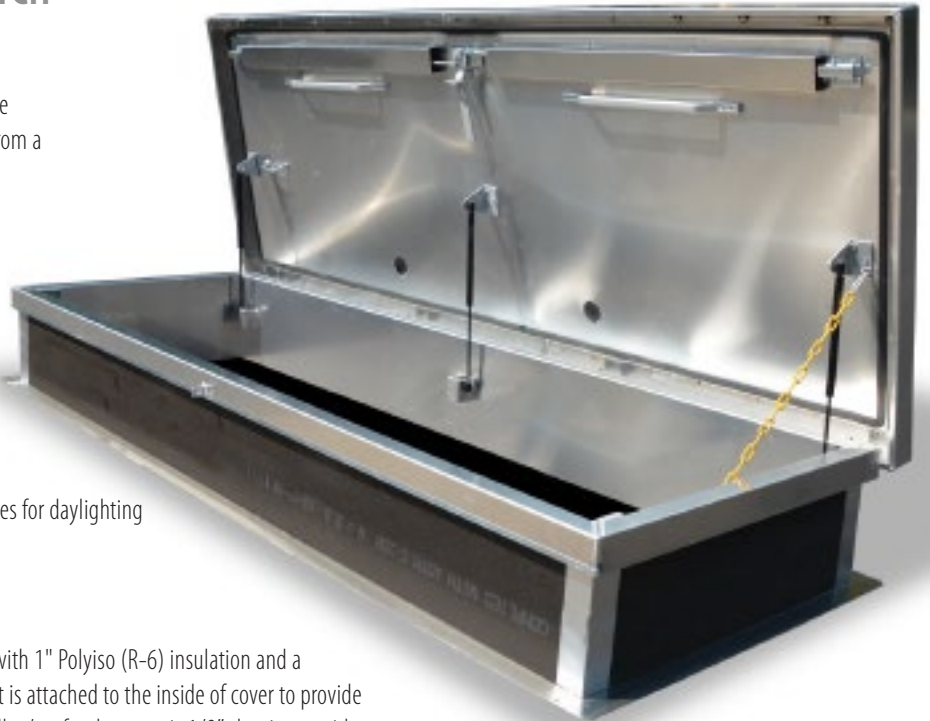

RHA STANDARD SIZES (other sizes available)

Model	Curb ID W&L inches (mm)	Weight per Hatch lbs. (kg.)
A38104	30 x 96 (762 x 2438)	245 (111.4)

For detailed specifications see submittal sheet

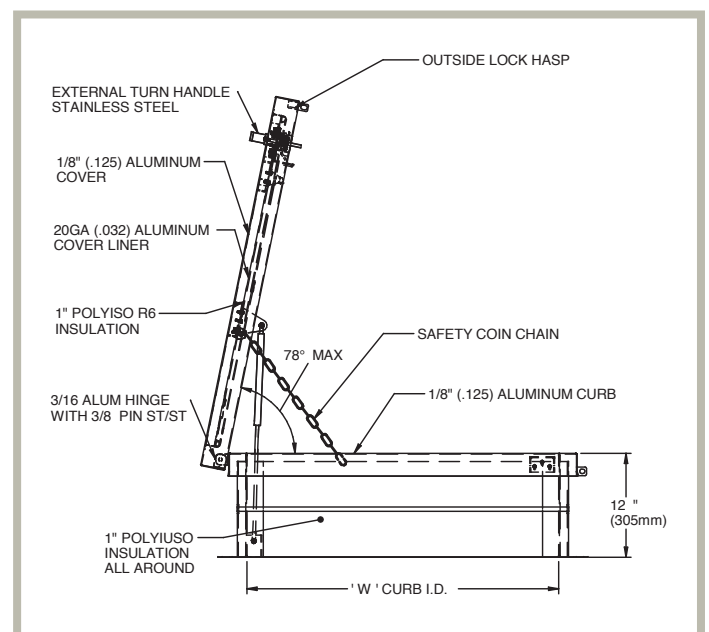

RHG GALVANIZED EQUIPMENT ACCESS ROOF HATCH

Application

Acudor Equipment Access Roof Hatches are designed to provide convenient, economical access to the roof of a building where larger openings are required. This opening allows for equipment to be installed or removed from a building through the roof.

Features RHG

- Weather tight construction
- 12" high insulated curb
- G90 Galv. Steel
- Convenient one-hand operation
- Supports 40lbs./sq. ft. live load
- Stainless Steel Hardware

Optional Features RHG

- Stainless Steel cover, curb
- Louvered Curbs
- Curb pitch corrected for sloped roof
- Higher curb heights for "green roof" applications
- Polycarbonate domes for daylighting
- Curb Mounted Units

RHG Specifications:

Cover: Double-skin construction ("in box type design") with 1" Polyiso (R-6) insulation and a continuous EPDM foam weather/draft seal gasket that is attached to the inside of cover to provide a flush, tight fit. Designed to support a live load of 40lbs./sq. ft., the cover is 14 gauge galvanized steel with a 22 gauge galvanized steel inside liner.

Curb: 14 gauge galvanized steel with 1" thick Polyiso (R-6) insulation with Fiberglass liner at curb exterior. Curb is 12" high, with 3.375" wide bottom flange and pre-drilled mounting holes.

Hinge: Heavy duty galvanized steel pintle hinges with 3/8" SS pin

Opening: Gas spring operators allow cover to open and close with ease. Stainless Steel inside pull handle allows for easy control when closing cover.

Door Latch: Self latching, Stainless Steel outside T handle with stainless steel inside lock and lever assembly. Unit also has inside and outside padlock provisions.

Finish: Material is prepared with an iron phosphate wash, followed by a rust inhibiting primer, and then a baked on polyester enamel grey paint.



RHG STANDARD SIZES (other sizes available)

Model	Curb ID W&L inches (mm)	Weight per Hatch lbs. (kg.)
G5656	48 x 48 (1219 x 1219)	185 (84.0)

For detailed specifications see submittal sheet

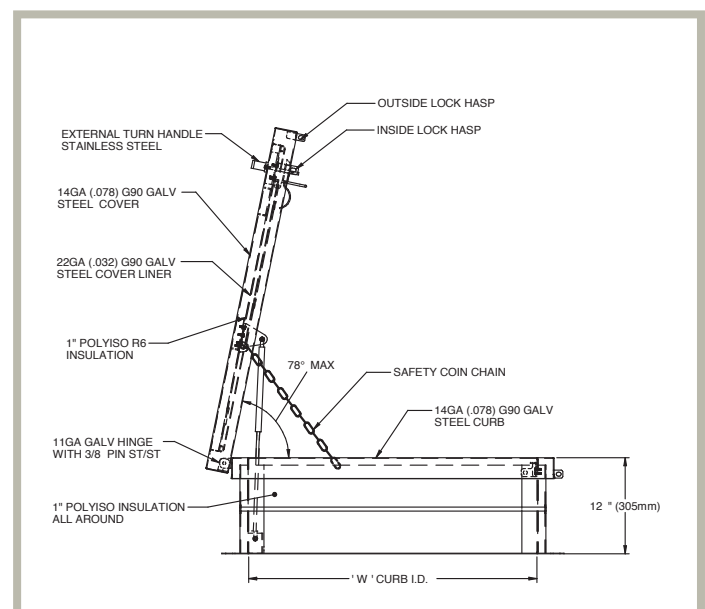

RHA ALUMINUM EQUIPMENT ACCESS ROOF HATCH

Application

Acudor Equipment Access Roof Hatches are designed to provide convenient, economical access to the roof of a building where larger openings are required. This opening allows for equipment to be installed or removed from a building through the roof.

Features RHA

- Weather tight construction
- Convenient one-hand operation
- 12" high insulated curb
- Supports 40lbs./sq. ft. live load
- Stainless Steel Hardware

Optional Features RHA

- Painted and Anodized finishes
- Polycarbonate domes for daylighting
- Louvered Curbs
- Curb Mounted Units
- Curb pitch corrected for sloped roof
- Higher curb heights for "green roof" applications

RHA Specifications:

Cover: Double-skin construction ("in box type design") with 1" Polyiso (R-6) insulation and a continuous EPDM foam weather/draft seal gasket that is attached to the inside of cover to provide a flush, tight fit. Designed to support a live load of 40lbs./sq. ft., the cover is 1/8" thick aluminum with a 20 gauge aluminum inside liner.

Curb: 1/8" thick aluminum with 1" thick Polyiso (R-6) insulation at curb exterior. Curb is 12" high, with 3.375" wide bottom flange and pre-drilled mounting holes.

Hinge: Heavy duty Aluminum pintle hinges with 3/8" SS pin

Opening: Gas spring operators allow cover to open and close with ease. Stainless Steel Inside pull handle allows for easy control when closing cover.

Door Latch: Self latching, Stainless steel outside T handle with stainless steel inside lock and lever assembly. Unit also has inside and outside padlock provisions.

Finish: Mill finish.



RHA STANDARD SIZES (other sizes available)

	Curb ID W&L	Weight per Hatch
Model	inches (mm)	lbs. (kg.)
A5656	48 x 48 (1219 x 1219)	115 (52.3)

For detailed specifications see submittal sheet

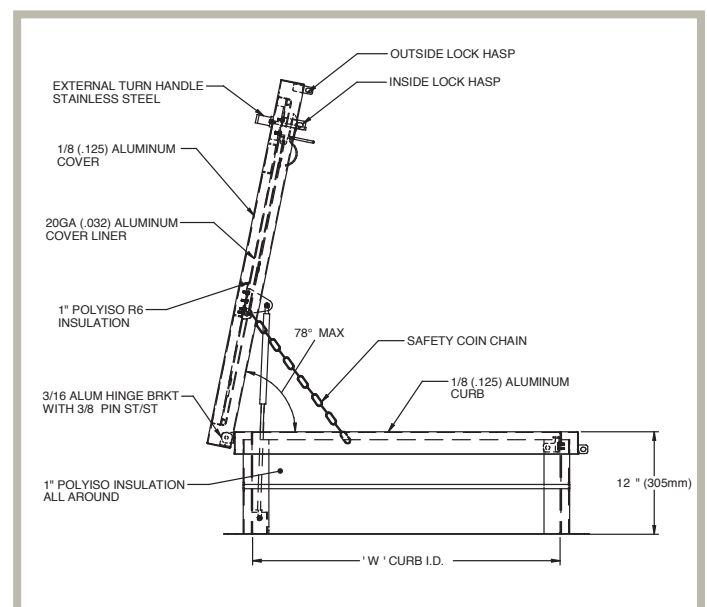

RHG GALVANIZED

EQUIPMENT ACCESS ROOF HATCH (Double Leaf)

Application

Acudor Equipment Access Roof Hatches are designed to provide convenient, economical access to the roof of a building where larger openings are required. This opening allows for equipment to be installed or removed from a building through the roof.

Features RHG

- Weather tight construction
- Convenient one-hand operation
- 12" high insulated curb
- Supports 40lbs./sq. ft. live load
- G90 Galv. Steel
- Stainless Steel Hardware

Optional Features RHG

- Painted and Anodized finishes
- Polycarbonate domes for daylighting
- Louvered Curbs
- Curb Mounted Units
- Galvanized steel curb and Aluminum cover
- Curb pitch corrected for sloped roof
- Higher curb heights for "green roof" applications
- Available with Galvanized Steel Curb and Aluminum Cover
- Higher Live Load Support

RHG Specifications:

Cover: Double-skin construction ("in box type design") with 1" Polyiso (R-6) insulation and a continuous EPDM foam weather/draft seal gasket that is attached to the inside of cover to provide a flush, tight fit. Designed to support a live load of 40lbs./sq. ft., the cover is 14 gauge galvanized steel with a 22 gauge galvanized steel inside liner.

Curb: 14 gauge galvanized steel with 1" thick Polyiso (R-6) insulation at curb exterior. Curb is 12" high, with 3.375" wide bottom flange and pre-drilled mounting holes.

Hinge: Heavy duty galvanized steel pintle hinges with 3/8" SS pin

Opening: Gas spring operators allow cover to open and close with ease.

Stainless Steel Inside pull handle allows for easy control when closing cover.

Door Latch: Self latching, Stainless steel outside T handle with stainless steel inside lock and lever assembly. Unit also has inside and outside padlock provisions.

Finish: Material is prepared with an iron phosphate wash, followed by a rust inhibiting primer, and then a baked on polyester enamel grey paint.



RHG STANDARD SIZES (other sizes available)

Model	Curb ID W&L inches (mm)	Weight per Hatch lbs. (kg.)
G6868	60 x 60 (1524 x 1524)	290 (131)

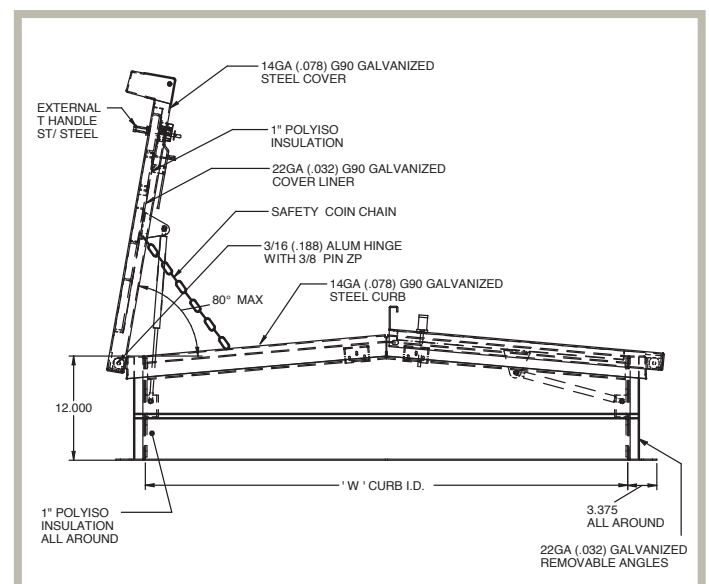

For detailed specifications see submittal sheet



RHA ALUMINUM

EQUIPMENT ACCESS ROOF HATCH (Double Leaf)

Application

Acudor Equipment Access Roof Hatches are designed to provide convenient, economical access to the roof of a building where larger openings are required. This opening allows for equipment to be installed or removed from a building through the roof.

Features RHA

- Weather tight construction
- Convenient one-hand operation
- 12" high insulated curb
- Supports 40lbs./sq. ft. live load
- Stainless Steel Hardware

Optional Features RHA

- Painted and Anodized finishes
- Polycarbonate domes for daylighting
- Louvered Curbs
- Curb Mounted Units
- Galvanized steel curb and Aluminum cover
- Curb pitch corrected for sloped roof
- Higher curb heights for "green roof" applications
- Higher Live Load Support

RHA Specifications:

Cover: Double-skin construction ("in box type design") with 1" Polyiso (R-6) insulation and a continuous EPDM foam weather/draft seal gasket that is attached to the inside of cover to provide a flush, tight fit. Designed to support a live load of 40lbs./sq. ft., the cover is 1/8" thick aluminum with a 20 gauge aluminum inside liner.

Curb: 1/8" thick aluminum with 1" thick Polyiso (R-6) insulation at curb exterior. Curb is 12" high, with 3.375" wide bottom flange and pre-drilled mounting holes.

Hinge: Heavy duty Aluminum pintle hinges with 3/8" SS pin

Opening: Gas spring operators allow cover to open and close with ease.

Stainless Steel Inside pull handle allows for easy control when closing cover.

Door Latch: Self latching, Stainless steel outside T handle with stainless steel inside lock and lever assembly. Unit also has inside and outside padlock provisions.

Finish: Mill finish.



RHA STANDARD SIZES (other sizes available)

Model	Curb ID W&L	Weight per Hatch
	inches (mm)	lbs. (kg.)
A6868	60 x 60 (1524 x 1524)	180 (82)

For detailed specifications see submittal sheet

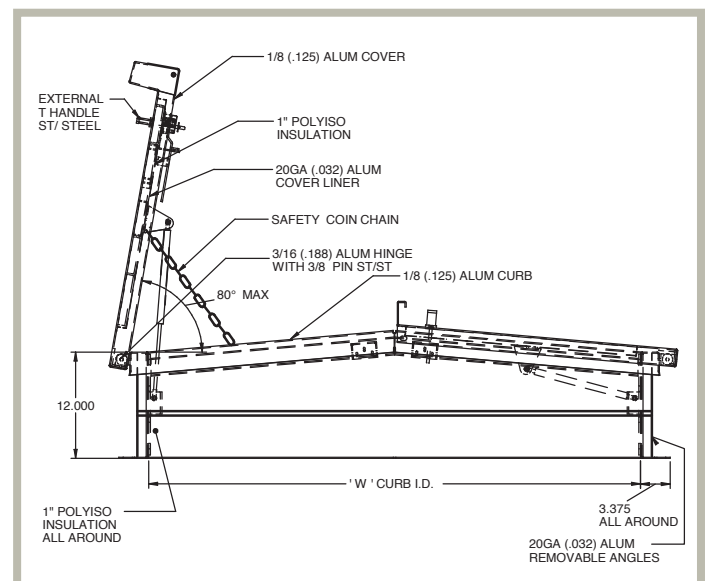

RHGDD

GALVANIZED

DOMED ROOF HATCH

Application

Acudor Domed Roof Hatches are designed to provide convenient, economical access to the roof of a building. The Polycarbonate Domes provide the benefit of a skylight.

Features RHGDD

- Clear, bronze, white, combination polycarbonate double-skin dome
- G90 Galv. Steel
- Stainless Steel Hardware

Optional Features RHGDD

- Stainless Steel cover, curb
- Louvered Curbs
- Curb Mounted Units
- Curb pitch corrected for sloped roof
- All Aluminum construction, cover and curb

RHGDD Specifications:

Cover: Double-skin construction ("in box type design") with 1" Polyiso (R-6) insulation and a continuous EPDM foam weather/draft seal gasket that is attached to the inside of cover to provide a flush, tight fit. Designed to support a live load of 40lbs./sq. ft., the cover is 1/8" thick aluminum, with a 20 gauge aluminum inside liner.

Curb: 14 gauge galvanized steel with 1" thick Polyiso (R-6) insulation with Fiberglass liner at curb exterior. Curb is 12" high, with 3.375" wide bottom flange and pre-drilled mounting holes.

Hinge: Heavy duty galvanized steel pintle hinges with 3/8" SS pin

Opening: Gas spring operators allow cover to open and close with ease. Stainless Steel inside pull handle allows for easy control when closing cover.

Door Latch: Self latching, Stainless Steel outside T handle with stainless steel inside lock and lever assembly. Unit also has inside and outside padlock provisions.

Finish: Material is prepared with an iron phosphate wash, followed by a rust inhibiting primer, and then a baked on polyester enamel grey paint.

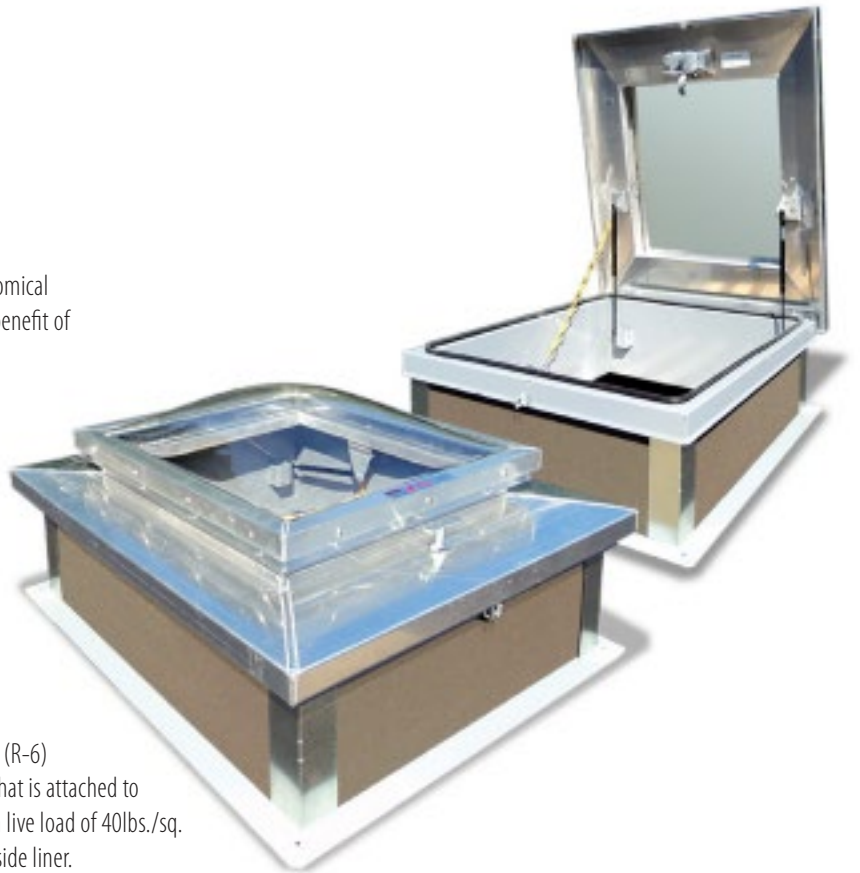

RHGDD STANDARD SIZES (other sizes available)

Model	Curb ID L&W inches (mm)	Weight per Hatch lbs. (kg.)
GD3232	24 X 24 (610 X 610)	125 (56.8)
GD3244	24 X 36 (610 X 914)	135 (61.4)
GD3838	30 X 30 (762 X 762)	140 (63.5)
GD3844	30 X 36 (762 X 914)	155 (70.5)
GD4444	36 X 36 (914 X 914)	170 (77.3)

For detailed specifications see submittal sheet

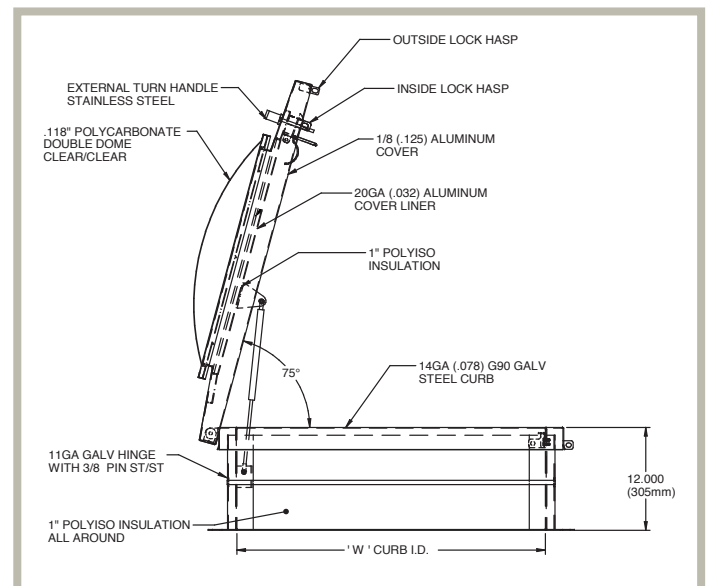

RHADD

ALUMINUM

DOMED ROOF HATCH

Application

Acudor Domed Roof Hatches are designed to provide convenient, economical access to the roof of a building. The Polycarbonate Domes provide the benefit of a skylight.

Features RHADD

- Clear, bronze, white, combination polycarbonate double-skin dome
- Stainless Steel Hardware

Optional Features RHADD

- Stainless Steel cover, curb
- Louvered Curbs
- Curb Mounted Units
- Curb pitch corrected for sloped roof
- All Aluminum construction, cover and curb

RHADD Specifications:

Cover: Double-skin construction ("in box type design") with 1" Polyiso (R-6) insulation and a continuous EPDM foam weather/draft seal gasket that is attached to the inside of cover to provide a flush, tight fit. Designed to support a live load of 40lbs./sq. ft., the cover is 1/8" thick aluminum, with a 20 gauge aluminum inside liner. To accommodate the polycarbonate domes, an aluminum extrusion with built in condensation drainage channel is provided.

Curb: 1/8" Aluminum with 1" thick Polyiso (R-6) insulation at curb exterior. Curb is 12" high, with 3.375" wide bottom flange and pre-drilled mounting holes

Hinge: Heavy Duty Aluminum pintle hinges with 3/8" SS pin

Opening: Gas spring operators allow cover to open and close with ease. Stainless Steel Inside pull handle allows for easy control when closing cover.

Door Latch: Self latching, Stainless steel outside T handle with stainless steel inside lock and lever assembly. Unit also has inside and outside padlock provisions.

Finish: Mill finish

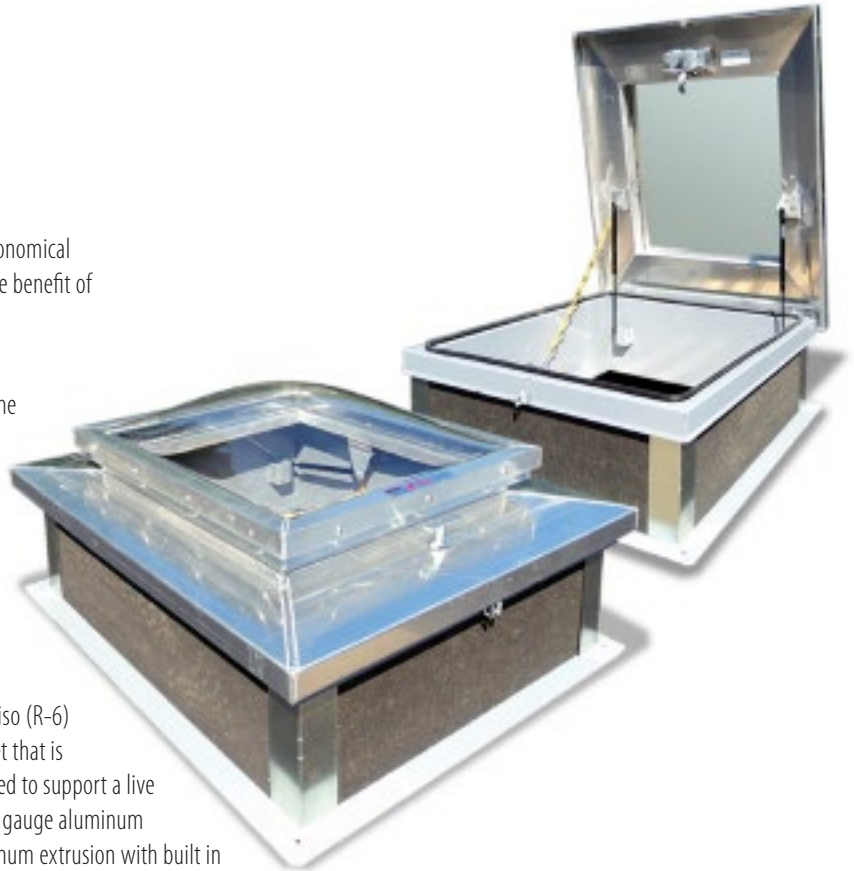

RHADD STANDARD SIZES (other sizes available)

Model	Curb ID W&L inches (mm)	Weight per Hatch lbs. (kg.)
AD3232	24 X 24 (610 X 610)	125 (56.8)
AD3244	24 X 36 (610 X 914)	135 (61.4)
AD3838	30 X 30 (762 X 762)	140 (63.5)
AD3844	30 X 36 (762 X 914)	155 (70.5)
AD4444	36 X 36 (914 X 914)	170 (77.3)

For detailed specifications see submittal sheet

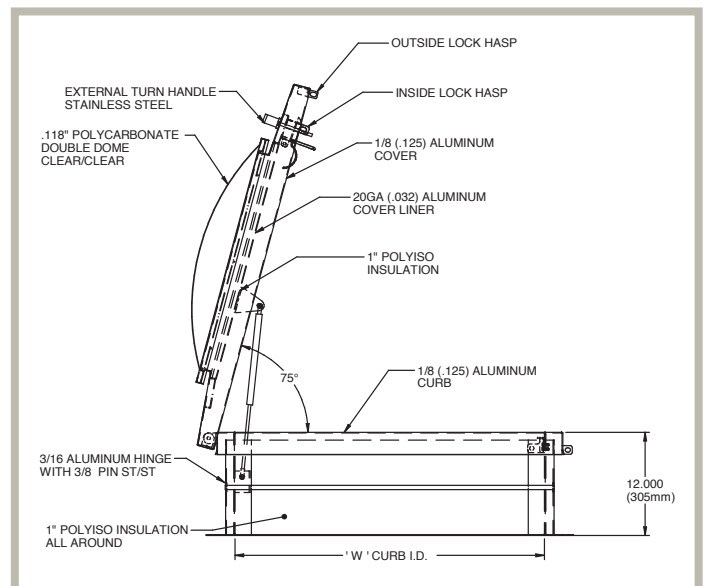



RHG GALVANIZED

ELECTRIC ACTUATION ROOF HATCH

Application

Acudor Electric Actuation Roof Hatches are designed to provide convenient, economical access to the roof of a building with the ease of automation. By adding an electric actuator, our hatch can be opened and closed remotely. This feature is available on small ladder access hatches, and more importantly on larger equipment hatches, which are typically heavy and difficult to operate.

Features RHG

- Choice of operating switch and/or remote control
- 12V/24V DC Electrical Actuator. Suitable for mains supply AC 120V/60Hz or 230V/50Hz
- Can open to any angle up to 80 degrees max
- Battery back-up
- G90 Galv. Steel
- Synchronized operation for large sizes
- Stainless Steel Hardware

Optional Features RHG

- Stainless Steel Hardware
- Louvered Curbs
- Curb Mounted Units
- Curb pitch corrected for sloped roof

RHG Specifications:

Cover: Double-skin construction ("in box type design") with 1" Polyiso (R-6) insulation and a continuous EPDM foam weather/draft seal gasket that is attached to the inside of cover to provide a flush, tight fit. Designed to support a live load of 40lbs./sq. ft., the cover is 14 gauge galvanized steel with a 22 gauge galvanized steel inside liner.

Curb: 14 gauge galvanized steel with 1" thick Polyiso (R-6) insulation with Fiberglass liner at curb exterior. Curb is 12" high, with 3.375" wide bottom flange and pre-drilled mounting holes.

RHG STANDARD SIZES

(Special sizes up to 197" x 197" available upon request)

Model	Curb ID W&L	Weight per Hatch
	inches (mm)	lbs. (kg.)
EG3232	24 X 24 (610 X 610)	125 (56.8)
EG3244	24 X 36 (610 X 914)	135 (61.4)
EG3838	30 X 30 (762 X 762)	140 (63.5)
EG3844	30 X 36 (762 X 914)	155 (70.5)
EG3862	30 X 54 (762 X 1372)	135 (61.4)
EG3804	30 X 96 (762 X 2438)	335 (152.3)
EG4444	36 X 36 (914 X 914)	170 (77.3)
EG5656	48 X 48 (1219 X 1219)	185 (83)

For detailed specifications see submittal sheet



Opening: Convenient electric actuation with options of Push Button Switch, Key Switch and/or Remote Control. Can be kept open at any angle for ventilation. Single covers with more than one actuator operate on synchronous mode. Hatches with more than one cover have at least two actuators which need to be operated in sequence. Battery back-up is provided for emergency exits to ensure power supply in case of power outage. Control Box keeps the batteries charged.

Door Latch: Self Locking feature of Electric Actuator replaces need for conventional locks in standard designs. Additional locking arrangements available upon request.

Finish: Material is prepared with an iron phosphate wash, followed by a rust inhibiting primer, and then a baked on polyester enamel paint.

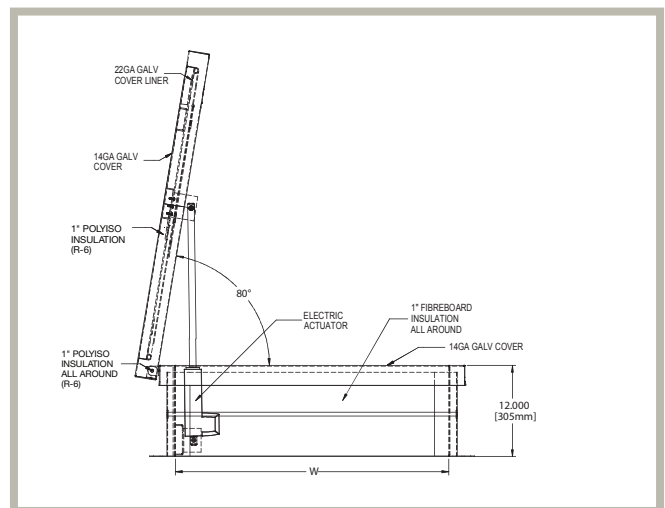



RHA ALUMINUM ELECTRIC ACTUATION ROOF HATCH

Application

Acudor Electric Actuation Roof Hatches are designed to provide convenient, economical access to the roof of a building with the ease of automation. By adding an electric actuator, our hatch can be opened and closed remotely. This feature is available on small ladder access hatches, and more importantly on larger equipment hatches, which are typically heavy and difficult to operate.

Features RHA

- Choice of operating switch and/or remote control
- 12V/24V DC Electrical Actuator. Suitable for mains supply AC 120V/60Hz or 230V/50Hz
- Can open to any angle up to 80 degrees max
- Battery back-up
- Synchronized operation for large sizes

Optional Features RHA

- Stainless Steel Hardware
- Louvered Curbs
- Curb Mounted Units
- Curb pitch corrected for sloped roof

RHA Specifications:

Cover: Double-skin construction ("in box type design") with 1" cellulose insulation and a continuous EPDM foam weather/draft seal gasket that is attached to the inside of cover to provide a flush, tight fit. Designed to support a live load of 40lbs./sq. ft.

Curb: 1" thick fiberboard roof insulation at curb exterior. Curb is 12" high, with 3.375" wide bottom flange and pre-drilled mounting holes

Door Latch: Self Locking feature of Electric Actuator replaces need for conventional locks in standard designs Additional locking arrangements available upon request.



Opening: Convenient electric actuation with options of Push Button Switch, Key Switch and/or Remote Control. Can be kept open at any angle for ventilation. Single covers with more than one actuator operate on synchronous mode. Hatches with more than one cover have at least two actuators which need to be operated in sequence. Battery back-up is provided for emergency exits to ensure power supply in case of power outage. Control Box keeps the batteries charged.

Finish: Aluminum: Mill Finish

RHA STANDARD SIZES

(Special sizes up to 197" x 197" available upon request)

Model	Curb ID W&L	Weight per Hatch
	inches (mm)	lbs. (kg.)
EA3232	24 X 24 (610 X 610)	60 (27.3)
EA3244	24 X 36 (610 X 914)	70 (31.8)
EA3838	30 X 30 (762 X 762)	75 (34.0)
EA3844	30 X 36 (762 X 914)	85 (38.6)
EA3862	30 X 54 (762 X 1372)	135 (61.4)
EA3804	30 X 96 (762 X 2438)	245 (111.4)
EA4444	36 X 36 (914 X 914)	95 (43.2)
EA5656	48 X 48 (1219 X 1219)	115 (52)

For detailed specifications see submittal sheet

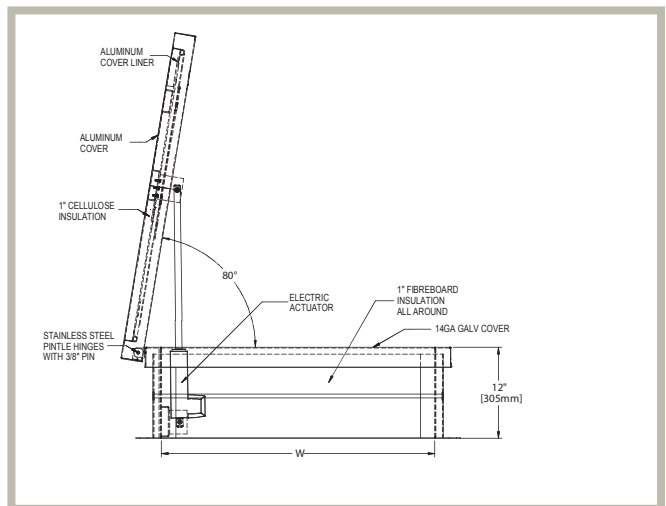

RHG-SEC

SECURITY ROOF HATCH, GALVANIZED

Application

Acudor Security Roof Hatches are designed to provide convenient, economical access to the roof of a building while adding an additional level of security. The heavy gauge materials used to manufacture this hatch are ideal for applications in banks, prisons, hospitals and more.

Features RHG-SEC

- Weather tight construction
- Convenient one-hand operation
- 12" high insulated curb
- Supports 40lbs./sq. ft. live load
- G90 Galv. Steel
- Stainless Steel Hardware

Optional Features RHG-SEC

- Stainless Steel cover, curb
- Aluminum Material
- Louvered Curbs
- Curb Mounted Units
- Curb pitch corrected for sloped roof
- Higher curb heights for "green roof" applications

RHG Specifications:

Cover: Double-skin construction ("in box type design") with 1" Polyiso (R-6) insulation and a continuous EPDM foam weather/draft seal gasket that is attached to the inside of cover to provide a flush, tight fit. Designed to support a live load of 40lbs./sq. ft., the cover is 10 gauge galvanized steel with a 18 gauge galvanized steel inside liner.

Curb: 10 gauge galvanized steel with 1" thick Polyiso (R-6) insulation with Fiberglass liner at curb exterior. Curb is 12" high, with 3.375" wide bottom flange and pre-drilled mounting holes.

Hinge: Heavy duty galvanized steel pintle hinges with 3/8" SS pin

Opening: Gas spring operators allow cover to open and close with ease. Stainless Steel inside pull handle allows for easy control when closing cover.

RHG-SEC STANDARD SIZES *(other sizes available)*

Model	Curb ID L&W	Weight per Hatch	
	inches (mm)	materials	lbs. (kg.)
GSEC3232	24 X 24 (610 X 610)	GAL.	250 (114)
GSEC3224	24 X 36 (610 X 914)	GAL.	270 (122)
GSEC3838	30 X 30 (762 X 762)	GAL.	280 (128)
GSEC3844	30 X 36 (762 X 914)	GAL.	310 (142)
GSEC4444	36 X 36 (914 X 914)	GAL.	340 (154)

For detailed specifications see submittal sheet



Door Latch: Self latching, zinc plated outside T handle with stainless steel inside lock and lever assembly. Heavy duty detention lock with paracentric key. Unit also has inside and outside padlock provisions.

Finish: Material is prepared with an iron phosphate wash, followed by a rust inhibiting primer, and then a baked on polyester enamel paint.

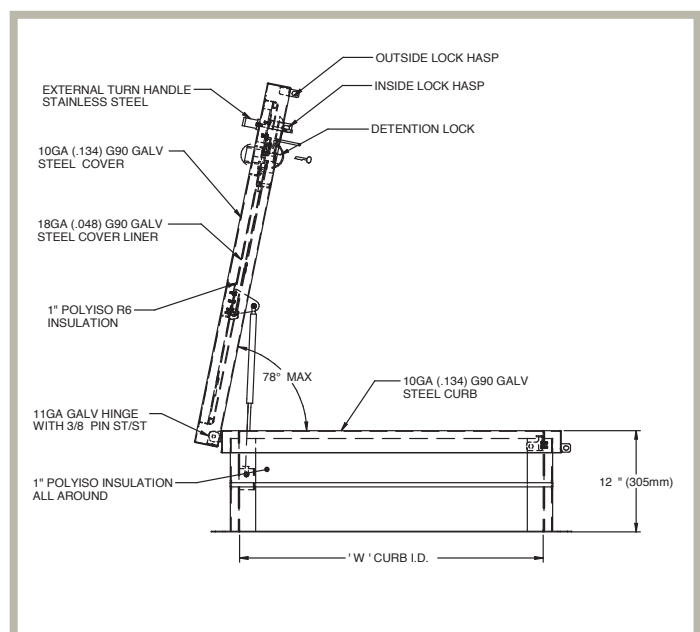



RHATB_{ALUMINUM}

THERMALLY BROKEN ROOF HATCH

Application

Acudor Thermally broken Roof Hatches are designed to provide superior energy efficiency together with convenient, economical access to the roof of a building

Features RHATB

- Thermally broken design
- Convenient one-hand operation
- R-18 insulated curb and cover
- Supports 40lbs./sq. ft. live load
- Stainless Steel Hardware

Optional Features RHATB

- Painted and Anodized finishes
- Curb pitch corrected for sloped roof
- Higher curb heights for "green roof" applications

RHATB Specifications:

Cover: Double-skin construction ("in box type design") with 3" Polyiso (R-18) insulation integrating non-conductive separator between exposed exterior and interior surfaces, providing superior thermal performance and improved energy efficiency. EPDM foam weather draft seal gasket on the inside of the cover assures weather tight construction. The cover is 11Ga Aluminum with a 20Ga aluminum inside liner, with thicknesses adjusted to suit sizes.

Curb: 11Ga Aluminum with 3" thick Polyiso (R-18) insulation integrating non-conductive separator between exposed exterior and interior surfaces, providing superior thermal performance and improved energy efficiency. Curb is 12" high.

Thermal Performance: Tested to ASTM C1363-11 (Standard Test Method for Thermal Performance of Building Materials and Envelope Assemblies by Means of a Hot Box Apparatus)

Hinge: Heavy duty Aluminum pintle hinges with 3/8" SS Pin

Opening: Gas Spring operators allow cover to open and close with ease.

Latch: Self latching, Stainless Steel outside T handle with Stainless Steel inside lock and lever assembly.

Finish: Mill Finish

RHATB STANDARD SIZES *(other sizes available)*

Model	Curb ID W&L	Weight per Hatch
	inches (mm)	lbs. (kg.)
T3838	30 x 30 (762 x 762)	77 (34.0)
T3844	30 x 36 (762 x 914)	84 (38.6)
T4444	36 x 36 (914 x 914)	91 (43.2)
T3862	30 x 54 (762 x 1372)	105 (47.6)
T38104	30 x 96 (762 x 2438)	165 (75.0)
T5656	48 x 48 (1219 x 1219)	122 (55.0)

For detailed specifications see submittal sheet

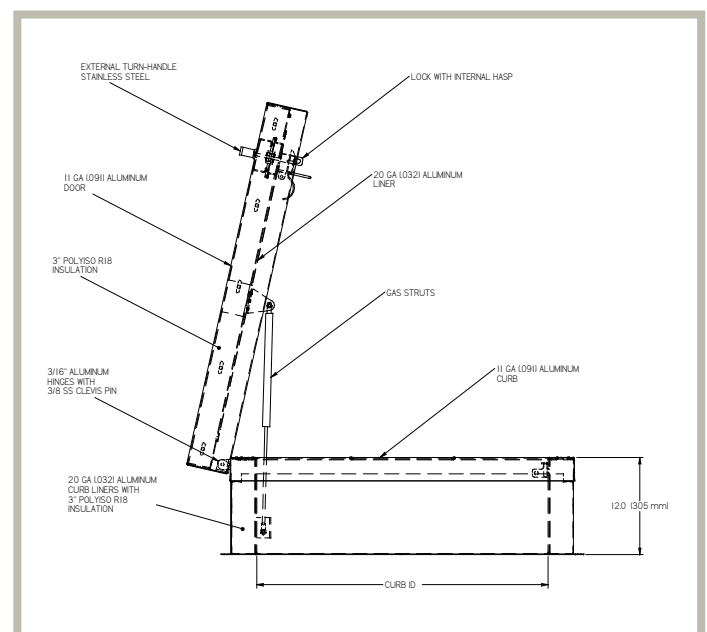



SVG

GALVANIZED

Smoke Vent, Single Leaf

Application

Acudor Smoke Vents are designed to provide an economical solution for fire ventilation by removing deadly smoke, heat, and gases from a burning building. Single leaf Smoke Vents are used for smaller areas that need venting, including elevator shafts and stairwells. *Single leaf units are not U.L. Listed.*

Features SVG

- 14 gauge G90 Galvanized Steel
- 12" high insulated curb
- High performance gas springs
- Inside and Outside manual release
- UL Listed Fusible or McCabe Resettable Links

Optional Features SVG

- Curb mount or Metal Building Flange
- Double-Dome Co-Polyester lids for daylighting
- Louvered curb for ventilation

SVG Specifications:

Cover: Double-skin construction ("in box type design") with 1" cellulose insulation and a continuous EPDM foam weather/draft seal gasket that is attached to the inside of cover to provide a flush, tight fit. Designed to support a live load of 40lbs./sq. ft., the cover is 14 gauge galvanized steel with a 22 gauge galvanized steel inside liner.

Curb: 14 gauge galvanized steel with 1" thick fiberboard roof insulation at curb exterior. Curb is 12" high, with 3.375" wide bottom flange and pre-drilled mounting holes.

Hinge: Heavy duty galvanized steel with 3/8" pin



Opening: Gas spring operators allow cover to open and close with ease. Inside and outside release allows for manual lid operation.

Door Latch: Self latching Slam Latch. Supplied standard with 165° UL Listed Fusible Link. Resettable McCabe link available.

Finish: Galvanized Steel: baked on polyester enamel paint

SVG STANDARD SIZES (other sizes available)

Model	Curb ID W&L	Weight per Hatch
	inches (mm)	lbs. (kg.)
SVG2424	24 x 24 (610 x 610)	125 (56.8)
SVG2436	24 x 36 (610 x 914)	135 (61.4)
SVG3030	30 x 30 (762 x 762)	140 (63.5)
SVG3036	30 x 36 (762 x 914)	155 (70.5)
SVG3096	30 x 96 (762 x 2438)	387 (175.5)
SVG3636	36 x 36 (914 x 914)	170 (77.3)
SVG4848	48 x 48 (1219 x 1219)	221 (100.2)

For detailed specifications see submittal sheet

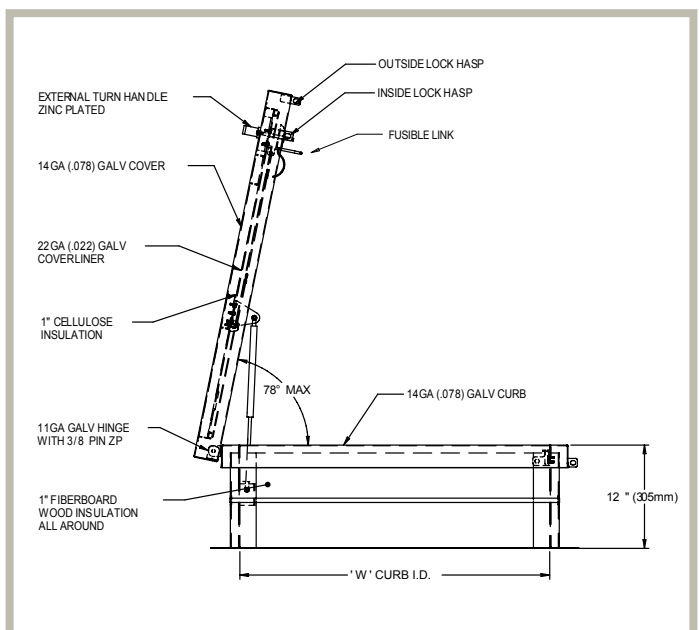



SVA ALUMINUM

Smoke Vent, Single Leaf

Application

Acudor Smoke Vents are designed to provide an economical solution for fire ventilation by removing deadly smoke, heat, and gases from a burning building. Single leaf Smoke Vents are used for smaller areas that need venting, including elevator shafts and stairwells. *Single leaf units are not U.L. Listed.*

Features SVA

- 1/8" thick aluminum
- 12" high insulated curb
- High performance gas springs
- Inside and Outside manual release
- UL Listed Fusible or McCabe Resettable Link
- Stainless Steel Hardware

Optional Features SVA

- Curb mount or Metal Building Flange
- Double-Dome Polycarbonate lids for daylighting
- Louvered curb for ventilation

SVA Specifications:

Cover: Double-skin construction ("in box type design") with 1" Polyiso (R-6) insulation and a continuous EPDM foam weather/draft seal gasket that is attached to the inside of cover to provide a flush, tight fit. Designed to support a live load of 40lbs./sq. ft., the cover is 1/8" thick aluminum with a 20 gauge aluminum inside liner.

Curb: 1/8" Aluminum with 1" thick Polyiso (R-6) insulation at curb exterior. Curb is 12" high, with 3.375" wide bottom flange and pre-drilled mounting holes.

Hinge: Aluminum pintle hinges with 3/8" pin



Opening: Gas spring operators allow cover to open and close with ease. Inside and outside release allows for manual lid operation.

Door Latch: Self latching Slam Latch. Supplied standard with 165° UL Listed Fusible Link. Resettable McCabe link available.

Finish: Mill Finish

SVA STANDARD SIZES (other sizes available)

Model	Curb ID W&L	Weight per Hatch
	inches (mm)	lbs. (kg.)
SVA2424	24 x 24 (610 x 610)	60 (27.3)
SVA2436	24 x 36 (610 x 914)	70 (31.8)
SVA3030	30 x 30 (762 x 762)	75 (34.0)
SVA3036	30 x 36 (762 x 914)	85 (38.6)
SVA3096	30 x 96 (762 x 2438)	212 (96.1)
SVA3636	36 x 36 (914 x 914)	95 (43.2)
SVA4848	48 x 48 (1219 x 1219)	123 (55.8)

For detailed specifications see submittal sheet

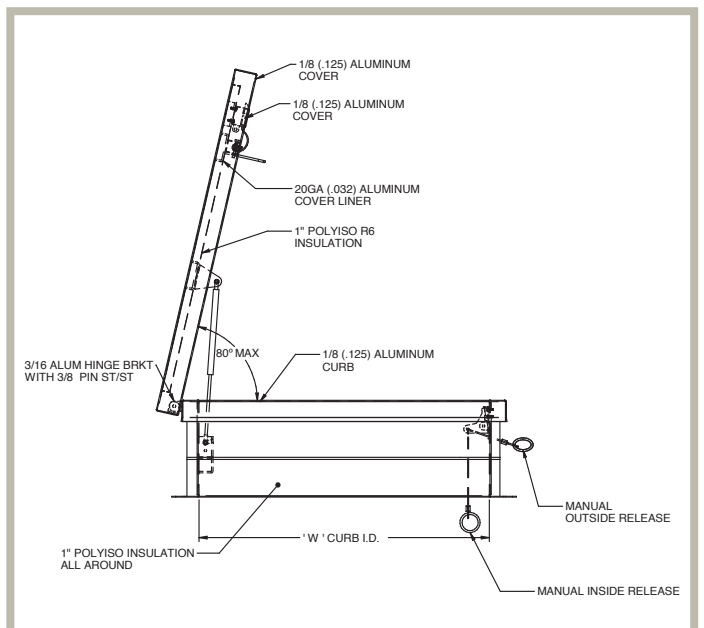

SVG

GALVANIZED

UL LISTED SMOKE VENT, Double Leaf

Application

Acudor Smoke Vents are designed to provide an economical solution for fire ventilation by removing deadly smoke, heat, and gases from a burning building.

Features SVG

- 14 gauge G90 Galvanized Steel
- 12" high insulated curb
- High performance gas springs
- Inside and Outside manual release
- UL Listed Fusible or McCabe Resettable Links

Optional Features SVG

- Curb mount or Metal Building Flange
- Double-Dome Co-Polyester lids for daylighting
- Louvered curb for ventilation

SVG Specifications:

Cover: Double-skin construction ("in box type design") with 1" cellulose insulation and a continuous EPDM foam weather/draft seal gasket that is attached to the inside of cover to provide a flush, tight fit. Designed to support a live load of 40lbs./sq. ft., the cover is 14 gauge galvanized steel with a 22 gauge galvanized steel inside liner.

Curb: 14 gauge galvanized steel with 1" thick fiberboard roof insulation at curb exterior. Curb is 12" high, with 3.375" wide bottom flange and pre-drilled mounting holes.

Hinge: Heavy duty galvanized steel / aluminum pintle hinges with 3/8" pin



Opening: Gas spring operators allow cover to open and close with ease.

Inside and outside release allows for manual lid operation.

Door Latch: Self latching Slam Latch. Supplied standard with 165° UL Listed Fusible Link. Resettable McCabe link available.

Finish: Galvanized Steel: baked on polyester enamel paint

SVG STANDARD SIZES (other sizes available)

Model	Curb ID W&L	Weight per Hatch
	inches (mm)	lbs. (kg.)
SVG4848	48 x 48 (1219 x 1219)	180 (82)
SVG4872	48 x 72 (1219 x 1829)	230 (104)
SVG4890	48 x 90 (1219 x 2286)	240 (109)
SVG4896	48 x 96 (1219 x 2438)	250 (113)
SVG6060	60 x 60 (1524 x 1524)	235 (106)
SVG6072	60 x 72 (1524 x 1829)	240 (109)
SVG6090	60 x 90 (1524 x 2286)	300 (136)
SVG6096	60 x 96 (1524 x 2438)	310 (141)

For detailed specifications see submittal sheet

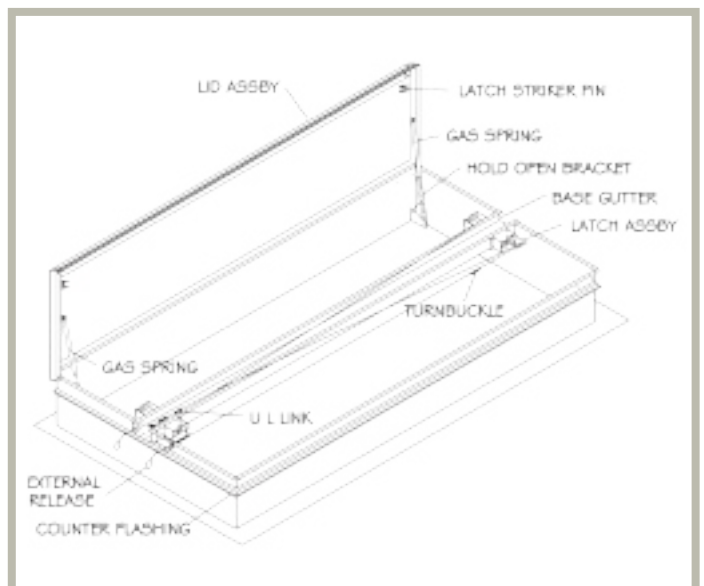



SVA

ALUMINUM

UL LISTED SMOKE VENT, Double Leaf

Application

Acudor Smoke Vents are designed to provide an economical solution for fire ventilation by removing deadly smoke, heat, and gases from a burning building.

Features SVA

- 1/8" Aluminum
- 12" high insulated curb
- High performance gas springs
- Inside and Outside manual release
- UL Listed Fusible or McCabe Resettable Links

Optional Features SVA

- Curb mount or Metal Building Flange
- Double-Dome Co-Polyester lids for daylighting
- Louvered curb for ventilation

SVA Specifications:

Cover: Double-skin construction ("in box type design") with 1" cellulose insulation and a continuous EPDM foam weather/draft seal gasket that is attached to the inside of cover to provide a flush, tight fit. Designed to support a live load of 40lbs./sq. ft., the cover is 11 gauge aluminum with a 20 gauge aluminum inside liner.

Curb: 1/8" Aluminum with 1" thick fiberboard roof insulation at curb exterior. Curb is 12" high, with 3.375" wide bottom flange and pre-drilled mounting holes.

Hinge: Heavy duty galvanized steel / aluminum pintle hinges with 3/8" pin



Opening: Gas spring operators allow cover to open and close with ease.

Inside and outside release allows for manual lid operation.

Door Latch: Self latching Slam Latch. Supplied standard with 165° UL Listed Fusible Link. Resettable McCabe link available.

Finish: Aluminum: Mill Finish

SVA STANDARD SIZES *(other sizes available)*

Model	Curb ID W&L	Weight per Hatch
	inches (mm)	lbs. (kg.)
SVA4848	48 x 48 (1219 x 1219)	105 (48)
SVA4872	48 x 72 (1219 x 1829)	130 (59)
SVA4890	48 x 90 (1219 x 2286)	135 (61)
SVA4896	48 x 96 (1219 x 2438)	140 (64)
SVA6060	60 x 60 (1524 x 1524)	130 (59)
SVA6072	60 x 72 (1524 x 1829)	135 (61)
SVA6090	60 x 90 (1524 x 2286)	165 (75)
SVA6096	60 x 96 (1524 x 2438)	170 (77)

For detailed specifications see submittal sheet

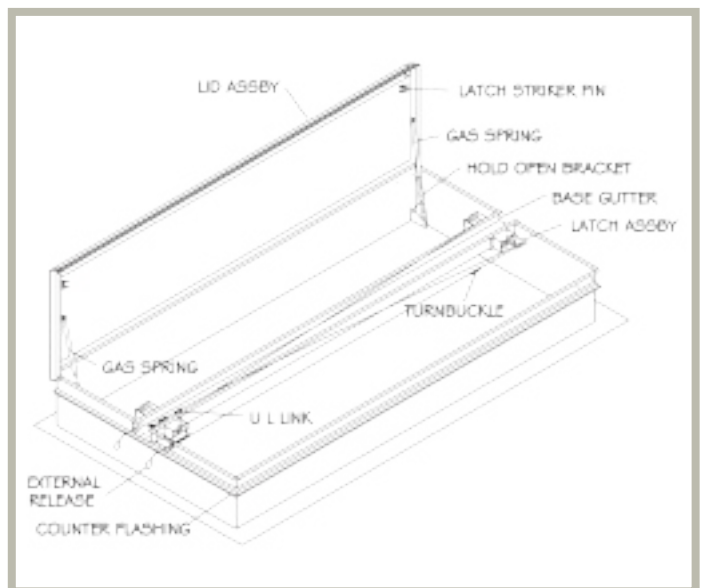

RGS SAFETY RAILS

SAFETY ACCESSORIES Roof Hatch Rail System

Safety First

Caution is the key when working in high elevations and that is where most roof and ceiling access is found. Acudor Safety Rails are designed for all Roof Hatch applications to assist in making every work space as safe as possible.

Features

- Railing system surrounds all sides of the opening
- (Self Closing Gate) Spring tension gate keeps the opening closed after pass through
- Easy to install
- Assembled on site, no special tools necessary
- Safe, easy and economic access
- Standard Finish is Safety Yellow Painted, also available in Galvanized finish

Components

Material: Steel ASTM A36

Rails: Steel ASTM A36

Joiners: Steel ASTM A36

Rail Width: Various lengths to fit the multiple sizes of openings

Weight: Standard rail lengths range from 8lbs. to 11lbs.

Compliance

- Designs complying OSHA standards
- Other specifications available

RAIL SYSTEM STANDARD SIZES

(other sizes available upon request)

Nominal Opening W&H		Weight per System Kit	
inches	mm	lbs.	kg.
24 x 24	610 x 610	60	27.2
24 x 30	610 x 762	70	31.8
24 x 36	610 x 914	75	34
30 x 30	762 x 762	80	36.4
30 x 36	762 x 914	90	41
42 x 42	1067 x 1067	125	56.8
48 x 48	1220 x 1220	155	70.4
48 x 72	1220 x 1829	210	95.3
60 x 60	1524 x 1524	220	98.9



ROOF HATCH & SAFETY RAILS FRONT VIEW
(ROOF HATCH COVER REMOVED FOR A BETTER VIEW OF THE RAIL SYSTEM)

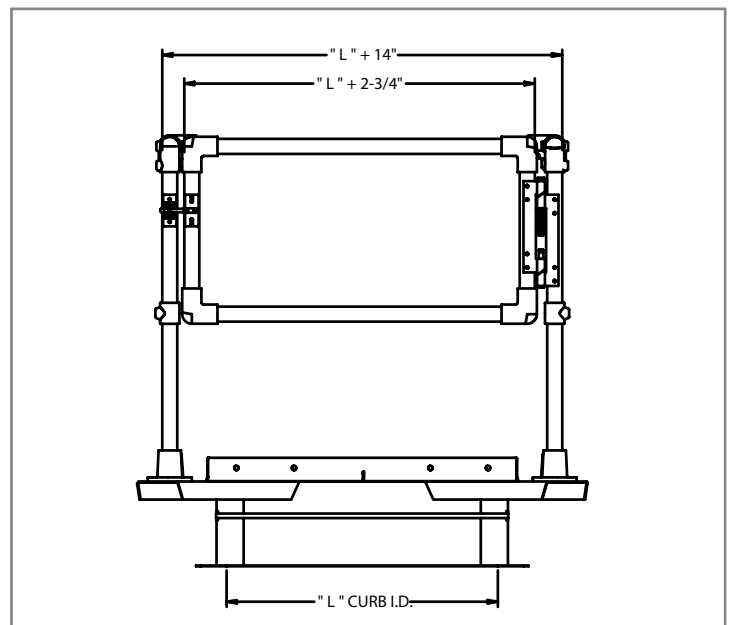

NOTE: Railing product image shown with 36" x 36" Aluminum Roof Hatch. Roof Hatch products are sold separately. For more information on Roof Hatches and Smoke Vents, contact Acudor at "www.acudor.com" - info@acudor.com

For detailed specifications see submittal sheet

LADDERS

Fixed Shaft Modular Ladder System

Component System

Create the desired length using 4 ft. & 5 ft. Ladder modules along with a variety of accessories & mounting options.

Features

- Provides safe, easy & economic access
- Ladders Flat Packed Kit with rapid delivery
- Modular design serving multitude of length requirements
- Easy to store & install
- Assembled on site, no special tools necessary
- Non-slip Rungs ensure secure footholds & handholds
- Standard Finish is Safety Yellow Painted, also available in Galvanized finish

Ladder

Material: Steel ASTM A36

Stringers: LAD-S: 2 1/2" x 5/16"

Rungs: LAD-S: 3/4" dia

Ladder Width: 20" inside

Length: 4' & 5' (special lengths available on request)

Weight: LAD-S: 8 Lbs/ft

Cage

Material: Steel ASTM A36

Hoops: 2" x 1/4" Th.

Straps: 1" x 3/16" Th.

Weight: 8 Lbs/ft

Height: 48"

Telescopic Safety Upstand

Material: Steel ASTM A36

Extended height: 40" from top rung

Landing Guide Rail

Material: Steel ASTM A36

Extended height: 42" from top rung

Hinged Gate

Material: 12 Ga. Steel ASTM A36

Height: 7'

Also Available

- OSHA Compliant Ladder



Optional: Hinged Gate



NOTE: All application requirements are different depending on site conditions. Acudor has provided their Ladder System in modular parts to allow a perfect fit for all uses. All components are sold separately. See a parts list and sample reference on the back of this page.

SAFETY OPTIONS

SAFETY ACCESSORIES

Application

- Safety accessibility to roof areas through the Roof Hatch opening

Product Features

- All of these safety products are designed to be used with the Acudor Roof Hatch to allow safe use at all times

Components

TSP-1:

Telescoping Safety Post

SLE-Y:

Safety Ladder Extension





For inquiries in the U.S.A. and Caribbean
ACUDOR PRODUCTS INC.

9 Woodland Rd., Unit A Roseland, NJ 07068
TEL: (973) 575-5120 - FAX: (973) 575-5160
TOLL FREE: 800.722.0501
info@acudor.com / www.acudor.com

U.S.A. West Coast Office:

4216 North Pecos Rd., Las Vegas, NV 89115
TEL: (702) 644-8710 - FAX: (702) 644-8720

For inquiries in Mexico
ACUDOR PRODUCTS, S. DE R.L. DE C.V.

Nelson Mexico
Carretera Saltillo-Zacatecas km 4.5
Parque Industrial La Angostura
Saltillo, Coahuila, México CP 25315
infomx@acudor.com /spanish.acudor.com
+521 (844) 101-0081

For inquiries in India / Middle East / North Africa
ACUDOR PRODUCTS IMEA

PO Box 46747 Dubai, United Arab Emirates
+971-4-399-6966
ap-imea@acudor.com / www.acudor.com

For inquiries in Canada
ACUDOR PRODUCTS LTD.

1125 Squires Beach Road, Pickering, Ontario, Canada L1W 3T9
TEL: (905) 683.6121 - FAX: (905) 426.2978 - TOLL FREE: 844.228.3671
info@acudor.ca / www.acudor.com

For inquiries Outside of North America:
ACUDOR INTERNATIONAL (c/o Nelson Industrial Inc.)

905-428-2240
info@acudorintl.com / www.acudor.com