

AirFlo Ridge Vent Installation Instructions

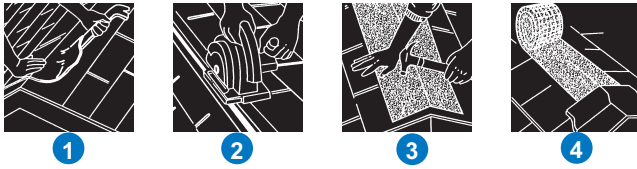

- 1 Remove ridge cap shingles along entire length of roof.
- 2
 - a. Measure 1" from ridge peak on each side of ridge. For ridge board construction measure 1 3/4" on each side of the ridge.
 - b. Snap chalk line along entire length of ridge.
 - c. Cut opening in sheathing along ridge. DO NOT CUT through roof trusses or ridge board.
 - d. Remove sheathing to create slot.
 - e. Leave a minimum of 12" of sheathing closed at each end of ridge.
- 3 Tack one end of AirFlo Ridge Vent with netting side down, over the slot to hold in place at one end of the ridge. Unroll entire length of vent, pull to remove sags and tack in place so vent is snug and centered over slot. If more than one piece is needed, simply butt the multiple pieces together and tack in place with nail.
- 4 Install ridge cap shingles directly over AirFlo. Use roofing nails included in package to secure in place. When properly installed AirFlo fills the 3/4" space between the underside of the cap shingle and the top surface of the roof shingles. DO NOT drive nails through shingle.

NAILS INCLUDED

THE SOLUTION

AirFlo Ridge Vent

Deters mold and mildew growth by ventilating the attic. A balanced system of soffit vents beneath the eaves and a continuous ridge vent allows overheated and moisture laden air out and fresh air in. Relief of excess heat makes your home more comfortable and saves on cooling costs. Moist air must be allowed to exit attic to deter growth of mold and mildew.

AirFlo is nearly invisible when installed on your roof. You will appreciate the superior ventilation features and cosmetically pleasing appearance for your home.

AirFlo Ridge Vent offers home owners nationwide a means of promoting safe, clean and environmentally responsible venting options for the attic.

SPECIFICATIONS

Dimensions	.75"x10.5"x20'
Weight per Box	9 Lbs.
Boxes per pallet	36
Weight per pallet	375 Lbs.
Boxes per Truckload	1872
Net Free Area (in ² /ft.)	15.2



TRI-BUILT ROOFING PRODUCTS
800-516-1485

Choose AirFlo Ridge Vent for Performance and Value



AirFlo Ridge Vent

HOW IT WORKS

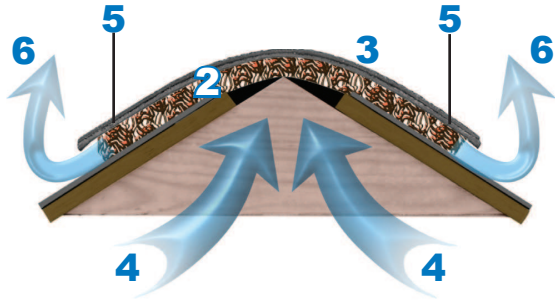

- 1. Roof Sheathing
- 2. AirFlo Ridge Vent
- 3. Cap Shingle
- 4. Hot, Moist Attic Air
- 5. Negative Pressure
- 6. Exhaust Air

Air flow across the exterior roof ridge draws hot, moist air out through the ridge vent and pulls fresh air into the attic through the soffit vents. Removal of hot, moist air from the attic reduces cooling costs and eliminates potential damage to your roof.

FEATURES

Meets Attic Ventilation Requirements of ALL Nationally Recognized Building Codes

UL Class A Fire Rating

40-Year Warranty

Coil Nails Included

Natural Sustainable Building Material

Helps Deter Mold and Mildew in the Attic

BENEFITS

Proper Ventilation Provides:	Which Leads to:
Minimal heat build-up in attic	Lower cooling bills
Most effective insulation due to less moisture	Lower heating bills
Decreased condensation moisture	Deters mold and fungal allergen growth
Increased lifespan for roof materials	Slower aging of roof materials

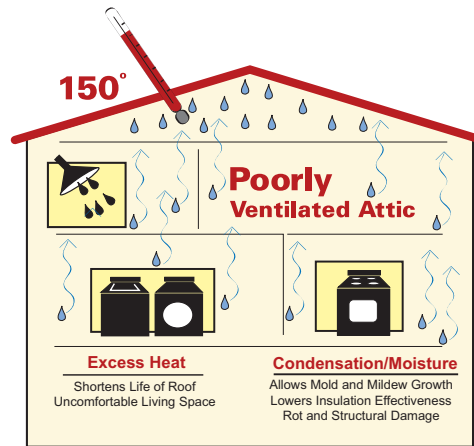

POORLY VENTILATED SYSTEM

Net Free Area table - when no Moisture Barrier is installed.
1 square foot total net free area per 150 square feet of attic

Attic Area(SF)	Total NFA(SF)	Ridge NFA(SF)	Length of AirFlo(feet)	Soffit NFA(SF)
1600	10.7	5.3	45.6	5.3
1900	12.7	6.3	54.1	6.3
2200	14.7	7.3	62.7	7.3
2500	16.7	8.3	71.2	8.3
2800	18.7	9.3	79.8	9.3
3100	20.7	10.3	88.3	10.3
3400	22.7	11.3	96.9	11.3

See soffit vent manufacturer's information on the Net Free Area provided by soffit vent product

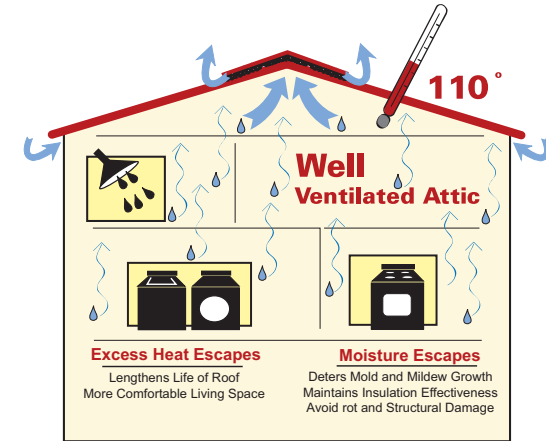

BALANCED SYSTEM

Net Free Area table - when Moisture Barrier is installed.
1 square foot total net free area per 300 square feet of attic

Attic Area(SF)	Total NFA(SF)	Ridge NFA(SF)	Length of AirFlo(feet)	Soffit NFA(SF)
1600	5.3	2.7	22.8	2.7
1900	6.3	3.2	27.1	3.2
2200	7.3	3.7	31.3	3.7
2500	8.3	4.2	35.6	4.2
2800	9.3	4.7	39.9	4.7
3100	10.3	5.2	44.2	5.2
3400	11.3	5.7	48.4	5.7

A **BALANCED SYSTEM** requires soffit ventilation in an amount equal to or greater than the amount of ridge ventilation.