

# LIGHTING SOLUTIONS

## Linear Lighting for Drywall & AcoustiBuilt® Panels

RECYCLED  
CONTENT

LEED V5

Ecomedes Data

UP TO  
50%

COMMON MATERIALS FRAMEWORK

Human Health

Climate Health

Ecosystem Health

Circular Economy



Optima® 24" x 24" Tegular panels with Suprafine® 9/16" suspension system and integrated linear lighting

Create inspiring ceiling designs with higher ceiling heights, zero plenum interference, and on-center continuous or non-continuous customized layouts that provide clean, modern aesthetics.

### KEY SELECTION ATTRIBUTES

- Seamless integration between drywall ceilings and linear lighting for consistent fit and finish
- Leverage LED in long runs to create a monolithic look - varying length and on-center spacing true to design intent
- Faster and easier to build and install compared to traditional framed linear lighting
- Light fixture installs from below the ceiling to optimize ceiling heights

### VISUAL SELECTION

	Item No.	Description	Fixture Length
Drywall Linear Lighting (Linear Light Trim Kits designed to work with 5/8" drywall)	DGSLTK24	2' Linear Light Trim Kit	24" x 4"
	DGSLTK30	2' - 6" Linear Light Trim Kit	30" x 4"
	DGSLTK48	4' Linear Light Trim Kit	48" x 4"
	DGSLTK60	5' Linear Light Trim Kit	60" x 4"
	DGSLTK72	6' Linear Light Trim Kit	72" x 4"
	DGSLTK90	7' - 6" Linear Light Trim Kit	90" x 4"
	DGSLTK96	8' Linear Light Trim Kit	96" x 4"
	DGSLTK120	10' Linear Light Trim Kit	120" x 4"
	DGSLTKCON	10' Continuous Linear Light Trim Kit	10'

**new** AcoustiBuilt Linear Lighting

	Item No.	Description	Fixture Length
AcoustiBuilt Linear Lighting	DGSLACBTK24	2' Linear Light Trim Kit	24" x 4"
	DGSLACBTK30	2' - 6" Linear Light Trim Kit	30" x 4"
	DGSLACBTK48	4' Linear Light Trim Kit	48" x 4"
	DGSLACBTK60	5' Linear Light Trim Kit	60" x 4"
	DGSLACBTK72	6' Linear Light Trim Kit	72" x 4"
	DGSLACBTK90	7' - 6" Linear Light Trim Kit	90" x 4"
	DGSLACBTK96	8' Linear Light Trim Kit	96" x 4"
	DGSLACBTK120	10' Linear Light Trim Kit	120" x 4"
	DGSLACBTKCON	10' Continuous Linear Light Trim Kit	10'

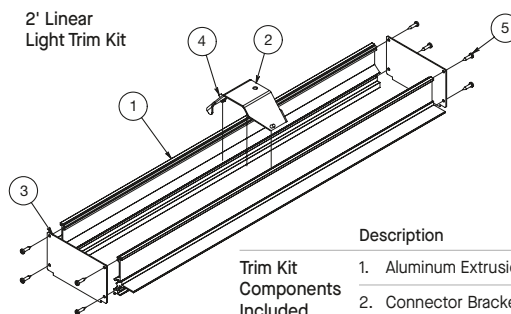
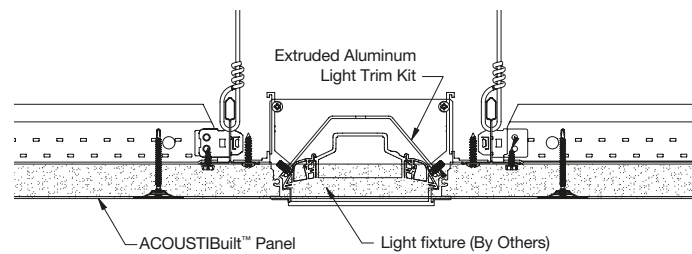
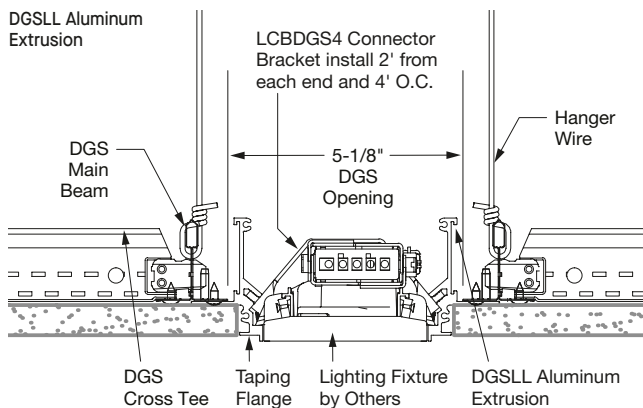

### LIGHTING FIXTURES

Compatible with BASO LENO® Luminaire and Axis Click

For detailed lighting information, contact your local BASO representative.



### Description

1. Aluminum Extrusions (2)
2. Connector Bracket (varies)
3. End Plates (2)
4. #8-32 x 5/16" Pan Head Machine Screws
5. #6-20 x 5/8" Pan Head Sharp Point Screws

# LIGHTING SOLUTIONS

## Linear T-BAR LED Lighting



T-Bar LED installation

Zero plenum lighting fixture integrates with Armstrong® LED cross tee clips for seamless integration.

### KEY SELECTION ATTRIBUTES

- Popular linear light fixture available in two lengths with four different lens options, compatible with most Armstrong® 15/16" and 9/16" suspension systems
- Sleek energy-efficient design reduces energy use up to 50% over conventional lighting
- Low-profile design is perfect for use in crowded plenum spaces such as hospitals and corridors
- Seismic D,E, F compliant and pre-engineered to install with all 15/16" and 9/16" Armstrong® suspension systems

### LINEAR LIGHTING FOR ZERO PLENUM APPLICATIONS

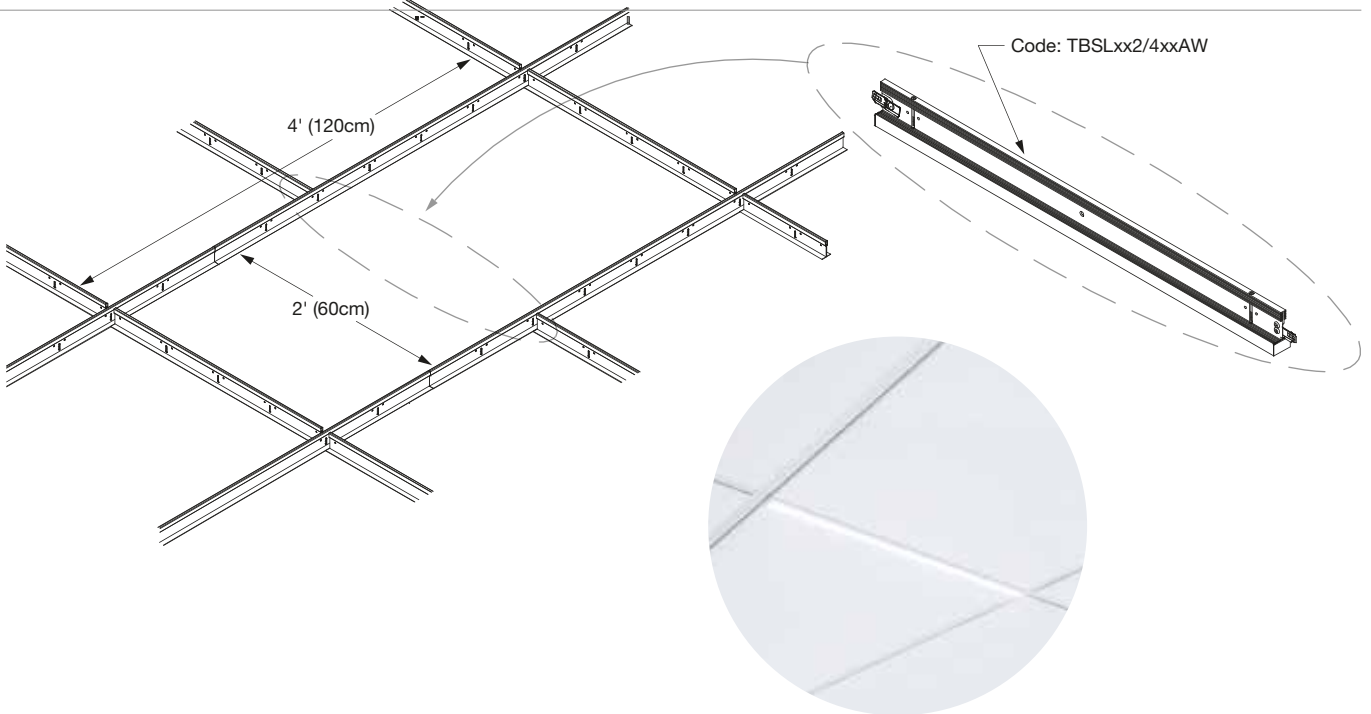

### SUSPENSION SYSTEMS

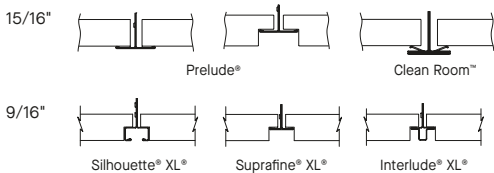

### LIGHTING FIXTURES

JLC • tech

T-BAR LED specified, sold and installed through typical electrical channel. For more information visit JLC-Tech at [www.tbarledsmartlight.com](http://www.tbarledsmartlight.com)



INTEGRATED CEILING SOLUTIONS – Standard

# LIGHTING SOLUTIONS

## Linear On-Center Lighting for Acoustical Panels

RECYCLED  
CONTENT

LEED V5

Ecomedes Data

UP TO  
**50%**

COMMON MATERIALS FRAMEWORK

Human Health

Climate Health

Ecosystem Health

Circular Economy



Optima® 24" x 24" Tegular panels with Suprafine® 9/16" suspension system and integrated linear lighting

Continuous or non-continuous on-center linear lighting layouts – inspiring symmetry to match your building design.

### KEY SELECTION ATTRIBUTES

- Zero Interference – Eliminates interference with mechanicals in the plenum
- Zero Construction Coordination – Install from below to speed construction
- Zero Independent Suspension – No independent suspension is required; approved for Seismic D, E, F installations

### COLOR

Standard



White (WH)

Due to printing limitations, shade may vary from actual product.

**1 Ctn Min  
FASTSIZE  
3 WEEKS  
order to ship**

\* FastSize panels and suspension systems are identified in this catalog by this symbol on product pages.

Using a combination of FastSize™ factory-finished ceiling panels and suspension systems, perfect lighting layouts like this are easy to specify and install.

### ON-CENTER LIGHTING FOR ACOUSTICAL APPLICATIONS

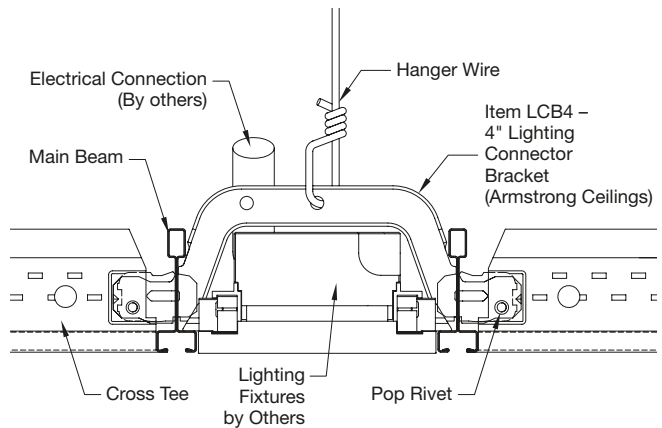
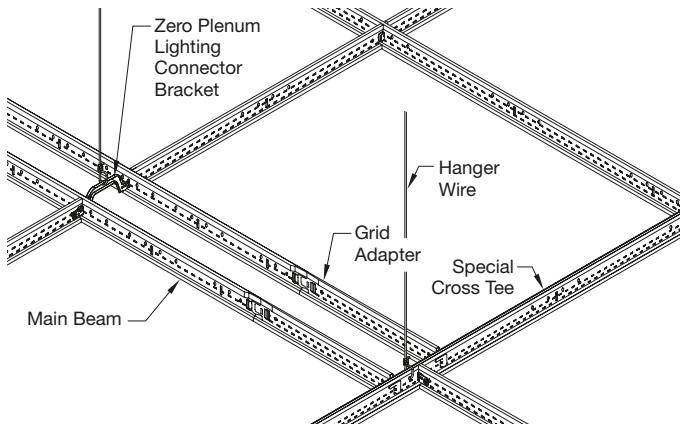

### ACCESSORIES

#### Cross Tee Adapter Clip (XTAC)



- Create a sleek ceiling design with uninterrupted ribbons of light
- Alternate continuous lights and diffusers with other services for a monolithic, uncluttered visual
- Easy installation
- Seismic tested
- Ability to use with 4" and 6" configurations

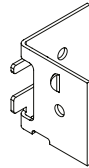

#### TechZone® Ceiling Systems Bracing Clip (TZBC)

Use to connect cross tees to the main beam of the continuous technical zone when no yoke is present.

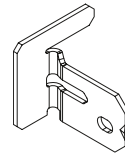

#### STAC Clip

Allows you to create strong, code compliant, non-seismic and seismic D, E, F main beam-to-cross tee connections.

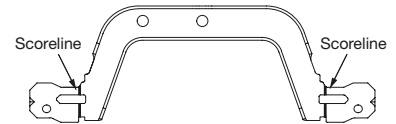

### PHYSICAL DATA

**Material**  
Commercial quality extruded aluminum alloy 6063

**Surface Finish**  
Factory-applied baked polyester paint finish

**Warranty**  
10-Year Limited Warranty; 30-Year System Warranty

### LIGHTING FIXTURES

Compatible with BASO™ LENO® Luminaire and Axis Click

**BASO axis**

For detailed lighting information, contact your local BASO representative.

INTEGRATED CEILING SOLUTIONS – Standard

# LIGHTING SOLUTIONS FORMATIONS™ Clouds

Linear LED Recessed Lighting Kits



Formations™ cloud with integrated linear lighting

The epitome of simple sophistication – LED lighting in Formations™ Clouds provides unrivaled performance and a truly innovative design.

### KEY SELECTION ATTRIBUTES

- Offers best possible combination of lighting control and brightness
- Creates a balanced luminous environment with smooth, even gradients of light
- Easy to install
- Unique cable-cinch design saves time and money
- Offers wide-row spacing to create uniform illumination using fewer fixtures and less energy



### VISUAL SELECTION

Cloud Size	Suspension Kit Item No. (Axiom® Vector Trim & Suspension System)
Formations™ Clouds Linear Lighting Kits	
6' x 8'	L0608T_AV_ _ _
8' x 8'	L0808T_AV_ _ _
8' x 10'	L0810T_AV_ _ _
* 10' x 10'	L1010T_AV_ _ _

### PANEL SELECTION

Optima® Beveled Tegular Panels		Ultima® Beveled Tegular Panels		Calla® Beveled Tegular Panels		Lyra® Square Tegular Panels	
24" x 24"		24" x 24"		24" x 24"		24" x 24"	
15/16"	9/16"	15/16"	9/16"	15/16"	9/16"	15/16"	9/16"
3354	3251	1911	1912	2822	2824	8360	8361
3354	3251	1911	1912	2822	2824	8360	8361
3354	3251	1911	1912	2822	2824		
30" x 30"		30" x 30"		30" x 30"		30" x 30"	
3258		1905		N/A		N/A	

\* 10' x 10' Formations Clouds must use 9/16" suspension system only (Suprafine® or Interlude® XL® HRC)

### PLANKS CLOUD SHAPE AND SIZE SELECTION

#### 24" x 24" Panels



6' x 8'



8' x 8'



8' x 10'

#### 30" x 30" Panels



10' x 10'

### LIGHTING FIXTURES

Compatible with:

- Focal Point (Avenue™ or Seem™)
- BASO™ (LENO® Luminaire, Axis Click)
- USAI Lighting (BeveLED®, CONNECT Family)



### SUSPENSION SYSTEMS

15/16"

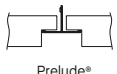

Prelude®

9/16"

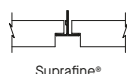

Suprafine®

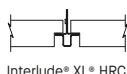

Interlude® XL® HRC

View installation videos or download CAD, Revit®, and SketchUp® files at [armstrongceilings.com/formations](http://armstrongceilings.com/formations)

INTEGRATED CEILING SOLUTIONS – Standard