

OPF

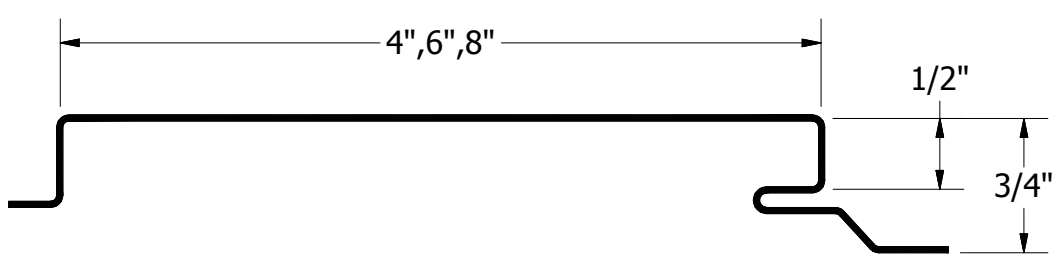

OPM

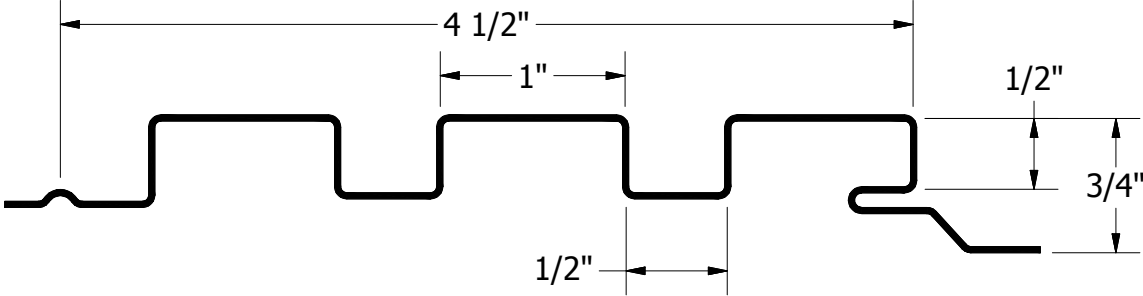

OPN

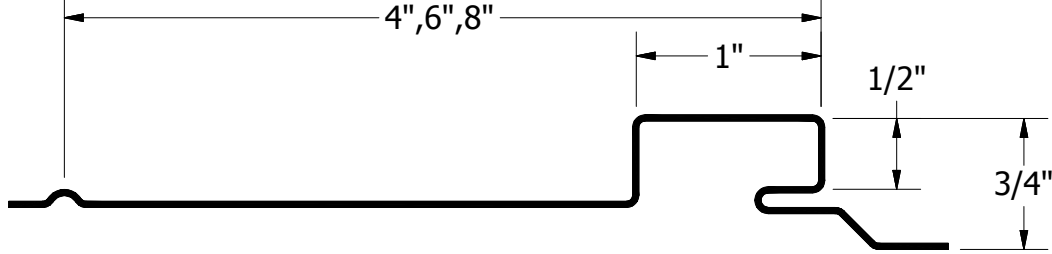

OPW

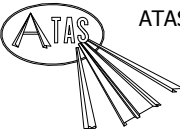
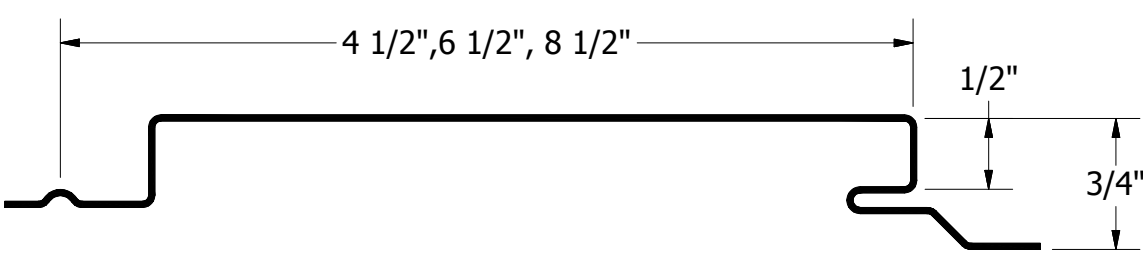

ATAS INTERNATIONAL, INC
Allentown PA
610-395-8445
Mesa AZ
480-558-7210

TITLE			
Opaline Line Drawing Detail			
DWG. NO.		DR	DATE
		KRK	4/16/2015
		APP	DATE
		DAS	8/4/16
MATERIAL		SH. SIZE	SCALE
		B	X:X

REV. NO.	DATE	DESCRIPTION OF REVISION	BY	APP

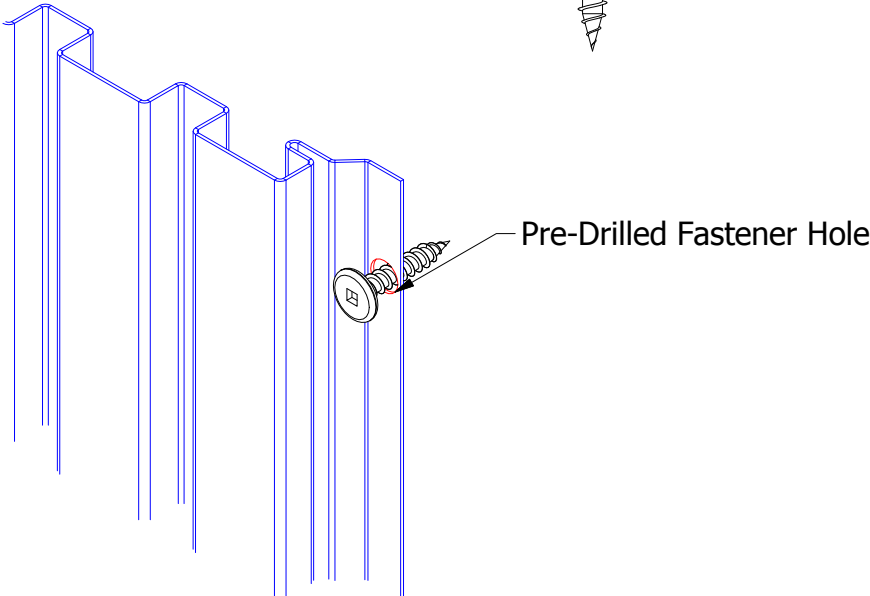
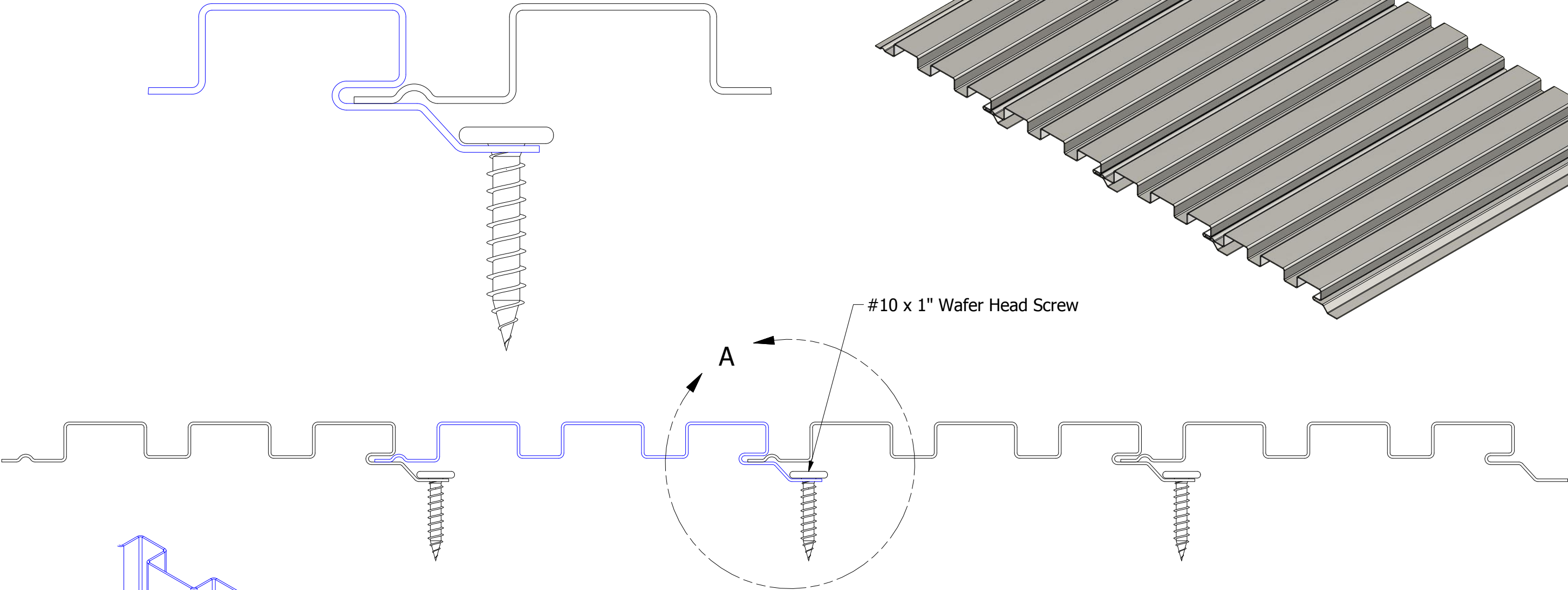
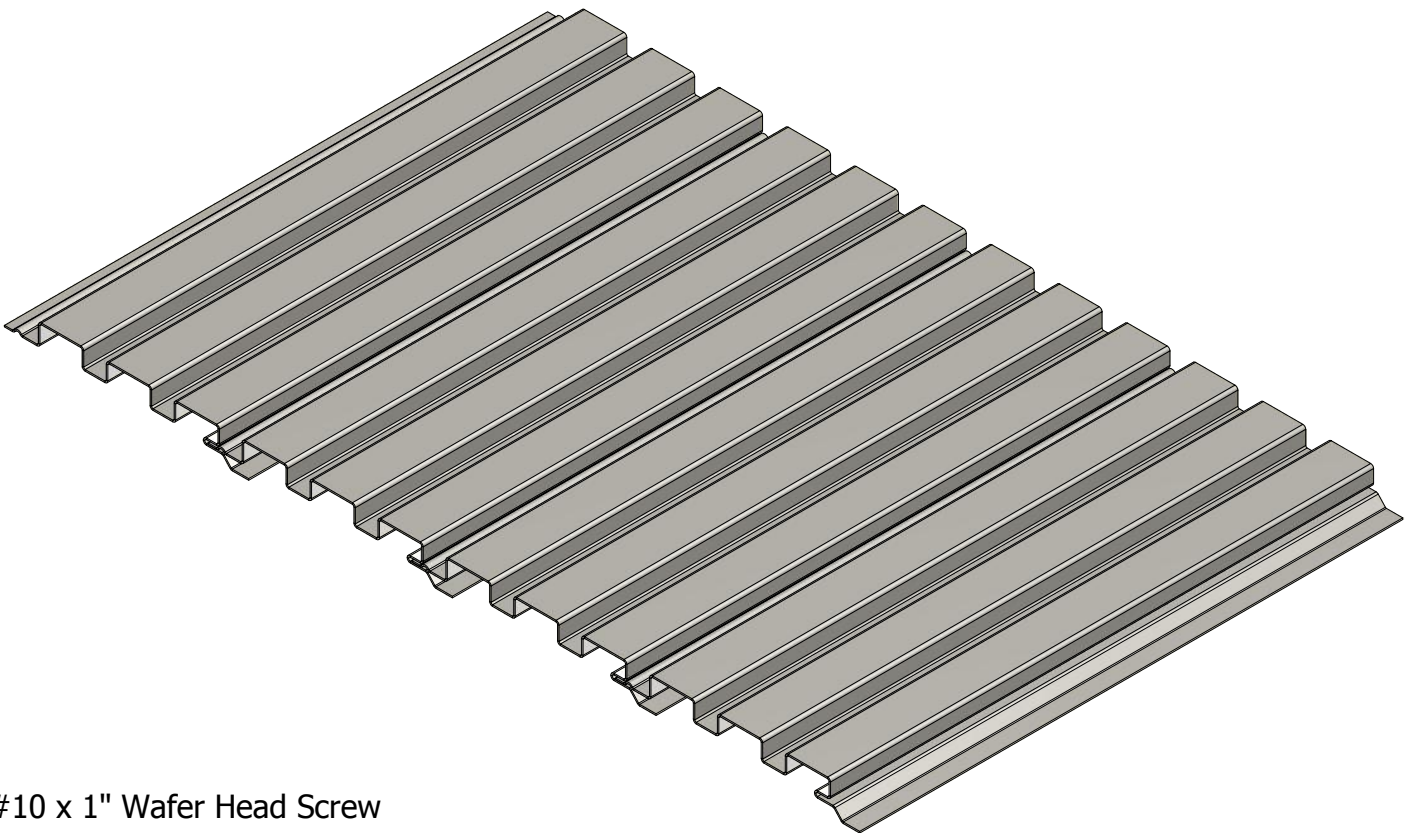

Pre-Drill Fastener Holes for Panels Greater than 20'-0" in Length



ATAS INTERNATIONAL, INC
Allentown PA
610-395-8445
Mesa AZ
480-558-7210

TITLE Opaline Panel Installation Detail			
DWG. NO.		DR DMR	DATE 10/18/2016
MATERIAL		APP	DATE
REV. NO.	DATE	DESCRIPTION OF REVISION	BY APP
SH. SIZE B		SCALE X:X	

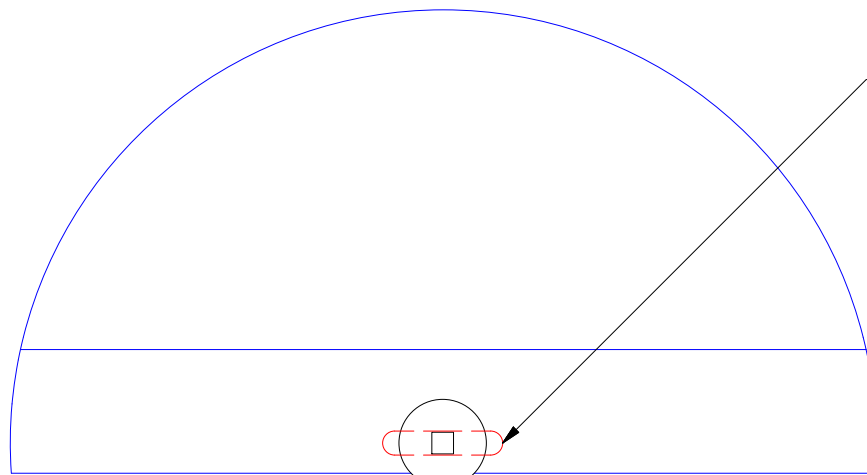
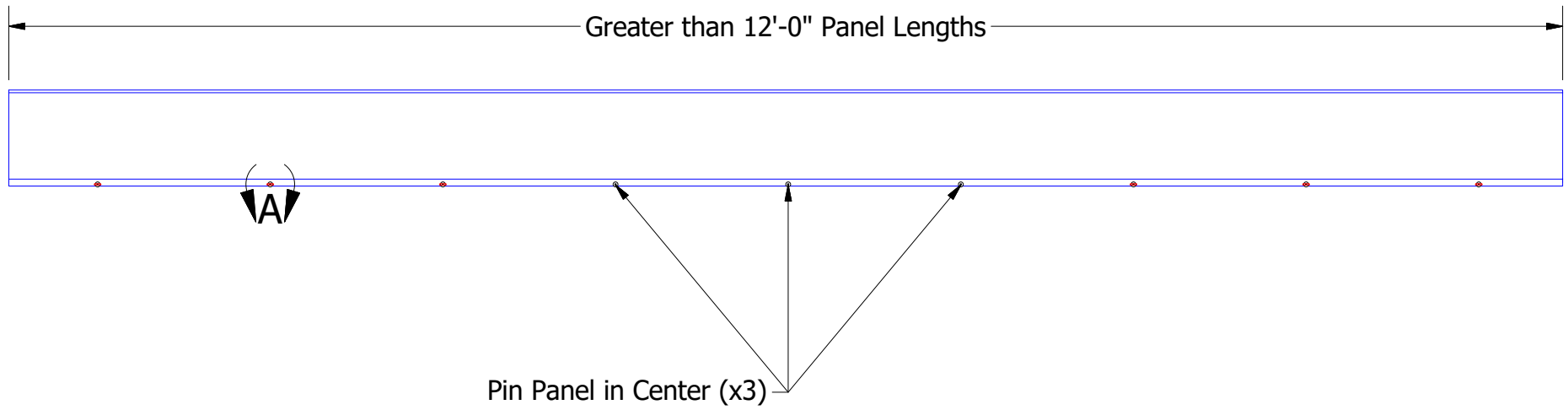

DETAIL A

Field Pre-Punch Fastener Slots to allow for Panel Expansion and Contraction.

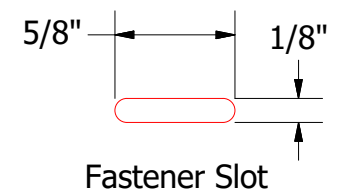

Secure Fastener in Center of the Slot



ATAS INTERNATIONAL, INC
Allentown PA
610-395-8445
Mesa AZ
480-558-7210

TITLE			Opaline Fastener Slots Detail	
DWG. NO.			DR	DATE
			DMR	5/13/2021
MATERIAL			APP	DATE
			SH. SIZE	SCALE
			A	X:X

REV. NO.	DATE	DESCRIPTION OF REVISION	BY	APP

Horizontal Panel

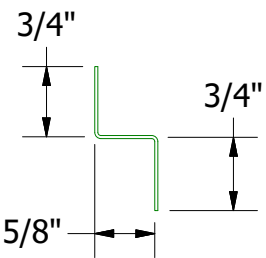
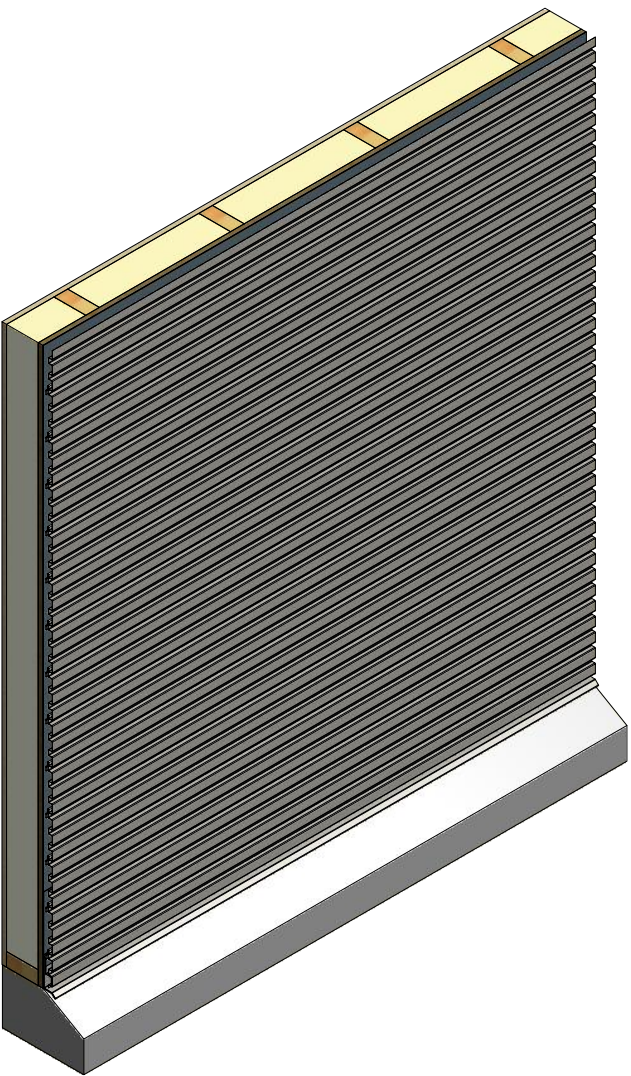
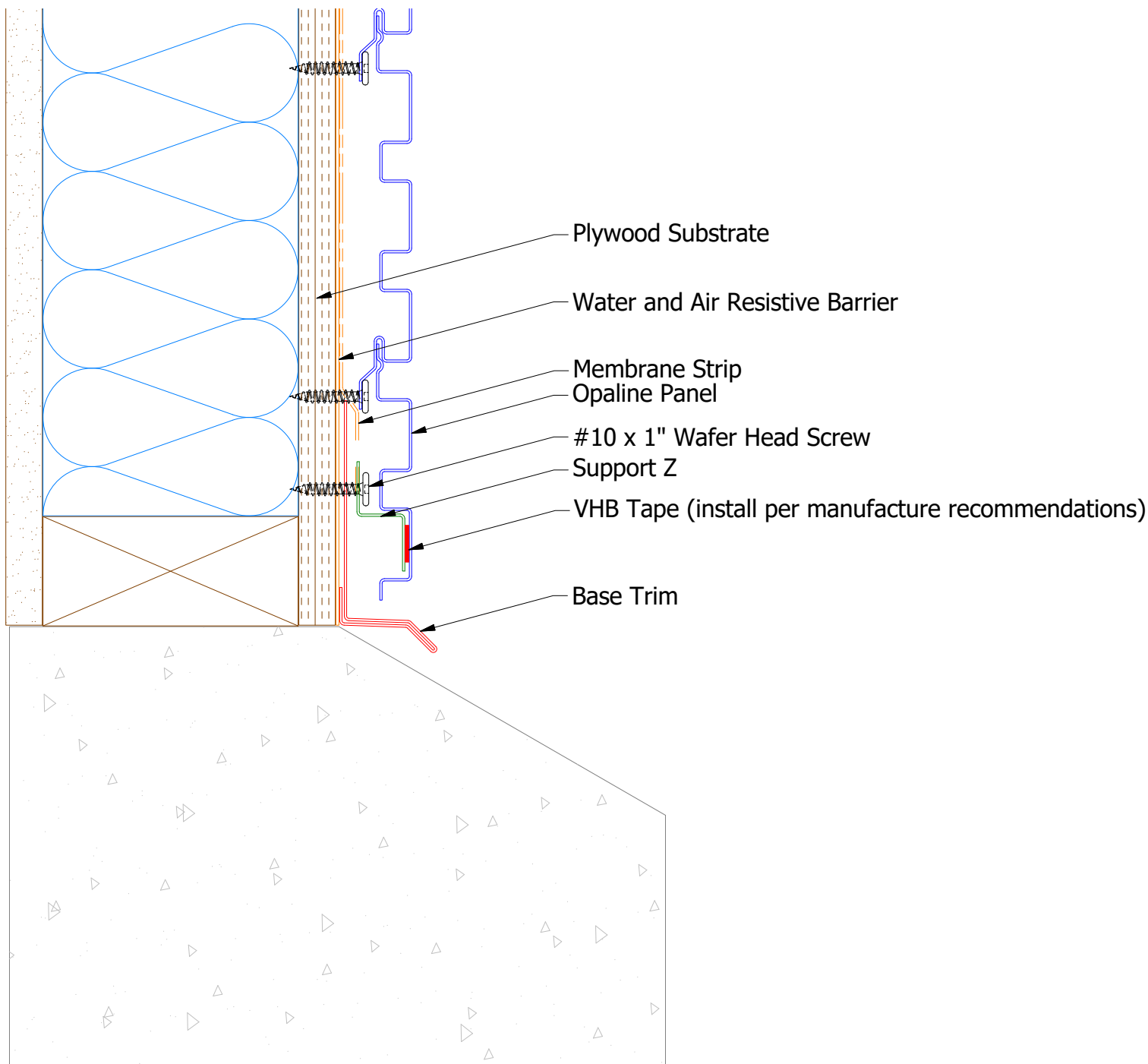

OPA681 - Support Z

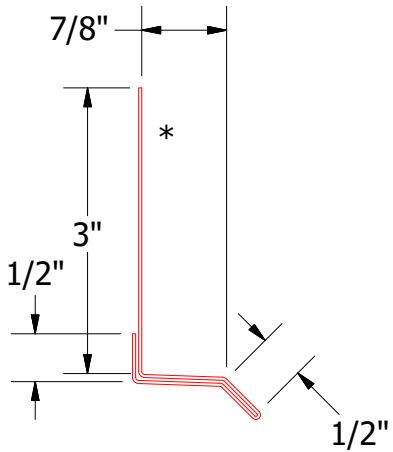

OPA661 - Base Trim

Note: * denotes color side.
Note: Stainless Steel Pop Rivets maybe needed along with VHB Tape for longer Panels.

				TITLE			
				Opaline Base Detail			
		DWG. NO.		DR	MBP	DATE 7/5/2016	
01		8/27/2021		APP	DAS	DATE 7/28/16	
REV. NO.		DATE		DESCRIPTION OF REVISION		BY	APP
						SH. SIZE	SCALE
						B	X:X



ATAS INTERNATIONAL, INC
Allentown PA
610-395-8445
Mesa AZ
480-558-7210

Horizontal Panel

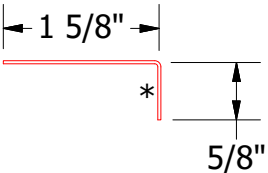
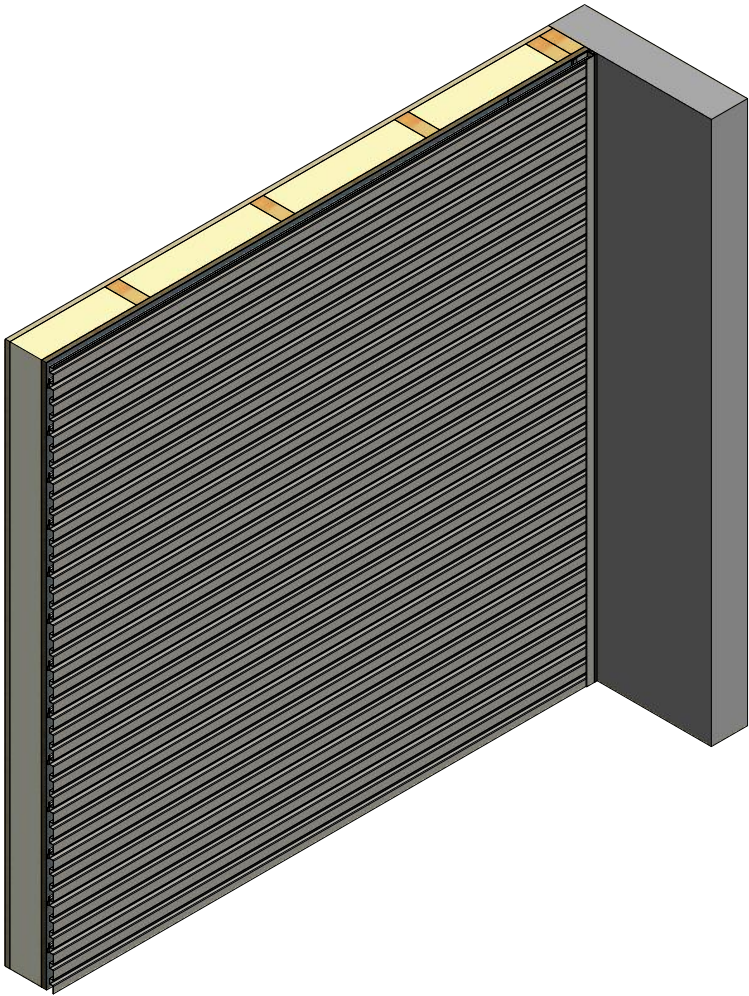
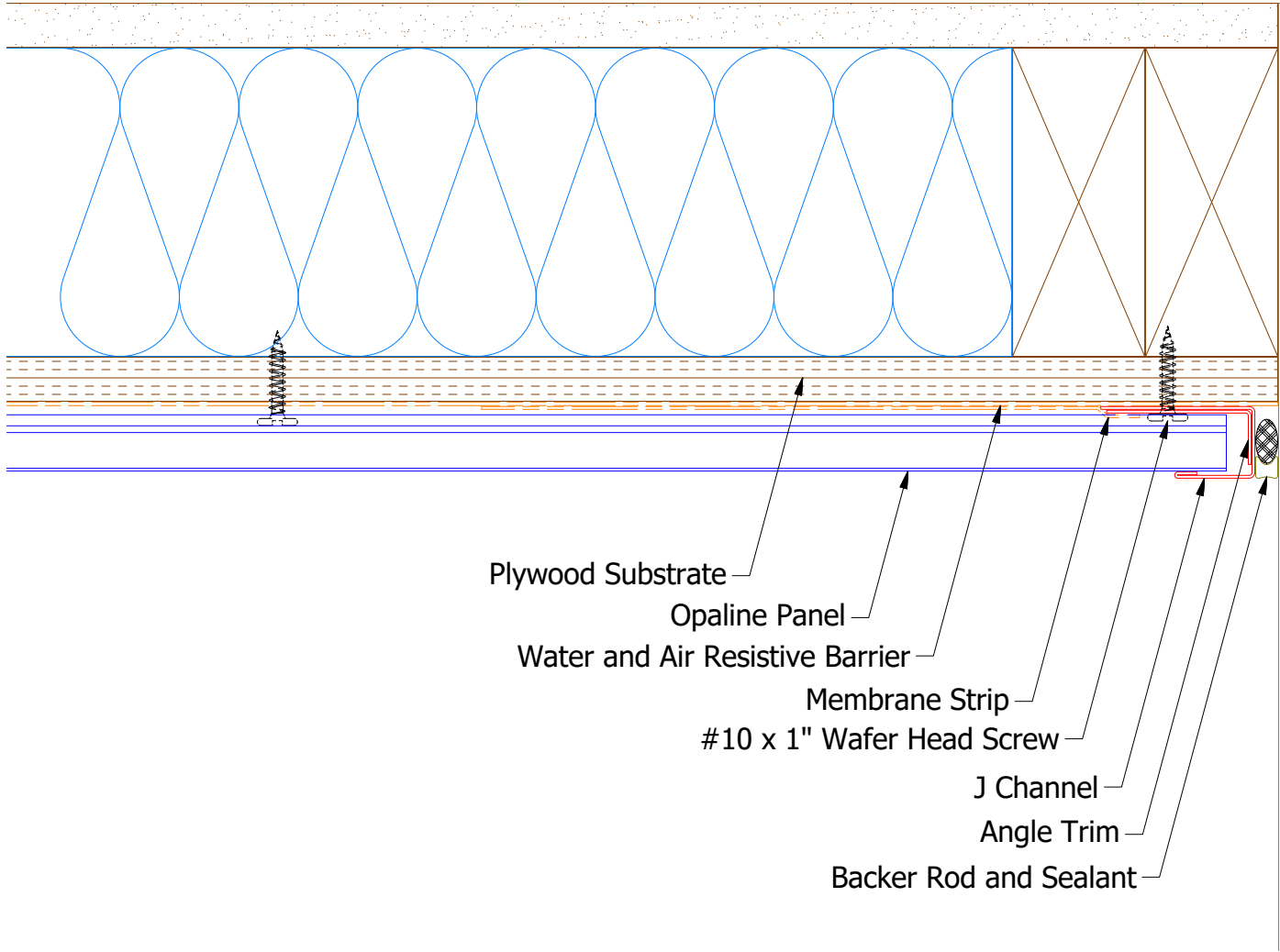

OPA680 - Angle Trim

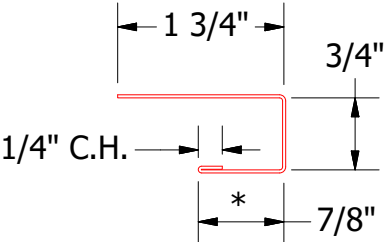

OPA034 - J Channel

Note: * denotes color side.

				TITLE			
				Opaline Endwall Detail			
				DWG. NO.		DR MBP	DATE 7/6/2016
						APP DAS	DATE 7/28/16
				MATERIAL		SH. SIZE B	SCALE X:X
REV. NO.	DATE	DESCRIPTION OF REVISION	BY	APP			

Horizontal Panel

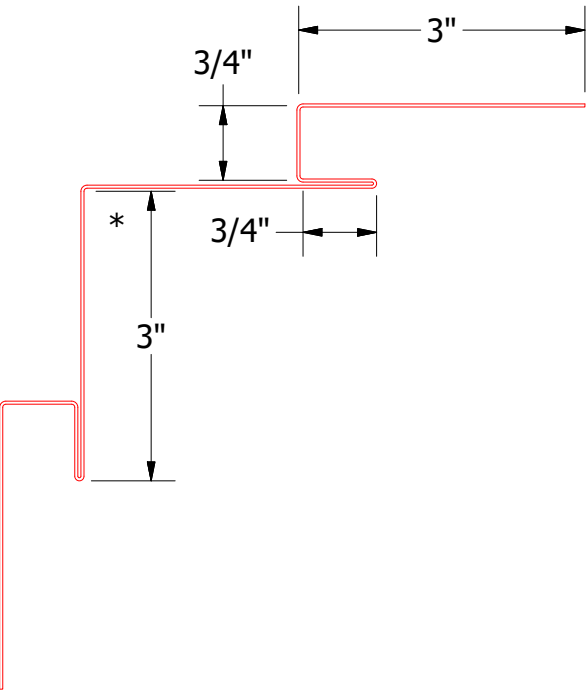
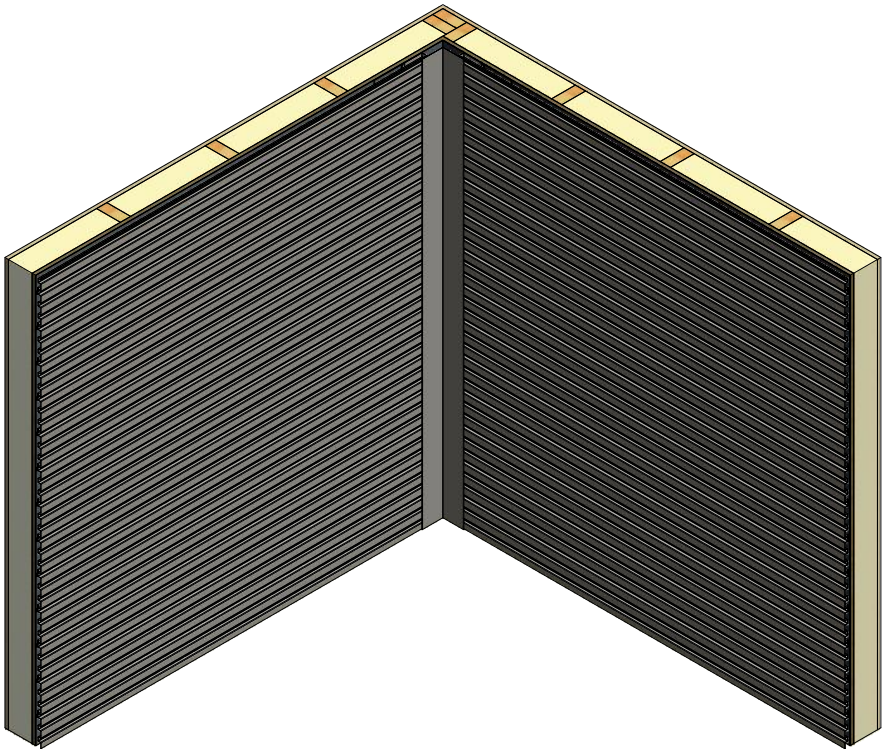
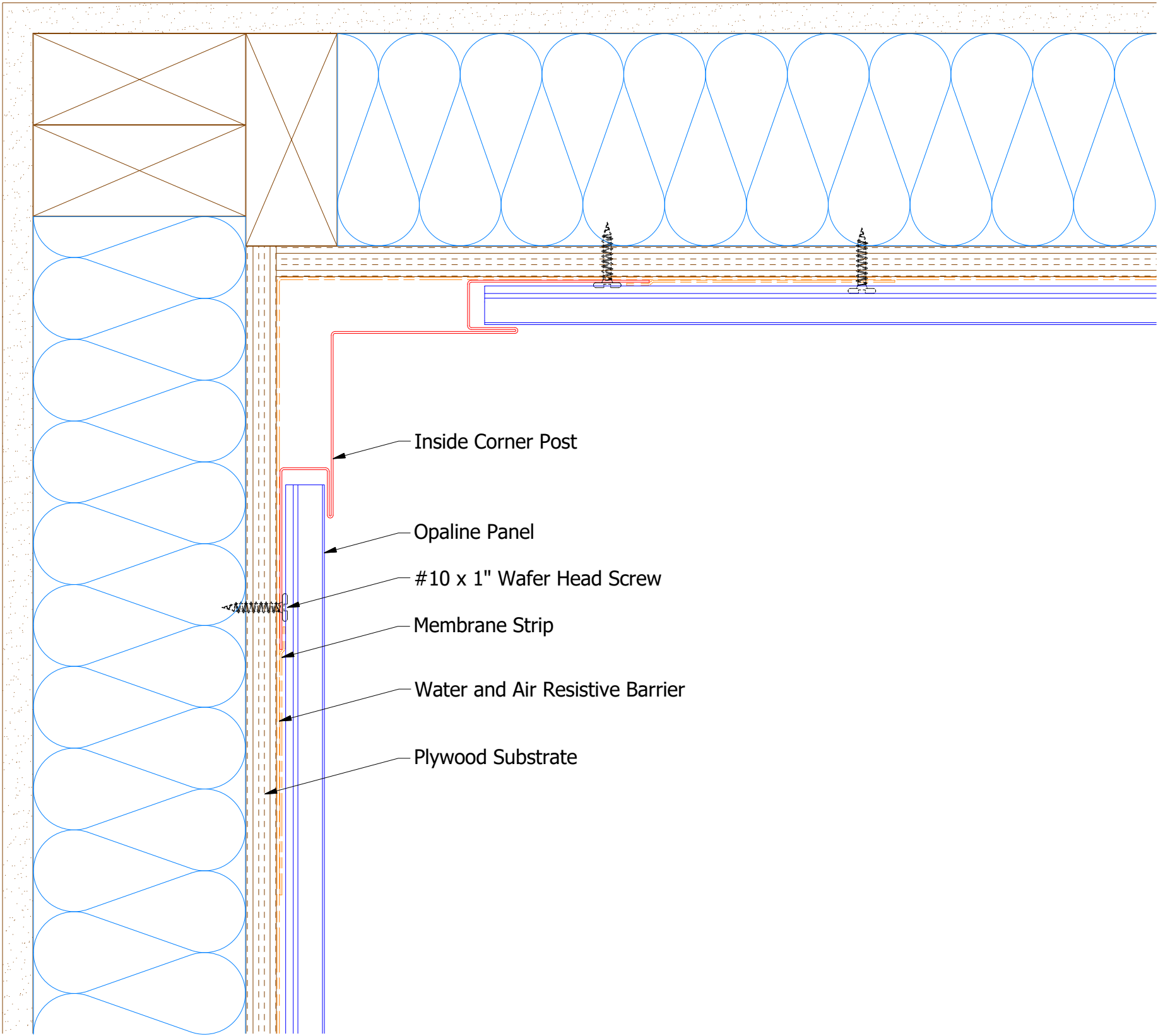

OPA601 - Inside Corner Post

Note: * denotes color side.

					<div><div><div>ATAS</div></div><div>ATAS INTERNATIONAL, INC Allentown PA 610-395-8445 Mesa AZ 480-558-7210</div></div>	
					TITLE Opaline Inside Corner Detail	
		DWG. NO.			DR MBP	DATE 7/6/2016
					APP DAS	DATE 7/28/16
		MATERIAL			SH. SIZE B	SCALE X:X
REV. NO.	DATE	DESCRIPTION OF REVISION		BY	APP	

Horizontal Panel

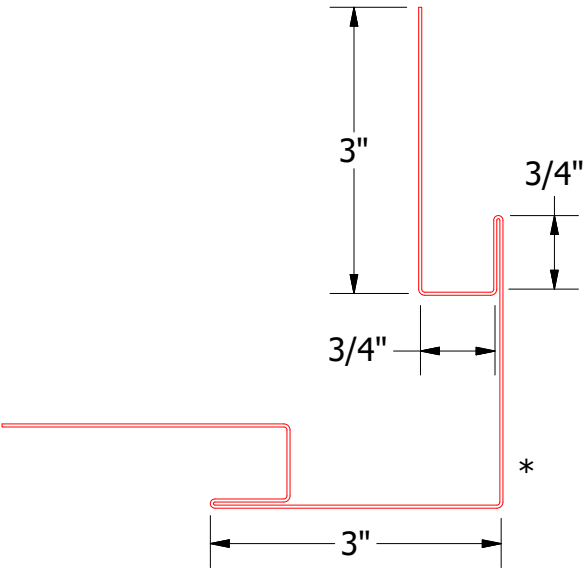
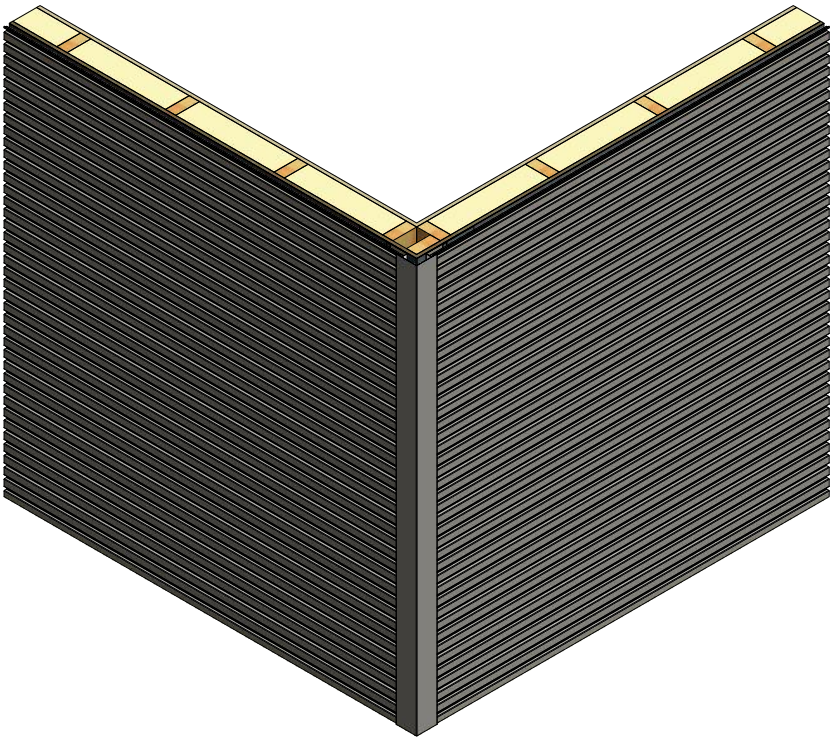
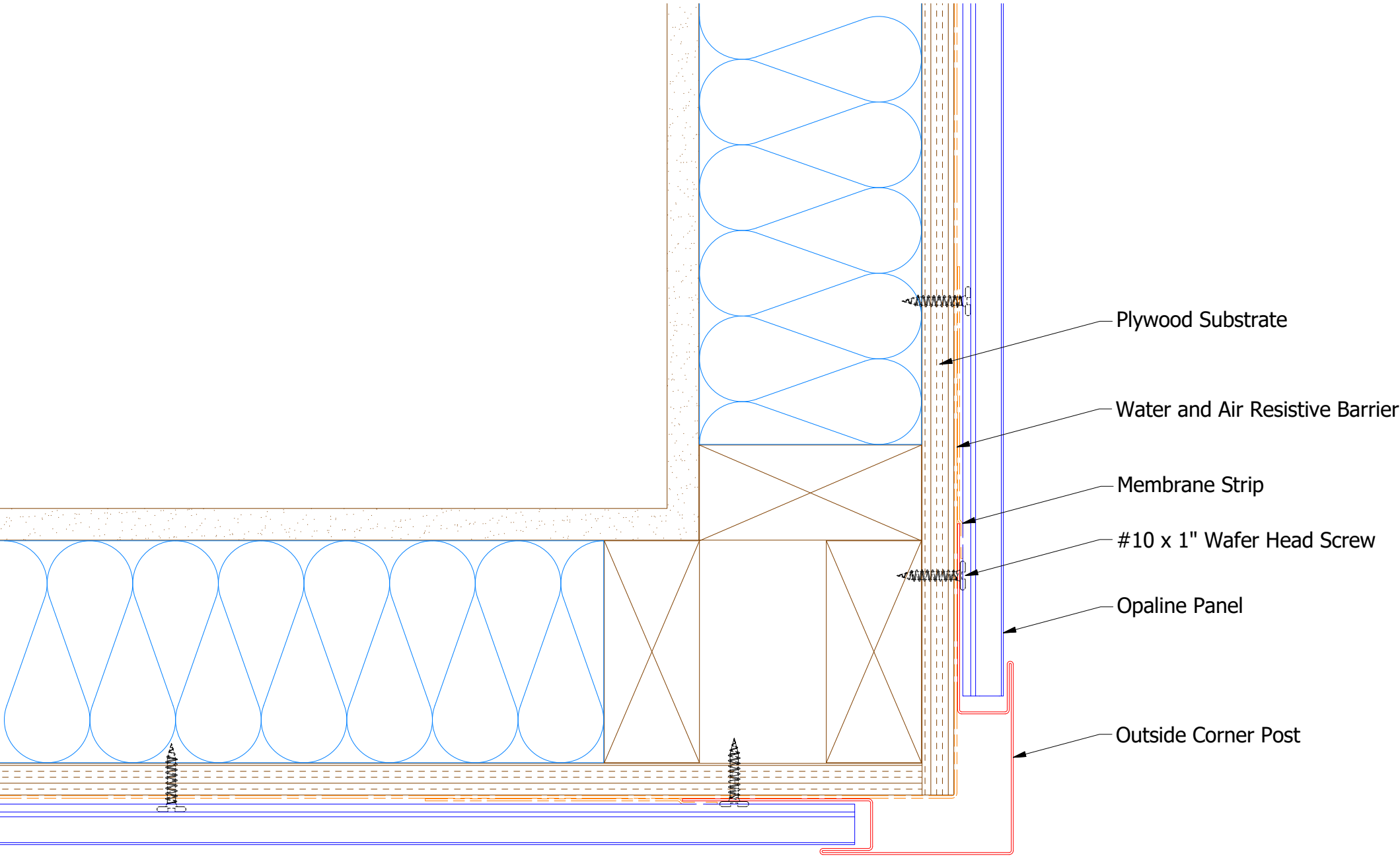

OPA602 - Outside Corner Post

Note: * denotes color side.

						TITLE		Opaline Outside Corner Detail	
						DWG. NO.		DR	DATE
								MBP	7/6/2016
								APP	DATE
								DAS	7/28/16
								SH. SIZE	SCALE
								B	X:X
REV. NO.	DATE	DESCRIPTION OF REVISION			BY	APP			



ATAS INTERNATIONAL, INC
Allentown PA
610-395-8445
Mesa AZ
480-558-7210

Horizontal Panel

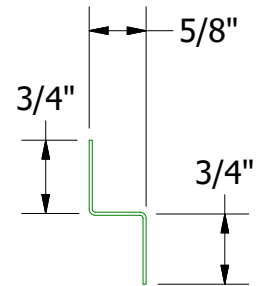
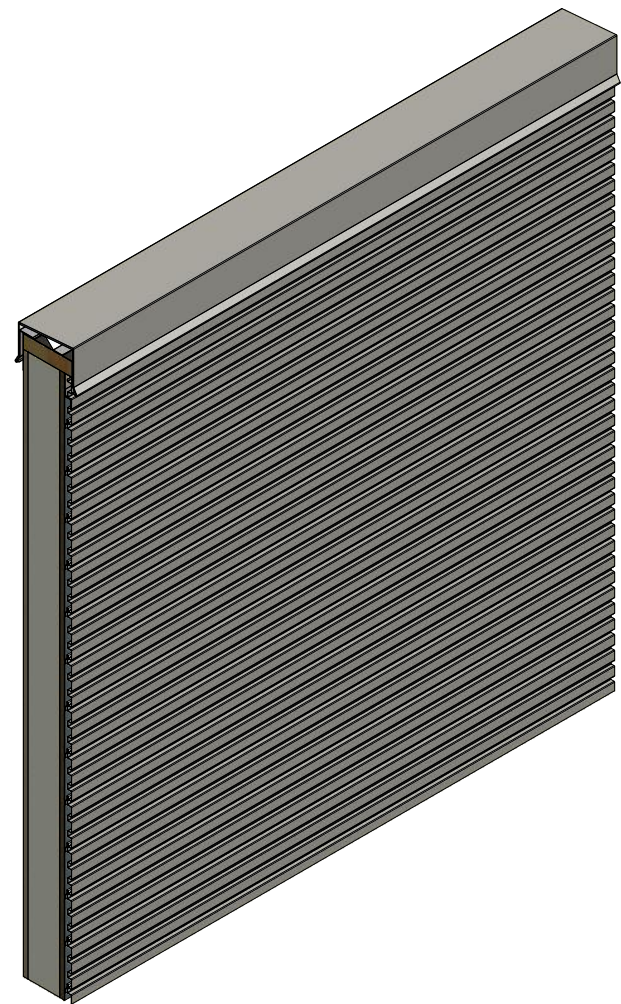
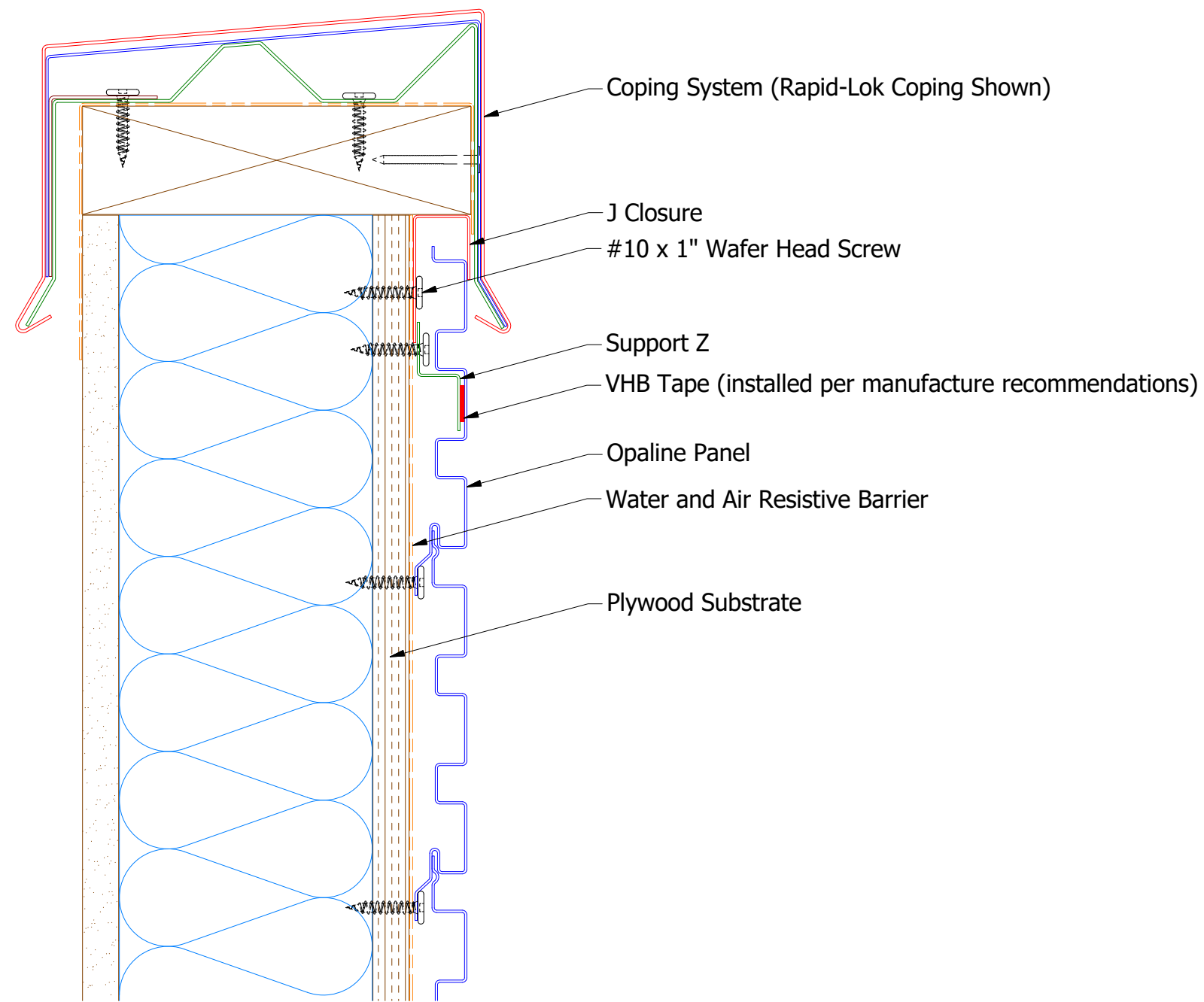

OPA681 - Support Z

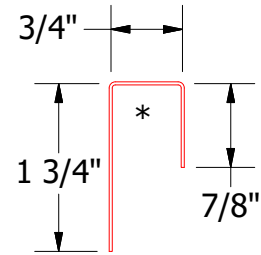

OPA270 - J Closure

Note: * denotes color side.
Note: stainless steel pop rivets maybe needed along with VHB tape for longer panels.

						TITLE		Opaline Top of Wall Detail	
						DWG. NO.		DR	DATE
01		8/31/2021		Changed Pop Rivets to VHB Tape		KRK		MBP	7/6/2016
REV. NO.		DATE		DESCRIPTION OF REVISION		BY		APP	MATERIAL
								DAS	DATE
								SH. SIZE	SCALE
								B	X:X

Horizontal Panel

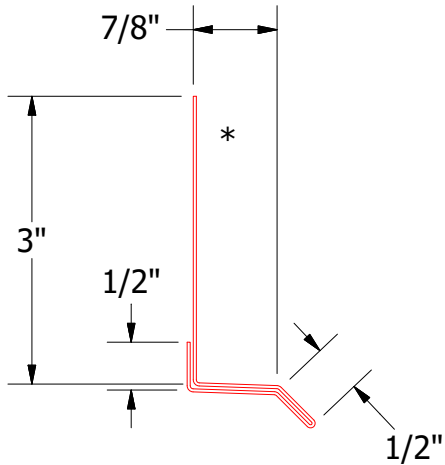
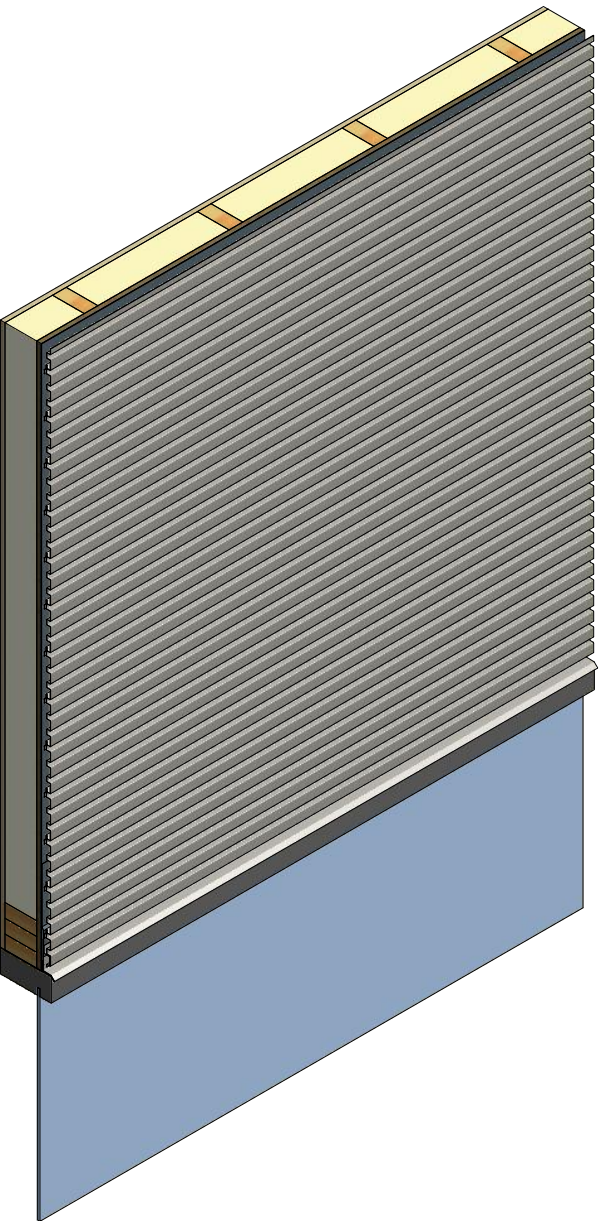
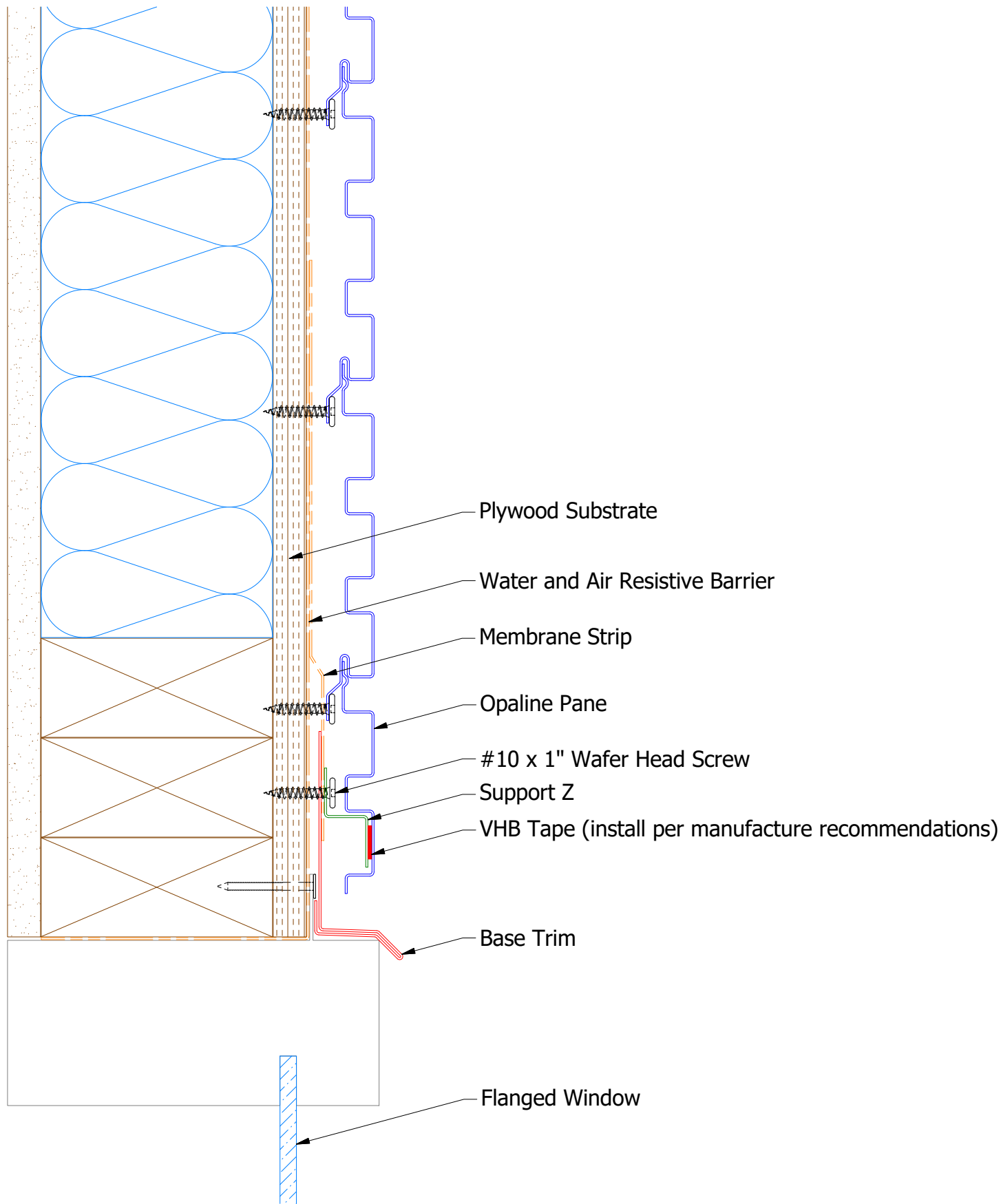

OPA661 - Base Trim

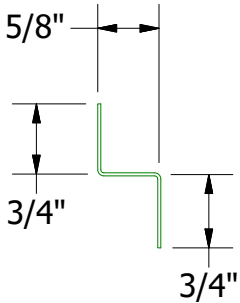

OPA681 - Support Z

		ATAS INTERNATIONAL, INC Allentown PA 610-395-8445 Mesa AZ 480-558-7210	
TITLE Opaline Head Window Flange Detail			
DWG. NO.		DR MBP	DATE 7/31/2018
MATERIAL		APP	DATE
		SH. SIZE B	SCALE X:X

Note: * denotes color side.
Note: stainless steel pop rivets maybe needed along with VHB tape for longer panels.

01	8/30/2021	Changed Pop Rivet to VHB Tape	KRK		
REV. NO.	DATE	DESCRIPTION OF REVISION	BY	APP	

Horizontal Panel

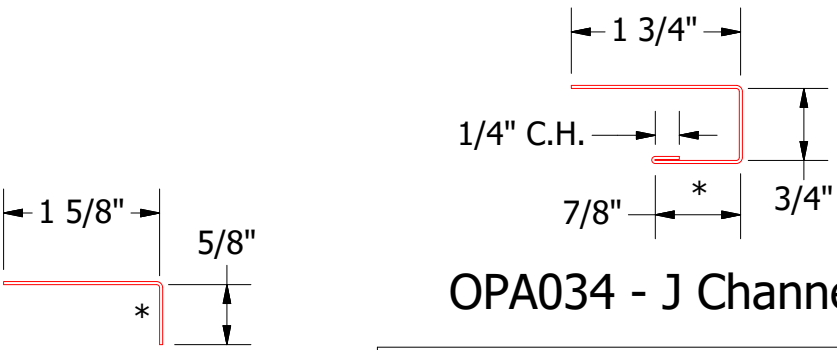
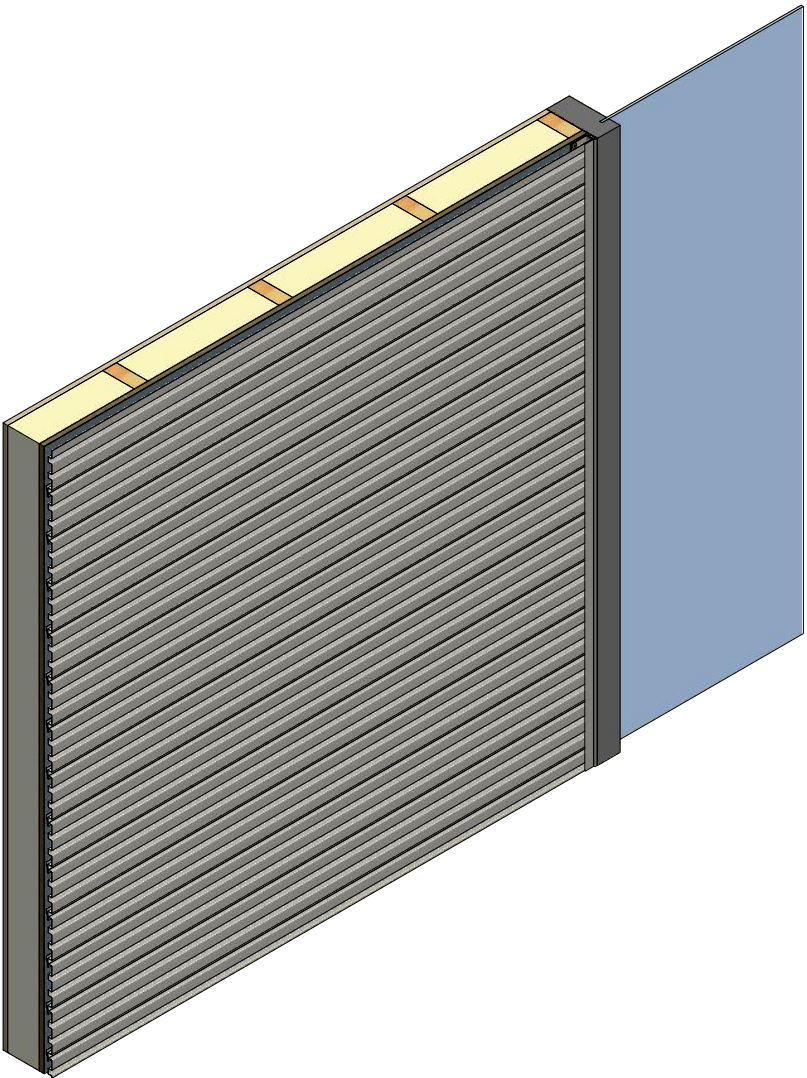
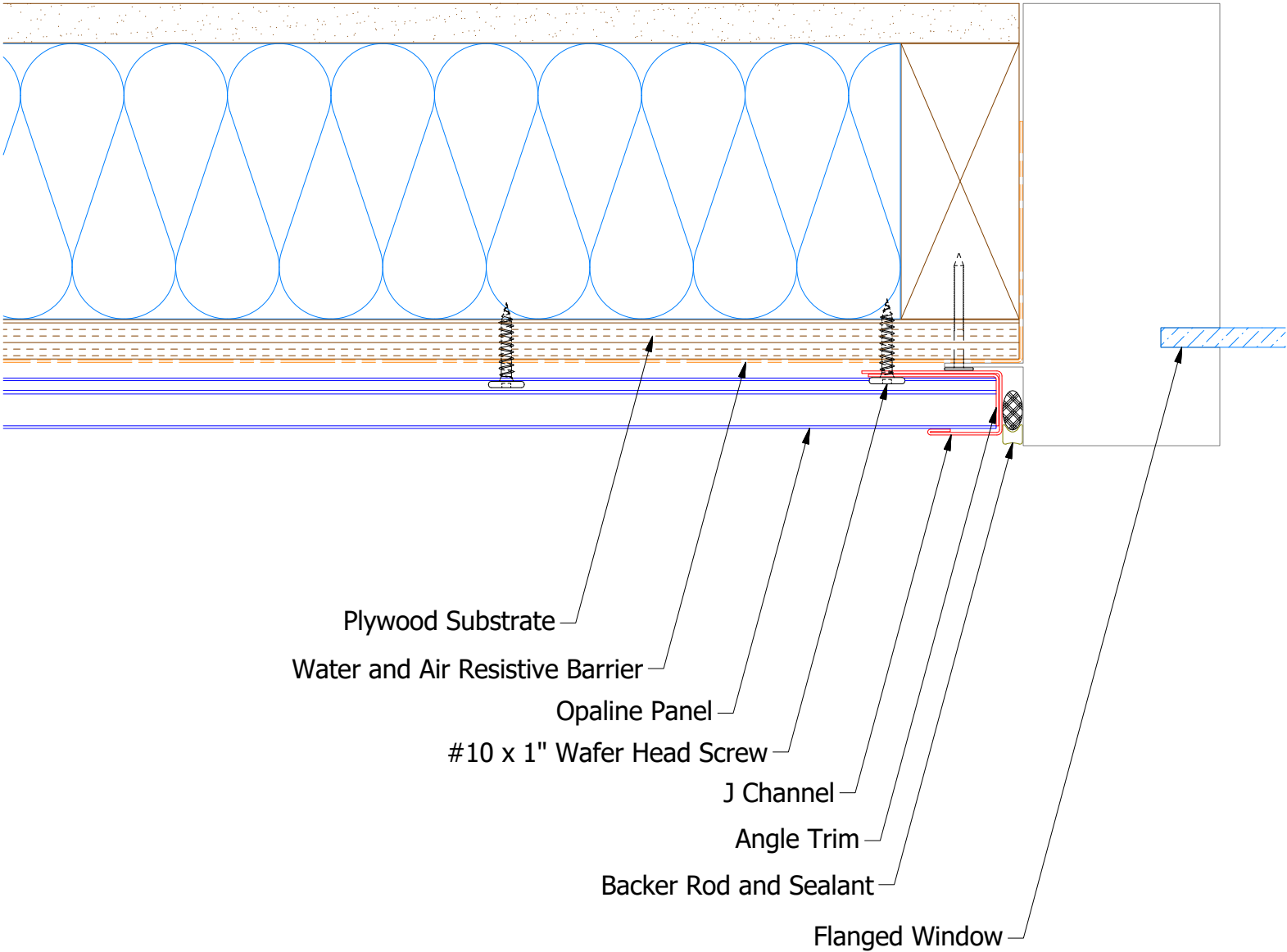

OPA034 - J Channel

OPA680 - Angle Trim

Note: * denotes color side.

		ATAS INTERNATIONAL, INC Allentown PA 610-395-8445 Mesa AZ 480-558-7210	
TITLE Opaline Jamb Window Flange Detail			
DWG. NO.		DR MBP	DATE 7/31/2018
MATERIAL		APP	DATE
		SH. SIZE B	SCALE X:X

REV. NO.	DATE	DESCRIPTION OF REVISION	BY	APP

Horizontal Panel

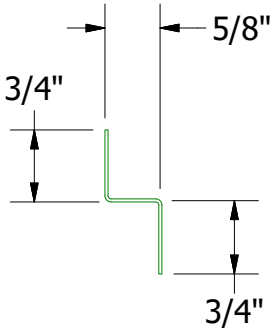
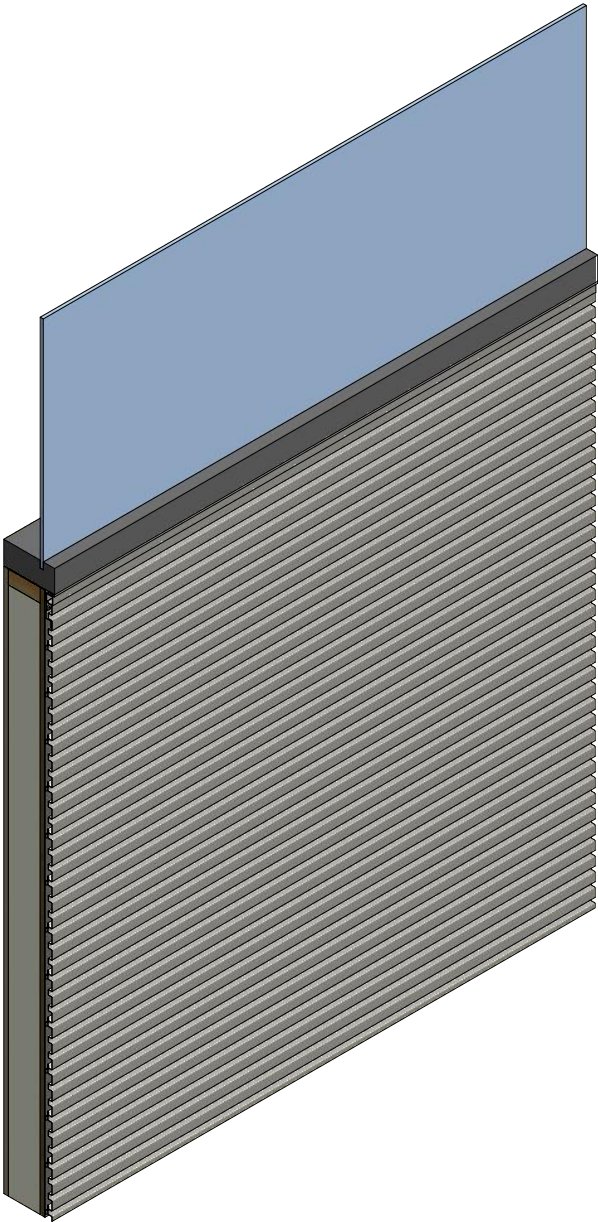
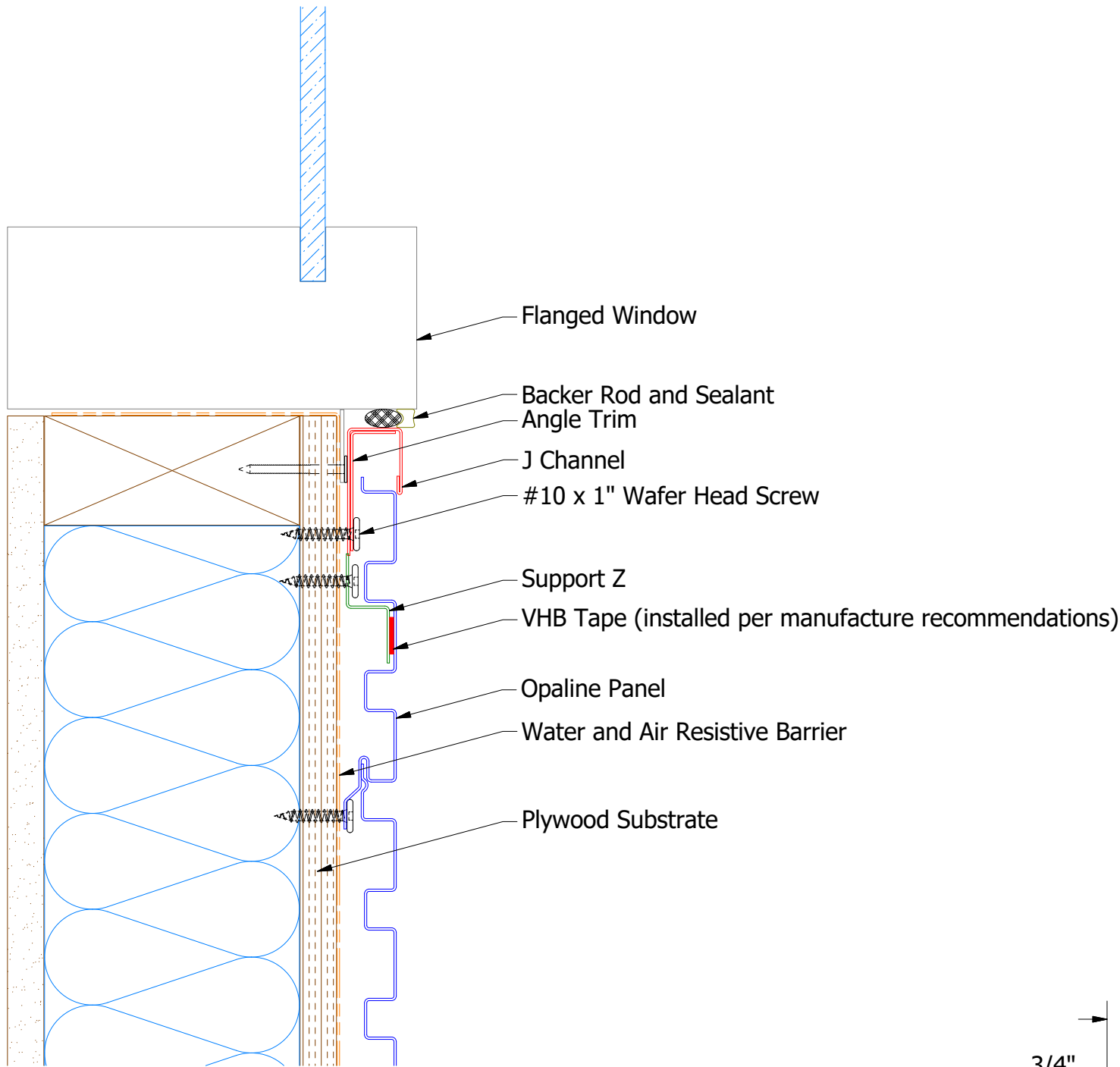

OPA681 - Support Z

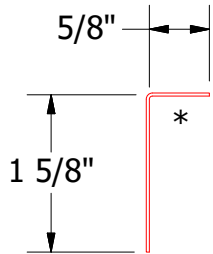

OPA680 - Angle Trim

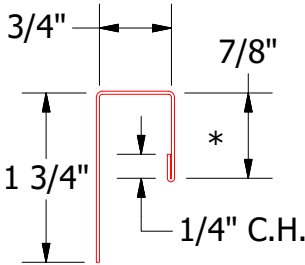

OPA034 - J Channel

Note: * denotes color side.
Note: stainless steel pop rivets maybe needed along with VHB tape for longer panels.

				ATAS INTERNATIONAL, INC Allentown PA 610-395-8445 Mesa AZ 480-558-7210			
				TITLE Opaline Window Sill Flange Detail			
		DWG. NO.		DR MBP		DATE 7/31/2018	
01		8/31/2021		APP		DATE	
REV. NO.		DATE		DESCRIPTION OF REVISION		BY APP	
						SH. SIZE B	
						SCALE X:X	

Horizontal Panel

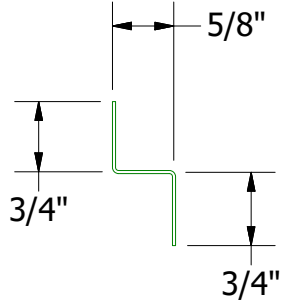
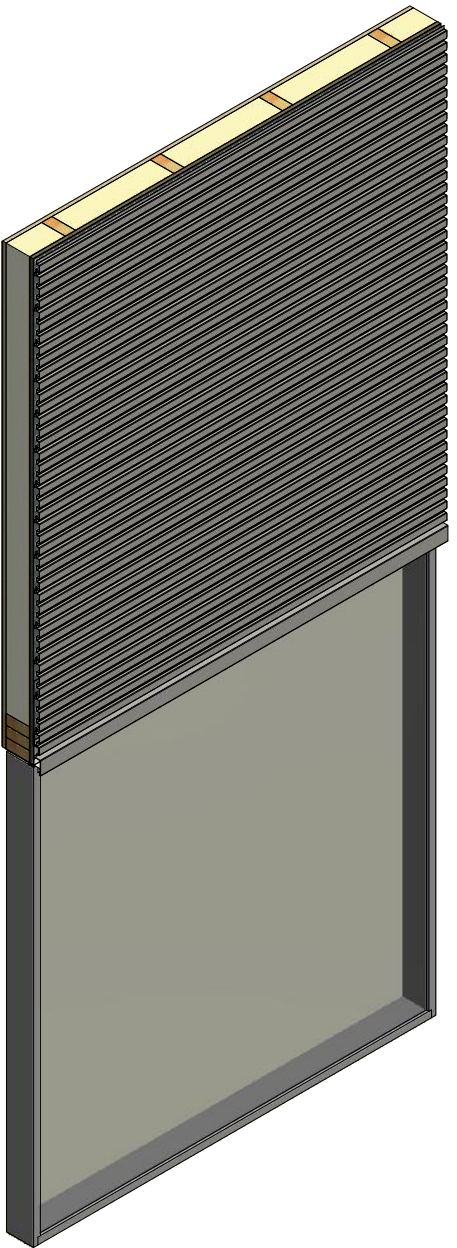
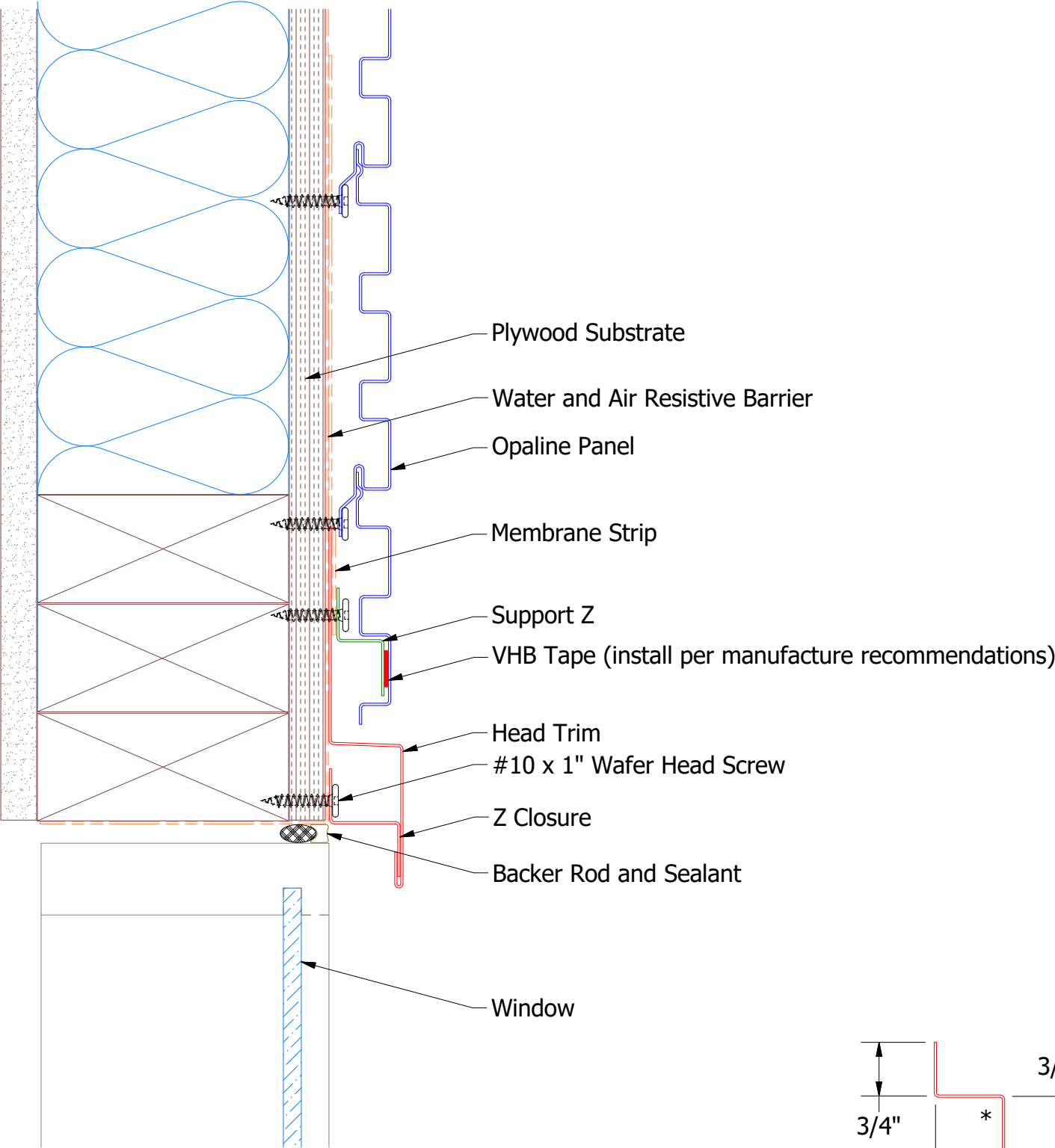

Support Z

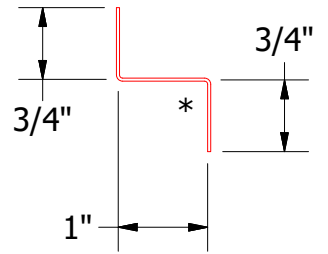

OPA681 - Z Closure

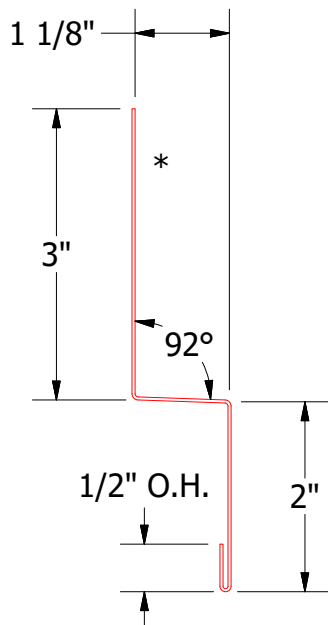

OPA550 - Head Trim

Note: * denotes color side.
Note: stainless steel pop rivets maybe needed along with VHB tape for longer panels.

01				8/30/2021				Changed Pop Rivet to VHB Tape				KRK			
REV. NO.				DATE				DESCRIPTION OF REVISION				BY APP			
DWG. NO.				DR				DATE				12/27/2018			
MATERIAL				APP				DATE				SH. SIZE			
				B				SCALE				X:X			

Horizontal Panel

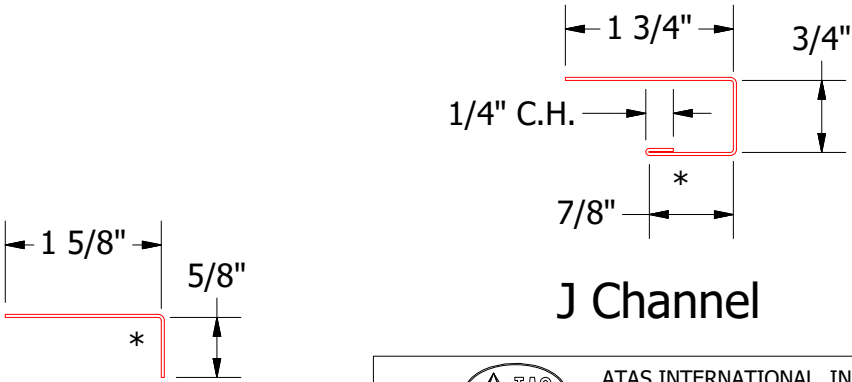
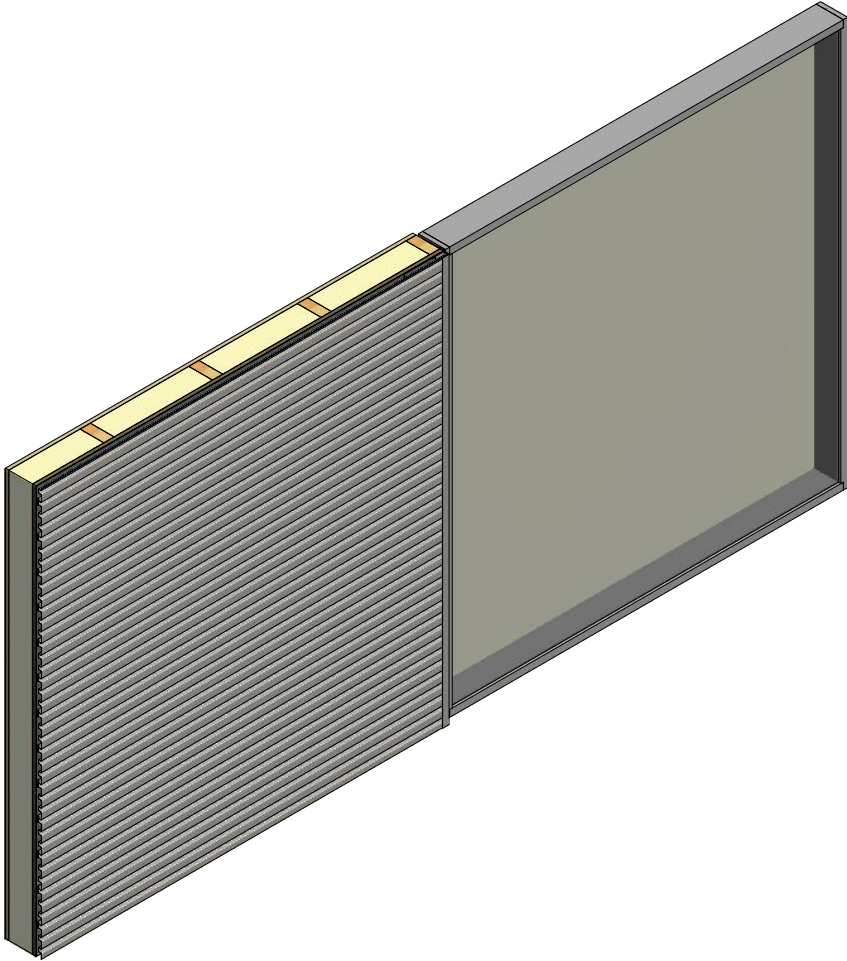
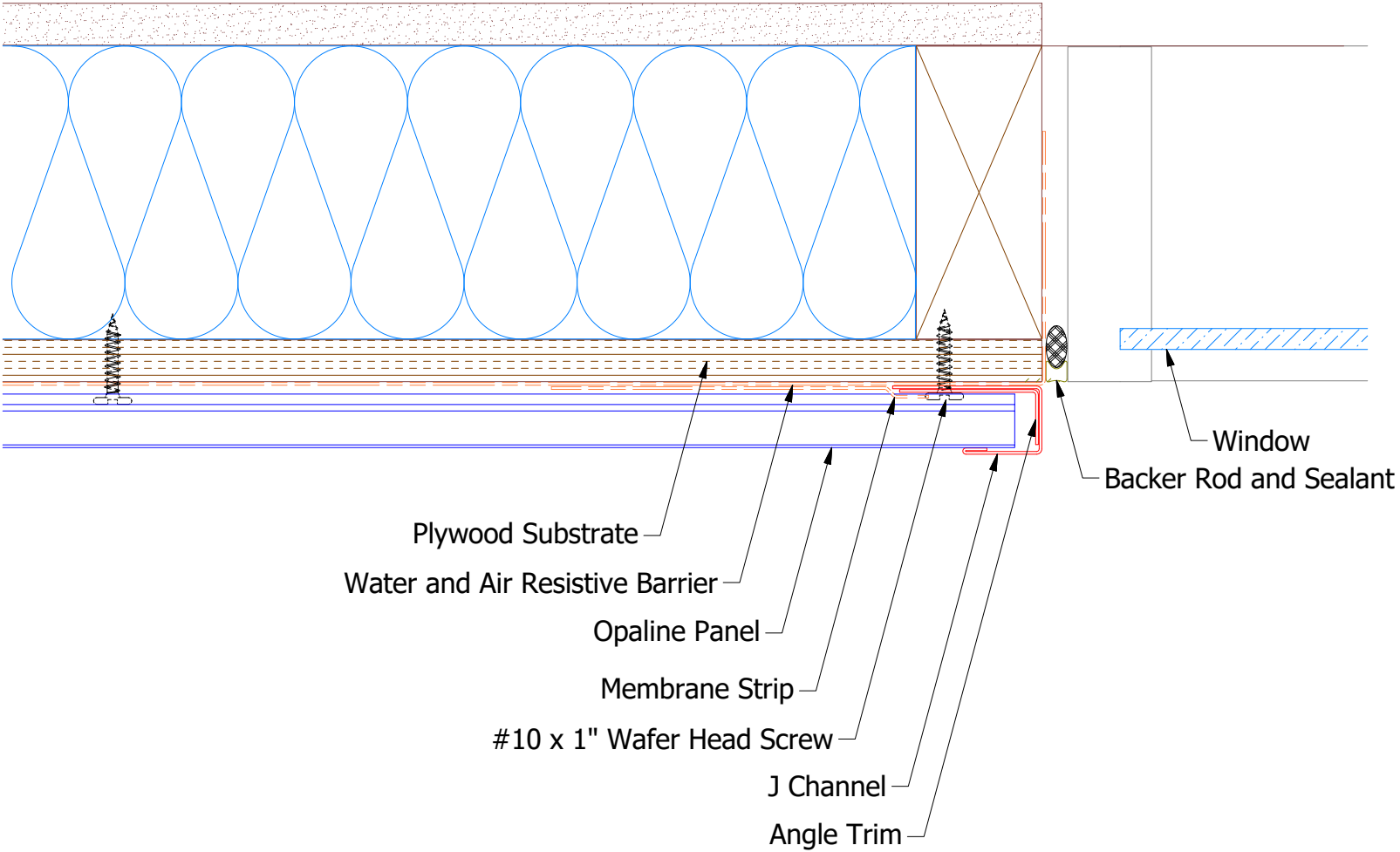

J Channel

Angle Trim



ATAS INTERNATIONAL, INC
Allentown PA
610-395-8445
Mesa AZ
480-558-7210

TITLE Opaline Existing Jamb Window Detail			
DWG. NO.		DR DMR	DATE 12/31/2018
MATERIAL		APP	DATE
REV. NO.	DATE	DESCRIPTION OF REVISION	BY APP
SH. SIZE B		SCALE X:X	

Note: * denotes color side.

Horizontal Panel

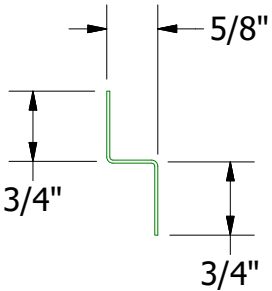
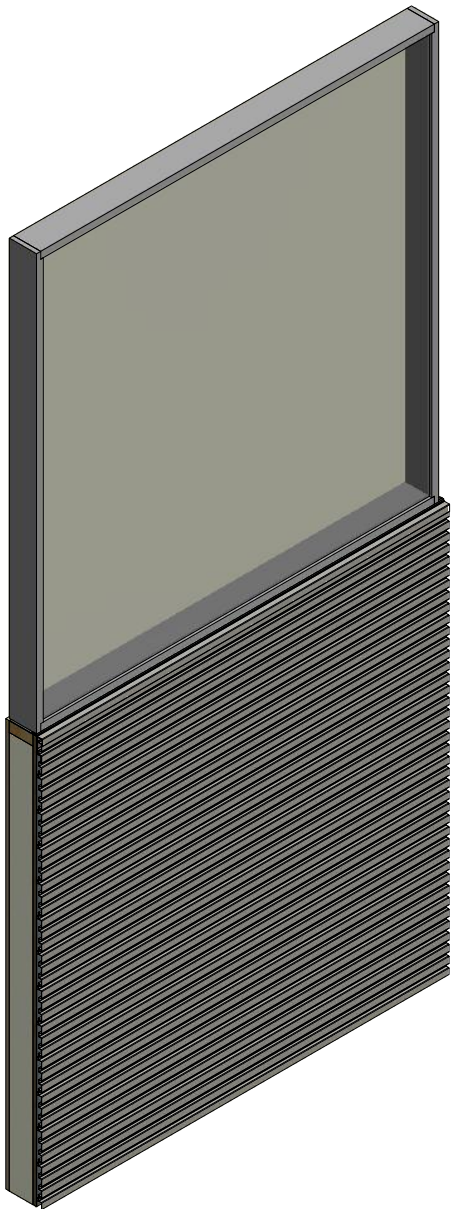
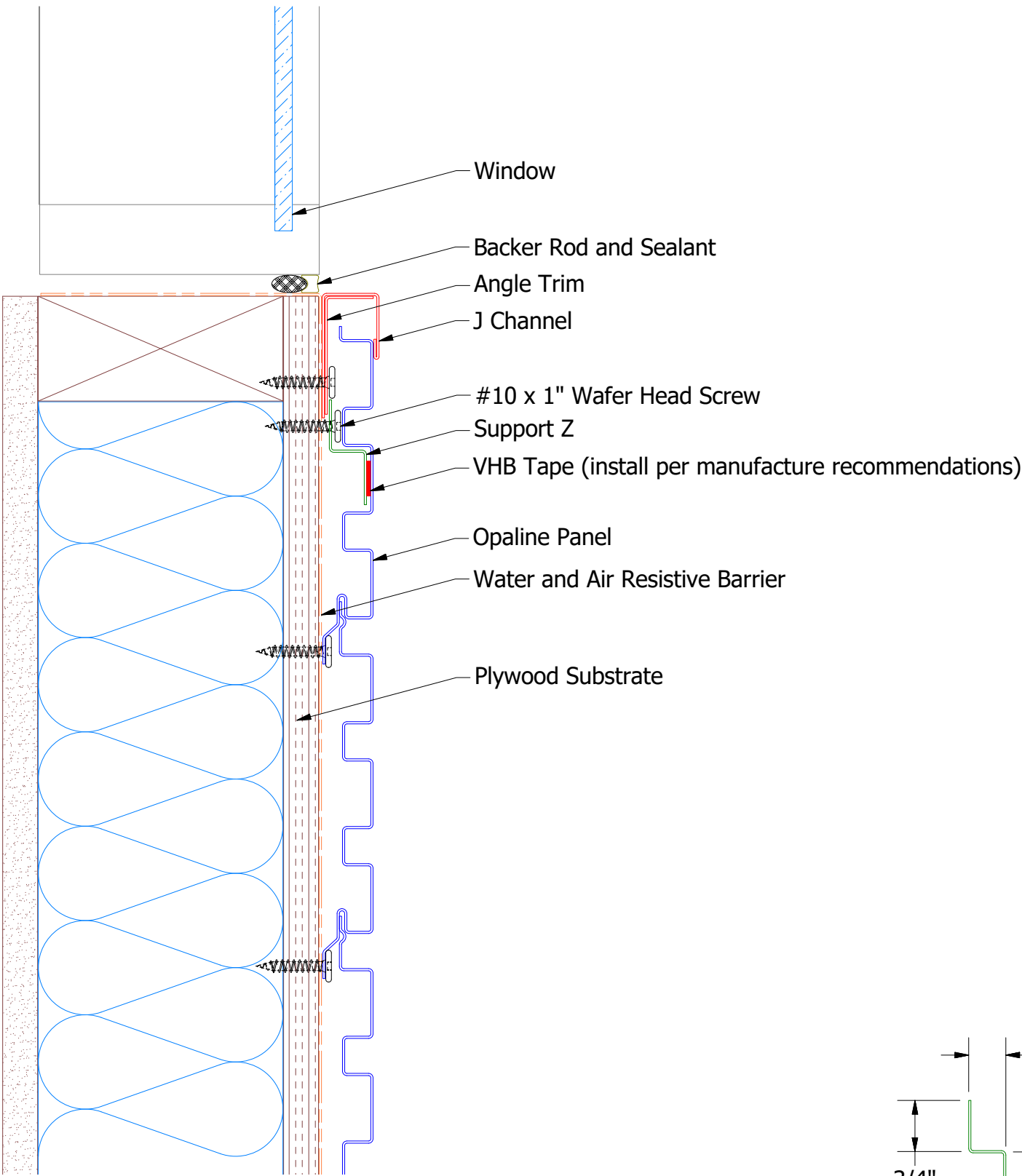

OPA681 - Support Z

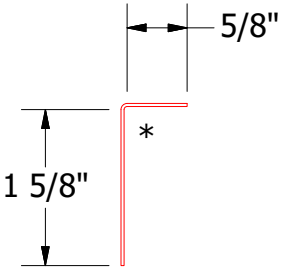

OPA680 - Angle Trim

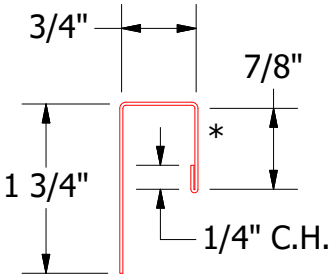

OPA034 - J Channel

Note: * denotes color side.
Note: Stainless Steel Pop Rivets maybe needed along with VHB Tape for longer Panels.

						TITLE	
						Opaline Existing Window Sill Detail	
				DWG. NO.		DR	DATE
						DMR	12/31/2018
						APP	DATE
				MATERIAL		SH. SIZE	SCALE
						B	X:X



ATAS INTERNATIONAL, INC
Allentown PA
610-395-8445
Mesa AZ
480-558-7210

Horizontal Panel

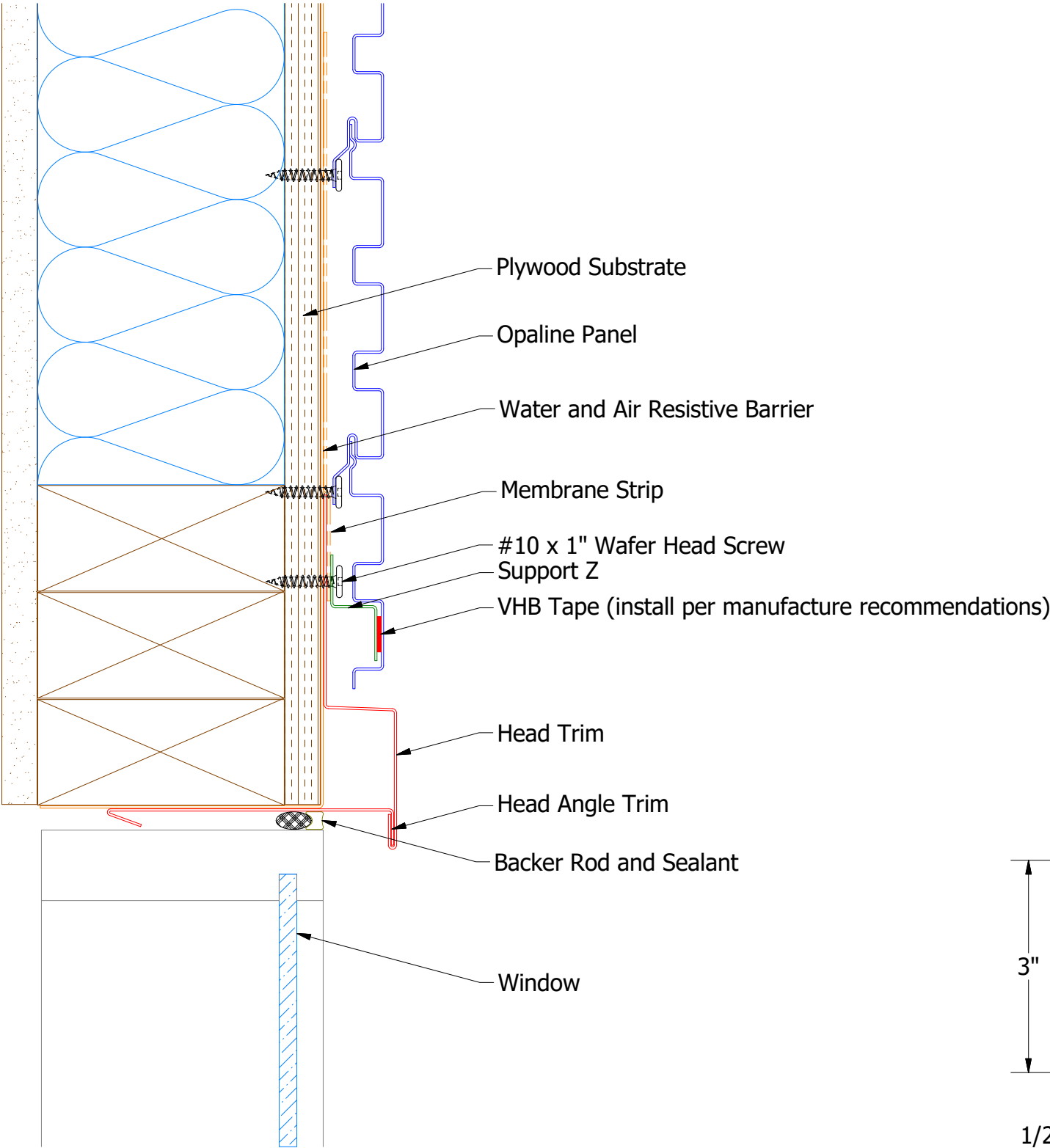

Note: * denotes color side.
Note: stainless steel pop rivets maybe needed along with VHB tape for longer panels.

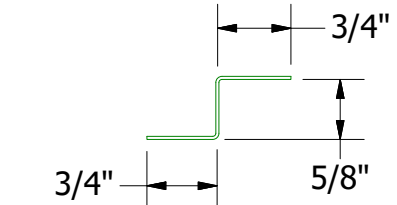
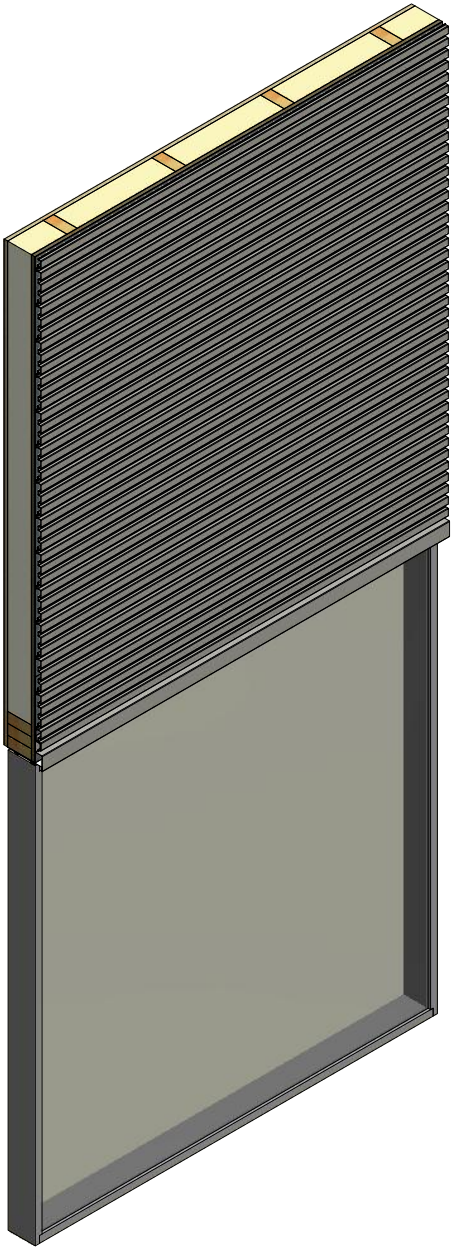
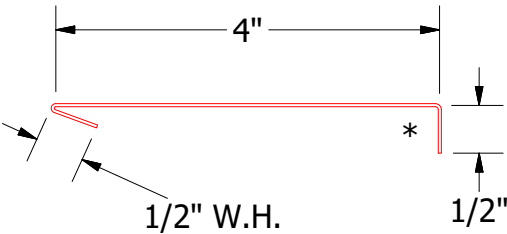
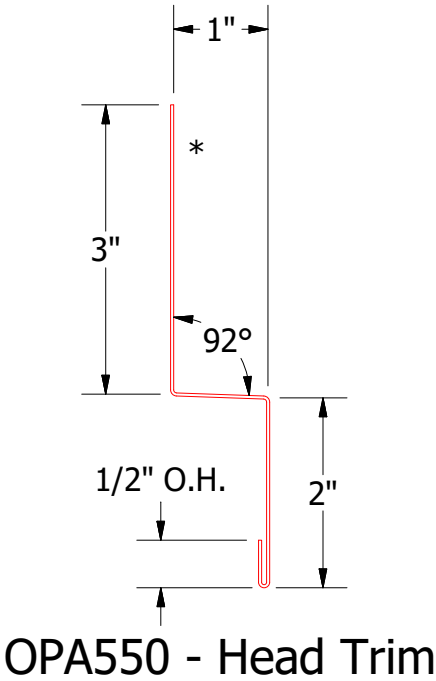

OPA690 - Head Angle Trim

OPA681 - Support Z

TITLE				Opaline Head Detail			
DWG. NO.		DR		DATE		DATE	
01		8/27/2021		MBP		7/6/2016	
REV. NO.		DATE		DESCRIPTION OF REVISION		BY	
01		8/27/2021		Changed Pop Rivet to VHB Tape		KRK	
MATERIAL		SH. SIZE		SCALE		DATE	
		B		X:X		7/28/16	



ATAS INTERNATIONAL, INC
Allentown PA
610-395-8445
Mesa AZ
480-558-7210

Horizontal Panel

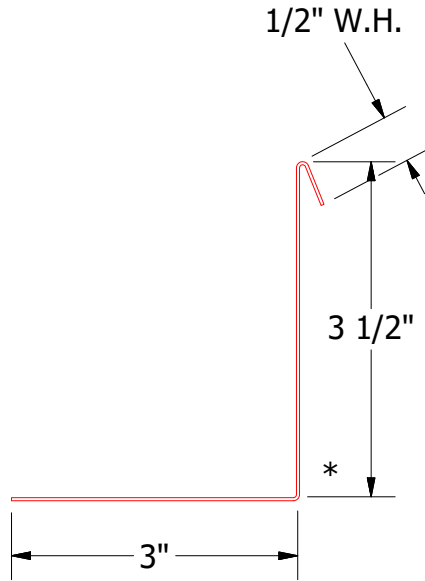
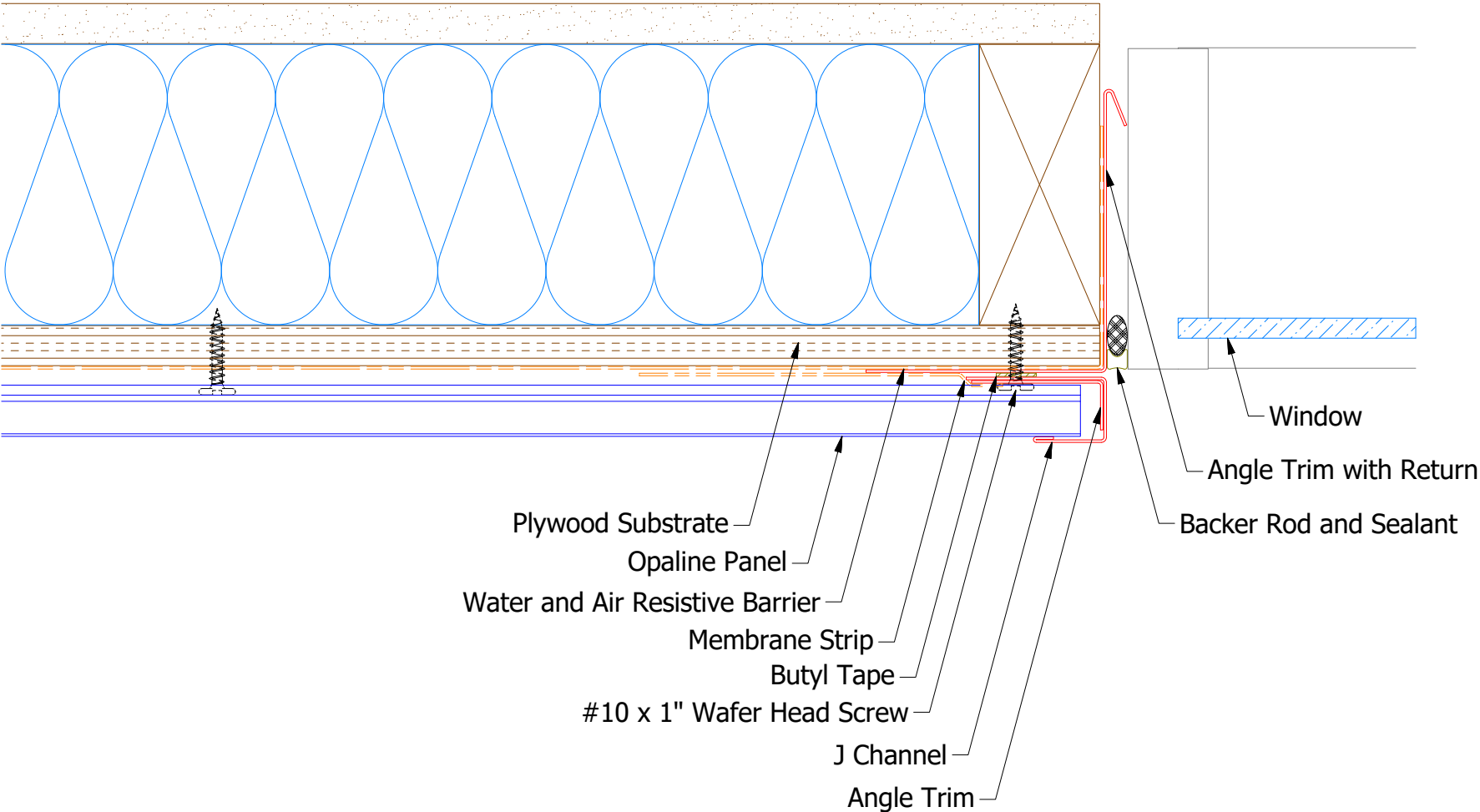
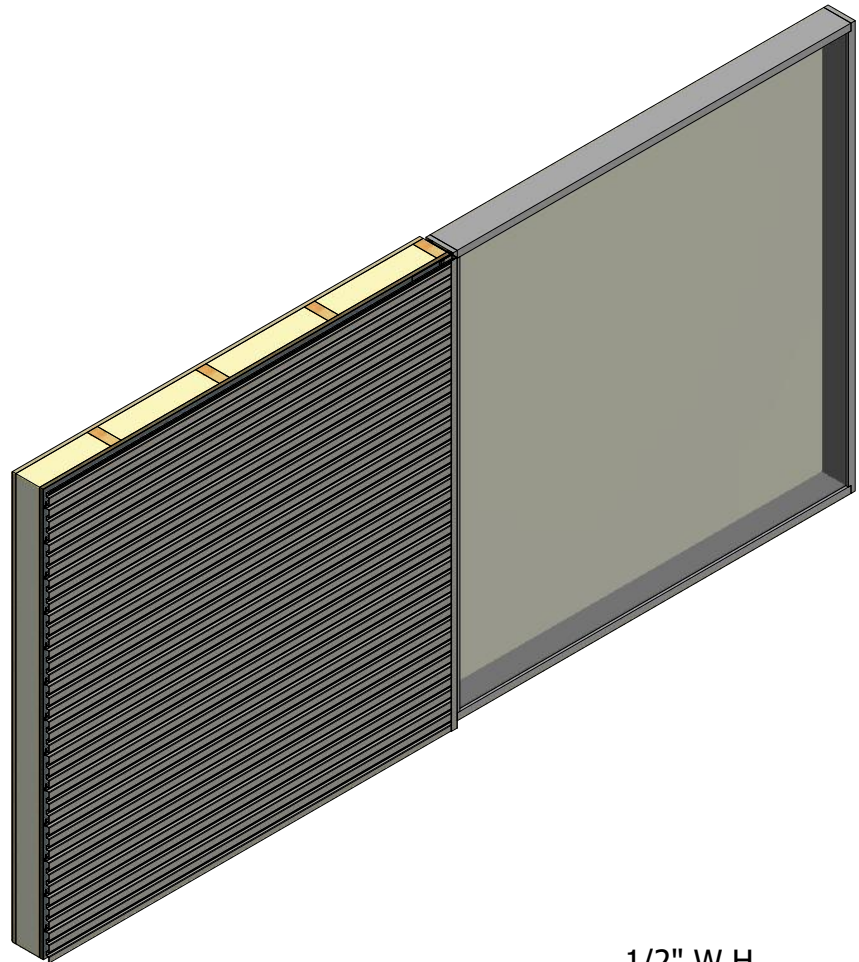

OPA683 - Angle Trim With Return

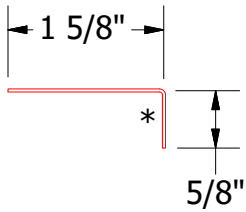

OPA680 - Angle Trim

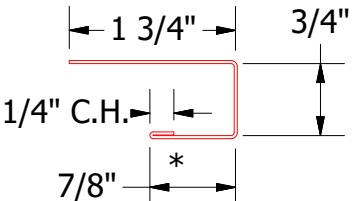

OPA034 - J Channel

Note: * denotes color side.

REV. NO.		DATE	DESCRIPTION OF REVISION	BY	APP	TITLE		DR	MBP	DATE
						DWG. NO.		APP	DAS	DATE
						MATERIAL		SH. SIZE	B	SCALE
										X:X



ATAS INTERNATIONAL, INC
Allentown PA
610-395-8445
Mesa AZ
480-558-7210

Opaline Jamb Detail

Horizontal Panel - Alternate

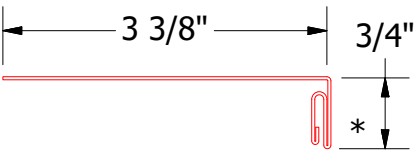
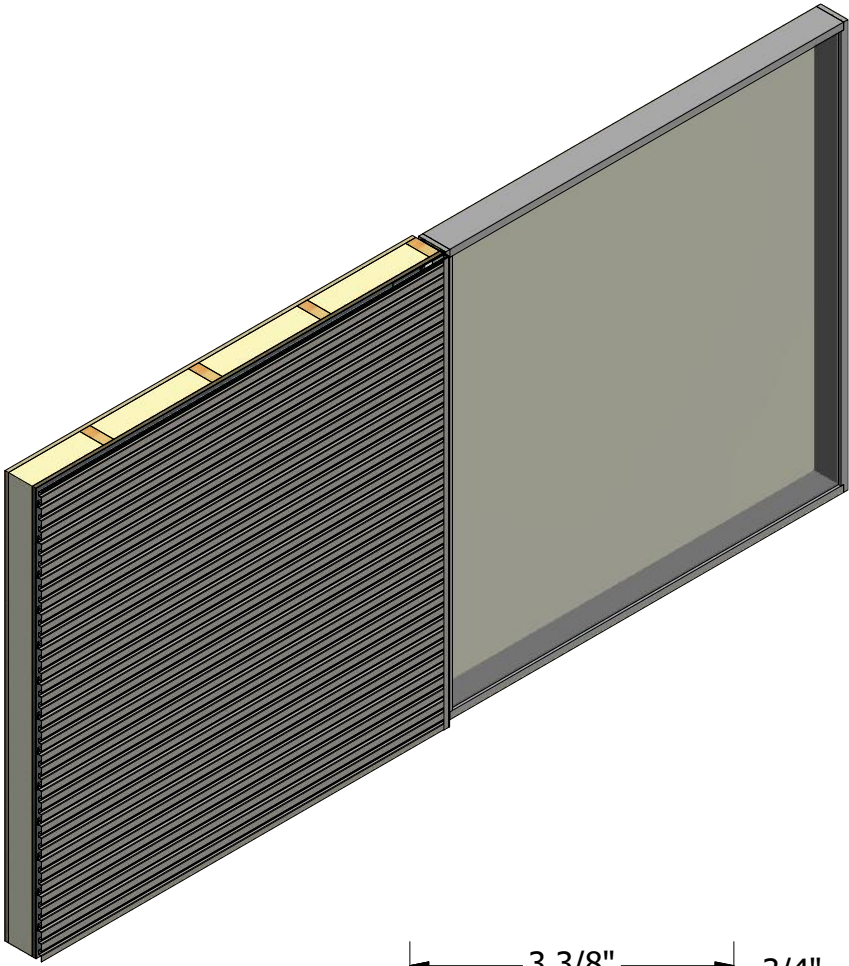
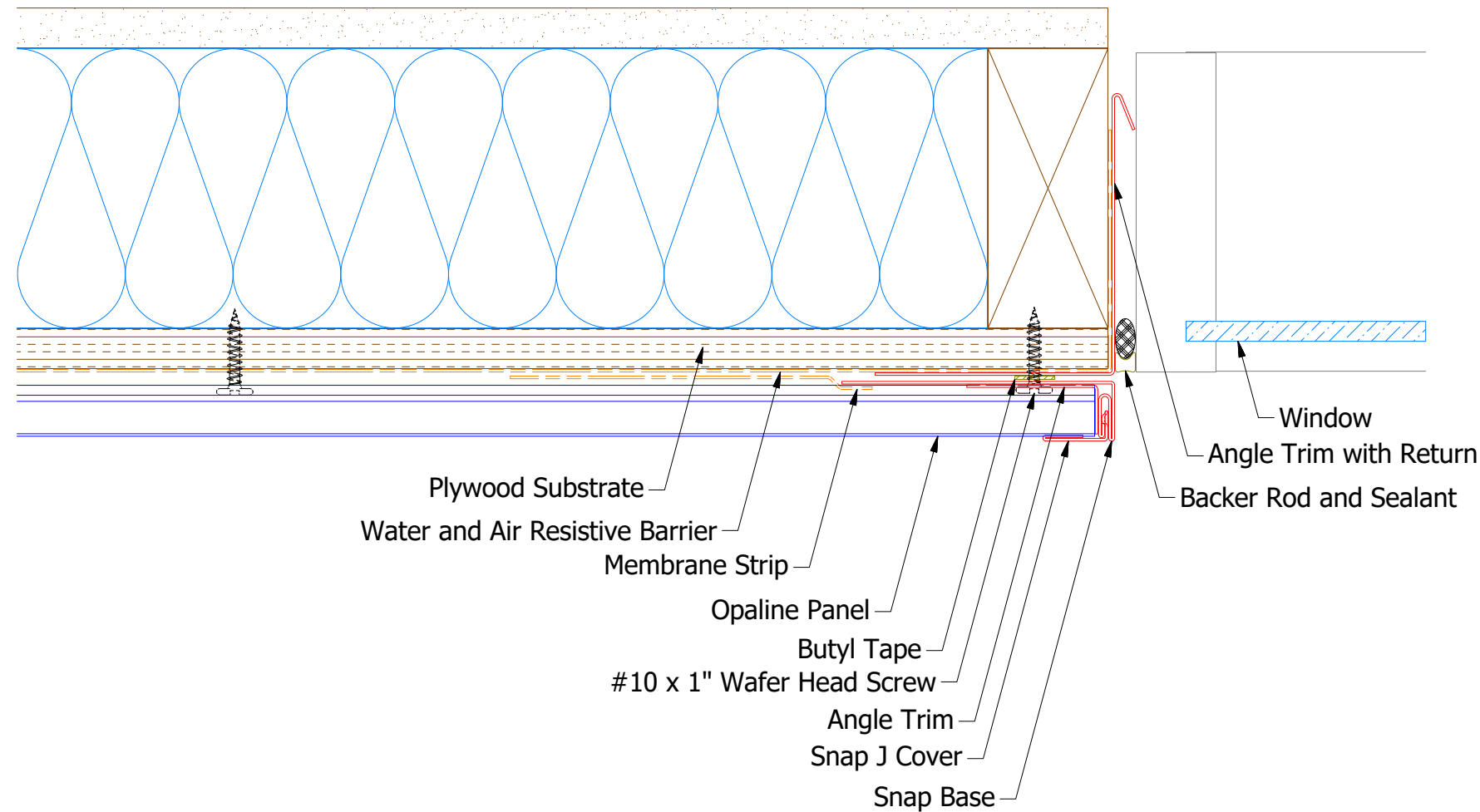

OPA039 - Snap J Base

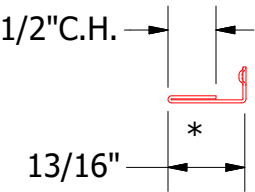

UNS078 - Snap J Cover

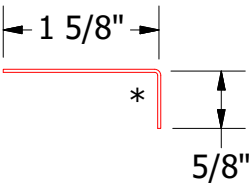

OPA680 - Angle Trim

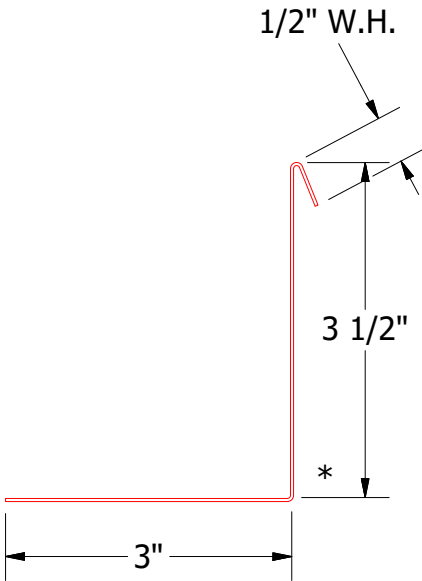

OPA683 - Angle Trim With Return

Note: * denotes color side.

 ATAS INTERNATIONAL, INC Allentown PA 610-395-8445 Mesa AZ 480-558-7210			
TITLE Opaline Jamb Alt Detail			
DWG. NO.		DR MBP	DATE 7/6/2016
		APP DAS	DATE 7/28/16
MATERIAL		SH. SIZE B	SCALE X:X

REV. NO.	DATE	DESCRIPTION OF REVISION	BY	APP

Horizontal Panel

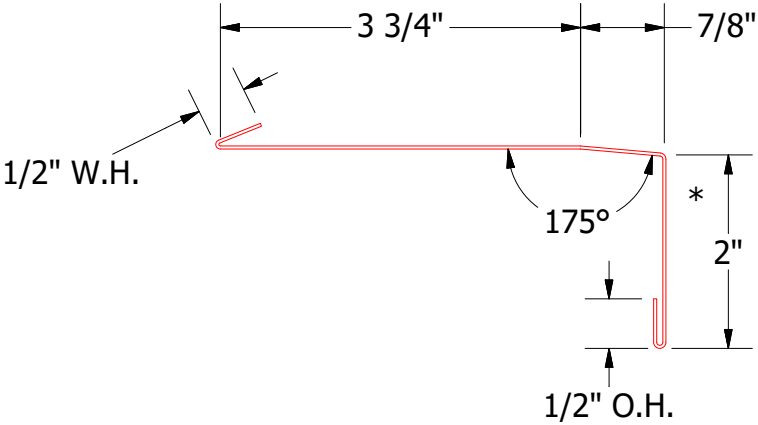
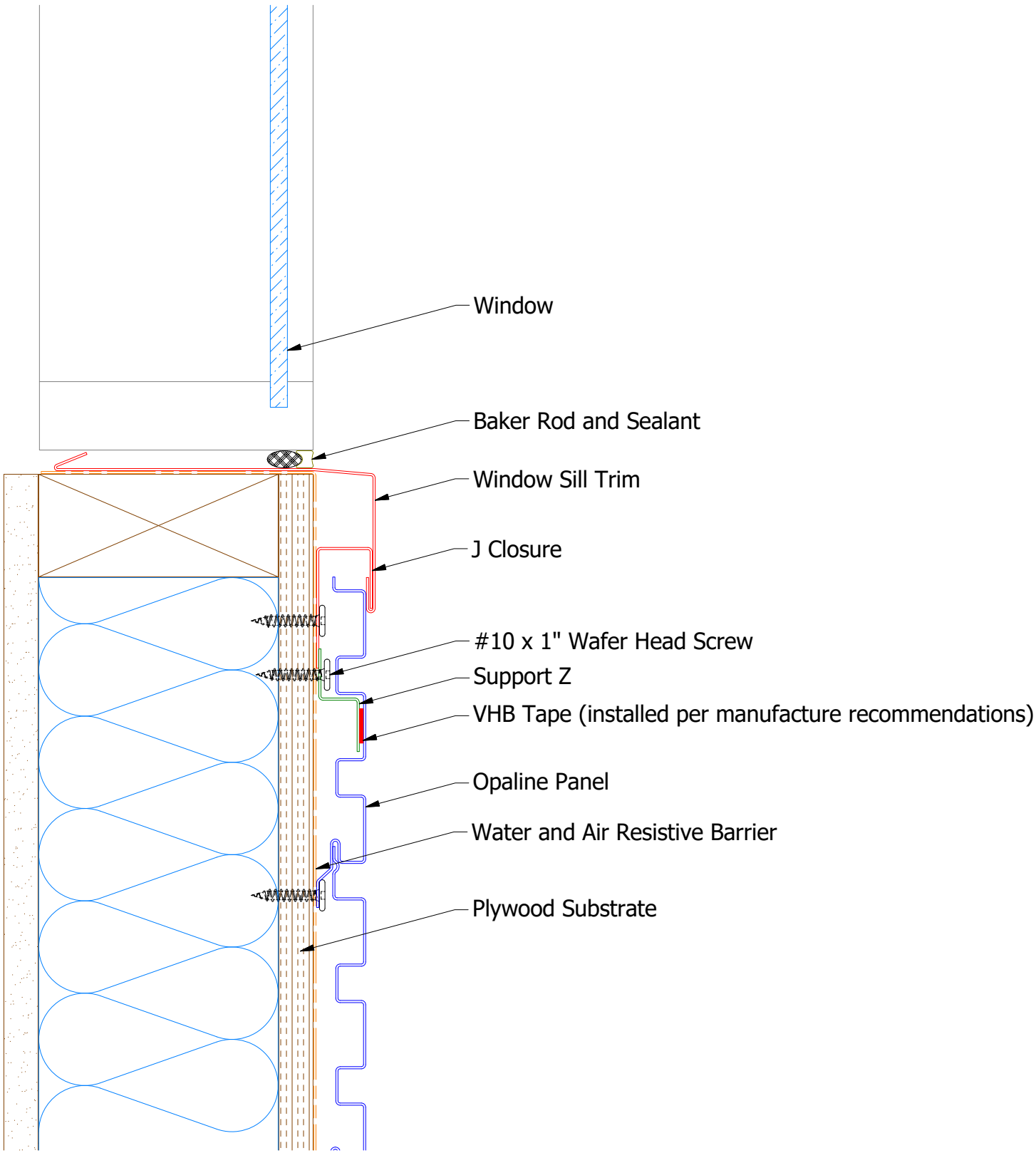

OPA670 - Window Sill Trim

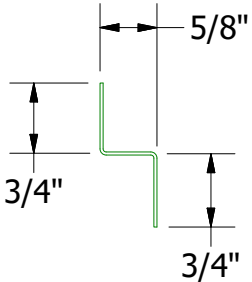
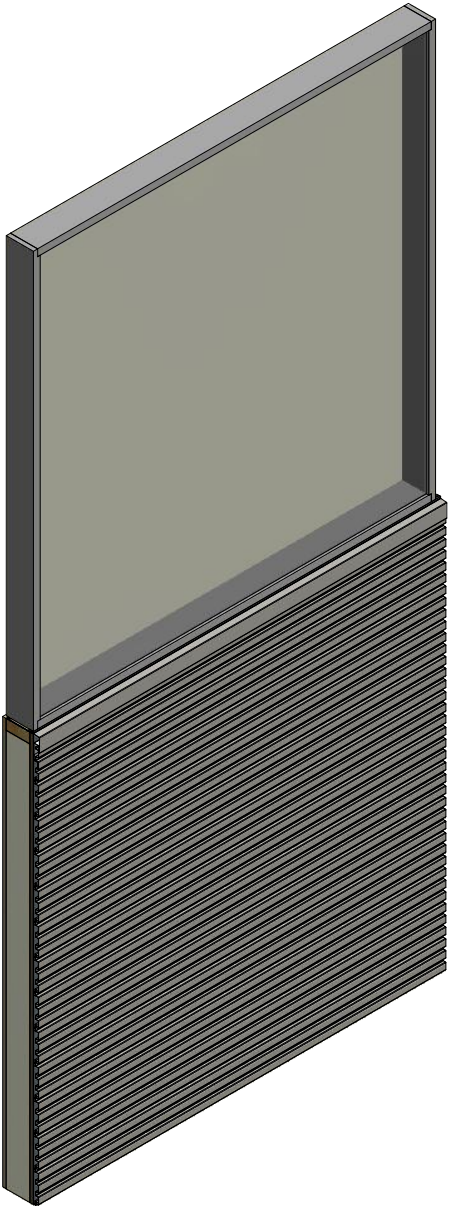

OPA681 - Support Z

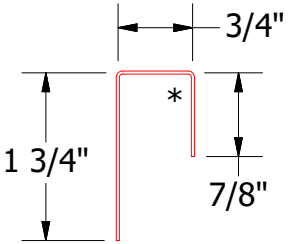

OPA270 - J Closure

Note: * denotes color side.
Note: stainless steel pop rivets maybe needed along with VHB tape for longer panels.

				TITLE Opaline Window Sill Detail			
				DWG. NO.	DR MBP	DATE	7/7/2016
01	8/31/2021	Changed Pop Rivets to VHB Tape	KRK			APP DAS	DATE 7/28/16
REV. NO.	DATE	DESCRIPTION OF REVISION	BY	APP	MATERIAL	SH. SIZE B	SCALE X:X



ATAS INTERNATIONAL, INC
Allentown PA
610-395-8445
Mesa AZ
480-558-7210