

**RAPID-LOK EXTRUDED FASCIA
INSTALLATION GUIDE**

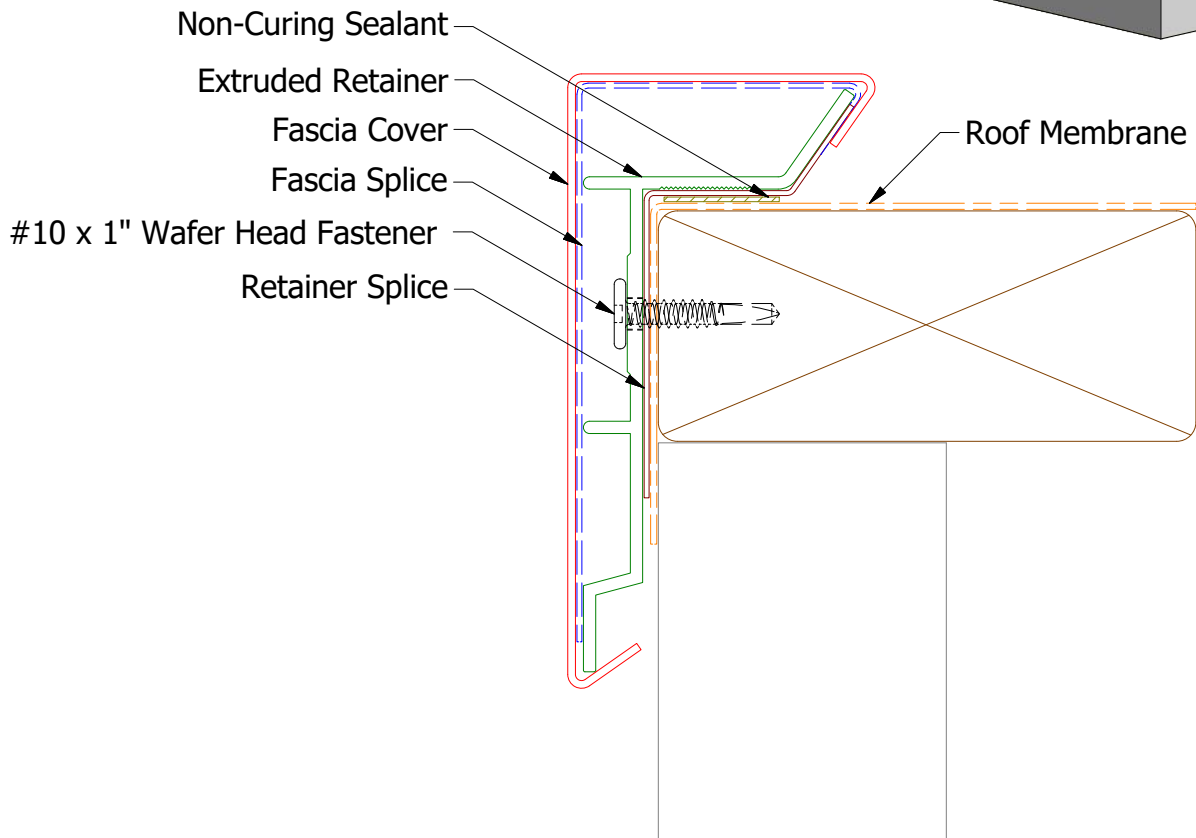

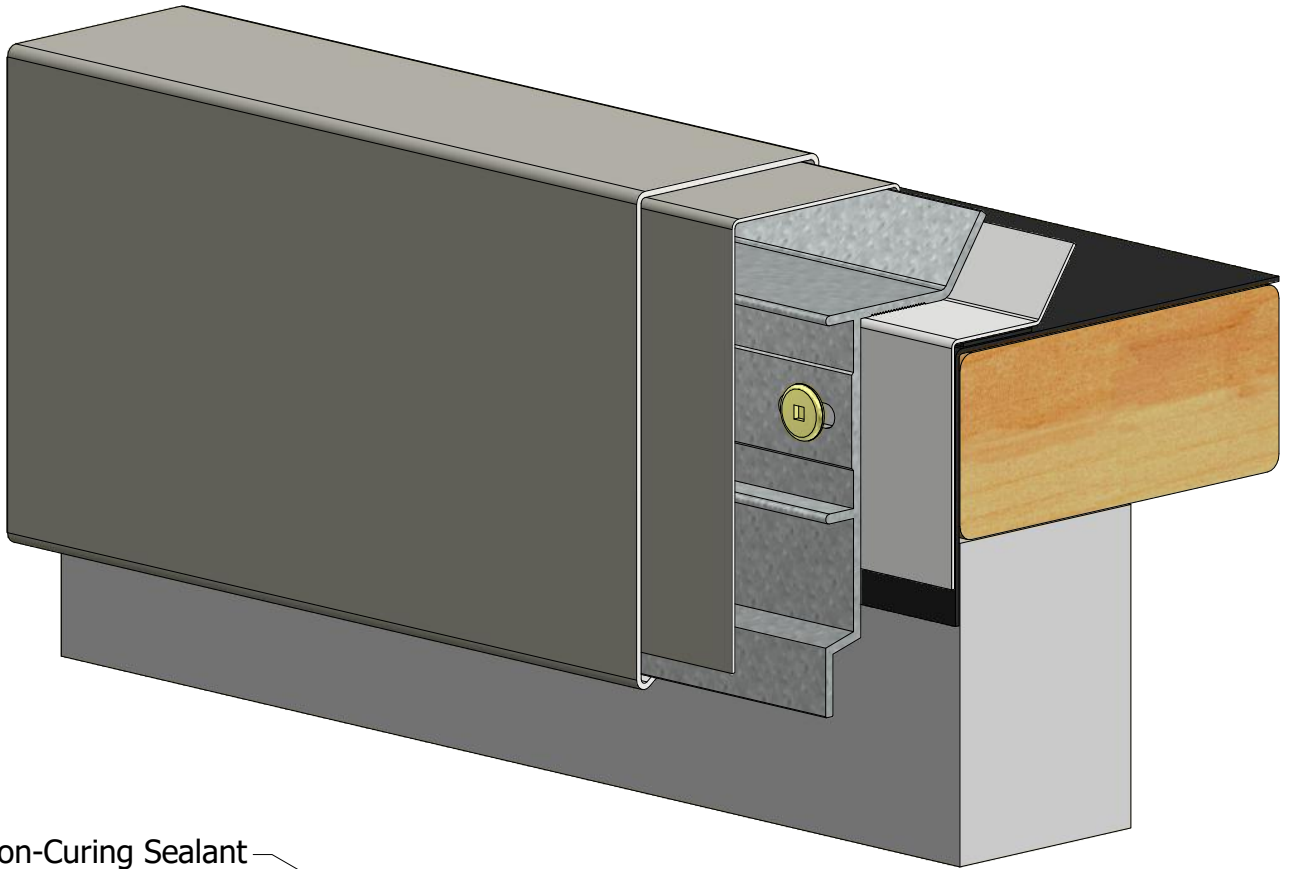

1) Wood blocking must be flush with the face of the wall below. Roof membrane must cover the wood extending 3/4" below the bottom of the blocking.

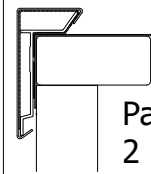
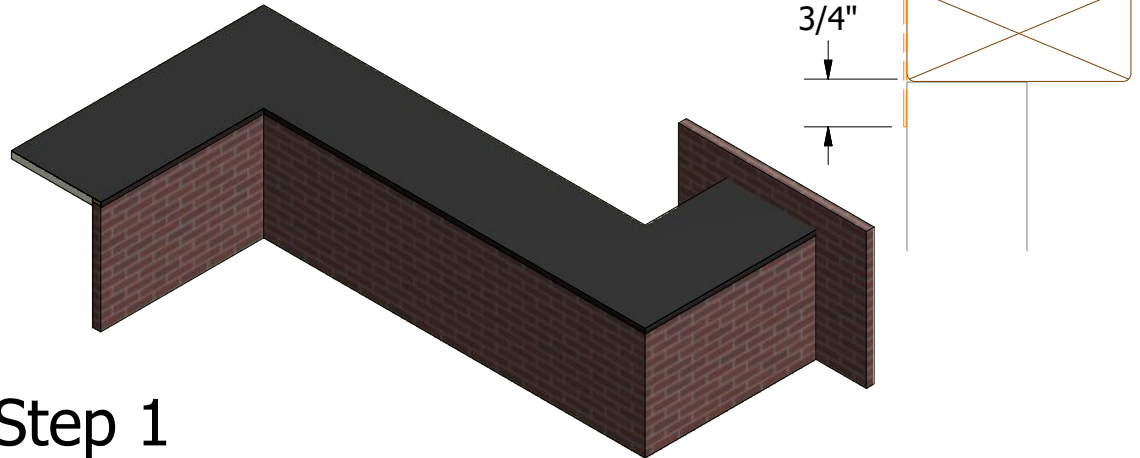

Step 1

2) Locate and install any scupper spillouts or sump cores, and flash in per membrane manufacturers specifications.

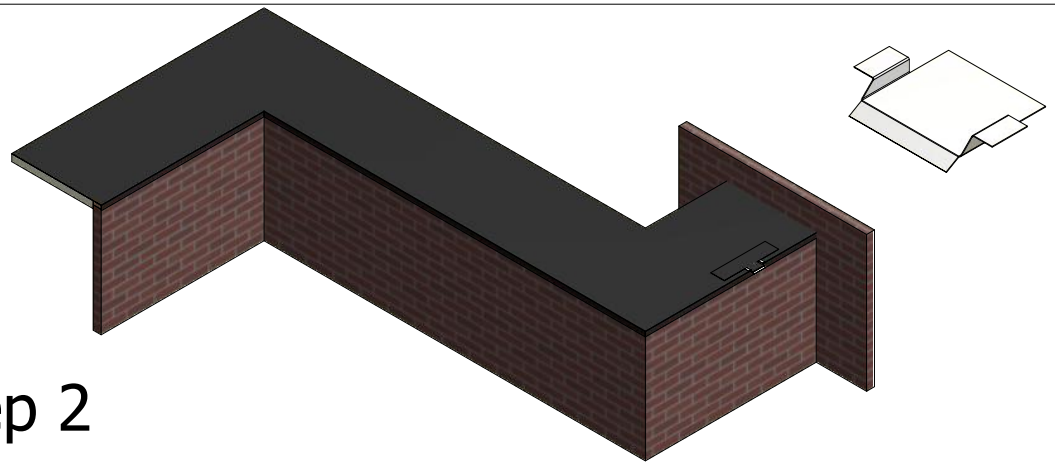

Step 2

3) Install a heavy continuous bead of non-curing sealant (membrane manufacturer's recommended product) on the bottom side of flange on retainer miters. Position a retainer splice in sealant on each side of miter, and run a bead of sealant on the bottom of the splice. Set the retainer miter with splices on the roof edge over the membrane at the corner, and secure to substrate with provided screws through each pre-punched slot.

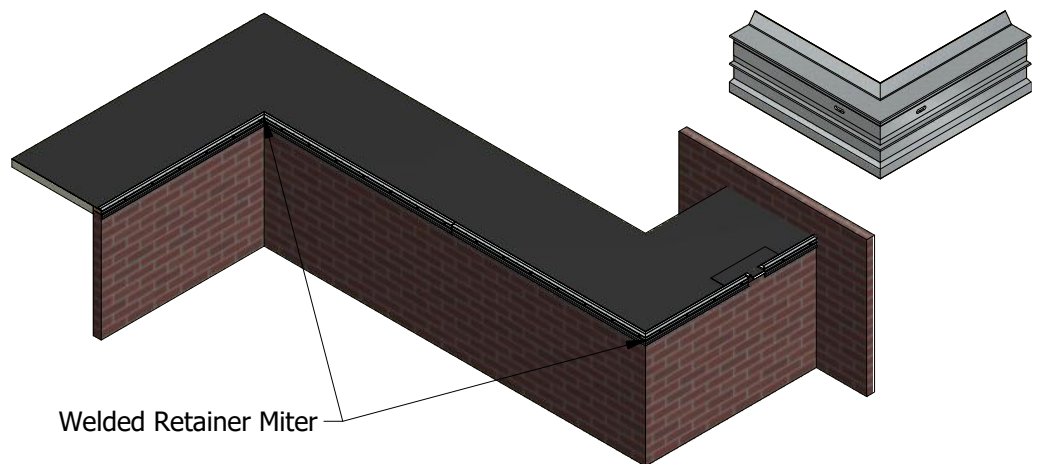

Welded Retainer Miter

Step 3

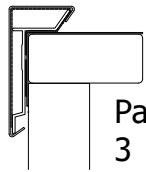

4) Install sealant on a 12'0" section of retainer and install a retainer splice with sealant in the opposite end (see page 4). Position retainer with splice on the edge of the roof next to the installed retainer **leaving 1/4" gap between retainer sections for thermal expansion.** Cut retainer sections as needed to fit.

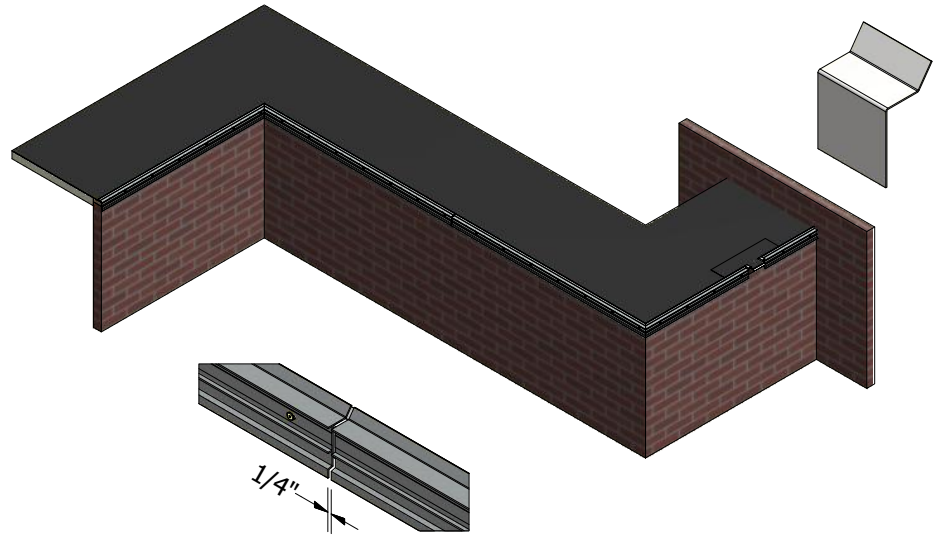
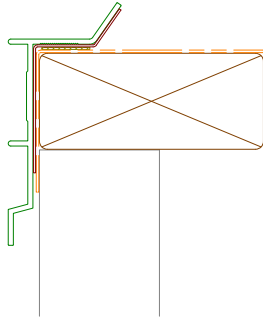

Step 4

5) Locate miter covers for the appropriate corners and position a splice in each side of the cover. Hook the top flange of the cover over the top flange of the retainer rotating the cover towards the outside of the building. Press down on the top of the cover to snap the bottom hook onto the bottom of the retainer. Make sure the cover is fully engaged on the retainer (see page 4).

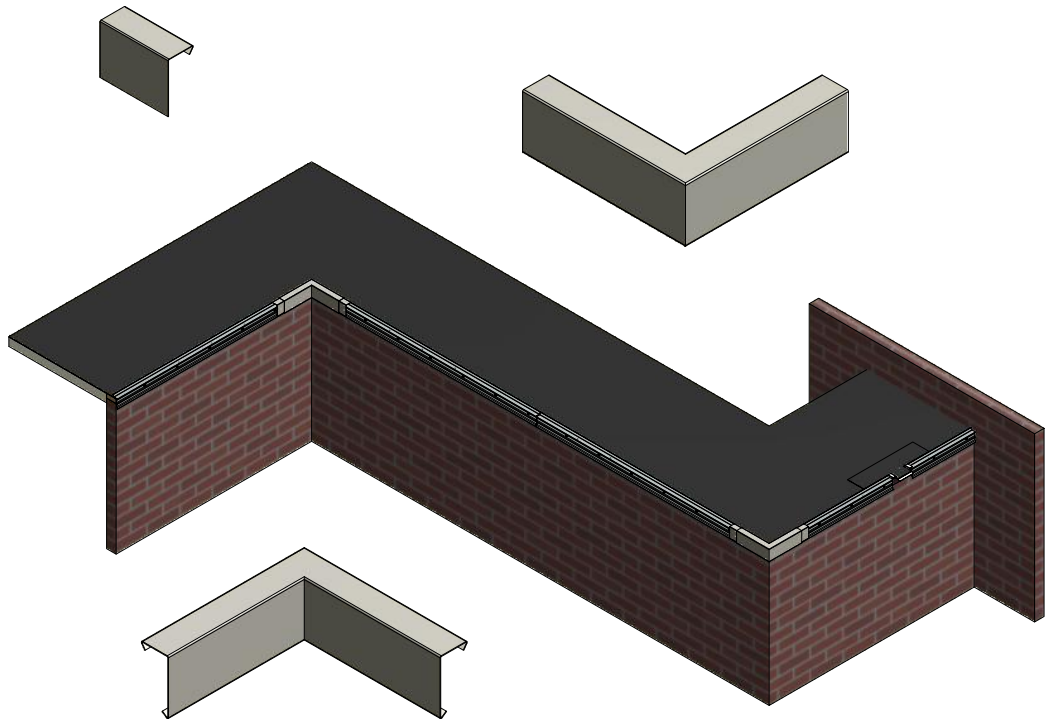

Step 5

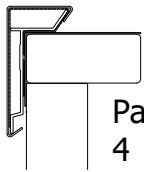

6) Locate covers for end closures, end terms, and scuppers for appropriate locations and position a splice in the end. Install covers by hooking at top and pressing down to snap into place (see page 4).

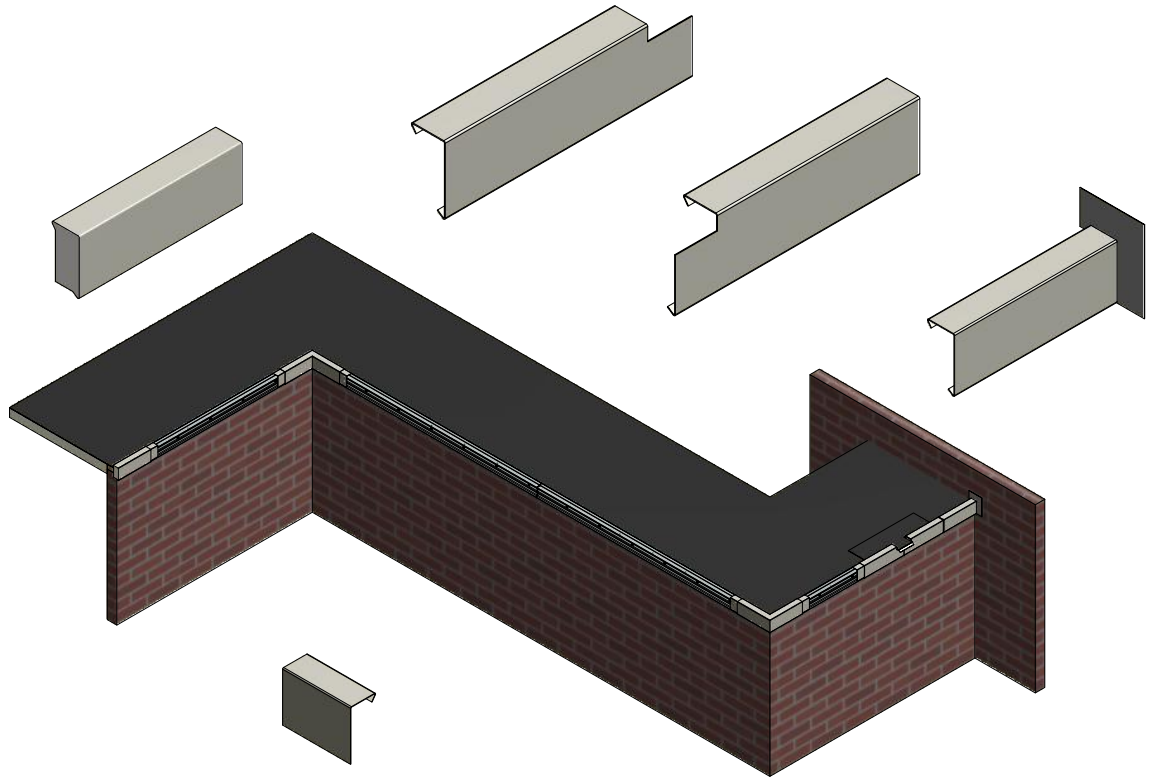

Step 6

7) 12'-0" cover sections are then installed between corners, ends and scuppers cutting to length as needed (plan cover layout to be balanced and to avoid creating short sections). Position a splice in the end of the cover opposite the installed piece, hook the top flange over the top flange of the retainer rotating the cover towards the outside of the building. Press down on the top of the cover to snap the bottom hook onto the bottom of the retainer. Make sure the cover is fully engaged on the retainer.

Allow a 1/4" gap between fascia sections for thermal expansion.

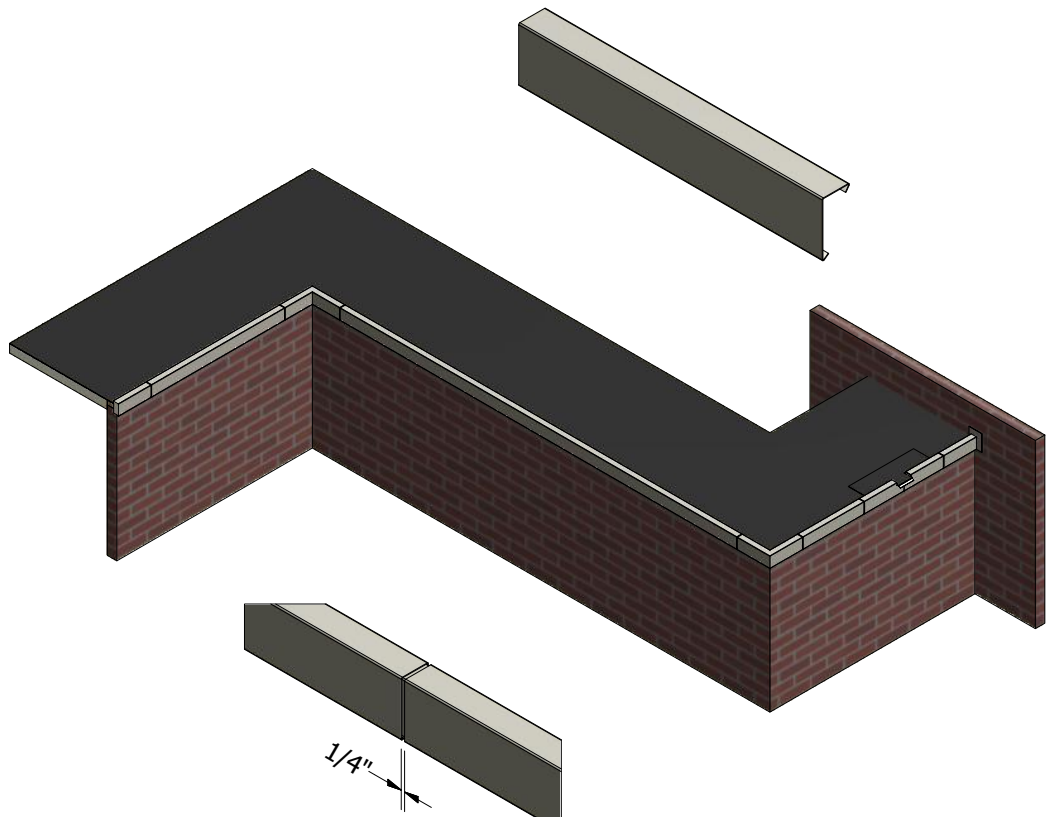

Step 7

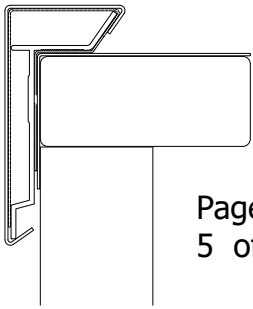

For more information go to: www.atas.com

**RAPID-LOK EXTRUDED FASCIA
ADDITIONAL DETAILS**

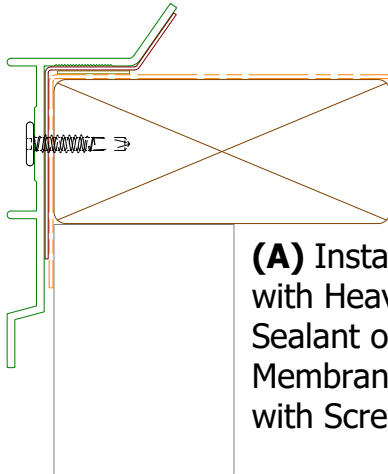

(A) Install Extruded Retainer with Heavy Bead of Non-Curing Sealant over Splice Cleats onto Membrane and Substrate, Secure with Screws at 12" O.C.

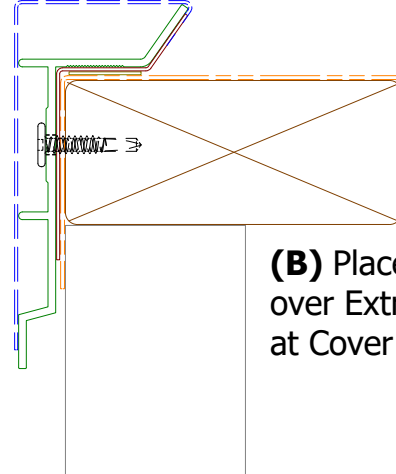

(B) Place a Splice over Extruded Retainer at Cover Joint Locations

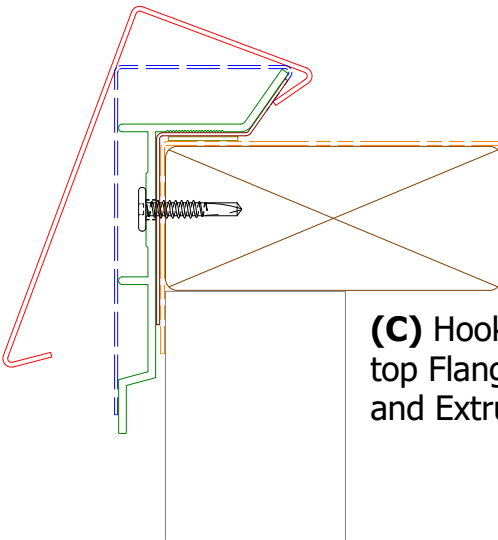

(C) Hook Cover over top Flange of Splice and Extruded Retainer

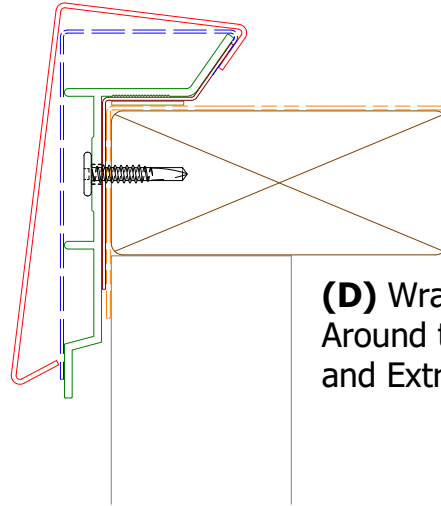

(D) Wrap the Cover Around the Splice and Extruded Retainer

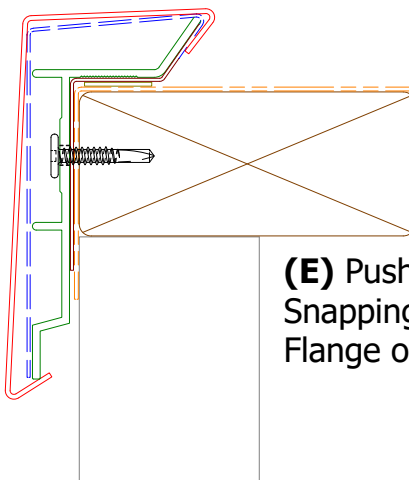

(E) Push Down on the Cover Snapping it Past the Bottom Flange of the Extruded Retainer

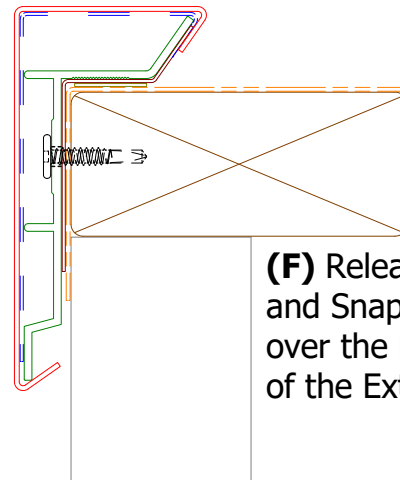

(F) Release the Cover and Snap the Hook over the Bottom Flange of the Extruded Retainer