

DOVETAIL ANCHOR SLOT & DOVETAIL ANCHORS

PRO-SLOT™ Anchor Slot is a stay-in-place concrete form used in forming a channel into the face of any cast in place wall or column. By installing Dovetail Anchors into the PRO-SLOT™, you can then anchor brick, block or stone to the concrete surface.

Material

BoMetals galvanized PRO-SLOT™ Anchor Slot is manufactured of G60 hot dipped mill galvanized steel in 26, 24, 22, 20 and 18 gauge. PRO-SLOT™ is offered standard in 10' lengths with custom lengths available on a special order basis. BoMetals' PRO-SLOT™ is standard with a polystyrene foam filler to keep the channel clear of concrete and resist closure due to hydraulic pressure. It is also available without a polystyrene foam. PRO-SLOT™ incorporates continuous nail grooves along the back edge of the profile to help in nailing the slot to the forms.

Dovetail Anchors are manufactured in 16 gauge hot dipped, mill galvanized steel and are furnished in 3 1/2", 5 1/2" and 7 1/2" lengths with a 1" overall width. PRO-SLOT™ Anchor Slot and Dovetail Anchors are mill galvanized before fabrication and conform to ASTM A 924, ASTM A 653 CQ or LFQ.

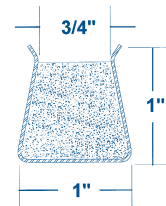
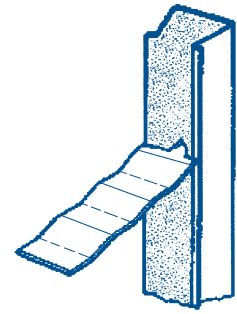

Advantages

- ❖ PRO-SLOT™ Anchor Slot and Dovetail Anchors provide a permanent, fast, flexible and cost effective method of anchoring brick, stone and block to cast-in-place concrete walls and columns.
- ❖ PRO-SLOT™ provides an excellent anchoring system for both cast-in-place and precast concrete.
- ❖ With a heavy, galvanized coating to prevent corrosion, Dovetail Anchors have deep corrugations to increase pull out strength.

Installation Instructions

- ❖ Nail BoMetals' PRO-SLOT™ Anchor Slot to the inside of the form wall prior to erection. Install vertically, spacing the channels 16", 18" or 24" on center. Use the nail grooves to speed up installation and space nails on 12" center.
- ❖ Dovetail Anchors should be spaced as indicated on drawings or called for in specifications or as recommended by local building codes. Typically, Anchors are spaced 12" to 16" vertically.

Product	Color Code	Description	Feet / Skid	# / Skid
DAS-18*	ORANGE	18ga Anchor Slot STANDARD 10' long	6,000'	2,933
DAS-20*	YELLOW	20ga Anchor Slot STANDARD 10' long	6,000'	2,247
DAS-22*	GREEN	22ga Anchor Slot STANDARD 10' long	6,000'	1,873
DAS-24*	BLUE	24ga Anchor Slot STANDARD 10' long	6,000'	1,508
DAS-26*	RED	26ga Anchor Slot STANDARD 10' long	6,000'	1,068

DOVETAIL ANCHORS 16 GAUGE		
DTA-35 3 1/2" (500 / box)	DTA-55 5 1/2" (500 / box)	DTA-75 7 1/2" (300 / box)

*Custom lengths are available. Please call 800.862.4835 for information.

Accessories – DAS