



# Monumental Strength. Seamless Beauty.

**GUIDE TO BOSTIK'S INNOVATIVE PRODUCT PORTFOLIO FOR  
DESIGNING AND INSTALLING GAUGED PORCELAIN TILE**





**FLOOR SYSTEM:**  
TOTALPrime™  
SL-200™  
Ultra-Set® SingleStep2™

**WALL SYSTEM:**  
TOTALPrime™  
Webcrete® 95™  
Bosti-Set™  
TruColor® RapidCure™  
Pure Silicone™

**COUNTERTOP SYSTEM  
(AND TRIM WORK):**  
Grip N Grab™  
Bosti-Set™  
TruColor® RapidCure™  
Pure Silicone™

## CONNECTING INNOVATION WITH BEAUTY

When it comes to innovative and thoughtful design, the latest design materials require diverse system solutions. From ventilated façades to performance or designer flooring and wall surfaces, Bostik is uniquely positioned to help architects and design professionals execute the latest designs.

Your project deserves a quality and comprehensive portfolio of products with proven success with gauged porcelain tile panels. This guide of Bostik's high-performing primers, self-leveling underlayments, patches, mortars and adhesives will give you an overview of the innovation driving our brand, 130 years in the making.

For decades, Bostik's products have created literal bonds between surfaces and building components, all while supporting distinctive design. Together, with our parent company, Arkema, that bond is reinforced.

A global leader in specialty chemicals and advanced materials, France-based Arkema is

building the future of the chemical industry every day. Bostik is well positioned as part of Arkema's High Performance Materials segment, alongside brands like Kynar® fluoropolymer coatings, the Rilsan® high-performance polyamides family, and Plexiglas® acrylic sheet and resin products.

Adding to our expansive portfolio of bonding solutions for construction, we are pleased to introduce our new PanelTack™ System of Wall Panel and Façade Cladding Adhesives, available for both interior and exterior use. Our trusted line of innovative products is fully adapted to an extensive assortment of substrates and panel materials, suitable for any environment.



# Surface Preparation

Gauged porcelain tile panels (GPTP) have specific floor and wall preparation requirements due to the large size of the panels. The American National Standards Institute, per A137.3 calls out a minimum substrate flatness of 1/8" in 10' for GPTP's on floor or wall installations. The use of self-leveling underlayments, and especially ultra-fluid self-smoothing levelers, is necessary for floors and repair and patching compounds are necessary for walls. In many cases, GPTP's can be used over existing substrates, like tile or epoxy coatings, diverting waste from landfill by methods of preparing existing surfaces for bond with TOTALPrime™. Bostik has optimized formulations for our surface preparation category for maximum flatness, providing craftspeople with a high level of workability and speed to get their job done right and on time.

## MOISTURE VAPOR BARRIER

### Slab-Cote™

#### EXTREME MOISTURE VAPOR BARRIER COATING

- Single coat, rapid cure, 100% solids epoxy formulation
- For use on properly prepared, green concrete
- ≤0.1 perm rate, Class 1 vapor retarder per the IRC



Bostik Slab-Cote™ Extreme Moisture Vapor Barrier Coating is a single coat, two-component, 100% solids, epoxy formulated to dramatically reduce moisture vapor transmission and surface alkalinity from substrates. Slab-Cote™ perm rate is ≤0.1, is a Class 1 vapor retarder per the 2007 supplement to the 2006 IRC (International Residential Code), and passes ASTM F 3010-13, moisture mitigation system for use under resilient flooring. It has 0 VOC's (as calculated per SCAQMD Rule 1113), low odor and is solvent-free. Slab-Cote™ also contains Bostik's Blockade™ antimicrobial protection that provides built in protection to inhibit the growth of a broad range of odor causing bacteria, mold and mildew on the surface of the coating's film. It is pigmented blue for visual indication of coverage and film thickness during the installation process. It is extremely durable and can be used as a wear layer.

## PRIMERS

### TOTALPrime™

#### MULTI-SURFACE, BOND-ENHANCING PRIMER

- Textured, bond-promoting primer
- 1- to 2-hour rapid dry time
- For multiple substrates

Bostik's TOTALPrime™ is a ready-to-use, polymer-based primer designed for a variety of challenging substrates. TOTALPrime™ tenaciously bonds to non-porous substrates, like epoxy coatings and existing tiles. The bond-enhancing sand suspended in the formulation imparts superior mechanical adhesion. TOTALPrime™ provides a coarse textured surface ideal for enhancing the bond of mortars, self-leveling underlayment and patches, ensuring excellent adhesion even on challenging substrates (see technical datasheet).



## WATERPROOFING & ANTI-FRACTURE

### GoldPlus™

#### LATEX WATERPROOFING AND ANTI-FRACTURE MEMBRANE

- Roller-applied for easy application
- Exceeds ANSI A118.10 and A118.12 waterproofing and crack isolation specifications
- 1-hour dry time for fast installation



GoldPlus™ is a ready-to-use, roller-applied, latex waterproofing and anti-fracture membrane for use beneath thin set ceramic tile installations on vertical and horizontal surfaces. GoldPlus™ exceeds the requirements of ANSI A118.10 (specification for waterproofing membranes beneath thin set tile and stone) and ANSI A118.12 specification for crack isolation membranes. Apply GoldPlus™ over concrete, cement block walls, cement backer board, exterior grade plywood (interior, dry installations only), mortar beds, and poured gypsum-based underlayments. Use to prevent tile cracking caused by the shrinkage of new concrete slabs and to prevent cracks up to 1/8" from transferring through tile or stone. Use GoldPlus™ to waterproof showers, lavatories, fountains, commercial kitchens and restaurants, etc. GoldPlus™ contains Bostik's Blockade® antimicrobial protection which helps protect against the growth of bacteria, mold and mildew and enables it to offer resistance to stains caused by mold.

## PATCHES

### Webcrete® 95

#### FAST-SETTING, HIGH STRENGTH, FLOOR AND WALL PATCH

- Excellent for skim-coating, patching and leveling
- Featheredge finish
- Apply up to 1/2" depth in one application



Bostik Webcrete® 95 is a fast-setting, polymer-modified, Portland cement patch for interior use on floors and walls. This product may be used to skim coat or featheredge finish up to 1/2" deep in one application. Floor covering can be installed after just one hour from application. Bostik Webcrete® 95 is used to patch and smooth floors prior to the installation of engineered hardwood, solid wood, laminate, ceramic tile, carpet, and resilient flooring. It can be used over properly prepared concrete; cementitious backer board; structurally sound exterior grade plywood (interior/ dry use only); existing, well bonded vinyl/VCT or ceramic tile; and cutback adhesive residue (dry only). When mixed with Bostik 425™ Multi-purpose Acrylic Latex Admixture instead of water, not only is the performance and flexibility improved, but Bostik Webcrete 95® can also be used as an embossing leveler.

## SELF-LEVELING UNDERLAYMENT

### SL-200™

#### ULTRA FLUID SELF-SMOOTHING UNDERLAYMENT

- Install from 1/8" to 1" neat
- Walkable in 2 to 3 hours
- Install floor covering in 6 to 16 hours



SL-200™ is an ultra fluid, self-smoothing underlayment used in preparation of finished floor coverings. SL-200™ can be installed at 1/8" using a gauge rake and smoothing tool. The ultra fluid, single lift application increases production over multi-coat patching methods and leaves a smoother surface. SL-200™ can also be installed as a self-leveling underlayment up to 1" when a flat or level subfloor is desired. Ceramic tile and stone can be installed 6 hours after SL-200™ is poured. Floor coverings such as carpet, VCT, Vinyl sheet goods, LVT, rubber and wood can be installed in as little as 16 hours.

# Gauged Porcelain

## Tile Bonding For Floors & Walls

Gauged porcelain tile panels (GPTP) require adhesives that are optimized for their unique size, variety of backing materials, and installation method requirements. The following materials have a value to the installer, as well as design professionals and end users such as sound reduction capabilities, fast return to service and increased workability times.

### PREMIUM MORTARS (FLOORS)

#### BAM™

##### FIBER-REINFORCED, RAPIDCURE™, LARGE & HEAVY TILE MORTAR

- Grout in 4 hours
- Workability, open time in excess of 30 minutes
- Risk reduction for end user and tile contractor by allowing for earlier traffic



The award-winning new mortar from Bostik, BAM™ the Bostik Accelerated Mortar, offers a standard feel with rapid return. It is the best in its class, demonstrating exceptional strength as a high-performance, fiber-reinforced mortar for large and heavy tile. And with that comes the power of RapidCure™ Technology, specially formulated for maximum performance in commercial and residential applications, making most jobs ready to grout in 4 hours while delivering an open time and adjustability time of up to 30 minutes at exceptional bond strength that exceeds ANSI 118.15 requirements.

#### Reflex®

##### ULTRA-PREMIUM, POLYMER-MODIFIED THIN SET MORTAR

- For interior and exterior use
- Exceeds ANSI A118.4 and A118.11
- Excellent working characteristics



Bostik Reflex® ultra-premium polymer-modified thin set mortar is for interior or exterior installations to set all types of porcelain, saltillo, ceramic, glass, granite, slate, marble, limestone, thin porcelain tiles, large porcelain panels and dimensional stone tiles. Reflex® has excellent mixing and application properties. Use over properly prepared concrete; structurally-sound, exterior grade plywood (interior/dry use only); cementitious backer board; Bostik Ultra-Set® Advanced, Bostik Black-Top™, Bostik GoldPlus™; existing, well-bonded vinyl/VCT or ceramic tile and cutback adhesive residue (dry only).

#### Big Tile & Stone™

##### POLYMER-MODIFIED LARGE & HEAVY TILE MORTAR

- For interior or exterior installations
- For large and heavy tile installations
- Exceeds ANSI A118.4 and A118.11



Bostik Big Tile & Stone™ is a polymer-modified, large & heavy tile mortar used for interior or exterior installations to set all large sized ceramic, porcelain, granite, slate, marble, limestone, thin porcelain tiles, large porcelain panels and dimensional stone tiles. Bostik Big Tile & Stone™ may also be used for vertical applications. Use over polyethylene uncoupling membranes and fleeced sheet membranes, structurally sound: properly prepared concrete, exterior grade plywood (interior/ dry use only), cementitious backer board, Bostik Ultra-Set® Advanced, Bostik Black-Top™, Bostik GoldPlus™ and existing, well-bonded vinyl composition tile (VCT) or ceramic tile. Big Tile & Stone™ may be used for uneven tile and stone thicknesses; or to minimize lippage. Big Tile & Stone™ white formulation is approved for non-sag applications for tiles up to 12" x 24".



Bosti-Set™ is an industry first innovation that utilizes Bostik's new Tenirex™ Polymer and a Thickness Control™ Spacer in the adhesive's polymer matrix. This combination results in a fast curing, highly workable and adjustable adhesive that reduces sound transmission on wall applications. Bosti-Set™ has revolutionized installations of Gauged Porcelain Tiles through faster installation speeds and stronger adhesive bonds while helping achieve International Building Code (IBC) acoustic performance requirements and sound control.

### GPTP ADHESIVE (WALLS)

#### Bosti-Set™

##### THIN PORCELAIN TILE PANEL ADHESIVE & SOUND REDUCTION MEMBRANE

- Non-sag, single-coat adhesive
- No water or mixing
- Thickness Control™ Spacer Technology



Bosti-Set™ is a one-component, non-sag, easy to trowel adhesive that is specifically formulated for the installation of thin (gauged) porcelain tile panels on interior, vertical surfaces or counter tops. Bostik's patent pending Tenirex™ Polymer Technology used in this product is a revolutionary, proprietary formulation found only in Bosti-Set™. Tenirex™ Polymer Technology provides the adhesive remarkable instant grab and holding power, enabling panels to be rapidly set on walls and repositioned for up to 30 minutes with no slip or sag. Bosti-Set™ requires only a single coat application for faster and easier installation than a conventional mortar installation and holds thin porcelain tiles as large as 1/4" x 5' x 10' (6mm x 1.5m x 3m). Once cured, Bosti-Set™ has a tenacious bond that remains tough, yet flexible for durability and sound abatement. This unique formulation is also easy to clean off tile surfaces before and after cure without the need for water or solvents. Bosti-Set™ contains 0% solvents, zero VOC (as calculated per SCAQMD Rule 1168) and is low-odor.

Introducing

# PanelTack™

An Industry leader in Discreet Wall Panel and Façade Cladding Solutions

Bostik has been a leader in the field of wall cladding and panel bonding with the PanelTack™ system for more than 30 years, with proven performance to highlight our knowledge, experience and innovation on a global scale.

Wall cladding has gained popularity in recent years for its durability, energy-saving benefits, the ease, speed and cleanliness of installation, and for a seamless aesthetic look. The adhesive system prevents the panels from sagging under their own weight, and they absorb cyclical expansion and contraction due to environmental changes, such as wind, temperature and humidity. Wall panel and façade cladding materials such as gauged porcelain tile panels, high-pressure laminate (HPL), aluminum composite materials (ACM), pressed mineral wool (PMW), fiber cement boards (FCB), porcelain, ceramic, concrete, porous substrates and other materials, to name just a few, are able to absorb wind loads and ensure a lasting bond under extreme conditions.

The complete PanelTack™ System includes Primer PanelTack™, FoamTape™, PanelTack HM™ and other PanelTack™ primers. Please refer to each product's Technical Data Sheet for a comprehensive list of approved substrates.

## THE PANELTACK™ SYSTEM

### PanelTack HM™

#### ADHESIVE FOR PANELTACK™ WALL PANEL AND FAÇADE CLADDING SYSTEM

- High modulus and permanently elastic for tension distribution
- Interior and exterior use
- Continuous bond of panel to substructure

PanelTack HM™ is a homogenous, highly elastic, smooth adhesive that provides a continuous bond of the panel to the support structure. PanelTack HM™ is suitable for use with various panels and wall cladding materials, including gauged porcelain tile panels, some high-pressure laminate panels (HPL), aluminum composite materials (ACM), pressed mineral wool (PMW), porous substrates, fiber cement boards (FCB), concrete, porcelain, ceramic and other natural materials.

### Primer PanelTack™

#### MULTI-PURPOSE PRIMER AND CLEANER FOR WALL PANEL AND FAÇADE CLADDING SYSTEMS

- HPL and ACM panels
- Transparent, quick-drying
- Ensures a strong adhesive bond

Primer PanelTack™ is an multi-purpose cleaner and primer used on the back of façade and decorative panels, and on aluminum and stainless steel support constructions. With high coverage and a 10-minute quick drying time, Primer PanelTack™ is suitable for use with various panels and wall cladding materials, including mesh backed GPTP, high-pressure laminate (HPL), aluminum composite materials (ACM), and other materials.

For more information about systems & products, visit **Bostik's YouTube channel:**  
[youtube.com/bostikUSA](https://www.youtube.com/bostikUSA)



### PanelTack™ Primer MSP™

#### PRIMER FOR TILE, FIBER CEMENT BOARDS, MINERAL AND POROUS WALL PANELS AND FAÇADE CLADDING SYSTEMS

- For FCB, PMW, natural stone, concrete, porous and mineral cladding panels
- Fast-drying
- Ensures a strong adhesive bond



Primer MSP™ is suitable for use with various panels and wall cladding materials, including some fiber cement boards (FCB), pressed mineral wool (PMW), concrete, natural stones, porous and mineral cladding panels.

### PanelTack™ Primer Q™

#### PRIMER FOR POROUS WALL PANEL AND FAÇADE CLADDING SYSTEMS

- For FCB panels
- For porous surfaces
- Ensures a strong adhesive bond

Primer Q™ is a transparent polyurethane suitable for use with pressed mineral wool (PMW), natural stone, ceramic and porcelain tiles, brick and concrete cladding panels.



### PanelTack™ FoamTape™

#### ADHESIVE TAPE AND SPACER FOR PANELTACK™ WALL PANEL AND FAÇADE CLADDING SYSTEM

- Provides the first adhesion on the façade panels while the adhesive cures
- Ensures the proper adhesive thickness between the panel and the support structure
- Ensures a strong adhesive bond

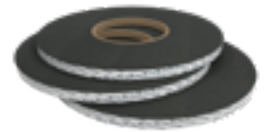

FoamTape™ serves as a spacer for the adhesive bead, to ensure the proper adhesive thickness between the panel and the support structure. FoamTape™ provides an initial fixation of the panel or substrate until the PanelTack HM™ adhesive has cured, while ensuring a strong, lasting bond. FoamTape™ is suitable for use with almost any panels and wall cladding materials, including gauged porcelain tile panels, high-pressure laminate (HPL), aluminum composite materials (ACM), pressed mineral wool (PMW), fiber cement boards (FCB), concrete, porcelain, ceramic, porous substrates and other natural materials.

## INSTANT GRAB ADHESIVE (INTERIORS)

### Grip N Grab™

#### ADVANCED HYBRID POLYMER GRAB ADHESIVE

- Extreme green strength
- Works with a variety of substrates and materials
- Ideal for interior walls in non-impact areas and trim pieces



Bostik's Grip N Grab™ is an instant grab adhesive, based on advanced hybrid polymer technology, specifically designed to decrease installation time of vertical applications. Grip N Grab™ high initial bond strength provides the ability to grab heavy materials quickly without slippage, eliminating the need for secondary support on majority of applications. Grip N Grab™ cures under the influence of humidity to form a durable elastic rubber, that bonds to most building materials in a variety of applications. This 100% waterproof, low odor formula is designed for both interior and exterior projects. Grip N Grab™ is solvent free, has a quick cure time, and can even be used on damp or wet surfaces.

# Grout & Joint Solutions

Gauged porcelain tile panels (GPTP), given their often large formats, imply that grout is less of a decision to make since there's significantly fewer grout joints in an installation. Now, GPTP are available in a variety of formats and can be used in a number of different installation types. Selection of grout, or expansion joint materials, is absolutely critical. Whether desiring chemical resistance, color consistency, ease of use, or flexibility, Bostik has the solution to complete your job with quality, durability and speed.

## PREMIUM GROUTING OPTIONS

### Hydroment® Vivid™

#### RAPID-CURING HIGH-PERFORMANCE GROUT

- Superior color consistency
- Fiber-reinforced durability
- Excellent stain resistance



Hydroment® Vivid™ is a rapid-curing, high-performance, cement grout developed with the scientific breakthroughs of Bostik's HyDrix™ and Color Suspension™ Technologies. HyDrix™ Technology allows Bostik to precisely control the timing and formation of both the chemical and physical matrices of Hydroment® Vivid™ grout during the curing process. Color Suspension™ Technology offers ease of installation because it forms a protective matrix around the pigment itself, keeping it evenly suspended during application and clean-up. The grout floats across the tile surface and remains easy to tool, which produces a superior, color consistent grout joint. Hydroment® Vivid™ exceed the requirements of ANSI 118.7 and contains Bostik's Blockade® Antimicrobial Protection. HyDrix™ Technology allows Bostik to precisely control the curing process and the development of the internal matrix of the Hydroment® Vivid™ grout. Hydroment® Vivid™ offers the most revolutionary grout technology in the industry today, making it the highest performing, most durable and user friendly grout solution available.

**Case Study:** Bosti-Set™ at Fertitta Center Arena is available at [Bostik.com/us](http://Bostik.com/us)

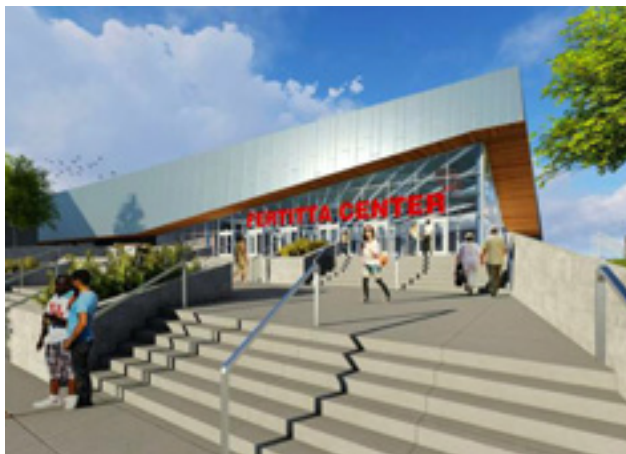

### EzPoxy™ EzClean™

#### 100% SOLIDS EPOXY MORTAR & GROUT

- Excellent cleanability
- Superior chemical resistance
- Meets ANSI A118.3 Specification



Bostik EzPoxy™ EzClean™ is a 100% Solids Epoxy Mortar & Grout with outstanding application and clean-up properties. Use with ceramic, quarry, porcelain, granite, slate, pre-cast terrazzo, dimensional and moisture sensitive stone tiles over properly prepared concrete, structurally sound, exterior grade plywood (interior/dry use only), cement backer board, Bostik GoldPlus™, Ultra-Set® Advanced, Black-Top™ and existing ceramic tile.

### TruColor® RapidCure™

#### PREMIUM, PRE-MIXED, URETHANE GROUT

- Consistent color every time
- No sealing required ever
- 3-day water exposure



Bostik TruColor® RapidCure™ premium, pre-mixed, urethane grout is a patented, water-based, grout offering the ultimate in color accuracy, water resistance, and stain and crack protection. This breakthrough formulation installs up to 50% faster than traditional grouts, and never needs to be sealed. Its perfect balance of flexibility and toughness enables it to exhibit unmatched performance. Unlike other grouts that contain loose color pigments which can cause staining or be washed away during the installation process, TruColor® RapidCure™ quartz aggregate is color coated to ensure perfect color consistency every time you install. TruColor® RapidCure™ contains Bostik's Blockade® antimicrobial protection, which inhibits the growth of bacteria, mold, or mildew on the surface of the dried grout and enables it to resist stains caused by mold. TruColor® RapidCure™ is approved for intermittent water exposure after only 3 days of cure and full water submersion after 7 days of cure (see typical working properties chart for details).

## HIGH-PERFORMANCE CAULK

### Pure Silicone™

#### 100% NEUTRAL-CURE SILICONE

- Waterproof
- Permanently flexible
- Conforms to TCNA Handbook EJ171



Pure Silicone™ sealant is a specially formulated, neutral-cure, 100% silicone sealant for a variety of substrates such as ceramic tile, slate, wood, metal, glass, fiberglass, laminate and plastic. For use as a flexible barrier between horizontal and vertical surfaces or any other changes in plane such as expansion joints in non-traffic areas, fixtures, tub surrounds, sinks, toilets, vanities, electrical plumbing penetrations, floors, walls and ceilings. Pure Silicone™ is designed for use in interior, exterior, intermittent wet and dry installations. Pure Silicone™ has superior elongation and flexibility for use in change of plane joint applications. Pure Silicone™ sealant meets or exceeds the test requirements of:

- Meets ASTM C-920; Type S; Grade NS; Class 25; Use A, G, I, M, NT, O
- Federal Specification TT-SS-0001543A (COM-NBS) Class A, Type NS, Class A, Use G
- Federal Specification TT-S-00230C (COM-NBS) Type II, Class A, Use G

Additional Bostik products may be suitable for Gauged Porcelain Tile Panels, contact your Territory Sales Manager or Technical Service to determine which solutions are right for your project.





# Bostik Pro Rewards™

## Contractor Loyalty Program

Now you can earn valuable reward points which can be redeemed for thousands of brand name items or travel rewards, all while growing your business!

To join the **Bostik Pro Rewards™** contractor loyalty program, visit: [www.awardlink.com/Bostik](http://www.awardlink.com/Bostik) where you'll be asked to create a user name and password for your account.

1. Register all eligible Bostik product purchases by submitting your invoices via our rewards program web portal.
2. All registered Bostik product purchases will automatically be deposited into your **Bostik Pro Rewards™** account.
3. Redeem the points you've earned for a wide variety of great rewards.

# JOIN NOW!

[www.awardlink.com/Bostik](http://www.awardlink.com/Bostik)



**BOSTIK HOTLINE**  
**Smart help**  
**1-800-726-7845**

Bostik, Inc.  
 11320 W. Watertown Plank Road  
 Wauwatosa, WI 53226  
[www.bostik.com/us](http://www.bostik.com/us)



This document supersedes all previously published literature.