

# WATERPROOFING

## Barritape™

### Description

Barritape is a 20-mil self-adhering exterior sheathing joint tape consisting of a flexible, dimensionally stable polypropylene film laminated with an aggressively tacky, rubber-modified asphalt adhesive. Available 4" width x 100' rolls interleaved with a disposable release paper liner that is removed during application, Barritape offers factory-controlled uniformity with quick and easy peel-and-stick application. This self-adhering flashing exhibits tenacious grip when pressed against the substrate and provides excellent air and moisture leakage protection over exterior sheathing joints.

### Features and Benefits

- Provides a positive, visually verifiable seal over sheathing joints
- Provides a continuous, supported surface for application of fluid-applied air/vapor barrier over sheathing joints
- Compatible with Barriseal™ fluid-applied air/vapor barrier
- Permanently adhered to substrate with use of CCW contact adhesives
- Use with CAV-GRIP allows surface prep and joint taping in same lift
- Part of a complete building envelope protection system from CCW

### Installation

Barritape can be applied over most common exterior sheathing surfaces including gypsum board, insulation board, water-resistant facers on gypsum or insulation board, oriented strand board (OSB) and plywood. Barritape can span sheathing joints up to ¼" wide. Joints exceeding ¼" shall be filled with LM-800XL sealant or other approved material. Strike sealant flush and allow full cure before covering with Barritape.

Apply CCW contact adhesive to clean, dry surfaces. Apply thin, continuous coating of contact adhesive.

Allow contact adhesive to dry until it does not transfer when touched, but still has tack. Re-apply contact adhesive to surfaces that have become dusty or lost tack. Apply Barritape over surface the same day of application of contact adhesive.

When installing CCW sheet membranes and sheet flashings over gyp-sheathing with glass-mat facers, coverage rates for contact adhesives and primers will depend on the porosity and texture of the sheathing and will vary substantially by gypsum-sheathing brand and manufacturer.

To achieve consistent contact adhesive and/or primer coverage with adequate tack, it may be necessary to decrease the coverage rate (i.e. increase the amount applied) of the contact adhesive and/or primer and/or the application of multiple coats. CCW Contact adhesives and primers shall be allowed to dry completely (lower temperatures will extend drying time) before additional coats are applied or membranes installed. Caution should be taken as contact adhesives and/or primers applied to gyp-sheathings with glass-mat facers will take longer to dry than other substrates. Multiple adhesion tests should be performed randomly to verify proper application of primer and ensure a successful application.

Position Barritape over joint, remove release paper and bond in place with hand pressure. Make straight, clean cuts of Barritape from roll with sharp utility knife or scissors. Avoid forming wrinkles or bubbles. Lap adjacent pieces of Barritape at least 2". Sequence installation to provide shingled laps. Roll Barritape firmly in place with hand roller tool.

Cover Barritape with Barriseal, board insulation or exterior cladding as soon as schedule allows.

Outside temperatures below 40°F require these additional steps to the normal application procedure: Store Barritape in heated area until use. Prepare surfaces with CCW-702 or CAV-GRIP. Do not use CCW-702 WB in these cold temperatures. Where CAV-GRIP is used, store cylinder, hose and gun in heated area until use and maintain at 60°F or higher during spray. Once surfaces are ready, bring Barritape out of heated area and apply as soon as possible. This procedure enables installation down to 25°F.

### Limitations

Do not leave Barritape exposed for longer than 30 days.

Do not apply Barritape or CCW contact adhesives to dirty, damp, frosty or contaminated surfaces.

Apply at temperatures of 40°F or higher unless special procedure for low-temperature application is followed. Do not apply where temperature exceeding 149°F is expected.

### Storage

Protect materials from excessive heat or cold. Store away from open flames, sparks or welding. For outside storage, protect cartons from rain, direct sunlight or other harmful environmental conditions. Consult with a Carlisle representative for extreme high or low temperatures.

# WATERPROOFING

## Barritape

### Packaging

Product	Size
4" x 100' rolls	12 per case, 27 cases per pallet
CCW-702 Solvent-Based Contact Adhesive	1-gal can; 5-gal pail
CCW-702 VOC Compliant Solvent-Based Contact Adhesive	5-gal pail
CCW-702 WB Water-Based Contact Adhesive	5-gal pail
CAV-GRIP Aerosol Spray Contact Adhesive	40 # Aerosol Cylinder (30 lb fill weight of adhesive); spray gun; Hose: 6', 12' or 18' length
CCW LM-800XL Mastic	29 fl-oz cartridges, 12 per case; 1-gal can; 5-gal pail

### Typical Application

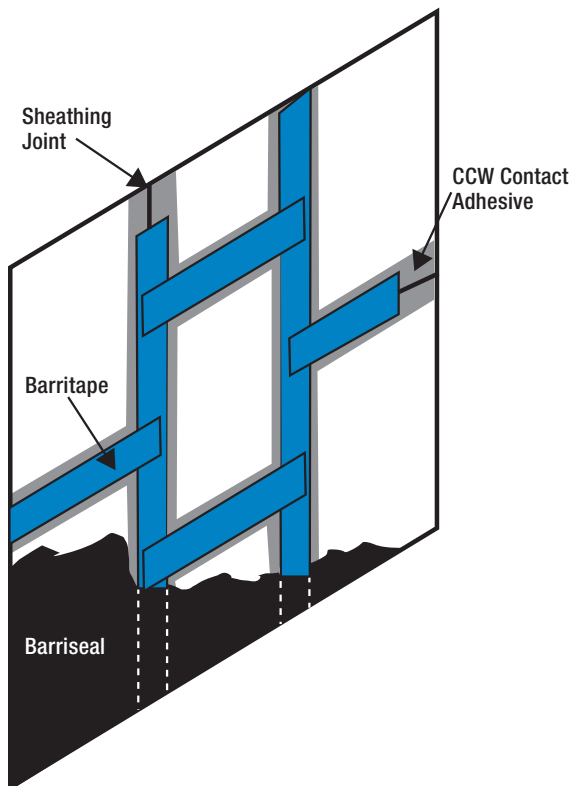

### Typical Properties

Property	Method	Results
Thickness	—	20 mils
Tensile	ASTM D412	709 psi
Elongation	ASTM D412	500%
Peel Strength	ASTM D903	4.5 lb/in width
Puncture Resistance	ASTM E154	27 lbs (min)
Lap Adhesion	D1876 Mod	4.5 lb/in width

### Limited Warranty

Carlisle Coatings & Waterproofing Incorporated (Carlisle) warrants this product to be free of defects in workmanship and materials only at the time of shipment from our factory. If any Carlisle materials prove to contain manufacturing defects that substantially affect their performance, Carlisle will, at its option, replace the materials or refund its purchase price. This limited warranty is the only warranty extended by Carlisle with respect to its materials. There are no other warranties, including the implied warranties of merchantability and fitness for a particular purpose. Carlisle specifically disclaims liability for any incidental, consequential, or other damages, including but not limited to, loss of profits or damages to a structure or its contents, arising under any theory of law whatsoever. The dollar value of Carlisle's liability and buyer's remedy under this limited warranty shall not exceed the purchase price of the Carlisle material in question.