

BARRITECH VP
ROLLER APPLICATION

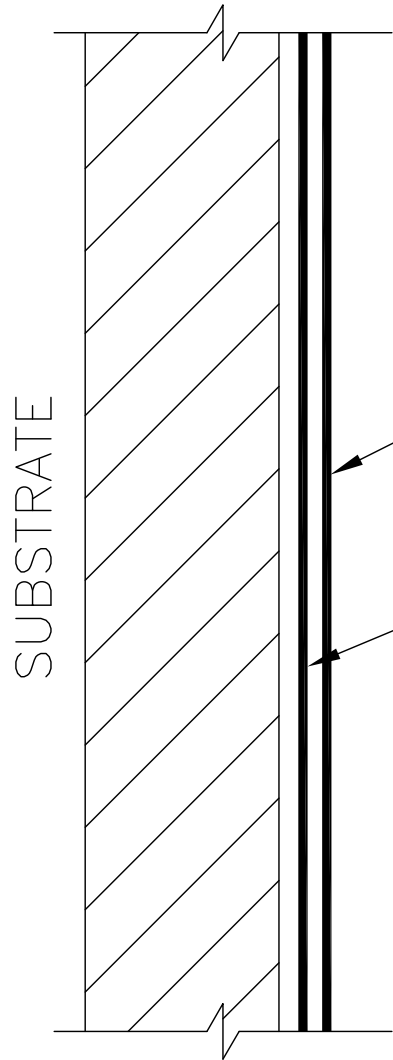

TOP COAT BARRITECH VP,
MINIMUM 30 WET MILS

BASE COAT BARRITECH VP,
MINIMUM 30 WET MILS

BARRITECH VP, SINGLE OR
MULTIPLE COATS, MINIMUM
60 WET MILS

NOTES:

1. FOR ROLLER APPLICATION, ALLOW PREVIOUS COAT TO DRY FIRM BEFORE APPLICATION OF SUBSEQUENT COAT

BARRITECH VP
SPRAY APPLICATION

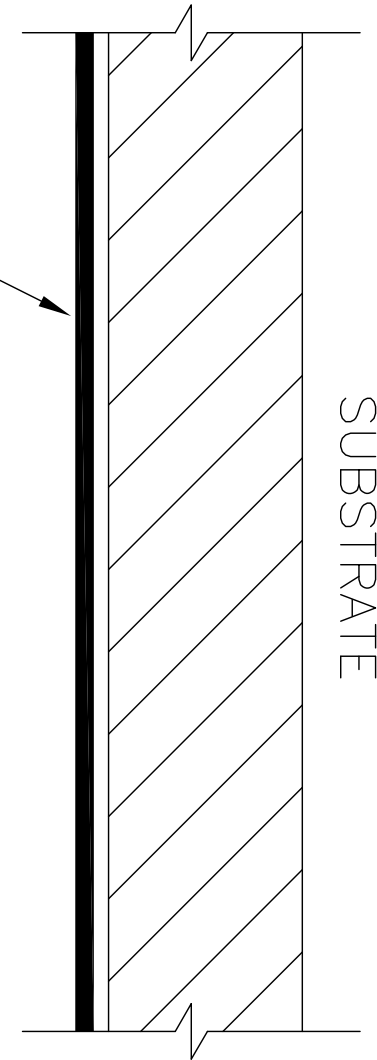

DETAIL IS INTENDED TO BE A GUIDE
FOR AIR BARRIER INSTALLATION ONLY.

BVP-1A

BARRITECH VP
COVERAGE

CARLISLE
COATINGS & WATERPROOFING

© 2012 CARLISLE CORPORATION