



WATERPROOFING

MiraPLY™ Seam Tape-LT



Description

MiraPLY Seam Tape-LT is a primer-less, double sided tape with a tough, conformable carrier and aggressive adhesive system for sealing and holding to difficult-to-stick-to surfaces under a variety of conditions.

Features and Benefits

- Offers aggressive, quick sticking adhesive for fast and sure holding.
- Moisture resistant.
- Can be exposed for up to 60 days.
- Can be applied at temperatures as low as 25 °F (-4 °C).
- Primer-less.
- Unique combination of adhesive and proprietary carrier conforms and seals over and around irregular surfaces.
- Easy releasing PET liner which is strong and tear resistant.

Product Construction

Carrier	Adhesive	Liner	Color	Standard Roll Length	Width
Proprietary Film	Butyl	Clear PET	Gray	75 feet	6"

Installation

1. Overlap the membranes the appropriate amount. For 6" (150 mm) Seam Tape-LT, overlap the membranes 6" (152.4 mm).
2. All surfaces to receive the Seam Tape-LT must be clean. The Seam Tape-LT will not adhere to dusted or dirty surfaces. Any residual contamination will be detrimental to the bond strength of the adhesive.
3. Remove all foreign material.
 - a. Remove excess mica dust by brooming or wiping with a clean, dry rag or CCW HP Splice Wipe.
 - b. The use of Weathered Membrane Cleaner may be necessary.
 - c. This process is essential on membrane that has been exposed to construction dust or silt.
 - d. Allow the membrane to dry thoroughly before proceeding.
4. Mark the bottom sheet with a crayon approximately ¼" (6 mm) at the edge of the top sheet along the entire splice length as a guide to install the Seam Tape-LT.
5. Unroll approximately 3' (1 m) of Seam Tape-LT. Align the tape with a marked line and press tape down to bottom sheet using firm, even hand pressure. Continue for the length of the splice. Tape roll ends should be overlapped 1" (25 mm). Allow top sheet to rest on poly backing after application. A minimum of ⅛" (3 mm) to a maximum of ½" (12 mm) of tape must extend beyond the splice edge. A continuous piece of Seam Tape-LT must be used at all field and factory splice intersections. Rolling the Seam Tape-LT with a 2"-wide rubber hand roller after application will significantly reduce the frequency of air blisters in the completed field seam.

WATERPROOFING

MiraPLY Seam Tape-LT

6. Pull the poly backing from the Seam Tape-LT beneath the top sheet and allow the top sheet to fall freely onto the exposed tape.
7. Press top sheet onto tape using firm, even hand pressure across the splice towards the splice edge.
8. Immediately roll the splice with a 2"-wide rubber hand roller using positive pressure. Roll across the splice edge, not parallel to it.
9. The use of Lap Sealant with Seam Tape-LT splices is optional except at cut edges of reinforced membrane (exposed scrim reinforcement and tape overlaps), where Lap Sealant must be utilized. Lap Sealant may be applied immediately following the completion of a Seam Tape splice. See Lap Sealant TDS or appropriate detail for more information.

Storage

Store under normal conditions of 60° to 80°F (16° to 27°C) and 40 to 60% R.H. in the original carton.

Shelf Life

To obtain best performance, use this product within 24 months from date of manufacture.

Technical Information

The technical information, recommendations and other statements contained in this document are based upon tests or experience that CCW believes are reliable, but the accuracy or completeness of such information is not guaranteed.

Product Use

Many factors beyond CCW's control and uniquely within user's knowledge and control can affect the use and performance of a product in a particular application. Given the variety of factors that can affect the use and performance of a CCW product, user is solely responsible for evaluating the CCW product and determining whether it is fit for a particular purpose and suitable for user's method of application.

Typical Properties

		ASTM Test Method
Adhesion to Steel:	58 oz./in. width (63 N/100 mm)	D-3330
Carrier Thickness:	10 mils (0.26 mm)	D-3652
Tape Thickness:	40.0 mils (0.38 mm)	D-3652
Liner Thickness:	2 mils (0.05 mm)	D-3652
Application Temp. Range:	25°F to 80°F	

Note: The following technical information and data should be considered representative or typical only and should not be used for specification purposes.

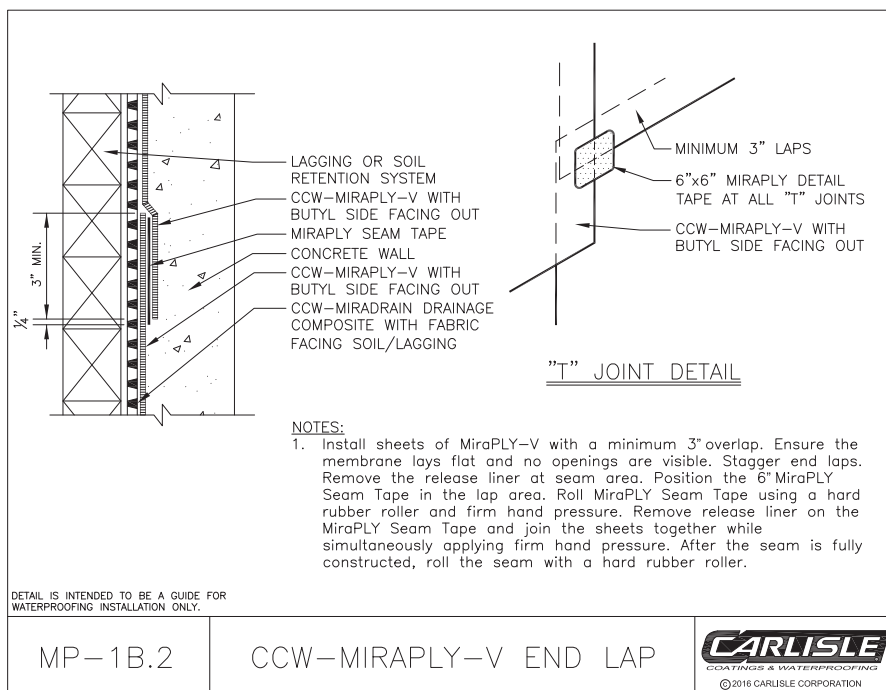
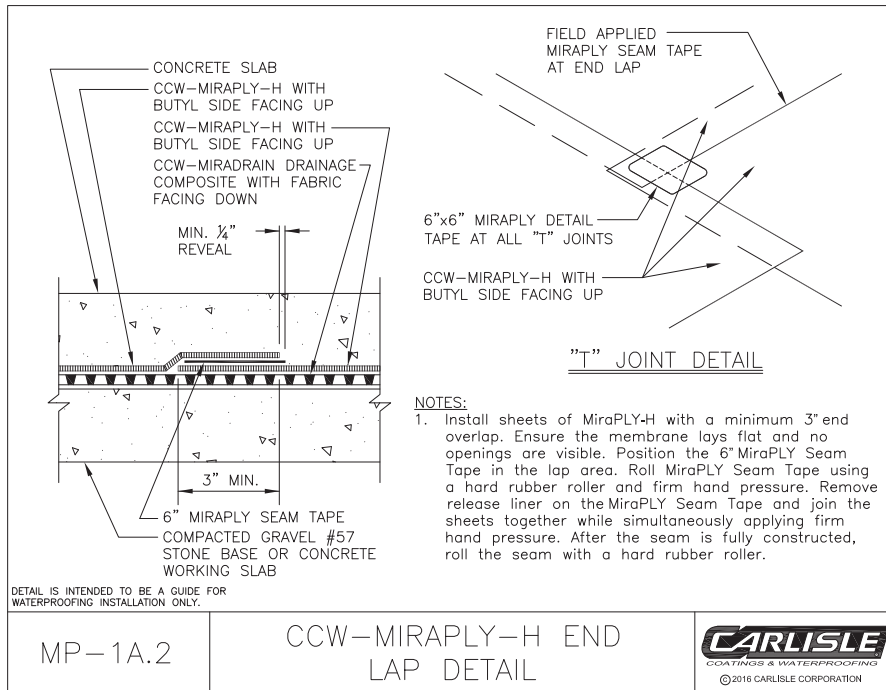

WATERPROOFING

MiraPLY Seam Tape-LT

Warranty, Limited Remedy, and Disclaimer

Unless an additional warranty is specifically stated on the applicable CCW product packaging or product literature, CCW warrants that each product meets the applicable product specification at the time CCW ships the product. CCW MAKES NO OTHER WARRANTIES OR CONDITIONS, EXPRESS OR IMPLIED, INCLUDING, BUT NOT LIMITED TO, ANY IMPLIED WARRANTY OR CONDITION OF MERCHANTABILITY OR FITNESS FOR A PARTICULAR PURPOSE OR ANY IMPLIED WARRANTY OR CONDITION ARISING OUT OF A COURSE OF DEALING, CUSTOM OR USAGE OF TRADE.

If the CCW product does not conform to this warranty, then the sole and exclusive remedy is, at CCW's option, replacement of the CCW product or refund of the purchase price.

Limitation of Liability

Except where prohibited by law, CCW will not be liable for any loss or damage arising from the product, whether direct, indirect, special, incidental or consequential, regardless of the legal theory asserted, including warranty, contract, negligence or strict liability.