

# AccuTrac® Plate

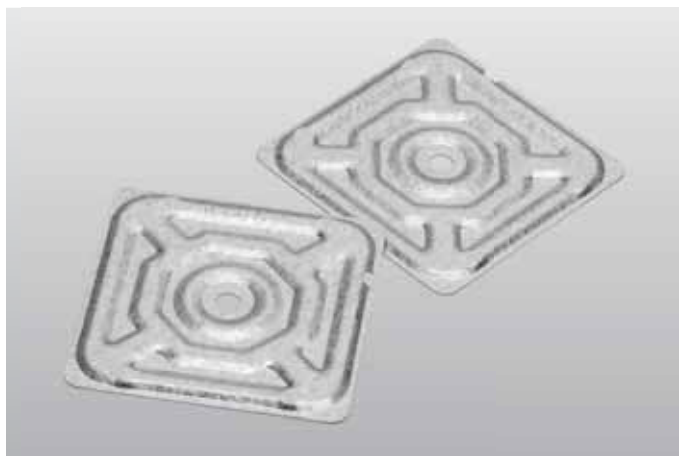

## Overview

Carlisle's AccuTrac Steel Insulation Plates have a Galvalume® coating and are available in two designs. The 3" (75 mm) square, recessed AccuTrac Plate may be used with manufactured hex head fasteners, Phillips head fasteners, or square drive fasteners. The 3" (75 mm) square, flat-bottom AccuTrac Plate is used with manufactured Phillips head fasteners only.

## Features and Benefits

- » Recessed AccuTrac Plates feature deep reinforcing ribs for superior resistance to bending
- » Flat-bottom AccuTrac Plates can be used with DensDeck® Prime, SECUROCK®, OSB, and ½" SecurShield™ HD
- » Plates are packaged 125 per sleeve for easy loading into the AccuTrac Tool
- » Plates are packaged in weather-proof buckets; two Phillips drive bits are included
- » Factory Mutual and Dade County approved

## Productivity Boosting Features and Benefits:

- » Improved productivity when compared to traditional installation methods
- » Using AccuTrac Tool to attach insulation is up to 38% faster than traditional installation methods
- » AccuTracTool allows users to stand up while installing fasteners instead of bending over, making the job easier
- » No more placing insulation plates by hand: plates are automatically fed into AccuTrac boot
- » Once calibrated, fasteners are driven to the proper depth every time, ensuring maximum thread engagement and pullout performance



## Installation

1. For use with InsulFast™, HD 14-10, and HP-X Fasteners™ up to 6" (150 mm), and the AccuTrac Tool to attach insulation.

*Review Carlisle specifications and details for complete installation information.*

## Precautions

- » AccuTrac Plates should only be used when fastening insulation with the AccuTrac Tool.

## Packaging

Style	Weight/Carton – Pounds (Kg)	Plates/Bucket
Flat	43 (19.52)	1,000/bucket
Recessed	43 (19.52)	1,000/bucket

Typical properties and characteristics are based on samples tested and are not guaranteed for all samples of this product. This data and information is intended as a guide and does not reflect the specification range for any particular property of this product.