

GreenGuard® PB6 Fanfold Roofing Recover Board



Overview

Carlisle's GreenGuard PB6 is a lightweight roofing recovery board consisting of a high-density extruded polystyrene (XPS) foam core with high-strength film facers on both sides. PB6 can be used under mechanically attached or loose-laid, ballasted applications. The recovery board is both UL and FM approved.

Features and Benefits

- » High-density and moisture-resistant XPS foam core provides protection for the new roof membrane.
- » Lightweight material allows for fast, easy installation.
- » Withstands pressure from foot and equipment traffic.
- » Rigid, fan-folded bundles allow for maximum coverage of 200 square feet.

Panel Characteristics

- » Normal Thickness: $\frac{3}{8}$ " (9.51 mm)
- » Size: 4' x 50' (1.2 x 15.2 m)

Installation

1. Unfold three sections of the 50' (15.2 m) bundle of PB6 and attach it to the existing roof deck using 2-3" (76 mm) diameter plates and screws that are long enough to penetrate through the existing roof system to the underlying roof deck.
2. Attach PB6 using the fastening pattern shown in Figure 1 or Figure 2.
3. Additional fasteners may be used if necessary to secure the roofing recovery board during windy conditions or when the surface of the existing roof system has inconsistencies.
4. The PB6 should be installed with the longest dimension perpendicular to the membrane seams and with end joints staggered. Note: Factory Mutual Research requires that a minimum of 4 fasteners (1 fastener / 4 ft²) be used for insulations having any one dimension greater than 4' (1.2 m) on a job that involve building insured by Factory Mutual underwriter companies.

Typical Physical Properties

Property	Test Method	PB6
Thermal Resistance , R-value ¹ (°F-ft ² -h/Btu) ¹	ASTM C518 (@ 75 °F Mean Temperature)	1.5
Thermal Conductivity (Btu-in/hr-ft ² -°F)	ASTM C518 (@ 75 °F Mean Temp., k)	0.25
Water Vapor Permeance (perm)	ASTM E96 (Procedure A)	0.6
Water Absorption (max. % by Volume)	ASTM C272	0.6
Compressive Strength (psi @ 10% Deflection)	ASTM D1621	15
Fire Characteristics ² Flame Spread Smoke Developed	ASTM E84/UL 723	10 45-140
Max Recommended Use Temp. (°F)		200
Average Weight (lbs./1,000 sq. ft.)		105

Dimensions/Packaging

Thickness (Nominal)	$\frac{3}{8}$ "
Bundle Dimensions	4' x 50'
Square Feet/Bundle	200
Bundles/Pallet	30
Square Feet/Pallet	6,000

GreenGuard PB6 Fanfold Roofing Recover Board

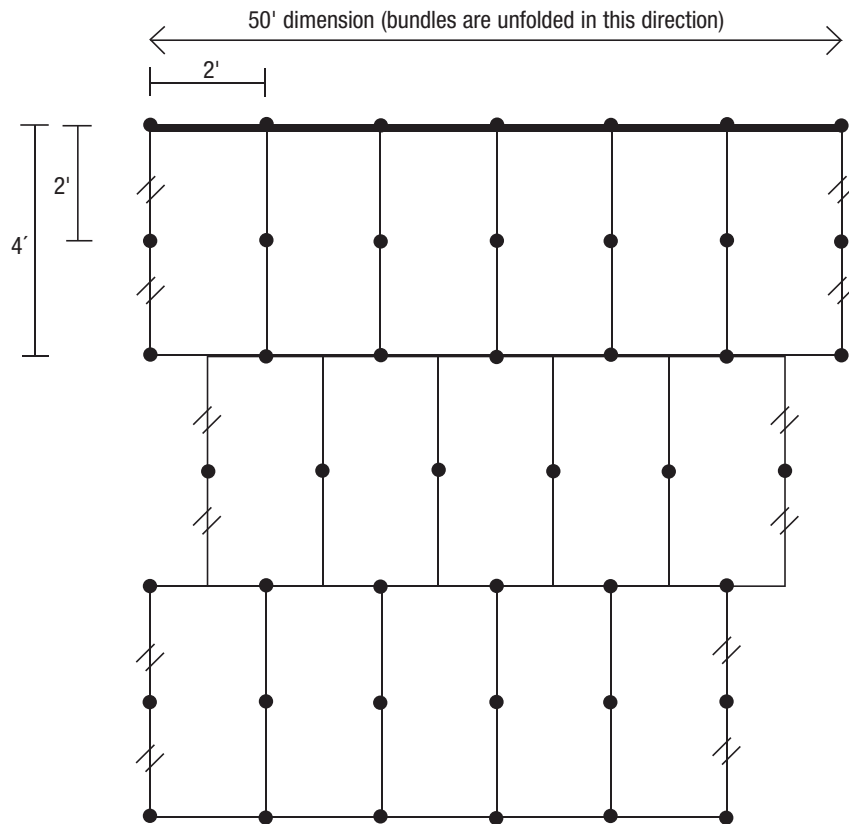

Figure 1 Fastening Pattern for GreenGuard PB6 Roofing Recover Boards Installed Directly Under Dark-colored Roof Membranes in Mechanically Attached and Loose-Laid and Ballasted Roof Systems. (Top view, represents only a small portion of three adjacent GreenGuard PB6 bundles are shown.)

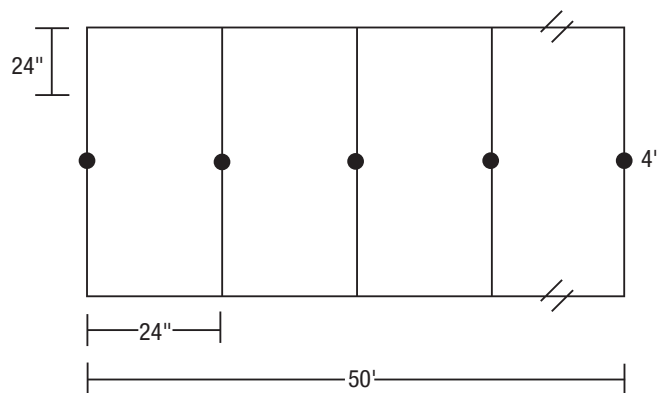

Figure 2 GreenGuard PB6 used under light-colored roof membranes.