

SecurEdge™ 200 Cantilevered Coping

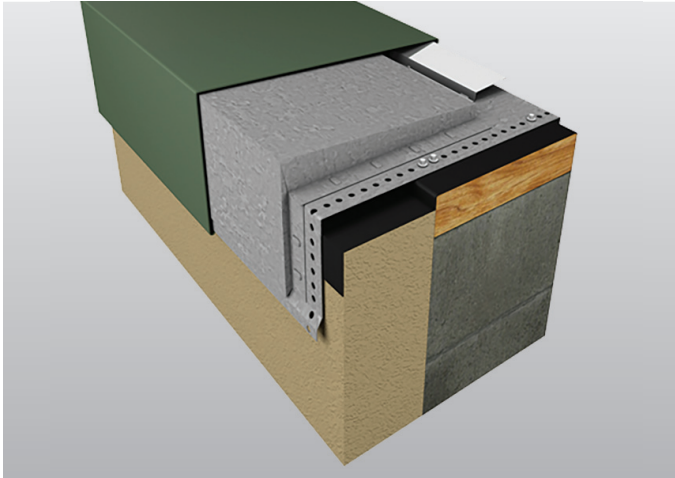

Overview

Carlisle's SecurEdge 200 Cantilevered Coping is ideal for attachment to parapet walls with a non-structural exterior building facade. When exterior insulation finishing system, brick, or panels don't allow for traditional anchoring to the exterior building structure, SecurEdge 200 Cantilevered Coping's unique support brackets add extra stability to the roof edge system in cases where the attachment is up to 6" away from the outside facade. Its full snap-on design features 16-gauge galvanized steel anchor clips and factory-applied stainless steel springs, which ensure long-term positive attachment.

Features and Benefits

- » Manufactured in 12' snap-on lengths with no crimping required
- » Pre-punched fastening holes ensure proper attachment
- » Corrosion-resistant stainless steel springs are factory-applied to the anchor clips, providing long-term positive spring loading
- » Available in a wide variety of warranted colors and finishes to match any building
- » 12"-wide, 16-gauge spring clips placed 3' on center provide positive attachment for extra system stability
- » Designed and ANSI/SPRI ES-1 tested to comply with International Building Code
- » Factory Mutual (FM)-Approved

Installation

For complete installation instructions, refer to Carlisle specifications and details or visit www.carlisesyntec.com.

Finishes

- » Natural mill finish aluminum
- » Standard pre-coat Kynar® 500 colors from Carlisle's standard color chart
- » Premium metallic Kynar
- » Anodized aluminum – clear, bronze, and black
- » Custom post-painted Kynar finishes - available upon request

Quality Assurance

SecurEdge 200 Cantilevered Coping is tested per ANSI/SPRI Pull-Off test for coping. Coping shall be certified by Carlisle to design pressures as indicated in current edition of SPRI's Wind Resistance Standard for Edge Systems used with Low-Slope Roofing Systems. Meets International Building Code. FM-Approved.

Technical Services

Engineering and shop drawings, long-form specifications, and CAD details are available from Carlisle. Product samples, detail sheets, color chips, and color charts are also available for submittal packages. For assistance with questions or submittals, contact Carlisle or a Carlisle Manufacturer's Representative.