

SecurWeld® 200 PVC Skirted Drip Edge

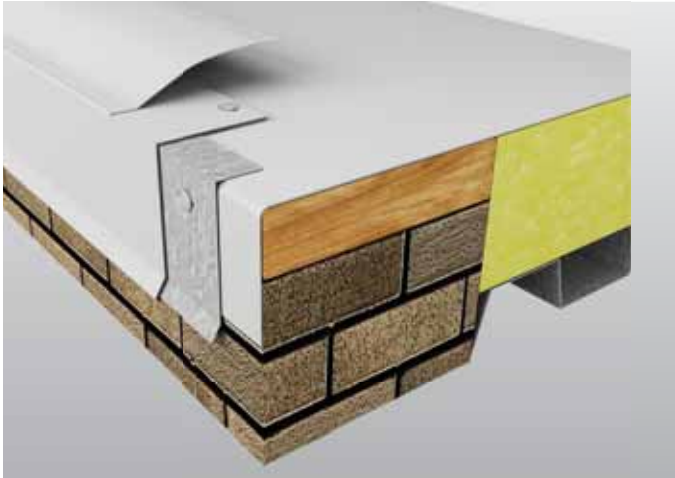

- » Tan and gray (special order)

Quality Assurance

Tested up to 577 psf per ANSI/SPRI Pull-Off Test for fascia. This product is eligible to meet International Building Code and is Florida Building Code Approved.

Technical Services

Engineering and shop drawings, as well as long-form specifications and CAD details, are available from Carlisle. Product samples, detail sheets, color chips, and color charts are also available for submittal packages. For assistance with questions or submittals, contact Carlisle or your local manufacturer's representative.

Overview

Carlisle's SecurWeld 200 PVC Skirted Drip Edge features a 60-mil (1.52 mm) 6"-wide, pre-attached, factory-heat-welded PVC membrane flashing skirt which facilitates a quicker installation and lowers labor costs. Manufactured in 12' lengths, this product features pre-punched fastening holes that are slotted to allow for proper thermal movement of materials. This product is ANSI/SPRI ES-1 tested and Florida Building Code Approved.

Features and Benefits

- » Manufactured in 12' lengths with pre-punched holes that are slotted to allow for proper thermal movement of materials
- » Factory-applied Carlisle Sure-Flex™ PVC Flashing saves labor
- » Carefully designed and ANSI/SPRI ES-1 tested to comply with International Building Code
- » Florida Building Code Approved
- » Available in face sizes from 1 ¼" - 8"

Installation

For complete installation instructions, refer to Carlisle specifications and details or visit www.carlisesyntec.com.

Colors Available

- » White (standard)