

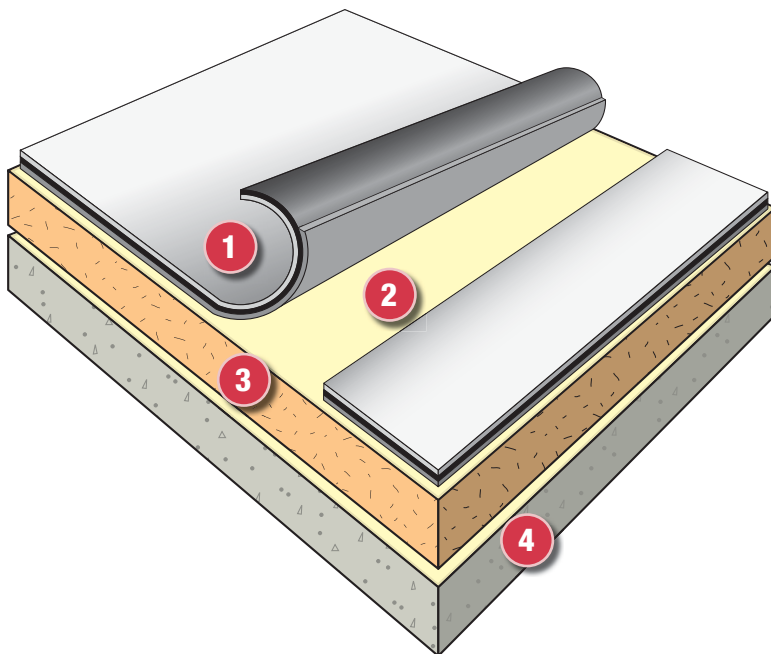

SURE-WELD FLEECEBACK®

FULLY ADHERED ROOFING SYSTEM



TYPICAL APPLICATION

- 1 Sure-Weld FleeceBACK Membrane
- 2 Insulating FAST™ Adhesive
- 3 Acceptable Insulation
- 4 Approved Roof Deck

SYSTEM FEATURES AND BENEFITS INCLUDE:

- Heat-weldable membranes
- Reduced noise during installation
- High wind uplift performance
- Hail and puncture resistance
- Top-ply membrane thickness adds improved long-term weatherability and durability
- Can be installed on non-nailable decks using patented VOC-free FAST adhesive for secure attachment
- White and tan SWFB membrane meets ENERGY STAR® performance guidelines
- Insulating FAST Adhesive adds R-value

Fully Adhered Systems are available in the following:

Colors: White, Gray, Tan

Thicknesses (mils) TPO + Fleece: 100 and 115

Standard Widths: 6' and 12'

Standard Lengths: 50' and 100' (6' only in 100' roll)

| EXISTING OR NEW DECK TYPE | NEW CONSTRUCTION | | | | | | REROOFING | | |
|---------------------------|--|---------|------------------|---------------------|-------------|-------------------------|---------------------------|---------------------|---------------------|
| | STEEL | PLYWOOD | LT. WT. CONCRETE | STRUCTURAL CONCRETE | WOOD PLANKS | GYPSUM & FIBROUS CEMENT | SMOOTH BUR SURFACE | GRAVEL SURFACED BUR | EXISTING SINGLE PLY |
| INSULATION REQUIRED | YES | NO | NO | NO | NO | NO | NO | YES | NO |
| RECOMMENDED INSULATIONS | CARLISLE POLYISO, HP RECOVERY BOARD, DENS-DECK, SECUROCK OR HP RECOVERY BOARD OVER ACCEPTABLE INSULATION | | | | | | REFER TO NEW CONSTRUCTION | | |
| INSULATION ATTACHED BY | FAST ADHESIVE OR CARLISLE FASTENERS | | | | | | REFER TO NEW CONSTRUCTION | | |
| MEMBRANE ATTACHED BY | FAST ADHESIVE | | | | | | REFER TO NEW CONSTRUCTION | | |

FOR TEAR OFF OPTIONS REFER TO NEW CONSTRUCTION ABOVE.

For current code approvals and warranties, visit Carlisle's web site or contact a design analyst.

* Refer to Carlisle's Sure-Weld FleeceBACK Design Criteria portion of the current specifications.



OCTAGUARD XT
WEATHERING PACKAGE

Investing in Roofing Solutions for Over 45 Years

800-4-SYNTEC • P.O. Box 7000 • Carlisle, PA 17013 • Fax: 717-245-7053 • www.carlisle-syntec.com



Carlisle SynTec



SURE-WELD FLEECEBACK

FULLY ADHERED ROOFING SYSTEM

Project Information

This Fully Adhered Roofing System is being installed for the project named below.

Job Name: _____

City: _____

State: _____

The Carlisle Authorized Roofing Applicator is: _____

Company Name: _____

Address: _____

City: _____

State: _____

Zip: _____

Phone: _____

Installation

Carlisle's Sure-Weld FleeceBACK Fully Adhered Roofing System utilizes 45- or 60-mil thick white, gray or tan Sure-Weld thermoplastic polyolefin (TPO) membrane laminated to a non-woven polyester fleece backing.

FAST Adhesive, a low-rise insulating, two-component spray-applied polyurethane adhesive, is used to adhere insulation to the substrate. FAST Adhesive is then sprayed onto the insulation and Sure-Weld FleeceBACK membrane is rolled into the foamed adhesive after it develops string/body. Adjoining sheets are hot air welded to form a monolithic assembly.

The above information represents a typical Carlisle Sure-Weld Fully Adhered Roofing System application. Refer to Carlisle's published specifications and details for more complete information.

Sure-Weld Membrane Strengths

- Sure-Weld FleeceBACK Membrane is available in white, gray and tan; 12'-widths
- When tested for puncture resistance, Sure-Weld FleeceBACK results were notably better than competitive heat weldable membranes including PVC and Hypalon
- Sure-Weld white and tan membrane reflectivity values meet and/or exceed the white ENERGY STAR® program requirements
- Sure-Weld membranes are considered environmentally friendly as they do not contain chlorine or plasticizers
- 12'-wide widths result in substantial material and labor savings
- Membranes resist hail damage and tolerate frequent foot traffic
- Sure-Weld FleeceBACK's smooth top-ply surface resists dirt pickup and bacteria growth plus provides for a clean monolithic seam weld
- Sure-Weld membrane features OctaGuard XT weathering technology, which provides superior long-term weathering protection. OctaGuard

XT technology is comprised of eight performance enhancing ingredients, including three antioxidants, three UV light stabilizers as well as organic and inorganic UV absorbers providing a weathering package second to none in the TPO industry.

System Codes

UL Class A and B ratings are available over various deck types. FM codes are available ranging from FM 1-90 to FM 1-990. For code specifics, also refer to Carlisle's Code Approval Guide.

Quality Assurance

Carlisle Authorized Applicators have been trained to install Fully Adhered Roofing Systems

Inspection

Upon installation completion, and prior to the issuance of a membrane system warranty, an inspection will be conducted by a Carlisle Field Service Representative.

Warranty

Consult your Authorized Applicator or Carlisle Manufacturer's Representative/Distributor for associated warranty charges.

This system properly installed and inspected on a commercial project may receive:

- A 5- or 10- year Membrane System Warranty; peak gust wind speed coverage up to 80 mph.
- A 10-year, 15-year or 20-year Golden Seal™ Total System Warranty may be requested when all materials used for the roofing installation are manufactured or marketed by Carlisle.
- A maximum peak gust wind speed coverage of 120 mph is available with design enhancements
- A 10-year Reflective Warranty (based on ENERGY STAR criteria) is available for white membrane
- A hail resistance warranty may be included for up to 1" hail for SWFB 100 and up to 2" hail for SWFB 115
- A limited accidental puncture warranty is also available when using FleeceBACK 115

For more specifics or for International warranty programs, contact Carlisle.



Investing in Roofing Solutions for Over 45 Years

800-4-SYNTEC • P.O. Box 7000 • Carlisle, PA 17013 • Fax: 717-245-7053 • www.carlisle-syntec.com
Carlisle, Sure-Weld, FleeceBACK, FAST and Golden Seal are trademarks of Carlisle. ENERGY STAR is a registered trademark owned by the U.S. Government.
REPRINT CODE: 600470 - SWFB-Fully Adhered System Sheet - 07/15/09 © 2009 Carlisle.

