

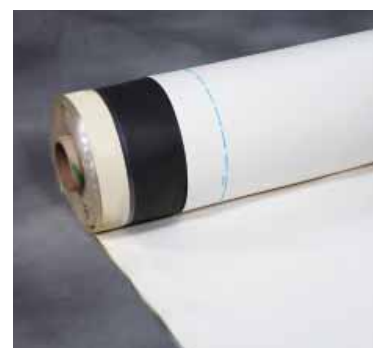

CARLISLE'S
SURE-WHITE[®]
WHITE EPDM ROOFING SYSTEMS

REFLECTIVE • EFFICIENT INSTALLATION • PROVEN PERFORMANCE





CARLISLE'S **SURE-WHITE®**

Sure-White® EPDM Roofing Systems

Highly reflective and aesthetically pleasing, Carlisle's Sure-White membrane is the only white EPDM membrane with 25 years of proven field experience. Specially developed for Carlisle's fully adhered systems, the membrane offers superior performance including greater durability and puncture resistance. Environmentally friendly, the Sure-White roofing system can withstand enhanced wind uplifts and long-term weathering.

History of Carlisle

50 years ago, Carlisle pioneered single-ply roofing. Today, more than 15 billion square feet of membrane have been sold and installed. No other manufacturer has a comparable track record. EPDM's success is due to its many exceptional characteristics, including material longevity, weatherability and elasticity.

These non-reinforced membranes are lightweight and easy to maneuver on the roof and offer optimal reroofing as well as new roofing solutions.

ENERGY STAR®-Qualified

Sure-White membranes are ENERGY STAR®-qualified, environmentally friendly and LEED® approved. The ENERGY STAR program recommends using the Roof Savings Calculator (rsc.ornl.gov) to determine if a white reflective roof will save or cost you money compared to a dark-colored roof depending on geographic climate conditions, building location, and other variables. Sure-White EPDM non-reinforced membrane is available in 60-mil and 90-mil thicknesses, can be ordered in widths up to 30' (9m) and standard lengths of 100' (30m) for fast, economical installations.

Save Time and Money with FAT Technology

Installing a Sure-White EPDM roof system is easier and more efficient with the availability of Carlisle's innovative Factory-Applied Tape™ (FAT). Many Sure-White membranes are now standard with FAT seam technology, which has been proven to reduce seaming time by 75 percent and cut labor requirements by one-third, when compared to hand seaming. FAT also delivers 30 percent greater peel strength and 32 percent greater shear strength, making Sure-White roof systems one of the strongest and most efficient reflective roofing options on the market.

Increase Productivity and Improve Appearance with Pressure-Sensitive Accessories

The most time-consuming portion of a Sure-White installation is faster and easier with Carlisle's pressure-sensitive Elastoform flashing, a self-curing material that resists cracking and abrasion. Also available with the Sure-White system are pressure-sensitive walkway pads that are easily installed over top of the membrane, helping extend the service life of this premium roof system. As with its Sure-Seal® and Sure-Tough™ EPDM roof systems, Carlisle also offers its complete line of pressure-sensitive accessories for the Sure-White system, including pipe seals, curb wraps, cured cover strips and RUSS strips.

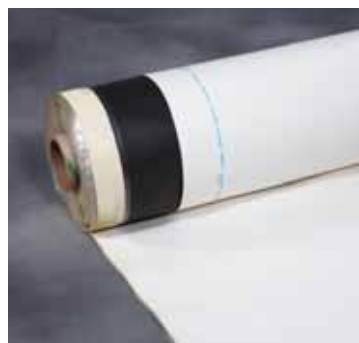



Membrane Options

Color: White
Thickness (mils): 60 and 90
Standard width: 10', 16½' and 20'
Standard length: 100'

Typical Application

1. Sure-White EPDM membrane with FAT
2. Carlisle bonding adhesive
3. Carlisle fasteners and plates
4. Acceptable insulation
5. Approved roof deck

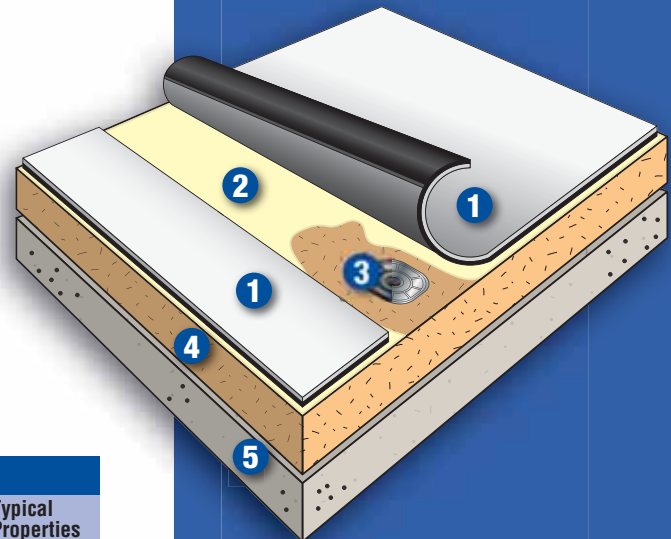

Features and Benefits

- 25 years of proven performance
- Industry leading UV resistance of 25,200 kJ/m² for white membranes
- Reduces air conditioning costs
- 540% elongation results in superior hail resistance
- Lowest global warming potential, acid rain and smog impact according to a study using EPA's TRACI model
- FleeceBACK option available

Sure-White EPDM Non-Reinforced Membrane

Property (Metric-SI Units)	Test Method	Specifications	Typical Properties
Tolerance on Nominal Thickness, %	ASTM D412	±10	±10
Tensile Strength, min., psi (mpa)	ASTM D412	1305 (9)	1465 (10.1)
Elongation, Ultimate, min. %	ASTM D412	300	480
Tearing Strength, min., lbf (kN/m)	ASTM D624 Die C	150 (26.3)	200 (35)
Factory Seam Strength, minimum	ASTM D816 Modified	Membrane Rupture	Membrane Rupture
Brittleness Point, max deg. °F (deg. °C)	ASTM D746	-49 (-45)	-67 (-55)
Resistance to Heat Aging* Sure-White aged 1 wk @ 240°F (116°C)	ASTM D573		
Tensile Strength, min, psi (mpa)	ASTM D412	1205 (8.3)	1550 (10.7)
Elongation, Ultimate, min. %	ASTM D412	200	250
Tear Strength, min, lbf/in. (kN/m)	ASTM D624 Die C	125 (21.9)	185 (32.4)
Linear Dimensional Change, max, %	ASTM D1204	±1	-0.5
Ozone Resistance* Condition after exposure to 100 pphm Ozone in air for 168 hours @ 104°F (40°C) Specimen wrapped around 3" mandrel	ASTM D1149	No Cracks	No Cracks
Resistance to Water Absorption* After 7 days immersion @ 158°F (70°C) Change in mass, max. %	ASTM D471	+8 -2*	+3.6*
Water Vapor Permeance* Maximum, perms	ASTM E96 (proc B or BW)	0.10	0.05
Resistance to Outdoor (Ultraviolet) Weathering* ¹ Xenon-Arc, total radiant exposure at .07 W/m ² irradiance, 80° C black panel temperature	ASTM D4637 Conditions	No Cracks No Cracking 7,560 kJ/m ²	No Cracks No Cracking 25,200 kJ/m ²

* Not a Quality Control Test due to the time required for the test or the complexity of the test. However, all tests are run on a statistical basis to ensure overall long-term performance of the sheeting.

¹ Approximately equivalent to 3000 hours exposure at 158°F black panel temperature, using xenon-arc apparatus operated at .07 W/m² irradiance.

Warranty

This system, properly installed and inspected on a commercial project, may receive:

- A 5-, 10-, 15-, 20- or 30-year Golden Seal Total System Warranty may be requested when all materials used for the roofing installation are manufactured or marketed by Carlisle.
- A maximum peak gust wind speed coverage of 55 miles per hour is standard. Additional coverage up to 120 mph is available.

Consult your Carlisle authorized applicator or manufacturer's representative/distributor for associated warranty changes and the full text of sample warranties.

Sure-White White EPDM Roofing Systems

- Carlisle manufactures all major components of the roofing system
 - Including Low VOC Bonding Adhesive and splice primers
- EPDM is dimensionally stable in both hot and cold climates
- FAT Seam Technology and Pressure-Sensitive Flashing enhance workmanship quality
- Meets ENERGY STAR guidelines to reduce air conditioning costs, which are predominant in warm southern climates, is CRRC certified and can contribute toward LEED credit requirements
- 60-mil and 90-mil available in 10' widths
- 60-mil also available in 16.5' and 20' widths
- Warranties up to 20 years with 60-mil and up to 30 years with 90-mil

800-479-6832 • P.O. Box 7000 • Carlisle, PA 17013 • Fax: 717-245-7053 • www.carlisesyntec.com

Carlisle, Sure-White, Sure-Seal, Sure-Tough, FleeceBACK, FAT and Golden Seal are trademarks of Carlisle.
ENERGY STAR is a registered trademark owned by the US government. LEED is a registered trademark of the U.S. Green Building Council.
*ENERGY STAR qualification is only valid in the U.S.

REPRINT CODE: 601763 - Sure-White Brochure - 01.14.14 - © 2014 Carlisle.

