

CertainTeed  
**Gypsum Board &  
Finishing Products**

Featuring ProRoc® and GlasRoc® Brands

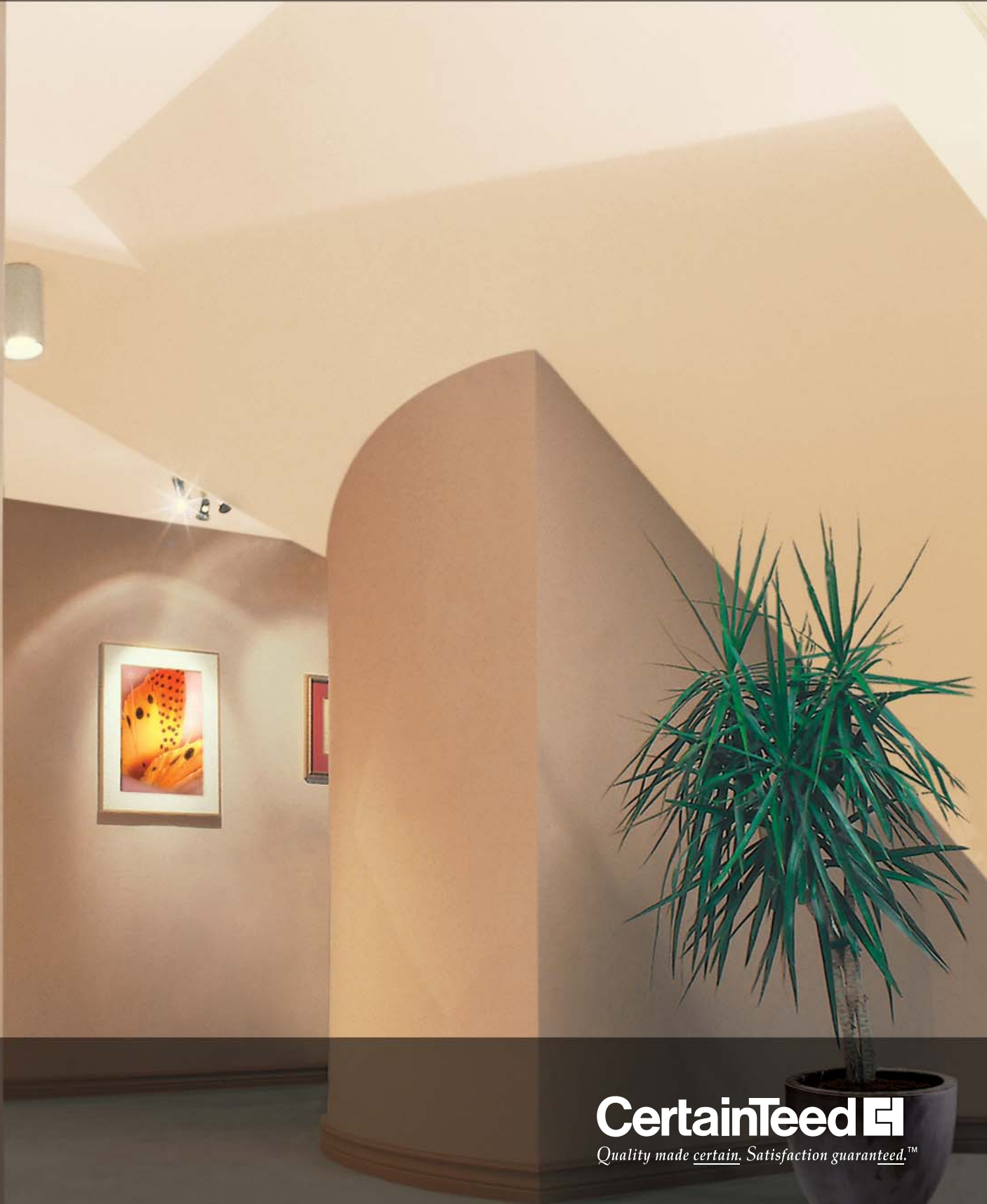

**CertainTeed**   
*Quality made certain. Satisfaction guaranteed.™*

# Quality Made Certain. Satisfaction Guaranteed.

Known for being a leader in interior and exterior building products, CertainTeed provides innovative solutions for commercial, institutional and residential designs. With over 80 years of experience in North America, CertainTeed Gypsum is committed to focusing on quality, service, and safety to provide a superior experience to its customers.

In addition, the company continues to look for ways to reduce impact on the environment while meeting customer demand for sustainable products that deliver comfort, protection and performance.

## A Full Line Product Offering

- ProRoc® Gypsum Board Products
- ProRoc® Moisture and Mold Resistant Gypsum Board with M2Tech™
- GlasRoc® Glass Mat Gypsum Products
- ProRoc® Finishing Products

## Attentive Customer Service

For technical support, product samples, installation advice, or to reach your local gypsum board and finishing expert, call our customer service team toll free at 800-233-8990. Visit our website at [www.certainteed.com/gypsum](http://www.certainteed.com/gypsum) for literature, product data sheets, CAD drawings and project case studies.

**CertainTeed**   
Quality made certain. Satisfaction guaranteed.™



PRODUCT / DESCRIPTION	CORE	THICKNESS	WIDTH	LENGTH	EDGE DETAIL	ASTM*	FEDERAL* STANDARD
-----------------------	------	-----------	-------	--------	-------------	-------	-------------------

## STANDARD PRODUCTS

<b>ProRoc® REGULAR</b> Interior gypsum board with a solid set gypsum core enclosed in ivory-colored face paper and liner back paper. Used for interior walls and ceilings in standard residential or commercial applications.	Regular	1/4" (6.4 mm)	4' (1220 mm) 54" (1370 mm)	8' (2440 mm)	Square Tapered	C 1396	SS-L-30D Type III Grade R
		3/8" (9.5 mm) 1/2" (12.7 mm)		9' (2740 mm) 10' (3050 mm) 12' (3660 mm) 14' (4270 mm) 16' (4880 mm)			

<b>ProRoc® EVENWALL™</b> Interior gypsum board with a solid set gypsum core enclosed in ivory-colored face paper and liner back paper. Used for interior walls and ceilings in standard residential or commercial applications. Evenwall edge results in stronger joints, virtually eliminating ridging and beading.	Regular	1/2" (12.7 mm)	4' (1220 mm) 54" (1370 mm)	8' (2440 mm)	Rounded & Tapered	C 1396	SS-L-30D Type III Grade R
				12' (3660 mm) 14' (4270 mm)			



<b>ProRoc® EVENWALL™ TYPE X</b> Interior gypsum board having a specially formulated core, enclosed in ivory-colored face paper and liner back paper, for use in fire resistance, Type X designs. Used for interior walls and ceilings in residential and commercial applications requiring extended fire resistance ratings. Evenwall edge results in stronger joints, virtually eliminating ridging and beading.	Type X	5/8" (15.9 mm)	4' (1220 mm) 54" (1370 mm)	8' (2440 mm)	Rounded & Tapered	C 1396 Type X	SS-L-30D Type III Grade X
				12' (3660 mm) 14' (4270 mm)			

For Fire Safety Information, see [www.certainteed.com/gypsum](http://www.certainteed.com/gypsum)



<b>ProRoc® TYPE X</b> Interior gypsum board having a specially formulated core, enclosed in ivory-colored face paper and liner back paper, for use in fire resistance, Type X designs. Used for interior walls and ceilings in residential and commercial applications requiring extended fire resistance ratings.	Type X	5/8" (15.9 mm)	4' (1220 mm) 54" (1370 mm)	8' (2440 mm)	Tapered	C 1396 Type X	SS-L-30D Type III Grade X
				9' (2740 mm) 10' (3050 mm) 12' (3660 mm) 14' (4270 mm) 16' (4880 mm)			

For Fire Safety Information, see [www.certainteed.com/gypsum](http://www.certainteed.com/gypsum)







<b>ProRoc® TYPE C</b> Interior gypsum boards consisting of a solid set, fire-resistive, Type C gypsum core enclosed in ivory-colored face paper and a strong liner back paper. ProRoc® Type C board features a specially formulated enhanced Type X core providing fire resistance ratings when used in tested assemblies. Used for interior walls and ceilings in residential and commercial applications requiring extended fire resistance ratings.	Type C	1/2" (12.7 mm) 5/8" (15.9 mm)	4' (1220 mm)	8' (2440 mm)	Tapered	C 1396 Type X	SS-L-30D Type III Grade X
				9' (2740 mm) 10' (3050 mm) 12' (3660 mm)			

Fire Resistant Rated Product.
 Moisture Resistant Product.
 Custom lengths available. Check with Territory Manager.

\*CertainTeed certifies that the products described herein meet or exceed listed ASTM and Federal Standard Specifications.

# Moisture & Mold Resistant Products

PRODUCT / DESCRIPTION	CORE	THICKNESS	WIDTH	LENGTH	EDGE DETAIL	ASTM*	FEDERAL* STANDARD
<b>MOISTURE AND MOLD RESISTANT PRODUCTS</b>							
 <b>GlasRoc® SHEATHING</b> Weather-resistant, paperless gypsum sheathing produced with CertainTeed's proprietary Embedded Glass Reinforced Gypsum™ technology. Appropriate substrate in EIF Systems, one-coat and conventional stucco systems, traditional cladding systems, exterior ceilings, soffit systems and exterior curved applications.	Regular	1/2" (12.7 mm)	4' (1220 mm)	8' (2440 mm)	Square	C 1177	—
 <b>GlasRoc® SHEATHING TYPE X</b> Weather-resistant, paperless Type X gypsum sheathing produced with CertainTeed's proprietary Embedded Glass Reinforced Gypsum™ technology. Appropriate substrate in EIF Systems, one-coat and conventional stucco systems, traditional cladding systems, exterior ceilings, soffit systems and exterior curved applications.	Type X	5/8" (15.9 mm)	4' (1220 mm)	8' (2440 mm)	Square	C 1177	—
 <b>ProRoc® MOISTURE AND MOLD RESISTANT GYPSUM BOARD WITH M2Tech™</b> Interior gypsum board, featuring M2Tech technology, specially engineered to provide enhanced moisture and mold resistance. Used for interior walls and ceilings in standard residential, commercial, or institutional applications in humid areas such as back splashes, laundry rooms, basements, and bathrooms or anywhere extra moisture and mold protection is desired.	Regular	1/2" (12.7 mm)	4' (1220 mm)	8' (2440 mm) 10' (3050 mm) 12' (3660 mm)	Tapered	C 1396	SS-L-30D Type III
 <b>ProRoc® MOISTURE AND MOLD RESISTANT TYPE X GYPSUM BOARD WITH M2Tech™</b> Provides the same protection as ProRoc with M2Tech plus a specially formulated core for use in fire resistance designs.	Type X	5/8" (15.9 mm)	4' (1220 mm)	8' (2440 mm) 10' (3050 mm) 12' (3660 mm)	Tapered	C 1396 Type X	SS-L-30D Type III Grade X
 <b>ProRoc® MOISTURE AND MOLD RESISTANT SHAFTLINER TYPE X WITH M2Tech™</b> Shaftliner core board specially engineered to provide enhanced moisture and mold resistance. Gypsum shaftwall systems have replaced traditional masonry for interior vertical enclosures, stairwells, elevator enclosures, mechanical chases and area separation walls. Some inherent advantages of gypsum shaftwall and area separation wall systems are: lightweight construction, thinner walls, ease and speed of installation and clean up, and cost effective construction.	Type X	1" (25.4 mm)	2' (610 mm)	8' (2440 mm) 10' (3050 mm) 12' (3660 mm)	Double Beveled	C 1396 C 442 Type X	SS-L-30D Type IV Grade X



Fire Resistant Rated Product.



Moisture Resistant Product.

Custom lengths available. Check with Territory Manager.

\*CertainTeed certifies that the products described herein meet or exceed listed ASTM and Federal Standard Specifications.

# Moisture Resistant Products



PRODUCT / DESCRIPTION	CORE	THICKNESS	WIDTH	LENGTH	EDGE DETAIL	ASTM*	FEDERAL* STANDARD
-----------------------	------	-----------	-------	--------	----------------	-------	----------------------

## MOISTURE RESISTANT PRODUCTS



### GlasRoc® TILE BACKER

Moisture resistant, paperless gypsum tile backer produced with CertainTeed's proprietary Embedded Glass Reinforced Gypsum™ technology. Appropriate substrate for walls, ceilings and countertops as well as high humidity areas in both tile and non-tile applications.

Regular	1/2" (12.7 mm)	4' (1220 mm)	8' (2440 mm)	Square	C 1178	—
---------	----------------	--------------	--------------	--------	--------	---



### GlasRoc® TILE BACKER TYPE X

Moisture resistant, paperless gypsum tile backer produced with CertainTeed's proprietary Embedded Glass Reinforced Gypsum™ technology. Appropriate substrate for walls, ceilings and countertops as well as high humidity areas in both tile and non-tile applications. Specially formulated core for use in fire resistance designs.



Type X	5/8" (15.9 mm)	4' (1220 mm)	8' (2440 mm)	Square	C 1178	—
--------	----------------	--------------	--------------	--------	--------	---



### ProRoc® MOISTURE RESISTANT

Water resistant gypsum board used behind tiles in humid areas such as bathrooms, laundries, utility rooms, and kitchens. Check with your local code authorities for approval of Moisture Resistant board as a tile backer in wet (tub/shower) areas.

Regular	1/2" (12.7 mm)	4' (1220 mm)	8' (2440 mm) 9' (2740 mm) 10' (3050 mm) 12' (3660 mm)	Tapered	C 1396	SS-L-30D Type VII Grade W
---------	----------------	--------------	--	---------	--------	---------------------------------



### ProRoc® MOISTURE RESISTANT TYPE X

Provides the same protection as ProRoc® Moisture Resistant plus a specially formulated core for use in fire resistance designs. Check with your local code authorities for approval of Moisture Resistant board as a tile backer in wet (tub/shower) areas.



Type X	5/8" (15.9 mm)	4' (1220 mm)	8' (2440 mm) 9' (2740 mm) 10' (3050 mm) 12' (3660 mm)	Tapered	C 1396 Type X	SS-L-30D Type VII Grade W, X
--------	----------------	--------------	--	---------	------------------	------------------------------------

Fire Resistant Rated Product. Moisture Resistant Product.

Custom lengths available. Check with Territory Manager.

\*CertainTeed certifies that the products described herein meet or exceed listed ASTM and Federal Standard Specifications.

# Exterior Products

PRODUCT / DESCRIPTION	CORE	THICKNESS	WIDTH	LENGTH	EDGE DETAIL	ASTM*	FEDERAL* STANDARD
-----------------------	------	-----------	-------	--------	----------------	-------	----------------------

## EXTERIOR PRODUCTS

 <b>GlasRoc® SHEATHING</b> Weather-resistant, paperless gypsum sheathing produced with CertainTeed's proprietary Embedded Glass Reinforced Gypsum™ technology. Appropriate substrate in EIF Systems, one-coat and conventional stucco systems, traditional cladding systems, exterior ceilings, soffit systems and exterior curved applications.	Regular	1/2" (12.7 mm)	4' (1220 mm)	8' (2440 mm)	Square	C 1177	—
---	---------	----------------	--------------	--------------	--------	--------	---

 <b>GlasRoc® SHEATHING TYPE X</b> Weather-resistant, paperless Type X gypsum sheathing produced with CertainTeed's proprietary Embedded Glass Reinforced Gypsum™ technology. Appropriate substrate in EIF Systems, one-coat and conventional stucco systems, traditional cladding systems, exterior ceilings, soffit systems and exterior curved applications.	Type X	5/8" (15.9 mm)	4' (1220 mm)	8' (2440 mm)	Square	C 1177	—
---	--------	----------------	--------------	--------------	--------	--------	---

 <b>ProRoc® SHEATHING TREATED CORE</b> A water-resistant gypsum sheathing for application to the outside of building framing members, and serves as the base for the exterior wall finish. Used as attachments to the outside of exterior wall framing as a water-resistant underlayment for various siding materials.	Regular	1/2" (12.7 mm)	4' (1220 mm)	8' (2440 mm) 9' (2740 mm)	Square	C 1396	SS-L-30D Type II Grade W
---	---------	----------------	--------------	------------------------------	--------	--------	--------------------------------



<sup>1</sup>2x 8' Tongue and Groove at Nashville, AR plant only.

 <b>ProRoc® SHEATHING TREATED CORE TYPE X</b> Provides the same base as ProRoc® Sheathing Treated Core plus a specially formulated core for use in fire resistance designs.	Type X	5/8" (15.9 mm)	4' (1220 mm)	8' (2440 mm) 9' (2740 mm) 10' (3050 mm) 12' (3660 mm)	Square	C 1396 Type X	SS-L-30D Type II Grade W, X
--	--------	----------------	--------------	--	--------	------------------	-----------------------------------

### ProRoc® EXTERIOR SOFFIT BOARD

Used for the underside of eaves, carport ceilings, canopies and other commercial and residential exterior applications where indirect exposure to moisture may occur.	Regular	1/2" (12.7 mm)	4' (1220 mm)	12' (3660 mm)	Tapered	C 1396	—
---	---------	----------------	--------------	---------------	---------	--------	---

 <b>ProRoc® EXTERIOR SOFFIT BOARD TYPE X</b> Provides the same base as ProRoc® Exterior Gypsum Soffit Board plus a specially formulated core for use in fire resistance designs.	Type X	5/8" (15.9 mm)	4' (1220 mm)	8' (2440 mm) 10' (3050 mm) 12' (3660 mm)	Tapered	C 1396 Type X	—
---	--------	----------------	--------------	--	---------	------------------	---

 Fire Resistant Rated Product.
  Moisture Resistant Product.
 Custom lengths available. Check with Territory Manager.

\*CertainTeed certifies that the products described herein meet or exceed listed ASTM and Federal Standard Specifications.

PRODUCT / DESCRIPTION	CORE	THICKNESS	WIDTH	LENGTH	EDGE DETAIL	ASTM*	FEDERAL* STANDARD
-----------------------	------	-----------	-------	--------	-------------	-------	-------------------

## SPECIALTY PRODUCTS

<b>GlasRoc® SHEATHING</b> Weather-resistant, paperless gypsum sheathing produced with CertainTeed's proprietary Embedded Glass Reinforced Gypsum™ technology. Appropriate substrate in EIF Systems, one-coat and conventional stucco systems, traditional cladding systems, exterior ceilings, soffit systems and exterior curved applications.	Regular	1/2" (12.7 mm)	4' (1220 mm)	8' (2440 mm)	Square	C 1177	—
<b>GlasRoc® SHEATHING TYPE X</b> Weather-resistant, paperless Type X gypsum sheathing produced with CertainTeed's proprietary Embedded Glass Reinforced Gypsum™ technology. Appropriate substrate in EIF Systems, one-coat and conventional stucco systems, traditional cladding systems, exterior ceilings, soffit systems and exterior curved applications.	Type X	5/8" (15.9 mm)	4' (1220 mm)	8' (2440 mm)	Square	C 1177	—
<b>GlasRoc® TILE BACKER</b> Moisture resistant, paperless gypsum tile backer produced with CertainTeed's proprietary Embedded Glass Reinforced Gypsum™ technology. Appropriate substrate for walls, ceilings and countertops as well as high humidity areas in both tile and non-tile applications.	Regular	1/2" (12.7 mm)	4' (1220 mm)	8' (2440 mm)	Square	C 1178	—
<b>GlasRoc® TILE BACKER TYPE X</b> Moisture resistant, paperless gypsum tile backer produced with CertainTeed's proprietary Embedded Glass Reinforced Gypsum™ technology. Appropriate substrate for walls, ceilings and countertops as well as high humidity areas in both tile and non-tile applications. Specially formulated core for use in fire resistance designs.	Type X	5/8" (15.9 mm)	4' (1220 mm)	8' (2440 mm)	Square	C 1178	—
<b>ProRoc® INTERIOR CEILING</b> A solid set, gypsum core enclosed in ivory-colored face paper and a liner back paper, for use on interior ceilings perpendicular to framing spaced up to 24" o.c. where texture spray is being applied. Gypsum core is comprised of special sag-resistant additives.	Regular	1/2" (12.7 mm)	4' (1220 mm)	10' (3050 mm) 12' (3660 mm) 14' (4270 mm)	Tapered	C 1396	SS-L-30D Type III Grade R
<b>ProRoc® VENEER PLASTER BASE</b> Interior gypsum board with a specially formulated face paper for use with veneer plaster finishes.	Regular	1/2" (12.7 mm)	4' (1220 mm)	8' (2440 mm) 12' (3660 mm)	Square Tapered	C 1396	SS-L-30D Type VI Grade R
<b>ProRoc® VENEER PLASTER BASE TYPE X</b> Provides the same base as ProRoc® Veneer Plaster Base plus a specially formulated core for use in fire resistance designs.	Type X	5/8" (15.9 mm)	4' (1220 mm)	8' (2440 mm) 12' (3660 mm)	Square Tapered	C 1396 Type X	SS-L-30D Type VI Grade X
<b>ProRoc® 1/4" FLEX</b> 1/4" Flex is ideal for curved walls, staircases and ceilings as well as column enclosures in low and high-rise residences, sport facilities, schools, condominiums and office areas.	Regular	1/4" (6.4 mm)	4' (1220 mm)	8' (2440 mm) 12' (3660 mm)	Tapered	C 1396 C 36	SS-L-30D Type III Grade R

Fire Resistant Rated Product.
 Moisture Resistant Product.
 Custom lengths available. Check with Territory Manager.

\*CertainTeed certifies that the products described herein meet or exceed listed ASTM and Federal Standard Specifications.

# High Performance Products

PRODUCT / DESCRIPTION	CORE	THICKNESS	WIDTH	LENGTH	EDGE DETAIL	ASTM*	FEDERAL* STANDARD
-----------------------	------	-----------	-------	--------	----------------	-------	----------------------

## HIGH PERFORMANCE & ACCESSORY PRODUCTS



### GlasRoc® SHEATHING

Weather-resistant, paperless gypsum sheathing produced with CertainTeed's proprietary Embedded Glass Reinforced Gypsum™ technology. Appropriate substrate in EIF Systems, one-coat and conventional stucco systems, traditional cladding systems, exterior ceilings, soffit systems and exterior curved applications.

Regular	1/2" (12.7 mm)	4' (1220 mm)	8' (2440 mm)	Square	C 1177	—
---------	----------------	--------------	--------------	--------	--------	---



### GlasRoc® SHEATHING TYPE X

Weather-resistant, paperless Type X gypsum sheathing produced with CertainTeed's proprietary Embedded Glass Reinforced Gypsum™ technology. Appropriate substrate in EIF Systems, one-coat and conventional stucco systems, traditional cladding systems, exterior ceilings, soffit systems and exterior curved applications.



Type X	5/8" (15.9 mm)	4' (1220 mm)	8' (2440 mm)	Square	C 1177	—
--------	----------------	--------------	--------------	--------	--------	---



### GlasRoc® TILE BACKER

Moisture resistant, paperless gypsum tile backer produced with CertainTeed's proprietary Embedded Glass Reinforced Gypsum™ technology. Appropriate substrate for walls, ceilings and countertops as well as high humidity areas in both tile and non-tile applications.

Regular	1/2" (12.7 mm)	4' (1220 mm)	8' (2440 mm)	Square	C 1178	—
---------	----------------	--------------	--------------	--------	--------	---



### GlasRoc® TILE BACKER TYPE X

Moisture resistant, paperless gypsum tile backer produced with CertainTeed's proprietary Embedded Glass Reinforced Gypsum™ technology. Appropriate substrate for walls, ceilings and countertops as well as high humidity areas in both tile and non-tile applications. Specially formulated core for use in fire-resistant designs.



Type X	5/8" (15.9 mm)	4' (1220 mm)	8' (2440 mm)	Square	C 1178	—
--------	----------------	--------------	--------------	--------	--------	---

Fire Resistant Rated Product. Moisture Resistant Product.

Custom lengths available. Check with Territory Manager.

\*CertainTeed certifies that the products described herein meet or exceed listed ASTM and Federal Standard Specifications.



PRODUCT / DESCRIPTION	CORE	THICKNESS	WIDTH	LENGTH	EDGE DETAIL	ASTM*	FEDERAL* STANDARD
-----------------------	------	-----------	-------	--------	----------------	-------	----------------------

**HIGH PERFORMANCE & ACCESSORY PRODUCTS**



**ProRoc® ABUSE RESISTANT TYPE X**

ProRoc® Abuse Resistant products are composed of a dense gypsum core, reinforced by glass fiber. Engineered for use in areas requiring high abuse and indentation resistance; corridors, schools, hospitals, and public buildings.

Type X	5/8" (15.9 mm)	4' (1220 mm)	8' (2440 mm) 10' (3050 mm) 12' (3660 mm)	Tapered	C 1396 Type X	SS-L-30D Type III Grade X
--------	----------------	--------------	--	---------	------------------	---------------------------------



**ProRoc® SHAFTLINER TYPE X**

Gypsum Shaftwall Systems have replaced traditional masonry for interior vertical enclosures, stairwells, elevator enclosures, mechanical chases and area separation walls. Some inherent advantages of gypsum shaftwall and area separation wall systems are: light weight construction, thinner walls, ease and speed of installation and clean up, and cost effective construction.

Type X	1" (25.4 mm)	2' (610 mm)	8' (2440 mm) 10' (3050 mm) 12' (3660 mm)	Double Beveled	C 1396 Type X	SS-L-30D Type IV Grade X
--------	--------------	-------------	--	-------------------	------------------	--------------------------------



**ProRoc® MOISTURE AND MOLD RESISTANT SHAFTLINER TYPE X WITH M2Tech™**



Shaftliner core board specially engineered to provide enhanced moisture and mold resistance. Gypsum shaftwall systems have replaced traditional masonry for interior vertical enclosures, stairwells, elevator enclosures, mechanical chases and area separation walls. Some inherent advantages of gypsum shaftwall and area separation wall systems are: lightweight construction, thinner walls, ease and speed of installation and clean up, and cost effective construction.

Type X	1" (25.4 mm)	2' (610 mm)	8' (2440 mm) 10' (3050 mm) 12' (3660 mm)	Double Beveled	C 1396 C 442 Type X	SS-L-30D Type IV Grade X
--------	--------------	-------------	--	-------------------	---------------------------	--------------------------------

Fire Resistant Rated Product.

Moisture Resistant Product.

Custom lengths available. Check with Territory Manager.

\*CertainTeed certifies that the products described herein meet or exceed listed ASTM and Federal Standard Specifications.

# Finishing Products

## FINISHING COMPOUNDS, SPRAY TEXTURES AND PLASTERS<sup>1</sup>

<b>ProRoc® Ready-Mixed Joint Compounds</b>	LIGHTWEIGHT CARTONS	HEAVYWEIGHT CARTONS	MULTI-PURPOSE CARTONS	LIGHTWEIGHT PAILS	HEAVYWEIGHT PAILS	ASTM*	FEDERAL* STANDARD
Ready-mixed joint compounds are pre-mixed high performance products designed for professional applicators, and have a six month shelf life from date of manufacture.	ProRoc® LITE Taping	ProRoc® Taping	ProRoc® Extra Multi-Purpose LITE				
	ProRoc® LITE Finishing	ProRoc® Finishing	ProRoc® ONE Multi-Purpose	ProRoc® LITE All-Purpose	ProRoc® All-Purpose	C 475	SS-J-570B
	ProRoc® LITE All-Purpose	ProRoc® All-Purpose					

<b>ProRoc® Level V Primer/Surfacer Roll-On</b>	COVERAGE	APPLICATOR	SANDING	ASTM*	FEDERAL* STANDARD
Takes a GA level 4 finish to a level 5 without the need for a skim coat allowing for significant labor savings. Can be roller or airless sprayer applied.	267 sq ft per gallon @ 6 wet mils	Roller 3/8 - 1/2 nap Sprayer 1/2 gal/min	150-220 grit	C 840	—

<b>ProRoc® Setting Compounds</b>	PRODUCT NAME	SETTING TIME	TYPE	ASTM*	FEDERAL* STANDARD
Lightweight, low shrinkage, sandable setting powders that offer a choice of setting times ranging from 5 minutes to 210 minutes, and have a six month shelf life from date of manufacture. Ideal for heavy fills and required for exterior soffit finishing.	ProRoc Moisture and Mold Resistant 90 with M2Tech	75-105 minutes	Sandable		
	ProRoc® LITE Sand 5	5-10 minutes	Sandable	C 475	SS-J-570B
	ProRoc® LITE Sand 20	15-25 minutes	Sandable		
	ProRoc® LITE Sand 45	37-52 minutes	Sandable		
	ProRoc® LITE Sand 90	75-105 minutes	Sandable		
	ProRoc® LITE Sand 210	180-240 minutes	Sandable		

<b>ProRoc® Wall &amp; Ceiling Spray Textures</b>	PRODUCT NAME	TEXTURE TYPE	ASTM*	FEDERAL* STANDARD
Suitable for all unaggregated interior spray patterns and equipment, including splatter, knockdown and orange peel designs. Twelve month shelf life from date of manufacture.	ProRoc® Spray Texture (Green Bag)	Heavy	—	—
	ProRoc® All Purpose (Red Bag)	Medium		
	ProRoc® Easy Mixing (Blue Bag)	Light		

<b>Double Duty® Hardwall Plasters</b>	APPEARANCE	SHELF LIFE	DRY WEIGHT	DRYING TEMPERATURE	ASTM*	FEDERAL* STANDARD
Use as the basecoat in two-coat interior plastering and for both the scratch and brown coats in three-coat work.	White to tan powder	3 months from date of manufacture	55 lbs./cu. ft.	60° - 80°F 16° - 27°C	C 11	SS-P-00402B Type II
					C 28	
					C 35	
					C 842	

<b>Perlited Pre-Mixed Gypsum Plaster</b>	APPEARANCE	SHELF LIFE	DRY WEIGHT	DRYING TEMPERATURE	ASTM*	FEDERAL* STANDARD
50% lighter than conventional gypsum plaster. Use as the basecoat in two-coat interior plastering and for both the scratch and brown coats in three-coat work.	White powder	3 months from date of manufacture	50 lbs./cu. ft.	60° - 80°F 16° - 27°C	C 28	SS-P-00402B Type I
					C 35	
					C 842	

<sup>1</sup> Not available in all areas. Consult your CertainTeed Territory Manager for availability in your area.

\*CertainTeed certifies that the products described herein meet or exceed listed ASTM and Federal Standard Specifications.

## FINISHING JOINT TAPES AND CORNER REINFORCEMENT

PRODUCT / DESCRIPTION	LENGTH X WIDTH	LENGTH X WIDTH (METRIC)	ASTM*	FEDERAL* STANDARD
<p><b>ProRoc® Marco® Spark-Perf® Tape</b></p> <p>Spark-perforated tape for easy pass-through of joint compound (mud) and elimination of air bubbles. Manufactured from fibered-paper with added tensile strength to help prevent tearing, wrinkling or stretching. Also available in 94# in 500' rolls only.</p>	<p>75' x 2-1/16"</p> <p>250' x 2-1/16"</p> <p>500' x 2-1/16"</p>	<p>23 m x 52 mm</p> <p>76 m x 52 mm</p> <p>152 m x 52 mm</p>	C 475	SS-J-570B
<p><b>FibaTape® Mold-X10™ Fiberglass Tape</b></p> <p>Self adhesive, mold resistant fiberglass tape for easy application and for elimination of blisters and bonding.</p>	300' x 1-7/8"	92 m x 48 mm	C 475	—
<p><b>ProRoc® Marco® Metal Flex Corner Tape</b></p> <p>Flexible tape for inside and outside angles. Foldable to any angle.</p>	<p>100' x 2-1/16"</p> <p>25' x 2-1/16"</p>	<p>31 m x 52 mm</p> <p>8 m x 52 mm</p>	C 1047	—
<p><b>ProRoc® Marco® Plastic Flex Corner Tape</b></p> <p>Easy to install, flexible plastic tape for inside and outside angles.</p>	100' x 2-1/16"	31 m x 52 mm	C 1047	—

\*CertainTeed certifies that the products described herein meet or exceed listed ASTM and Federal Standard Specifications.

# Product Assurances & Technical Support

CertainTeed provides innovative building products and systems for commercial, institutional and residential designs. With over 80 years of experience manufacturing and marketing in North America, CertainTeed Gypsum is committed to focusing on quality, service, and safety to provide a superior experience to its customers.

## Test Standards

Fire resistance and sound tests are conducted in accordance with ASTM E 119 (NFPA 251, ANSI/UL 263, CAN/ULC-S101M) and ASTM E 90, respectively, and no warranty is made other than conformance to the standard under which the assembly was tested. Minor discrepancies may exist in the values of ratings, attributable to changes in materials and standards, as well as differences between testing facilities. Assemblies are listed as "combustible" (wood framing) and "noncombustible" (concrete and/or steel construction).

## Combustible Assemblies

These include all wood stud walls, wood joist or truss ceilings and floors consisting of tongue-and-groove, plywood, or OSB sub-flooring and finish flooring or a poured gypsum floor underlayment over wood structural panel sub-flooring. Floor assembly may be used over the wood joists with ceilings as detailed in GA and UL/ULC references.

## Noncombustible Assemblies

These include steel studs, bar joist ceilings with poured concrete floors over metal lath or steel. Also included are steel beams and steel columns. Ceilings for all 1-hour, 1 1/2-hour, and 2-hour noncombustible floor and ceiling assemblies with 2" or 2 1/2" concrete floor or metal lath over steel bar joists, unless otherwise specified,

may be directly attached or suspended as detailed in GA and UL/ULC references.



## Fire Resistance

CertainTeed's ProRoc® Type X and Type C, ProRoc® Moisture and Mold Resistant Type X with M2Tech™ and GlasRoc® Type X products are Classified by Underwriters Laboratories Inc. and listed by Underwriters Laboratories of Canada and carries the UL/ULC Label for 1-, 2-, 3- and 4-hour Fire Resistance in various designs. Underwriters Laboratories Inc. tests have proven that joint finishing is not required for the rating in certain assemblies using ProRoc® Type X and Type C and GlasRoc® Type X products. For fire resistance ratings, refer to the Gypsum Association Fire Resistance Design Manual GA-600, and the UL and ULC Fire Resistance Directories.

## Surface Burning Characteristics

ProRoc® Gypsum Boards have a Flame Spread rating of 15 and Smoke Developed rating of 0, and GlasRoc® products have a Flame Spread Rating of 0 and a Smoke Developed Rating of 0, in accordance with ASTM E84 (UL 723, UBC 8-1, NFPA 255, CAN/ULC-S102M).

## Sound Characteristics

The degree to which assemblies block the passage of sound is measured by Sound Transmission Class (STC) per ASTM E 90 and E 413, which is a single figure rating derived from the sound transmission loss values over a range of sound frequencies. All sound-rated assemblies require caulking at the top and bottom, and other locations where sound leaks may develop. For sound characteristics, refer to the Gypsum Association Fire Resistance Design Manual GA-600.

## Storage

Gypsum boards must be stored in an area that protects it from adverse weather conditions, condensation and other forms of moisture and direct sunlight. Boards should be neatly stacked flat with care taken to prevent sagging or damage to edges, ends, and surfaces. Storing board lengthwise leaning against the framing is not recommended. Boards should be carried, not dragged, to place of installation to prevent damaging finished edges. Refer to "Handling and Storage of Gypsum Panel Products" GA-810.

## More Information

Consult the Gypsum Association publication "Recommended Specifications for the Application and Finishing of Gypsum Board," GA-216, for detailed application and finishing procedures. For full details of fire and sound ratings, consult test references listed for system assemblies.

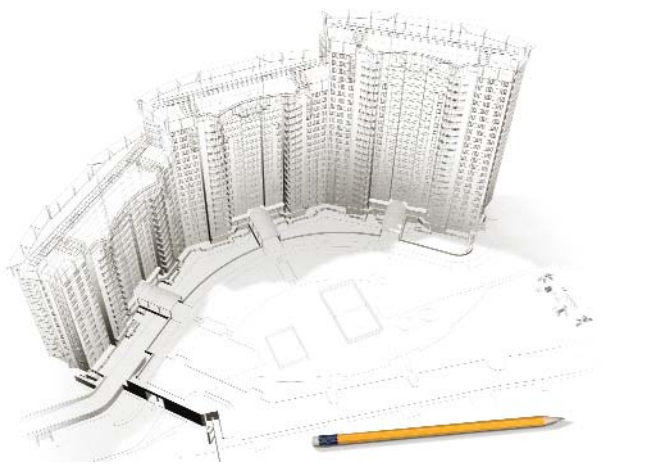

## ASK ABOUT OUR OTHER CERTAINTEED PRODUCTS AND SYSTEMS:

**EXTERIOR:** ROOFING • SIDING • WINDOWS • FENCE • RAILING • TRIM • DECKING • FOUNDATIONS • PIPE  
**INTERIOR:** INSULATION • GYPSUM • CEILINGS

CertainTeed Corporation  
P.O. Box 860  
Valley Forge, PA 19482

Professional: 800-233-8990  
Consumer: 800-782-8777  
www.certainteed.com

**CertainTeed**

Characteristics, properties or performance of materials or systems manufactured by CertainTeed herein described are derived from data obtained under controlled test conditions. CertainTeed makes no warranties, express or implied, as to their characteristics, properties or performance under any variations from such conditions in actual construction. CertainTeed assumes no responsibility for the effects of structural movement.

™ © CertainTeed and the tag line "Quality made certain. Satisfaction guaranteed." are trademarks of CertainTeed Corporation. All other trademarks are the property of its affiliates and related companies.

NOTICE: The information in this document is subject to change without notice. CertainTeed assumes no responsibility for any errors that may inadvertently appear in this document.

© 06/09 CertainTeed Corporation. Printed in U.S.A. Form # CTG-2323/15M/Rev 06-2009