

NO-COAT® PRO CORNER

Operating Instructions

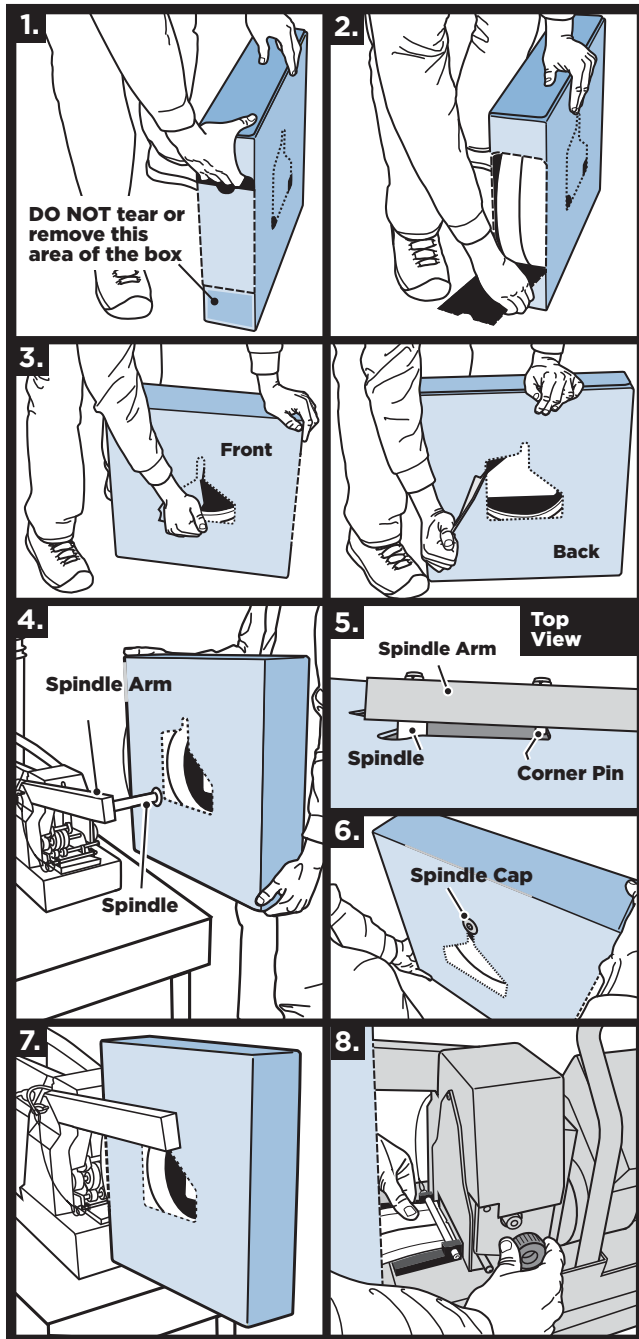

To load NO-COAT® PRO Corner into the NO-COAT® PRO machine:

1. Push in perforated section above finger hole.
2. Tear out perforated large end panel and remove.
3. Using finger holes, remove perforated panels on both sides of the box.
4. Lift box, with perforated end panel facing machine, and mount over spindle.
5. Box should fit snugly against spindle arm, resting on the spindle and corner pin (as shown in #7).
6. On opposite box side, make sure box sits on spindle and is secured in place by spindle cap.
8. Pull end of NO-COAT PRO CORNER out of box and feed it under the guide pin.
9. Feed NO-COAT PRO CORNER through open slot into feed rollers using the feed knob. Make sure center groove in product lines up with centering roller. Turn feed knob counter-clockwise until product stops against inside cutter blade.
10. To remove or adjust position of NO-COAT PRO CORNER, push down on feed release lever.

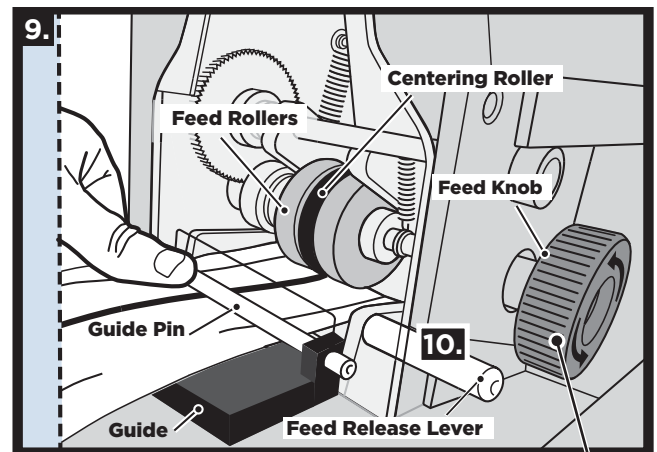

Turn Feed Knob
counter-clockwise only!

