

QuickSpan™ Locking Drywall Grid System

The fastest way to install drywall grid in corridors.



Fast

Fewer Hanger Wires Means Quicker Installation And Industry Leading Spacing



Efficient

Lower Labor Costs With Fewer Installers Needed



Simple

Convenient Pre-Measured Tabs Make Layout A Breeze



Smart

Audible Click Lets You Know Tee Is Locked In Place



Strong

New Support Clip Offers Maximum Support For Longer Spans



Fewer Hanger Wires, Faster Installation, Lower Labor Costs

The QuickSpan™ Locking Drywall Grid System offers quicker, easier installation of spans for drywall ceilings in hallway and corridor applications.

The QuickSpan Support Clip is an accessory designed for load-bearing support, providing longer and stronger spans with fewer wires. Simply slide, snap and fasten it in place to support spans up to 16’.

In hands-on trials, installers agree – the click-in design of QuickSpan delivers faster installation with strength and stability.

QuickSpan™ Support Clip

NEW

Slides and snaps into place on carrying tees for fast, easy installation

Allows for fewer hanger wires at 4’-6’6” O.C., versus 3’-4’ O.C. from the competition

Enables longer spans up to 16’ with minimal hanger wires

Supports wider spanning tee spacing at 24” O.C.

Provides easier connection at walls utilizing the QuickSpan patented locking channel

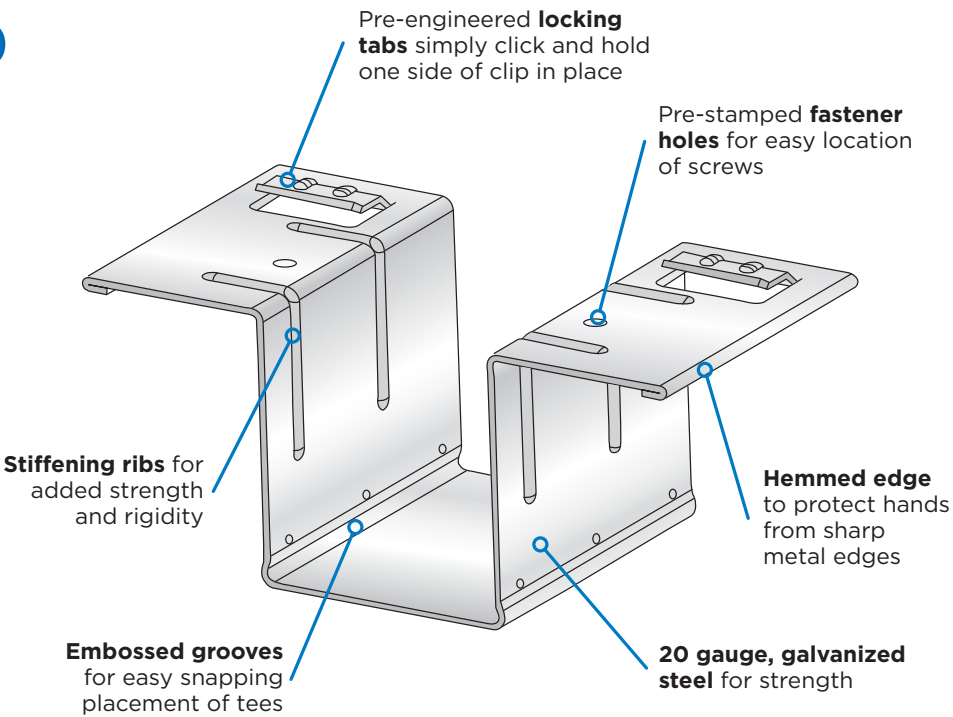

QuickSpan Tees

- Eliminates the need for hanger wires for unsupported spans up to 9’ with 5/8” drywall and 16” O.C. spacing (See ICC-ES ESR-3941)
- Knurled face for easier screw installation
- Web is double-stitched for added strength
- Heavy-duty material for maximum rigidity and screw grip
- G40 galvanization and 0.020” metal thickness

QuickSpan Locking Channel

- Pre-engineered locking tabs punched at 8” O.C.
- Tees quickly twist into place for fast installation
- Locking tab prevents lateral and upward movement
- No need for screws, pop rivets or crimpers
- Carpenters marks at locking tabs for quick alignment

Applications include:

Corridors, offices, and small rooms in condominiums, apartments, hotels, motels, education, healthcare and offices.

All QuickSpan Grid Components Offer:

- Tested performance data available in ICC-ES ESR-3941
- 10-year limited warranty

Hanger Wire Spacing (in.) for QuickSpan Tee perpendicular support with Support Clip at center

GYPSUM BOARD WEIGHT	FULL SPAN IN ft. (UNSUPPORTED SPAN IN ft.)*									
	7'(3.5')	8'(4')	9'(4.5')	10'(5')	11'(5.5')	12'(6')	13'(6.5')	14'(7')	15'(7.5')	16'(8')
	Hanger spacing (in.)									
5 lbs/Sq. ft.	60.0	57.4	55.2	53.3	51.6	50.1	48.8	47.6	46.5	45.5
2.5 lbs/Sq. ft.	75.6	72.3	69.5	67.1	65.0	63.2	61.5	60.0	58.6	57.4
2 lbs/Sq. ft.	78.0	78.0	74.9	72.3	70.0	68.0	66.2	64.6	63.2	61.8
1.4 lbs/Sq. ft.	78.0	78.0	78.0	78.0	78.0	76.6	74.6	72.8	71.1	69.6

*Unsupported span is equal to the distance measured between locking channels and the perpendicular QuickSpan support tee.

For full load test data, download the QuickSpan Locking Drywall Grid System data sheet at [CertainTeed.com/QuickSpan](https://www.certainteed.com/QuickSpan).

More Time-Saving Solutions from CertainTeed

View product videos and learn more about our QuickSpan™ Locking Drywall Grid System at CertainTeed.com/QuickSpan

Side-by-Side Product Comparison Video

Watch how much faster the QuickSpan Locking Drywall Grid System is versus the competition.

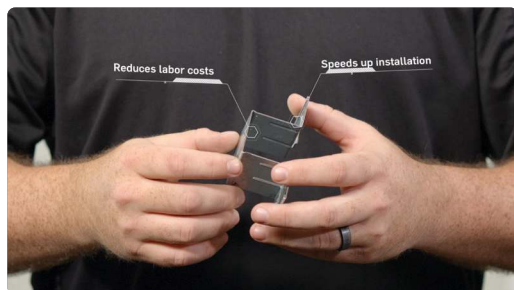

Watch Step-by-Step Installation Guides:

- QuickSpan Locking Drywall Grid System
- QuickSpan Support Clip

To learn more, contact your CertainTeed ceilings representative by calling 800-233-8990



CertainTeed

Ceilings • Gypsum • Insulation • Roofing • Siding • Trim
20 Moores Road, Malvern, PA 19355 | 800-233-8990 | certainteed.com