

# HYDROFIX WATERPROOFING

## HF-04

### PLAZA DECK

### 101-NH V01

#### Typical Assembly - Single Coat

SCALE: NTS 04/14

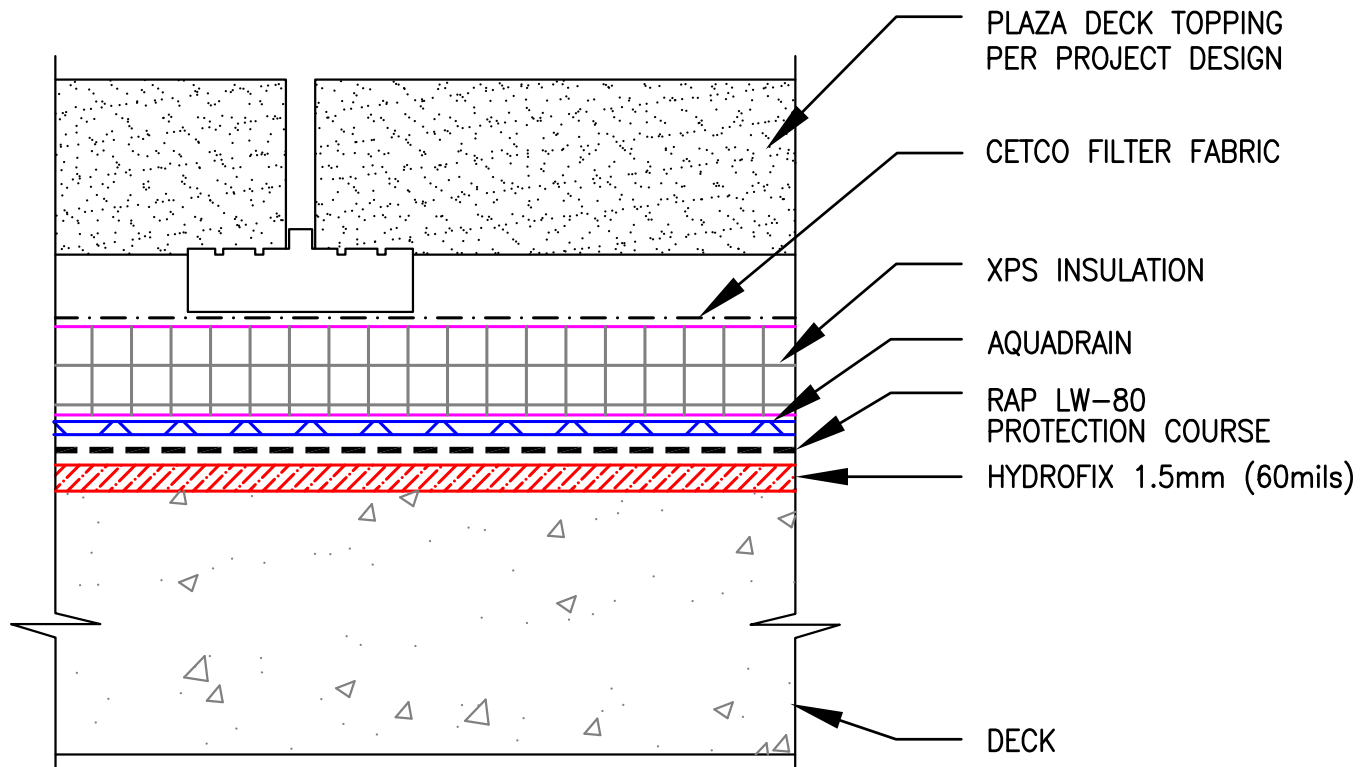

NOTE: CLEAN DECK TO BARE CONCRETE  
WHERE HYDROFIX IS BEING INSTALLED

This information is based on data and knowledge considered to be true and accurate. The information is offered for the users' consideration, verification, and requires project designer's approval before installation. CETCO does not warrant the results obtained and assumes no liability for the use of the information. CETCO waterproofing membranes are not intended to seal expansion joints; contact CETCO for expansion joint applications. This information is subject to change without notice.



2870 Forbs Avenue, Hoffman Estates, IL 60192 USA  
tel 847.851.1800 fax (847) 851.1371 <http://www.cetco.com>  
800.527.9948 email: [field.services@cetco.com](mailto:field.services@cetco.com)