

# VOLTEX DS WATERPROOFING

## FOUNDATION SLAB

CXJ-200 Below Grade Expansion Joint

DS-01

501-H

SCALE: NTS 06/14

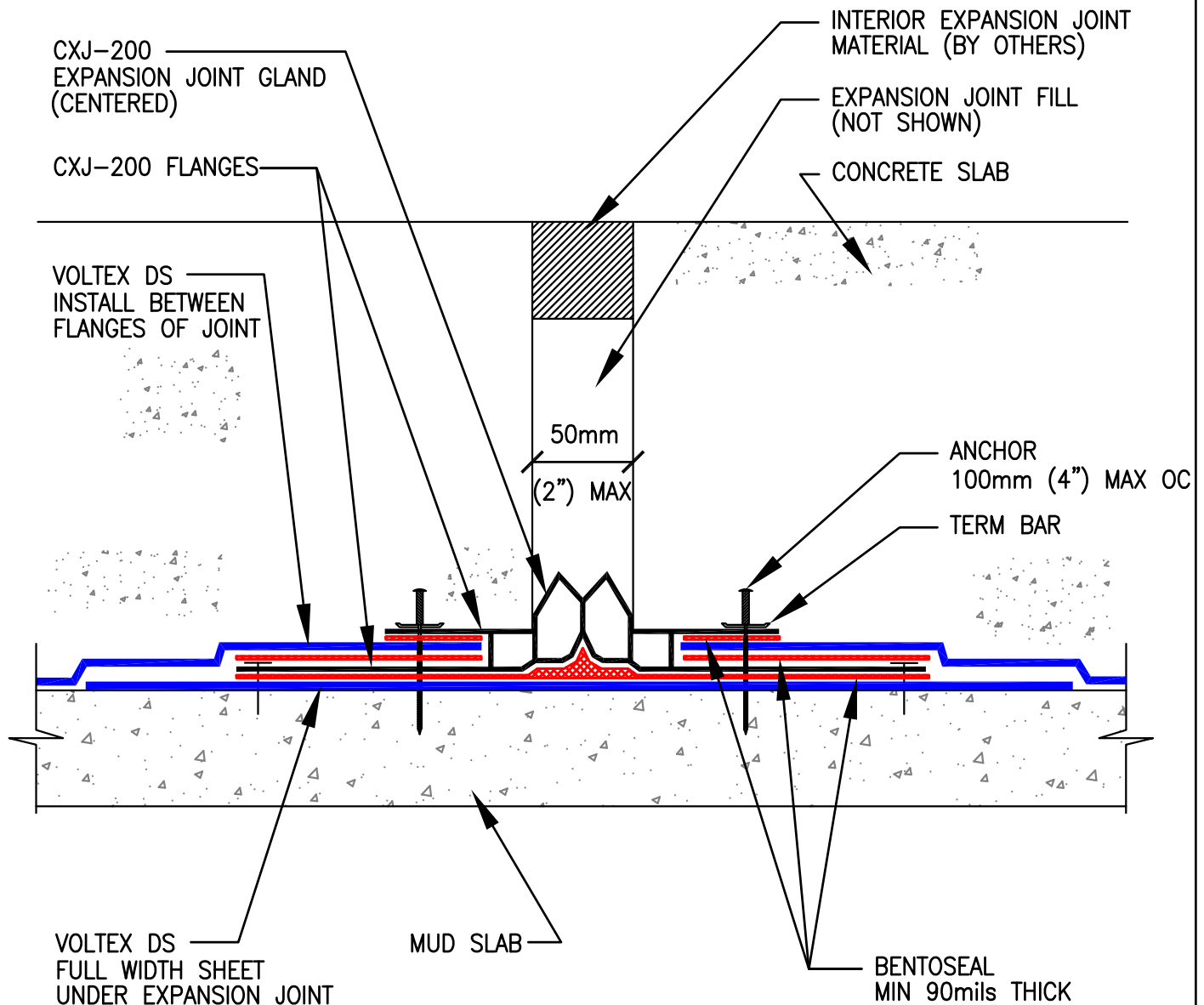

### INSTALL VOLTEX DS WITH GRAY GEOTEXTILE FACING INSTALLER

This information is based on data and knowledge considered to be true and accurate. The information is offered for the users' consideration, verification, and requires project designer's approval before installation. CETCO does not warrant the results obtained and assumes no liability for the use of the information. Expansion Joints should be sealed with a proper expansion joint product. Please contact CETCO with any questions or deviations from this information. This information is subject to change without notice.



2870 Forbs Avenue, Hoffman Estates, IL 60192 USA  
tel 847.851.1800 fax (847) 851.1371 <http://www.cetco.com>  
800.527.9948 email: [field.services@cetco.com](mailto:field.services@cetco.com)