

Spray Rib Lath

More rigid than diamond lath and helps to prevent plaster loss

3-3/16" wide strips of plain 50lb kraft paper spot attached with glue between the herringbone mesh pattern with seven, 3/8" deep longitudinal solid steel ribs spaced at 3-7/8" intervals across the sheet.

Spray Rib Lath provides the superior strength and exceptional rigidity of regular 3/8" High Rib Lath while the addition of the strips of kraft paper limits the loss of plaster when used over open framing or when spray applied. Spray Rib Lath is not a replacement for Grade-D weather resistant barrier.

Spray Rib Lath is the same as 3/8" High Rib Lath with paper attached and is only available in the West Coast.

Product Data & Ordering Information:

Material: G60 Galvanized Steel
 50lb Kraft paper
 Packaged: 25 bundles or 250 pieces per pallet

Product Code	Wt. per Sq. Yd.	Sheet Size	Pcs./Bdl.	Yds./Bdl.	Yds./Pallet
LARS	3.4 lbs.	27" x 97"	10	20	500

ASTM & Code Standards:

- Material: ASTM C847
- All ClarkDietrich Expanded Metal Lath is fabricated from prime galvanized steel, G60 zinc coating by the hot dipped method, conforming to Specification ASTM A653/A653M.
- Intertek CCRR-0204 - Metal Lath - Code Compliance Research Report
- SDS & Product Certification Information is available at www.clarkdietrich.com/SupportDocs
- Installation: ASTM C1063 (exterior), ASTM C841 (interior), ASTM C1780 (thin veneer stone).

Storage:

All stored materials shall be kept dry. Materials shall be stacked off the ground, supported on a level platform, and protected from the weather and surface contamination per ASTM C847 and C1063.

Limitations:

Galvanized steel products should not be used with magnesium oxychloride cement stucco or Portland cement stucco containing calcium chloride additives.

09.22.36 (Metal Lath)

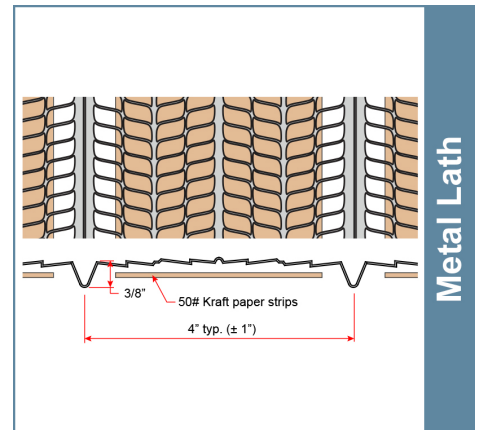

Metal Lath

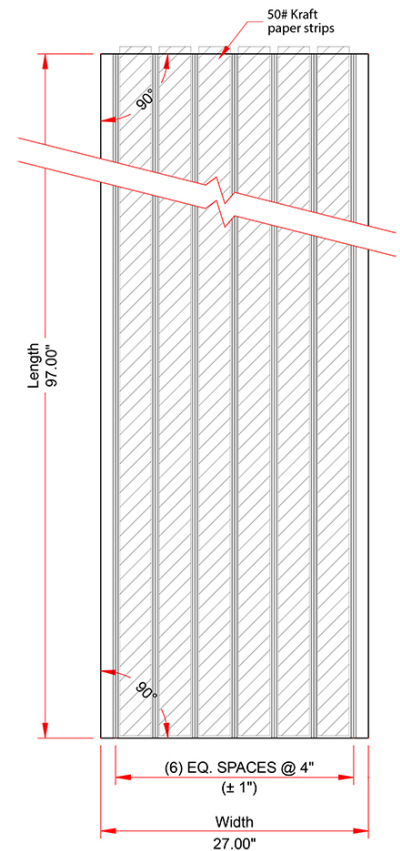

Sustainability Credits:

For more details and LEED letters contact Technical Services at 888-437-3244 or visit www.clarkdietrich.com/LEED

LEED v4 MR Credit -- Building Product Disclosure and Optimization: EPD (1 point) - Sourcing of Raw Materials (1 point) - Material Ingredients (1 point) - Construction and Demolition Waste Management (up to 2 points) - Innovation Credit (up to 2 points).

LEED 2009 Credit MR 2 & MR 4 -- ClarkDietrich's steel products are 100% recyclable and have a national average recycled content of 34.2% (19.8% post-consumer and 14.4% pre-consumer). If seeking a higher number to meet Credit MR 5, please contact us at (info@clarkdietrich.com / 888-437-3244)

Project Information

Name:
 Address:

Contractor Information

Name:
 Contact:
 Phone:
 Fax:

Architect Information

Name:
 Contact:
 Phone:
 Fax: