

PRODUCT BROCHURE



ClarkDietrich®

BACKERBEAD®

VINYL TRIMS WITH INTEGRATED BACKER ROD

BackerBead®

Combination Casing Bead & Backer Rod

To properly assemble a wall cladding system using stucco or manufactured stone veneer, the best practice is to maintain a “gap” around door and window openings and install a backer rod with compatible sealant in order to keep moisture out.

The use of BackerBead ensures that the correct caulk gap will be created around all door and window openings on exterior walls. The gap is predetermined by the factory-applied, closed-cell backer rod that is properly aligned and adhered to the vinyl casing bead. This approach eliminates the need to install the backer rod separately, saving time and ensuring a consistent, normal gap width and depth of ¼" x ¼". When installed and caulked properly, BackerBead provides added protection from water penetration.

Features/Benefits

- **Combination Bead**—Reduces steps in the field installation of casing bead and separate backer rod. Ensures backer rod is installed around all door and window openings.
- **Improved Quality**—Factory-applied blue backer rod with preset width and depth to ensure proper caulk gap for sealant application. When the gap is properly caulked, the blue backer rod will no longer be visible.
- **Separation of Dissimilar Materials**—Properly terminates stucco and mortar at window and door frames.
- **Sealant Compatibility**—Closed-cell backer rod compatible with elastomeric and other cold-applied sealants.

Physical Properties

- **Vinyl Accessory**—Complies with ASTM D1784, ASTM C1861 and ASTM C1063, Table 1, PVC for exterior use.
- **Backer Rod**—Closed-cell material per ASTM C1330 and ASTM C1016, square, flexible, continuous lengths of extruded polyethylene foam used as backing material.
- BackerBead components are chemically inert and virtually dust-free.

Product Notes

- BackerBead casing bead products with 1" and larger ground height includes an intermediate stiffening rib in the ground flange.
- Factory applied 3/8" x 3/8" backer rod is adhered with set back of 1/4" from the leading edge of the ground on BackerBead casing bead products, unless noted.
- BackerBead also available with a solid flange upon request. Add U to product code, example: 6650BBU.
- Integral backer rod also available in white upon request for clear sealant applications. Add -WH to product code, example 6650BB-WH.

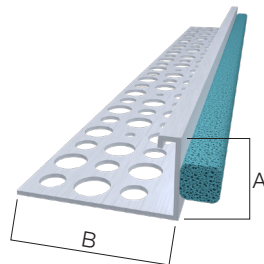
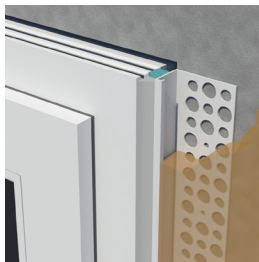
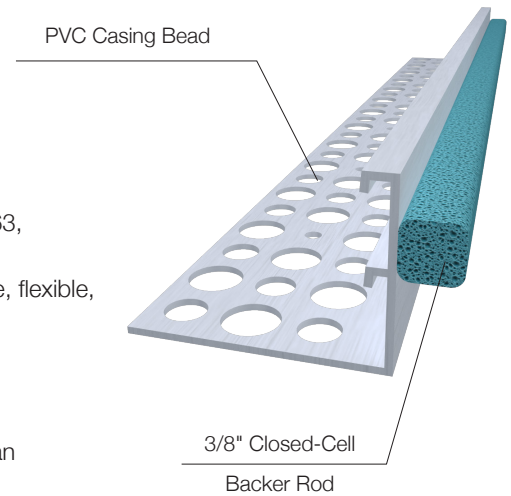

Original BackerBead®

Product Code	(A) Ground	(B) Flange	Length	Pieces per Box
6650BB	1/2"	1-3/4"	10'	50
6658BB	5/8"	1-3/4"	10'	50
6675BB	3/4"	1-3/4"	10'	50
6678BB	7/8"	1-3/4"	10'	50
66100TBB	1"	1-3/4"	10'	50
66125BB	1-1/4"	1-3/4"	10'	50
66150BB	1-1/2"	1-3/4"	10'	40
66175BB	1-3/4"	1-3/4"	10'	40
66200BB	2"	1-3/4"	10'	40

U.S. Patent Number D761,971

BackerBead®

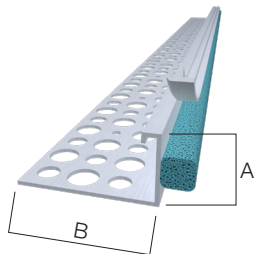
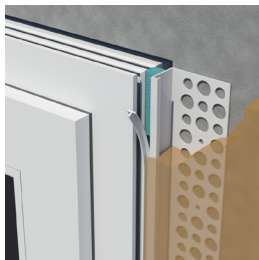

BackerBead® with Tear-away

1/4" tear-away strip provides a clean, stucco-free caulk gap. A clean 1/4" x 1/4" caulk gap assures the most efficient caulk seal for optimal moisture protection.

Product Code	(A) Ground	(B) Flange	Length	Pieces per Box
6658BBR	5/8"	1-3/4"	10'	50
6678BBR	7/8"	1-3/4"	10'	50

U.S. Patent Number D762,310

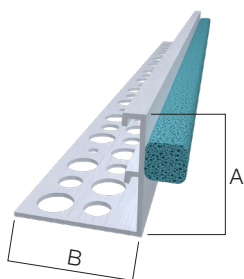
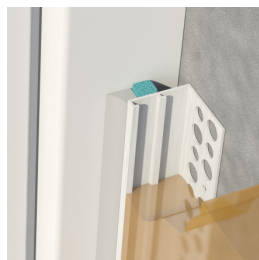

BackerBead® with Short Flange

Perfect for situations where the standard 1-3/4" flange size is too large for the application. Easy to install in tight areas such as recessed doors and windows, providing added moisture protection and a clean finish.

Product Code	(A) Ground	(B) Flange	Length	Pieces per Box
6658BBSF	5/8"	1"	10'	50
6678BBSF	7/8"	1"	10'	50
66125BBSF	1-1/4"	1"	10'	50

U.S. Patent Number D761,971

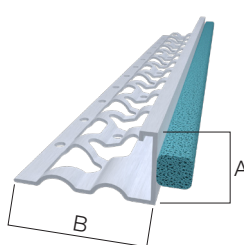
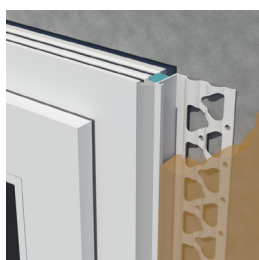

BackerBead® with E-Flange™

Allows more of the stucco mix to flow to the substrate, providing two times the stucco embedment of standard casing bead. More embedment means less cracking. BackerBead with E-Flange is the ultimate solution for moisture protection on stucco installations.

Product Code	(A) Ground	(B) Flange	Length	Pieces per Box
6658BBE	5/8"	1-3/4"	10'	50
6675BBE	3/4"	1-3/4"	10'	50
6678BBE	7/8"	1-3/4"	10'	50
66100TBBE	1"	1-3/4"	10'	50
66125BBE	1-1/4"	1-3/4"	10'	50
66150BBE	1-1/2"	1-3/4"	10'	40
66175BBE	1-3/4"	1-3/4"	10'	40
66200BBE	2"	1-3/4"	10'	40

U.S. Patent Number D842,496; D843,015

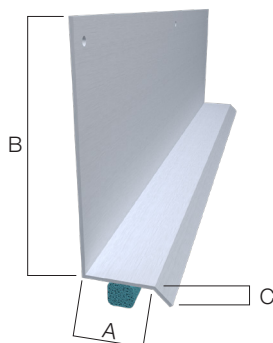
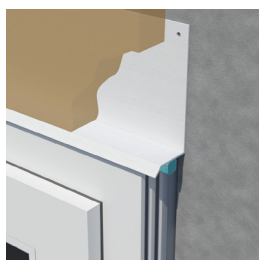

BackerBead® Drip Flashing - 3-1/2" Flange

Designed to provide positive drainage above exterior window and door openings while also providing a caulk tray at the top of window and door frames for the proper seal and added moisture protection.

Product Code	(A) Ground	(B) Flange	(C) Drip Leg	Length	Pieces per Box
DFL50-25BB	1/2"	3-1/2"	1/4"	10'	35
DFL58-25BB	5/8"	3-1/2"	1/4"	10'	35
DFL75-25BB	3/4"	3-1/2"	1/4"	10'	35
DFL78-25BB	7/8"	3-1/2"	1/4"	10'	35
DFL100-25BB	1"	3-1/2"	1/4"	10'	35
DFL150-25BB	1-1/2"	3-1/2"	1/4"	10'	35
DFL200-25BB	2"	3-1/2"	1/4"	10'	35
DFL300-25BB	3"	3-1/2"	1/4"	10'	25
DFL400-25BB	4"	3-1/2"	1/4"	10'	25

Patent Pending

Note: - Factory applied 3/8" x 3/8" backer rod is adhered 3/8" from the leading edge of the ground. Custom placement of the backer rod is available, contact Vinyl Corp. Customer Service for more information.

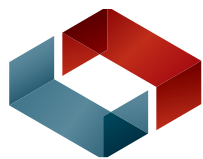

ClarkDietrich®

Vinyl Corp., a brand long associated with our company, will now officially bear our name. All of the same trusted products will be available through ClarkDietrich—which offers an ever-expanding lineup of interior and exterior finishing products.

8000 NW 79th Place
Miami, FL 33166

Phone: 305-477-6464
Fax: 305-477-4108

For more information,
call toll-free 1-800-648-4695
or visit www.vinylcorp.com

VC-BB-PROD ©04/19 CLARKWESTERN DIETRICH BUILDING SYSTEMS, LLC