

BlazeFrame® Flute Cover (FC)

"FC" Fire Stop Flute Cover profiles

Corrugated strap for horizontal use to span fluted areas of unprotected or protected metal decks in up to 2 hr rated assemblies. Profile attached to deck "valley" surfaces a max 16" o.c. on both sides.

Profiles provide a surface area for attachment of head of wall partition track profiles centered or offset underneath and parallel to deck fluted areas per listed assemblies in UL Fire Resistance Directory.

Product Data & Ordering Information:

Material: Yield Strength: Grade 33ksi
 Coating: CP60 (G90 available)
 33mils: 20ga, 0.0346" Design Thickness, 0.0329" Min. Thickness

Dimensions:

Width: 425 (4-1/4"), 675 (6-3/4") and 725 (7-1/4")
 Lengths: 10'

For connection details and fire rated assembly details on either of these systems, refer to www.clarkdietrich.com/BlazeFrame.

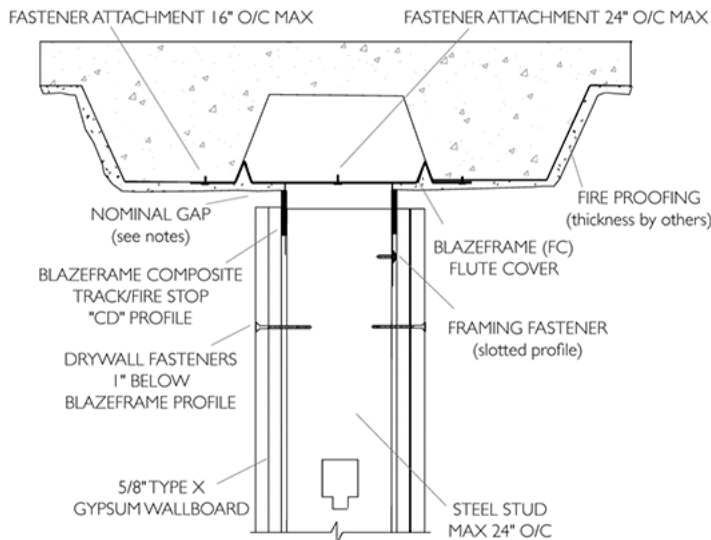

09.22.16 (Non-Structural Metal Framing)

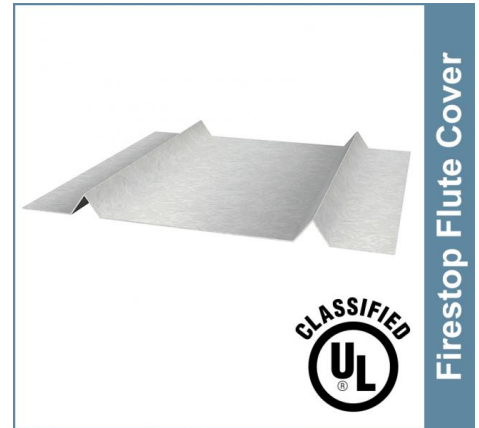

- UL Classified and Listed Joint Systems
- Patents: www.cd-patents.com

ASTM & Code Standards:

- ASTM C645, C955, A1003 and A653
- UL 2079 - Fifth Edition compliant (When used in conjunction with BlazeFrame Perimeter L-Bead)
- IBC requires fire-resistant joint systems be tested in accordance w/the requirements of either ASTM E1966 or UL 2079.
- SDS & Product Certification Info available at www.clarkdietrich.com/SupportDocs

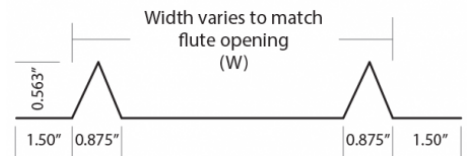

Project Information

Name:
 Address:

Contractor Information

Name:
 Contact:
 Phone:
 Fax:

Architect Information

Name:
 Contact:
 Phone:
 Fax: