

FastBack® Backing System (FBBC) 5-1/8" Wide

Universal design - works with studs in either direction

The FastBack® backing system features a universal design that works with studs in either direction—concealing fasteners on the face of the product. The system creates an interlocked design between the stud and track for baseboard backing installations; and a cutaway design allows backing and bracing to be installed all the way to the floor.

Product Data & Ordering Information: (FastBack® Backing System)

Product code	Width (in.)	Length (in.)	Packaging pcs./ctn.
FBBC	1-1/4	5-1/8	50

Clip Material: Grade 50ksi min. yield strength, G90
 33mils: 20ga STR, 0.0346" Design Thickness, 0.0329" Min. Thickness

Product Data & Ordering Information: (Dricon® & FlamePRO® Wood Backing)

Product code	Width (in.)	Length (in.)	Stud Spacing	Packaging pcs./skid
FBW	5-1/8	10-1/2	12" o.c.	720
FBW	5-1/8	14-1/2	16" o.c.	540
FBW	5-1/8	22-1/2	24" o.c.	360

5-1/8" Wide FastBack Backing System Nominal Load Values:

Installation Condition	Nominal (lbs)
Shear / 0" Offset	2045
Shear / 1" Offset	950
Shear / 3" Offset	325
Tension	740

Load Table Notes:

- Listed load values are nominal test load values, appropriate safety factors/resistance factors should be applied by the designer for calculating loads for intended use.
- Shear / Offset (moment-rotation) Load refers to load directed in the plane of the wall.
- Tension Load refers to load directed perpendicular to wall or plywood surface.
- Tabulated loads include the contribution of 5/8" gypsum board.
- Test loads were applied to the gypsum board and backing system through a 1/2" thick, 2-3/4" diameter steel plate secured w/(4) #12 hex head screws.
- Loads were applied directly through the steel plate or to a steel rod that cantilevered from the plate.
- Typical failure mode in backing testing was the gypsum board failure.
- 24-in on-center stud spacing test results were similar/identical to 16-in on-center test results.
- Listed capacities are based on 68mils (14ga) 50ksi studs.
- To install, rotate the FastBack® clip over the flange of the stud until it sits flush. Fasten into place using (3) #8 wafer head/pan head screws to metal stud at each pre-punched holes. Place wood onto tabs and fasten into place using (3) #8 wafer head/pan head screws. One screw at the center and one screw 1/2" from the top and bottom edges of wood

Dricon® or FlamePRO® FRT Wood Code Approvals:

Dricon	FlamePRO
UL Recognized Component - UL 723	UL GreenGuard Gold Certification - UL 2818
ICC-ES ESR-1626	ICC ESR-4244
NFPA 703, 101 Life Safety Code	NFPA 703, 101 Life Safety Code
City of Los Angeles (RR 25122)	City of Los Angeles Building Code
EPA Registration (62190-9)	City of Los Angeles Residential Code
NYC MEA 199-81-M, NYC MEA 200-81-M	National Building Code of Canada
HUD Materials Release (1261)	AIA Approved
Class A FRT wood	Class A FRT wood

For a complete list of FRT wood code approvals, visit www.clarkdietrich.com/FastBack

05.40.00 (Cold-Formed Metal Framing)

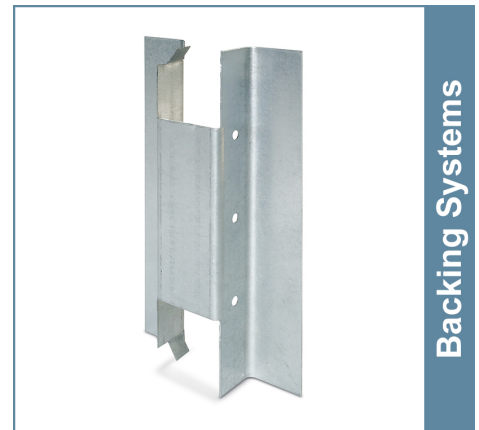

Backing Systems

- Pre-cut fire-rated wood backing sized to fit 12", 16", and 24" o.c. spacing
- Available for overnight delivery
- U.S. Patent No. 7,882,676

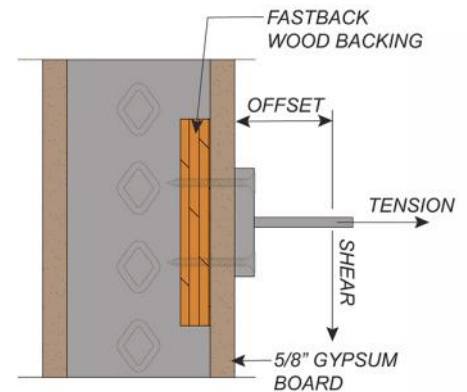

Project Information

Name:
Address:

Contractor Information

Name:
Contact:
Phone:
Fax:

Architect Information

Name:
Contact:
Phone:
Fax: