

**Product category:** S137 (1-3/8" Flange Structural Stud)  
**Product name:** **400S137-33 (33ksi, CP60) P - Punched**  
33mils (20ga) Coating: CP60 per ASTM C955  
Color coding: White

## Geometric Properties

Web depth	4.000 in		
Flange width	1.375 in	Punchout width	1.50 in
Stiffening lip	0.375 in	Punchout length	4.00 in
Design thickness	0.0346 in	Min. steel thickness	0.0329 in
Yield strength, Fy	33 ksi	Fy with Cold-Work, Fya	33.0 ksi
Ultimate, Fu	45.0 ksi		

## Gross Section Properties of Full Section, Strong Axis

Cross sectional area (A)	0.249 in <sup>2</sup>
Member weight per foot of length	0.85 lb/ft
Moment of inertia (Ix)	0.603 in <sup>4</sup>
Section modulus (Sx)	0.302 in <sup>3</sup>
Radius of gyration (Rx)	1.556 in
Gross moment of inertia (Iy)	0.061 in <sup>4</sup>
Gross radius of gyration (Ry)	0.496 in

## Effective Section Properties, Strong Axis

Effective Area (Ae)	0.150 in <sup>2</sup>
Moment of inertia for deflection (Ix)	0.603 in <sup>4</sup>
Section modulus (Sx)	0.259 in <sup>3</sup>
Allowable bending moment (Ma)	5.12 in-k
Allowable moment based on distortion buckling (Mad)	5.29 in-k
Allowable shear force in web (solid section)	976 lb
Allowable shear force in web (perforated section)	595 lb
Unbraced length (Lu)	34.5 in

## Torsional Properties

St. Venant torsion constant (J x 1000)	0.099 in <sup>4</sup>
Warping constant (Cw)	0.204 in <sup>6</sup>
Distance from shear center to neutral axis (Xo)	-0.965 in
Distance between shear center and web centerline (m)	0.597 in
Radii of gyration (Ro)	1.897 in
Torsional flexural constant (Beta)	0.741

## ASTM & Code Standards:

- AISI North American Specification [NASPEC] S100-12
- \* Effective properties incorporate the strength increase from the cold work of forming
- Gross properties are based on the cross section away from the punchouts
- Structural framing is produced to meet or exceed ASTM C955
- Sheet steel meets or exceeds mechanical and chemical requirements of ASTM A1003
- ClarkDietrich's structural and nonstructural framing comply with the SFIA Code Compliance Certification Program, ICC-ES ESR-1166P and Intertek CCRR-0206
- For installation & storage information refer to ASTM C1007
- SDS & Product Certification Information is available at [tools.clarkdietrich.com](http://tools.clarkdietrich.com)

## Sustainability Credits:

For more details and LEED letters contact Technical Services at 888-437-3244 or visit [www.clarkdietrich.com/LEED](http://www.clarkdietrich.com/LEED)

**LEED v4 MR Credit** -- Building Product Disclosure and Optimization: EPD (1 point) - Sourcing of Raw Materials (1 point) - Material Ingredients (1 point) - Construction and Demolition Waste Management (up to 2 points) - Innovation Credit (up to 2 points).

**LEED 2009 Credit MR 2 & MR 4** -- ClarkDietrich's steel products are 100% recyclable and have a national average recycled content of 34.2% (19.8% post-consumer and 14.4% pre-consumer). If seeking a higher number to meet Credit MR 5, please contact us at ([info@clarkdietrich.com](mailto:info@clarkdietrich.com) / 888-437-3244)

## 05.40.00 (Cold-Formed Metal Framing)

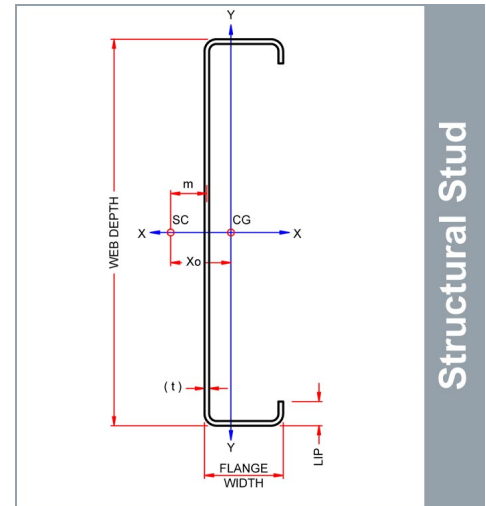

## Used in framing applications:

- Load-bearing walls
- Curtain walls
- Tall interior walls
- Floor & ceiling joists
- Trusses

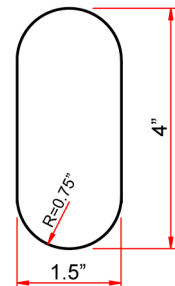

**Structural Punchout**

East market punchout spacing:  
12" from lead end then 24" o.c.

West market punchout spacing:  
24" from lead end then 24" o.c.

## Project Information

Name:  
Address:

## Contractor Information

Name:  
Contact:  
Phone:  
Fax:

## Architect Information

Name:  
Contact:  
Phone:  
Fax: