

Product category: S137 (1-3/8" Flange Structural Stud)
Product name: **400S137-54 (50ksi, CP60) P - Punched**
54mils (16ga) Coating: CP60 per ASTM C955
Color coding: Green

Geometric Properties

Web depth	4.000 in		
Flange width	1.375 in	Punchout width	1.50 in
Stiffening lip	0.375 in	Punchout length	4.00 in
Design thickness	0.0566 in	Min. steel thickness	0.0538 in
Yield strength, Fy	50 ksi	Fy with Cold-Work, Fya	50.0 ksi
Ultimate, Fu	65.0 ksi		

Gross Section Properties of Full Section, Strong Axis

Cross sectional area (A)	0.401 in ²
Member weight per foot of length	1.36 lb/ft
Moment of inertia (Ix)	0.953 in ⁴
Section modulus (Sx)	0.477 in ³
Radius of gyration (Rx)	1.543 in
Gross moment of inertia (Iy)	0.094 in ⁴
Gross radius of gyration (Ry)	0.484 in

Effective Section Properties, Strong Axis

Effective Area (Ae)	0.260 in ²
Moment of inertia for deflection (Ix)	0.953 in ⁴
Section modulus (Sx)	0.428 in ³
Allowable bending moment (Ma)	12.82 in-k
Allowable moment based on distortion buckling (Mad)	13.38 in-k
Allowable shear force in web (solid section)	3372 lb
Allowable shear force in web (perforated section)	1223 lb
Unbraced length (Lu)	27.7 in

Torsional Properties

St. Venant torsion constant (J x 1000)	0.428 in ⁴
Warping constant (Cw)	0.311 in ⁶
Distance from shear center to neutral axis (Xo)	-0.940 in
Distance between shear center and web centerline (m)	0.583 in
Radii of gyration (Ro)	1.870 in
Torsional flexural constant (Beta)	0.747

ASTM & Code Standards:

- AISI North American Specification [NASPEC] S100-12
- * Effective properties incorporate the strength increase from the cold work of forming
- Gross properties are based on the cross section away from the punchouts
- Structural framing is produced to meet or exceed ASTM C955
- Sheet steel meets or exceeds mechanical and chemical requirements of ASTM A1003
- ClarkDietrich's structural and nonstructural framing comply with the SFIA Code Compliance Certification Program, ICC-ES ESR-1166P and Intertek CCRR-0206
- For installation & storage information refer to ASTM C1007
- SDS & Product Certification Information is available at tools.clarkdietrich.com

Sustainability Credits:

For more details and LEED letters contact Technical Services at 888-437-3244 or visit www.clarkdietrich.com/LEED

LEED v4 MR Credit -- Building Product Disclosure and Optimization: EPD (1 point) - Sourcing of Raw Materials (1 point) - Material Ingredients (1 point) - Construction and Demolition Waste Management (up to 2 points) - Innovation Credit (up to 2 points).

LEED 2009 Credit MR 2 & MR 4 -- ClarkDietrich's steel products are 100% recyclable and have a national average recycled content of 34.2% (19.8% post-consumer and 14.4% pre-consumer). If seeking a higher number to meet Credit MR 5, please contact us at (info@clarkdietrich.com / 888-437-3244)

05.40.00 (Cold-Formed Metal Framing)

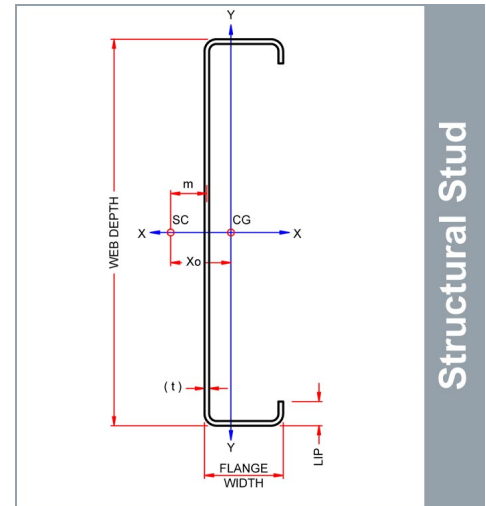

Used in framing applications:

- Load-bearing walls
- Curtain walls
- Tall interior walls
- Floor & ceiling joists
- Trusses

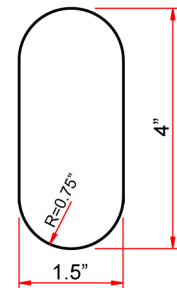

Structural Punchout

East market punchout spacing:
12" from lead end then 24" o.c.

West market punchout spacing:
24" from lead end then 24" o.c.

Project Information

Name:
Address:

Contractor Information

Name:
Contact:
Phone:
Fax:

Architect Information

Name:
Contact:
Phone:
Fax: