

SwiftClip™ L-Series™ Support Clip

Support for the most demanding applications.

SwiftClip™ L-Series™ support clips are used in multiple construction projects, specifically in conjunction with structural studs and track. The L-shaped clips fit between the stud flanges, so that shorter length clips do not need to be ordered. These labor time-savers include prepunched holes for quicker screw attachments, and are punched to accommodate for CRC lateral bracing connections.

ALTERNATIVE PRODUCTS

EasyClip™ E-Series™ Support Clip
 EasyClip S-Series™ Support Clip
 EasyClip U-Series™ Clip Angle
 FastBridge™ Clip
 EasyClip X-Series™ Clip Angle
 EasyClip A-Series™ End Clip

PRODUCT DIMENSIONS

See chart below for available sizes.

MATERIAL SPECIFICATIONS

Gauge: 16 gauge (54mil)

Design Thickness: 0.0566 inches

Gauge: 14 gauge (68mil)

Design Thickness: 0.0713 inches

Gauge: 12 gauge (97mil)

Design Thickness: 0.1017 inches

Coating: G90

Yield Strength: 50ksi

ASTM: A653/A653M

SwiftClip™ L-Series™ Support Clip

Product code	Thickness		Size (in)	Common application	Packaging Pcs./Bucket
	Mils (Gauge)	Design thickness (in)			
LS543	54mil (16ga)	0.0566	1-1/2 x 1-1/2 x 3-1/4	CRC/Openings	300
LS683	68mil (14ga)	0.0713		Openings	300
LS973	97mil (12ga)	0.1017		Openings	200
LS545	54mil (16ga)	0.0566	1-1/2 x 1-1/2 x 5-1/2	CRC/Openings/Joists	200
LS685	68mil (14ga)	0.0713		Openings/Joists	200
LS975	97mil (12ga)	0.1017		Openings/Joists	100
LS547	54mil (16ga)	0.0566	1-1/2 x 1-1/2 x 7-1/4	CRC/Openings/Joists	150
LS687	68mil (14ga)	0.0713		Openings/Joists	100
LS977	97mil (12ga)	0.1017		Openings/Joists	100
LS549	54mil (16ga)	0.0566	1-1/2 x 1-1/2 x 9-1/4	Joists	100
LS689	68mil (14ga)	0.0713		Joists	100
LS979	97mil (12ga)	0.1017		Joists	50
LS541	54mil (16ga)	0.0566	1-1/2 x 1-1/2 x 11-1/4	Joists	100
LS681	68mil (14ga)	0.0713		Joists	50
LS971	97mil (12ga)	0.1017		Joists	50
LS5413	54mil (16ga)	0.0566	1-1/2 x 1-1/2 x 13-1/4	Joists	50
LS6813	68mil (14ga)	0.0713		Joists	50
LS9713	97mil (12ga)	0.1017		Joists	25
LE543	54mil (16ga)	0.0566	1-1/2 x 3 x 3-1/4	Fixed/Joists/Trusses	100
LE683	68mil (14ga)	0.0713		Fixed/Joists/Trusses	100
LE973	97mil (12ga)	0.1017		Fixed/Joists/Trusses	50
LE545	54mil (16ga)	0.0566	1-1/2 x 3 x 5-1/2	Fixed/Joists/Trusses	100
LE685	68mil (14ga)	0.0713		Fixed/Joists/Trusses	100
LE975	97mil (12ga)	0.1017		Fixed/Joists/Trusses	50
LE547	54mil (16ga)	0.0566	1-1/2 x 3 x 7-1/4	Fixed/Joists/Trusses	100
LE687	68mil (14ga)	0.0713		Fixed/Joists/Trusses	50
LE977	97mil (12ga)	0.1017		Fixed/Joists/Trusses	50
LA543	54mil (16ga)	0.0566	3 x 3 x 3-1/4	Joists/Trusses	100
LA683	68mil (14ga)	0.0713		Joists/Trusses	100
LA973	97mil (12ga)	0.1017		Joists/Trusses	50
LA545	54mil (16ga)	0.0566	3 x 3 x 5-1/2	Joists/Trusses	100
LA685	68mil (14ga)	0.0713		Joists/Trusses	50
LA975	97mil (12ga)	0.1017		Joists/Trusses	50
LA547	54mil (16ga)	0.0566	3 x 3 x 7-1/4	Joists/Trusses	50
LA687	68mil (14ga)	0.0713		Joists/Trusses	50
LA977	97mil (12ga)	0.1017		Joists/Trusses	50

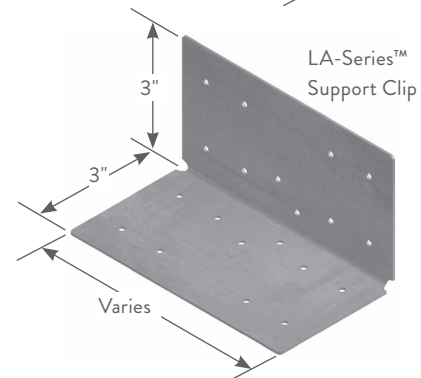
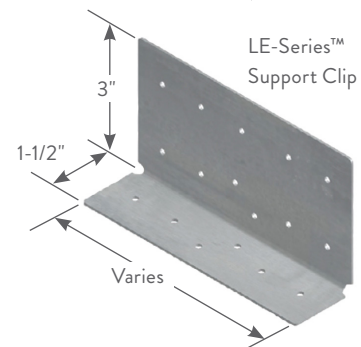
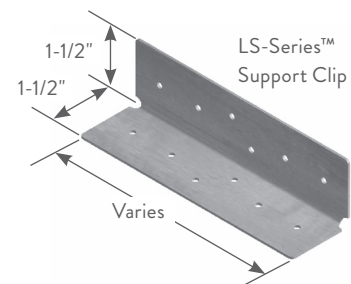

Allowable Shear Load Table

Product code	No. of screws/leg	Stud Thickness (Yield Strength)				
		20ga (33mil) 33ksi	18ga (43mil) 33ksi	16ga (54mil) 50ksi	14ga (68mil) 50ksi	12ga (97mil) 50ksi
LS543	2	294	438	777	777	777
	4	437	651	1154	1154	1154
LS683	2	294	438	777	777	777
	4	437	651	1154	1154	1154
LS973	2	294	438	777	777	777
	4	437	651	1154	1154	1154
LS545	2	333	496	880	880	880
	4	619	921	1635	1635	1635
LS685	2	333	496	880	880	880
	4	619	921	1635	1635	1635
LS975	2	333	496	880	880	880
	4	619	921	1635	1635	1635
LS547	4	651	968	1718	1718	1718
	6	966	1438	2551	2551	2551
LS687	4	651	968	1718	1718	1718
	6	966	1438	2551	2551	2551
LS977	4	651	968	1718	1718	1718
	6	966	1438	2551	2551	2551
LS549	4	670	997	1768	1768	1768
	6	1007	1498	2658	2658	2658
LS689	4	670	997	1768	1768	1768
	6	1007	1498	2658	2658	2658
LS979	4	670	997	1768	1768	1768
	6	1007	1498	2658	2658	2658
LS541	4	681	1013	1798	1798	1798
	6	1013	1508	2675	2675	2675
LS681	4	681	1013	1798	1798	1798
	6	1013	1508	2675	2675	2675
LS971	4	681	1013	1798	1798	1798
	6	1013	1508	2675	2675	2675
LS5413	4	688	1024	1816	1816	1816
	6	1020	1518	2694	2694	2694
LS6813	4	688	1024	1816	1816	1816
	6	1020	1518	2694	2694	2694
LS9713	4	688	1024	1816	1816	1816
	6	1020	1518	2694	2694	2694

Notes:

- 1 Shear values for clips are based on attachment to cold-formed steel members. Attachment to other substrates must be designed separately.
- 2 Place the first two screws in each leg in the outermost screw holes. Place the next two screws (if needed) in center holes next to the CRC holes (diagonal). The next screws (if needed) are placed moving from the outermost holes toward the center, symmetrically.
- 3 Shear values are based on the tilting bearing modes of failure Eq. E4.3.1-1, E4.3.1-2.4 Allowable screw shear is based on a factor of safety of 3.0. #10 screws (0.19" min. diameter) must have minimum ultimate shear strength of 1400 lbs.
- 4 Screws must have three threads exposed after installation.
- 5 It is the responsibility of the design engineer to detail the attachment of clips and verify their capacity meets the application. This table is intended for use by qualified engineers.
- 6 For technical assistance or additional load charts, contact ClarkDietrich at 888-437-3244.

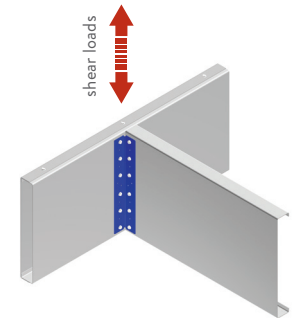

Joist-to-Joist Connections

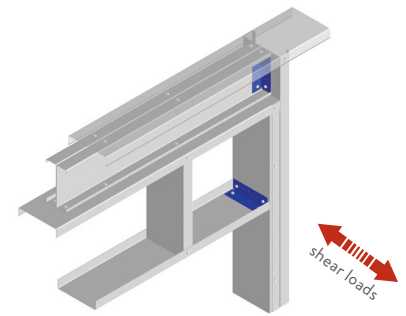

Head-to-Jamb Connections

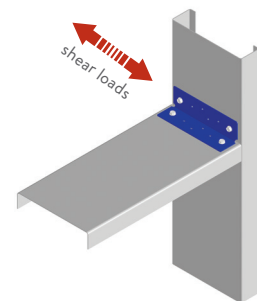

Sill-to-Jamb Connections

