

Muddable J-Bead Commerical Beads

Muddable J-Bead is used to cover and protect exposed ends of gypsum panels that abut to other substrates such as masonry, glass and metal frames. Raised shoulder and extensive perforations along flange ensure excellent finishing compound adhesion and flush finish. Moisture- and thermal-resistant properties of rigid vinyl trims make for ideal use around bathtubs, showers, windows and skylights. Rust proof and dent resistant. Easy to cut and install.

Product Data & Ordering Information:

Material: 0.028" PVC (Polyvinyl Chloride)
 Dimensions: 1/2" & 5/8" depths

Product code	Board thickness	Return leg	Flange	Length	Pcs./Ctn.
MJB50-8	1/2"	1/4"	1-1/8"	8'	50
MJB50-10	1/2"	1/4"	1-1/8"	10'	50
MJB58-8	5/8"	1/4"	1-1/8"	8'	50
MJB58-10	5/8"	1/4"	1-1/8"	10'	50

ASTM & Code Standards:

- ASTM C1047 - Standard Specification for Accessories for Gypsum Wallboard and Gypsum Veneer Base
- ASTM D3678 Class 2 materials
- Installation: ASTM C840 & C841 (Interior Finishes)
- SDS & Product Certification Information is available at www.clarkdietrich.com/SupportDocs

Storage:

All stored materials shall be kept dry. Materials shall be stacked off the ground, supported on a level platform, and protected from the weather.

09.22.00 (Support for Plaster & Gypsum Board)



- Rust proof and dent resistant
- Produces finished edges at panel terminations
- Raised shoulder and perforations enhance compound adhesion

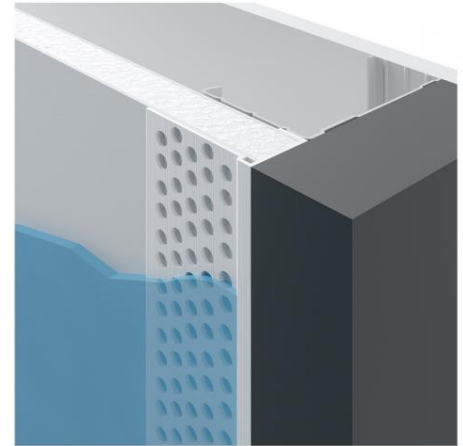

Project Information

Name:
Address:

Contractor Information

Name:
Contact:
Phone:
Fax:

Architect Information

Name:
Contact:
Phone:
Fax: