

C25 45° Heavy Duty Adjustable Half Hanger

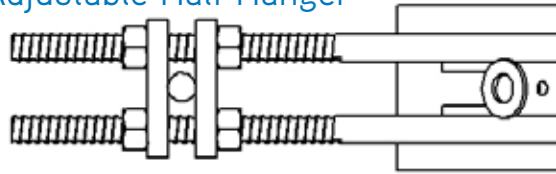

Top View without B13 and Coil Rod at 45°

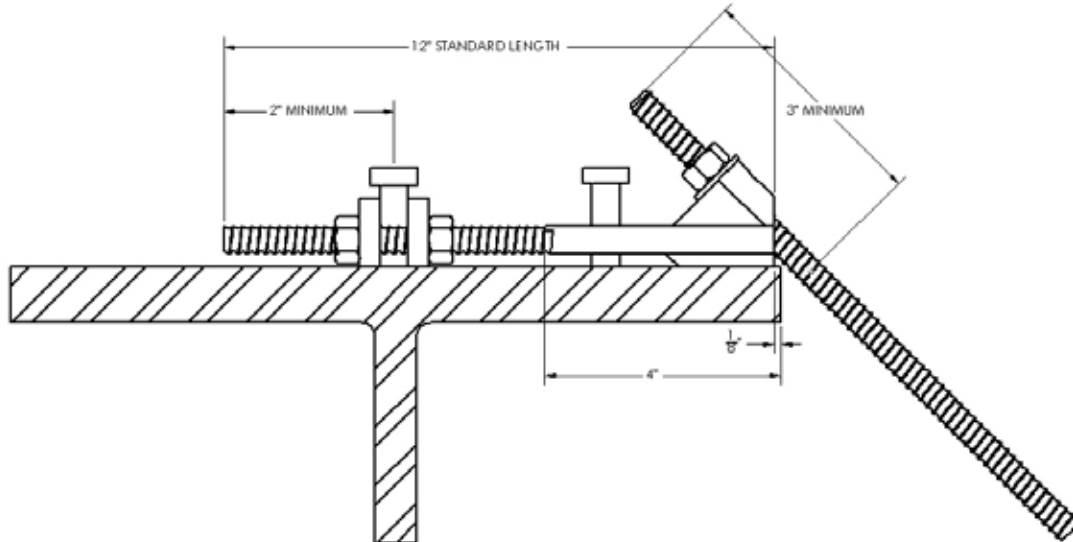

This adjustable half hanger consists of a 45° end clip welded to two 1/2" diameter coil rods, two connection bars and five 1/2" coil nuts. The standard length is 12". Other lengths are available on request.

These half hangers are used to support overhang brackets for exterior deck formwork where one-sided forming is required, welding is not permitted and rebar or headed stud shear connectors are available to connect the hanger to.

Safe Working Load
6,000 lbs.

SWL provides a factor of safety of approximately 2 to 1.

To Order:

Specify: (1) quantity, (2) name, (3) type, (4) length, (5) number of connection bars.

Example:

125 pcs. C25 Heavy Duty Adjustable Half Hanger, 12" long with 2 connection bars.