

GENERAL INFORMATION

AC100+ GOLD®

Vinylester Injection Adhesive Anchoring System

PRODUCT DESCRIPTION

The AC100+ Gold is a two-component vinylester adhesive anchoring system. The system includes injection adhesive in plastic cartridges, mixing nozzles, dispensing tools and hole cleaning equipment. The adhesive is designed for bonding threaded rod and reinforcing bar elements into drilled holes in concrete and masonry base materials. It can be considered for use in solid base materials as well as hollow base materials with screen tubes.

GENERAL APPLICATIONS AND USES

- Bonding threaded rod and reinforcing bar into hardened concrete and masonry
- Evaluated for use in dry and water-saturated concrete (including water filled holes)
- Suitable to resist loads in cracked or uncracked concrete base materials
- Adhesive system can be installed in a wide range of base material temperatures; qualified for anchoring applications in concrete as low as 14°F (-10°C)
- Tested and qualified for wind and seismic loading (SDC A - F)

FEATURES AND BENEFITS

- + Designed for use with threaded rod and reinforcing bar hardware elements
- + Consistent performance in low and high strength concrete
- + Evaluated and recognized for freeze/thaw performance and sustained loading
- + Evaluated and recognized for a range of embedments
- + Versatile low odor formula with optimized cure time
- + Evaluated and recognized for long term and short term loading (see performance tables)
- + Mixing nozzles proportion adhesive and provide simple delivery method into drilled holes
- + Cartridge design allows for multiple uses using extra mixing nozzles
- + Universal product for concrete and masonry (hollow and solid base materials)

APPROVALS AND LISTINGS

- International Code Council, Evaluation Service (ICC-ES) ESR-2582 for cracked and uncracked concrete
- International Code Council, Evaluation Service (ICC-ES) ESR-3200 for cracked and uncracked masonry
- International Code Council, Evaluation Service (ICC-ES) ESR-4105 for Unreinforced Masonry (URM)
- Code compliant with the 2024 IBC/IRC, 2021 IBC/IRC, 2018 IBC/IRC and 2015 IBC/IRC
- Tested in accordance with ASTM E488 / ACI 355.4 and ICC-ES AC308 for use in structural concrete with design according to ACI 318 (-19 & -14) Chapter 17 and ACI 318 Appendix D
- Tested in accordance with ICC-ES AC58 and ICC-ES AC60 for use in masonry walls
- Compliant with NSF/ANSI Standard 61 for drinking water system components – health effects
- Compliant to California DPH for VOC emissions and South Coast AQMD for VOC content (LEED v4.1)
- Conforms to requirements of ASTM C881 including C882 and AASHTO M235, Types I, II, IV and V, Grade 3, Class A and conforms to requirements of ASTM C881 Types I and IV, Grade 3, Class B
- Department of Transportation listings – see www.DEWALT.com or contact transportation agency

GUIDE SPECIFICATIONS

CSI Divisions: 03 16 00 - Concrete Anchors, 04 05 19.16 - Masonry Anchors and 05 05 19 - Post-Installed Concrete Anchors. Adhesive anchoring system shall be AC100+ Gold as supplied by DEWALT, Towson, MD. Anchors shall be installed in accordance with published instructions and requirements of the Authority Having Jurisdiction.

SECTION CONTENTS

General Information..... 1
 Installation Specifications 2
 Performance Data (ASD) 3
 Strength Design Information 10
 Design Strength Tables (SD) 15
 Installation Instructions :
 Solid Base Materials..... 26
 Installation Instructions :
 Unreinforced Masonry [URM Walls]
 and Hollow Base Materials 27
 Reference Installation Tables 28
 Ordering Information 29



**AC100+ GOLD ADHESIVE
IN CARTRIDGE**
(STANDARD THREADED ROD AND
REBAR STEEL SUPPLIED BY OTHERS)

PACKAGING (10:1 MIX RATIO)

Coaxial Cartridge

- 9.5 fl. oz. (280 mL or 17.1 in³)

Dual Cartridge (side-by-side)

- 28 fl. oz. (825 mL or 50.3 in³)

STORAGE LIFE & CONDITIONS

Eighteen months in a dry, dark environment with temperature ranging from 32°F and 86°F (-0°C to 30°C)

ANCHOR SIZE RANGE (TYPICAL)

- 3/8" to 1-1/4" diameter threaded rod
- No. 3 to No. 10 reinforcing bar

SUITABLE BASE MATERIALS

- Normal-weight concrete
- Lightweight concrete
- Grouted concrete masonry (CMU)
- Hollow concrete masonry (CMU)
- Hollow core concrete
- Brick masonry
- Unreinforced Masonry (URM Walls)

**PERMISSIBLE INSTALLATION
CONDITIONS (ADHESIVE)**

- Dry concrete
- Water-saturated concrete (wet)
- Water-filled holes (flooded)



INSTALLATION SPECIFICATIONS

Installation Table for AC100+ Gold (Solid Concrete Base Materials)

Parameter	Symbol	Units	Fractional Nominal Rod Diameter (Inch) / Reinforcing Bar Size									
			3/8 or #3	1/2	#4	5/8 or #5	3/4 or #6	7/8 or #7	1 or #8	#9	1-1/4	#10
Threaded rod outside diameter	d_a (d)	inch (mm)	0.375 (9.5)	0.500 (12.7)	0.625 (15.9)	0.750 (19.1)	0.875 (22.2)	1.000 (25.4)	-	1.250 (31.8)	-	
Rebar nominal outside diameter	d_a (d)	inch (mm)	0.375 (9.5)	0.500 (12.7)	0.625 (15.9)	0.750 (19.1)	0.875 (22.2)	1.000 (25.4)	1.125 (28.7)	-	1.250 (31.8)	
Nominal drill bit size (ANSI) ⁶	d_o (d_{bit})	inch	7/16	9/16	5/8	11/16 or 3/4	7/8	1	1-1/8	1-3/8	1-3/8	1-1/2
Minimum embedment ¹	$h_{ef,min}$	inch (mm)	2-3/8 (60)	2-3/4 (70)	3-1/8 (79)	3-1/2 (89)	3-1/2 (89)	4 (102)	4-1/2 (114)	5 (127)	5 (127)	
Maximum embedment ¹	$h_{ef,max}$	inch (mm)	4-1/2 (114)	6 (152)	7-1/2 (191)	9 (229)	10-1/2 (267)	12 (305)	13-1/2 (343)	15 (381)	15 (381)	
Minimum member thickness	h_{min}	inch (mm)	$h_{ef} + 1-1/4$ ($h_{ef} + 30$)			$h_{ef} + 2d_o$						
Minimum anchor spacing	s_{min}	inch (mm)	1-7/8 (48)	2-1/2 (64)	3-1/8 (79)	3-3/4 (95)	4-3/8 (111)	5 (127)	5-5/8 (143)	6-1/4 (159)	6-1/4 (159)	
Minimum edge distance (up to 100% T_{max})	c_{min}	inch (mm)	1-7/8 (48)	2-1/2 (64)	3-1/8 (79)	3-3/4 (95)	4-3/8 (111)	5 (127)	5-5/8 (143)	6-1/4 (159)	6-1/4 (159)	
Max. rod torque ²	T_{max}	ft-lbs	15	33	60	105	125	165	-	280	-	
Minimum edge distance, reduced ^{4,5}	$c_{min,red}$	inch (mm)	1-3/4 (45)	1-3/4 (45)	1-3/4 (45)	1-3/4 (45)	1-3/4 (45)	1-3/4 (45)	2-3/4 (70)	2-3/4 (70)	2-3/4 (70)	
Max. torque ^{2,3} (low strength rods)	$T_{max,ls-rod}$	ft-lbs	7	20	40	60	100	165	-	280	-	

- For pound-inch units: 1 mm = 0.03937 inch, 1 N-m = 0.7375 ft-lbf. For SI: 1 inch = 25.4 mm, 1 ft-lbf = 1.356 N-m.
- Embedment range qualified for use with the design provisions of ACI 318 (-19 and -14) Chapter 17 as applicable and ICC-ES AC308, and ESR-2582 in concrete.
 - Torque may not be applied to the anchors until the full cure time of the adhesive has been achieved.
 - These torque values apply to ASTM A36 / F1554 Grade 36 carbon steel threaded rods and ASTM A193 Grade B8/B8M (Class 1) stainless steel threaded rods.
 - For installation below the minimum edge distance, c_{min} , down to the reduced minimum edge distance, $c_{min,red}$, the reduced maximum torque is $0.45 \cdot T_{max}$.
 - For installations down to the reduced minimum edge distance, $c_{min,red}$, the minimum anchor spacing, s_{min} , is 5d.
 - The listed drill bit sizes are also applicable to installations into grouted concrete masonry.

Installation Table for AC100+ Gold (Hollow Base Material with Screen Tube)

Parameter	Symbol	Units	Nominal Tube Size - Stainless Steel						Nominal Tube Size - Plastic		
			1/4	3/8	1/2	5/8	3/4	3/8	1/2	5/8	
Nominal threaded rod size	-	in.	1/4	3/8	1/2	5/8	3/4	3/8	1/2	5/8	
Nominal threaded rod diameter	d	in.	0.250	0.375	0.500	0.625	0.750	0.375	0.500	0.625	
Reinforcing bar size	-	No.	-	-	#3	#4	#5	#6	-	-	-
Nominal rebar diameter	d	in.	-	-	0.375	0.500	0.625	0.750	-	-	-
Nominal screen tube diameter	-	in.	1/4	3/8	1/2	5/8	3/4	15/16	3/8	1/2	5/8
Nominal drill bit size (ANSI)	d_{bit}	in.	3/8	1/2	5/8	3/4	7/8	1	9/16	3/4	7/8
Maximum torque ¹	T_{max}	ft-lbs	2	5	10	10	10	10	5	8	8

- Torque may not be applied to the anchors until the full cure time of the adhesive has been achieved.
- For Unreinforced Masonry (URM Walls) see separate installation details and information in these tech pages for 'Retrofit Bolt Anchors in URM Walls'.

Detail of Steel Hardware Elements used with Injection Adhesive System

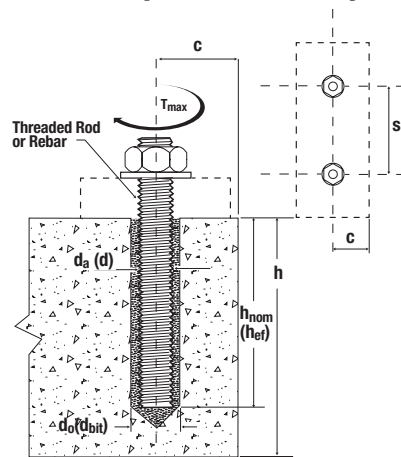

- Nomenclature**
- d_a (d) = Diameter of anchor
 - d_o (d_{bit}) = Diameter of drilled hole
 - h = Base material thickness
 - h_{nom} (h_{ef}) = Embedment depth
 - s = Spacing of anchors
 - c = Edge distance
 - T_{max} = Maximum torque

Threaded Rod and Deformed Reinforcing Bar Material Properties

Steel Description (General)	Steel Specification (ASTM)	Nominal Anchor Size (inch/No.)	Minimum Yield Strength, f_y (psi)	Minimum Ultimate Strength, f_u (psi)
Carbon rod	ASTM A36 and F1554 Grade 36	3/8 through 1-1/4	36,000	58,000
	ASTM F1554 Grade 55	3/8 through 1-1/4	55,000	75,000
	ASTM A449	3/8 through 1	92,000	120,000
		1-1/4	81,000	105,000
Stainless rod (Alloy 304/316)	ASTM A193 Grade B7 and F1554 Grade 105	3/8 through 1-1/4	105,000	125,000
	ASTM F593 Condition CW	3/8 through 5/8	65,000	100,000
		3/4 through 1-1/4	45,000	85,000
Reinforcing Bar	ASTM A193 Grade B8/B8M, Class 1	3/8 through 1-1/4	30,000	75,000
	ASTM A193 Grade B8/B8M2, Class 2B	3/8 through 1-1/4	75,000	95,000
	ASTM A615/A706, Grade 80	#3 through #10	80,000	100,000
	ASTM A615, Grade 75	#3 through #10	75,000	100,000
	ASTM A615/A706, Grade 60	#3 through #10	60,000	80,000
	ASTM A615, Grade 40	#3 through #6	40,000	60,000

Tabulated material properties are provided for reference; other steel hardware elements and sizes may also be considered. Reinforcing bars typically are bare, zinc coated or galvanized in accordance with ASTM A767.

PERFORMANCE DATA (ASD)

Ultimate and Allowable Load Capacities for AC100+ Gold Installed into Normal Weight Concrete with Threaded Rod and Reinforcing Bar (based on bond strength/concrete capacity)^{1,2,3,4,5,6}



Nominal Rod Diameter or Rebar Size d in. or No.	Minimum Embedment Depth h _{nom} in.	Minimum Concrete Compressive Strength							
		f'c = 3,000 psi		f'c = 4,000 psi		f'c = 5,000 psi		f'c = 6,000 psi	
		Ultimate Tension Load Capacity lbs (kN)	Allowable Tension Load Capacity lbs (kN)	Ultimate Tension Load Capacity lbs (kN)	Allowable Tension Load Capacity lbs (kN)	Ultimate Tension Load Capacity lbs (kN)	Allowable Tension Load Capacity lbs (kN)	Ultimate Tension Load Capacity lbs (kN)	Allowable Tension Load Capacity lbs (kN)
3/8 or #3	2-3/8	4,840 (21.5)	1,210 (5.4)	5,040 (22.4)	1,260 (5.6)	5,180 (23.0)	1,295 (5.8)	5,320 (23.7)	1,330 (5.9)
	3-1/2	7,140 (31.8)	1,785 (7.9)	7,420 (33.0)	1,855 (8.3)	7,640 (34.0)	1,910 (8.5)	7,820 (34.8)	1,955 (8.7)
	4-1/2	9,180 (40.8)	2,295 (10.2)	9,540 (42.4)	2,385 (10.6)	9,820 (43.7)	2,455 (10.9)	10,060 (44.7)	2,515 (11.2)
1/2 or #4	2-3/4	7,980 (35.5)	1,995 (8.9)	8,280 (36.8)	2,070 (9.2)	8,540 (38.0)	2,135 (9.5)	8,740 (38.9)	2,185 (9.7)
	4-3/8	12,720 (56.6)	3,180 (14.1)	13,200 (58.7)	3,300 (14.7)	13,580 (60.4)	3,395 (15.1)	13,900 (61.8)	3,475 (15.5)
	6	17,420 (77.5)	4,355 (19.4)	18,100 (80.5)	4,525 (20.1)	18,620 (82.8)	4,655 (20.7)	19,080 (84.9)	4,770 (21.2)
5/8 or #5	3-1/8	11,220 (49.9)	2,805 (12.5)	11,660 (51.9)	2,915 (13.0)	12,000 (53.4)	3,000 (13.3)	12,300 (54.7)	3,075 (13.7)
	5-1/4	19,200 (85.4)	4,800 (21.4)	19,960 (88.8)	4,990 (22.2)	20,540 (91.4)	5,135 (22.8)	21,020 (93.5)	5,255 (23.4)
	7-1/2	27,660 (123.0)	6,915 (30.8)	28,720 (127.8)	7,180 (31.9)	29,560 (131.5)	7,390 (32.9)	30,280 (134.7)	7,570 (33.7)
3/4 or #6	3-1/2	13,320 (59.3)	3,330 (14.8)	13,820 (61.5)	3,455 (15.4)	14,220 (63.3)	3,555 (15.8)	14,560 (64.8)	3,640 (16.2)
	6-1/4	26,880 (119.6)	6,720 (29.9)	27,900 (124.1)	6,975 (31.0)	28,720 (127.8)	7,180 (31.9)	29,420 (130.9)	7,355 (32.7)
	9	40,440 (179.9)	10,110 (45.0)	42,000 (186.8)	10,500 (46.7)	43,220 (192.3)	10,805 (48.1)	44,260 (196.9)	11,065 (49.2)
7/8 or #7	3-1/2	13,320 (59.3)	3,330 (14.8)	13,820 (61.5)	3,455 (15.4)	14,220 (63.3)	3,555 (15.8)	14,560 (64.8)	3,640 (16.2)
	7	36,680 (163.2)	9,170 (40.8)	38,080 (169.4)	9,520 (42.3)	39,200 (174.4)	9,800 (43.6)	40,140 (178.6)	10,035 (44.6)
	10-1/2	60,040 (267.1)	15,010 (66.8)	62,340 (277.3)	15,585 (69.3)	64,180 (285.5)	16,045 (71.4)	65,700 (292.2)	16,425 (73.1)
1 or #8	4	16,260 (72.3)	4,065 (18.1)	16,880 (75.1)	4,220 (18.8)	17,380 (77.3)	4,345 (19.3)	17,800 (79.2)	4,450 (19.8)
	8	46,540 (207.0)	11,635 (51.8)	48,300 (214.8)	12,075 (53.7)	49,740 (221.3)	12,435 (55.3)	50,920 (226.5)	12,730 (56.6)
	12	76,820 (341.7)	19,205 (85.4)	79,740 (354.7)	19,935 (88.7)	82,080 (365.1)	20,520 (91.3)	84,060 (373.9)	21,015 (93.5)
1-1/4 or #10	5	22,740 (101.2)	5,685 (25.3)	23,600 (105.0)	5,900 (26.2)	24,300 (108.1)	6,075 (27.0)	24,880 (110.7)	6,220 (27.7)
	10	65,880 (293.0)	16,470 (73.3)	68,400 (304.3)	17,100 (76.1)	70,420 (313.2)	17,605 (78.3)	72,100 (320.7)	18,025 (80.2)
	15	93,775 (417.1)	23,445 (104.3)	97,350 (433.1)	24,340 (108.3)	100,225 (445.8)	25,055 (111.5)	102,615 (456.5)	25,655 (114.1)

1. Allowable load capacities listed are calculated using an applied safety factor of 4.0 which includes an assessment of freezing/thawing conditions and sensitivity to sustained loads (i.e. creep resistance). Consideration of safety factors of 10 or higher may be necessary depending on the application, such as life safety or overhead.
2. Linear interpolation may be used to determine allowable loads for intermediate embedments and compressive strengths.
3. The tabulated load values are applicable to single anchors installed at critical edge and spacing distances of 3 times embedment depth and where the minimum member thickness is the greater of [h_{nom} + 1-1/4"] and [h_{nom} + 2d_{adj}].
4. The tabulated load values are applicable for dry uncracked concrete installed into holes drilled with a hammer drill and an ANSI carbide drill bit. Installations into saturated (wet) concrete or water-filled holes require a reduction in capacity for tabulated values of 15 percent or 50 percent, respectively.
5. Adhesives experience reductions in capacity at elevated temperatures. See the In-Service Temperature chart for allowable loads capacity reduction factors.
6. Allowable bond strength/concrete capacity must be checked against allowable steel strength to determine the controlling allowable load. Allowable shear capacity is controlled by allowable steel strength for the given conditions.

ADHESIVES

AC100+ GOLD®
Vinylester Injection Adhesive Anchoring System



Allowable Load Capacities for Threaded Rod and Reinforcing Bar (Based on Steel Strength)^{1,2,3,4}

Nominal Rod Diameter or Rebar Size (in. or No.)	Steel Elements - Threaded Rod and Reinforcing Bar																	
	A36 or F1554, Grade 36		A36 or F1554, Grade 55		A193, Grade B7 or F1554, Grade 105		F593, CW (SS)		ASTM A615 Grade 40 Rebar		ASTM A615 Grade 60 Rebar		ASTM A706 Grade 60 Rebar		ASTM A615 Grade 75 / Grade 80 Rebar		ASTM A706 Grade 80 Rebar	
	Tension lbs. (kN)	Shear lbs. (kN)	Tension lbs. (kN)	Shear lbs. (kN)	Tension lbs. (kN)	Shear lbs. (kN)	Tension lbs. (kN)	Shear lbs. (kN)	Tension lbs. (kN)	Shear lbs. (kN)	Tension lbs. (kN)	Shear lbs. (kN)	Tension lbs. (kN)	Shear lbs. (kN)	Tension lbs. (kN)	Shear lbs. (kN)	Tension lbs. (kN)	Shear lbs. (kN)
3/8 or #3	2,115 (9.4)	1,090 (4.8)	2,735 (12.2)	1,410 (6.3)	4,555 (20.3)	2,345 (10.4)	3,645 (16.2)	1,880 (8.4)	2,210 (9.8)	1,125 (5.0)	2,650 (11.8)	1,500 (6.7)	2,650 (11.8)	1,500 (6.7)	2,650 (11.8)	1,875 (8.3)	2,650 (11.8)	1,875 (8.3)
1/2 or #4	3,760 (16.7)	1,935 (8.6)	4,860 (21.6)	2,505 (11.1)	8,100 (36.0)	4,170 (18.5)	6,480 (28.8)	3,340 (14.9)	3,925 (17.5)	2,005 (8.9)	4,710 (21.0)	2,670 (11.9)	4,710 (21.0)	2,670 (11.9)	4,710 (21.0)	3,335 (14.8)	4,710 (21.0)	3,335 (14.8)
5/8 or #5	5,870 (26.1)	3,025 (13.5)	7,595 (33.8)	3,910 (17.4)	12,655 (56.3)	6,520 (29.0)	10,125 (45.0)	5,215 (23.2)	6,135 (27.3)	3,130 (13.9)	7,365 (32.8)	4,170 (18.5)	7,365 (32.8)	4,170 (18.5)	7,365 (32.8)	5,215 (23.2)	7,365 (32.8)	5,215 (23.2)
3/4 or #6	8,455 (37.6)	4,355 (19.4)	10,935 (48.6)	5,635 (25.1)	18,225 (81.1)	9,390 (41.8)	12,390 (55.1)	6,385 (28.4)	8,835 (39.3)	4,505 (20.0)	10,605 (47.2)	6,010 (26.7)	10,605 (47.2)	6,010 (26.7)	10,605 (47.2)	7,510 (33.4)	10,605 (47.2)	7,510 (33.4)
7/8 or #7	11,510 (51.2)	5,930 (26.4)	14,885 (66.2)	7,665 (34.1)	24,805 (110.3)	12,780 (56.8)	16,865 (75.0)	8,690 (38.7)	-	-	14,430 (64.2)	8,180 (36.4)	14,430 (64.2)	8,180 (36.4)	14,430 (64.2)	10,220 (45.5)	14,430 (64.2)	10,220 (45.5)
1 or #8	15,035 (66.9)	7,745 (34.5)	19,440 (86.5)	10,015 (44.5)	32,400 (144.1)	16,690 (74.2)	22,030 (98.0)	11,350 (50.5)	-	-	18,850 (83.8)	10,680 (47.5)	18,850 (83.8)	10,680 (47.5)	18,850 (83.8)	13,350 (59.4)	18,850 (83.8)	13,350 (59.4)
#9	-	-	-	-	-	-	-	-	-	-	23,985 (106.7)	13,590 (60.5)	23,985 (106.7)	13,590 (60.5)	23,985 (106.7)	16,990 (75.6)	23,985 (106.7)	16,990 (75.6)
1-1/4	23,490 (104.5)	12,100 (53.8)	30,375 (135.1)	15,645 (69.6)	50,620 (225.2)	26,080 (116.0)	34,425 (153.1)	17,735 (78.9)	-	-	-	-	-	-	-	-	-	-
#10	-	-	-	-	-	-	-	-	-	-	30,405 (135.2)	17,230 (76.6)	30,405 (135.2)	17,230 (76.6)	30,405 (135.2)	21,535 (95.8)	30,405 (135.2)	21,535 (95.8)

1. AISI defined steel strength (ASD) for threaded rod: Tensile = 0.33 • Fu • Anom, Shear = 0.17 • Fu • Anom
2. For reinforcing bars: The allowable steel tensile strength is based on 20 ksi for Grade 40 and 24 ksi for Grade 60 and higher, applied to the cross sectional area of the bar; allowable steel shear strength = 0.17 • Fu • Anom
3. Allowable load capacities are calculated for the steel element type. Consideration of applying additional safety factors may be necessary depending on the application, such as life safety or overhead.
4. Allowable steel strength in tension must be checked against allowable bond strength/concrete capacity in tension to determine the controlling allowable load.

In-Service Temperature Chart For Allowable Load Capacities
Concrete Base Materials **Masonry Units**

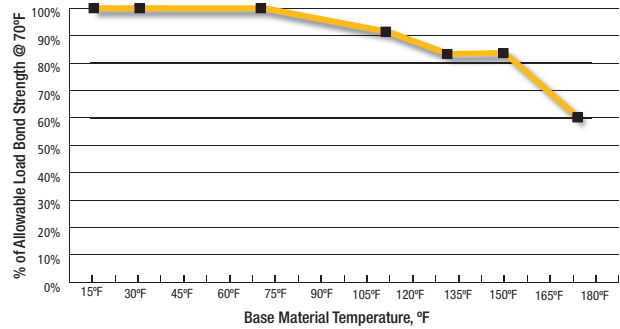
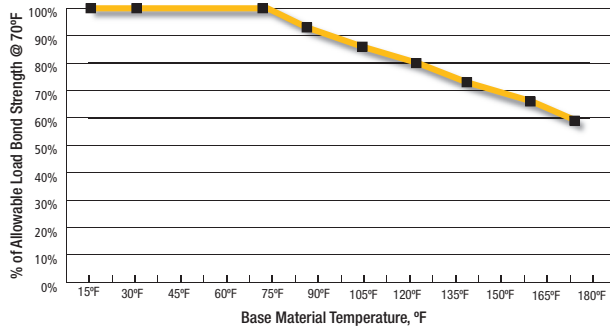



Allowable Load Capacities for Threaded Rod Installed with AC100+ Gold into Grout-Filled Concrete Masonry (Based on Bond Strength/Masonry Strength)^{1,2,3,7,9,12}

Anchor Diameter d inch	Minimum Embedment h _{nom} inch	Critical Spacing Distance s _{cr} inch	Minimum Edge Distance C _{min} inch	Minimum End Distance C _{min} inch	Tension Load lbs	Direction of Shear Loading	Shear Load lbs
Anchor Installed Into Grouted Masonry Wall Faces ^{4,5,6,8,10,11,13}							
3/8	3	6	3	3	615	Towards Edge/End	275
			3	4		Away From Edge/End	340
			12	12	Any	490	
1/2	4	8	3	3	720	Towards Edge/End	430
			4	4		Away From Edge/End	1320
			12	12	Any	655	
			7-3/4 (Bed Joint)	3	960	Towards Edge/End	1430
			7-3/4 (Bed Joint)	3		Away From Edge/End	1760
5/8	5	10	3	3	710	Load To Edge	460
			12	12		Towards Edge/End	460
			7-3/4 (Bed Joint)	3	Away From Edge/End	1410	
			7-3/4 (Bed Joint)	3	Towards Edge/End	1530	
3/4	6	12	4	4	755	Away From Edge/End	1880
			12	12		Load To Edge	590
			7-3/4 (Bed Joint)	4	1160	Towards Edge/End	630
			7-3/4 (Bed Joint)	4		Away From Edge/End	1450
Anchor Installed Into Tops of Grouted Masonry Walls ^{14,15}							
Anchor Diameter d inch	Minimum Embedment h _{nom} inch	Minimum Spacing Distance	Minimum Edge Distance C _{min} inch	Minimum End Distance C _{min} inch	Tension Load lbs	Direction of Shear Loading	Shear Load lbs
1/2	2-3/4	1 anchor per cell	1-3/4	4	595	Any	300
	4			3	520	Load To Edge	190
	10			10-1/2	1670	Load To End	300
5/8	5	1 anchor per cell	1-3/4	3	745	Load To Edge	190
	12-1/2	1 anchor per block		10-1/2	2095	Load To End	300
	6	1 anchor per cell		4	1260	Load To Edge	240
3/4	6	1 anchor per cell	1-3/4	4	1260	Load To End	300
						Load To Edge	410
						Load To End	490

1. Tabulated load values are for anchors installed in nominal 8-inch wide (203 mm) Grade N, Type II, lightweight, medium-weight or normal-weight grout filled concrete masonry units with a minimum masonry strength, f'm, of 1,500 psi (10.3 MPa) conforming to ASTM C90. If the specified compressive strength of the masonry, f'm, is 2,000 psi (13.8 MPa) minimum the tabulated values may be increased by 4 percent (multiplied by 1.04).
2. Allowable bond or masonry strengths in tension and shear are calculated using a safety factor of 5.0 and must be checked against the allowable tension and shear capacities for threaded rod based on steel strength to determine the controlling factor. See allowable load table based on steel strength.
3. Embedment is measured from the outside surface of the concrete masonry unit to the embedded end of the anchor.
4. Anchors may be installed in the grouted cells, cell webs and bed joints not closer than 1-1/2-inch from the vertical mortar joint (head joint) provided the minimum edge and end distances are maintained. Anchors may be placed in the head joint if the vertical joint is mortared full-depth.
5. A maximum of two anchors may be installed in a single masonry cell in accordance with the spacing and edge or end distance requirements.
6. The critical spacing, s_{cr}, for use with the anchor values shown in this table is 16 anchor diameters. The critical spacing, s_{cr}, distance is the distance where the full load values in the table may be used. The minimum spacing distance, s_{min}, is the minimum anchor spacing for which values are available and installation is permitted. For 3/8-inch diameter anchors, the spacing may be reduced to 8 anchor diameters when using a tension reduction factor of 0.70 and a shear reduction factor of 0.45. For 1/2-inch and 5/8-inch diameter anchors, the spacing may be reduced to 8 anchor diameters when using a tension reduction factor of 0.85 and a shear reduction factor of 0.45. For 3/4-inch diameter anchors, the spacing may be reduced to 8 anchor diameters when using a tension reduction factor of 1.00 and a shear reduction factor of 0.45.
7. Spacing distance is measured from the centerline to centerline between two anchors.
8. The minimum edge or end distance, C_{min}, is the minimum distance for which values are available and installation is permitted.
9. Edge or end distance is measured from anchor centerline to the closest unrestrained edge.
10. Linear interpolation of load values between the minimum spacing, s_{min}, and critical spacing, s_{cr}, distances and between minimum edge or end distance, C_{min} is permitted.
11. The tabulated values are applicable for anchors in the ends of grout-filled concrete masonry units where minimum edge and end distances are maintained.
12. The tabulated values must be adjusted for increased in-service base material temperatures in accordance with the In-Service Temperature chart, as applicable.
13. Concrete masonry width (wall thickness) must be equal to or greater than 1.5 times the anchor embedment depth (e.g. 3/8-inch and 1/2-inch diameter anchors are permitted in nominally 6-inch-thick concrete masonry). The 5/8-inch and 3/4-inch diameter anchors must be installed in minimum nominally 8-inch-thick concrete masonry.
14. Anchors must be installed into the grouted cell; anchors are not permitted to be installed in a head joint, flange or web of the concrete masonry unit.
15. Allowable shear loads parallel or perpendicular to the edge of a masonry wall may be applied in or out of plane.

AC100+ Gold Adhesive Anchors Installed into Grouted Concrete Masonry Wall

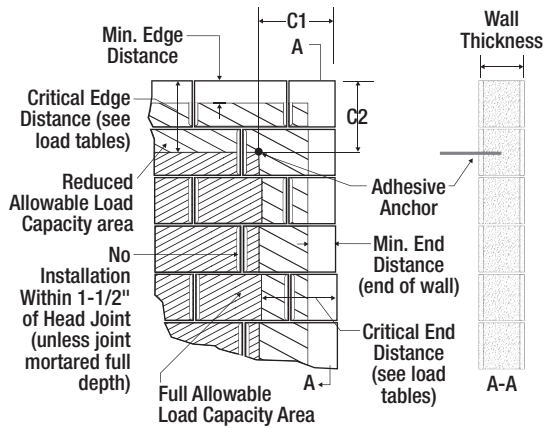

AC100+ Gold Adhesive Anchors Installed into Top of Grouted Concrete Masonry Wall

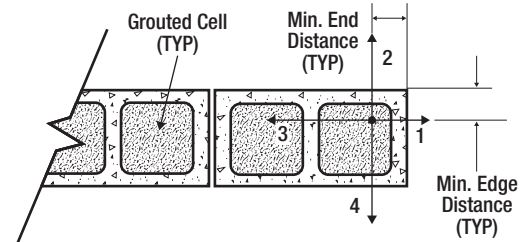

1. Shear load parallel to Edge and perpendicular to End
2. Shear load parallel to End and perpendicular to Edge
3. Shear load parallel to Edge and perpendicular away from End
4. Shear load parallel to End and perpendicular to opposite Edge

AC100+ Gold Adhesive Anchors Installed into Hollow Concrete Masonry Wall

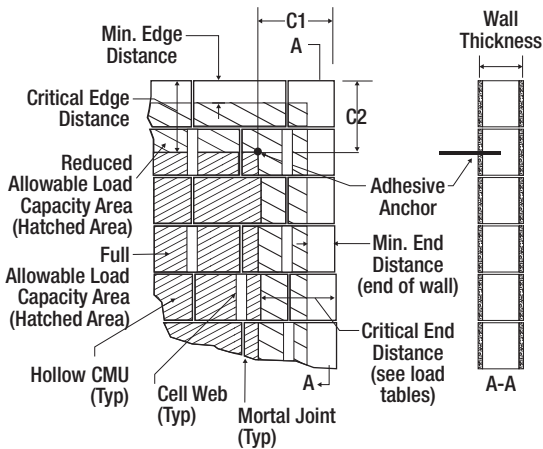

Direction of Shear Loading in Relation to Edge and End of Masonry Wall

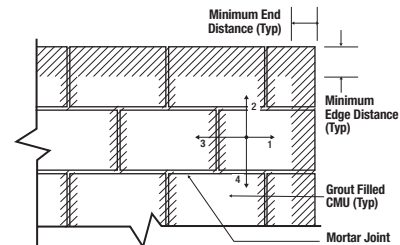

1. Shear load parallel to Edge and perpendicular to End
2. Shear load parallel to End and perpendicular to Edge
3. Shear load parallel to Edge and perpendicular away from End
4. Shear load parallel to End and perpendicular away from Edge



Allowable Load Capacities for Threaded Rod Installed with AC100+ Gold into Hollow Concrete Masonry Walls with Stainless Steel and Plastic Screen Tubes

1,2,3,4,5,6,7,8,9,10,11,12,13

Anchor Diameter d inch	Screen Tube type	Minimum Embedment h _{nom} inch	Critical Spacing Distance S _{cr} inch	Minimum Edge Distance C _{min} inch	Minimum End Distance C _{min} inch	Allowable Load		
						Tension Load lbs	Direction of Shear Loading	Shear Load lbs
1/4	Stainless Steel	1-1/4	4	1-1/2	1-1/2	280	Towards Edge/End	140
							Away From Edge/End	235
3/8	Stainless Steel	1-1/4	6	1-7/8	1-7/8	320	Towards Edge/End	145
							Away From Edge/End	245
	Plastic	1-1/4	1 anchor per cell	3-3/4	3-3/4	400	Towards Edge/End	290
							Away From Edge/End	490
1/2	Stainless Steel	1-1/4	8	3-3/4	3-3/4	380	Towards Edge/End	215
							Away From Edge/End	365
	Plastic	1-1/4	1 anchor per cell	11-1/4	11-1/4	400	Towards Edge/End	430
							Away From Edge/End	730
5/8	Stainless Steel	1-1/4	8	3-3/4	3-3/4	380	Towards Edge/End	215
							Away From Edge/End	365
	Plastic	1-1/4	1 anchor per cell	11-1/4	11-1/4	400	Towards Edge/End	430
							Away From Edge/End	730
3/4	Stainless Steel	1-1/4	8	3-3/4	3-3/4	380	Towards Edge/End	215
							Away From Edge/End	365
	Plastic	1-1/4	1 anchor per cell	11-1/4	11-1/4	400	Towards Edge/End	430
							Away From Edge/End	730

1. Tabulated load values are for anchors installed in hollow concrete masonry with minimum masonry strength, f_m, of 1,500 psi (10.3 MPa). Concrete masonry units must be lightweight, medium-weight or normal-weight conforming to ASTM C90. Allowable loads have been calculated using a safety factor of 5.0.
2. Anchors must be installed into the hollow cell; anchors are not permitted to be installed in a mortar joint, flange or web of the concrete masonry unit.
3. A maximum of two anchor may be installed in a single masonry cell in accordance with the spacing and edge distance requirements, except as noted in the table.
4. Embedment is measured from the outside surface of the concrete masonry unit to the embedded end of the anchor.
5. Edge or end distance is measured from anchor centerline to the closest unrestrained edge of the CMU block.
6. The critical spacing, S_{cr}, for use with the anchor values shown in this table is 16 anchor diameters, except as noted in the table. The critical spacing, S_{cr}, distance is the distance where the full load values in the table may be used. The minimum spacing distance, S_{min}, is the minimum anchor spacing for which values are available and installation is permitted. The spacing may be reduced to 8 anchor diameters by multiplying the tension load value by a reduction factor of 0.60 and multiplying the shear load value by a reduction factor of 0.45.
7. Spacing distance is measured from the centerline to centerline between two anchors.
8. Linear interpolation of load values between the minimum spacing, S_{min}, and critical spacing, S_{cr}, distances and between minimum edge or end distance, C_{min}, is permitted if applicable.
9. Concrete masonry width (wall thickness) may be minimum nominal 6-inch-thick provided the minimum embedment (i.e. face shell thickness) is maintained.
10. The tabulated values are applicable for anchors in the ends of hollow concrete masonry units where minimum face shell thickness, minimum edge and end distances are maintained.
11. Anchors are recognized to resist dead, live and wind loads.
12. Allowable loads must be the lesser of the adjusted masonry or bond values tabulated above and the steel strength values.
13. The tabulated values must be adjusted for increased in-service base material temperatures in accordance with the In-Service Temperature chart, as applicable.

ADHESIVES

AC100+ GOLD®
Vinylester Injection Adhesive Anchoring System

Ultimate and Allowable Load Capacities for AC100+ Gold into Precast Hollow Core Concrete with Threaded Rod and Stainless Steel Screen Tubes^{1,2,3,4,5,6,7}



Anchor Diameter d in.	Drill Bit Diameter d _{bit} in.	Minimum Embedment h _{com} in. (mm)	Minimum End Distance in. (mm)	Minimum Edge Distance in. (mm)	Ultimate Load		Allowable Load	
					Tension lbs. (kN)	Shear lbs. (kN)	Tension lbs. (kN)	Shear lbs. (kN)
1/4	3/8	1-1/2 (38)	4 (102)	4 (102)	900 (4.0)	1,550 (6.9)	180 (0.8)	310 (1.4)
3/8	1/2	1-1/2 (38)	6 (152)	6 (152)	1,975 (8.8)	3,650 (16.2)	395 (1.8)	730 (3.2)
1/2	5/8	1-1/2 (38)	8 (203)	8 (203)	4,400 (19.6)	5,875 (26.1)	880 (3.9)	1,175 (5.2)

1. Tabulated load values are for anchors installed in precast hollow core concrete with minimum strength, f'm, of 5,000 psi (34.5 MPa). Allowable loads have been calculated using a safety factor of 5.0. The allowable load capacities may be increased by a factor of (f'c / 5000)^{0.13} for concrete compressive strength between 5,000 psi and 8000 psi.
2. Anchors must be installed into the hollow core; anchors are not permitted to be installed in a cell web of the hollow core concrete member.
3. Embedment is measured from the outside surface of the concrete to the embedded end of the anchor.
4. Edge or end distance is measured from anchor centerline to the closest unrestrained edge of the concrete member.
5. The tabulated values are for anchors installed at a minimum of 16 anchor diameters on center for 100 percent capacity. Spacing distance is measured from the centerline to centerline between two anchors.
6. Allowable loads must be the lesser of the adjusted masonry or bond values tabulated above and the steel strength values.
7. The tabulated values must be adjusted for increased in-service base material temperatures in accordance with the In-Service Temperature chart, as applicable.

Ultimate and Allowable Load Capacities for Threaded Rod Installed with AC100+ Gold into Brick Masonry Walls^{1,2,3,4}



Anchor Diameter d in.	Drill Diameter d _{bit} in.	Minimum Embedment h _{com} in. (mm)	Minimum End Distance in. (mm)	Minimum Edge Distance in. (mm)	Ultimate Load		Allowable Load	
					Tension lbs. (kN)	Shear lbs. (kN)	Tension lbs. (kN)	Shear lbs. (kN)
Anchors Installed into the Face of Brick Masonry Walls								
3/8	1/2	3-1/2 (89)	2-1/2 (64)	2-1/2 (64)	3,600 (16.0)	4,505 (20.0)	720 (3.2)	900 (4.0)
		3-1/2 (89)	6 (152)	6 (152)	5,845 (26.0)	4,580 (20.4)	1,170 (5.2)	915 (4.1)
		6 (152)	6 (152)	6 (152)	10,420 (46.4)	4,580 (20.4)	2,085 (9.3)	915 (4.1)
1/2	5/8	6 (152)	8 (203)	8 (203)	11,500 (51.2)	9,300 (41.4)	2,300 (10.2)	1,860 (8.3)
5/8	3/4	3-1/8 (79)	9-1/2 (241)	9-1/2 (241)	4,715 (21.0)	7,700 (34.3)	945 (4.2)	1,540 (6.6)
		6 (152)	9-1/2 (241)	9-1/2 (241)	9,925 (44.2)	7,700 (34.3)	1,985 (8.8)	1,540 (6.6)
Anchors Installed into the Top of Brick Masonry Walls								
3/8	1/2	3-1/2 (89)	2-1/2 (64)	2-1/2 (64)	3,665 (16.3)	2,435 (10.8)	735 (3.3)	485 (2.2)

1. Tabulated load values are for anchors installed in minimum 2 wythe, Grade SW, solid clay brick masonry conforming to ASTM C 62. Mortar and minimum mortar strength must meet Type N, S or M.
2. Allowable loads are calculated using an applied safety factor of 5.0. Consideration of safety factors of 10 or higher may be necessary depending on the application, such as life safety.
3. Allowable loads apply to installations in the face of brick or mortar joint. The tabulated values are for anchors installed at a minimum of 16 anchor diameters on center for 100 percent capacity.
4. The tabulated values must be adjusted for increased in-service base material temperatures in accordance with the In-Service Temperature chart, as applicable.

Allowable Load Capacities AC100+ Gold with for Threaded Rods and Reinforcing Bars or Rebar Dowel Installed in Unreinforced Masonry Walls with Stainless Steel Screen Tubes^{1,2} (Retrofit Bolt Anchors in URM Walls with Low Minimum Mortar Strengths)

CODE LISTED
ICC-ES ESR-4105

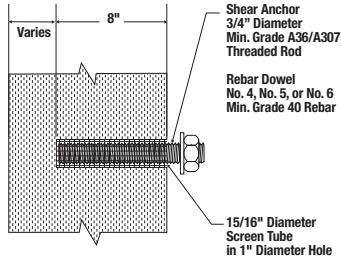

Figure 1

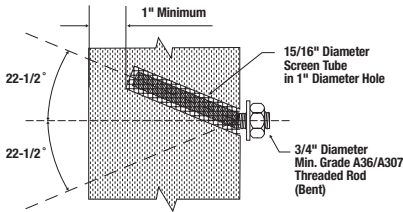

Figure 2

Shear Anchor – Configuration A (See Figure 1)

Rod Dia. or Rebar Size d in.	Minimum Embed. h _{nom} in. (mm)	Minimum Wall Thickness in. (mm)	Allowable Tension lbs. (kN)	Allowable Shear lbs. (kN)
3/4	8 (203)	13 (330)	See note 3	1,000 (4.5)
No. 4	8 (203)	13 (330)	See note 3	500 (2.3)
No. 5	8 (203)	13 (330)	See note 3	750 (3.4)
No. 6	8 (203)	13 (330)	See note 3	1,000 (4.5)

1. Allowable load values are applicable only where in-place shear tests indicate minimum mortar strength of 35 psi net.
2. These retrofit anchors installed in unreinforced brick walls are limited to resisting seismic or wind loads only.
3. Tension loading for these anchors is outside the scope of ICC-ES AC608; see ESR-4105.

22-1/2° Combination Anchor – Configuration B (See Figure 2)

Rod Dia. d in.	Minimum Embed. h _{nom} in. (mm)	Minimum Wall Thickness in. (mm)	Allowable Tension lbs. (kN)	Allowable Shear lbs. (kN)
3/4	Within 1 inch (25mm) of opposite wall surface	13 (330)	1,200 (5.4)	1,000 (4.5)

1. Allowable load values are applicable only where in-place shear tests indicate minimum mortar strength of 35 psi net.
2. These retrofit anchors installed in unreinforced brick walls are limited to resisting seismic or wind loads only.

Retrofit Anchor Description	Minimum Vertical Spacing in.	Minimum Horizontal Spacing in.	Minimum Edge Distance in.
Shear Anchor - Configuration A (See Figure 1)	16	16	16
22-1/2° Combination Anchor - Configuration B (See Figure 2)	16	16	16

STRENGTH DESIGN INFORMATION

Steel Tension and Shear Design for Threaded Rod in Normal Weight Concrete

CODE LISTED
ICC-ES ESR-2582



Design Information		Symbol	Units	Nominal Rod Diameter ¹ (inch)						
				3/8	1/2	5/8	3/4	7/8	1	1-1/4
Threaded rod nominal outside diameter		d_a	inch (mm)	0.375 (9.5)	0.500 (12.7)	0.625 (15.9)	0.750 (19.1)	0.875 (22.2)	1.000 (25.4)	1.250 (31.8)
Threaded rod effective cross-sectional area		A_{se}	inch ² (mm ²)	0.0775 (50)	0.1419 (92)	0.2260 (146)	0.3345 (216)	0.4617 (298)	0.6057 (391)	0.9691 (625)
ASTM A36 and ASTM F1554 Grade 36	Nominal strength as governed by steel strength (for a single anchor)	N_{sa}	lbf (kN)	4,495 (20.0)	8,230 (36.6)	13,110 (58.3)	19,400 (86.3)	26,780 (119.1)	35,130 (156.3)	56,210 (250.0)
		V_{sa}	lbf (kN)	2,695 (12.0)	4,940 (22.0)	7,860 (35.0)	11,640 (51.8)	16,070 (71.4)	21,080 (93.8)	33,725 (150.0)
	Reduction factor for seismic shear	$\alpha_{V,seis}$	-	0.80	0.80	0.80	0.80	0.80	0.80	0.80
	Strength reduction factor for tension ²	ϕ	-	0.75						
	Strength reduction factor for shear ²	ϕ	-	0.65						
ASTM F1554 Grade 55	Nominal strength as governed by steel strength (for a single anchor)	N_{sa}	lbf (kN)	5,810 (25.9)	10,640 (47.3)	16,950 (75.4)	25,085 (111.6)	34,625 (154.0)	45,425 (202.0)	72,680 (323.3)
		V_{sa}	lbf (kN)	3,485 (15.5)	6,385 (28.4)	10,170 (45.2)	15,050 (67.0)	20,775 (92.4)	27,255 (121.2)	43,610 (194.0)
	Reduction factor for seismic shear	$\alpha_{V,seis}$	-	0.80	0.80	0.80	0.80	0.80	0.80	0.80
	Strength reduction factor for tension ²	ϕ	-	0.75						
	Strength reduction factor for shear ²	ϕ	-	0.65						
ASTM A193 Grade B7 and ASTM F1554 Grade 105	Nominal strength as governed by steel strength (for a single anchor)	N_{sa}	lbf (kN)	9,685 (43.1)	17,735 (78.9)	28,250 (125.7)	41,810 (186.0)	57,710 (256.7)	75,710 (336.8)	121,135 (538.8)
		V_{sa}	lbf (kN)	5,815 (25.9)	10,640 (47.3)	16,950 (75.4)	25,085 (111.6)	34,625 (154.0)	45,425 (202.1)	72,680 (323.3)
	Reduction factor for seismic shear	$\alpha_{V,seis}$	-	0.80	0.80	0.80	0.80	0.80	0.80	0.80
	Strength reduction factor for tension ²	ϕ	-	0.75						
	Strength reduction factor for shear ²	ϕ	-	0.65						
ASTM A449	Nominal strength as governed by steel strength (for a single anchor)	N_{sa}	lbf (kN)	9,300 (41.4)	17,025 (75.7)	27,120 (120.6)	40,140 (178.5)	55,905 (248.7)	72,685 (323.3)	101,755 (452.6)
		V_{sa}	lbf (kN)	5,580 (24.8)	10,215 (45.4)	16,270 (72.4)	24,085 (107.1)	33,540 (149.2)	43,610 (194.0)	61,050 (271.6)
	Reduction factor for seismic shear	$\alpha_{V,seis}$	-	0.80	0.80	0.80	0.80	0.80	0.80	0.80
	Strength reduction factor for tension ²	ϕ	-	0.75						
	Strength reduction factor for shear ²	ϕ	-	0.65						
ASTM F593 CW Stainless (Types 304 and 316)	Nominal strength as governed by steel strength (for a single anchor)	N_{sa}	lbf (kN)	7,750 (34.5)	14,190 (63.1)	22,600 (100.5)	28,430 (126.5)	39,245 (174.6)	51,485 (229.0)	82,370 (366.4)
		V_{sa}	lbf (kN)	4,650 (20.7)	8,515 (37.9)	13,560 (60.3)	17,060 (75.9)	23,545 (104.7)	30,890 (137.4)	49,425 (219.8)
	Reduction factor for seismic shear	$\alpha_{V,seis}$	-	0.70	0.70	0.80	0.80	0.80	0.80	0.80
	Strength reduction factor for tension ³	ϕ	-	0.65						
	Strength reduction factor for shear ³	ϕ	-	0.60						
ASTM A193 Grade B8/B8M, Class 1 Stainless (Types 304 and 316)	Nominal strength as governed by steel strength (for a single anchor) ⁴	N_{sa}	lbf (kN)	4,420 (19.7)	8,090 (36.0)	12,880 (57.3)	19,065 (84.8)	26,315 (117.1)	34,525 (153.6)	55,240 (245.7)
		V_{sa}	lbf (kN)	2,650 (11.8)	4,855 (21.6)	7,730 (34.4)	11,440 (50.9)	15,790 (70.2)	20,715 (92.1)	33,145 (147.4)
	Reduction factor for seismic shear	$\alpha_{V,seis}$	-	0.70	0.70	0.80	0.80	0.80	0.80	0.80
	Strength reduction factor for tension ²	ϕ	-	0.75						
	Strength reduction factor for shear ²	ϕ	-	0.65						
ASTM A193 Grade B8/B8M2, Class 2B Stainless (Types 304 and 316)	Nominal strength as governed by steel strength (for a single anchor)	N_{sa}	lbf (kN)	7,365 (32.8)	13,480 (60.0)	21,470 (95.5)	31,775 (141.3)	43,860 (195.1)	57,545 (256.0)	92,065 (409.5)
		V_{sa}	lbf (kN)	4,420 (19.7)	8,085 (36.0)	12,880 (57.3)	19,065 (84.8)	26,315 (117.1)	34,525 (153.6)	55,240 (245.7)
	Reduction factor for seismic shear	$\alpha_{V,seis}$	-	0.70	0.70	0.80	0.80	0.80	0.80	0.80
	Strength reduction factor for tension ²	ϕ	-	0.75						
	Strength reduction factor for shear ²	ϕ	-	0.65						

For SI: 1 inch = 25.4 mm, 1 lbf = 4.448 N. For pound-inch units: 1 mm = 0.03937 inches, 1 N = 0.2248 lbf.

- Values provided for steel element material types are based on minimum specified strengths and calculated in accordance with ACI 318-19 Eq. 17.6.1.2 and Eq. 17.7.1.2(b), ACI 318-14 Eq. 17.4.1.2 and Eq. 17.5.1.2b, as applicable, except where noted. Nuts and washers must be appropriate for the rod. Nuts must have specified proof load stresses equal to or greater than the minimum tensile strength of the specified threaded rod.
- The tabulated value of ϕ applies when the load combinations of Section 1605.2 of the IBC, ACI 318 (-19 or -14) 5.3, as applicable, are used in accordance with ACI 318-19 17.5.3, ACI 318-14 17.3.3, as applicable. If the load combinations of ACI 318-11 Appendix C are used, the appropriate value of ϕ must be determined in accordance with ACI 318 D.4.4. Values correspond to ductile steel elements.
- The tabulated value of ϕ applies when the load combinations of Section 1605.2 of the IBC, ACI 318 (-19 or -14) 5.3, as applicable, are used in accordance with ACI 318-19 17.5.3, ACI 318-14 17.3.3, as applicable. If the load combinations of ACI 318-11 Appendix C are used, the appropriate value of ϕ must be determined in accordance with ACI 318 D.4.4. Values correspond to brittle steel elements.
- In accordance with ACI 318-19 Eq. 17.6.1.2 and Eq. 17.7.1.2(b), ACI 318-14 17.4.1.2 and 17.5.1.2, as applicable, the calculated values for nominal tension and shear strength for ASTM A193 Grade B8/B8M Class 1 stainless steel threaded rods are based on limiting the specified tensile strength of the anchor steel to 1.9 f_y or 57,000 psi (393 MPa).

Steel Tension and Shear Design for Reinforcing Bars in Normal Weight Concrete

CODE LISTED
ICC-ES ESR-2582



Design Information		Symbol	Units	Nominal Reinforcing Bar Size (Rebar) ¹							
				No. 3	No. 4	No. 5	No. 6	No. 7	No. 8	No. 9	No. 10
Rebar nominal outside diameter		d_a	inch (mm)	0.375 (9.5)	0.500 (12.7)	0.625 (15.9)	0.750 (19.1)	0.875 (22.2)	1.000 (25.4)	1.125 (28.7)	1.250 (32.3)
Rebar effective cross-sectional area		A_{se}	inch ² (mm ²)	0.110 (71.0)	0.200 (129.0)	0.310 (200.0)	0.440 (283.9)	0.600 (387.1)	0.790 (509.7)	1.000 (645.2)	1.270 (819.4)
ASTM A615 Grade 75 / Grade 80	Nominal strength as governed by steel strength (for a single anchor)	N_{sa}	lbf (kN)	11,000 (48.9)	20,000 (89.0)	31,000 (137.9)	44,000 (195.7)	60,000 (266.9)	79,000 (351.4)	100,000 (444.8)	127,000 (564.9)
		V_{sa}	lbf (kN)	6,600 (29.4)	12,000 (53.4)	18,600 (82.7)	26,400 (117.4)	36,000 (160.1)	47,400 (210.8)	60,000 (266.9)	76,200 (338.9)
	Reduction factor for seismic shear	$\alpha_{V,seis}$	-	0.70	0.70	0.80	0.80	0.80	0.80	0.80	0.80
	Strength reduction factor for tension ³	ϕ	-	0.65							
	Strength reduction factor for shear ³	ϕ	-	0.60							
ASTM A615 Grade 60	Nominal strength as governed by steel strength (for a single anchor)	N_{sa}	lbf (kN)	8,800 (39.1)	16,000 (71.2)	24,800 (110.3)	35,200 (156.6)	48,000 (213.5)	63,200 (281.1)	80,000 (355.9)	101,600 (451.9)
		V_{sa}	lbf (kN)	5,280 (23.5)	9,600 (42.7)	14,880 (66.2)	21,120 (93.9)	28,800 (128.1)	37,920 (168.7)	48,000 (213.5)	60,960 (271.2)
	Reduction factor for seismic shear	$\alpha_{V,seis}$	-	0.70	0.70	0.80	0.80	0.80	0.80	0.80	0.80
	Strength reduction factor for tension ³	ϕ	-	0.65							
	Strength reduction factor for shear ³	ϕ	-	0.60							
ASTM A706 Grade 60	Nominal strength as governed by steel strength (for a single anchor)	N_{sa}	lbf (kN)	8,800 (39.1)	16,000 (71.2)	24,800 (110.3)	35,200 (156.6)	48,000 (213.5)	63,200 (281.1)	80,000 (355.9)	101,600 (452.0)
		V_{sa}	lbf (kN)	5,280 (23.5)	9,600 (42.7)	14,880 (66.2)	21,120 (94.0)	28,800 (128.1)	37,920 (168.7)	48,000 (213.5)	60,960 (271.2)
	Reduction factor for seismic shear	$\alpha_{V,seis}$	-	0.70	0.70	0.80	0.80	0.80	0.80	0.80	0.80
	Strength reduction factor for tension ²	ϕ	-	0.75							
	Strength reduction factor for shear ²	ϕ	-	0.65							
ASTM A615 Grade 40	Nominal strength as governed by steel strength (for a single anchor)	N_{sa}	lbf (kN)	6,600 (29.4)	12,000 (53.4)	18,600 (82.7)	26,400 (117.4)	In accordance with ASTM A 615, Grade 40 bars are furnished only in sizes No. 3 through No. 6			
		V_{sa}	lbf (kN)	3,960 (17.6)	7,200 (32.0)	11,160 (49.6)	15,840 (70.5)				
	Reduction factor for seismic shear	$\alpha_{V,seis}$	-	0.70	0.70	0.80	0.80				
	Strength reduction factor for tension ³	ϕ	-	0.65							
	Strength reduction factor for shear ³	ϕ	-	0.60							

1. Values provided for reinforcing bar material types based on minimum specified strengths and calculated in accordance with ACI 318-19 Eq. 17.6.1.2 and Eq. 17.7.1.2(b), ACI 318-14 Eq. 17.4.1.2 and Eq. 17.5.1.2b, as applicable.
2. The tabulated value of ϕ applies when the load combinations of Section 1605.2 of the IBC, ACI 318 (-19 or -14) 5.3, as applicable, are used in accordance with ACI 318-19 17.5.3, ACI 318-14 17.3.3, as applicable. Values correspond to ductile steel elements. In accordance with ACI 318-19 17.10.5.3(a)(vi), ACI 318-14 17.2.3.4.3(a)(vi), as applicable, deformed reinforcing bars meeting this specification used as ductile steel elements to resist earthquake effects shall be limited to reinforcing bars satisfying the requirements of ACI 318-19 20.2.2, ACI 318-14 20.2.2.4 and 20.2.2.5, as applicable.
3. The tabulated value of ϕ applies when the load combinations of Section 1605.2 of the IBC, ACI 318 (-19 or -14) 5.3, as applicable, are used in accordance with ACI 318-19 17.5.3, ACI 318-14 17.3.3, as applicable. Values correspond to brittle steel elements.

ADHESIVES
AC100+ GOLD®
Vinylester Injection Adhesive Anchoring System

Concrete Breakout Design Information for Threaded Rod and Reinforcing Bars

CODE LISTED
ICC-ES ESR-2582



Design Information	Symbol	Units	Nominal Rod Diameter (inch) / Reinforcing Bar Size							
			3/8 or #3	1/2 or #4	5/8 or #5	3/4 or #6	7/8 or #7	1 or #8	#9	1-1/4 or #10
Effectiveness factor for cracked concrete	$k_{c,cr}$	- (SI)	Not Applicable		17 (7.1)					
Effectiveness factor for uncracked concrete	$k_{c,uncr}$	- (SI)	24 (10.0)							
Minimum embedment	$h_{ef,min}$	inch (mm)	2-3/8 (60)	2-3/4 (70)	3-1/8 (79)	3-1/2 (89)	3-1/2 (89)	4 (102)	4-1/2 (114)	5 (127)
Maximum embedment	$h_{ef,max}$	inch (mm)	4-1/2 (114)	6 (152)	7-1/2 (191)	9 (229)	10-1/2 (267)	12 (305)	13-1/2 (343)	15 (381)
Minimum anchor spacing	s_{min}	inch (mm)	1-7/8 (48)	2-1/2 (64)	3-1/8 (79)	3-3/4 (95)	4-3/8 (111)	5 (127)	5-5/8 (143)	6-1/4 (159)
Minimum edge distance ²	c_{min}	inch (mm)	5d where d is nominal outside diameter of the anchor							
Minimum edge distance, reduced ² (45% T_{max})	$c_{min,red}$	inch (mm)	1-3/4 (45)	1-3/4 (45)	1-3/4 (45)	1-3/4 (45)	1-3/4 (45)	1-3/4 (45)	2-3/4 (70)	2-3/4 (70)
Minimum member thickness	h_{min}	inch (mm)	$h_{ef} + 1-1/4$ ($h_{ef} + 30$)		$h_{ef} + 2d_o$ where d_o is hole diameter;					
Critical edge distance—splitting (for uncracked concrete only) ³	c_{ac}	inch	$c_{ac} = h_{ef} \cdot \left(\frac{\tau_{uncr}}{1160}\right)^{0.4} \cdot \left[3.1 - 0.7 \frac{h}{h_{ef}}\right]$							
		(mm)	$c_{ac} = h_{ef} \cdot \left(\frac{\tau_{uncr}}{8}\right)^{0.4} \cdot \left[3.1 - 0.7 \frac{h}{h_{ef}}\right]$							
Strength reduction factor for tension, concrete failure modes, Condition B ⁴	ϕ	-	0.65							
Strength reduction factor for shear, concrete failure modes, Condition B ⁴	ϕ	-	0.70							

For SI: 1 inch = 25.4 mm, 1 lbf = 4.448 N. For pound-inch units: 1 mm = 0.03937 inch, 1 N = 0.2248 lbf.

- Additional setting information is described in the installation instructions.
- For installation between the minimum edge distance, c_{min} , and the reduced minimum edge distance, $c_{min,red}$, the maximum torque applied must be reduced (multiplied) by a factor of 0.45.
- τ_{uncr} need not be taken as greater than: $\tau_{k,uncr} = \frac{k_{uncr} \cdot \sqrt{h_{ef} \cdot f'_c}}{\pi \cdot d}$ and $\frac{h}{h_{ef}}$ need not be taken as larger than 2.4.
- Condition A requires supplemental reinforcement, while Condition B applies where supplemental reinforcement is not provided or where pryout governs, as set forth in ACI 318-19 17.5.3, ACI 318-14 17.3.3, as applicable. The tabulated value of ϕ applies when the load combinations of Section 1605.2 of the IBC, ACI 318 (-19 or -14) 5.3, as applicable, are used in accordance with ACI 318-19 17.5.3, ACI 318-14 17.3.3, as applicable.

Bond Strength Design Information for AC100+ Gold with Threaded Rods in Concrete

CODE LISTED
ICC-ES ESR-2582



Design Information	Symbol	Units	Nominal Rod Diameter (Inch) / Reinforcing Bar Size							
			3/8	1/2	5/8	3/4	7/8	1	1-1/4	
Minimum embedment	$h_{ef,min}$	inch (mm)	2-3/8 (60)	2-3/4 (70)	3-1/8 (79)	3-1/2 (89)	3-1/2 (89)	4 (102)	5 (127)	
Maximum embedment	$h_{ef,max}$	inch (mm)	4-1/2 (114)	6 (152)	7-1/2 (191)	9 (229)	10-1/2 (267)	12 (305)	15 (381)	
Temperature Range 110°F (43.3°C) Maximum long-term service temperature; 140°F (60°C) maximum short-term service temperature ³	Characteristic bond strength in cracked concrete ^{4,6}	$\tau_{k,cr}$	psi (N/mm ²)	Not Applicable	545 (3.8)	568 (3.9)	568 (3.9)	568 (3.9)	575 (4.0)	575 (4.0)
	Characteristic bond strength in cracked concrete, short-term loads only ⁶	$\tau_{k,cr}$	psi (N/mm ²)	Not Applicable	779 (5.4)	811 (5.6)	811 (5.6)	811 (5.6)	821 (5.7)	821 (5.7)
	Characteristic bond strength in uncracked concrete ^{4,7}	$\tau_{k,uncr}$	psi (N/mm ²)	902 (6.2)	902 (6.2)	902 (6.2)	902 (6.2)	902 (6.2)	815 (5.6)	645 (4.4)
	Characteristic bond strength in uncracked concrete, short-term loads only ⁷	$\tau_{k,uncr}$	psi (N/mm ²)	1,288 (8.9)	1,288 (8.9)	1,288 (8.9)	1,288 (8.9)	1,288 (8.9)	Not applicable in water-filled hole installation condition	
Temperature Range 122°F (50°C) Maximum Long-Term Service Temperature; 176°F (80°C) Maximum Short-Term Service Temperature ^{3,4}	Characteristic bond strength in cracked concrete ^{4,6}	$\tau_{k,cr}$	psi (N/mm ²)	Not Applicable	498 (3.4)	519 (3.6)	519 (3.6)	519 (3.6)	519 (3.6)	525 (3.6)
	Characteristic bond strength in cracked concrete, short-term loads only ⁶	$\tau_{k,cr}$	psi (N/mm ²)	Not Applicable	712 (4.9)	742 (5.1)	742 (5.1)	742 (5.1)	742 (5.1)	751 (5.2)
	Characteristic bond strength in uncracked concrete ^{4,7}	$\tau_{k,uncr}$	psi (N/mm ²)	823 (5.7)	823 (5.7)	823 (5.7)	823 (5.7)	823 (5.7)	743 (5.1)	588 (4.1)
	Characteristic bond strength in uncracked concrete, short-term loads only ⁷	$\tau_{k,uncr}$	psi (N/mm ²)	1,177 (8.1)	1,177 (8.1)	1,177 (8.1)	1,177 (8.1)	1,177 (8.1)	Not applicable in water-filled hole installation condition	
Temperature Range 162°F (72°C) Maximum Long-Term Service Temperature; 248°F (120°C) Maximum Short-Term Service Temperature ^{3,4}	Characteristic bond strength in cracked concrete ^{4,6}	$\tau_{k,cr}$	psi (N/mm ²)	Not Applicable	245 (1.7)	255 (1.8)	255 (1.8)	255 (1.8)	255 (1.8)	255 (1.8)
	Characteristic bond strength in cracked concrete, short-term loads only ⁶	$\tau_{k,cr}$	psi (N/mm ²)	Not Applicable	544 (3.7)	566 (3.9)	566 (3.9)	566 (3.9)	566 (3.9)	566 (3.9)
	Characteristic bond strength in uncracked concrete ^{4,7}	$\tau_{k,uncr}$	psi (N/mm ²)	405 (2.8)	405 (2.8)	405 (2.8)	405 (2.8)	405 (2.8)	366 (2.5)	Not Applicable
	Characteristic bond strength in uncracked concrete, short-term loads only ⁷	$\tau_{k,uncr}$	psi (N/mm ²)	899 (6.2)	899 (6.2)	899 (6.2)	899 (6.2)	899 (6.2)	899 (6.2)	813 (5.6)
Permissible installation conditions ⁶	Dry concrete	Anchor Category	-	1						
		ϕ_b	-	1					2	
	Water-saturated concrete	Anchor Category	-	0.65					0.55	
		ϕ_{ws}	-	0.55						
	Water-filled hole (flooded)	Anchor Category	-	3						
		ϕ_{wf}	-	0.45						
K_{wf}		-	0.78			0.70		0.69	0.67	
Reduction factor for seismic tension			$C_{N,seis}$	0.95						

For SI: 1 inch = 25.4 mm, 1 psi = 0.006894 MPa. For pound-inch units: 1 mm = 0.03937 inch, 1 MPa = 145.0 psi.

- Bond strength values correspond to a normal-weight concrete compressive strength $f'_c = 2,500$ psi (17.2 MPa). For concrete compressive strength, f'_c between 2,500 psi and 8,000 psi (17.2 MPa and 55.2 MPa), the tabulated characteristic bond strength may be increased by a factor of $(f'_c / 2,500)^{0.13}$ [For SI: $(f'_c / 17.2)^{0.13}$].
- The modification factor for bond strength of adhesive anchors in lightweight concrete shall be taken as given in ACI 318-19 17.2.4.1, ACI 318-14 17.2.6 where applicable.
- Long-term and short-term temperatures meet the requirements of Section 8.5 of ACI 355.4 and Table 9.1, Temperature Category A.
- Short-term base material service temperatures are those that occur over brief intervals, e.g. as a result of diurnal cycling. Long-term base material service temperatures are roughly constant over significant periods of time.
- Characteristic bond strengths are for sustained loads including dead and live loads. Characteristic bond strengths are also applicable to short-term loading. For load combinations consisting of short-term loads only such as wind and seismic, bond strengths may be increased by 43 percent for Temperature Range A and 122 percent for Temperature Range B.
- Permissible installation conditions include dry concrete, water-saturated concrete and water-filled holes. Water-filled holes include applications in dry or water-saturated concrete where the drilled holes contain standing water at the time of anchor installation.
- For structures assigned to Seismic Design Categories C, D, E or F, the tabulated bond strength values for cracked concrete must be adjusted by an additional reduction factor, $C_{N,seis}$, as given in this table.
- Bond strength values for uncracked concrete are applicable for structures assigned to Seismic Design Categories A and B only.

Bond Strength Design Information for AC100+ Gold with Reinforcing Bars in Concrete

CODE LISTED
ICC-ES ESR-2582



Design Information		Symbol	Units	Nominal Rod Diameter (Inch) / Reinforcing Bar Size							
				#3	#4	#5	#6	#7	#8	#9	#10
Minimum embedment		$h_{ef,min}$	inch (mm)	2-3/8 (60)	2-3/4 (70)	3-1/8 (79)	3-1/2 (89)	3-1/2 (89)	4 (102)	4-1/2 (114)	5 (127)
Maximum embedment		$h_{ef,max}$	inch (mm)	4-1/2 (114)	6 (152)	7-1/2 (191)	9 (229)	10-1/2 (267)	12 (305)	13-1/2 (343)	15 (381)
Temperature Range 110°F (43.3°C) Maximum long-term service temperature; 140°F (60°C) maximum short-term service temperature ³	Characteristic bond strength in cracked concrete ^{4,6}	$\tau_{k,cr}$	psi (N/mm ²)	Not Applicable	361 (2.5)	376 (2.6)	376 (2.6)	376 (2.6)	381 (2.6)	381 (2.6)	381 (2.6)
	Characteristic bond strength in cracked concrete, short-term loads only ⁶	$\tau_{k,cr}$	psi (N/mm ²)	Not Applicable	516 (3.6)	538 (3.7)	538 (3.7)	538 (3.7)	544 (3.8)	544 (3.8)	544 (3.8)
	Characteristic bond strength in uncracked concrete ^{4,7}	$\tau_{k,uncr}$	psi (N/mm ²)	902 (6.2)	902 (6.2)	902 (6.2)	902 (6.2)	902 (6.2)	815 (5.6)	732 (5.0)	645 (4.4)
	Characteristic bond strength in uncracked concrete, short-term loads only ⁷	$\tau_{k,uncr}$	psi (N/mm ²)	1,288 (8.9)	1,288 (8.9)	1,288 (8.9)	1,288 (8.9)	1,288 (8.9)	1,164 (8.0)	1,046 (7.2)	921 (6.4)
Temperature Range 122°F (50°C) Maximum Long-Term Service Temperature; 176°F (80°C) Maximum Short-Term Service Temperature ^{3,4}	Characteristic bond strength in cracked concrete ^{4,6}	$\tau_{k,cr}$	psi (N/mm ²)	Not Applicable	331 (2.3)	345 (2.4)	345 (2.4)	345 (2.4)	345 (2.4)	349 (2.4)	349 (2.4)
	Characteristic bond strength in cracked concrete, short-term loads only ⁶	$\tau_{k,cr}$	psi (N/mm ²)	Not Applicable	473 (3.3)	493 (3.4)	493 (3.4)	493 (3.4)	493 (3.4)	499 (3.4)	499 (3.4)
	Characteristic bond strength in uncracked concrete ^{4,7}	$\tau_{k,uncr}$	psi (N/mm ²)	823 (5.7)	823 (5.7)	823 (5.7)	823 (5.7)	823 (5.7)	743 (5.1)	655 (4.5)	588 (4.1)
	Characteristic bond strength in uncracked concrete, short-term loads only ⁷	$\tau_{k,uncr}$	psi (N/mm ²)	1,117 (8.1)	1,117 (8.1)	1,117 (8.1)	1,117 (8.1)	1,117 (8.1)	1,062 (7.3)	951 (6.6)	841 (5.8)
Temperature Range 162°F (72°C) Maximum Long-Term Service Temperature; 248°F (120°C) Maximum Short-Term Service Temperature ^{3,4}	Characteristic bond strength in cracked concrete ^{4,6}	$\tau_{k,cr}$	psi (N/mm ²)	Not Applicable	163 (1.1)	170 (1.2)	170 (1.2)	170 (1.2)	170 (1.2)	170 (1.2)	170 (1.2)
	Characteristic bond strength in cracked concrete, short-term loads only ⁶	$\tau_{k,cr}$	psi (N/mm ²)	Not Applicable	362 (2.5)	377 (2.6)	377 (2.6)	377 (2.6)	377 (2.6)	382 (2.6)	382 (2.6)
	Characteristic bond strength in uncracked concrete ^{4,7}	$\tau_{k,uncr}$	psi (N/mm ²)	405 (2.8)	405 (2.8)	405 (2.8)	405 (2.8)	405 (2.8)	366 (2.5)	329 (2.3)	Not Applicable
	Characteristic bond strength in uncracked concrete, short-term loads only ⁷	$\tau_{k,uncr}$	psi (N/mm ²)	899 (6.2)	899 (6.2)	899 (6.2)	899 (6.2)	899 (6.2)	899 (6.2)	813 (5.6)	730 (5.0)
Permissible installation conditions ⁶	Dry concrete	Anchor Category	-	1							
		ϕ_i	-	0.65							
	Water-saturated concrete	Anchor Category	-	1			2				
		ϕ_{ws}	-	0.65			0.55				
	Water-filled hole (flooded)	Anchor Category	-	3							
		ϕ_{wf}	-	0.45							
	K_{wf}	-	0.78			0.70	0.69	0.68	0.67		
Reduction factor for seismic tension		$\alpha_{N,seis}$	-	1.0							

For Sl: 1 inch = 25.4 mm, 1 psi = 0.006894 MPa. For pound-inch units: 1 mm = 0.03937 inch, 1 MPa = 145.0 psi.

- Bond strength values correspond to a normal-weight concrete compressive strength $f'_c = 2,500$ psi (17.2 MPa). For concrete compressive strength, f'_c between 2,500 psi and 8,000 psi (17.2 MPa and 55.2 MPa), the tabulated characteristic bond strength may be increased by a factor of $(f'_c / 2,500)^{0.13}$ [For Sl: $(f'_c / 17.2)^{0.13}$].
- The modification factor for bond strength of adhesive anchors in lightweight concrete shall be taken as given in ACI 318-19 17.2.4.1, ACI 318-14 17.2.6 where applicable.
- Long-term and short-term temperatures meet the requirements of Section 8.5 of ACI 355.4 and Table 9.1, Temperature Category A.
- Short-term base material service temperatures are those that occur over brief intervals, e.g. as a result of diurnal cycling. Long-term base material service temperatures are roughly constant over significant periods of time.
- Characteristic bond strengths are for sustained loads including dead and live loads. Characteristic bond strengths are also applicable to short-term loading. For load combinations consisting of short-term loads only such as wind and seismic, bond strengths may be increased by 43 percent for Temperature Range A and 122 percent for Temperature Range B.
- Permissible installation conditions include dry concrete, water-saturated concrete and water-filled holes. Water-filled holes include applications in dry or water-saturated concrete where the drilled holes contain standing water at the time of anchor installation.
- For structures assigned to Seismic Design Categories C, D, E or F, the tabulated bond strength values for cracked concrete must be adjusted by an additional reduction factor, $\alpha_{N,seis}$, as given in this table.
- Bond strength values for uncracked concrete are applicable for structures assigned to Seismic Design Categories A and B only.



DESIGN STRENGTH TABLES (SD)

Tension and Shear Design Strength for Threaded Rod and Reinforcing Bar Installed in Uncracked Concrete (Bond or Concrete Strength) Drilled with a Hammer-Drill and Carbide Bit in a Dry Hole Condition
110°F (43.3°C) Maximum Long-Term Service Temperature;
140°F (60°C) Maximum Short-Term Service Temperature^{1,2,3,4,5,6,7,8,9,10,11}

Nominal Rod/Rebar Size (in. or #)	Embed. Depth h _{ef} (in.)	Minimum Concrete Compressive Strength									
		f' _c = 2,500 (psi)		f' _c = 3,000 (psi)		f' _c = 4,000 (psi)		f' _c = 6,000 (psi)		f' _c = 8,000 (psi)	
		ϕN_{cb} or ϕN_a Tension (lbs.)	ϕN_{cb} or ϕV_{cp} Shear (lbs.)	ϕN_{cb} or ϕN_a Tension (lbs.)	ϕV_{cb} or ϕV_{cp} Shear (lbs.)	ϕN_{cb} or ϕN_a Tension (lbs.)	ϕV_{cb} or ϕV_{cp} Shear (lbs.)	ϕN_{cb} or ϕN_a Tension (lbs.)	ϕV_{cb} or ϕV_{cp} Shear (lbs.)	ϕN_{cb} or ϕN_a Tension (lbs.)	ϕV_{cb} or ϕV_{cp} Shear (lbs.)
3/8 or #3	2-3/8	1,640	1,765	1,680	1,810	1,745	1,880	1,840	1,980	1,910	2,055
	3	2,070	3,065	2,120	3,390	2,205	3,975	2,320	4,970	2,410	5,190
	4-1/2	3,110	5,595	3,185	6,185	3,305	7,115	3,485	7,500	3,615	7,785
1/2 or #4	2-3/4	2,535	2,885	2,595	3,190	2,690	3,740	2,840	4,675	2,945	5,480
	4	3,685	5,425	3,770	6,000	3,915	7,035	4,130	8,800	4,285	9,230
	6	5,525	9,885	5,660	10,930	5,875	12,650	6,190	13,335	6,430	13,845
5/8 or #5	3-1/8	3,595	3,830	3,685	4,235	3,825	4,965	4,030	6,210	4,185	7,280
	5	5,755	8,455	5,895	9,350	6,120	10,960	6,450	13,710	6,695	14,420
	7-1/2	8,635	15,405	8,840	17,035	9,180	19,770	9,675	20,840	10,045	21,630
3/4 or #6	3-1/2	4,665	4,905	4,765	5,425	4,935	6,360	5,180	7,955	5,360	9,325
	6	8,290	11,940	8,485	13,205	8,810	15,480	9,290	19,365	9,640	20,765
	9	12,435	21,750	12,730	24,055	13,215	28,195	13,930	30,005	14,460	31,150
7/8 or #7	3-1/2	4,640	4,930	4,830	5,605	5,045	6,650	5,300	8,320	5,490	9,750
	7	11,280	15,045	11,550	16,635	11,995	19,500	12,640	24,390	13,125	28,265
	10-1/2	16,925	27,400	17,330	30,300	17,990	35,515	18,960	40,840	19,685	42,400
1 or #8	4	5,575	6,115	5,805	6,935	6,010	8,130	6,315	10,170	6,535	11,920
	8	13,315	17,645	13,635	19,510	14,155	22,870	14,920	28,605	15,485	33,360
	12	19,970	32,135	20,450	35,535	21,230	41,650	22,380	48,200	23,230	50,035
#9	4.5	6,400	7,110	6,570	7,915	6,800	9,275	7,145	11,605	7,395	13,600
	9	15,135	20,200	15,500	22,340	16,090	26,185	16,960	32,750	17,605	37,920
	13.5	22,700	36,795	23,245	40,690	24,130	47,695	25,440	54,790	26,410	56,880
1-1/4	5	7,160	7,985	7,320	8,830	7,580	10,350	7,960	12,950	8,240	15,175
	10	16,465	22,445	16,860	24,820	17,500	29,090	18,450	36,390	19,150	41,250
	15	24,695	40,875	25,290	45,205	26,250	52,985	27,675	59,605	28,725	61,875
#10	5	7,075	7,975	7,230	8,815	7,485	10,335	7,865	12,925	8,140	15,150
	10	16,465	22,485	16,860	24,865	17,500	29,140	18,450	36,450	19,150	41,250
	15	24,695	40,950	25,290	45,285	26,250	53,080	27,675	59,605	28,725	61,875

■ - Concrete Breakout Strength ■ - Bond Strength/Pryout Strength

- Tabular values are provided for illustration and are applicable for single anchors installed in uncracked normal-weight concrete with minimum slab thickness, h_a = h_{min}, and with the following conditions:
 - C_{a1} is greater than or equal to the critical edge distance, c_{ac}
 - C_{a2} is greater than or equal to 1.5 times C_{a1}.
- Calculations were performed according to ACI 318 (-19 or -14), Ch.17 and ICC-ES AC308. The load level corresponding to the failure mode listed [Concrete breakout strength, bond strength/ pryout strength] must be checked against the tabulated steel strength of the corresponding threaded rod or rebar size and type, the lowest load level controls.
- Strength reduction factors (φ) for concrete breakout strength are based on ACI 318 (-19 or -14) 5.3 for load combinations. Condition B was assumed.
- Strength reduction factors (φ) for bond strength are determined from reliability testing and qualification in accordance with ICC-ES AC308 and are tabulated in this product information and in ESR-2582.
- Tabular values are permitted for static loads only, seismic loading is not considered with these tables. Periodic special inspection must be performed where required by code, see ESR-2582 for applicable information.
- For anchors subjected to tension resulting from sustained loading a supplemental check must be performed according to ACI 318 -19 17.5.2.2, ACI 318-14 17.3.1.2.
- For designs that include combined tension and shear, the interaction of tension and shear loads must be calculated in accordance with ACI 318 (-19 or -14), Ch.17.
- Interpolation is not permitted to be used with the tabular values. For intermediate base material compressive strengths, please see ACI 318 (-19 or -14), Ch.17, ICC-ES AC308 and information included in this product supplement. For other design conditions including seismic considerations please see ACI 318 (-19 or -14), Ch.17 and ICC-ES AC308 and ESR-2582.
- Long term concrete temperatures are roughly constant over significant periods of time. Short-term elevated temperatures are those that occur over brief intervals, e.g. as a result of diurnal cycling.
- The tabulated design strengths may be converted to allowable stress design values. Divide by conversion factor calculated as a weighted average of the load factors for the controlling load combination.
- For other installation conditions such as water-saturated concrete or water-filled hole applications, see the associated strength reduction factors (φ) for bond strength in the determination of controlling design strength values, as applicable.

ADHESIVES

AC100+ GOLD®
Vinylester Injection Adhesive Anchoring System

TECHNICAL GUIDE – ADHESIVES ©2025 DEWALT – REV. K



**Tension and Shear Design Strength for Threaded Rod Installed in Cracked Concrete (Bond or Concrete Strength)
Drilled with a Hammer-Drill and Carbide Bit in a Dry Hole Condition
110°F (43.3°C) Maximum Long-Term Service Temperature;
140°F (60°C) Maximum Short-Term Service Temperature^{1,2,3,4,5,6,7,8,9,10,11,12}**

Nominal Rod/Rebar Size (in.)	Embed. Depth h_{ef} (in.)	Minimum Concrete Compressive Strength									
		$f'_c = 2,500$ (psi)		$f'_c = 3,000$ (psi)		$f'_c = 4,000$ (psi)		$f'_c = 6,000$ (psi)		$f'_c = 8,000$ (psi)	
		ϕN_{cb} or ϕN_s Tension (lbs.)	ϕV_{cb} or ϕV_{cp} Shear (lbs.)	ϕN_{cb} or ϕN_s Tension (lbs.)	ϕV_{cb} or ϕV_{cp} Shear (lbs.)	ϕN_{cb} or ϕN_s Tension (lbs.)	ϕV_{cb} or ϕV_{cp} Shear (lbs.)	ϕN_{cb} or ϕN_s Tension (lbs.)	ϕV_{cb} or ϕV_{cp} Shear (lbs.)	ϕN_{cb} or ϕN_s Tension (lbs.)	ϕV_{cb} or ϕV_{cp} Shear (lbs.)
1/2	2-3/4	1,530	2,060	1,565	2,280	1,625	2,670	1,715	3,340	1,780	3,835
	4	2,225	3,875	2,280	4,285	2,365	5,025	2,495	5,370	2,590	5,575
	6	3,340	7,060	3,420	7,365	3,550	7,645	3,740	8,060	3,885	8,365
5/8	3-1/8	2,265	2,735	2,320	3,025	2,410	3,545	2,540	4,435	2,635	5,200
	5	3,625	6,040	3,710	6,680	3,855	7,830	4,060	8,750	4,215	9,080
	7-1/2	5,435	11,000	5,565	11,990	5,780	12,450	6,090	13,120	6,325	13,620
3/4	3-1/2	2,935	3,505	3,000	3,875	3,105	4,545	3,260	5,680	3,375	6,660
	6	5,220	8,530	5,345	9,435	5,550	11,055	5,850	12,595	6,070	13,075
	9	7,830	15,535	8,015	17,180	8,320	17,925	8,775	18,895	9,105	19,615
7/8	3-1/2	2,920	3,525	3,040	4,000	3,180	4,750	3,335	5,945	3,455	6,965
	7	7,105	10,745	7,275	11,885	7,550	13,930	7,960	17,145	8,265	17,800
	10-1/2	10,655	19,570	10,910	21,640	11,330	24,400	11,940	25,720	12,395	26,700
1	4	3,935	4,365	4,095	4,955	4,240	5,810	4,455	7,265	4,610	8,515
	8	9,395	12,600	9,620	13,935	9,985	16,335	10,525	20,430	10,925	23,535
	12	14,090	22,950	14,430	25,380	14,980	29,750	15,790	34,005	16,390	35,300
1-1/4	5	6,175	5,705	6,525	6,310	6,760	7,395	7,095	9,250	7,350	10,840
	10	14,675	16,030	15,030	17,730	15,600	20,780	16,445	25,990	17,075	30,465
	15	22,015	29,195	22,545	32,290	23,405	37,845	24,670	47,340	25,610	55,160

■ - Concrete Breakout Strength □ - Bond Strength/Pryout Strength

- Tabular values are provided for illustration and are applicable for single anchors installed in cracked normal-weight concrete with minimum slab thickness, $h_a = h_{min}$, and with the following conditions:
 - c_{a1} is greater than or equal to the critical edge distance, c_{ac}
 - c_{a2} is greater than or equal to 1.5 times c_{a1} .
- Calculations were performed according to ACI 318 (-19 or -14) Ch.17 and ICC-ES AC308. The load level corresponding to the failure mode listed [Concrete breakout strength, bond strength/pryout strength] must be checked against the tabulated steel strength of the corresponding threaded rod or rebar size and type, the lowest load level controls.
- Strength reduction factors (ϕ) for concrete breakout strength are based on ACI 318 (-19 or -14) Section 5.3 for load combinations. Condition B was assumed.
- Strength reduction factors (ϕ) for bond strength are determined from reliability testing and qualification in accordance with ICC-ES AC308 and are tabulated in this product information and in ESR-2582.
- Tabular values are permitted for static loads only, seismic loading is not considered with these tables. Periodic special inspection must be performed where required by code, see ESR-2582 for applicable information.
- For anchors subjected to tension resulting from sustained loading a supplemental check must be performed according to ACI 318 -19 17.5.2.2, ACI 318-14 17.3.1.2.
- For designs that include combined tension and shear, the interaction of tension and shear loads must be calculated in accordance with ACI 318 (-19 or -14) Ch.17.
- Interpolation is not permitted to be used with the tabular values. For intermediate base material compressive strengths, please see ACI 318 (-19 or -14) Ch.17, ICC-ES AC308 and information included in this product supplement. For other design conditions including seismic considerations please see ACI 318 (-19 or -14) Ch.17 and ICC-ES AC308 and ESR-2582.
- Long term concrete temperatures are roughly constant over significant periods of time. Short-term elevated temperatures are those that occur over brief intervals, e.g. as a result of diurnal cycling.
- The tabulated design strengths may be converted to allowable stress design values. Divide by conversion factor calculated as a weighted average of the load factors for the controlling load combination.
- For seismic design of anchors installed in regions designated as Seismic Design Categories C, D, E or F and in accordance with ACI 318, the tabulated tension design strengths in cracked concrete for concrete breakout and bond strength must be multiplied by a factor of 0.75. In the determination of the tension design strength values in cracked concrete, the bond strength requires an additional reduction factor applied for seismic tension ($\alpha_{s,seis}$), where seismic design is applicable.
- For other installation conditions such as water-saturated concrete or water-filled hole applications, see the associated strength reduction factors (ϕ) for bond strength in the determination of controlling design strength values, as applicable.

ADHESIVES

AC100+ GOLD[®]
Vinylester Injection Adhesive Anchoring System



**Tension and Shear Design Strength for Reinforcing Bar Installed in Cracked Concrete (Bond or Concrete Strength)
Drilled with a Hammer-Drill and Carbide Bit in a Dry Hole Condition
110°F (43.3°C) Maximum Long-Term Service Temperature;
140°F (60°C) Maximum Short-Term Service Temperature^{1,2,3,4,5,6,7,8,9,10,11,12}**

Nominal Rod/Rebar Size (#)	Embed. Depth h _{ef} (in.)	Minimum Concrete Compressive Strength									
		f'c = 2,500 (psi)		f'c = 3,000 (psi)		f'c = 4,000 (psi)		f'c = 6,000 (psi)		f'c = 8,000 (psi)	
		ϕN_{cb} or ϕN_a Tension (lbs.)	ϕV_{cb} or ϕV_{cp} Shear (lbs.)	ϕN_{cb} or ϕN_a Tension (lbs.)	ϕV_{cb} or ϕV_{cp} Shear (lbs.)	ϕN_{cb} or ϕN_a Tension (lbs.)	ϕV_{cb} or ϕV_{cp} Shear (lbs.)	ϕN_{cb} or ϕN_a Tension (lbs.)	ϕV_{cb} or ϕV_{cp} Shear (lbs.)	ϕN_{cb} or ϕN_a Tension (lbs.)	ϕV_{cb} or ϕV_{cp} Shear (lbs.)
#4	2-3/4	1,015	2,060	1,040	2,235	1,075	2,320	1,135	2,445	1,180	2,540
	4	1,475	3,175	1,510	3,250	1,565	3,375	1,650	3,560	1,715	3,695
	6	2,210	4,765	2,265	4,880	2,350	5,065	2,480	5,335	2,575	5,540
#5	3-1/8	1,500	2,735	1,535	3,025	1,595	3,435	1,680	3,620	1,745	3,755
	5	2,400	5,170	2,455	5,290	2,550	5,495	2,690	5,790	2,790	6,010
	7-1/2	3,600	7,750	3,685	7,940	3,825	8,240	4,035	8,685	4,185	9,015
#6	3-1/2	1,945	3,505	1,985	3,875	2,055	4,430	2,160	4,650	2,235	4,815
	6	3,455	7,440	3,540	7,620	3,675	7,910	3,870	8,340	4,020	8,655
	9	5,185	11,165	5,305	11,430	5,510	11,865	5,805	12,510	6,030	12,985
#7	3-1/2	1,935	3,525	2,015	4,000	2,105	4,530	2,210	4,760	2,290	4,925
	7	4,705	10,130	4,815	10,370	5,000	10,765	5,270	11,350	5,470	11,785
	10-1/2	7,055	15,195	7,225	15,560	7,500	16,150	7,905	17,025	8,205	17,675
#8	4	2,605	4,365	2,715	4,955	2,810	5,810	2,950	6,355	3,055	6,580
	8	6,225	12,600	6,375	13,725	6,615	14,250	6,975	15,020	7,240	15,595
	12	9,335	20,110	9,560	20,590	9,925	21,375	10,460	22,535	10,860	23,390
#9	4.5	3,330	5,080	3,420	5,655	3,540	6,625	3,720	8,010	3,850	8,295
	9	7,875	14,430	8,065	15,955	8,375	18,035	8,825	19,010	9,165	19,735
	13.5	11,815	25,450	12,100	26,060	12,560	27,055	13,240	28,520	13,745	29,605
#10	5	4,180	5,695	4,270	6,300	4,420	7,380	4,645	9,235	4,810	10,355
	10	9,725	16,060	9,960	17,760	10,340	20,815	10,895	23,470	11,315	24,365
	15	14,590	29,250	14,940	32,175	15,505	33,400	16,345	35,205	16,970	36,550

■ - Concrete Breakout Strength ■ - Bond Strength/Pryout Strength

- Tabular values are provided for illustration and are applicable for single anchors installed in cracked normal-weight concrete with minimum slab thickness, $h_a = h_{min}$, and with the following conditions:
 - C_{a1} is greater than or equal to the critical edge distance, C_{ac}
 - C_{a2} is greater than or equal to 1.5 times C_{a1} .
- Calculations were performed according to ACI 318 (-19 or -14) Ch.17 and ICC-ES AC308. The load level corresponding to the failure mode listed [Concrete breakout strength, bond strength/pryout strength] must be checked against the tabulated steel strength of the corresponding threaded rod or rebar size and type, the lowest load level controls.
- Strength reduction factors (ϕ) for concrete breakout strength are based on ACI 318 (-19 or -14) Section 5.3 for load combinations. Condition B was assumed.
- Strength reduction factors (ϕ) for bond strength are determined from reliability testing and qualification in accordance with ICC-ES AC308 and are tabulated in this product information and in ESR-2582.
- Tabular values are permitted for static loads only, seismic loading is not considered with these tables. Periodic special inspection must be performed where required by code, see ESR-2582 for applicable information.
- For anchors subjected to tension resulting from sustained loading a supplemental check must be performed according to ACI 318 -19 17.5.2.2, ACI 318-14 17.3.1.2.
- For designs that include combined tension and shear, the interaction of tension and shear loads must be calculated in accordance with ACI 318 (-19 or -14) Ch.17.
- Interpolation is not permitted to be used with the tabular values. For intermediate base material compressive strengths, please see ACI 318 (-19 or -14) Ch.17, ICC-ES AC308 and information included in this product supplement. For other design conditions including seismic considerations please see ACI 318 (-19 or -14) Ch.17 and ICC-ES AC308 and ESR-2582.
- Long term concrete temperatures are roughly constant over significant periods of time. Short-term elevated temperatures are those that occur over brief intervals, e.g. as a result of diurnal cycling.
- The tabulated design strengths may be converted to allowable stress design values. Divide by conversion factor calculated as a weighted average of the load factors for the controlling load combination.
- For seismic design of anchors installed in regions designated as Seismic Design Categories C, D, E or F and in accordance with ACI 318, the tabulated tension design strengths in cracked concrete for concrete breakout and bond strength must be multiplied by a factor of 0.75. In the determination of the tension design strength values in cracked concrete, the bond strength requires an additional reduction factor applied for seismic tension ($\phi_{s,seis}$), where seismic design is applicable.
- For other installation conditions such as water-saturated concrete or water-filled hole applications, see the associated strength reduction factors (ϕ) for bond strength in the determination of controlling design strength values, as applicable.

ADHESIVES
AC100+ GOLD®
Vinylester Injection Adhesive Anchoring System

TECHNICAL GUIDE – ADHESIVES ©2025 DEWALT – REV. K



Tension Design of Steel Elements (Steel Strength)^{1,2}

Steel Elements - Threaded Rod and Reinforcing Bar										
Nominal Rod/Rebar Size (in. or No.)	ASTM A36 and ASTM F1554 Grade 36	ASTM F1554 Grade 55	ASTM A193 Grade B7 and ASTM F1554 Grade 105	ASTM F593 CW Stainless (Types 304 and 316)	ASTM A193 Grade B8/ B8M, Class 1 Stainless (Types 304 and 316)	ASTM A193 Grade B8/ B8M2, Class 2B Stainless (Types 304 and 316)	ASTM A615 Grade 75 / Grade 80 Rebar	ASTM A615 Grade 60 Rebar	ASTM A706 Grade 60 Rebar	ASTM A615 Grade 40 Rebar
	ϕN_{sa} Tension (lbs.)	ϕN_{sa} Tension (lbs.)	ϕN_{sa} Tension (lbs.)	ϕN_{sa} Tension (lbs.)	ϕN_{sa} Tension (lbs.)	ϕN_{sa} Tension (lbs.)	ϕN_{sa} Tension (lbs.)	ϕN_{sa} Tension (lbs.)	ϕN_{sa} Tension (lbs.)	ϕN_{sa} Tension (lbs.)
3/8 or #3	3,370	4,360	7,265	5,040	3,315	5,525	7,150	5,720	6,600	4,290
1/2 or #4	6,175	7,980	13,300	9,225	6,070	10,110	13,000	10,400	12,000	7,800
5/8 or #5	9,835	12,715	21,190	14,690	9,660	16,105	20,150	16,120	18,600	12,090
3/4 or #6	14,550	18,815	31,360	18,480	14,300	23,830	28,600	22,880	26,400	17,160
7/8 or #7	20,085	25,970	43,285	25,510	19,735	32,895	39,000	31,200	36,000	-
1 or #8	26,350	34,070	56,785	33,465	25,895	43,160	51,350	41,080	47,400	-
#9	-	-	-	-	-	-	65,000	52,000	60,000	-
1-1/4 or #10	42,160	54,510	90,850	53,540	41,430	69,050	82,550	66,040	76,200	-

■ - Steel Strength

1. Steel tensile design strength according to ACI 318 (-19 or -14) Ch.17 or ACI 318 Appendix D, $\phi N_{sa} = \phi \cdot A_{se,N} \cdot f_{uta}$.
2. The tabulated steel design strength in tension must be checked against the bond strength/concrete capacity design strength to determine the controlling failure mode, the lowest load level controls.

Shear Design of Steel Elements (Steel Strength)^{1,2,3}

Steel Elements - Threaded Rod and Reinforcing Bar										
Nominal Rod/Rebar Size (in. or No.)	ASTM A36 and ASTM F1554 Grade 36	ASTM F1554 Grade 55	ASTM A193 Grade B7 and ASTM F1554 Grade 105	ASTM F593 CW Stainless (Types 304 and 316)	ASTM A193 Grade B8/ B8M, Class 1 Stainless (Types 304 and 316)	ASTM A193 Grade B8/ B8M2, Class 2B Stainless (Types 304 and 316)	ASTM A615 Grade 75 Rebar	ASTM A615 Grade 60 Rebar	ASTM A706 Grade 60 Rebar	ASTM A615 Grade 40 Rebar
	ϕV_{sa} Shear (lbs.)	ϕV_{sa} Shear (lbs.)	ϕV_{sa} Shear (lbs.)	ϕV_{sa} Shear (lbs.)	ϕV_{sa} Shear (lbs.)	ϕV_{sa} Shear (lbs.)	ϕV_{sa} Shear (lbs.)	ϕV_{sa} Shear (lbs.)	ϕV_{sa} Shear (lbs.)	ϕV_{sa} Shear (lbs.)
3/8 or #3	1,755	2,265	3,775	2,790	1,725	2,870	3,960	3,170	3,430	2,375
1/2 or #4	3,210	4,150	6,915	5,110	3,155	5,255	7,200	5,760	6,240	4,320
5/8 or #5	5,115	6,610	11,020	8,135	5,025	8,375	11,160	8,930	9,670	6,695
3/4 or #6	7,565	9,785	16,305	10,235	7,435	12,390	15,840	12,670	13,730	9,505
7/8 or #7	10,445	13,505	22,505	14,130	10,265	17,105	21,600	17,280	18,720	-
1 or #8	13,700	17,715	29,525	18,535	13,465	22,445	28,440	22,750	24,650	-
#9	-	-	-	-	-	-	36,000	28,800	31,200	-
1-1/4 or #10	21,920	28,345	47,240	29,655	21,545	35,905	45,720	36,575	39,625	-

■ - Steel Strength

1. Steel shear design strength according to ACI 318 (-19 or -14) Ch.17 or ACI 318 Appendix D, $\phi V_{sa} = \phi \cdot 0.60 \cdot A_{se,V} \cdot f_{uta}$.
2. The tabulated steel design strength in shear must be checked against the bond strength/concrete capacity design strength to determine the controlling failure mode, the lowest load level controls.
3. In the determination of the shear design strength values in cracked concrete, the steel strength requires an additional reduction factor applied for seismic shear (α_{seis}), where seismic design is applicable.

ADHESIVES

AC100+ GOLD
Vinylester Injection Adhesive Anchoring System



AC100+ Gold Adhesive Anchor Installation Specifications for Threaded Rods and Reinforcing Bars in Grouted Masonry²

Installation Information	Symbol	Units	Nominal Rod Diameter (Inch) / Rebar Size (No.)								
			3/8	#3	1/2	#4	5/8	#5	3/4	#6	
Drill Bit Diameter (ANSI)	d_o	inch	7/16		9/16	5/8		11/16	3/4		7/8
Minimum Embedment Depth	$h_{ef,min}$	in. (mm)	2-3/8 (60)		2-3/4 (70)		3-1/8 (79)		3-1/2 (89)		
Maximum Embedment Depth ¹	$h_{ef,max}$	in. (mm)	7-1/2 (191)		10 (254)		10-3/8 (264)		10-3/8 (264)		
Minimum Masonry Thickness ¹	h_{min}	in. (mm)	7-5/8 (194)								
Minimum Edge Distance	C_{min}	in. (mm)	2-1/4 (57)		3 (76)		3-3/4 (95)		4-1/2 (114)		
Minimum Anchor Spacing			2-1/4 (57)		3 (76)		3-3/4 (95)		4-1/2 (114)		
Minimum Edge Distance	$C_{min,tow}$	in. (mm)	Not Applicable		1-3/4 (45)	1-3/4 (45)	2 (51)	2-1/4 (57)	2-1/4 (57)	2-3/4 (70)	
Minimum Anchor Spacing			Not Applicable		8 (203)		8 (203)		8 (203)		
Minimum End Distance			Not Applicable		3 (76)	3-3/4 (95)		4-1/2 (114)			
Maximum Tightening Torque	T_{max} (T_{inst})	ft.-lbs. (N-m)	10 (14)		25 (34)		50 (68)		90 (122)		
Maximum Tightening Torque, Class 1 SS Rod ³			5 (7)		20 (27)		40 (54)		60 (81)		

For St: 1 inch = 25.4 mm, 1 ft-lb = 1.356 N-m.

1. Maximum embedment for installation into the face of 7-5/8" CMU wall (8-inch nominal) is 6-3/8"; maximum embedment for installation into the face of 9-5/8" CMU wall (10-inch nominal) is 8-3/8"; maximum embedment for installation into the face of 11-5/8" CMU wall (12-inch nominal) is 10-3/8".
2. The minimum distance from the center of an anchor to the centerline of a hollow head joint (vertical mortar joint) is 2" unless solid head joints are present.
3. These torque values apply to ASTM A193 Grade B8/B8M (Class 1) stainless steel threaded rods.

AC100+ Gold Adhesive Anchor Installation Specifications for Threaded Rods with Stainless Steel Screen Tubes in UngROUTED (Hollow) Masonry



Installation Information	Symbol	Units	Nominal Rod Diameter (Inch) / Rebar Size (No.)				
			1/4	3/8	1/2	5/8	3/4
Drill Bit Diameter (ANSI)	d_o	inch	3/8	1/2	5/8	3/4	7/8
Minimum Embedment Depth	$h_{ef,min}$	in. (mm)	2 (51)	2 (51)	2 (51)	2 (51)	2 (51)
Minimum Masonry Thickness	h_{min}	in. (mm)	7-5/8 (194)				
Critical Edge Distance, Tension	$C_{cr,N}$	in. (mm)	4 (102)				
Minimum Edge Distance, Tension			2 (51)				
Load Multiplier at Minimum Edge Distance ¹			0.80				
Critical Edge Distance, Shear			3 (76)	4-1/2 (114)	6 (152)	7-1/2 (191)	9 (229)
Minimum Edge Distance, Shear			1-1/2 (38)	2-1/4 (57)	3 (76)	3-3/4 (95)	4-1/2 (114)
Load Multiplier at Minimum Edge Distance ¹			0.80				
Minimum Anchor Spacing ²			8 (203)				
Maximum Tightening Torque			T_{max} (T_{inst})	ft.-lbs. (N-m)	2 (3)	5 (7)	12 (16)
Maximum Tool Impact Power (Hammer-Drill) ³	-	J	3.0		3.5		

For St: 1 inch = 25.4 mm, 1 ft-lb = 1.356 N-m.

1. The load multiplier at critical edge distance is 1.0. Load multiplier for edge distances between critical edge distance and minimum edge distance may be determined by linear interpolation.
2. Minimum anchor spacing is equal to critical anchor spacing; load multiplier at minimum spacing distance is 1.0.
3. A hammer-drill may be used to drill holes in ungrouted (hollow) masonry walls provided the maximum tool impact power is not exceeded.

Masonry Breakout and Shear Crushing Design Information for Threaded Rods and Reinforcing Bars in Fully Grouted CMU

CODE LISTED
ICC-ES ESR-3200



Design Information	Symbol	Units	Nominal Rod Diameter (Inch) / Rebar Size (No.)			
			3/8" or #3	1/2" or #4	5/8" or #5	3/4" or #6
Nominal Diameter	d_a	inch	0.375	0.500	0.625	0.750
Minimum Embedment Depth	$h_{ef,min}$	inch (mm)	2-3/8 (60)	2-3/4 (70)	3-1/8 (79)	3-1/2 (89)
Effectiveness Factor for Cracked Masonry	$k_{m,cr}$	-	12			
Effectiveness Factor for Uncracked Masonry	$k_{m,uncr}$	-	17			
Strength Reduction Factor, Masonry Breakout in Tension ¹	ϕ	-	0.65			
Strength Reduction Factor, Masonry Breakout in Shear ¹	ϕ	-	0.70			
Strength Reduction Factor, Shear Crushing ¹	ϕ	-	0.50			

For SI: 1 inch = 25.4 mm, 1 ft-lb = 1.356 Nm.

Bond Strength Design Information for AC100+ Gold with Fractional Threaded Rods in Fully Grouted CMU¹

CODE LISTED
ICC-ES ESR-3200



Design Information	Symbol	Units	Nominal Rod Diameter (Inch)				
			3/8"	1/2"	5/8"	3/4"	
Minimum embedment	$h_{ef,min}$	inch (mm)	2-3/8 (60)	2-3/4 (70)	3-1/8 (79)	3-1/2 (89)	
Maximum embedment	$h_{ef,max}$	inch (mm)	7-1/2 (191)	10 (254)	10-3/8 (264)	10-3/8 (264)	
Anchors Installed in Face of Masonry Wall							
110°F (43.3°C) Maximum long-term service temperature; 140°F (60°C) Maximum short-term service temperature ²	Characteristic bond strength in tension cracked masonry ^{3,7}	$\tau_{k,cr}$	psi (N/mm ²)	125 (0.9)	150 (1.0)	155 (1.1)	120 (0.8)
	Characteristic bond strength in tension cracked masonry, short-term loads only ⁷			190 (1.3)	225 (1.6)	235 (1.6)	180 (1.2)
	Characteristic bond strength in tension uncracked masonry ^{3,6}	$\tau_{k,uncr}$	psi (N/mm ²)	350 (2.4)	325 (2.2)	295 (2.0)	265 (1.8)
	Characteristic bond strength in tension uncracked masonry, short-term loads only ⁶			530 (3.7)	495 (3.4)	450 (3.1)	405 (2.8)
Anchors Installed in the Top of Masonry Wall							
110°F (43.3°C) Maximum long-term service temperature; 140°F (60°C) Maximum short-term service temperature ²	Characteristic bond strength in tension cracked masonry ^{3,7}	$\tau_{k,cr}$	psi (N/mm ²)	Not Applicable	60 (0.4)	70 (0.5)	80 (0.6)
	Characteristic bond strength in tension cracked masonry, short-term loads only ⁷			Not Applicable	90 (0.6)	105 (0.7)	120 (0.8)
	Characteristic bond strength in tension uncracked masonry ^{3,6}	$\tau_{k,uncr}$	psi (N/mm ²)	Not Applicable	130 (0.9)	135 (0.9)	175 (1.2)
	Characteristic bond strength in tension uncracked masonry, short-term loads only ⁶			Not Applicable	195 (1.3)	205 (1.4)	265 (1.8)
Permissible installation conditions ⁵	Dry masonry	Anchor Category	-	1			
		Strength reduction factor ⁴	ϕ_a	-	0.65		
	Water-saturated masonry	Anchor Category	-	2			
		Strength reduction factor ⁴	ϕ_a	-	0.55	0.55	0.55
	Modification factor for water-saturated masonry	ϕ_{ws}	-	0.50	0.65	0.90	1
Reduction factor for seismic tension ⁷		$\alpha_{N,seis}$	-	1.0			

For SI: 1 inch = 25.4 mm, 1 psi = 0.006894 MPa. For pound-inch units: 1 mm = 0.03937 inch, 1 MPa = 145.0 psi.
See Table Notes Below.



Bond Strength Design Information for AC100+ Gold with Common Reinforcing Bars in Fully Grouted CMU¹

Design Information		Symbol	Units	Nominal Rebar Size (No.)				
				#3	#4	#5	#6	
Minimum embedment		$h_{ef,min}$	inch (mm)	2-3/8 (60)	2-3/4 (70)	3-1/8 (79)	3-1/2 (89)	
Maximum embedment		$h_{ef,max}$	inch (mm)	7-1/2 (191)	10 (254)	10-3/8 (264)	10-3/8 (264)	
Anchors Installed in Face of Masonry Wall								
110°F (43.3°C) Maximum long-term service temperature; 140°F (60°C) Maximum short-term service temperature ²	Characteristic bond strength in tension cracked masonry ^{3,7}		$\tau_{k,cr}$	psi (N/mm ²)	120 (0.8)	135 (0.9)	170 (1.2)	140 (1.0)
	Characteristic bond strength in tension cracked masonry, short-term loads only ⁷				185 (1.3)	205 (1.4)	255 (1.8)	215 (1.5)
	Characteristic bond strength in tension uncracked masonry ^{3,6}		$\tau_{k,uncr}$	psi (N/mm ²)	345 (2.4)	315 (2.2)	290 (2.0)	260 (1.8)
	Characteristic bond strength in tension uncracked masonry, short-term loads only ⁶				520 (3.6)	480 (3.3)	440 (3.0)	395 (2.7)
Anchors Installed in The Top of Masonry Wall								
110°F (43.3°C) Maximum long-term service temperature; 140°F (60°C) Maximum short-term service temperature ²	Characteristic bond strength in tension cracked masonry ^{3,7}		$\tau_{k,cr}$	psi (N/mm ²)	Not applicable	55 (0.4)	100 (0.7)	95 (0.7)
	Characteristic bond strength in tension cracked masonry, short-term loads only ⁷					85 (0.6)	150 (1.0)	145 (1.0)
	Characteristic bond strength in tension uncracked masonry ^{3,6}		$\tau_{k,uncr}$	psi (N/mm ²)	Not applicable	130 (0.9)	170 (1.2)	175 (1.2)
	Characteristic bond strength in tension uncracked masonry, short-term loads only ⁶					195 (1.3)	255 (1.8)	265 (1.8)
Permissible installation conditions ⁵	Dry masonry	Anchor Category	-	-	1			
		Strength reduction factor ⁴	ϕ_d	-	0.65			
	Water-saturated masonry	Anchor Category	--	-	2			
		Strength reduction factor ⁴	ϕ_{ws}	-	0.55	0.55	0.55	0.55
		Modification factor for water-saturated masonry	ϕ_{ws}	-	0.50	0.65	0.90	1.0
Reduction factor for seismic tension ⁷		$C_{N,seis}$			1.0			

For SI: 1 inch = 25.4 mm, 1 psi = 0.006894 MPa. For pound-inch units: 1 mm = 0.03937 inch, 1 MPa = 145.0 psi.

- Bond strength values correspond to a minimum masonry concrete compressive strength $f'_m = 1,500$ psi.
- Short-term elevated masonry temperatures are those that occur over brief intervals, e.g. as a result of diurnal cycling. Long-term masonry temperatures are roughly constant over significant periods of time. The maximum short-term service temperature may be increased to 176°F (80°C) provided characteristic bond strengths are reduced by 4 percent.
- Characteristic bond strength values are for sustained loads, including dead and live loads.
- The strength reduction factors, ϕ , apply when the LRFD load combinations of IBC Section 1605.1 are used.
- Permissible installation conditions include dry masonry and water-saturated masonry.
- Bond strength values for uncracked masonry are applicable for structures assigned to Seismic Design Categories A and B only.
- For structures assigned to Seismic Design Categories C, D, E or F, bond strength values for cracked masonry do not require an additional reduction factor applied for seismic tension ($C_{N,seis} = 1.0$), where seismic design is applicable



Anchorage Strength Design Information for AC100+ Gold with Fractional Threaded Rods in UngROUTED CMU'

Design Information		Symbol	Units	Nominal Rod Diameter (inch)				
				1/4	3/8	1/2	5/8	3/4
Minimum embedment		$h_{ef,min}$	inch (mm)	2 (51)	2 (51)	2 (51)	2 (51)	2 (51)
110°F (43.3°C) Maximum long-term service temperature; 140°F (60°C) Maximum short-term service temperature ²	Characteristic anchor strength in tension cracked masonry ^{3,7}	$N_{k,cr}$	lbf (kN)	70 (0.3)	115 (0.5)	110 (0.5)	85 (0.4)	85 (0.4)
	Characteristic anchor strength in tension cracked masonry, short-term loads only ⁷			180 (0.8)	295 (1.3)	280 (1.2)	220 (1.0)	220 (1.0)
	Characteristic anchor strength in tension uncracked masonry ^{3,5}	$N_{k,uncr}$	lbf (kN)	140 (0.6)	230 (1.0)	215 (1.0)	175 (0.8)	175 (0.8)
	Characteristic anchor strength in tension uncracked masonry, short-term loads only ⁶			360 (1.6)	590 (2.6)	555 (2.5)	445 (2.0)	445 (2.0)
	Characteristic anchor strength in shear cracked masonry ^{3,7}	$V_{k,cr}$	lbf (kN)	180 (0.8)	295 (1.3)	280 (1.2)	220 (1.0)	220 (1.0)
	Characteristic anchor strength in shear uncracked masonry ^{3,5}	$V_{k,uncr}$	lbf (kN)	360 (1.6)	590 (2.6)	555 (2.5)	445 (2.0)	445 (2.0)
Permissible installation conditions ⁵	Dry masonry	Anchor Category	-	1				
		Strength reduction factor ⁴	ϕ_t	0.65				
	Water-saturated masonry	Anchor Category	-	1	2	2	2	2
		Strength reduction factor ⁴	ϕ_{ws}	0.65	0.55	0.55	0.55	0.55
	Modification factor for water-saturated masonry	ϕ_{ws}	1.0	0.50	0.65	0.90	1.0	
Reduction factor for seismic tension ⁷		$\alpha_{N,seis}$	-	1.0				
Reduction factor for seismic shear ⁷		$\alpha_{V,seis}$	-	0.75				

For SI: 1 inch = 25.4 mm, 1 psi = 0.006894 MPa. For pound-inch units: 1 mm = 0.03937 inch, 1 MPa = 145.0 psi.

- Strength values correspond to ungrouted units with a minimum net masonry concrete compressive strength $f'_m = 1,500$ psi.
- Short-term elevated masonry temperatures are those that occur over brief intervals, e.g. as a result of diurnal cycling. Long-term masonry temperatures are roughly constant over significant periods of time. The maximum short-term service temperature may be increased to 176°F (80°C) provided characteristic bond strengths are reduced by 37 percent.
- Characteristic strength values are for sustained loads, including dead and live loads.
- The strength reduction factors, ϕ , apply when the LRFD load combinations of IBC Section 1605.1 are used.
- Permissible installation conditions include dry masonry and water-saturated masonry.
- Strength values for uncracked masonry are applicable for structures assigned to Seismic Design Categories A and B only.
- For structures assigned to Seismic Design Categories C, D, E or F, strength values for cracked masonry do not require a reduction factor applied for seismic tension ($\alpha_{N,seis} = 1.0$); For seismic shear a reduction factor $\alpha_{V,seis} = 0.75$ must be applied to strength values for cracked masonry where seismic design is applicable.

ADHESIVES

AC100+ GOLD®
Vinylester Injection Adhesive Anchoring System



Tension and Shear Design Strength for Threaded Rod in Cracked and Uncracked Fully Grouted CMU Walls (Bond or Masonry Strength)
Drilled with a Hammer-Drill and Carbide Bit in a Dry Hole Condition, 110°F (43°C) Maximum Long-Term Service Temperature; 140°F (60°C) Maximum Short-Term Service Temperature^{1,2,3,4,5,6,7,8,9,10}

Nominal Rod Size (in.)	Embed. Depth h_{ef} (in.)	Uncracked Masonry		Nominal Rod Size (in.)	Embed. Depth h_{ef} (in.)	Cracked Masonry	
		Fully Grouted Masonry Compressive Strength				Fully Grouted Masonry Compressive Strength	
		$f'_m = 2,000$ psi				$f'_m = 2,000$ psi	
		ϕN_{mb} or ϕN_{ma} Tension (lbs.)	ϕV_{mb} , ϕV_{ms} or ϕV_{mp} Shear (lbs.)			ϕN_{mb} or ϕN_{ma} Tension (lbs.)	ϕV_{mb} , ϕV_{ms} or ϕV_{mp} Shear (lbs.)
3/8	2-1/2	670	1,445	3/8	2-1/2	240	515
	3	805	1,730		3	285	620
	4-1/2	1,205	2,600		4-1/2	430	930
	6-3/8	1,710	3,085		6-3/8	610	1,315
1/2	2-3/4	915	1,965	1/2	2-3/4	420	905
	4	1,325	2,860		4	615	1,320
	6-3/8	2,115	3,590		6-3/8	975	2,105
5/8	3-1/8	1,175	2,535	5/8	3-1/8	620	1,330
	5	1,885	4,035		5	990	2,130
	6-3/8	2,400	4,035		6-3/8	1,260	2,715
3/4	3-1/2	1,420	3,060	3/4	3-1/2	645	1,385
	4-3/4	1,930	4,150		4-3/4	875	1,880
	6-3/8	2,585	4,450		6-3/8	1,170	2,525

Tension and Shear Design Strength for Reinforcing Bar in Cracked and Uncracked Fully Grouted CMU Walls (Bond or Masonry Strength)
Drilled with a Hammer-Drill and Carbide Bit in a Dry Hole Condition, 110°F (43°C) Maximum Long-Term Service Temperature; 140°F (60°C) Maximum Short-Term Service Temperature^{1,2,3,4,5,6,7,8,9,10}

Nominal Rebar Size (#)	Embed. Depth h_{ef} (in.)	Uncracked Masonry		Nominal Rebar Size (#)	Embed. Depth h_{ef} (in.)	Cracked Masonry	
		Fully Grouted Masonry Compressive Strength				Fully Grouted Masonry Compressive Strength	
		$f'_m = 2,000$ psi				$f'_m = 2,000$ psi	
		ϕN_{mb} or ϕN_{ma} Tension (lbs.)	ϕV_{mb} , ϕV_{ms} or ϕV_{mp} Shear (lbs.)			ϕN_{mb} or ϕN_{ma} Tension (lbs.)	ϕV_{mb} , ϕV_{ms} or ϕV_{mp} Shear (lbs.)
#3	2-1/2	660	1,425	#3	2-1/2	230	495
	3	795	1,705		3	275	595
	4-1/2	1,190	2,560		4-1/2	415	890
	6-3/8	1,685	3,085		6-3/8	585	1,260
#4	2-3/4	885	1,905	#4	2-3/4	380	815
	4	1,285	2,770		4	550	1,190
	6-3/8	2,050	3,590		6-3/8	880	1,895
#5	3-1/8	1,155	2,490	#5	3-1/8	680	1,460
	5	1,850	3,985		5	1,085	2,335
	6-3/8	2,360	4,035		6-3/8	1,385	2,980
#6	3-1/2	1,395	3,000	#6	3-1/2	750	1,615
	4-3/4	1,890	4,075		4-3/4	1,020	2,195
	6-3/8	2,540	4,450		6-3/8	1,365	2,945

■ - Bond ■ - Crushing

- Tabular values are provided for illustration and are applicable for single anchors installed in grout filled closed-end CMU conforming to ASTM C90 with a minimum masonry concrete compressive strength $f'_m = 1,500$ psi and with minimum nominal size of the CMU of 8 inches wide by 8 inches high by 16 inches long. Grout must comply with IBC Section R606.2.12, grout must have a minimum compressive strength of not less than 2,000 psi. Mortar must be Type M, S, or N prepared in accordance with IBC Section 2103.2.1 or IRC Section R606.2.8. The following conditions:
 - $ca1 \geq 1.5$ times the nominal embedment depth
 - $ca2 \geq 1.5ca1$.
- Calculations were performed according to ACI 318 (-19 or -14), Ch.17 and ICC-ES AC58. The load level corresponding to the failure mode listed [Masonry Breakout strength, Bond strength, Pryout strength and Crushing strength] must be checked against the tabulated steel strength of the corresponding threaded rod size and type, the lowest load level controls.
- Strength reduction factors (ϕ) are based on ICC-ES AC58 (2024) and are tabulated in this product information and in ESR-3200.
- Tabular values are permitted for static loads only, seismic loading is not considered with these tables. Special inspection must be performed where required by code, see ESR-3200 for applicable information.
- For anchors subjected to tension resulting from sustained loading a supplemental check must be performed according to ACI 318-19 17.5.2.2, ACI 318-14 17.3.1.2.
- For designs that include combined tension and shear, the interaction of tension and shear loads must be calculated in accordance with ACI 318 (-19 or -14), Ch.17.
- Interpolation is not permitted to be used with the tabular values.
- Long term concrete temperatures are roughly constant over significant periods of time. Short-term elevated temperatures are those that occur over brief intervals, e.g. as a result of diurnal cycling.
- The tabulated design strengths may be converted to allowable stress design values. Divide by conversion factor calculated as a weighted average of the load factors for the controlling load combination.
- For other installation conditions such as water-saturated masonry applications, see the associated strength reduction factors (ϕ) for bond strength in the determination of controlling design strength values, as applicable.



Tension and Shear Design Strength for Threaded Rod Installed in Cracked and Uncracked UngROUTED CMU Walls (Pullout/Anchorage or Crushing Strength) Drilled with a Hammer-Drill and Carbide Bit in a Dry Hole Condition, 110°F (43°C) Maximum Long-Term Service Temperature; 140°F (60°C) Maximum Short-Term Service Temperature^{1,2,3,4,5,6,7,8,9,10}

Nominal Rod Size (in.)	Embed. Depth h_{ef} (in.)	Uncracked Masonry		Nominal Rod Size (in.)	Embed. Depth h_{ef} (in.)	Cracked Masonry	
		UngROUTED Masonry Compressive Strength				UngROUTED Masonry Compressive Strength	
		$f'_m = 1,500$ psi				$f'_m = 1,500$ psi	
		$\Phi_{N_{k,ug}}$ Tension (lbs.)	$\Phi_{V_{s,ug}}$ or $\Phi_{V_{mc,ug}}$ Shear (lbs.)			$\Phi_{N_{k,ug}}$ Tension (lbs.)	$\Phi_{V_{s,ug}}$ or $\Phi_{V_{mc,ug}}$ Shear (lbs.)
1/4	2	90	250	1/4	2	45	125
3/8	2	150	415	3/8	2	75	205
1/2	2	140	390	1/2	2	70	195
5/8	2	115	310	5/8	2	55	155
3/4	2	115	310	3/4	2	55	155

■ - Pullout Strength / Anchorage Strength ■ - Crushing Strength

- Tabular values are provided for illustration and are applicable for single anchors installed in ungrouted closed-end CMU conforming to ASTM C90 with a minimum masonry concrete compressive strength $f'_m = 1,500$ psi and with minimum nominal size of the CMU of 8 inches wide by 8 inches high by 16 inches long. Mortar must be Type M, S, or N prepared in accordance with IBC Section 2103.2.1 or IRC Section R606.2.8. The following conditions:
 - Edge distance is greater than or equal to the critical edge distance, $C_{cr,ug}$
- Calculations were performed according to ACI 318 (-19 or -14), Ch.17 and ICC-ES AC58. The load level corresponding to the failure mode listed [Pullout strength, Anchorage strength and Crushing strength] must be checked against the tabulated steel strength of the corresponding threaded rod size and type, the lowest load level controls.
- Strength reduction factors (ϕ) are based on ICC-ES AC58 (2024) and are tabulated in this product information and in ESR-3200.
- Tabular values are permitted for static loads only, seismic loading is not considered with these tables. Special inspection must be performed where required by code, see ESR-3200 for applicable information.
- For anchors subjected to tension resulting from sustained loading a supplemental check must be performed according to ACI 318-19 17.5.2.2, ACI 318-14 17.3.1.2.
- For designs that include combined tension and shear, the interaction of tension and shear loads must be calculated in accordance with ACI 318 (-19 or -14), Ch.17.
- Interpolation is not permitted to be used with the tabular values.
- Long term concrete temperatures are roughly constant over significant periods of time. Short-term elevated temperatures are those that occur over brief intervals, e.g. as a result of diurnal cycling.
- The tabulated design strengths may be converted to allowable stress design values. Divide by conversion factor calculated as a weighted average of the load factors for the controlling load combination.
- For other installation conditions such as water-saturated masonry applications, see the associated strength reduction factors (ϕ) for bond strength in the determination of controlling design strength values, as applicable.



Tension Design of Steel Elements (Steel Strength)

Steel Elements - Threaded Rod and Reinforcing Bar											
Nominal Rod/Rebar Size (in. or No.)	ASTM A36 and ASTM F1554 Grade 36	ASTM F1554 Grade 55	ASTM A193 Grade B7 and ASTM F1554 Grade 105	ASTM A449	ASTM F593 CW Stainless (Types 304 and 316)	ASTM A193 Grade B8/B8M, Class 1 Stainless (Types 304 and 316)	ASTM A193 Grade B8/B8M2, Class 2B Stainless (Types 304 and 316)	ASTM A615 Grade 75 / Grade 80 Rebar	ASTM A615 Grade 60 Rebar	ASTM A706 Grade 60 Rebar	ASTM A615 Grade 40 Rebar
	ϕN_{sa} Tension (lbs.)	ϕN_{sa} Tension (lbs.)	ϕN_{sa} Tension (lbs.)	ϕN_{sa} Tension (lbs.)	ϕN_{sa} Tension (lbs.)	ϕN_{sa} Tension (lbs.)	ϕN_{sa} Tension (lbs.)	ϕN_{sa} Tension (lbs.)	ϕN_{sa} Tension (lbs.)	ϕN_{sa} Tension (lbs.)	ϕN_{sa} Tension (lbs.)
3/8 or #3	3,370	4,360	7,265	6,975	5,040	3,315	5,525	7,150	5,720	6,600	4,290
1/2 or #4	6,175	7,980	13,300	12,770	9,225	6,070	10,110	13,000	10,400	12,000	7,800
5/8 or #5	9,835	12,715	21,190	20,340	14,690	9,660	16,105	20,150	16,120	18,600	12,090
3/4 or #6	14,550	18,815	31,360	30,105	18,480	14,300	23,830	28,600	22,880	26,400	17,160

■ - Steel Strength

1. Steel tensile design strength according to ACI 318 (-19 or -14) Ch. 17 and ACI 318 Appendix D, $\phi N_{sa} = \phi \cdot A_{se,N} \cdot f_{uta}$
2. The tabulated steel design strength in tension must be checked against the bond strength/concrete capacity design strength to determine the controlling failure mode, the lowest load level controls.

Shear Design of Steel Elements (Steel Strength)

Steel Elements - Threaded Rod and Reinforcing Bar											
Nominal Rod/Rebar Size (in. or No.)	ASTM A36 and ASTM F1554 Grade 36	ASTM F1554 Grade 55	ASTM A193 Grade B7 and ASTM F1554 Grade 105	ASTM A449	ASTM F593 CW Stainless (Types 304 and 316)	ASTM A193 Grade B8/B8M, Class 1 Stainless (Types 304 and 316)	ASTM A193 Grade B8/B8M2, Class 2B Stainless (Types 304 and 316)	ASTM A615 Grade 75 / Grade 80 Rebar	ASTM A615 Grade 60 Rebar	ASTM A706 Grade 60 Rebar	ASTM A615 Grade 40 Rebar
	ϕV_{sa} Shear (lbs.)	ϕV_{sa} Shear (lbs.)	ϕV_{sa} Shear (lbs.)	ϕV_{sa} Shear (lbs.)	ϕV_{sa} Shear (lbs.)	ϕV_{sa} Shear (lbs.)	ϕV_{sa} Shear (lbs.)	ϕV_{sa} Shear (lbs.)	ϕV_{sa} Shear (lbs.)	ϕV_{sa} Shear (lbs.)	ϕV_{sa} Shear (lbs.)
3/8 or #3	1,755	2,265	3,775	3,625	2,790	1,725	2,870	3,960	3,170	3,430	2,375
1/2 or #4	3,210	4,150	6,915	6,640	5,110	3,155	5,255	7,200	5,760	6,240	4,320
5/8 or #5	5,115	6,610	11,020	10,575	8,135	5,025	8,375	11,160	8,930	9,670	6,695
3/4 or #6	7,565	9,785	16,305	15,655	10,235	7,435	12,390	15,840	12,670	13,730	9,505

■ - Steel Strength

1. Steel shear design strength according to ACI 318 (-19 or -14) Ch. 17 and ACI 318 Appendix D, $\phi V_{sa} = \phi \cdot 0.60 \cdot A_{se,V} \cdot f_{uta}$
2. The tabulated steel design strength in shear must be checked against the bond strength/concrete capacity design strength to determine the controlling failure mode, the lowest load level controls.
3. In the determination of the shear design strength values in cracked concrete, the steel strength requires an additional reduction factor applies for seismic shear ($\alpha_{v,seis}$), where seismic design is applicable.

INSTALLATION INSTRUCTIONS: SOLID BASE MATERIALS

DRILLING

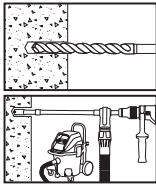

- 1- Drill a hole into the base material with rotary hammer drill (i.e. percussion drill) and a carbide drill bit to the size and embedment required by the selected steel hardware element (reference installation specifications for threaded rod and reinforcing bar). The tolerances of the carbide drill bits, including hollow bits, must meet ANSI Standard B212.15. Follow all tool instructions.
 - **Precaution:** Use suitable eye and skin protection. Avoid inhalation of dust during drilling and/or removal (see optional dust extraction equipment supplied by DEWALT to minimize dust emission).
 - **Note!** In case of standing water in the drilled hole (flooded hole condition), all the water has to be removed from the hole (e.g. vacuum, compressed air, etc.) prior to cleaning.
 - Drilling in dry base material is necessary when using hollow drill bits (vacuum must be on); not for use in wet concrete or masonry.

GO TO STEP 3 FOR HOLES DRILLED WITH DUSTX+™ DRILLING AND CLEANING SYSTEM; OTHERWISE GO TO STEP 2A.

HOLE CLEANING

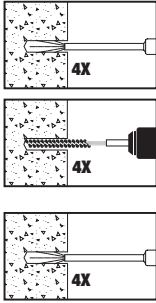

- 2a- Starting from the bottom or back of the anchor hole, blow the hole clean using a compressed air nozzle (min. 90 psi) or a hand pump (min. volume 25 fl. oz.) supplied by DEWALT a minimum of four times (4x).
 - Use a compressed air nozzle or a hand pump for anchor rod diameters 3/8" to 3/4" or reinforcing bar (rebar) sizes #3 to #6.
 - Use a compressed air nozzle for anchor rod diameter 7/8" to 1-1/4" and rebar sizes #7 to #10. Do not use a hand pump for these sizes.
- 2b- Determine wire brush diameter (see installation specifications) and attach the brush with adaptor to a rotary drill tool or battery screwgun. Brush the hole with the selected wire brush a minimum of four times (4x). A brush extension (supplied by DEWALT) should be used for holes drilled deeper than the listed brush length.
 - **Note!** The wire brush diameter should be checked periodically during use. The brush should resist insertion into the drilled hole and come into contact with the sides of the drilled hole. If not the brush is too small and must be replaced.
- 2c- Finally, blow the hole clean again using a compressed air nozzle (min. 90 psi) or a hand pump (min. volume 25 fl.oz.) supplied by DEWALT a minimum of four times (4x).
 - Use a compressed air nozzle or a hand pump for anchor rod diameters 3/8" to 3/4" or reinforcing bar (rebar) sizes #3 to #6.
 - Use a compressed air nozzle for anchor rod diameters 7/8" to 1-1/4" and rebar sizes #7 to #10. Do not use a hand pump for these sizes. When finished the hole should be clean and free of dust, debris, ice, grease, oil or other foreign material.

PREPARING

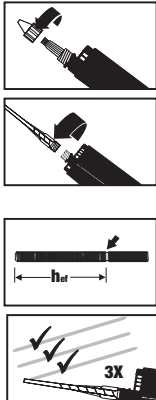

- 3- Check adhesive expiration date on cartridge label. Do not use expired product. Review Safety Data Sheet (SDS) before use. Cartridge temperature must be between 23°F to 95°F (-5°C to 35°C) when in use for concrete unless otherwise noted. Cartridge temperature must be between 41°F to 95°F (5°C to 35°C) when in use for masonry. Review gel (working) and cure time table. Consideration should be given to the reduced gel (working) time of the adhesive in warm temperatures.
 - Remove cap from cartridge.
 - Attach a supplied mixing nozzle to the cartridge. Unless otherwise noted do not modify the mixer in any way. Make sure the mixing element is inside the nozzle. Load the cartridge into the correct dispensing tool.
 - **Note!** Use a new mixing nozzle with new cartridges of adhesive and also for all work interruptions exceeding the published gel (working) time of the adhesive.
- 4- Prior to inserting the anchor rod or rebar into the drilled hole, the position of the embedment depth has to be marked on the anchor.
 - Verify anchor element is straight and free of surface damage.
- 5- Adhesive must be properly mixed to achieve published properties. For new cartridges and nozzles, prior to dispensing adhesive into the drilled hole, separately dispense at least three full strokes of adhesive through the mixing nozzle until the adhesive is a consistent **GRAY** color.
 - Unless otherwise noted, do not attach a used nozzle when changing to a new cartridge.
 - Review and note the published working and cure times (see gel time and curing time table) prior to injection of the mixed adhesive into the cleaned anchor hole.

INSTALLATION

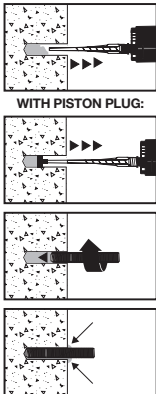

- 6- Fill the cleaned hole approximately two-thirds full with mixed adhesive starting from the bottom or back of the anchor hole. Slowly withdraw the mixing nozzle as the hole fills to avoid creating air pockets or voids. If the bottom or back of the anchor hole is not reached with the mixing nozzle only, a plastic extension tube supplied by DEWALT must be used with the mixing nozzle (see reference tables for installation).
 - Piston plugs must be used with and attached to mixing nozzle and extension tube for overhead (i.e. upwardly inclined) installations and horizontal installations with anchor sizes as indicated in the piston plug selection table. Insert piston plug to the back of the drilled hole and inject as described in the method above. During installation the piston plug will be naturally extruded from the drilled hole by the adhesive pressure.
 - **Attention!** Do not install anchors overhead without proper training and installation hardware provided by DEWALT. Contact DEWALT for details.
- 7- The anchor should be free of dirt, grease, oil or other foreign material. Push clean threaded rod or reinforcing bar into the anchor hole while turning slightly to ensure positive distribution of the adhesive until the embedment depth is reached. Observe the gel (working) time.
- 8- Be sure the rod or rebar is fully seated at the bottom of the hole to the specified embedment. Adhesive must completely fill the annular gap between the anchor and the base material. Protect exposed anchor threads from fouling with adhesive. For all installations the anchor must be restrained from movement throughout the specified curing period (as necessary) where necessary through the use of temporary wedges, external supports, or other methods. Minor adjustments to the position of the anchor element may be performed during the gel (working) time only.

CURING AND LOADING

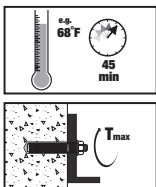

- 9- Allow the adhesive anchor to cure to the specified full curing time prior to applying any load (reference gel time and curing time table).
 - Do not disturb, torque or load the anchor until it is fully cured.
- 10- After full curing of the adhesive anchor, a fixture can be installed to the anchor and tightened up to the maximum torque (reference gel time and curing table) by using a calibrated torque wrench.
 - **Note!** Take care not to exceed the maximum torque for the selected anchor.

INSTALLATION INSTRUCTIONS: HOLLOW BASE MATERIALS AND UNREINFORCED MASONRY [URM WALLS]

DRILLING

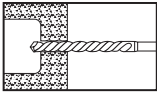

1- Drill a hole into the base material with a rotary drill tool to the size and embedment required by the selected screen tube size and steel anchor element (see installation specifications for threaded rod in hollow base material with screen tube supplied by DEWALT). Holes drilled in hollow concrete masonry units may be drilled with a rotary hammer-drill. The tolerances of the drill bit, including hollow drill bits, must meet the requirements of ANSI B212.15. Follow all tool instructions.

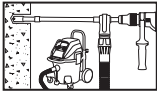

- Precaution: Wear suitable eye and skin protection. Avoid inhalation of dust during drilling and/or removal (see dust extraction by DEWALT to minimize dust emission).
- Drilling in dry base materials is necessary when using hollow drill bits (vacuum must be on); not for use in wet concrete or masonry.

GO TO STEP 3 FOR HOLES DRILLED WITH DUSTX+™ DRILLING AND CLEANING SYSTEM; OTHERWISE GO TO STEP 2.

HOLE CLEANING (BLOW 2X, BRUSH 2X, BLOW 2X)

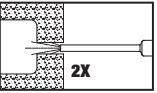

2- Starting from the bottom or back of the anchor hole, blow the hole clean with a hand pump with min. volume 25 fl.oz. supplied by DEWALT (Cat #08280-PWR) or compressed air nozzle a minimum of two times (2x).

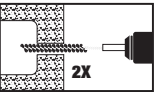

• Determine the wire brush diameter (see installation specifications) and attach the brush with adaptor to a rotary drill tool or battery screw gun. Brush the hole with the selected wire brush a minimum of two times (2x). A brush extension supplied by DEWALT (Cat. #08282-PWR) should be used for holes drilled deeper than the listed brush length.

• **Note!** The wire brush should be checked periodically during use. The brush should resist insertion into the drilled hole and come into contact with the sides of the drilled hole. If not the brush is too small and must be replaced.

• Finally, blow the hole clean again a minimum of two times (2x)

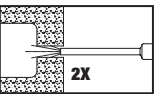

When finished the hole should be clean and free of dust, debris, ice, grease, oil or other foreign material.

PREPARING

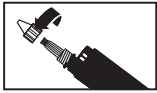

3- Check adhesive expiration date on cartridge label. Do not use expired product. Review Safety Data Sheet (SDS) before use. Cartridge temperature must be between 23°F to 95°F (-5°C to 35°C) when in use for concrete unless otherwise noted. Cartridge temperature must be between 41°F to 95°F (5°C to 35°C) when in use for masonry. Review gel (working) and cure time table. Consideration should be given to the reduced gel (working) time of the adhesive in warm temperatures.

• Remove cap from cartridge.

• Attach a supplied mixing nozzle to the cartridge. Unless otherwise noted do not modify the mixer in any way. Make sure the mixing element is inside the nozzle. Load the cartridge into the correct dispensing tool.

• **Note!** Use a new mixing nozzle with new cartridges of adhesive and also for all work interruptions exceeding the published gel (working) time of the adhesive.

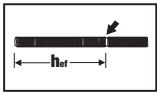

4- Prior to inserting the anchor rod or rebar into the drilled hole, the position of the embedment depth has to be marked on the anchor.

• Verify anchor element is straight and free of surface damage.

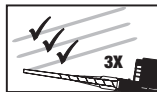

5- Adhesive must be properly mixed to achieve published properties. For new cartridges and nozzles, prior to dispensing adhesive into the drilled hole, separately dispense at least three full strokes of adhesive through the mixing nozzle until the adhesive is a consistent **GRAY** color.

• Unless otherwise noted, do not attach a used nozzle when changing to a new cartridge.

• Review and note the published working and cure times (see gel time and curing time table) prior to injection of the mixed adhesive into the cleaned anchor hole.

INSTALLATION

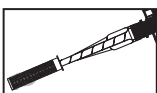

6- Select a screen tube of suitable length supplied by DEWALT. Fill the screen tube full with adhesive starting from the bottom or back of the tube. Slowly withdraw the mixing nozzle as the screen fills to avoid creating air pockets or voids. A plastic extension tube must be used with the mixing nozzle if the back of the screen tube cannot be reached (see reference tables for installation).

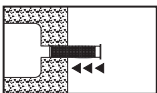

7- Insert the screen tube filled with adhesive into the cleaned anchor hole. Inject additional adhesive into the screen tube as necessary to ensure the screen tube is completely filled.

• **Note!** Overfilling the screen tube is acceptable but not required.

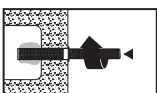

8- Prior to inserting the anchor rod into the screen tube inspect it to ensure that it is free of dirt, grease, oil or other foreign material.

• Push the threaded rod into the screen tube while turning slightly to ensure positive distribution of the adhesive until back of the tube is reached.

• **Note:** In cases where the drilled hole size is larger than specified due to rotary drilling (e.g. an elongated opening), the annular space between the screen tube and the hole at the base material surface must be filled with adhesive.

CURING AND FIXTURE

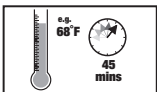

9- Allow the adhesive anchor to cure to the specified full curing time prior to applying any load.

• Do not disturb, torque or load the anchor until it is fully cured (see gel time and curing time table).



10- After full curing of the adhesive anchor, a fixture can be installed to the anchor and tightened up to the maximum torque (see installation specifications for threaded rod in hollow base material) by using a calibrated torque wrench.

• **Note!** Take care not to exceed the maximum torque for the selected anchor.

REFERENCE INSTALLATION TABLES

Gel (working) Time and Curing Table

Temperature of Base Material		Gel (working) Time	Full Curing Time
°F	°C		
14*	-10	90 minutes	24 hours
23	-5	90 minutes	14 hours
32	0	45 minutes	7 hours
41	5	25 minutes	2 hours
50	10	15 minutes	90 minutes
68	20	6 minutes	45 minutes
86	30	4 minutes	25 minutes
95	35	2 minutes	20 minutes
104	40	1.5 minutes	15 minutes

*Minimum temperature of base material is 14°F (-10°C) for concrete and 23°F (-5°C) for concrete masonry base materials. Cartridge temperature must be between 23°F to 95°F (-5°C to 35°C) when in use for concrete except for installations in base material temperatures between 14°F and 23°F (-10°C and -5°C) the cartridge temperature must be conditioned to between 68°F and 95°F (20°C - 35°C). Cartridge temperature must be between 41°F to 95°F (5°C to 35°C) when in use for masonry.
Linear interpolation to determine approximate gel and full curing times for intermediate base material temperatures is allowed.

Wire Brush Selection Table for AC100+ Gold^{1,2}

Nominal Wire Brush Size (inch)	ANSI Drill Bit Diameter (inch)	Brush Length (inches)	Steel Wire Brush (Cat. #)	Blowout Tool
Solid Base Material				
7/16	7/16	7	08284-PWR	Hand-pump (Cat #08280-PWR) or compressed air nozzle (e.g. Cat. #DFC165100)
9/16	9/16	7	08285-PWR	
5/8	5/8	7	08275-PWR	
11/16	11/16	9	08286-PWR	
3/4	3/4	9	08278-PWR	
7/8	7/8	9	08287-PWR	Compressed air nozzle only
1	1	11	08288-PWR	
1-1/8	1-1/8	11	08289-PWR	
1-3/8	1-3/8	11	08290-PWR	
1-1/2	1-1/2	11	08291-PWR	
Hollow Base Material (with Screen Tube)				
3/8	3/8 (SS screen)	7	08284-PWR	Hand pump (Cat# 08280-PWR) or compressed air nozzle (e.g. Cat. #DFC165100)
1/2	1/2 (SS screen)	7	08284-PWR	
9/16	9/16 (plastic screen)	7	08285-PWR	
5/8	5/8 (SS screen)	7	08275-PWR	
3/4	3/4 (plastic screen)	9	08278-PWR	
3/4	3/4 (SS screen)	9	08278-PWR	
7/8	7/8 (plastic screen)	9	08287-PWR	
7/8	7/8 (SS screen)	9	08287-PWR	
1	1 (SS screen)	11	08288-PWR	

1. An SDS-plus adaptor (Cat. #08283-PWR) or Jacobs chuck style adaptor (Cat. #08296-PWR) is available to attach a steel wire brush to the drill tool.
2. A brush extension (Cat. #08282-PWR) must be used for holes drilled deeper than the listed brush length.

For Retrofit Bolt Anchors in URM Walls, including separate installation details, see the table in this tech section entitled "Allowable Load Capacities for AC100+ Gold with Threaded Rods and Reinforcing Bars or Rebar Dowel Installed in Unreinforced Masonry Walls with Stainless Steel Screen Tubes".

Piston Plug Selection Table for Adhesive Anchors^{1,2,3,4}

Drill Bit Diameter (inch)	Plug Size (inch)	Piston Plug (Cat. #)	Premium Piston Plug (Cat. #)
11/16	11/16	08258-PWR	PFC1691515
3/4	3/4	08259-PWR	PFC1691520
7/8	7/8	08300-PWR	PFC1691530
1	1	08301-PWR	PFC1691540
1-1/8	1-1/8	08303-PWR	PFC1691550
1-1/4	1-1/4	08307-PWR	PFC1691555
1-3/8	1-3/8	08305-PWR	PFC1691560
1-1/2	1-1/2	08309-PWR	PFC1691570
1-3/4	1-3/4	-	PFC1691580
2	2	-	PFC1691590
2-3/16	2-3/16	-	PFC1691600

1. All overhead or upwardly inclined installations require the use of piston plugs where one is tabulated together with the anchor size.
2. All horizontal installations require the use of piston plugs where the embedment depth is greater than 8 inches and the drill bit size is larger than 5/8-inch.
3. The use of piston plugs is also recommended for underwater installations where one is tabulated together with the anchor size.
4. A flexible plastic extension tube (Cat. #08281-PWR or #08297-PWR) or equivalent approved by DEWALT must be used with piston plugs.

ORDERING INFORMATION

AC100+ Gold Cartridges (10:1 mix ratio)

Cat. No.	Description	Pack Qty.	Std. Carton	Pallet
8478SD-PWR	AC100+ Gold 9.5 fl. oz. Quick-Shot cartridge	12	36	648
8490SD-PWR	AC100+ Gold 28 fl. oz. dual cartridge	-	8	288

An AC100+ Gold mixing nozzle is packaged with each cartridge.

AC100+ Gold mixing nozzles must be used to ensure complete and proper mixing of the adhesive.



Cartridge System Mixing Nozzles and Extensions

Cat. No.	Description	Pack Qty.	Carton Qty.
08293-PWR	Mixing nozzle for AC100+ Gold	2	24
PFC1641600	Mixing nozzle (with an 8" extension)	2	24
08281-PWR	Mixing nozzle extension, 8" long (3/8" O.D.)	2	24
08297-PWR	Mixing nozzle extension, 20" long (3/8" O.D.)	12	36



Dispensing Tools for Injection Adhesive

Cat. No.	Description	Pack Qty.
DFC141100 (08437-PWR)	Manual caulking gun for Quick-Shot cartridge	1
DCE560D1	Cordless 20v battery powered tool for Quick-Shot	1
DFC141104 (08494-PWR)	28 oz. standard metal manual tool	1
08496-PWR	28 oz. pneumatic dispensing tool	1
DCE595D1	28 oz. 20v battery powered dispensing tool	1

Stainless Steel Screen Tubes

Cat. No.	Description	Drill Bit Dia.	Pack Qty.
07960-PWR	1/4" x 2" Screen Tube	3/8"	25
07862-PWR	1/4" x 6" Screen Tube*	3/8"	25
07864-PWR	1/4" x 8" Screen Tube*	3/8"	25
07856-PWR	3/8" x 2" Screen Tube	1/2"	25
07961-PWR	3/8" x 3-1/2" Screen Tube	1/2"	25
07962-PWR	3/8" x 6" Screen Tube*	1/2"	25
07963-PWR	3/8" x 8" Screen Tube*	1/2"	25
07964-PWR	3/8" x 10" Screen Tube*	1/2"	25
07959-PWR	3/8" x 12" Screen Tube*	1/2"	25
07857-PWR	1/2" x 2" Screen Tube	5/8"	25
07965-PWR	1/2" x 3-1/2" Screen Tube	5/8"	25
07966-PWR	1/2" x 6" Screen Tube	5/8"	25
07967-PWR	1/2" x 8" Screen Tube*	5/8"	25
07968-PWR	1/2" x 10" Screen Tube*	5/8"	25
07858-PWR	5/8" x 2" Screen Tube	3/4"	25
07969-PWR	5/8" x 4-1/2" Screen Tube	3/4"	20
07970-PWR	5/8" x 6" Screen Tube	3/4"	20
07971-PWR	5/8" x 8" Screen Tube	3/4"	20
07972-PWR	5/8" x 10" Screen Tube	3/4"	20
07859-PWR	3/4" x 2" Screen Tube	7/8"	25
07973-PWR	3/4" x 6" Screen Tube	7/8"	10
07977-PWR	3/4" x 8" Screen Tube	7/8"	10
07974-PWR	3/4" x 10" Screen Tube	7/8"	10
07975-PWR	3/4" x 13" Screen Tube	7/8"	10
07978-PWR	3/4" x 17" Screen Tube	7/8"	10
07855-PWR	15/16" x 2" Screen Tube	1"	25
07865-PWR	15/16" x 8" Screen Tube	1"	10
07867-PWR	15/16" x 13" Screen Tube	1"	10
07869-PWR	15/16" x 17" Screen Tube	1"	10

Screen tubes are made from a 300 series stainless steel. The nominal diameter of the screen listed indicates the matching rod diameter (except for the 15/16" screen tubes). 15/16" screen tubes can accept 3/4" diameter threaded rods and #4, #5 or #6 reinforcing bars for unreinforced masonry wall applications (URM).
*Includes extension straw..

Hole Cleaning Tools and Accessories

Cat. No.	Description	Pack Qty.
08284-PWR	Wire brush for 7/16" or 1/2" ANSI hole, 7" length	1
08285-PWR	Wire brush for 9/16" ANSI hole, 7" length	1
08275-PWR	Wire brush for 5/8" ANSI hole, 7" length	1
08286-PWR	Wire brush for 11/16" ANSI hole, 9" length	1
08278-PWR	Wire brush for 3/4" ANSI hole, 9" length	1
08287-PWR	Wire brush for 7/8" ANSI hole, 9" length	1
08288-PWR	Wire brush for 1" ANSI hole, 11" length	1
08289-PWR	Wire brush for 1-1/8" ANSI hole, 11" length	1
08276-PWR	Wire brush for 1-1/4" ANSI hole, 11" length	1
08290-PWR	Wire brush for 1-3/8" ANSI hole, 11" length	1
08291-PWR	Wire brush for 1-1/2" ANSI hole, 11" length	1
08299-PWR	Wire brush for 1-3/4" ANSI hole, 11" length	1
08271-PWR	Wire brush for 2" ANSI hole, 11" length	1
08272-PWR	Wire brush for 2-3/16" ANSI hole, 11" length	1
08283-PWR	SDS-plus adapter for steel brushes	1
08296-PWR	Standard drill adapter for steel brushes (e.g. Jacobs Chuck)	1
08282-PWR	Steel brush extension, 12" length	1
08280-PWR	Hand pump/dust blower (25 fl. oz. cylinder volume)	1
DFC165100	Air blow gun kit with guard & extension, 22" length	1

Premium Piston Plugs

Cat. No.	Description	Drill Bit Dia.	Pack Qty.
PFC1691510	5/8" Plug	5/8"	1
PFC1691515	11/16" Plug	11/16"	1
PFC1691520	3/4" Plug	3/4"	1
PFC1691530	7/8" Plug	7/8"	1
PFC1691540	1" Plug	1"	1
PFC1691550	1-1/8" Plug	1-1/8"	1
PFC1691555	1-1/4" Plug	1-1/4"	1
PFC1691560	1-3/8" Plug	1-3/8"	1
PFC1691570	1-1/2" Plug	1-1/2"	1
PFC1691580	1-3/4" Plug	1-3/4"	1
PFC1691590	2" Plug	2"	1
PFC1691600	2-3/16" Plug	2-3/16"	1

Piston Plugs for Adhesive Anchors

Cat. No.	Description	Drill Bit Dia.	Pack Qty.	Carton Qty.
08304-PWR	5/8" Plug	5/8"	10	100
08258-PWR	11/16" Plug	11/16"	10	100
08259-PWR	3/4" Plug	3/4"	10	100
08300-PWR	7/8" Plug	7/8"	10	100
08301-PWR	1" Plug	1"	10	100
08303-PWR	1-1/8" Plug	1-1/8"	10	100
08305-PWR	1-3/8" Plug	1-3/8"	10	100
08307-PWR	1-1/4" Plug	1-1/4"	10	100
08309-PWR	1-1/2" Plug	1-1/2"	10	100

A plastic extension tube (Cat# 08281-PWR or 08297-PWR) or equivalent approved by DEWALT must be used with piston plugs.

Plastic Screen Tubes



Cat. No.	Description	Drill Bit Dia.	Pack Qty.
08310-PWR	3/8" x 3-1/2" Plastic Screen	9/16"	25
08311-PWR	3/8" x 6" Plastic Screen	9/16"	25
08313-PWR	3/8" x 8" Plastic Screen	9/16"	25
08315-PWR	1/2" x 3-1/2" Plastic Screen	3/4"	25
08317-PWR	1/2" x 6" Plastic Screen	3/4"	25
08321-PWR	5/8" x 6" Plastic Screen	7/8"	25
08323-PWR	3/4" x 6" Plastic Screen	1"	10

The nominal diameter of the screen listed indicates the matching rod diameter.



SDS Max 4-Cutter Carbide Drill Bits

Cat. No.	Diameter	Usable Length	Overall Length
DW5806	5/8"	8"	13-1/2"
DW5809	5/8"	16"	21-1/2"
DW5807	5/8"	31"	36"
DW5808	11/16"	16"	21-1/2"
DW5810	3/4"	8"	13-1/2"
DW5812	3/4"	16"	21-1/2"
DW5813	3/4"	31"	36"
DW5814	13/16"	16"	21-1/2"
DW5815	7/8"	8"	13-1/2"
DW5816	7/8"	16"	21-1/2"
DW5851	7/8"	31"	36"
DW5818	1"	8"	13-1/2"
DW5819	1"	16"	22-1/2"
DW5852	1"	24"	29"
DW5820	1"	31"	36"
DW5821	1-1/8"	10"	15"
DW5822	1-1/8"	18"	22-1/2"
DW5853	1-1/8"	24"	29"
DW5854	1-1/8"	31"	36"
DW5824	1-1/4"	10"	15"
DW5825	1-1/4"	18"	22-1/2"

SDS+ Full Head Carbide Drill Bits



Cat. No.	Diameter	Usable Length	Overall Length
DW5527	3/8"	4"	6-1/2"
DW5529	3/8"	8"	10"
DW55300	3/8"	10"	12"
DW5531	3/8"	16"	18"
DW5537	1/2"	4"	6"
DW5538	1/2"	8"	10-1/2"
DW5539	1/2"	10"	12"
DW5540	1/2"	16"	18"



SDS+ 4-Cutter Carbide Drill Bits

Cat. No.	Diameter	Usable Length	Overall Length
DW5471	5/8"	8"	10"
DW5472	5/8"	16"	18"
DW5474	3/4"	8"	10"
DW5475	3/4"	16"	18"
DW5477	7/8"	8"	10"
DW5478	7/8"	16"	18"
DW5479	1"	8"	10"
DW5480	1"	16"	18"
DW5481	1-1/8"	8"	10"
DW5482	1-1/8"	6"	18"

Dust Extraction

Cat. No.	Description
DWV015	10 Gallon Wet/Dry Hepa/Rrp Dust Extractor DWV9402 Fleece bag (5 pack) for DEWALT dust extractors DWV9316 Replacement Anti-Static Hose DWV9320 Replacement HEPA Filter Set (Type 1)
DWH050K	Dust Extraction with two interchangeable drilling heads
DCB1800B	1800 Watt Portable Power Station & Parallel Battery Charger Bare Unit



Hollow Drill Bits

Shank	Cat. No.	Diameter	Overall Length	Usable Length	Recommended Hammer
SDS+	DWA54012	1/2"	14-1/2"	9-3/4"	DCH133 / DCH273 / DCH293
	DWA54916	9/16"	14-1/2"	9-3/4"	DCH133 / DCH273 / DCH293
	DWA54058	5/8"	14-1/2"	9-3/4"	DCH133 / DCH273 / DCH293
	DWA54034	3/4"	14-1/2"	9-3/4"	DCH133 / DCH273 / DCH293
SDS Max	DWA58058	5/8"	23-5/8"	15-3/4"	DCH481 / D25603K
	DWA58958	5/8"	47-1/4"	39-3/8"	DCH481 / D25603K
	DWA58116	11/16"	24-3/4"	15-3/4"	DCH481 / D25603K
	DWA58034	3/4"	23-5/8"	15-3/4"	DCH481 / D25603K
	DWA58934	3/4"	47-1/4"	39-3/8"	DCH481 / D25603K
	DWA58078	7/8"	23-5/8"	15-3/4"	DCH481 / D25603K
	DWA58001	1"	23-5/8"	15-3/4"	DCH481 / D25603K
	DWA58901	1"	47-1/4"	39-3/8"	DCH481 / D25603K
	DWA58118	1-1/8"	23-5/8"	15-3/4"	DCH481 / D25603K
	DWA58918	1-1/8"	47-1/4"	39-3/8"	DCH481 / D25603K
	DWA58115	1-1/4"	23-5/8"	15-3/4"	DCH481 / D25603K
	DWA58114	1-1/4"	47-1/4"	39-3/8"	DCH481 / D25603K
	DWA58138	1-3/8"	47-1/4"	39-3/8"	DCH481 / D25603K
	DWA58112	1-1/2"	47-1/4"	39-3/8"	DCH481 / D25603K

