

# ICC-ES Evaluation Report

ESR-3196

Reissued October 2024

This report also contains:



- [City of LA Supplement](#)

Subject to renewal October 2025

- [FL Supplement w/ HVHZ](#)

ICC-ES Evaluation Reports are not to be construed as representing aesthetics or any other attributes not specifically addressed, nor are they to be construed as an endorsement of the subject of the report or a recommendation for its use. There is no warranty by ICC Evaluation Service, LLC, express or implied, as to any finding or other matter in this report, or as to any product covered by the report.

Copyright © 2024 ICC Evaluation Service, LLC. All rights reserved.

<p><b>DIVISION: 04 00 00—</b> <b>MASONRY</b></p> <p><b>Section: 04 05 19.16—</b> <b>Masonry Anchors</b></p>	<p><b>REPORT HOLDER:</b> <b>DEWALT</b></p>  <p><b>ADDITIONAL LISTEE:</b> <b>ALL POINTS SCREW, BOLT &amp; SPECIALTY</b> <b>THE HILLMAN GROUP</b></p>	<p><b>EVALUATION SUBJECT:</b> <b>ULTRACON®+ SCREW ANCHORS IN MASONRY (DEWALT)</b></p>	
---	--	---	---

## 1.0 EVALUATION SCOPE

**Compliance with the following codes:**

- 2024, 2021, 2018, 2015 and 2012 [International Building Code® \(IBC\)](#)
- 2024, 2021, 2018, 2015 and 2012 [International Residential Code \(IRC\)](#)

Main references of this report are for the 2024 IBC and IRC. See [Table 5](#) and [Table 6](#) for applicable sections of the code for previous IBC and IRC editions.

**Property evaluated:**

Structural

## 2.0 USES

The UltraCon+ screw anchors, including product names described in Section 3.1 of this report, are used as anchorage to resist static, wind and seismic tension and shear loads in fully grout-filled concrete masonry units.

The UltraCon+ screw anchors are alternatives to cast-in-place anchors described in Section 8.1.4 of TMS 402 and as referenced in Section 2107.1 of the IBC.

The UltraCon+ screw anchors are permitted to be used in structures regulated under the IRC, provided an engineered design is submitted in accordance with Section R301.1.3.

## 3.0 DESCRIPTION

### 3.1 UltraCon+ Screw Anchors:

The screw anchors are comprised of a one-piece threaded anchor body with a hex head, a slotted hex head, countersunk flat head with either a Phillips drive or star drive recess, or countersunk TrimFit flat head with either a Phillips drive or star drive recess.

Product names for the report holder and the additional listees are presented in the following table of this report.

COMPANY NAME	PRODUCT NAME
DEWALT	UltraCon®+
All Points Screw, Bolt & Specialty	AP Tapper+
The Hillman Group	Hillman Tapper+

Available nominal diameters are  $\frac{3}{16}$ -inch and  $\frac{1}{4}$ -inch. The anchors are manufactured from low-carbon steel that is case-hardened, and they have a Stalgard® coating (Perma-seal® for Tapper+) available in various colors. The UltraCon+ screw anchor and drill bits are illustrated in [Figure 2](#) of this report.

The anchor body is formed with alternating high-low threads and a gimlet point tip. The anchors are installed in a predrilled hole with a powered tool during which the threads on the anchor body tap into the sides of the predrilled hole and interlock with the base material during installation. Installation specifications are given in [Table 1](#) and [Figures 1](#) and [3](#) of this report.

### 3.2 Grout-filled Concrete Masonry:

The specified compressive strength of masonry,  $f'_m$ , at 28 days must be a minimum of 1,500 psi (10.3 MPa). Fully grouted masonry walls must be constructed from the following materials:

**3.2.1 Concrete Masonry Units (CMUs):** Grout-filled concrete masonry walls must be constructed from minimum 6-inch-wide (152 mm), Grade N, Type II, concrete masonry units (CMUs) conforming to ASTM C90.

**3.2.2 Grout:** Grout-filled concrete masonry units must be fully grouted with grout complying with Section 2103.3 of the IBC, or Section R606 of the IRC. The grout must have a minimum compressive strength of 2,000 psi (13.8 MPa) at 28 days

**3.2.3 Mortar:** Mortar must be Types M, S or N, prepared in accordance with Section 2103 of the IBC, or Section R606.

## 4.0 DESIGN AND INSTALLATION

### 4.1 Allowable Stress Design:

The design load values for anchors described in this report are based on allowable stress design (ASD) under the codes described in Section 1.0 of this report.

Allowable tension and shear loads for installation in fully grout-filled masonry wall faces are noted in [Table 3](#) of this report. The allowable tension and shear loads are for anchors installed in the grouted cells, the center web of the concrete masonry units and horizontal mortared bed joints of the fully grouted CMU construction. Allowable loads for anchors installed within  $1\frac{3}{8}$  inches (35 mm) of the vertical (head) joint, as depicted in [Figure 4](#), are beyond the scope of this report.

Allowable tension and shear loads for installation in fully grout-filled masonry wall tops are noted in [Table 4](#) of this report. The allowable tension and shear loads are for anchors installed at a minimum end distance of 3 inches (76 mm) and a minimum edge distance of  $1\frac{1}{2}$  inches (38 mm). Allowable loads for anchors installed within  $1\frac{1}{2}$  inches (38 mm) of the vertical (head) joint are beyond the scope of this report.

The allowable loads for anchors installed in fully grout-filled concrete masonry subjected to combined tension and shear forces must be determined by the following equation:

$$\left(\frac{P_s}{P_t}\right) + \left(\frac{V_s}{V_t}\right) \leq 1$$

where:

$P_s$  = Applied service tension load.

$P_t$  = Allowable service tension load.

$V_s$  = Applied service shear load.

$V_t$  = Allowable service shear load.

### 4.2 Installation:

Anchors must be installed in accordance with this report ([Figure 3](#)) and the manufacturer's published installation instructions (MPII). Anchor locations must comply with the approved plans and specifications. The anchors must not be installed until the base material has reached its minimum designated compressive strength. The UltraCon+ drill bit size, hole diameter, hole depth, embedment depth, spacing, edge distance and base material must comply with the requirements of this report. Installation procedures and locations must be in accordance with [Tables 1](#), [3](#) and [4](#) as well as [Figures 1](#), [3](#) and [4](#) of this report.

### 4.3 Special Inspections:

Anchors must be installed with special inspection. Special inspection must be in accordance with Section 1704 and 1705 of the IBC. For fasteners installed under special inspection, the following items must be inspected: fastener type, fastener dimensions, masonry dimensions and compressive strength, grout and mortar

compliance with Section 3.2 of this report, drill bit size, fastener spacing, edge distances and fastener embedment (as applicable). The special inspector must verify that anchor installation is in compliance with this report and in accordance with the manufacturer's published installation instructions.

## 5.0 CONDITIONS OF USE:

The UltraCon<sup>®</sup>+ Screw Anchors in masonry described in this report are suitable alternatives to what is specified in the codes listed in Section 1.0 of this report, subject to the following conditions:

- 5.1 The anchors must be identified and installed in accordance with this report and the manufacturer's published installation instructions. In the event of a conflict between the instructions in this report and the manufacturer's instructions, this report must govern.
- 5.2 UltraCon+ screw anchor sizes, dimensions, and allowable loads must be as set forth in this report.
- 5.3 Anchors resisting static, seismic and wind tension and shear loads in concrete masonry must be designed in accordance with Section 4.1 of this report.
- 5.4 For installations in concrete masonry, anchors are recognized to static, seismic and wind tension and shear load applications. When using the basic load combinations in accordance with IBC Section 1605.1, allowable loads are not permitted to be increased for seismic or wind loading. The allowable loads or load combinations must not be adjusted.
- 5.5 Grout and mortar shall have reached its minimum specified compressive strength prior to installation of the anchors.
- 5.6 Anchors must be installed in holes predrilled in substrates described in this report, using only UltraCon+ carbide-tipped drill bits complying with the dimensions in [Table 1](#) of this report.
- 5.7 Calculations demonstrating that the applied loads are less than the allowable loads described in this report must be submitted to the code official for approval. The calculations must be prepared by a registered design professional where required by the statutes of the jurisdiction in which the project is being constructed.
- 5.8 Since an ICC-ES acceptance criteria for evaluating data to determine the performance of screw anchors subjected to fatigue and shock loading is unavailable at this time, the use of these anchors under these conditions is beyond the scope of this report.
- 5.9 Where not otherwise prohibited by the code, anchors are permitted for installation in fire-resistance-rated construction provided at least one of the following conditions is fulfilled:
  - Anchors are used to resist wind or seismic forces only.
  - Anchors that support fire-resistance-rated construction or gravity load-bearing structural elements are within a fire-resistance-rated envelope or a fire-resistance-rated membrane, are protected by approved fire-resistance-rated materials, or have been evaluated for resistance to fire exposure in accordance with recognized standards.
  - Anchors are used to support nonstructural elements.
- 5.10 Since evaluation of the performance of screw anchors in cracked masonry is beyond the scope of this criteria, the use of screw anchors is limited to installation in uncracked masonry. Cracking occurs when  $f_t > f_r$  due to service loads or deformations.
- 5.11 Special inspection, when required, must be provided in accordance with Section 4.3 of this report.
- 5.12 See [ESR-3213](#) for installation in which UltraCon+ screw anchors are used in contact with treated wood.
- 5.13 Anchors are limited to dry, interior use.
- 5.14 The UltraCon+ screw anchors are manufactured under an approved quality control program with inspections by ICC-ES.

## 6.0 EVIDENCE SUBMITTED

Data in accordance with the [ICC-ES Acceptance Criteria for Predrilled Fasteners \(Screw Anchors\) in Masonry \(AC106\)](#), dated March 2018 (editorially revised September 2024).

## 7.0 IDENTIFICATION

- 7.1 The ICC-ES mark of conformity, electronic labeling, or the evaluation report number (ICC-ES ESR-3196) along with the name, registered trademark, or registered logo of the report holder and/or listee must be included in the product label.

7.2 In addition, the screw anchors and additional product names described in Section 3.1 of this report must be identified in the field by labels on the packaging bearing the company name (DEWALT), the product name (UltraCon+), the anchor diameter and length.. In addition, the anchor length code (see [Table 2](#)) is stamped on the head of each screw anchor.

7.3 The report holder's contact information is the following:

**DEWALT**  
**701 EAST JOPPA ROAD**  
**TOWSON, MARYLAND 21286**  
**(800) 524-3244**  
[www.DEWALT.com](http://www.DEWALT.com)  
[anchors@DEWALT.com](mailto:anchors@DEWALT.com)

7.4 The additional listees' contact information is the following:

**ALL POINTS SCREW, BOLT & SPECIALTY**  
**1590 NW 27TH AVENUE, #9**  
**POMPANO BEACH, FLORIDA 33069**  
[info@allpointsscrew.com](mailto:info@allpointsscrew.com)

**THE HILLMAN GROUP**  
**10590 HAMILTON AVENUE**  
**CINCINNATI, OHIO 45231**  
[info@hillmangroup.com](mailto:info@hillmangroup.com)

TABLE 1—ULTRACON+ SCREW ANCHOR INSTALLATION SPECIFICATIONS<sup>1</sup>

Anchor Property / Setting Information	Symbol	Units	Nominal Anchor Size, d (inch)	
			<sup>3</sup> / <sub>16</sub>	<sup>1</sup> / <sub>4</sub>
Nominal outside anchor diameter	$d_a$	in.	0.145	0.185
Nominal drill bit diameter	$d_{bit}$	in.	<sup>5</sup> / <sub>32</sub> UltraCon+ bit	<sup>3</sup> / <sub>16</sub> UltraCon+ bit
UltraCon+ bit tolerance range	-	in.	0.170 to 0.176	0.202 to 0.206
Hex head wrench / socket size	$d_h$	in.	<sup>1</sup> / <sub>4</sub>	<sup>5</sup> / <sub>16</sub>
Hex head Height	-	in.	<sup>7</sup> / <sub>64</sub>	<sup>9</sup> / <sub>64</sub>
Flat head bit tip size	Phillips drive	-	No. 2	3
	star drive	-	T-25	T-25

For SI: 1 inch = 25.4 mm, 1 ft-lb = 1.356 N-m.

TABLE 2—FASTENER SPECIFICATIONS – ULTRACON+ SCREW ANCHOR

Length ID marking on head <sup>1</sup>		#	A	B	C	D	E	F	G	H	I	J
Overall anchor length, $\ell_{anch}$ , (inches)	From	1	1 <sup>1</sup> / <sub>2</sub>	2	2 <sup>1</sup> / <sub>2</sub>	3	3 <sup>1</sup> / <sub>2</sub>	4	4 <sup>1</sup> / <sub>2</sub>	5	5 <sup>1</sup> / <sub>2</sub>	6
	Up to but not including	1 <sup>1</sup> / <sub>2</sub>	2	2 <sup>1</sup> / <sub>2</sub>	3	3 <sup>1</sup> / <sub>2</sub>	4	4 <sup>1</sup> / <sub>2</sub>	5	5 <sup>1</sup> / <sub>2</sub>	6	6 <sup>1</sup> / <sub>2</sub>

For SI: 1 inch = 25.4 mm; 1 psi = 6.9 kPa.

<sup>1</sup>For purposes of measuring overall fastener length, the hex head versions are measured from the underside of the head to the bottom of the tip; flat head versions of the UltraCon+ are measured from the top of the head to the tip of the anchor.

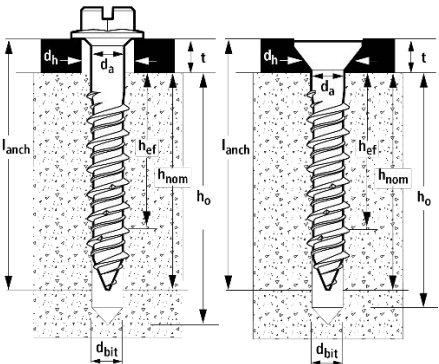

FIGURE 1—SCREW ANCHOR DETAIL

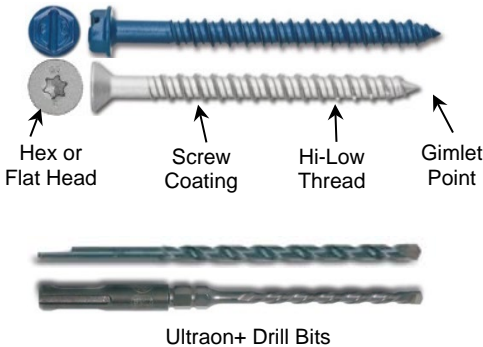

FIGURE 2—ULTRACON+ SCREW ANCHORS AND DRILL BITS

(Slotted Hex Head and star drive flat head shown for illustration – Shank and thread specifications are the same for screws with other head types.)

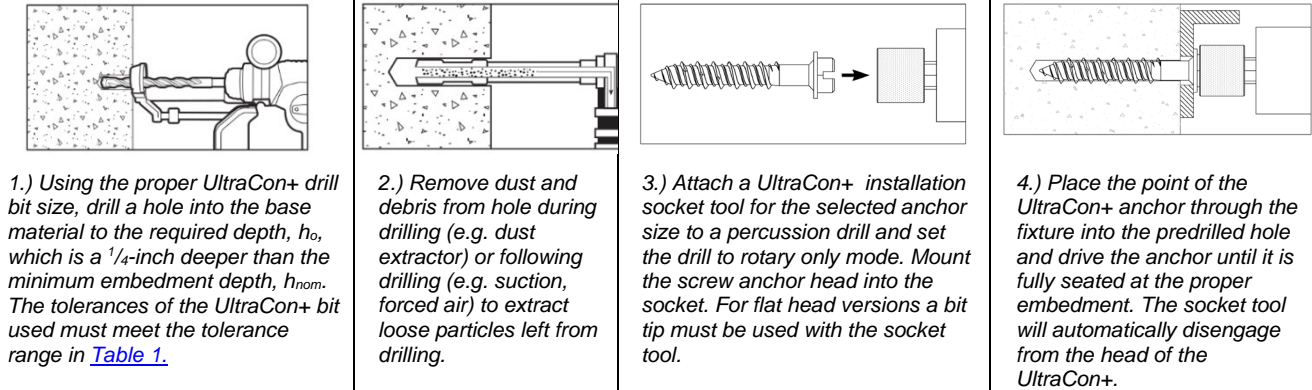

FIGURE 3—ULTRACON+ INSTALLATION INSTRUCTIONS

TABLE 3—ALLOWABLE TENSION AND SHEAR LOADS FOR ULTRACON+ SCREW ANCHORS  
INSTALLED IN THE FACE OF GROUT-FILLED CONCRETE MASONRY<sup>1,2,3,4,5</sup>

ANCHOR INSTALLED INTO GROUTED MASONRY WALL FACE								
NOMINAL ANCHOR SIZE $d$ (inch)	MINIMUM EMBEDMENT $h_{nom}$ (inches)	MINIMUM EDGE / END DISTANCE, $C_{min}$ (inches)	MINIMUM SPACING, $S_{min}$ (inches)	TENSION (pounds)		SHEAR (pounds)		
				Minimum Masonry Compressive Strength, $f'_m$		Direction of Loading	Minimum Masonry Compressive Strength, $f'_m$	
				1,500 psi	2,000 psi		1,500 psi	2,000 psi
$\frac{3}{16}$	$1\frac{1}{2}$	3	$1\frac{1}{2}$	80	95	Towards edge	115	135
						Towards end	130	150
$\frac{1}{4}$	$1\frac{1}{2}$	3	2	130	150	Any	200	235

For SI: 1 inch = 25.4 mm; 1 lbs = 0.0044 kN.

<sup>1</sup>The tabulated allowable loads are for anchors installed in minimum 6-inch-wide (152 mm) grout-filled concrete masonry units described in Section 3.2 of this report and must have reached the minimum specified masonry compressive strength at the time of installation.

<sup>2</sup>The minimum embedment,  $h_{nom}$ , is measured from the outside surface of the concrete masonry unit to the embedded end of the anchor.

<sup>3</sup>anchors may only be installed in the grouted cells and in cell webs and bed joints not closer than  $1\frac{3}{8}$  inches from head joints. The minimum edge and end distances,  $C_{min}$ , must be maintained.

<sup>4</sup>The tabulated minimum edge and end distances,  $C_{min}$ , are equal to the critical edge distance,  $C_{cr}$ , for the anchors. The tabulated minimum spacing  $S_{min}$ , is also equal to the critical spacing,  $S_{cr}$ , for the anchors.

<sup>5</sup>The tabulated allowable loads are based on a safety factor of 5.0.

TABLE 4—ALLOWABLE TENSION AND SHEAR LOADS FOR ULTRACON+ SCREW ANCHORS  
INSTALLED INTO THE TOP OF GROUT-FILLED CONCRETE MASONRY<sup>1,2,3,4,5</sup>

ANCHOR INSTALLED INTO TOP OF GROUTED MASONRY WALLS									
NOMINAL ANCHOR SIZE $d$ (inch)	MINIMUM EMBEDMENT $h_{nom}$ (inches)	MINIMUM EDGE DISTANCE $C_{min,1}$ (inches)	MINIMUM END DISTANCE $C_{min,2}$ (inches)	MINIMUM SPACING $S_{min}$ (inches)	TENSION (pounds)		SHEAR (pounds)		
					Minimum Masonry Compressive Strength, $f'_{\text{m}}$		Direction of Loading	Minimum Masonry Compressive Strength, $f'_{\text{m}}$	
					1,500 psi	2,000 psi		1,500 psi	2,000 psi
$\frac{3}{16}$	$1\frac{1}{2}$	$1\frac{1}{2}$	3	3	90	105	Any	100	115
$\frac{1}{4}$	$1\frac{1}{2}$	$1\frac{1}{2}$	3	2	165	190	Any	155	180

For SI: 1 inch = 25.4 mm; 1 lbs = 0.0044 kN.

<sup>1</sup>The tabulated allowable loads are for anchors installed in minimum 6-inch-wide (152 mm) grout-filled concrete masonry units described in Section 3.2. of this report and must have reached the minimum specified masonry compressive strength at the time of installation.

<sup>2</sup>The minimum embedment,  $h_{nom}$ , is measured from the outside surface of the concrete masonry unit to the embedded end of the anchor.

<sup>3</sup>anchors may only be installed in the grouted cells not closer than  $1\frac{1}{2}$  inches from head joints. The minimum edge and end distances,  $C_{min}$ , must be maintained.

<sup>4</sup>The tabulated minimum edge and end distances,  $C_{min}$ , are equal to the critical edge distance,  $C_{cr}$ , for the anchors. The tabulated minimum spacing  $S_{min}$ , is also equal to the critical spacing,  $S_{cr}$ , for the anchors.

<sup>5</sup>The tabulated allowable loads are based on a safety factor of 5.0.

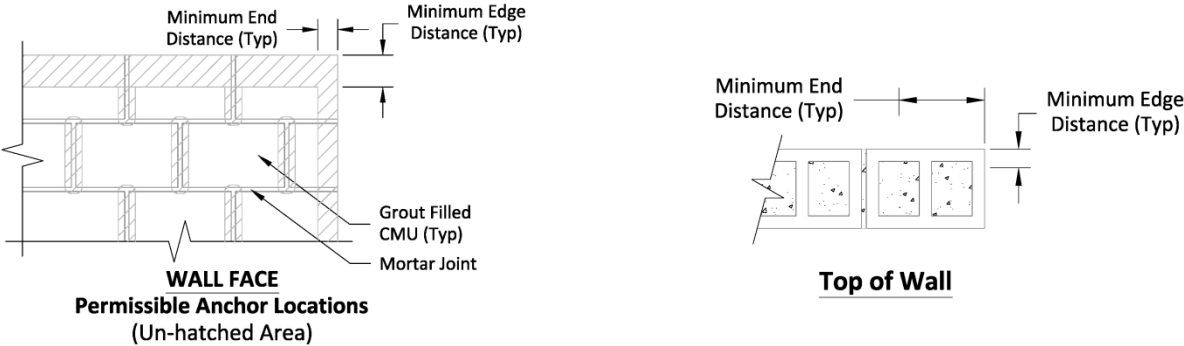

FIGURE 4—ULTRACON+ SCREW ANCHORS INSTALLED INTO GROUT-FILLED CONCRETE MASONRY

TABLE 5— APPLICABLE SECTIONS OF THE IBC CODE UNDER EACH EDITION OF THE IBC AND IRC

IBC				
<u>2024 IBC</u>	<u>2021 IBC</u>	<u>2018 IBC</u>	<u>2015 IBC</u>	<u>2012 IBC</u>
<u>Section 1605.1</u>		<u>Section 1605.3.1</u>		
<u>Section 1704</u>				
<u>Section 1705</u>				
<u>Section 2103</u>				
<u>Section 2103.3</u>				<u>Section 2103.13</u>
<u>Section 2107.1</u>				
IRC				
<u>2024 IRC</u>	<u>2021 IRC</u>	<u>2018 IRC</u>	<u>2015 IRC</u>	<u>2012 IRC</u>
R301.1.3				
R606				R607 and R609.1.1

TABLE 6— APPLICABLE SECTIONS OF TMS 402 UNDER EACH EDITION OF THE IBC

IBC				
2024 IBC	2021 IBC	2018 IBC	2015 IBC	2012 IBC
TMS 402-22	TMS 402-16		TMS 402-13	TMS 402-11
Section 8.1.4	Section 8.1.3			Section 2.1.4



DIVISION: 04 00 00—MASONRY  
Section: 04 05 19.16—Masonry Anchors

**REPORT HOLDER:****DEWALT****EVALUATION SUBJECT:****ULTRACON®+ SCREW ANCHORS IN MASONRY (DEWALT)****1.0 REPORT PURPOSE AND SCOPE****Purpose:**

The purpose of this evaluation report supplement is to indicate that the UltraCon+ screw anchors in masonry, described in ICC-ES evaluation report [ESR-3196](#), have also been evaluated for compliance with the codes noted below as adopted by the Los Angeles Department of Building and Safety (LADBS).

**Applicable code editions:**

- 2023 City of Los Angeles Building Code ([LABC](#))
- 2023 City of Los Angeles Residential Code ([LARC](#))

**2.0 CONCLUSIONS**

The UltraCon+ screw anchors in masonry, described in Sections 2.0 through 7.0 of the evaluation report [ESR-3196](#), comply with the LABC Chapter 21, and the LARC, and are subjected to the conditions of use described in this report.

**3.0 CONDITIONS OF USE**

The UltraCon+ screw anchors in masonry described in this evaluation report supplement must comply with all of the following conditions:

- All applicable sections in the evaluation report [ESR-3196](#).
- The design, installation, conditions of use and identification of the anchors are in accordance with the 2021 *International Building Code*® (IBC) provisions noted in the evaluation report [ESR-3196](#).
- The design, installation and inspection are in accordance with additional requirements of LABC Chapters 16 and 17, as applicable.
- Under the LARC, an engineered design in accordance with LARC Section R301.1.3 must be submitted.
- The allowable design values listed in the evaluation report and tables are for the connection of the anchors to masonry substrate. The connection between the anchors and the connected members shall be checked for capacity (which may govern).
- For use in wall anchorage assemblies to flexible diaphragm applications, anchors shall be designed per the requirements of City of Los Angeles Information Bulletin P/BC 2023-071.

This supplement expires concurrently with the evaluation report, reissued October 2024.

# ICC-ES Evaluation Report

# ESR-3196 FL Supplement w/HVHZ

Reissued October 2024

This report is subject to renewal October 2025.

[www.icc-es.org](http://www.icc-es.org) | (800) 423-6587 | (562) 699-0543

A Subsidiary of the International Code Council®

DIVISION: 04 00 00—MASONRY

Section: 04 05 19.16—Masonry Anchors

REPORT HOLDER:

DEWALT

EVALUATION SUBJECT:

ULTRACON®+ SCREW ANCHORS IN MASONRY (DEWALT)

## 1.0 REPORT PURPOSE AND SCOPE

### Purpose:

The purpose of this evaluation report supplement is to indicate that UltraCon+ screw anchors in masonry, described in ICC-ES evaluation report ESR-3196, have also been evaluated for compliance with the codes noted below.

### Applicable code editions:

- 2023 *Florida Building Code—Building*
- 2023 *Florida Building Code—Residential*

## 2.0 CONCLUSIONS

The UltraCon+ screw anchors in masonry, described in Sections 2.0 through 7.0 of the evaluation report ESR-3196, comply with the *Florida Building Code—Building* and the *Florida Building Code—Residential*. The design requirements must be determined in accordance with the *Florida Building Code—Building* and the *Florida Building Code—Residential*, as applicable. The installation requirements noted in ICC-ES evaluation report ESR-3196 for the 2021 *International Building Code*® meet the requirements of the *Florida Building Code—Building* and the *Florida Building Code—Residential*, as applicable.

Use of the UltraCon+ screw anchors in masonry has also been found to be in compliance with the High-Velocity Hurricane Zone provisions of the *Florida Building Code—Building* and the *Florida Building Code—Residential*, with the following additional conditions:

- a) Design and installation must meet the requirements of Section 2122.7 of the *Florida Building Code—Building*.
- b) For anchorage to wood members, the connection subject to uplift, must be designed for no less than 700 pounds (3114 N).

For products falling under Florida Rule 61G20-3, verification that the report holder's quality assurance program is audited by a quality-assurance entity approved by the Florida Building Commission for the type of inspections being conducted is the responsibility of an approved validation entity (or the code official when the report holder does not possess an approval by the Commission).

This supplement expires concurrently with the evaluation report, reissued October 2024.