

Installation of DuPont™ Styrofoam™ Brand XPS Insulation Products for Interior Unvented Crawl Spaces

For Single-Family Residential Buildings

Products for Installation

This installation guide covers single-family installation procedures for the **Styrofoam™ Brand XPS Insulation** products below:

- Styrofoam™ Brand Scoreboard
- Styrofoam™ Brand Square Edge
- Styrofoam™ Brand Tongue & Groove

Applications

- Interior unvented crawl spaces in single-family residential buildings

Personal Protective Equipment (PPE)

- Gloves (cut resistant advised)
- Safety glasses
- Hearing protection as necessary if/when using power tools and equipment

Site Preparation & Storage

- DuPont™ Styrofoam™ Brand XPS Insulation products should be stored on a clean, flat surface in an area free from flammable or volatile materials.
- Styrofoam™ Brand XPS Insulation must not contact hot objects, such as chimneys, furnace, and water heater flues, or any heat source greater than 165° F.
- Avoid reflective surfaces adjacent to the insulation. Surfaces, like glass or polished metal, adjacent to the insulation can direct extra solar energy onto a horizontally placed insulation board, and excessively increase the surface temperature.
- Ensure a clear work area free of debris and trip hazards.

Notices

- Check local codes or consult AHJ to ensure appropriate insulation thickness meets IECC Energy Code requirements.
- Reference [ESR-4755](#), local codes, or consult AHJ regarding thermal and/or ignition barrier requirements.
- Protection against termites: check local codes or consult AHJ to ensure compliance in areas where probability of termite infestation is very heavy.
- Styrofoam™ can be installed by individuals without prior training or certification.

Helpful Hints & Tools

- Styrofoam™ Brand XPS Insulation will not prevent bulk water entry, it essential to seal the wall prior to installing the insulation.
- Confirm chemical compatibility of Styrofoam™ Brand XPS Insulation with the concrete dampproofing/sealer.
- Waterproofing and dampproofing materials should not be used for adhering the insulation. The insulation should be installed once the damp-proofing has cured sufficiently, as the solvents in some of these materials may attack polystyrene insulation.
- Installation tools may include but not limited to, marker or pencil, straightedge, chalk line, hammer, drill or impact driver, caulk gun and adhesive, tape measure, utility knife, hand-held saw.
- Scaffolding, step stool, or ladder in proper working order.

Installation Procedures: Interior Unvented Crawl Spaces

Step 1

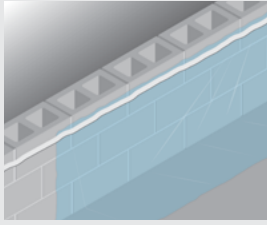

If needed, attach vapor retarder to the interior stem wall using water-based adhesive mastic. Extend the vapor retarder onto the ground about 1 to 2 feet from the wall.

Step 2



Attach the **Styrofoam™ Brand XPS Insulation** to the interior of the crawl space wall 24" o.c. vertically and 48" o.c. horizontally using power-driven fastener with 1-inch washers or caps.

Insulation should extend from the top of the stem wall to the footer, grade beam, or slab as applicable.

Step 3

Method A



Use **Froth-Pak™ Foam Insulation** up to 2 inches in thickness.

Refer to: <https://www.dupont.com/content/dam/dupont/amer/us/en/performance-building-solutions/public/documents/en/tech-solutions-2190-froth-pak-in-rim-joists-43-d100741-enus>.

Method B

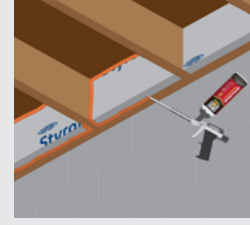

Use **Styrofoam™ Brand XPS Insulation** up to 2 inches in thickness, cut to fit between the floor joists, and seal the edges of the foam with **Great Stuff Pro™ Gaps & Cracks**.

Step 4



Seal all penetrations through the crawl space wall with **Great Stuff Pro™ Gaps & Cracks**.



**For more information about
DuPont Performance Building Solutions
please call 1-833-338-7668 or visit us at
building.dupont.com**

NOTICE: No freedom from any patent owned by DuPont or others is to be inferred. Because use conditions and applicable laws may differ from one location to another and may change with time, Customer is responsible for determining whether products and the information in this document are appropriate for Customer's use and for ensuring that Customer's workplace and disposal practices are in compliance with applicable laws and other government enactments. The product shown in this literature may not be available for sale and/or available in all geographies where DuPont is represented. The claims made may not have been approved for use in all countries or regions. DuPont assumes no obligation or liability for the information in this document. References to "DuPont" or the "Company" mean the DuPont legal entity selling the products to Customer unless otherwise expressly noted. NO EXPRESS WARRANTIES ARE GIVEN EXCEPT FOR ANY APPLICABLE WRITTEN WARRANTIES SPECIFICALLY PROVIDED BY DUPONT. ALL IMPLIED WARRANTIES INCLUDING THOSE OF MERCHANTABILITY AND FITNESS FOR A PARTICULAR PURPOSE ARE EXPRESSLY EXCLUDED. The buyer assumes all risks as to the use of the material. Buyer's exclusive remedy or any claim (including without limitations, negligence, strict liability, or tort) shall be limited to the refund of the purchase price of the material. Failure to strictly adhere to any recommended procedures shall release DuPont Specialty Products USA, LLC or its affiliates, of all liability with respect to the materials or the use thereof. The information herein is not intended for use by non-professional designers, applicators or other persons who do not purchase or utilize this product in the normal course of their business.

DuPont™, the DuPont Oval Logo, and all trademarks and service marks denoted with ™, SM or ® are owned by affiliates of DuPont de Nemours, Inc. unless otherwise noted. © 2024 DuPont. All rights reserved.

Form No. 43-D101329-enUS-0624 CDP