

DuPont™ Styrofoam™ Brand Wallmate™ XPS Insulation

Insulation Recommendations

OVERVIEW

DuPont™ Styrofoam™ Brand Wallmate™ Extruded Polystyrene (XPS) Foam Insulation is specially designed to insulate basement walls from the inside. Styrofoam™ Brand Wallmate™ Insulation has an R-value* of 5.0 per inch and resists moisture, keeping your basement comfortable all year long. It is quick and easy to install directly on masonry walls.

The following procedures are recommended for fast and easy installation of Styrofoam™ Brand Wallmate™ Insulation.

Before installing Styrofoam™ Brand Wallmate™ Insulation on the interior basement wall, be sure there are no leaks or structural cracks in the wall. Styrofoam™ Brand Wallmate™ Insulation insulates the basement wall; it does not stop water leakage.

Measuring And Cutting

1. To measure, mark board by dragging measuring tape hook along the surface of a board while holding the other end of the tape at the desired measurement (Figure 1).

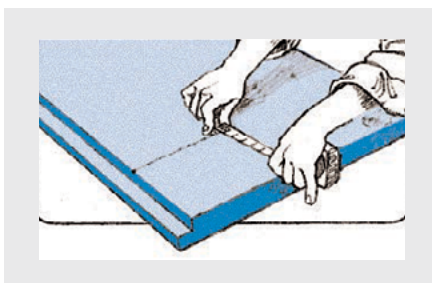

Figure 1

2. To cut, hold utility knife low against the board and make a deep impression. There is no need to cut all the way through.
3. Break board over the edge of a table.

Installation

1. Position boards of Styrofoam™ Brand Wallmate™ Insulation vertically against wall, ensuring they are plumb at right angles (90 degrees).
2. Place a 1" x 3" furring strip into the slot between two adjoining boards (Figure 2). Option: Using a 2" x 3" furring strip will provide an air space behind drywall for installation of electrical wiring.

3. With electric drill and masonry bit, drill holes through furring strips 1-1/2" into concrete wall. Concrete fasteners should be 1-1/4" longer than the insulation board thickness. (To secure board to wall, use three or four screws per 8' length of furring strip.)

Option: Styrofoam™ Brand Wallmate™ Insulation can be installed horizontally with furring strips running every 2'.

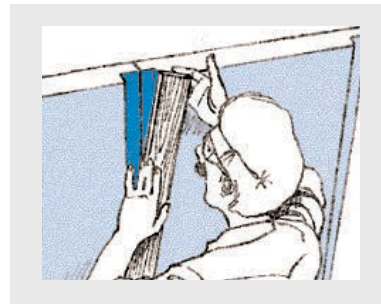

Figure 2

Measuring For Exact Fit

1. Styrofoam™ Brand Wallmate™ Insulation can be installed in tight spaces, even if the wall is uneven. Position insulation board squarely against corner, overlapping inside edge of last board installed (Figure 3).

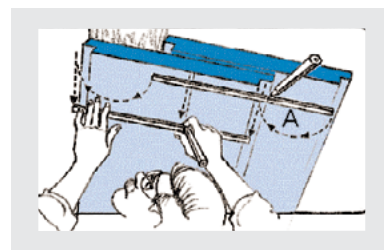

Figure 3

2. Using a 2'-long stick, measure from the outside edge of the last board installed to the outside edge of the new board (distance 'A'). Mark 'A' on stick.
3. Place stick against wall. With a pencil at 'A', move it down the board to be cut.
4. Cut along marked line.
5. Install overlap piece in corner.

Electrical Outlets

1. Cut a block of wood the same size as the electrical outlet box. Block thickness should ensure that the edge of the electrical outlet box will be flush with the drywall. Fasten wood block onto concrete wall with concrete fasteners.

Materials Checklist

To install DuPont™ Styrofoam™ Brand Wallmate™ Extruded Polystyrene (XPS) Foam Insulation, you need:

- Cut-proof gloves
- Measuring tape
- Level
- Hand saw
- Utility knife
- Hammer
- 1" x 3" Furring strips
- Electric drill
- Masonry bits, screwdriver bits
- Masonry nails and screws, such as Tapcon screws
- Drywall
- Drywall screws
- Outlet boxes
- Electrical wire, wire staples
- Polystyrene-compatible interior caulk, caulking gun
- Polystyrene-compatible spray foam adhesive, such as Great Stuff™ polyurethane foam sealant
- Safety glasses

2. Place insulation board over woodblock and tap firmly with hand, forming an imprint of the block on the back side of the insulation board. Turn board over and cut out imprint (Figure 4).

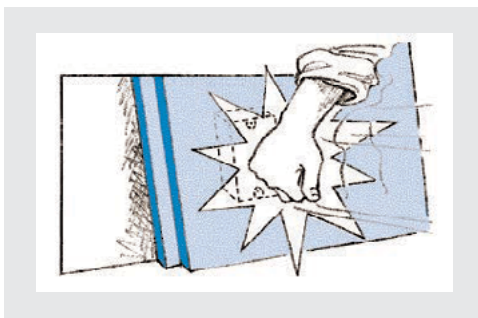

Figure 4

3. To accommodate electrical wires, cut 1/2"-deep channel on the back of the insulation board with utility knife (Figure 5). Use electrical staples to hold wires in place.

Caution: Some localities do not allow homeowners to do their own electrical work. In others, a permit is required. Check your local building code for rules and regulations. DuPont recommends that electrical work be done by qualified individuals only.

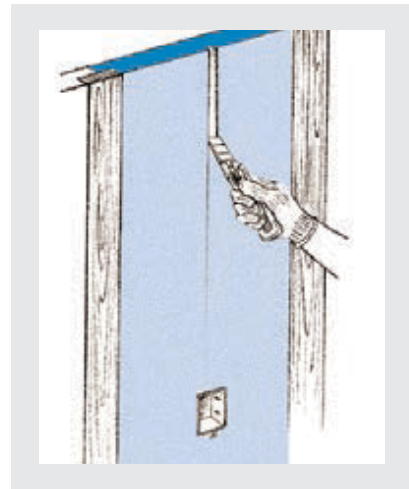

Figure 5

Plumbing Fixtures

To install Styrofoam™ Brand Wallmate™ Insulation around plumbing fixtures protruding from the wall, ensure furring strips are positioned on either side of the pipe. Trim slotted edge of insulation board to ensure the next furring strip is on 24" centers. For areas behind plumbing that cannot be filled with Styrofoam™ Brand Wallmate™ Insulation, fill with polystyrene-compatible spray foam insulation.

Windows And Doorways

1. Extend window and door framing so it will be flush with finishing drywall.
2. Place Styrofoam™ Brand Wallmate™ Insulation against window or door frame and tap (as with electrical outlet), making an imprint of the area to be cut on the back side of the board (Figure 6).

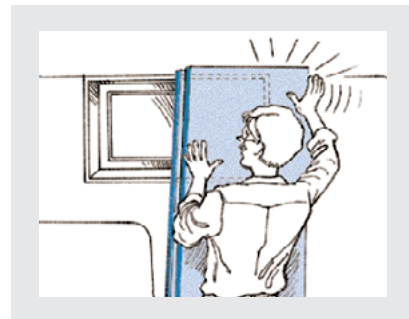

Figure 6

3. Turn board over and cut out imprint.
4. Seal the space between DuPont™ Styrofoam™ Brand Wallmate™ Extruded Polystyrene (XPS) Foam Insulation and the window or door frame with polystyrene compatible caulk.

Corners

Styrofoam™ Brand Wallmate™ Insulation can be installed to the outside or inside edge at corners of interior basement walls.

Outside (Figure 7)

1. Press drywall corner bead over outside corner of wall covered with Styrofoam™ Brand Wallmate™ Insulation.
2. Attach first drywall sheet flush to the corner, using drywall screws to fasten to corner bead.
3. Install second drywall sheet to cover end of first sheet.
4. Fasten to other flange of drywall corner bead.
5. For wall finishing, install second drywall corner bead over drywall corner by fastening with drywall screws to first corner bead.

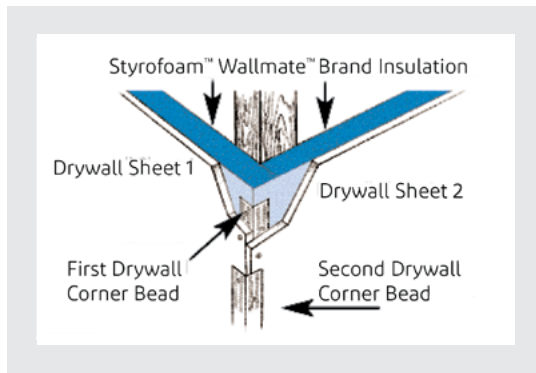

Figure 7

Inside (Figure 8)

1. Press a drywall corner bead into inside corner formed by boards of Styrofoam™ Brand Wallmate™ Insulation.
2. Butt first drywall board into corner, and fasten to corner bead flange using drywall screws.
3. Butt second drywall board to first, and fasten to other corner bead flange using drywall screws.

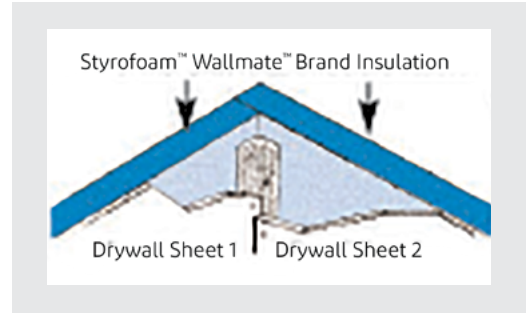

Figure 8

Install Drywall

With furring strips 2' apart around room perimeter, installing drywall over Styrofoam™ Brand Wallmate™ Insulation is fast and simple.

Use a wedge to lift the bottom of the drywall from floor before fastening. This will protect the drywall from incidental water on the basement floor.

Tape and finish drywall according to manufacturer's directions.



**For more information visit
Styrofoam.com
or call 1-866-583-2583**

NOTICE: No freedom from any patent owned by DuPont or others is to be inferred. Because use conditions and applicable laws may differ from one location to another and may change with time, Customer is responsible for determining whether products and the information in this document are appropriate for Customer's use and for ensuring that Customer's workplace and disposal practices are in compliance with applicable laws and other government enactments. The product shown in this literature may not be available for sale and/or available in all geographies where DuPont is represented. The claims made may not have been approved for use in all countries or regions. DuPont assumes no obligation or liability for the information in this document. References to "DuPont" or the "Company" mean the DuPont legal entity selling the products to Customer unless otherwise expressly noted. NO EXPRESS WARRANTIES ARE GIVEN EXCEPT FOR ANY APPLICABLE WRITTEN WARRANTIES SPECIFICALLY PROVIDED BY DUPONT. ALL IMPLIED WARRANTIES INCLUDING THOSE OF MERCHANTABILITY AND FITNESS FOR A PARTICULAR PURPOSE ARE EXPRESSLY EXCLUDED. The buyer assumes all risks as to the use of the material. Buyer's exclusive remedy or any claim (including without limitations, negligence, strict liability, or tort) shall be limited to the refund of the purchase price of the material. Failure to strictly adhere to any recommended procedures shall release DuPont Specialty Products USA, LLC or its affiliates, of all liability with respect to the materials or the use thereof. The information herein is not intended for use by non-professional designers, applicators or other persons who do not purchase or utilize this product in the normal course of their business.

CAUTION: This product is combustible. Protect from high heat sources. A protective barrier or thermal barrier may be required as specified in the appropriate building code. For more information, consult (Material) Safety Data Sheet ((M)SDS), call DuPont at 1-866-583-2583 or contact your local building inspector. In an emergency, call 1-989-636-4400 in the U.S. or 1-519-339-3711 in Canada.

WARNING: Rigid foam insulation does not constitute a working walkable surface or qualify as a fall protection product.

DuPont™, the DuPont Oval Logo, and all trademarks and service marks denoted with ™, SM or ® are owned by affiliates of DuPont de Nemours, Inc. unless otherwise noted. © 2019 DuPont.