

## Insulation Attachment Patterns

### Item Description

Fastening Patterns

### Product Information

### Description:

The diagrams below show the required patterns for proper placement of approved fasteners and plates for insulation on Standard Firestone 55 mph Roofing Systems.

The most common fastener density and pattern requirements are shown on this technical information sheet. Certain specifications may call for increased densities of fasteners in the perimeters and corners of roofs. For non-standard fastener densities, contact The Quality Building Services Technical Department at 800-428-4511 or visit the Firestone Website at [www.firestonebpc.com](http://www.firestonebpc.com).

### Minimum Number of Fasteners and Plates

<u>Property</u>	<u>Insulation</u>	<u>Thickness</u>	<u>4'x4' Boards</u>	<u>4'x8' Boards</u>
Mechanically Fastened Systems*:	Any approved insulation	Any approved thickness	4	5
Non-Mechanically Fastened Systems:	ISO 95+™ GL Insulation, RESISTA™ Insulation, HailGard™ Composite Board, ISO 95+™ GL Woodfiber Composite, or ISOGARD™ HD Composite	0.5"-1.4"	8	16
		1.5"-1.9"	6	12
		2"-4"	4	8
	FiberTop™ Insulation Structodeck HD (with primed red coating)	0.5"-1"	8	16
	ISOGARD™ HD Cover Board	0.5"-1"	6	12
	DensDeck® or SECUROCK® Gypsum Fiber Roof Board (in a single-ply system)	0.25"	8	16
		0.50"	6	12
		0.625"	4	8
	DensDeck Prime® (in a single-ply system)	0.25"	6	12
		0.50"	5	10
		0.625"	4	8
DensDeck® or SECUROCK® Gypsum Fiber Roof Board	Any approved thickness	6	12	
DensDeck Prime® (in an asphalt system)	Any approved thickness	4	8	

*(All the above insulations require the minimum fastener densities listed)*

*\*Contact the Quality Building Services Technical Department for fastening rates with and air or vapor barrier/retarder.*

## Insulation Attachment Patterns

### Fastening Patterns: Representing 4'x8' insulation boards

Please refer to the above mentioned attachment patterns for a specific board attachment rate. For further information relating to attachment patterns or system specifications please refer to the Firestone Technical Database at [www.firestonebpco.com](http://www.firestonebpco.com).

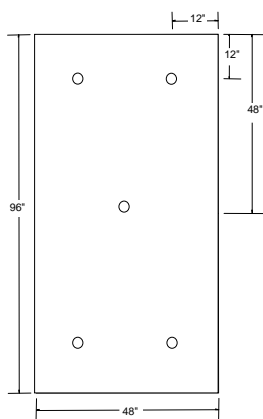

**5 fasteners**

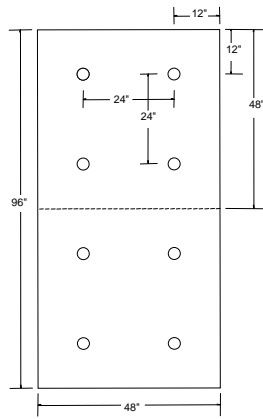

**8 fasteners**

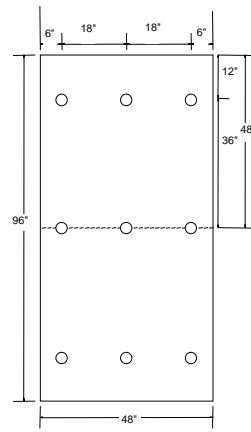

**9 fasteners**

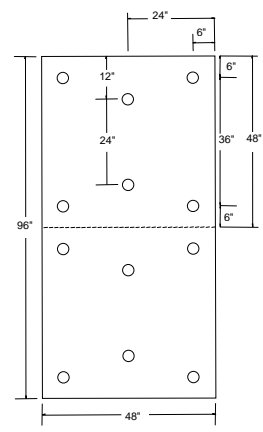

**12 fasteners**

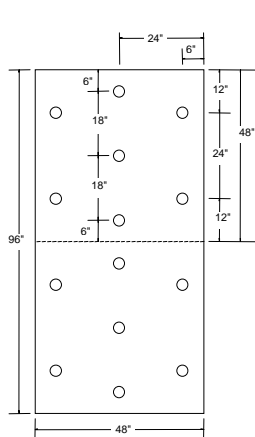

**14 fasteners**

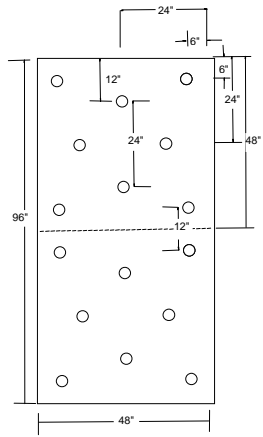

**16 fasteners**

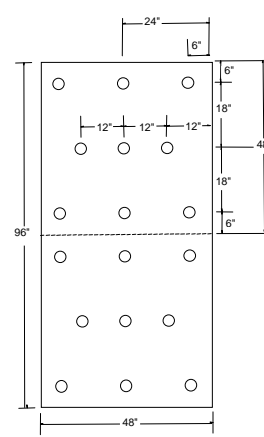

**18 fasteners**

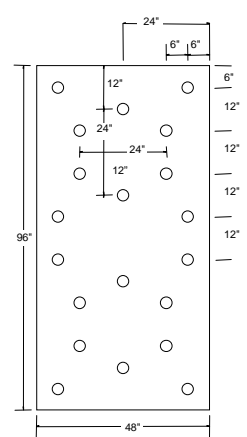

**20 fasteners**

## Insulation Attachment Patterns

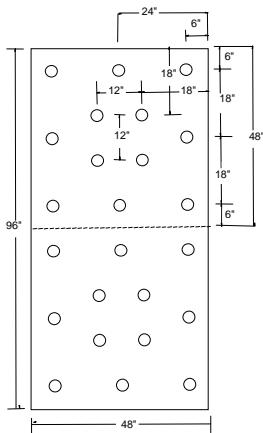

24 fasteners

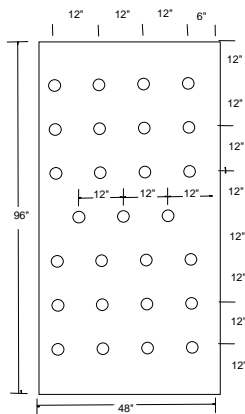

27 fasteners

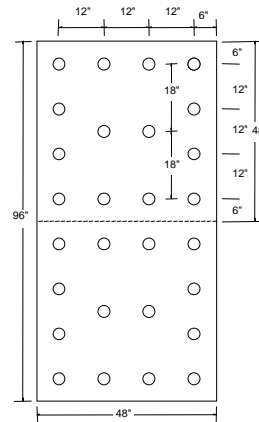

28 fasteners

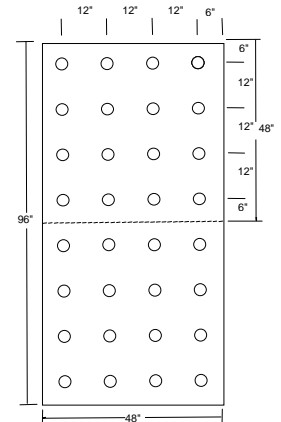

32 fasteners

### FM Global fastening pattern for 1-90 attachment of ISOGARD™HD Cover Board

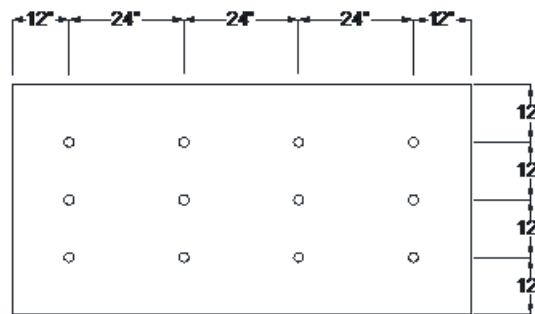

Please contact the Quality Building Services Technical Department at 1-800-428-4511 for further information.

*This sheet is meant to highlight Firestone products and specifications and is subject to change without notice. Firestone takes responsibility for furnishing quality materials which meet published Firestone product specifications. Neither Firestone nor its representatives practice architecture. Firestone offers no opinion on and expressly disclaims any responsibility for the soundness of any structure. Firestone accepts no liability for structural failure or resultant damages. Consult a competent structural engineer prior to installation if the structural soundness or structural ability to properly support a planned installation is in question. No Firestone representative is authorized to vary this disclaimer.*